

Trans Cooler Bracket Instructions

KIT CONTENTS:

- ✓ (1) Lower Bracket
- ✓ (2) Upper Brackets
- ✓ (4) 1/4"x20 Socket Headed Bolts
- ✓ (4) 1/4" Lock Washers
- ✓ (4) 1/4" Flat Washers
- ✓ (4) 1/4"x20 Hex Nuts
- ✓ (4) 1/4" Diameter Aluminum Standoff Spacers
- ✓ (2) Self-Drilling Screws
- ✓ **OPTIONAL** – (1) Tru-Cool 40K Transmission Cooler

HOW TO ORIENT YOUR HARDWARE:

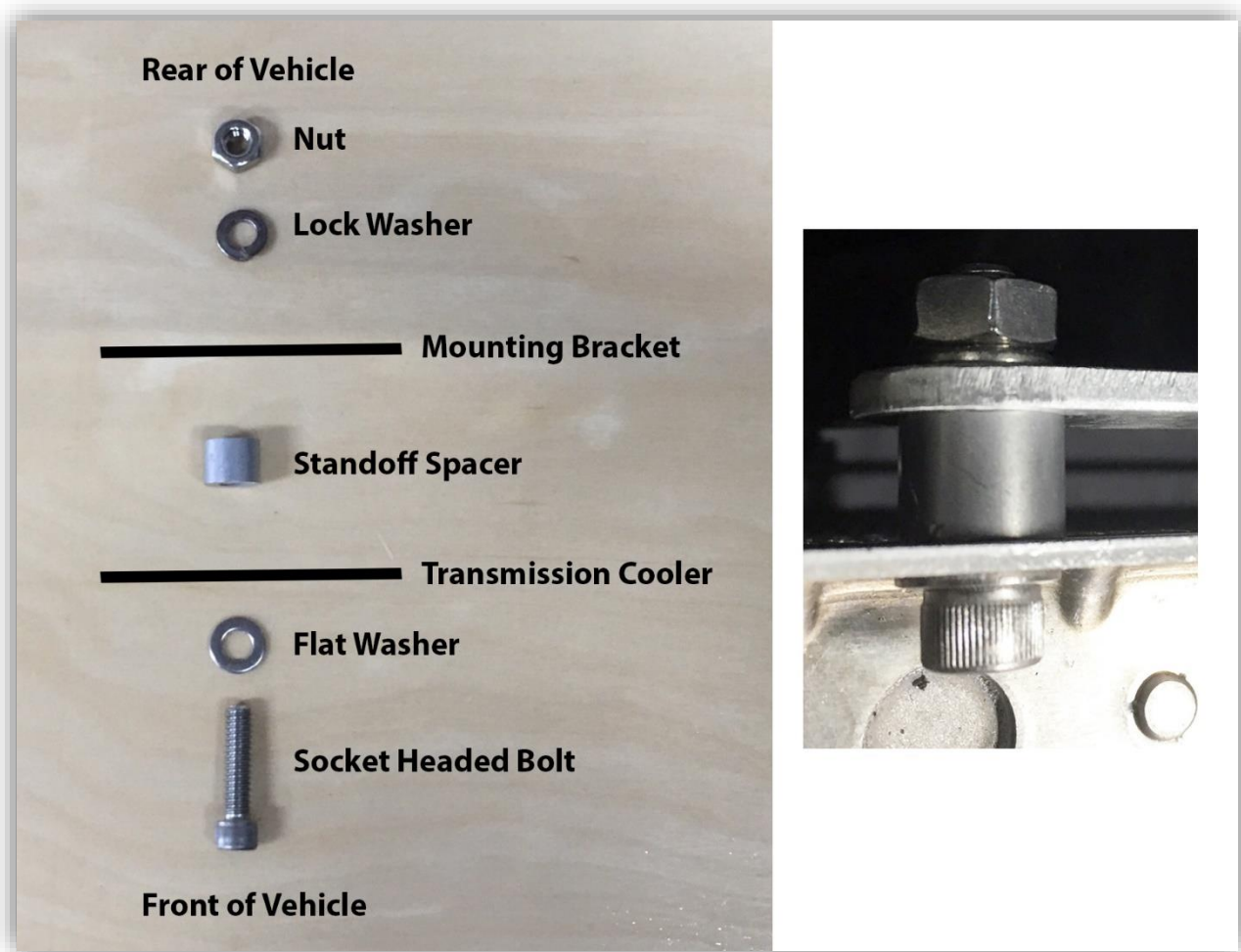

Step 1

Remove OE cooler assembly (if applicable) and OE core support cross brace (SEE FIGURE 1). **Be sure to retain the OE cross brace mounting hardware, as it will be reused.** The lower bracket included in this kit will replace the OE lower core support cross brace.

NOTE: If your vehicle is equipped with an ambient air temperature sensor (SEE FIGURE 2), it will need to be relocated, or modified to fit the new lower bracket.

If your vehicle is equipped with an OE power steering cooler assembly, the aluminum standoff spacers will be utilized to ensure clearance between the Tru-Cool 40K Transmission Cooler and OE power steering cooler bracket mounting hardware (SEE FIGURE 3). If your vehicle is not equipped with an OE power steering cooler, use of the aluminum standoff spacers is optional.

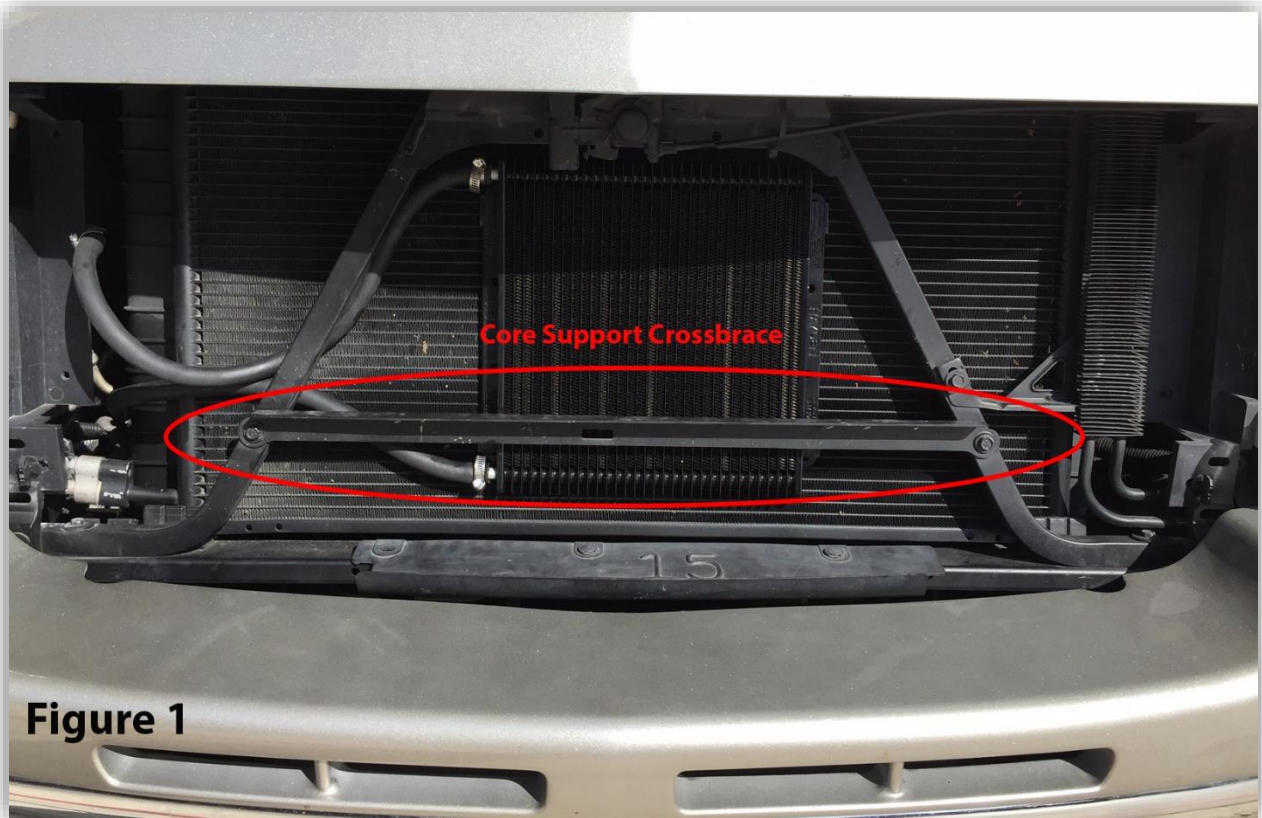



Figure 2

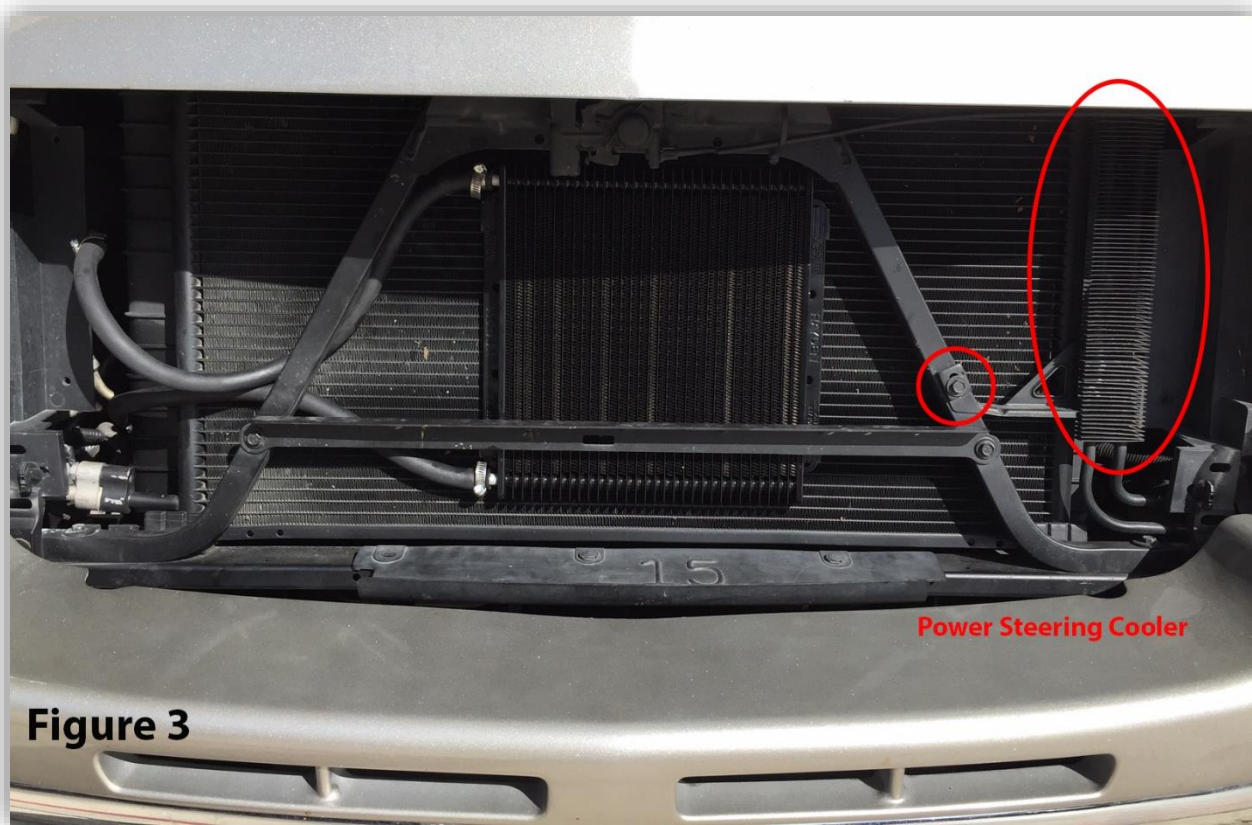
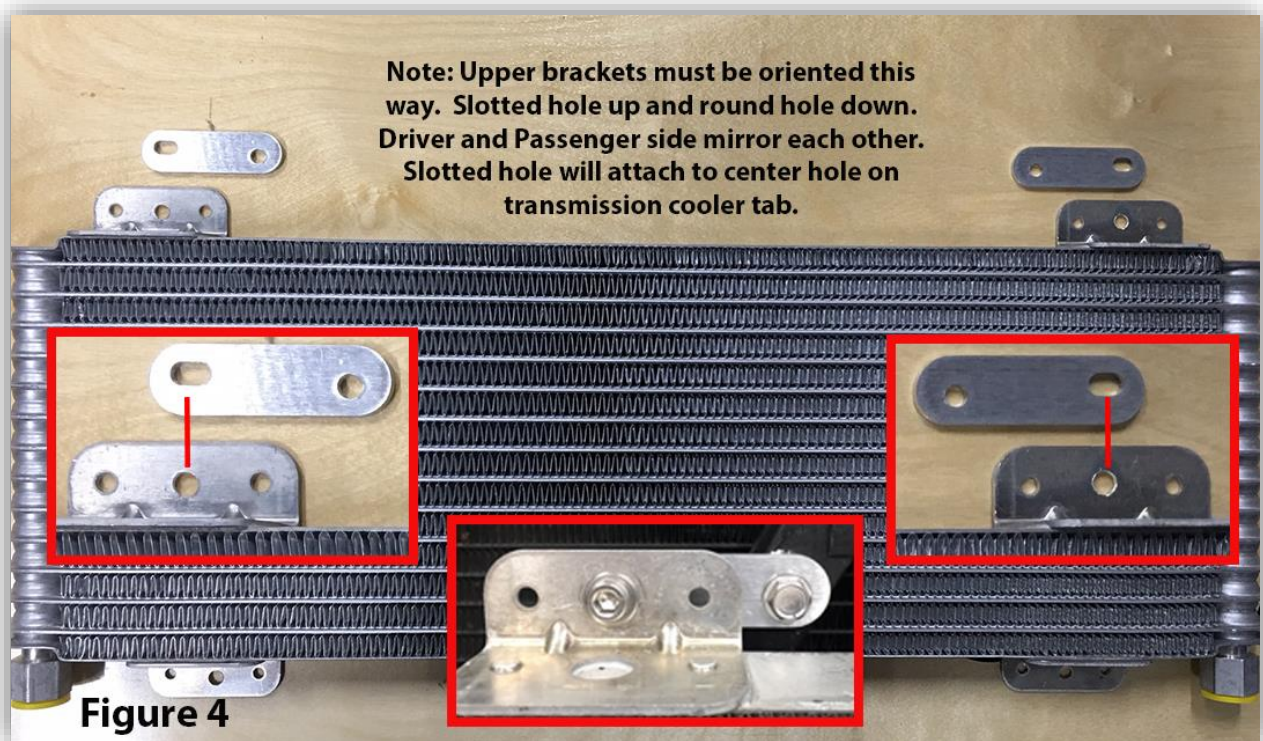

Figure 3

Step 2

Assemble the lower transmission cooler bracket to the Tru-Cool 40K Transmission Cooler according to the hardware orientation above. Keep the hardware loose at this time. Assemble the upper brackets to the Tru-Cool 40K Transmission Cooler in the orientation illustrated in **FIGURE 4** below.

NOTE: The slotted hole is used for attachment to the transmission cooler. Loosely tighten the upper brackets so that they remain parallel to the transmission cooler at this time.



Step 3

Install the transmission cooler and bracket assembly in place using the two original core support bracket mounting screws removed in step 1. Only secure the lower bracket at this time. Center the cooler assembly and snug all lower bracket mounting hardware. Adjust the upper brackets as needed to center the opening of the mounting hole on the on the core support brackets as show in **FIGURE 5** below.

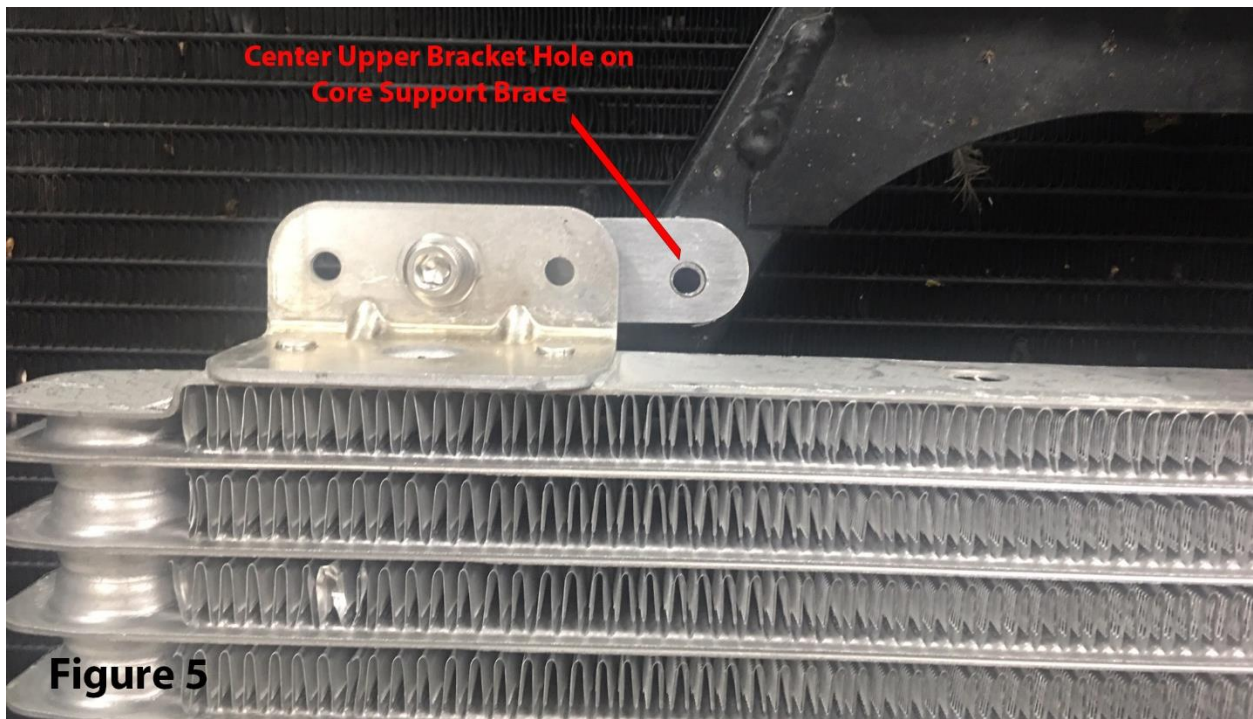

Step 4

Using a drill or impact driver install the self-drilling screws through the open mounting hole on the upper bracket assembly and into the core support bracing. Be cautious not to over-torque the self-drilling hardware to avoid stripping. **SEE FIGURE 6** for installed illustration.

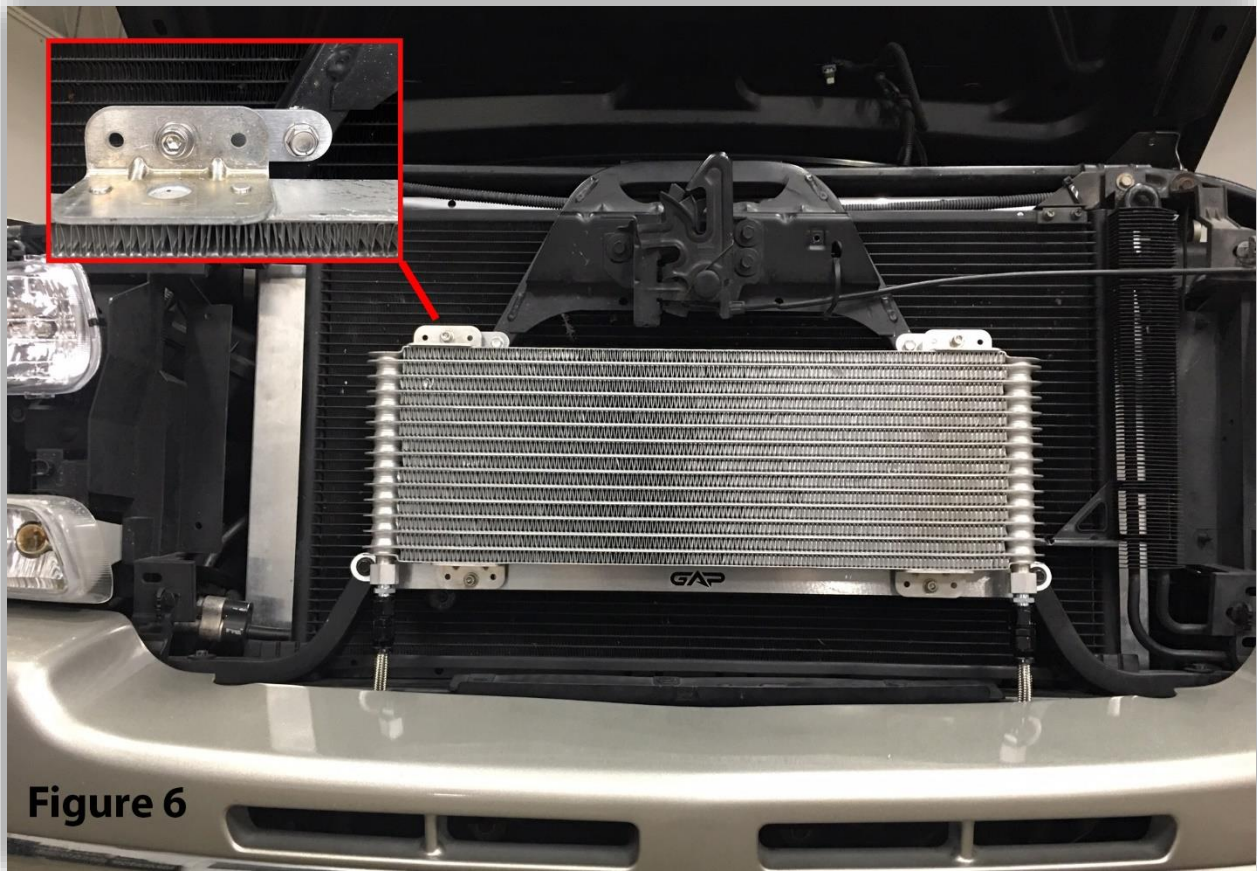
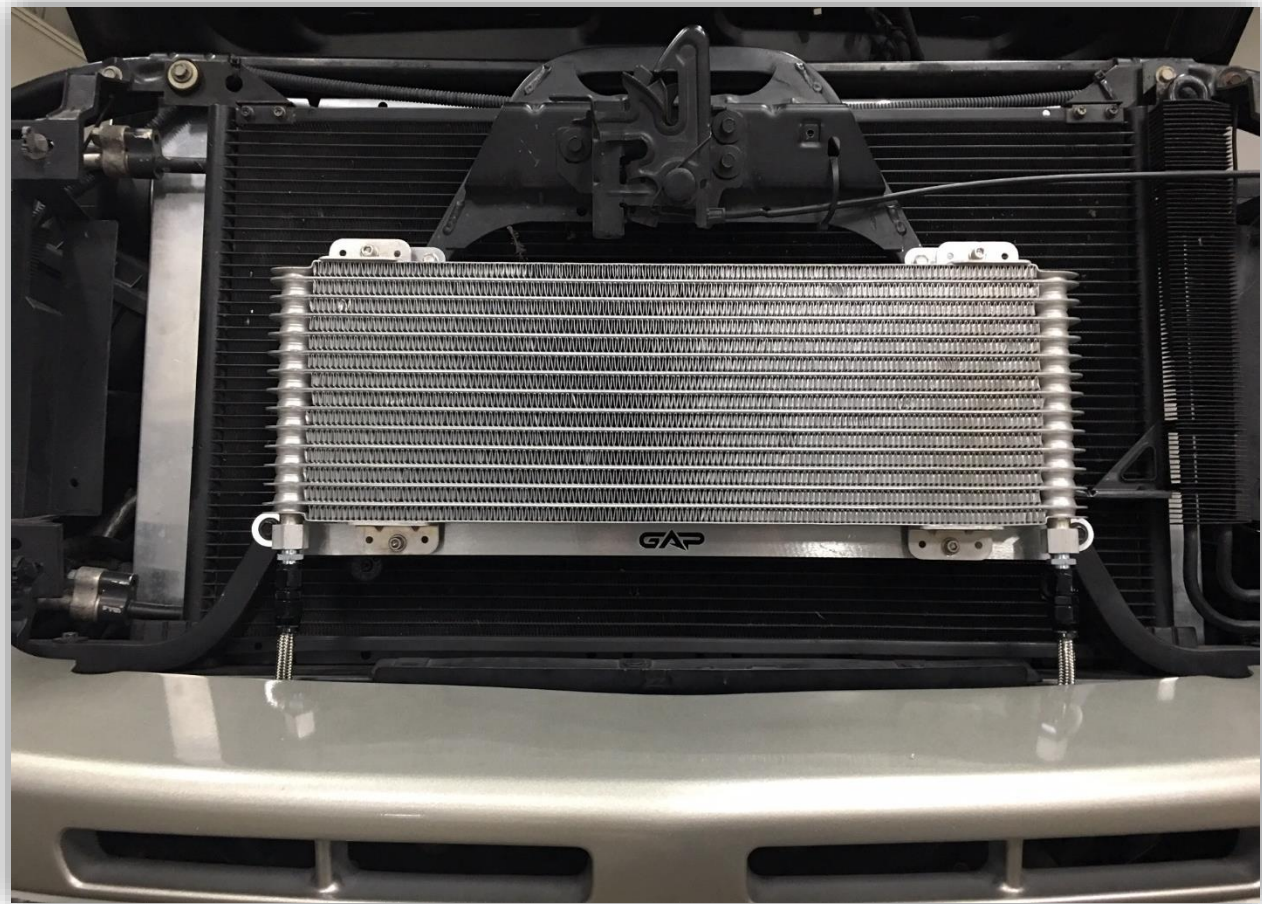

Figure 6

Step 5

Final tighten all mounting hardware to complete installation. You may now plumb the Tru-Cool 40K Transmission Cooler to your existing transmission cooler lines in the way of your choosing. If you're using one of our pre-built transmission cooler PTFE braided stainless -AN line kits, please see their included instructions for installation. Remember, the addition of an aftermarket transmission cooler will change the total fluid capacity. Please be sure the transmission has been bled and filled to proper capacity before driving the vehicle. Over or under filling of the transmission may result in damage to the unit.



GLENN'S AUTO PERFORMANCE IS NOT LIABLE FOR ANY DAMAGE TO BRACKETS OR TO VEHICLES THAT IS CAUSED BY INCORRECT INSTALLATION OR MISUSE.