

MB7006 - Assembly Instructions JLU 4-Link Suspension Bracket and Skid Kit

4-LINK SUSPENSION BRACKET AND SKID PLATE KIT - JLU

WILL ONLY FIT 2018-2020 JLU WITH THE 3.6L ENGINE

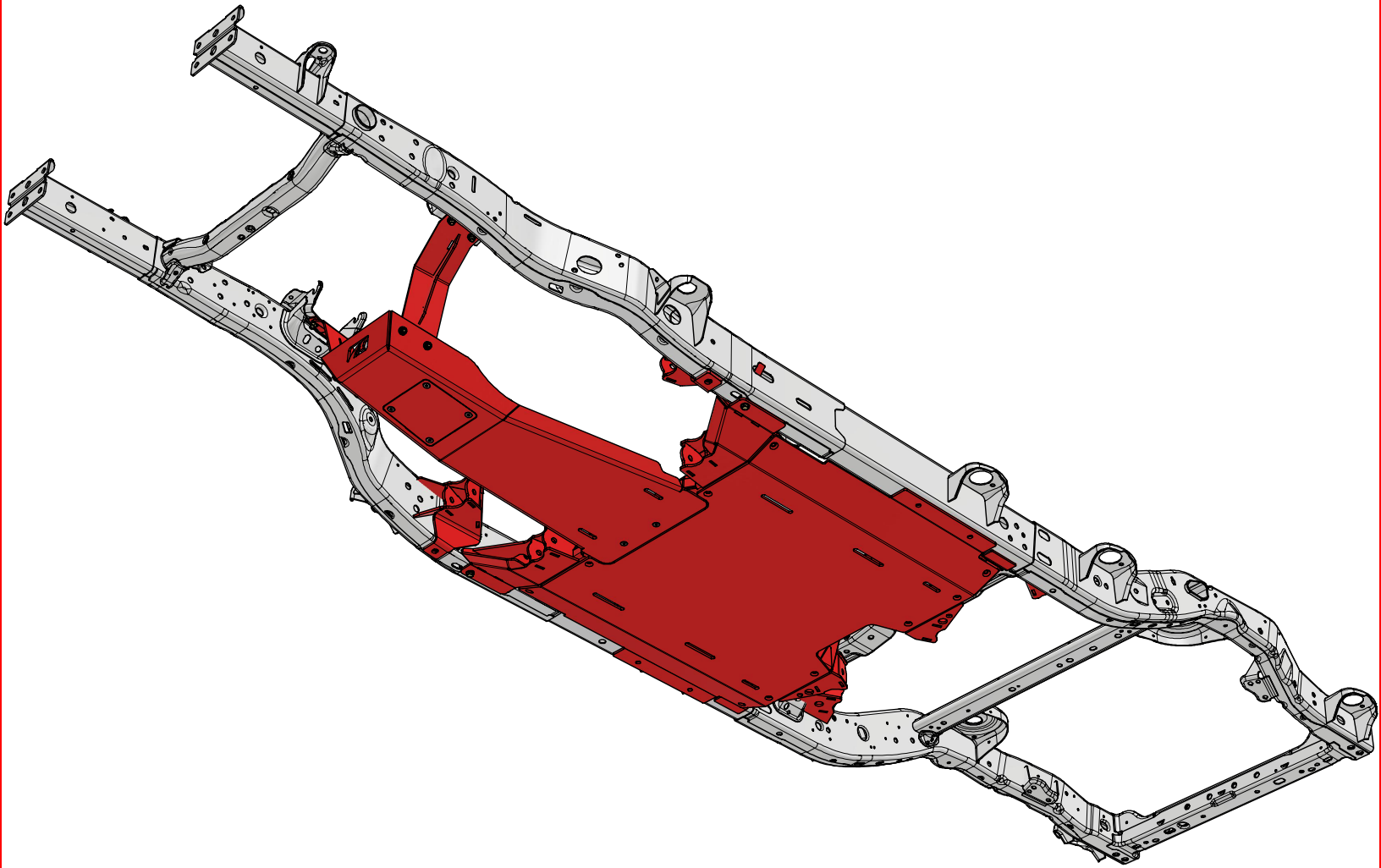

ASSEMBLY INSTRUCTIONS

MB7006 - Assembly Instructions JLU 4-Link Suspension Bracket and Skid Kit

KIT COMPONENTS

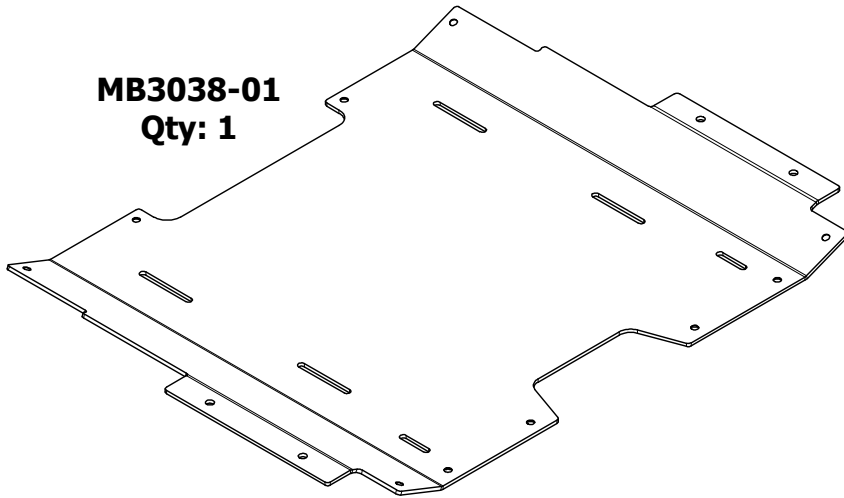

MB3038-01
Qty: 1

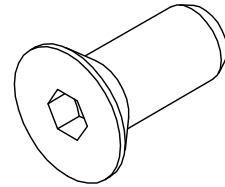

COUNTER SUNK BOLT
7/16"-14 x 1"
Qty: 10

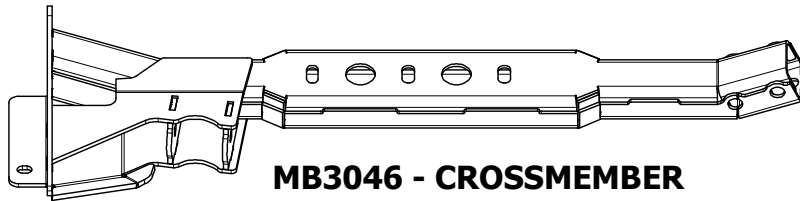

MB3046 - CROSSMEMBER
Qty: 1

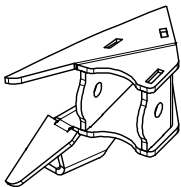

MB3047 - PASSENGER
Qty: 1

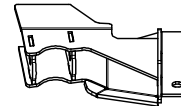

MB3046 - DRIVER LCA
Qty: 1

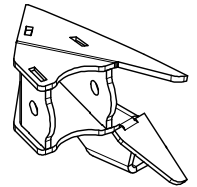

MB3047 - DRIVER
Qty: 1



FLAT WASHER
1/2"
Qty: 6



NYLOCK NUT
1/2"-13 GR 8
Qty: 3

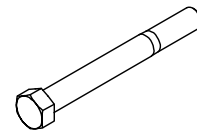

HEX BOLT
1/2"-13 x 4-1/2" GR 8
Qty: 3

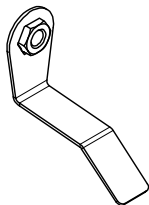

MB3046 FLAGNUT
Qty: 2

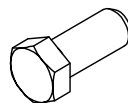

HEX BOLT
7/16"-13 x 1-1/2" GR 8
Qty: 2



FLAT WASHER
7/16"
Qty: 2

MB7006 - Assembly Instructions JLU 4-Link Suspension Bracket and Skid Kit

KIT COMPONENTS

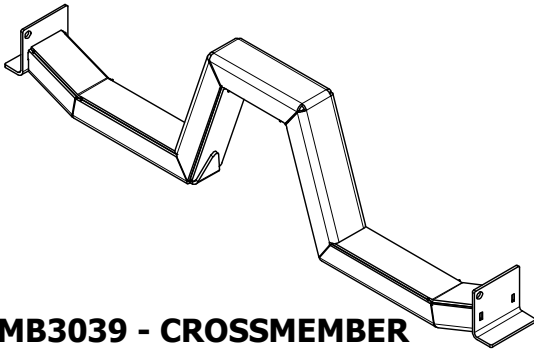

MB3039 - CROSSMEMBER
Qty: 1

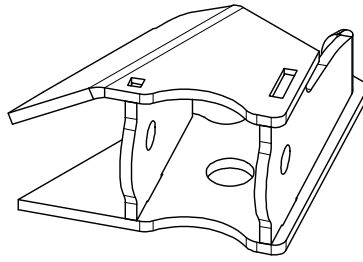

MB3041 - PASSENGER
Qty: 1

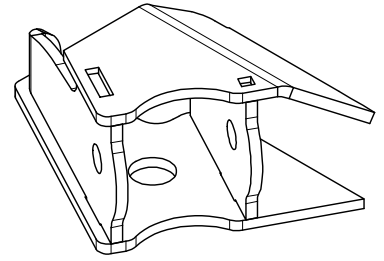

MB3041 - DRIVER
Qty: 1

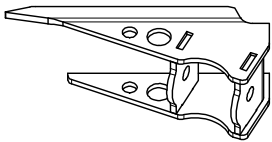

MB3039 - LCA MOUNT DRIVER
Qty: 1

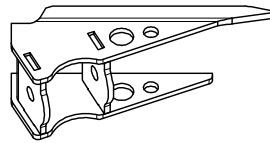

MB3039 - LCA MOUNT PASSENGER
Qty: 1

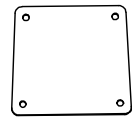

MB1147 - OIL PAN ACCESS PLATE
Qty: 1

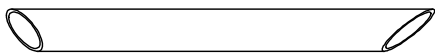

MB3039 - DRIVER BRACE
Qty: 1

MB1147 - SKID PLATE
Qty: 1

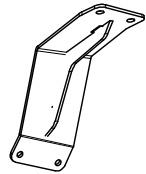
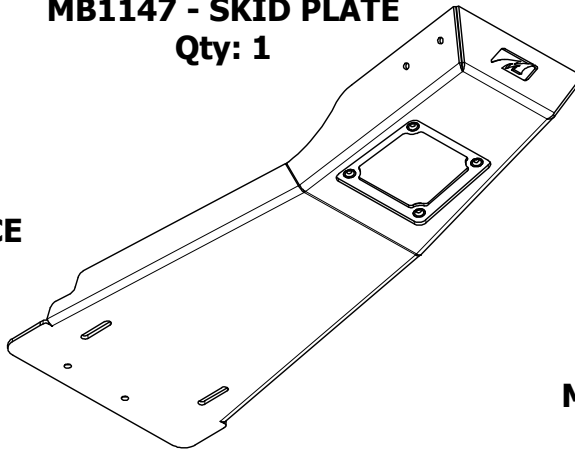

MB1147 - DRIVER MOUNT
Qty: 1

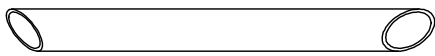

MB3039 - PASSENGER BRACE
Qty: 1

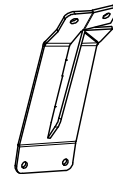

MB1147 - PASSENGER MOUNT
Qty: 1



MB3039-06
Qty: 2

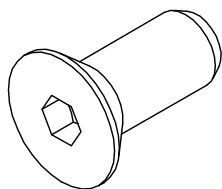

COUNTER SUNK BOLT
7/16"-14 x 1"
Qty: 6

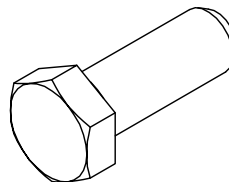

HEX BOLT
3/8"-16 x 1" GR8
Qty: 8

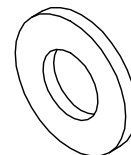

FLAT WASHER
3/8"
Qty: 16

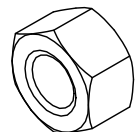

NYLOCK NUT
3/8"-16
Qty: 8

MB7006 - Assembly Instructions JLU 4-Link Suspension Bracket and Skid Kit

FRONT CROSSMEMBER INSTALLATION

SUPPORT THE TRANSMISSION AND TRANSFER CASE. UNBOLT THE FACTORY CROSS MEMBER AND REMOVE FROM THE VEHICLE ALONG WITH ANY OTHER SKID PLATE OR BRACE ATTACHED TO THE CROSSMEMBER. THIS INCLUDES THE GAS TANK AND TRANSFER CASE SKID PLATE. THE HARDWARE USED TO SECURE THE FACTORY CROSSMEMBER TO THE FRAME AND TRANSMISSION WILL BE REUSED. THE HARDWARE FROM THE BRACE IN FRONT OF THE TRANSMISSION CROSS MEMBER AND THE HARDWARE FROM THE TRANSFER CASE SKID PLATE WILL ALSO BE REUSED.

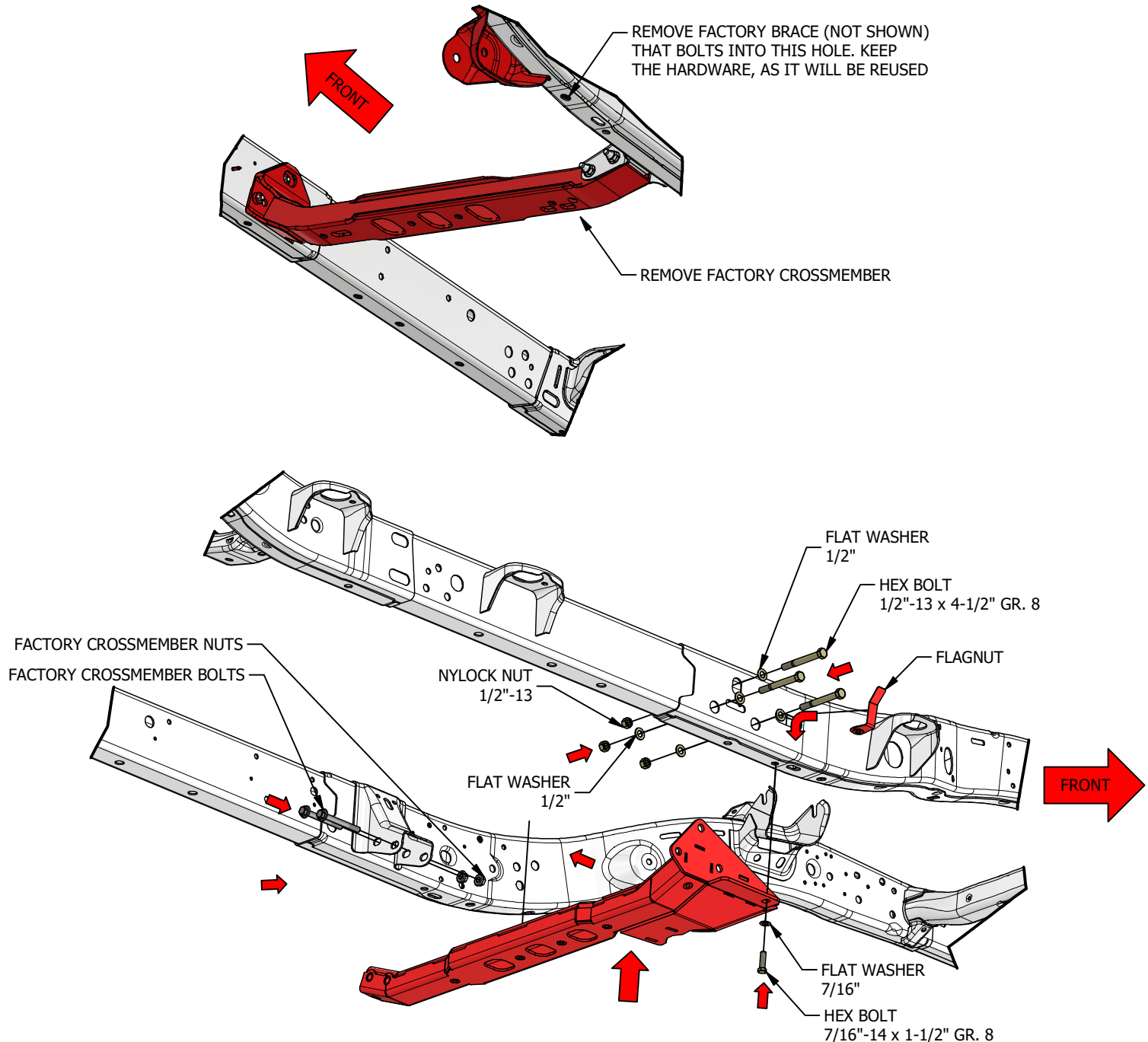

MB7006 - Assembly Instructions JLU 4-Link Suspension Bracket and Skid Kit**FRONT FRAME PREPARATION**

CUT AND REMOVE THE FACTORY FRONT UPPER AND LOWER CONTROL ARM MOUNTS HIGHLIGHTED IN RED. THEN GRIND THE FRAME SMOOTH AND PAINT TO PROTECT THE FRAME FROM CORROSION.

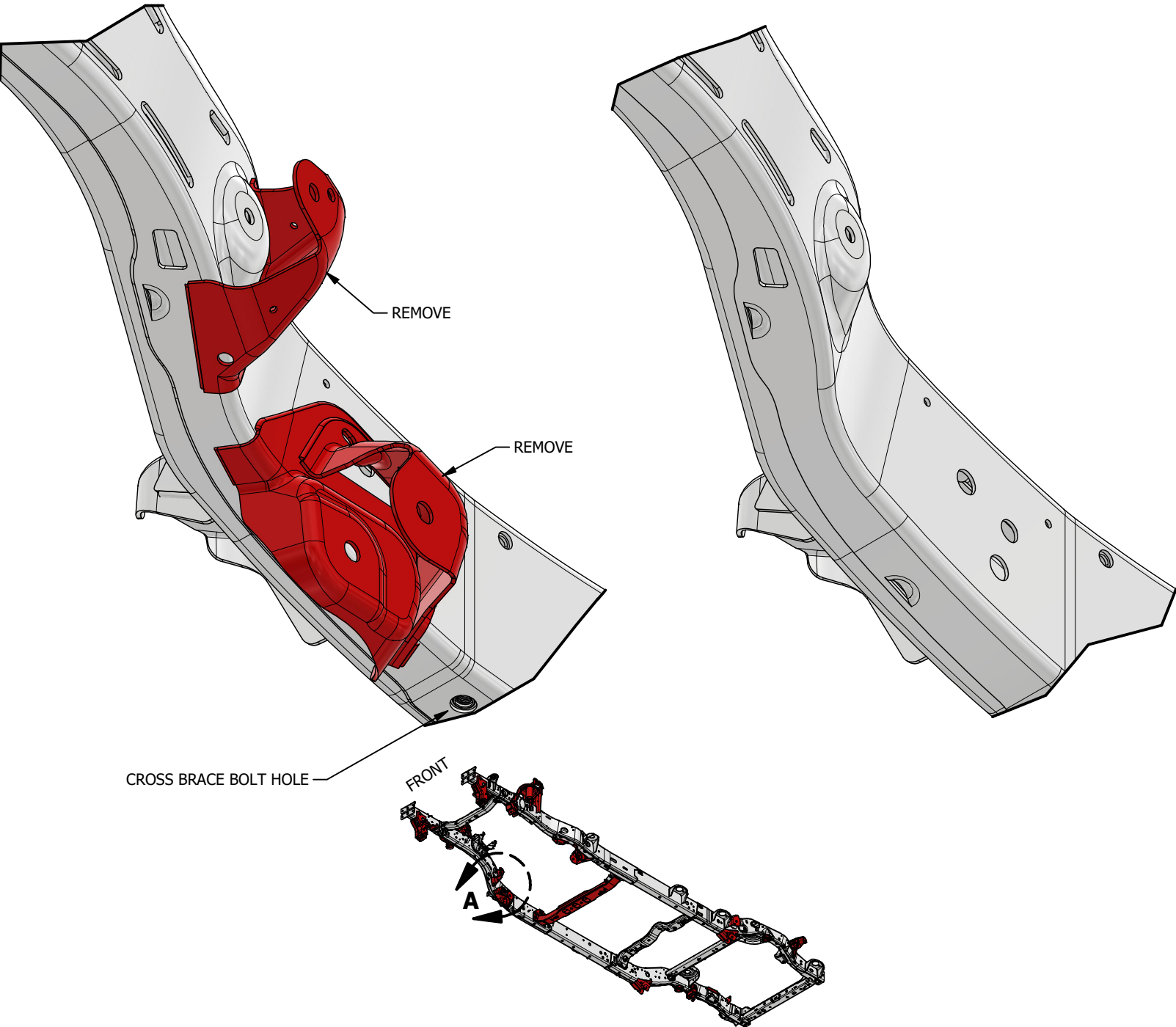
BEFORE**AFTER**

MB7006 - Assembly Instructions JLU 4-Link Suspension Bracket and Skid Kit

DRIVERS SIDE LOWER CONTROL ARM MOUNT

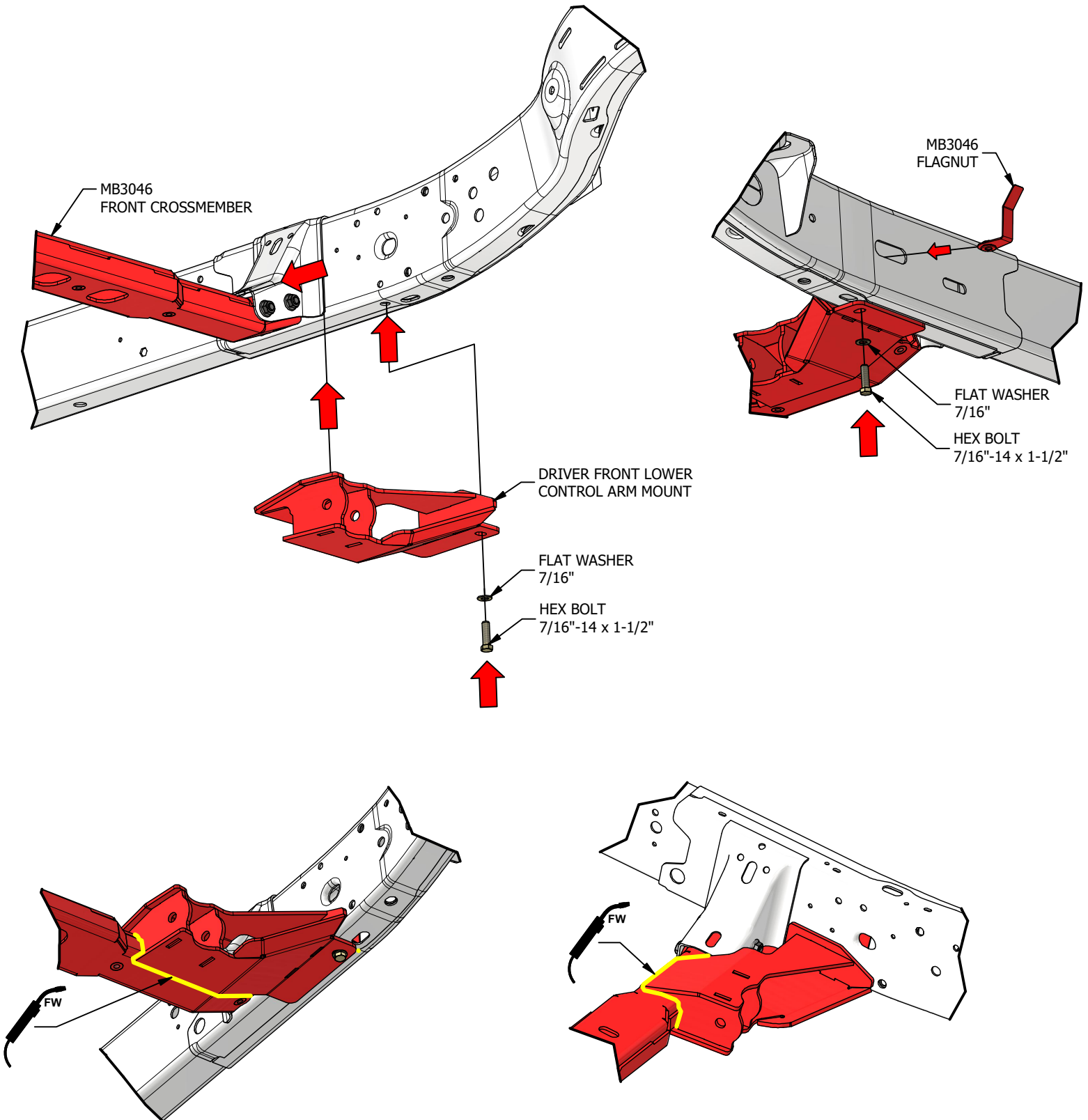

MB7006 - Assembly Instructions JLU 4-Link Suspension Bracket and Skid Kit

FRONT UPPER CONTROL ARM MOUNT INSTALLATION

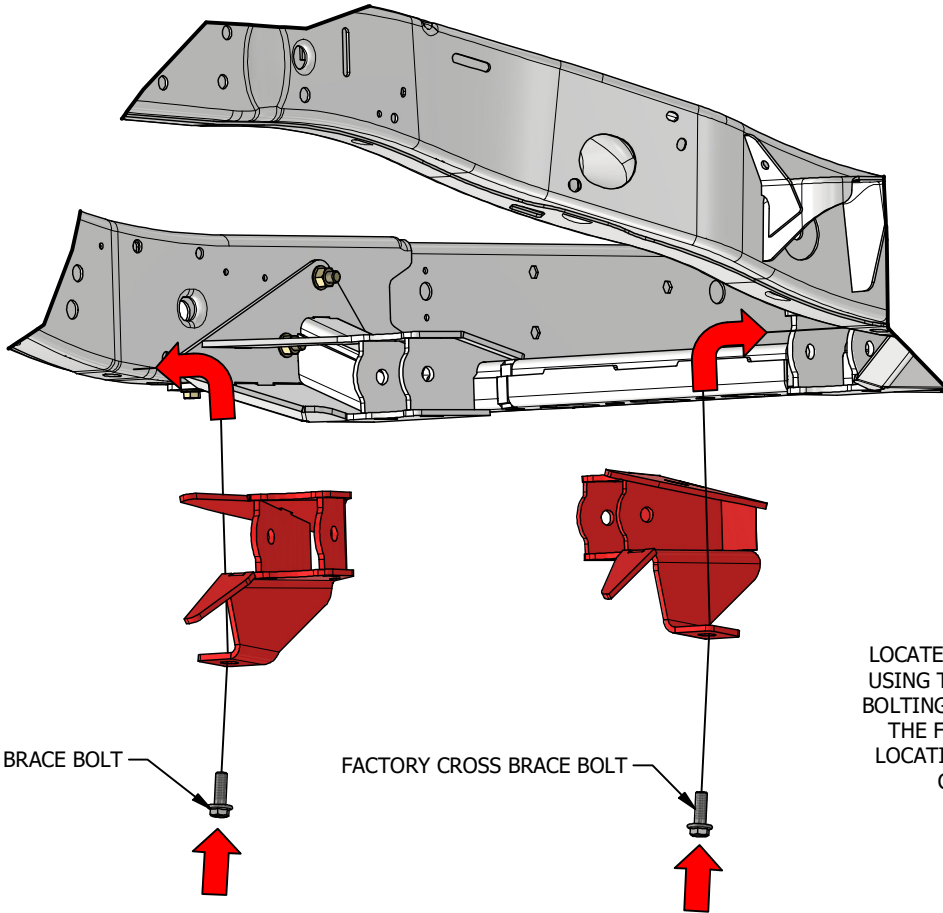

LOCATE THE UPPER CONTROL ARM MOUNTS BY USING THE FACTORY CROSS BRACE BOLTS AND BOLTING THE UPPER CONTROL ARM MOUNTS TO THE FRAME IN THE FACTORY CROSS BRACE LOCATION. ONCE SECURED, WELD THE UPPER CONTROL ARM MOUNT IN PLACE.

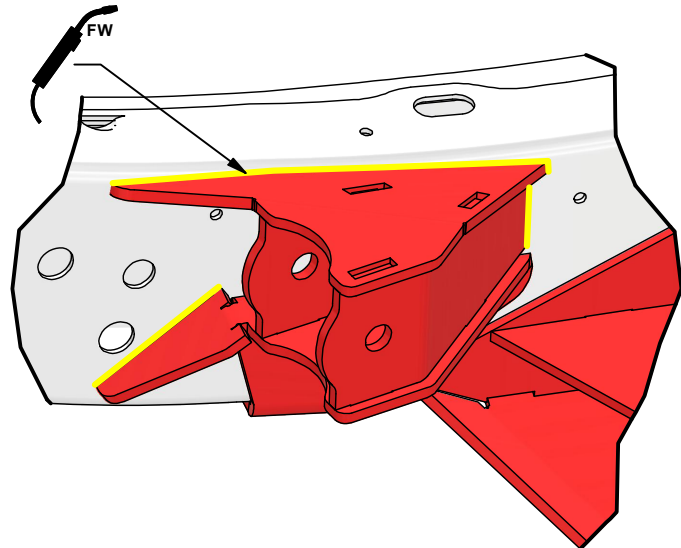
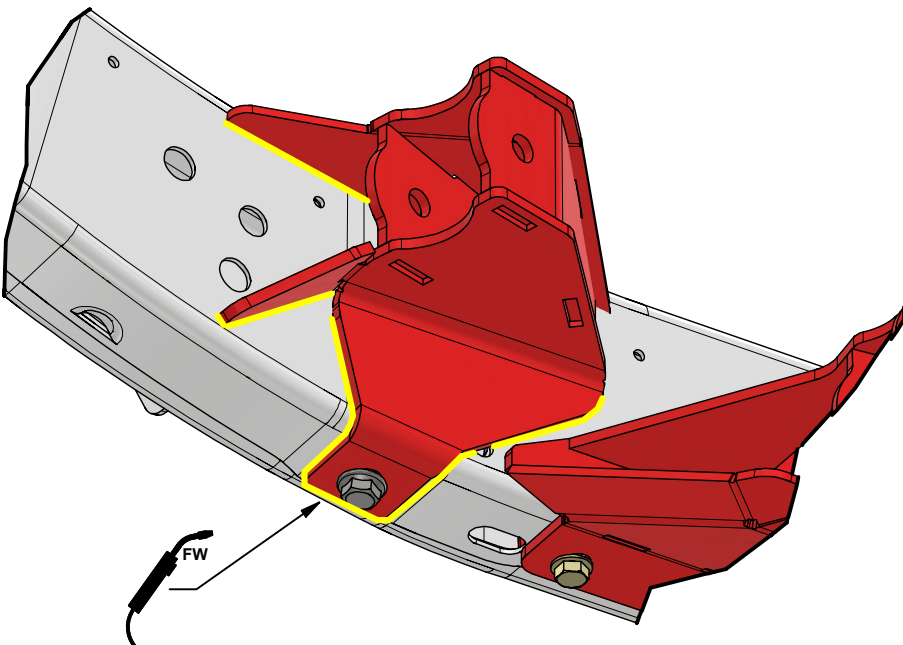

MB7006 - Assembly Instructions JLU 4-Link Suspension Bracket and Skid Kit

REAR FRAME PREPARATION

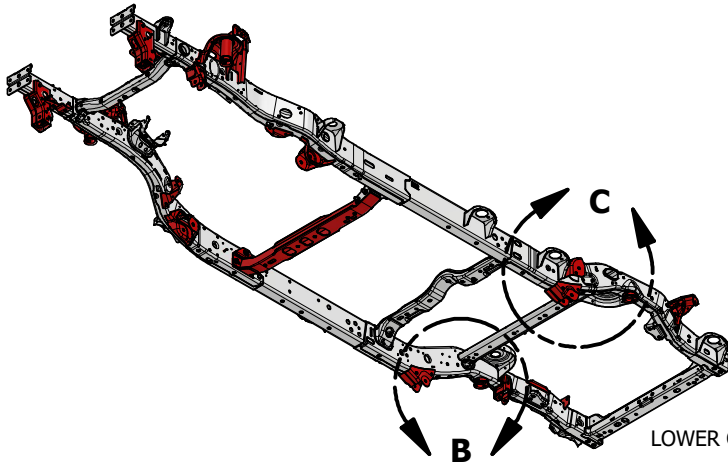

DETAIL C

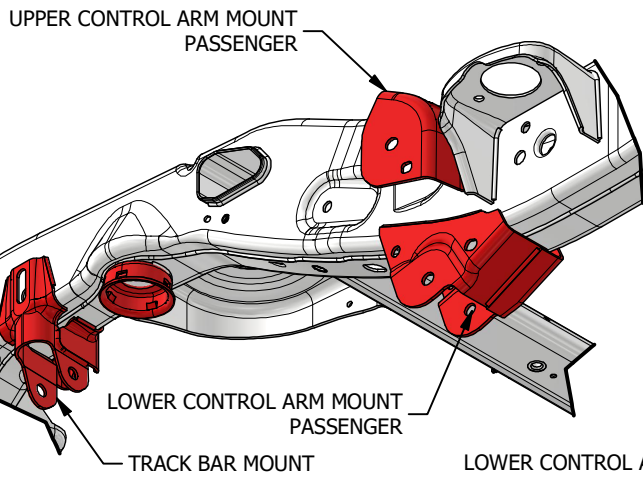
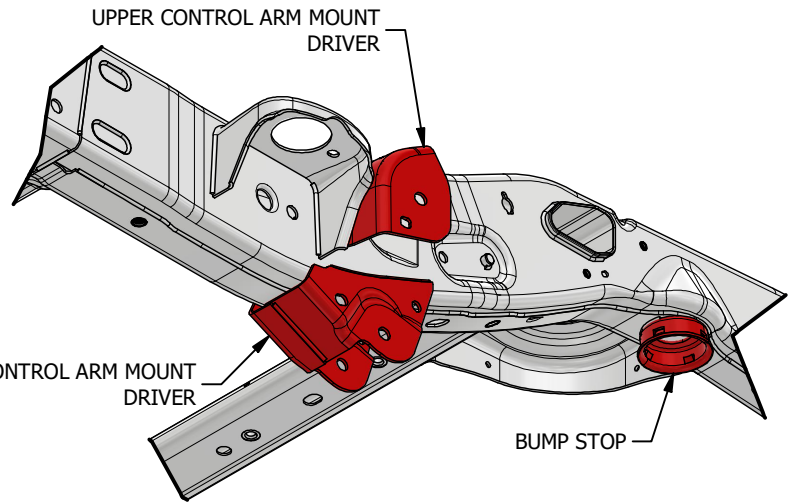

DETAIL B

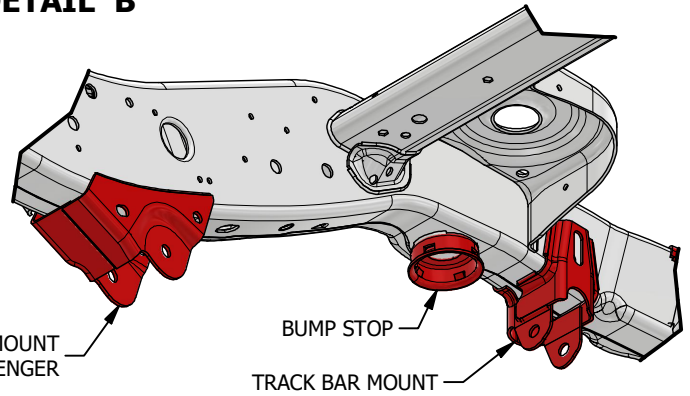

AFTER

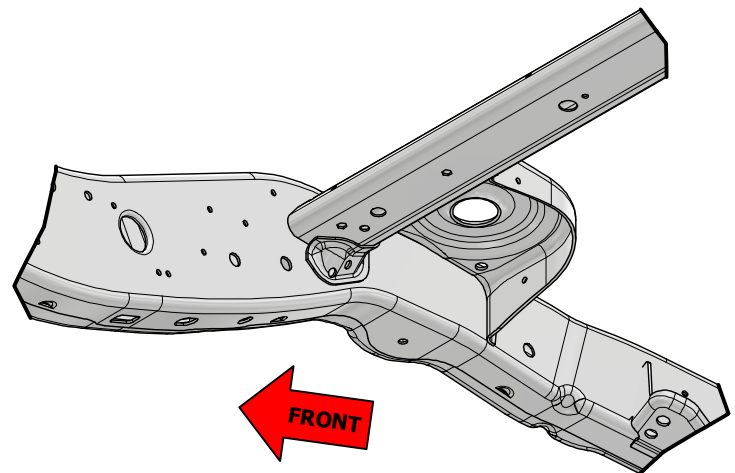
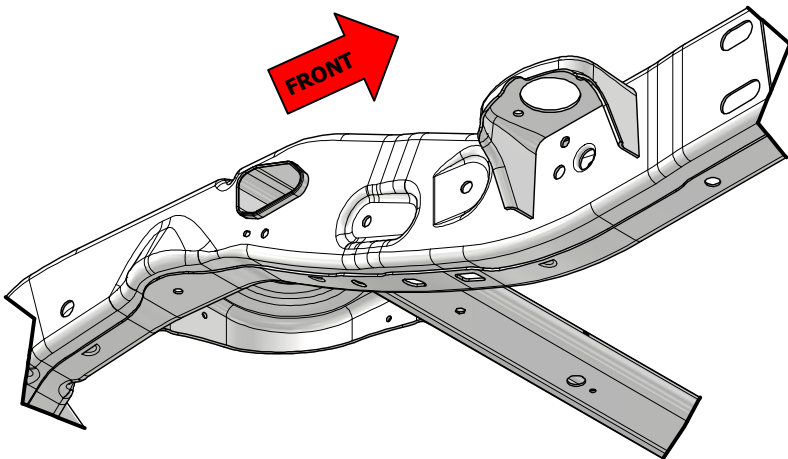

MB7006 - Assembly Instructions JLU 4-Link Suspension Bracket and Skid Kit**BELLY SKID PLATE**

REUSE THE HARDWARE FROM THE TRANSFER CASE SKID PLATE TO BOLT THE MOTOBILT BELLY SKID TO THE FRAME. ALIGN AND BOLT THE SKID PLATE TO THE MOTOBILT CROSSMEMBER USING 7/16" COUNTER SUNK BOLTS

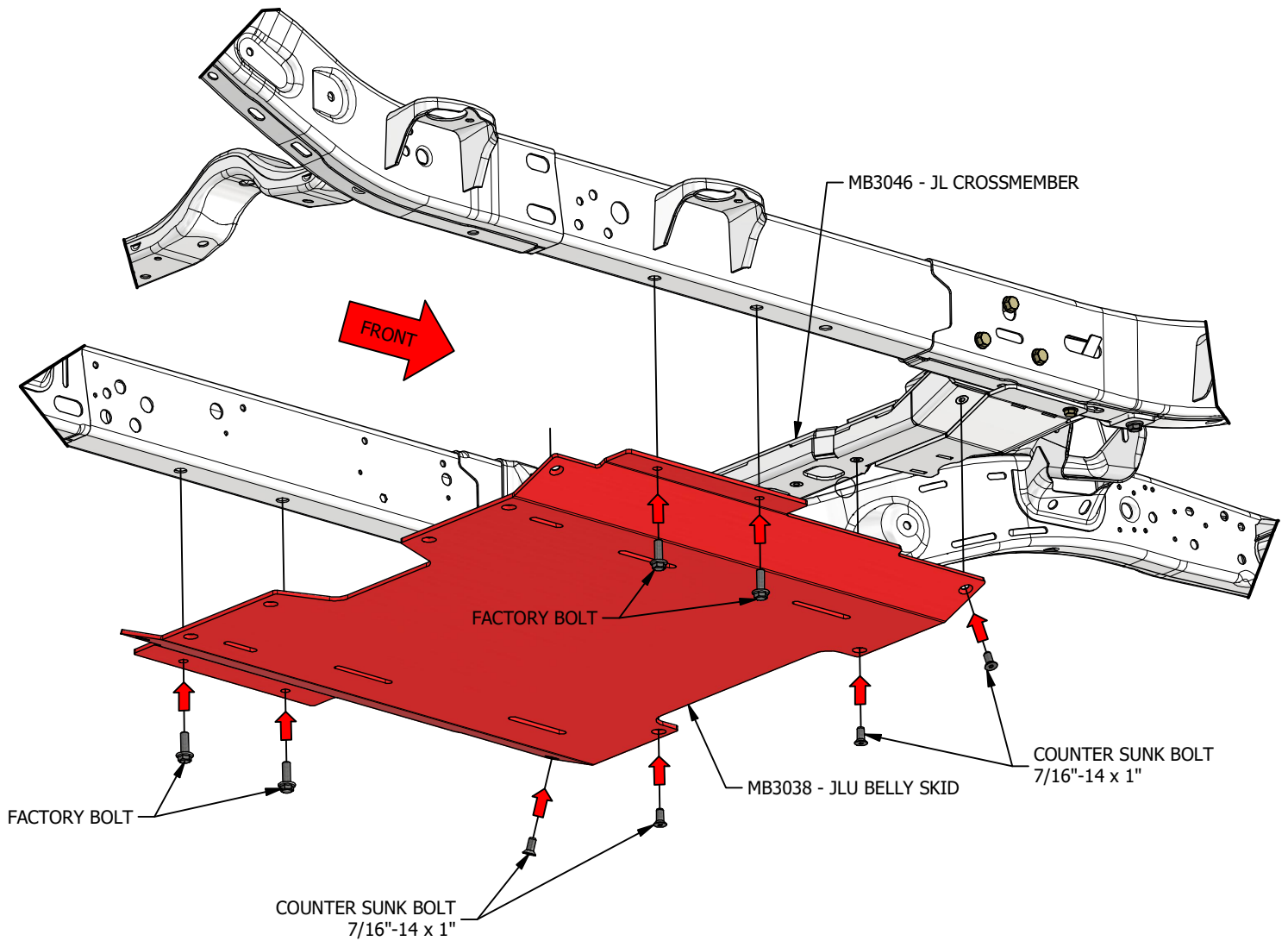

MB7006 - Assembly Instructions JLU 4-Link Suspension Bracket and Skid Kit

REAR CROSS MEMBER

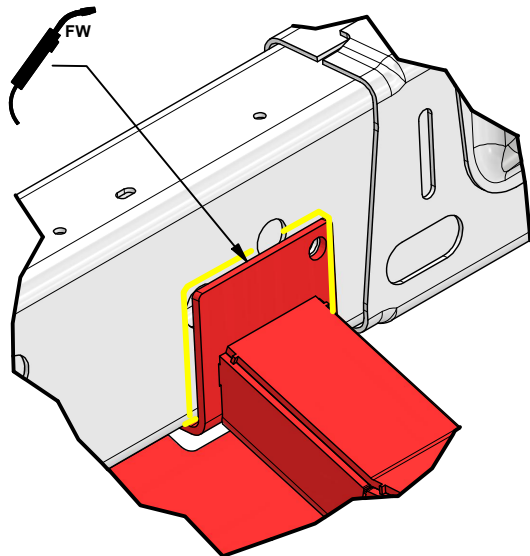
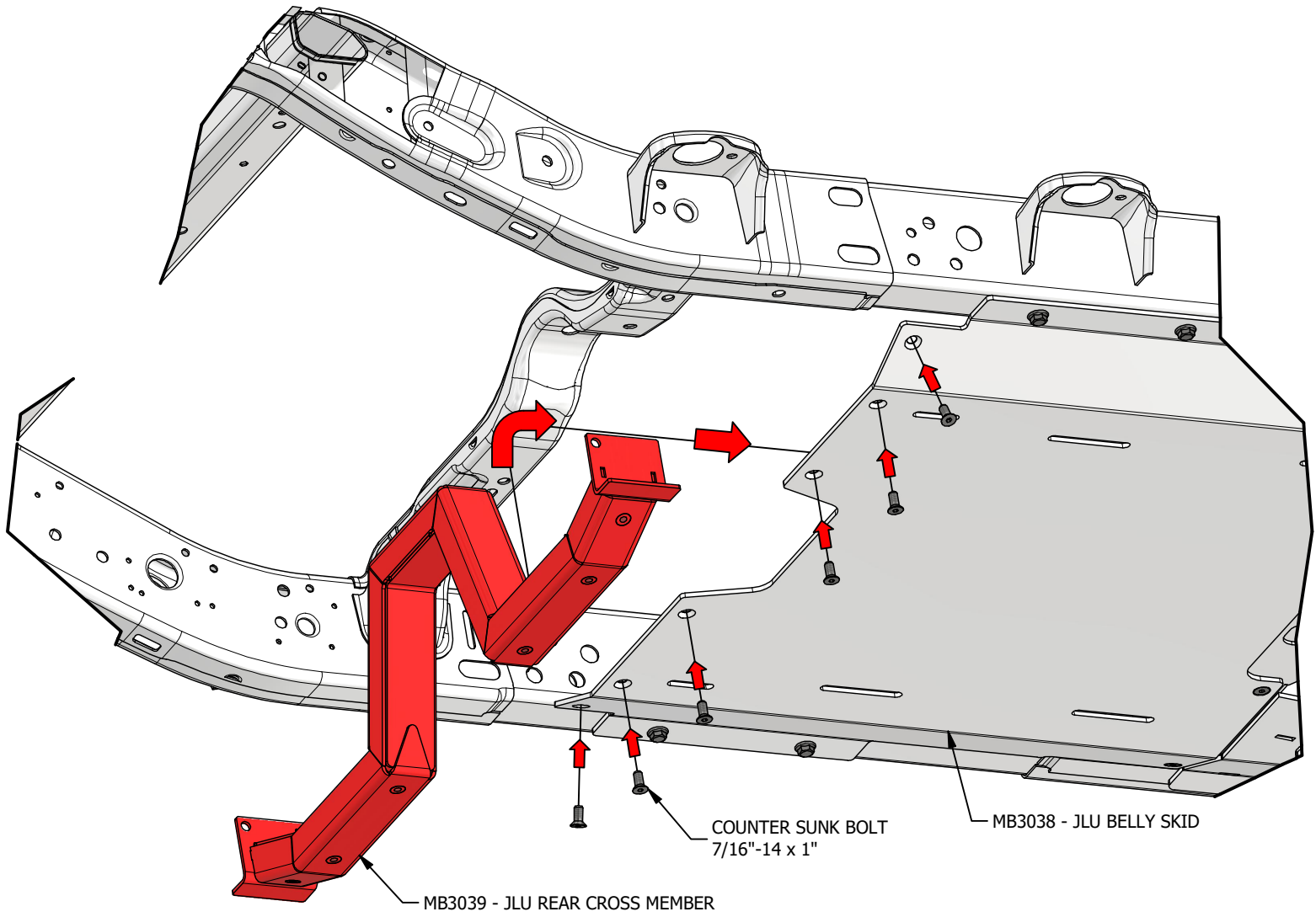

MB7006 - Assembly Instructions JLU 4-Link Suspension Bracket and Skid Kit

REAR LOWER CONTROL ARM MOUNTS

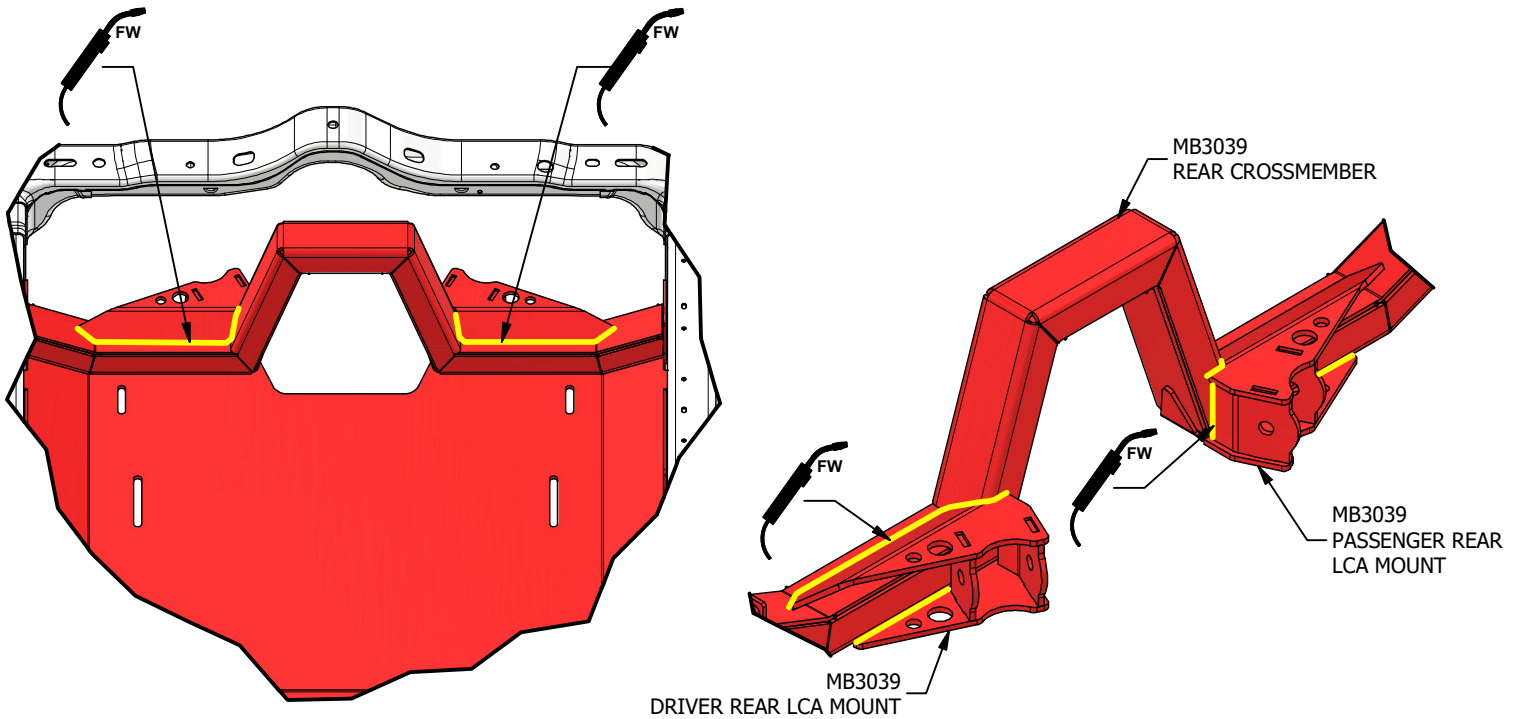
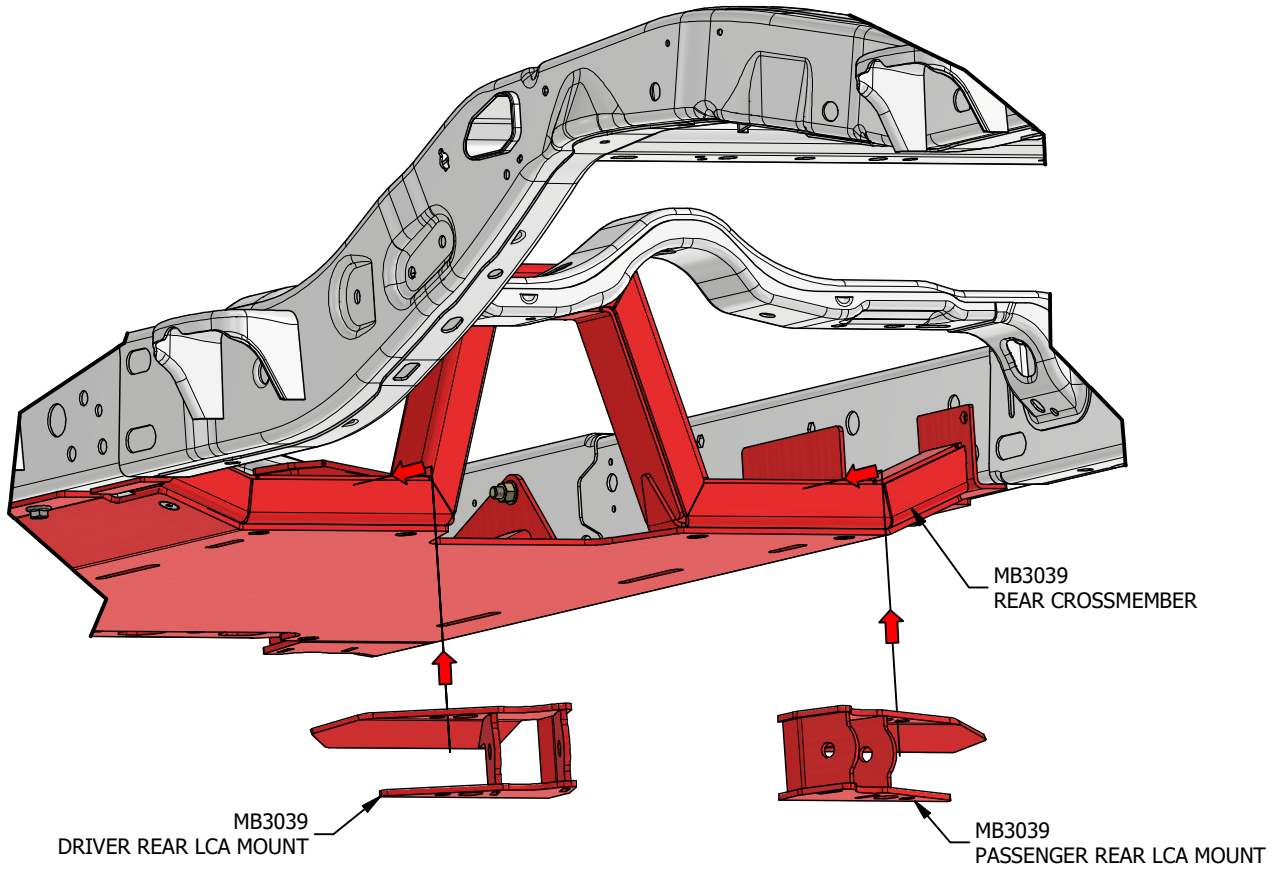

MB7006 - Assembly Instructions JLU 4-Link Suspension Bracket and Skid Kit

REAR CROSS MEMBER

REMOVE THE MB3038 JLU BELLY SKID FOR ACCESS

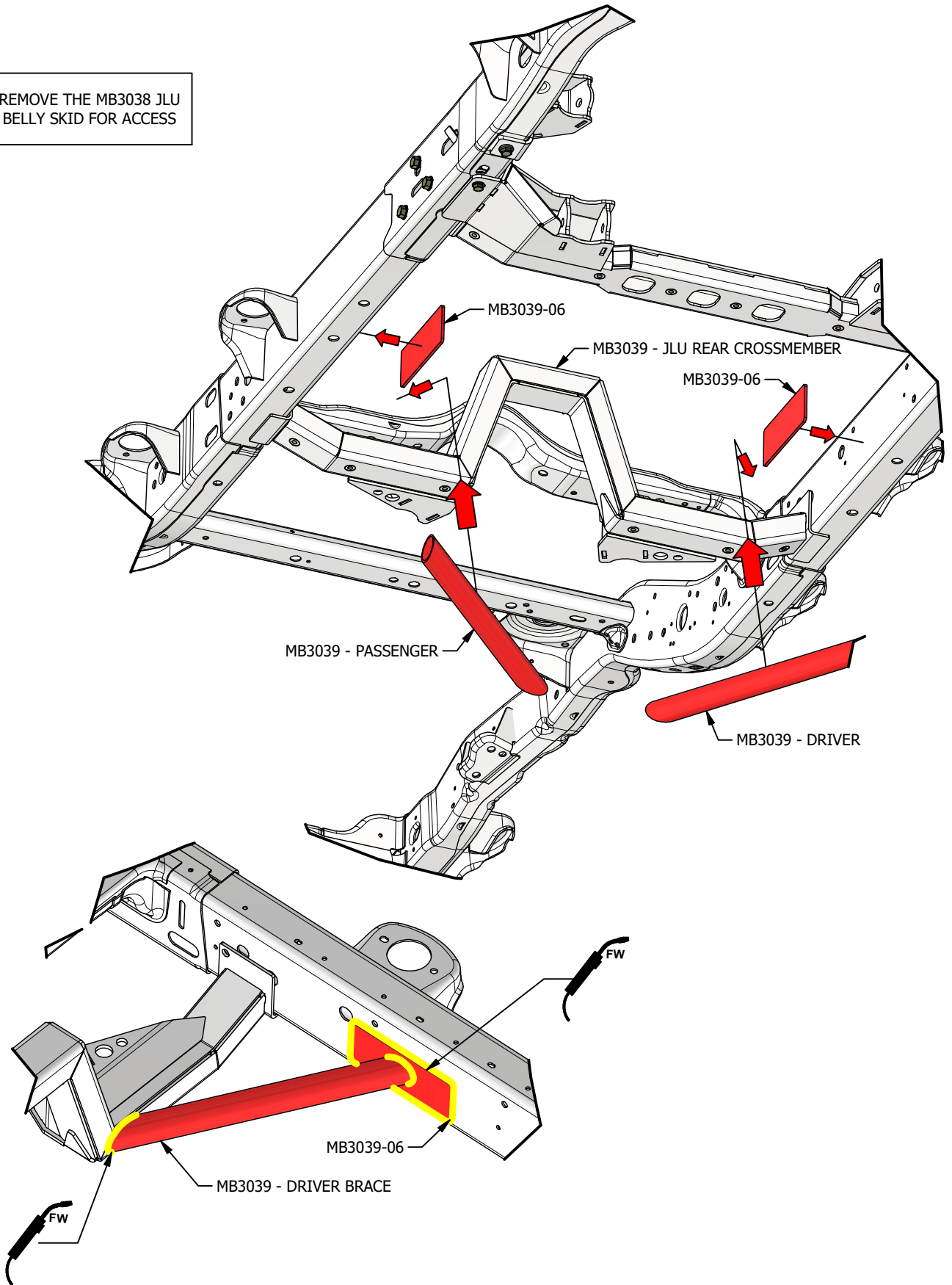

MB7006 - Assembly Instructions JLU 4-Link Suspension Bracket and Skid Kit

REAR UPPER CONTROLS ARM INSTALLATION

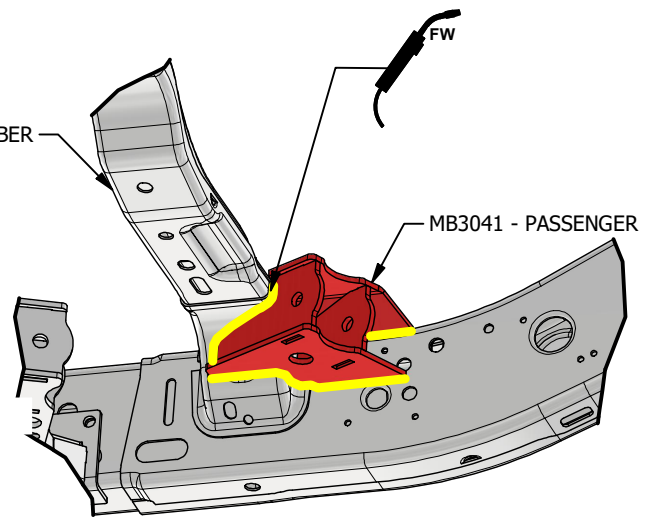
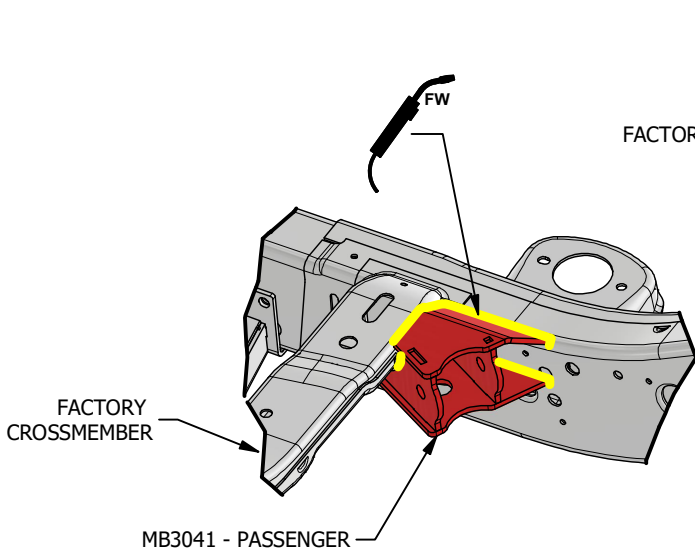
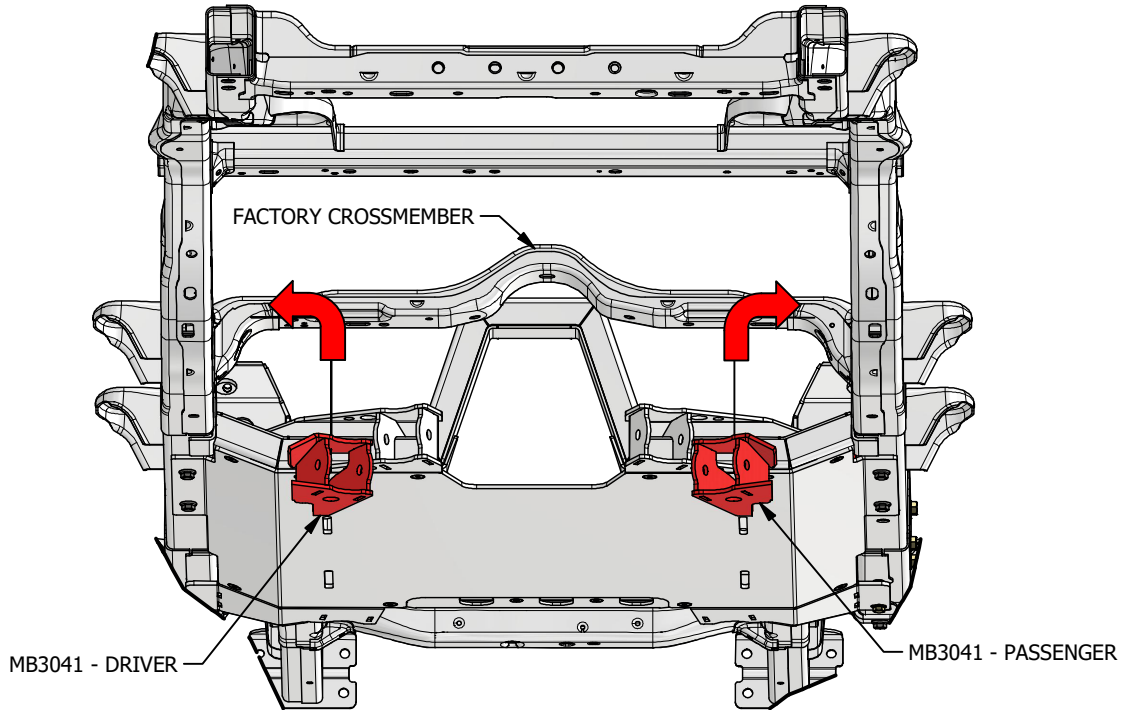

MB7006 - Assembly Instructions JLU 4-Link Suspension Bracket and Skid Kit

ENGINE SKID

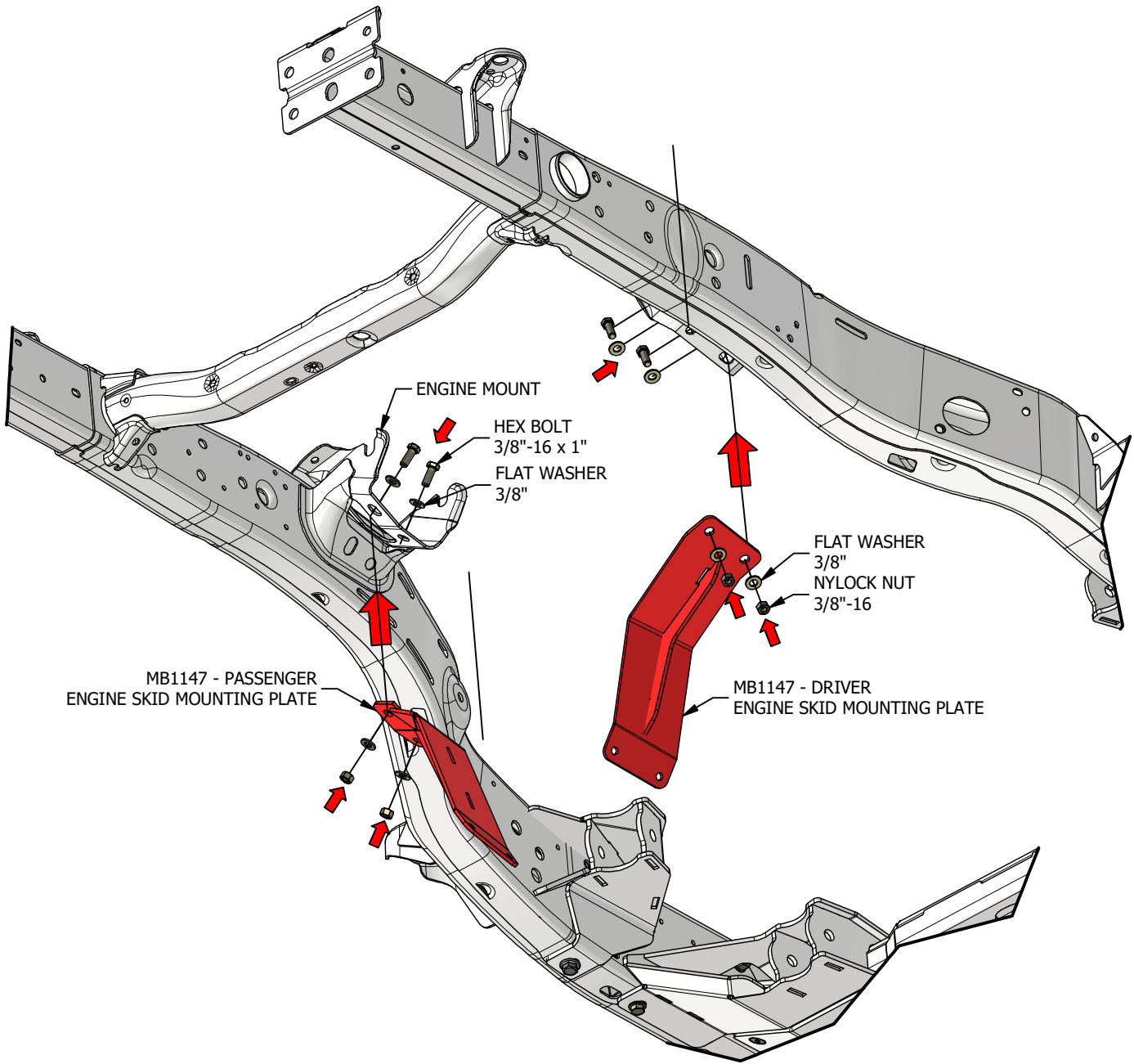

MB7006 - Assembly Instructions JLU 4-Link Suspension Bracket and Skid Kit

ENGINE SKID

