

MB5061 UNIVERSAL BED MOUNTED TIRE CARRIER

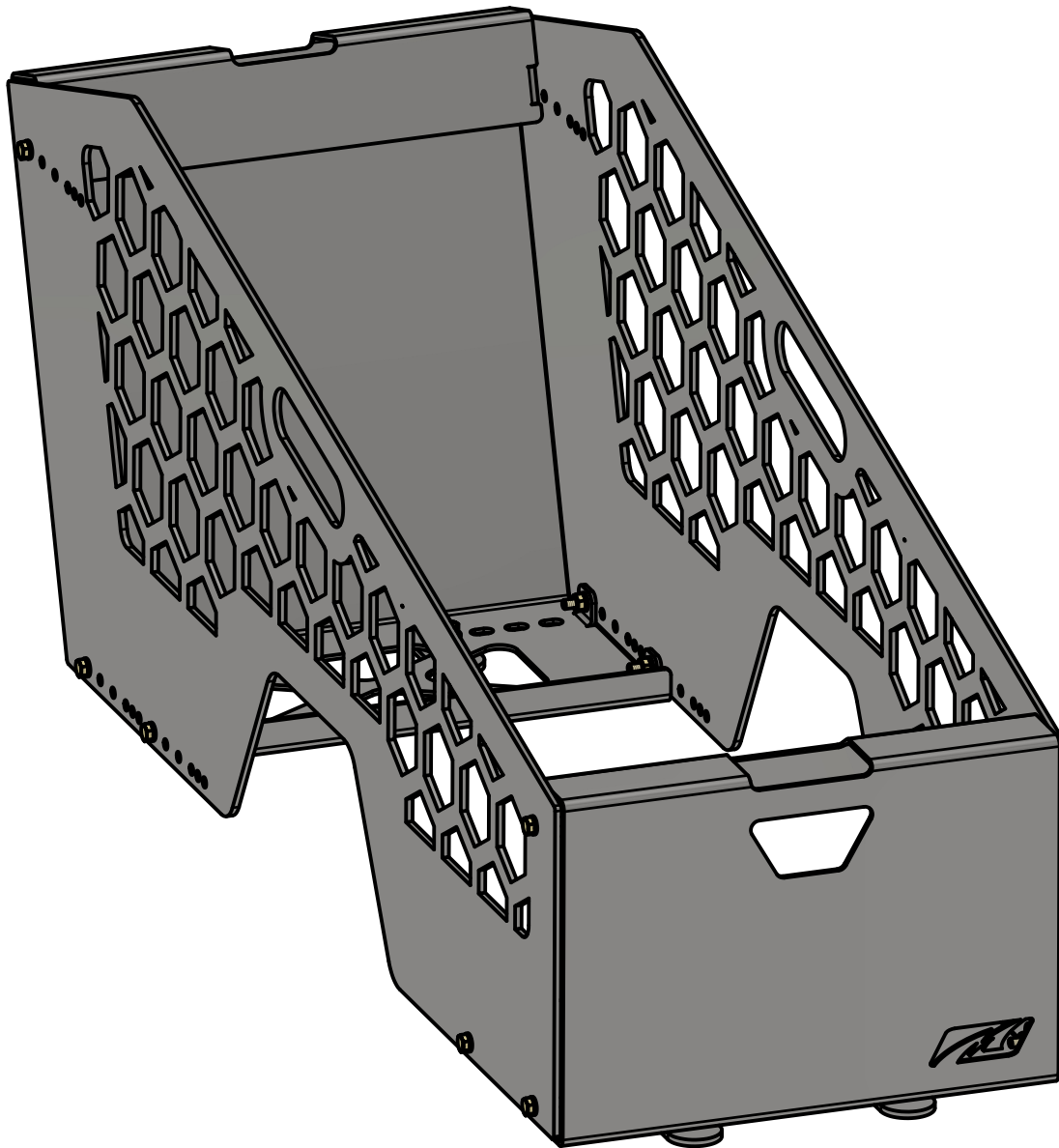

ASSEMBLY INSTRUCTIONS

MB5061 - Assembly Instructions Universal Bed Mounted Tire Carrier

CONTENTS

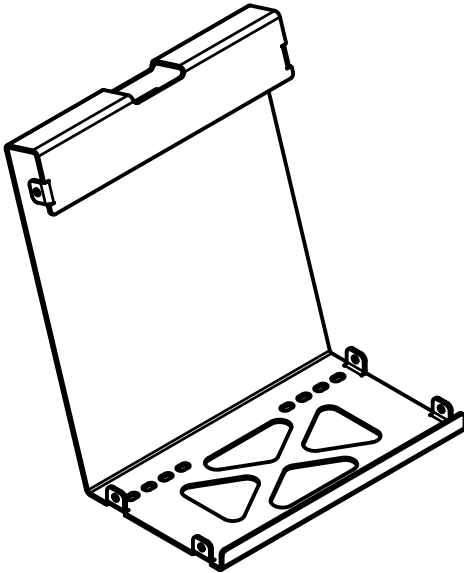

MB5061-01
Qty 1

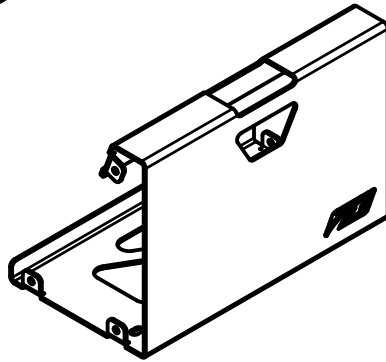

MB5061-02
Qty 1

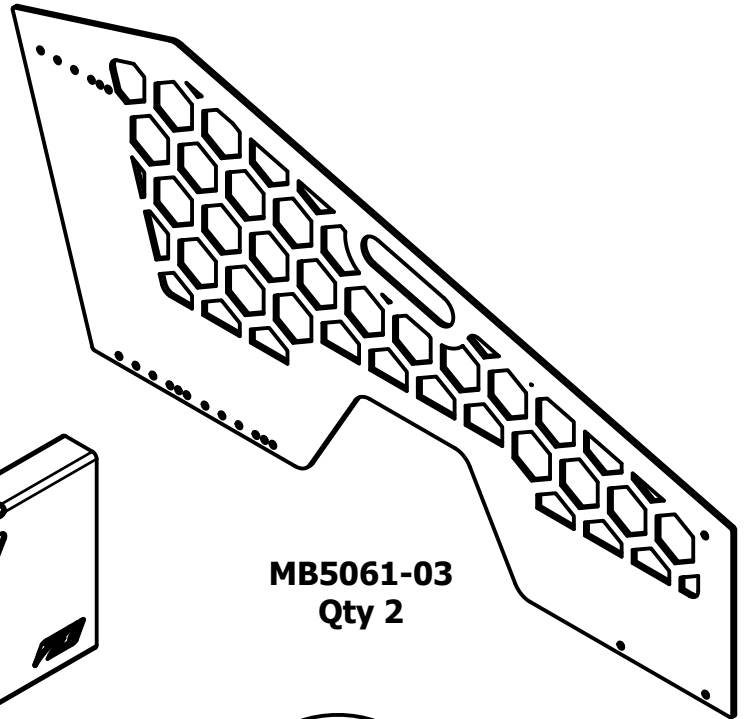

MB5061-03
Qty 2

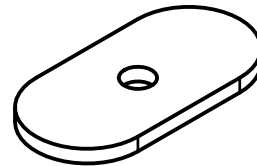

MB5061-04
Qty 4

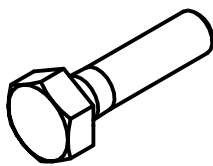

1/4\"-20 x 1\" HEX BOLT
Qty 12



1/4\" FLAT WASHER
Qty 24



1/4\"-20 NYLOCK HEX NUT
Qty 12

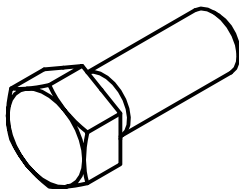

3/8\"-16 x 1\" HEX BOLT
Qty 4



3/8\" FLAT WASHER
Qty 8

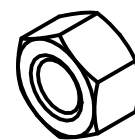

3/8\"-16 NYLOCK HEX NUT
Qty 4

MB5061 - Assembly Instructions Universal Bed Mounted Tire Carrier

ASSEMBLY

1/4" FLAT WASHER
1/4"-20 x 1" HEX BOLT

1/4" FLAT WASHER
1/4"-20 NYLOCK HEX NUT

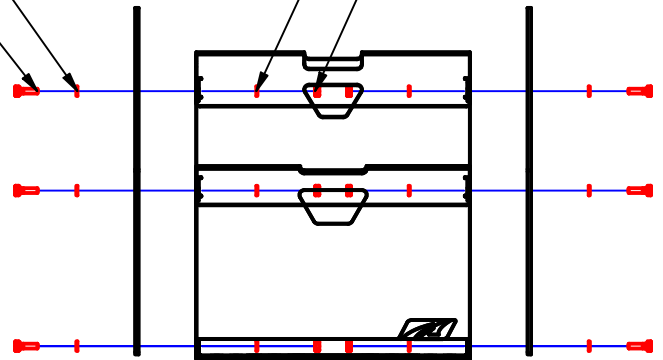

FRONT

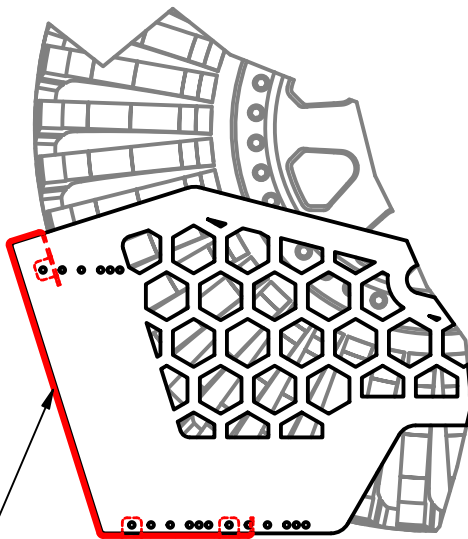

USE THE MOUNTING HOLES TO ADJUST
MB5061-01 TO YOUR TIRE SIZE.
* TIRE SHOULD BE FREE TO MOVE.

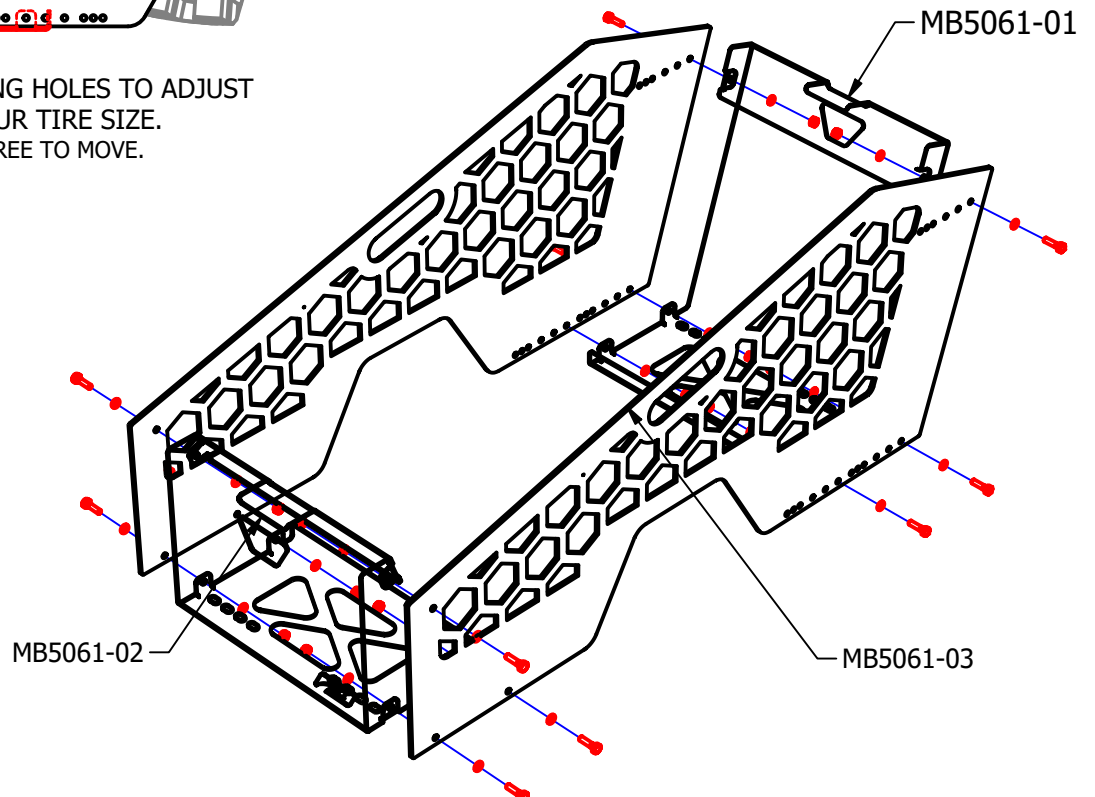

MB5061 - Assembly Instructions Universal Bed Mounted Tire Carrier

ASSEMBLY OPTIONAL DUAL TIRE

1/4" FLAT WASHER
1/4"-20 x 1" HEX BOLT

1/4" FLAT WASHER
1/4"-20 NYLOCK HEX NUT

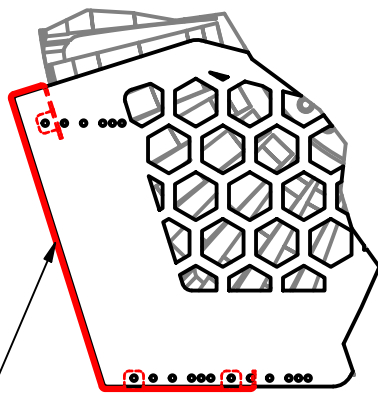

USE THE MOUNTING HOLES TO ADJUST
MB5061-01 FORWARD TO YOUR TIRE SIZE.
* TIRE SHOULD BE FREE TO MOVE.

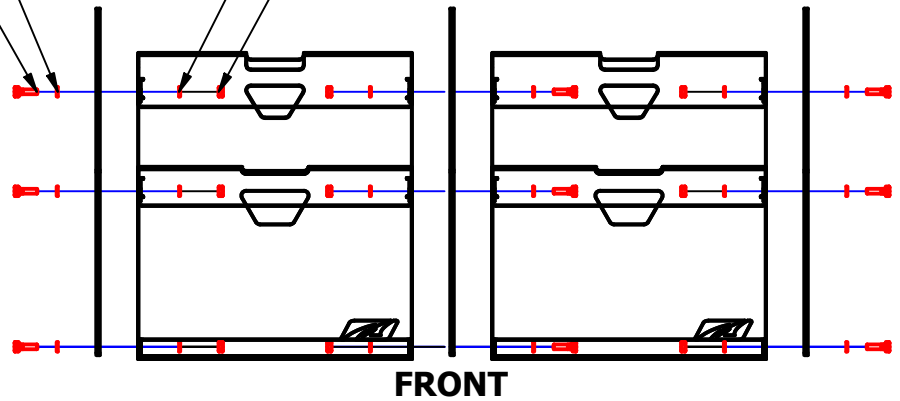

FRONT

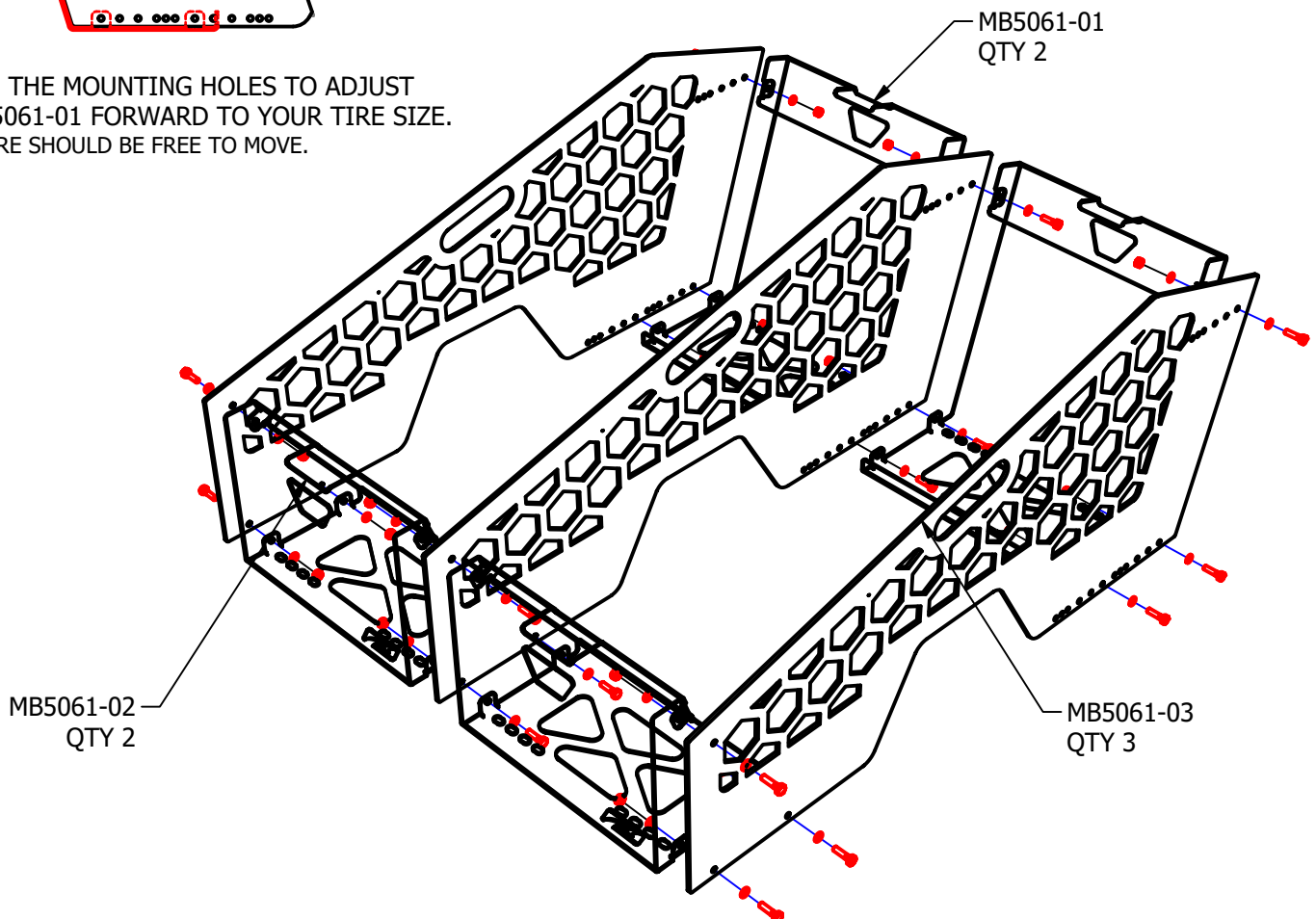

MB5061 - Assembly Instructions Universal Bed Mounted Tire Carrier

MOUNTING

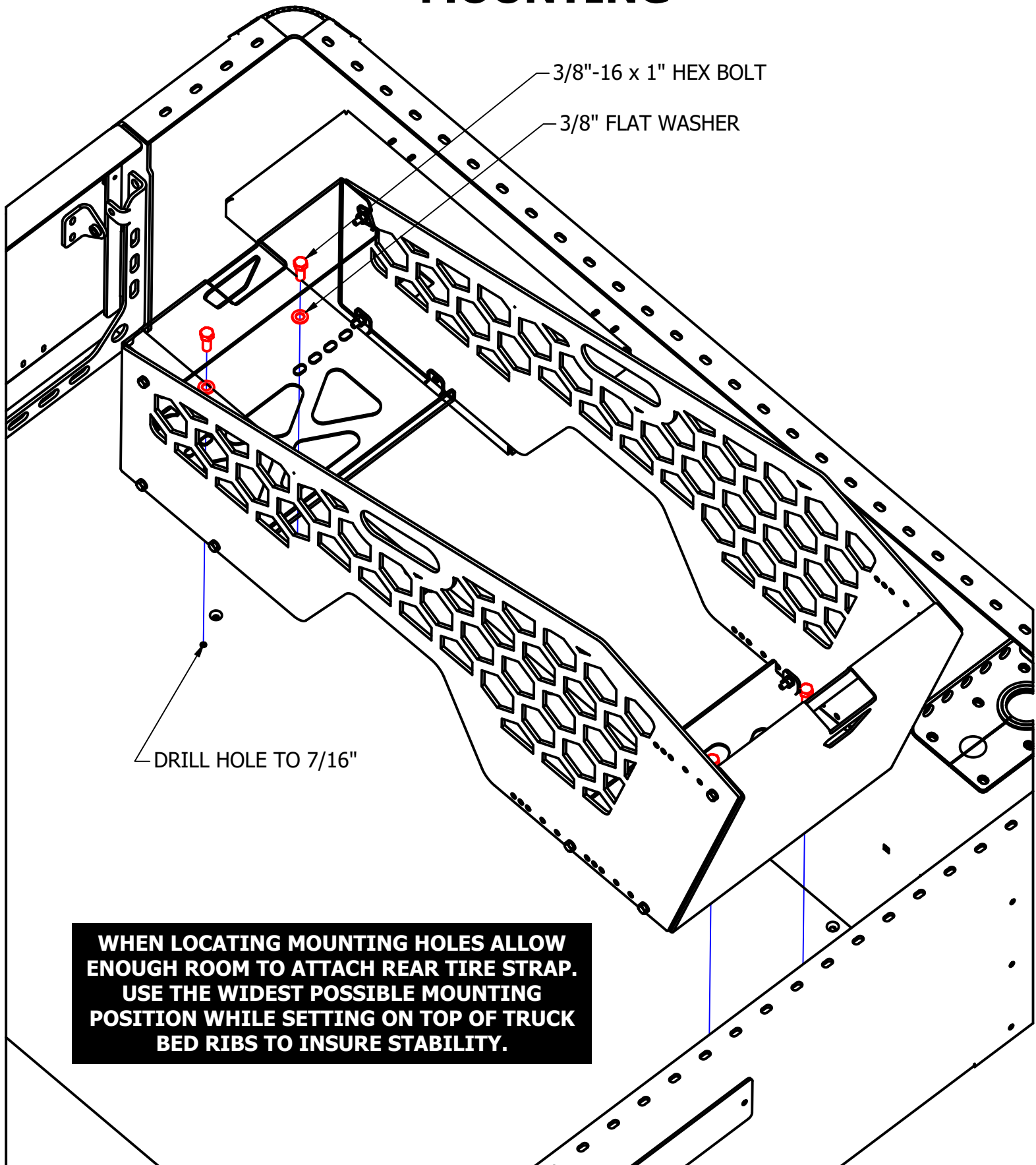

MB5061 - Assembly Instructions Universal Bed Mounted Tire Carrier

MOUNTING

