

**MB5056 - Shipping Gladiator Diesel Washer Fluid Tank**

**This product fits Jeep  
Gladiator with the Eco  
Diesel Engine**

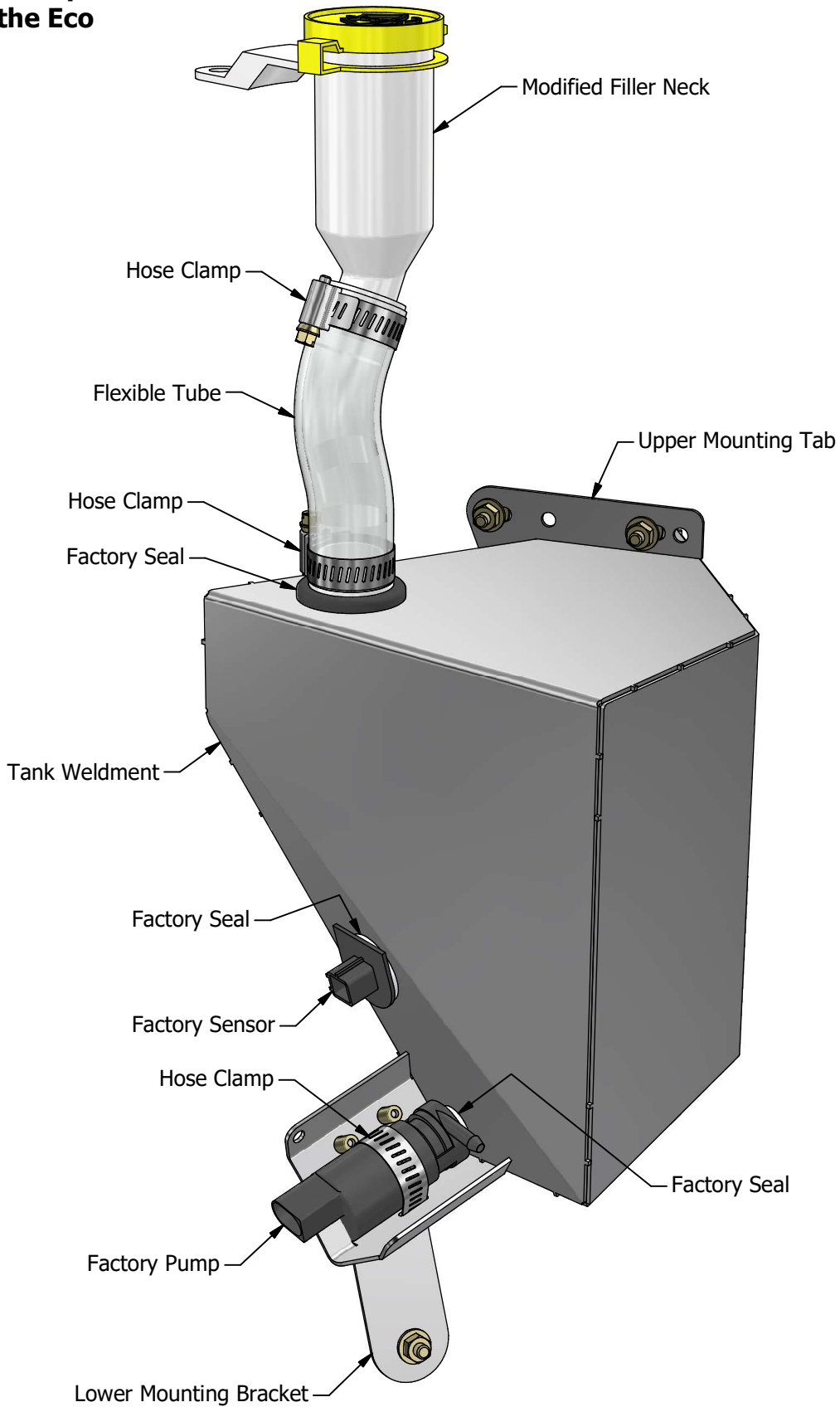

**MB5056 - Shipping Gladiator Diesel Washer Fluid Tank**

**CONTENTS**

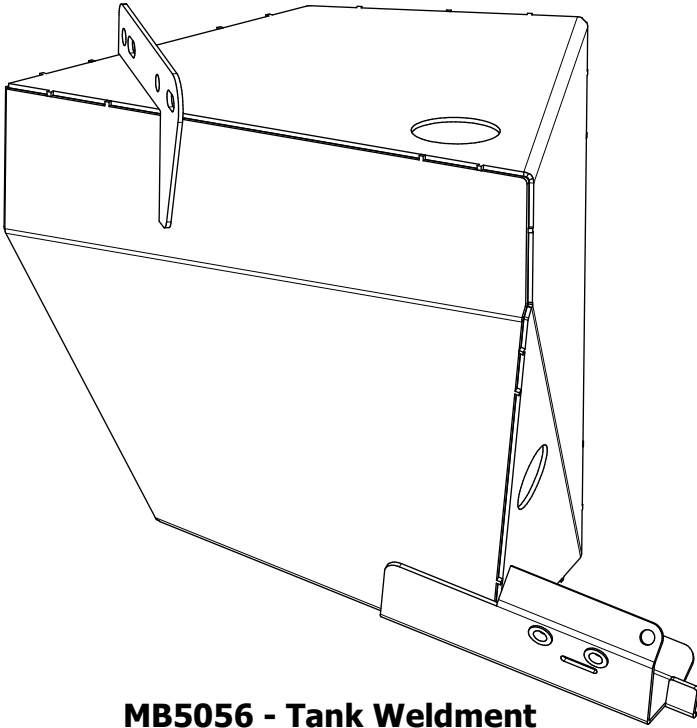

**MB5056 - Tank Weldment  
Qty 1**

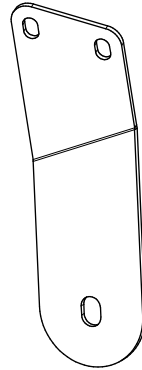

**MB5056-06  
Qty 1**

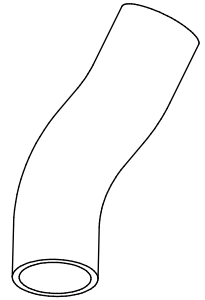

**Hose, 5" Long  
Qty 1**

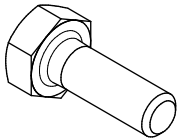

**Hex Bolt, 1/4"-20 x 0.75"  
Qty 3**

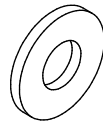

**Flat Washer, 1/4"  
Qty 6**

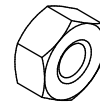

**Nylock Nut, 1/4"-20  
Qty 3**

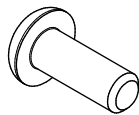

**Round Head Screw, #10-24 x 0.50"  
Qty 2**

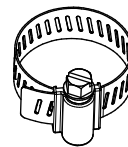

**Hose Clamp, 1.50" Dia  
Qty 3**

## MB5056 - Shipping Gladiator Diesel Washer Fluid Tank

**Remove the factory windshield washer fluid tank from the vehicle**



Using a 10mm socket, remove the bolt holding the Filler Neck to the fender structure. The factory filler neck is pushed into the factory windshield washer fluid tank. There is a rubber seal that connect the two parts. Once the bolt is removed, simply lift up on the filler neck to pull it away from the rubber seal in the tank.

Using a 10mm socket, remove the upper bolt holding the windshield washer fluid tank to the fender structure. The other points holding the tank are friction fit, thus, pull forward to release the tank from the friction fittings.

Disconnect the wiring to the sensor & the pump.

Disconnect the Pump Outlet Hose from the pump.

**MB5056 - Shipping Gladiator Diesel Washer Fluid Tank**

**Remove the factory windshield washer fluid pump & strainer/seal**





**MB5056 - Shipping Gladiator Diesel Washer Fluid Tank**

**Remove the factory low fluid sensor & seal**

Low Fluid Sensor

Seal for Low Fluid Sensor



**MB5056 - Shipping Gladiator Diesel Washer Fluid Tank**



Seal for Filler Neck

**Remove the factory seal for the filler neck**

**MB5056 - Shipping Gladiator Diesel Washer Fluid Tank**

**Modify the factory filler neck**

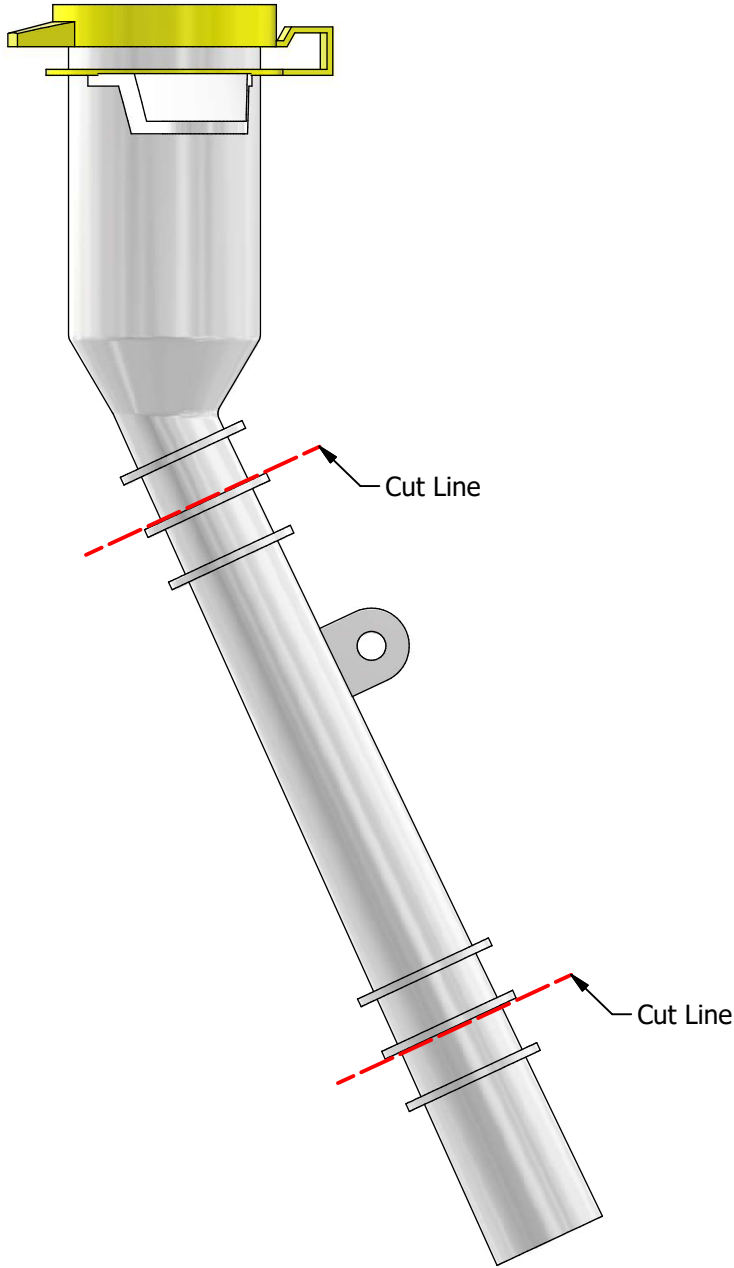

**Filler Neck  
Before Modification**

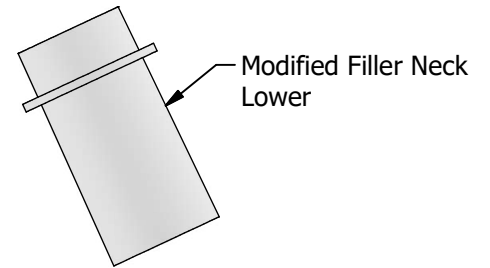
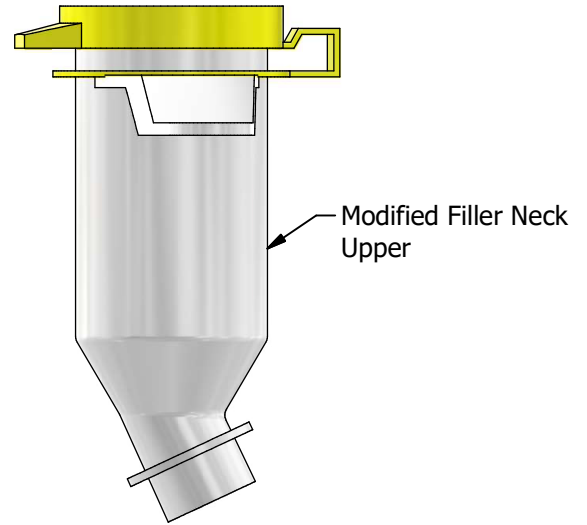

**Filler Neck  
After Cutting**

**MB5056 - Shipping Gladiator Diesel Washer Fluid Tank**

**Assemble the filler neck**

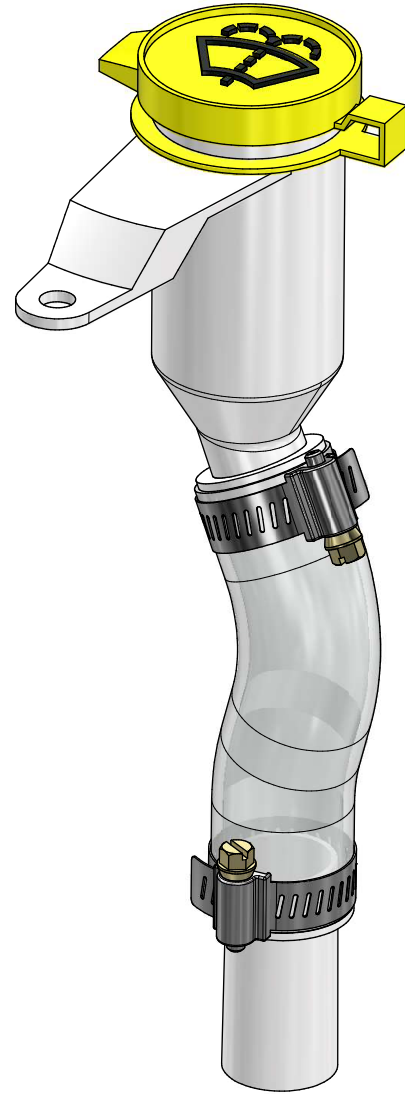
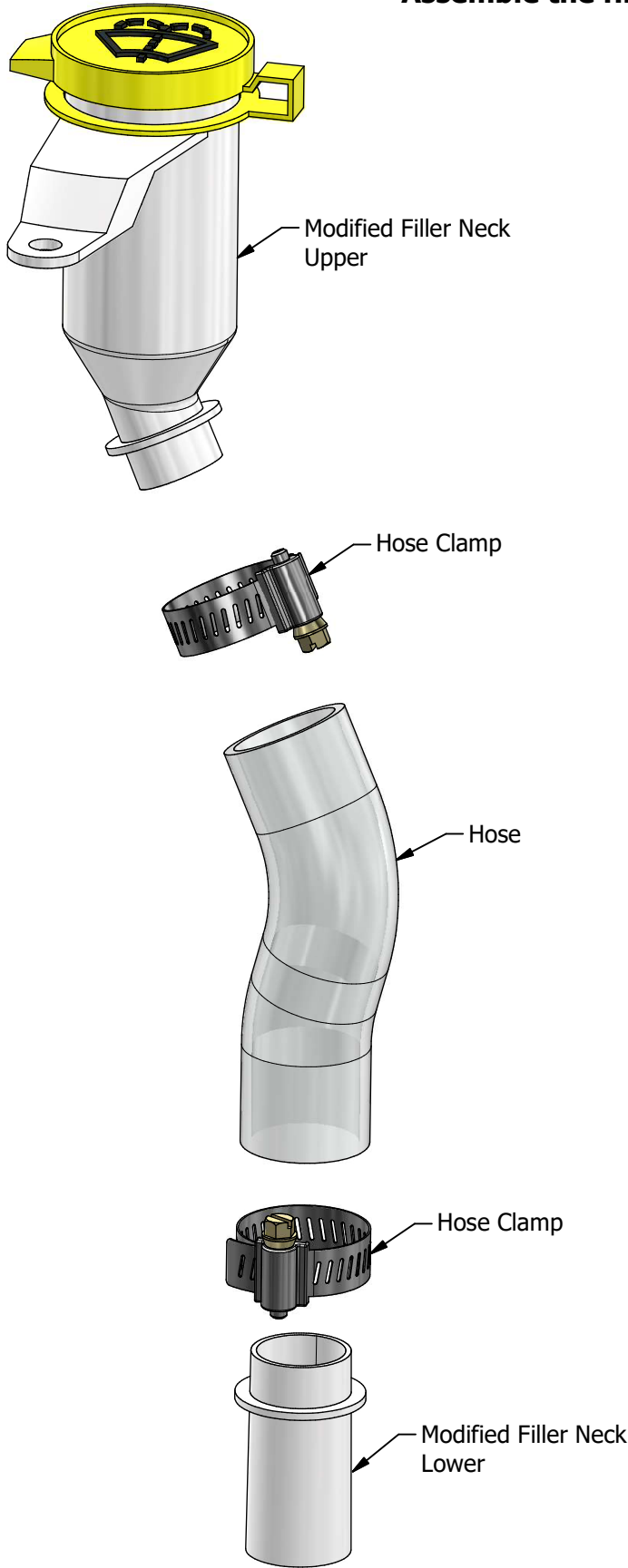

**Modified Filler Neck  
After Assembly**



**MB5056 - Shipping Gladiator Diesel Washer Fluid Tank**

**Assemble the washer fluid tank**

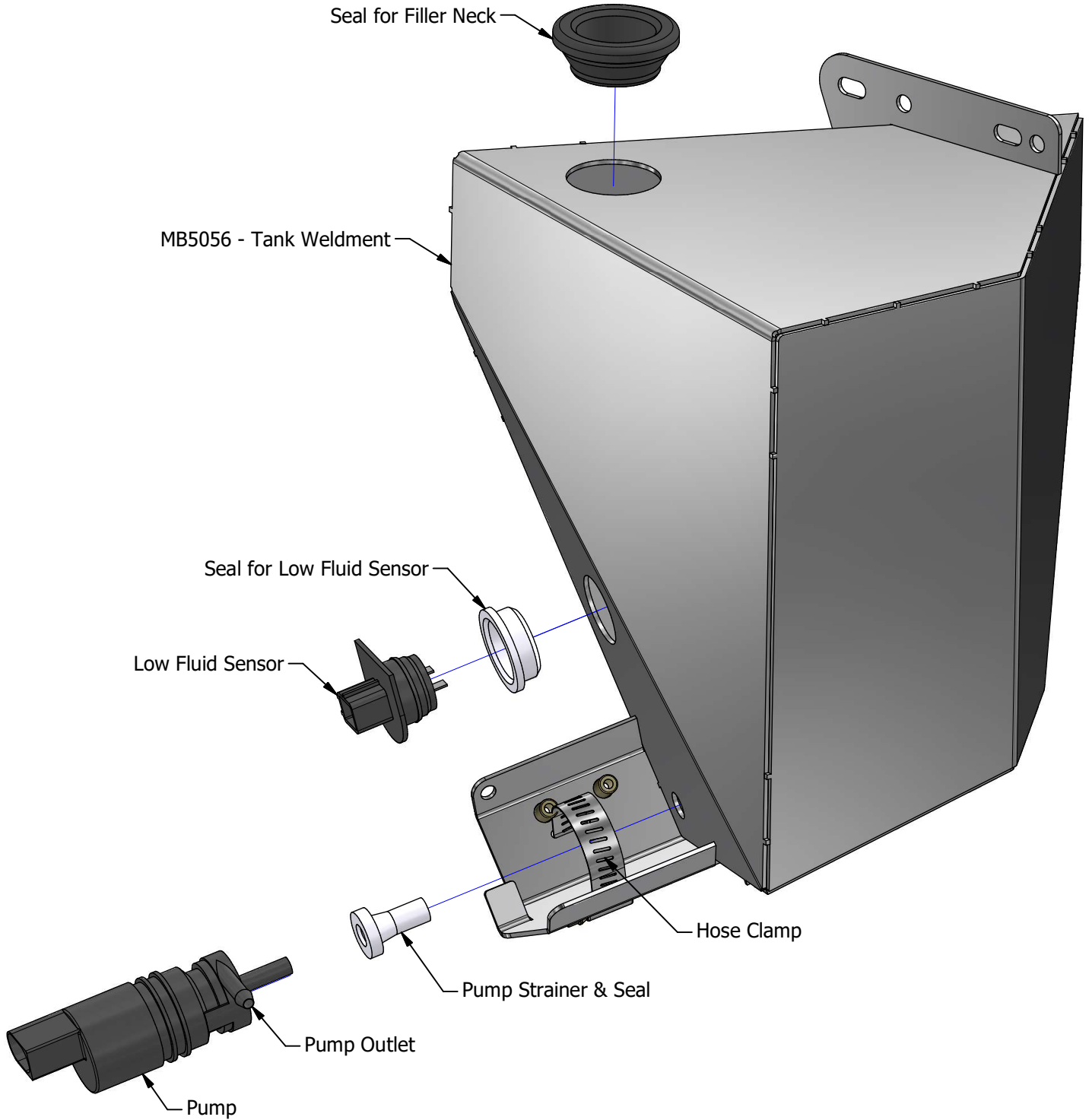

**MB5056 - Shipping Gladiator Diesel Washer Fluid Tank****Install the washer fluid tank**

Place the new washer fluid tank into position. On the ECO Diesel Gladiator, there is an existing bracket with a flange that faces down. This flange supports a wiring harness. Remove the wiring harness from the two holes. Using the 1/4" bolts, fasten the upper flange of the new washer fluid tank through the two slots. Reconnect the wiring harness using the two holes in the washer fluid tank upper flange.





**MB5056 - Shipping Gladiator Diesel Washer Fluid Tank****Install the lower bracket**

Install bracket #MB5056-06 using two (2) #10-24 round head screws for the upper position. These round head screws thread into the two pre-installed rivnuts on the washer fluid tank. Using a 1/4" bolt, install the lower bolt through an existing hole in the frame.



**MB5056 - Shipping Gladiator Diesel Washer Fluid Tank****Install the modified filler neck**

Place the modified filler neck down through the engine bay in its original position. Ensure the lower portion of the filler neck is firmly placed into the upper tank seal. Reuse the factory bolt to fasten the upper portion of the filler neck to the fender. Connect the factory hose to the factory pump. Connect the factory wiring to the pump & sensor. Fill the tank with fluid. Check for leaks.

