

MB5033 - JL EVAP Modification

MB5033 JL EVAP AND FUEL LINE MODIFICATION

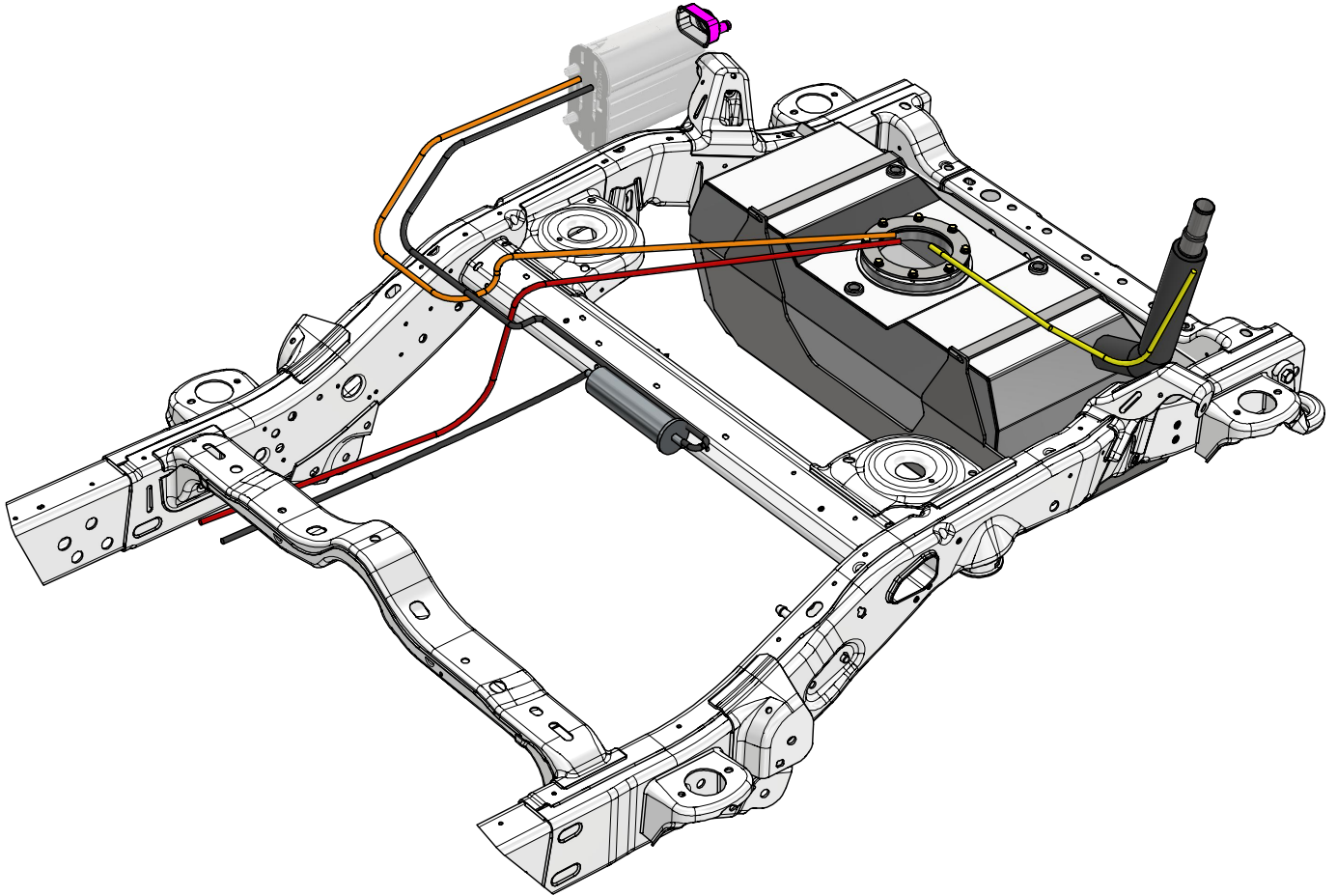
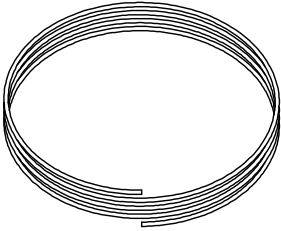

OFF-ROAD USE ONLY

MB5033 - JL EVAP Modification**KIT COMPONENTS**

5/16" FUEL LINE
Qty: 3 FT

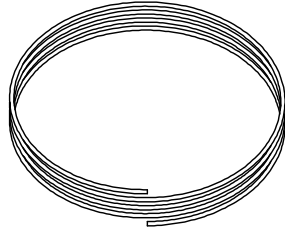

3/8" FUEL LINE
Qty: 4 FT

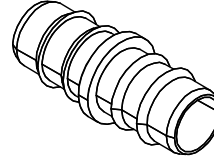

BARBED SPLICE
1/2"-3/8"
Qty: 2

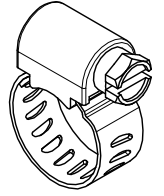

HOSE CLAMP
3/8"
Qty: 5

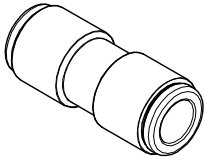

PUSH CONNECT UNION
3/8"
Qty: 2



FUEL PUMP EXTENSION WIRE
12Ga, 36"
Qty: 2



FUEL SENDER EXTENSION WIRE
16Ga, 36"
Qty: 2

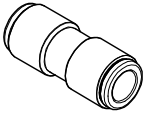

PUSH CONNECT UNION
5/16"
Qty: 1

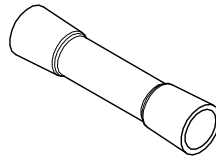

ELECTRICAL BUTT CONECTOR
16Ga - 14Ga
Qty: 4

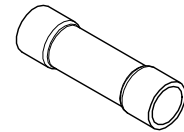

ELECTRICAL BUTT CONNECTOR
12Ga - 10Ga
Qty: 4

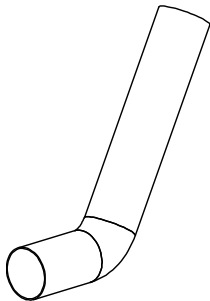

FUEL FILL HOSE
Qty: 1

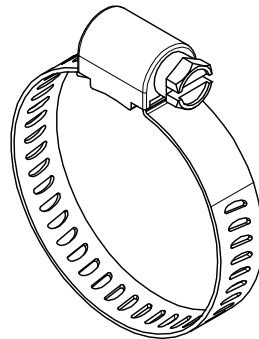

HOSE CLAMP
1-1/2"
Qty: 2

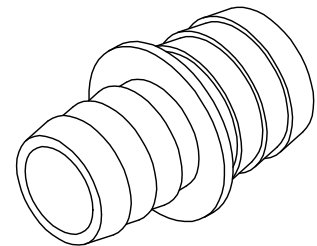

FUEL FILL REDUCER
Qty: 1

MB5033 - JL EVAP Modification

OVERVIEW

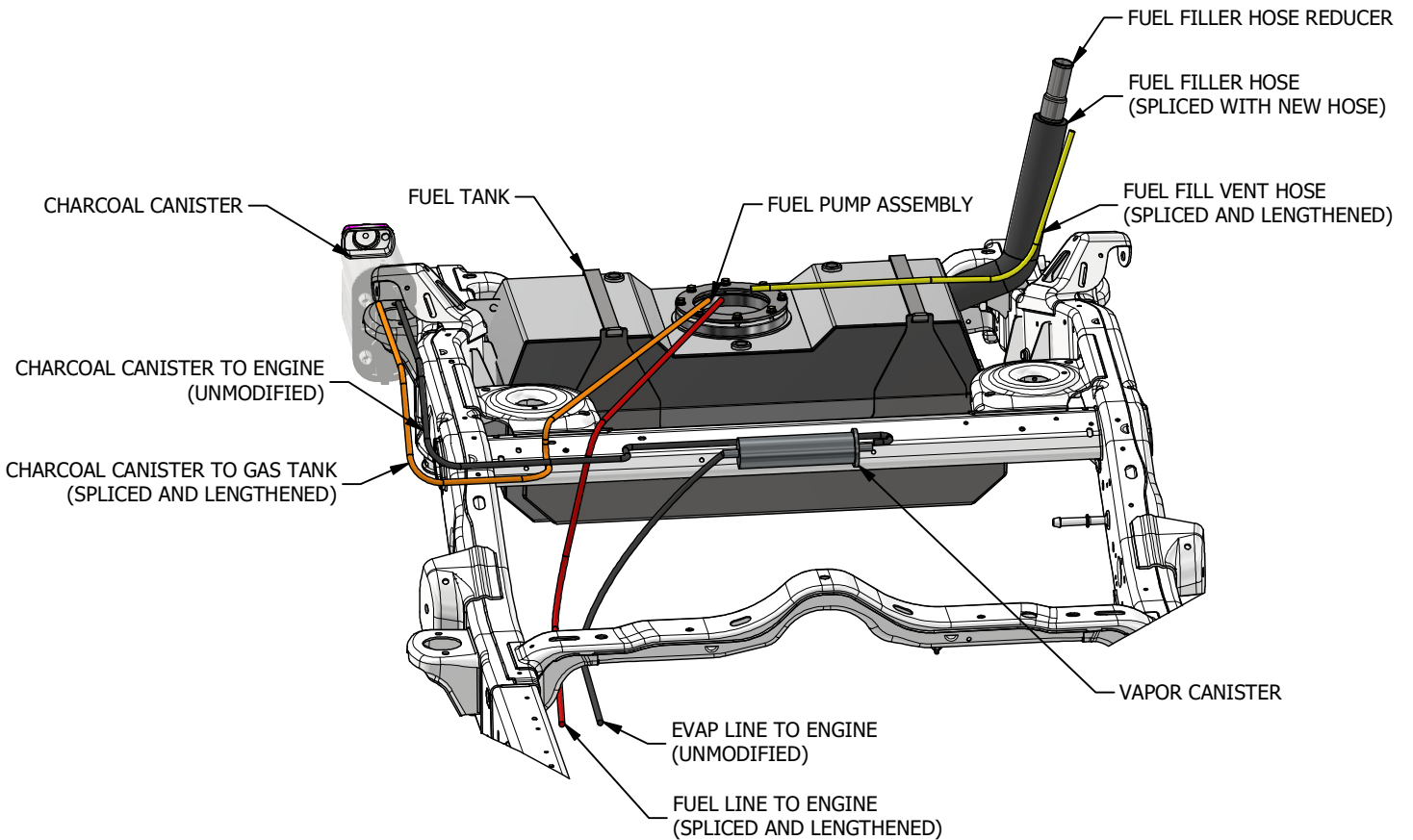
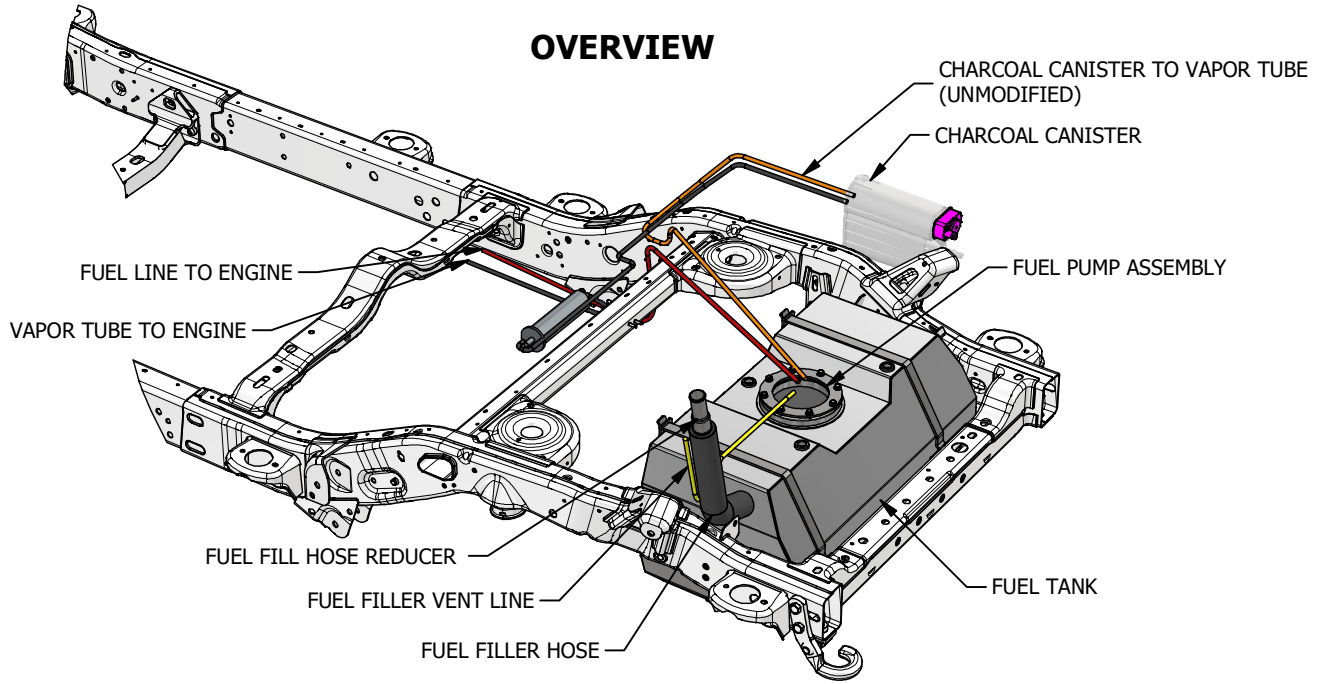

MB5033 - JL EVAP Modification

FACTORY FUEL PUMP

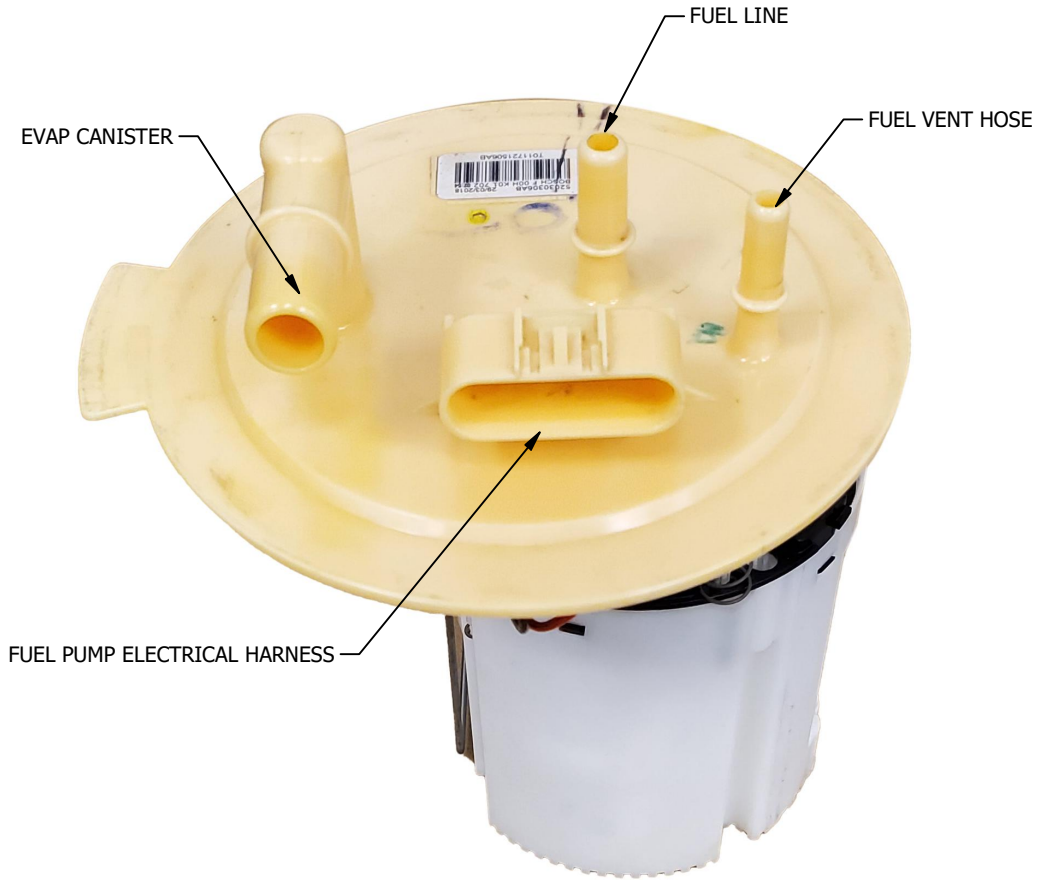

MB5033 - JL EVAP Modification

FUEL LINE (RED)

CUT THE FACTORY FUEL LINE AT THE CROSS MEMBER SO THERE IS ROUGHLY 1-1/2' OF THE FACTORY HOSE STILL ATTACHED TO THE FACTORY FUEL LINE CONNECTOR. THE PROVIDED 3/8" FUEL LINE CAN BE SPLICED INTO THE FACTORY FUEL LINE.

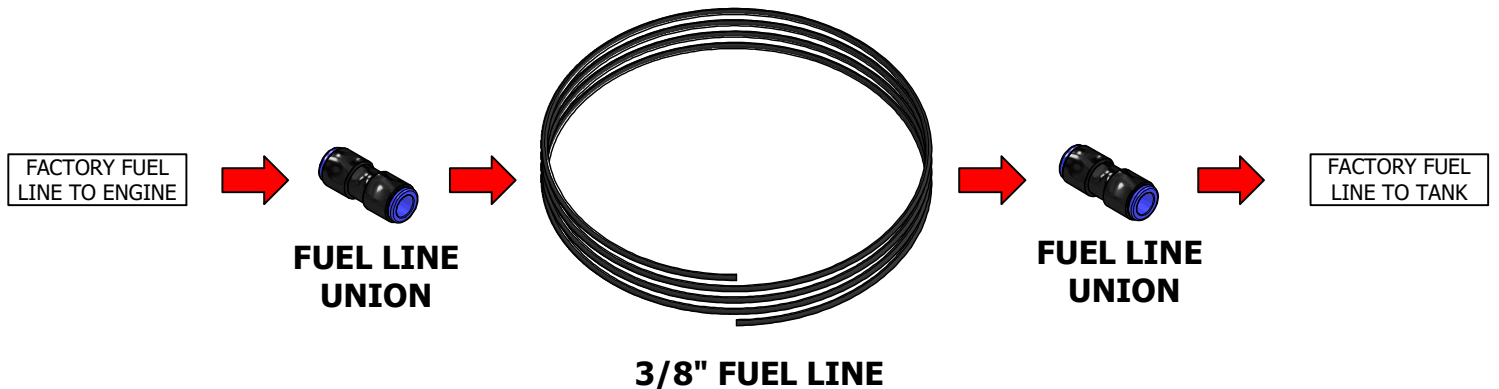
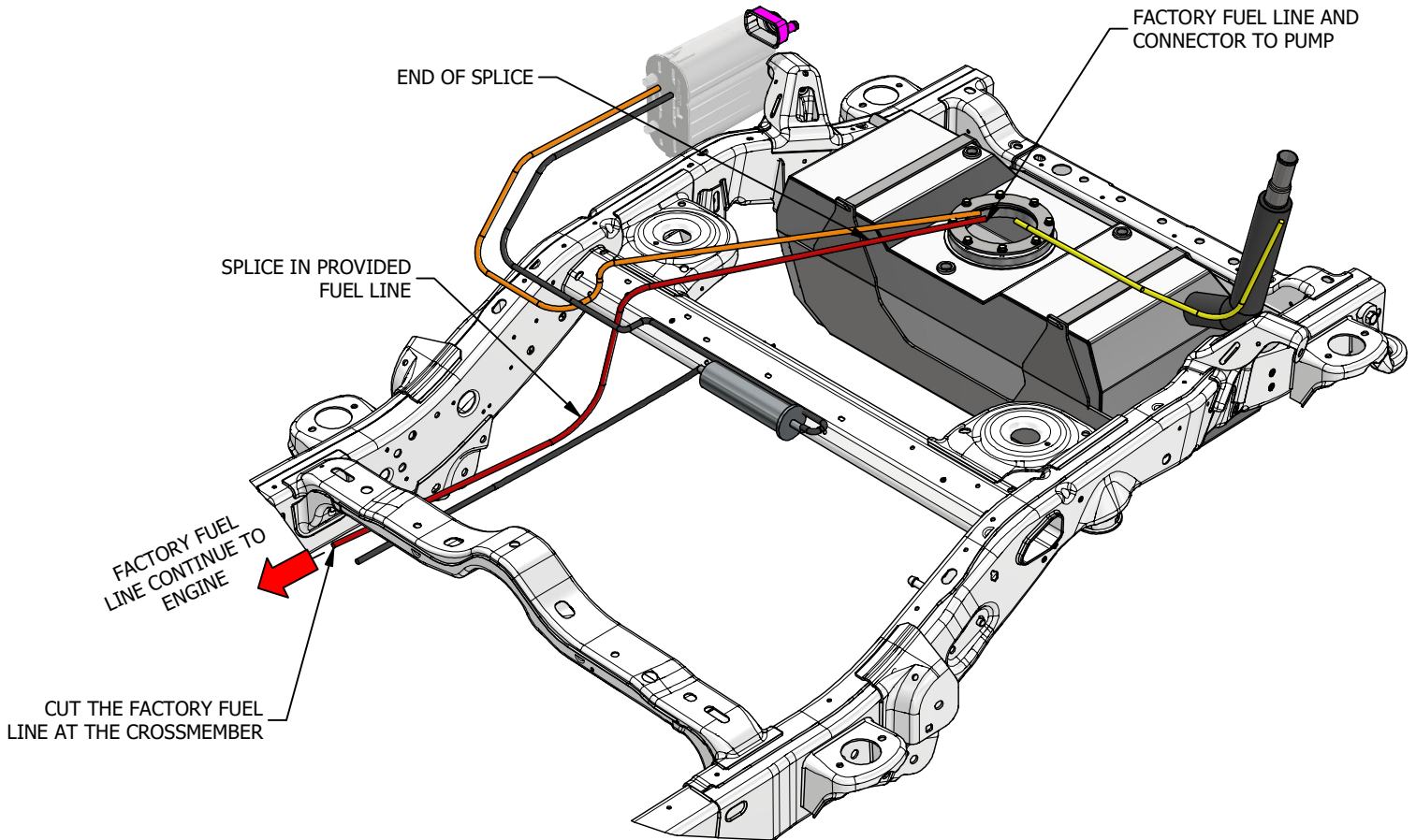

MB5033 - JL EVAP Modification

CHARCOAL CANISTER TO FUEL TANK LINE (ORANGE)

CUT THE FACTORY EVAP LINE INSIDE OF THE FRAME SO THERE IS ROUGHLY 6" OF THE FACTORY HOSE STILL ATTACHED TO THE FACTORY EVAP LINE CONNECTOR. THE PROVIDED 3/8" FUEL LINE CAN BE SPLICED INTO THE FACTORY EVAP LINE.

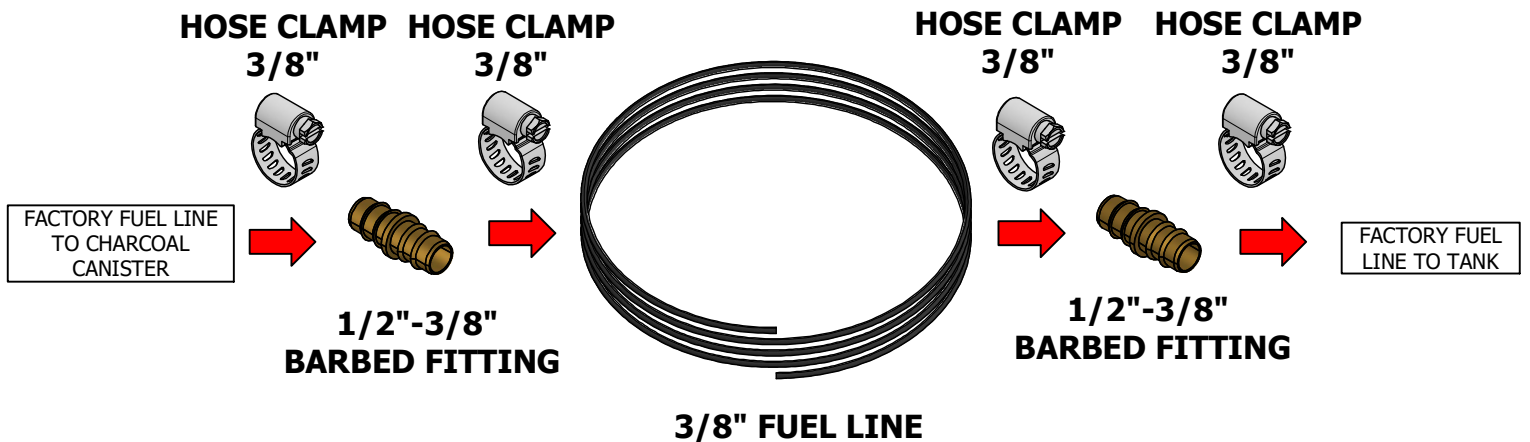
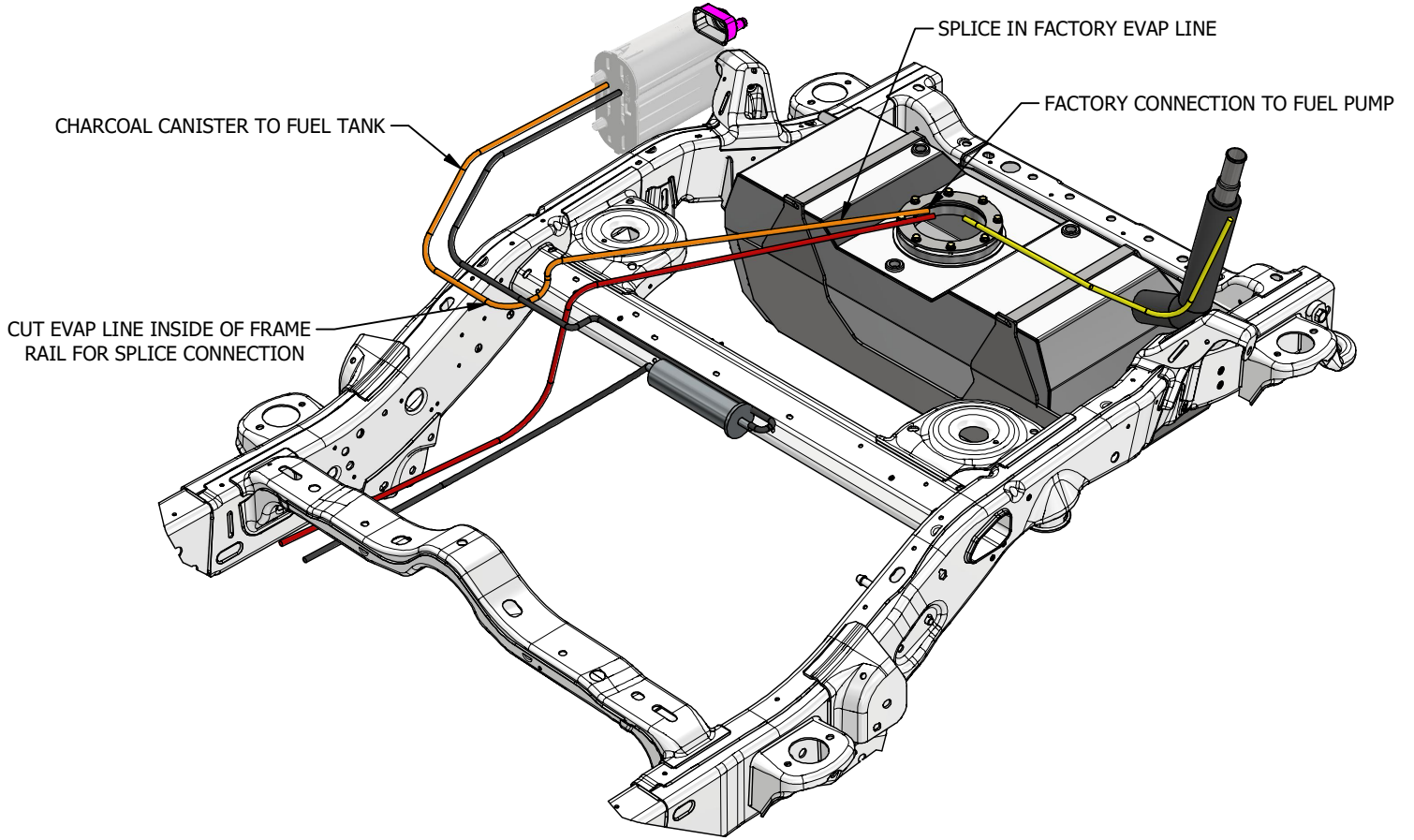

MB5033 - JL EVAP Modification**FUEL FILL VENT LINE (YELLOW)**

CUT THE FACTORY FUEL FILL VENT LINE 1FT BACK FROM THE CONNECTION AT THE FUEL PUMP. USE A 5/16" UNION TO SPLICE IN THE PROVIDED 5/16" FUEL LINE. RUN THE NEW FUEL FILL VENT LINE TO THE FACTORY FUEL FILL BARB CONNECTION AND HOSE CLAMP THE LINE IN PLACE.

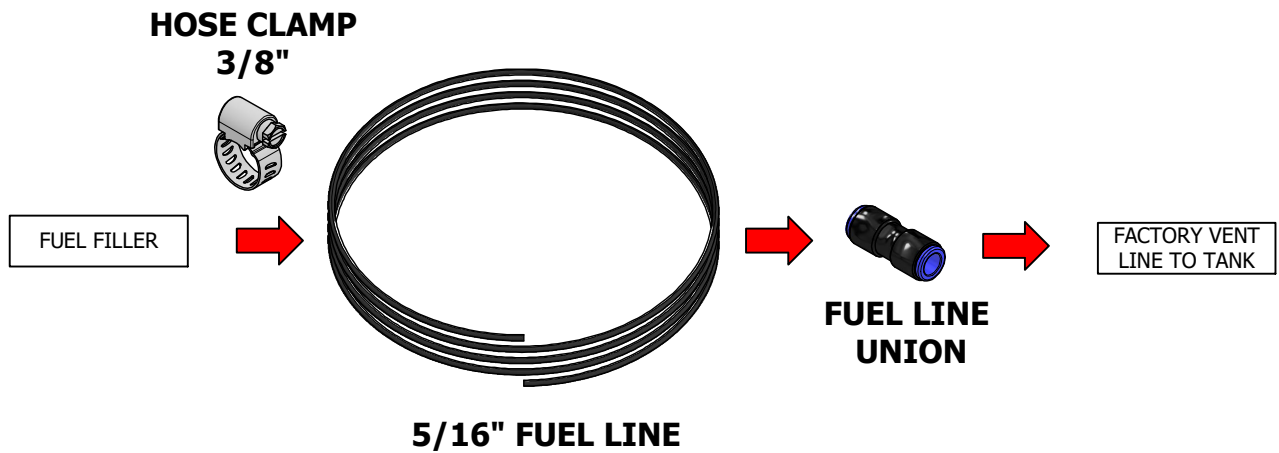
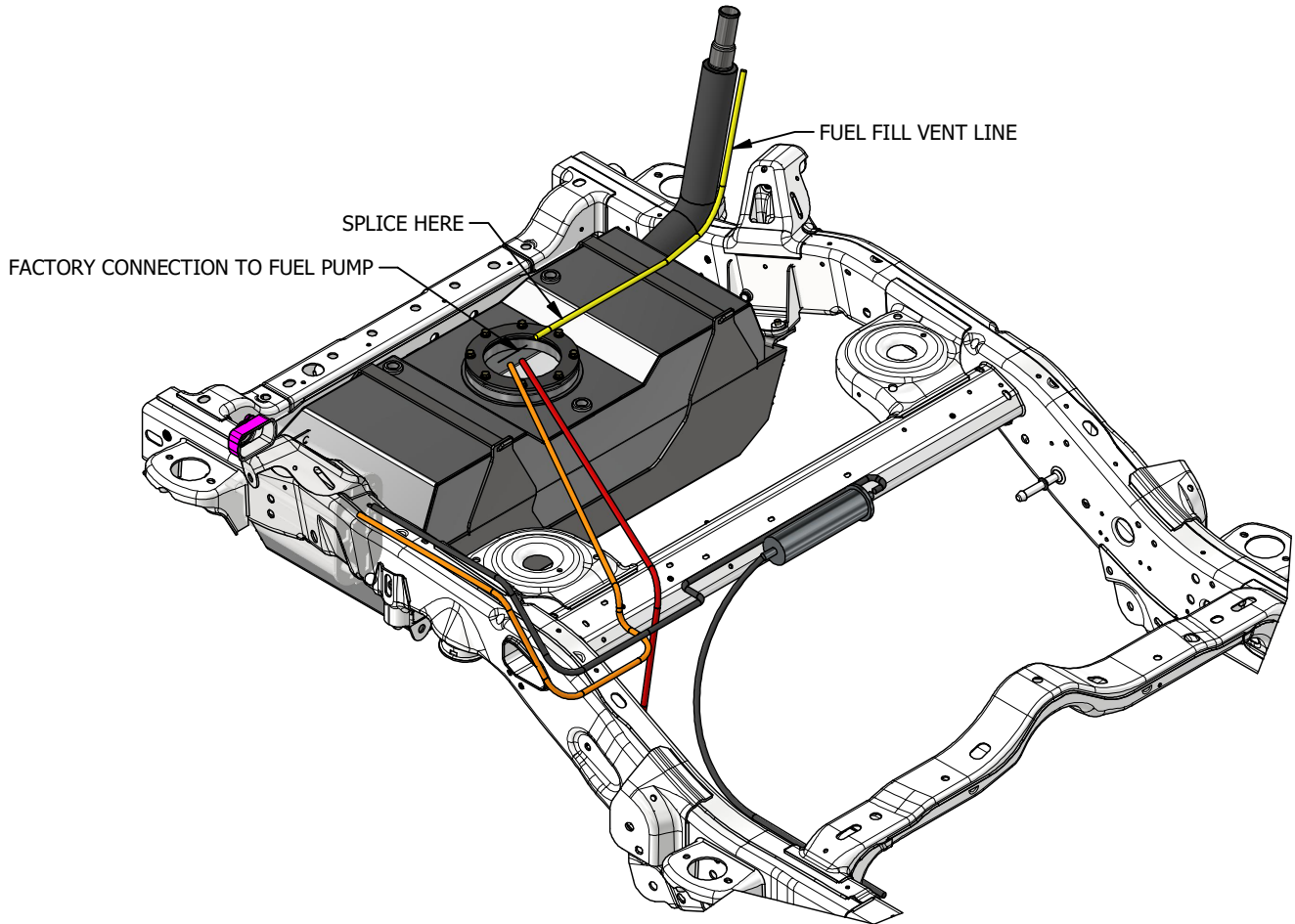

MB5033 - JL EVAP Modification**FUEL FILLER HOSE**

CUT THE FACTORY FUEL FILL HOSE TO ALLOW ENOUGH LENGTH TO SUFFICIENTLY SPLICE IN THE FUEL FILL REDUCER. SLIP THE SUPPLIED FUEL FILL HOSE OVER THE GAS TANK FUEL INLET. MARK AND TRIM THE SUPPLIED FUEL HOSE WHERE IT SLIPS ONTO THE FUEL FILL REDUCER. ONCE CUT TO LENGTH, INSTALL THE FUEL FILL HOSE AND CLAMP ALL CONNECTIONS WITH THE PROVIDED HOSE CLAMPS. CHECK FOR LEAKS.

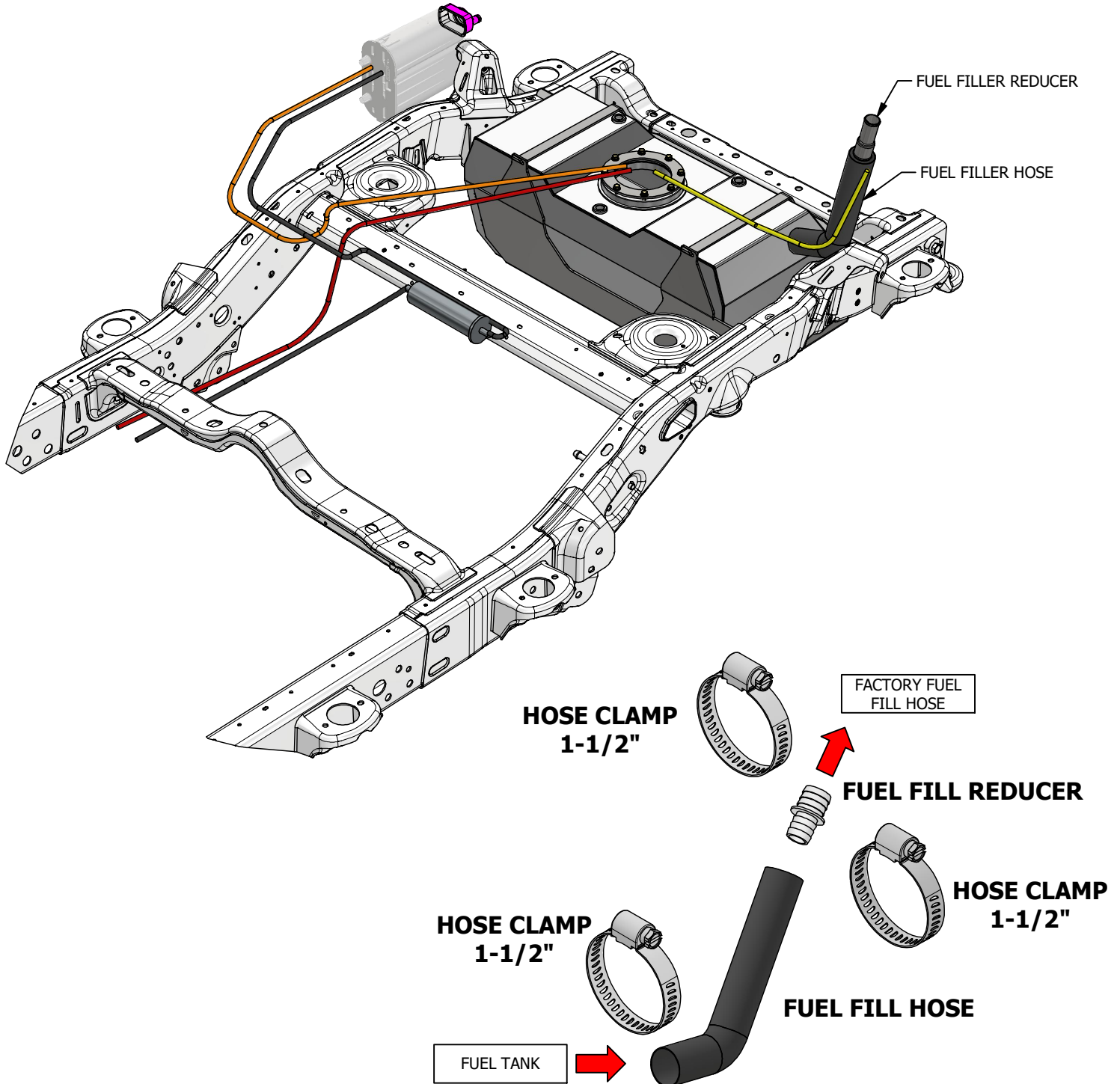

MB5033 - JL EVAP Modification**FUEL PUMP WIRING HARNESS**

THE FUEL PUMP WIRING HARNESS NEEDS TO BE LENGTHENED TO REACH THE NEW FUEL TANK LOCATION. CUT THE FACTORY HARNESS 6" FROM THE FUEL PUMP CONNECTOR AND ADD IN THE SPLICE USING THE PROVIDED WIRE AND BUTT CONNECTORS. HEAT SHRINK THE BUTT CONNECTORS TO PROTECT THE WIRING FROM THE ELEMENTS.

