

ASSEMBLY INSTRUCTIONS

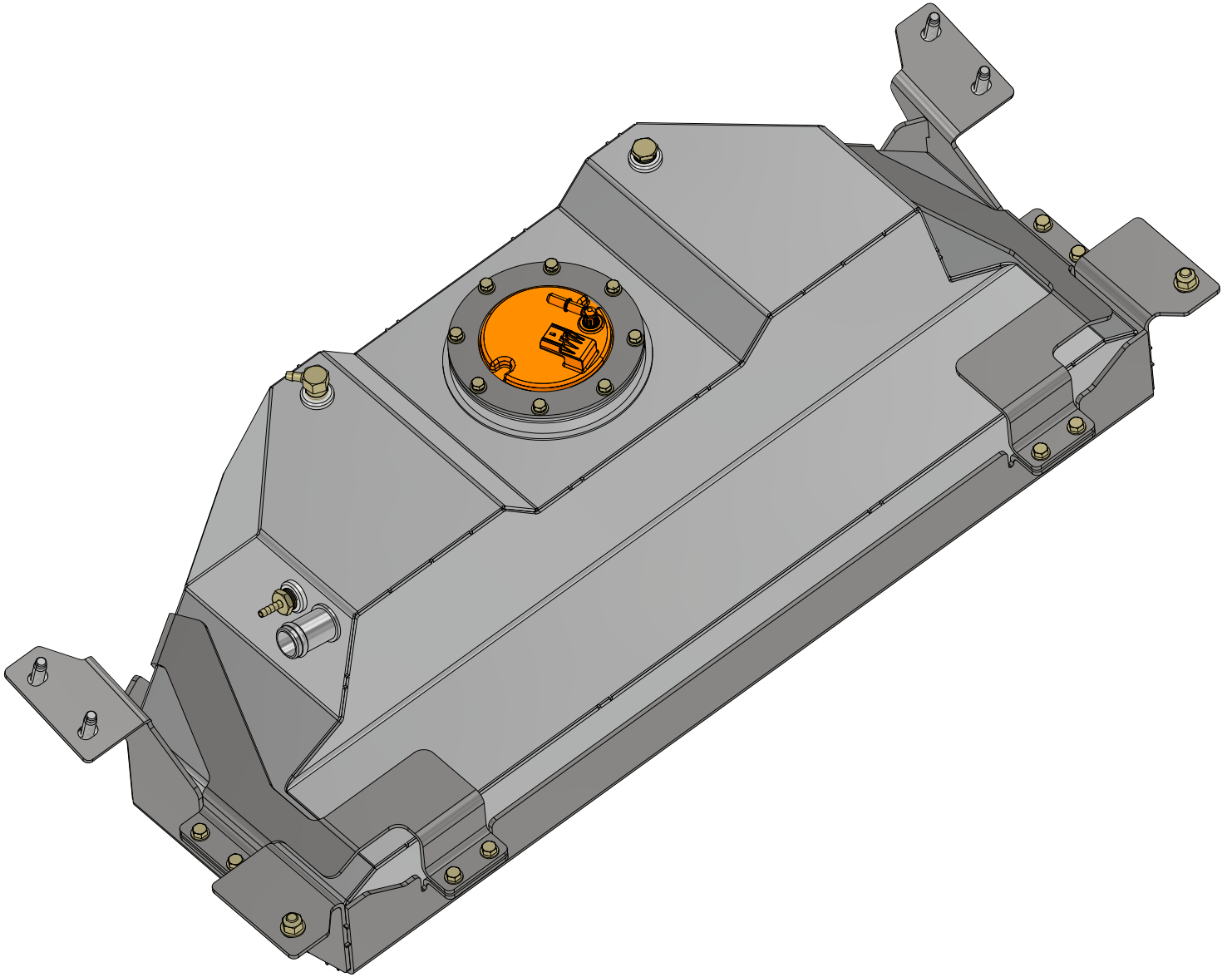

MB5032 - Assembly Instructions Rear Fuel Tank & Skid for Factory Frame

CONTENTS

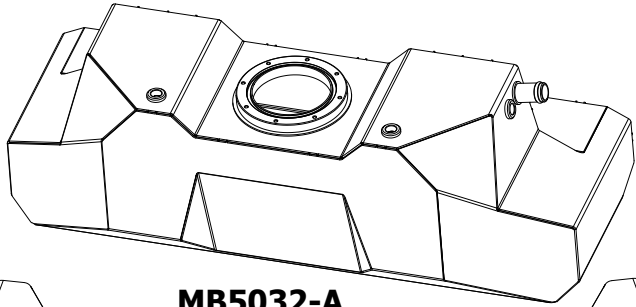

MB5032-A
Qty 1

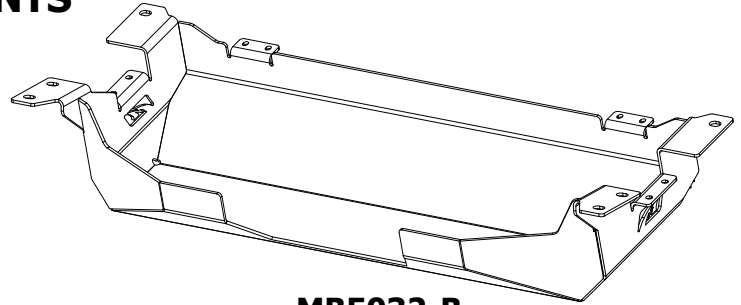

MB5032-B
Qty 1

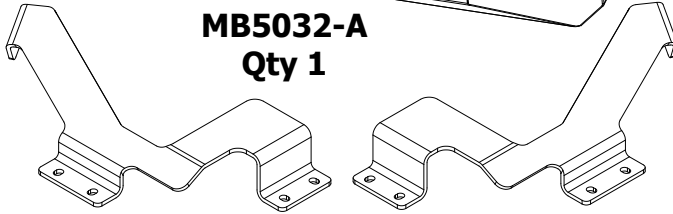

MB5032-10
Qty 1

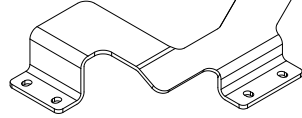

MB5032-10_MIR
Qty 1



Flat Washer
M6 Stainless
Qty 1

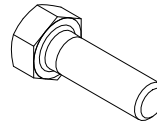

Hex Bolt
5/16"-18 x 1"
Qty 8



Flat Washer
5/16"
Qty 16



Nylock Nut
5/16"-18
Qty 8

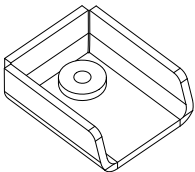

MB5032-11
Weldment
Qty 1

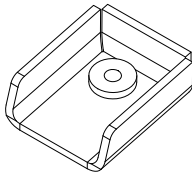

MB5032-11_MIR
Weldment
Qty 1



E-Clip, 4mm
Qty 4

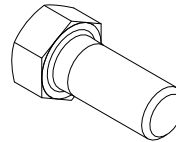

Hex Bolt
7/16"-14 x 1"
Qty 2



Flat Washer
7/16"
Qty 4

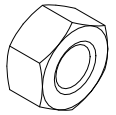

Nylock Nut
7/16"-14
Qty 2

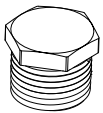

1/2" NPT Plug
Qty 1

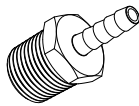

Barbed Hose Fitting
Qty 1

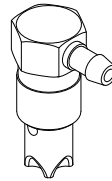

Roll Over Valve
Qty 1

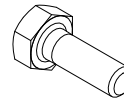

Hex Bolt
1/4"-20 x 3/4"
Qty 8



Lock Washer
1/4"
Qty 8



Flat Washer
1/4"
Qty 8

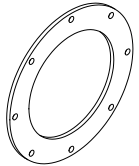

MB5515-02
Qty 1

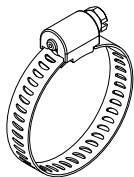

Hose Clamp, 1-1/2"
Qty 4

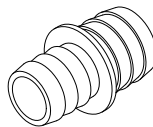

Fuel Fill Reducer
Qty: 2



MB5015
Fuel Pump Extension Rod
Qty 2



Primary Wire, Black 4"
Qty 1



Rubber Strip
Qty 2

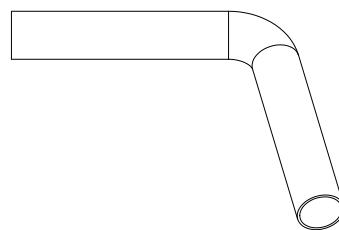

90 Degree Rubber Hose, 1-1/2"
Qty 1



Primary Wire, Red 4"
Qty 1



Butt Connector, Pink
Qty 4

MB5032 - Assembly Instructions Rear Fuel Tank & Skid for Factory Frame

FOREWORD

STEPS BEFORE YOU START:

1. Disconnect negative battery terminal.
2. Ideally, use a vehicle lift to safely raise the vehicle & perform many of the mechanical disassembly & reassembly steps shown in these instructions. It is possible to perform this install without a vehicle lift.
3. Remove the factory rear bumper, tow hook & hitch, if equipped.
4. You do **NOT** need to remove the factory rear axle or factory rear suspension to complete this install. The rear axle is NOT shown in the assembly instructions views, simply for clarity.
5. The skid plate & brackets included with this kit ship as raw steel. Clean & paint (or powder coat) all steel parts AFTER INSTALLATION & FITMENT IS CONFIRMED.
6. Have a can of touch up spray paint on hand for the frame modifications.

NOTES:

This installation will create permanent & extensive modifications to fuel system, EVAP system, frame, body, exhaust & factory rear swaybar. Check with your local laws & insurance before performing this install.

The MB5032 Fuel Tank & Skid kit is designed to function with an aftermarket rear swaybar, available from Currie Enterprises. This kit will NOT function with the factory rear swaybar.

The function of this product is to relocate the fuel storage from the factory location to the rear of the vehicle, making room for an aftermarket 4 link rear suspension system for increased suspension articulation. Motobilt offers a compatible 4 link suspension bracket kit that works seamlessly with this rear fuel tank system. See MB7000 Jeep JKU 4 Link Suspension Bracket & Skid Kit on our website.

This product also functions with our MB1081 Frame Chop Rear Bumper & Cross Member kit for Jeep JK/JKU. We include a pair weld-in brackets to adapt the mounting of the tank to function with the modifications performed to the rear of the frame for Kit MB1081. You do NOT need MB1081 to install this product.

This product utilizes the space previously occupied by the factory muffler. You will have to cut & remove the factory muffler, heat shield & factory muffler hangers. You will have to relocate & add an aftermarket muffler. These assembly instructions do NOT cover the installation of an aftermarket exhaust system.

This product requires cutting the body in the rear compartment area to gain access to the top of the new aluminum tank for making connections & maintenance. Motobilt offers MB5019 Fuel Cell Access Hatch (sold separately) as an optional product to cover the opening that will be created when installing this product.

You will reuse & modify the factory fuel pump/sending unit. This product includes all of the components to modify the factory fuel sending unit.

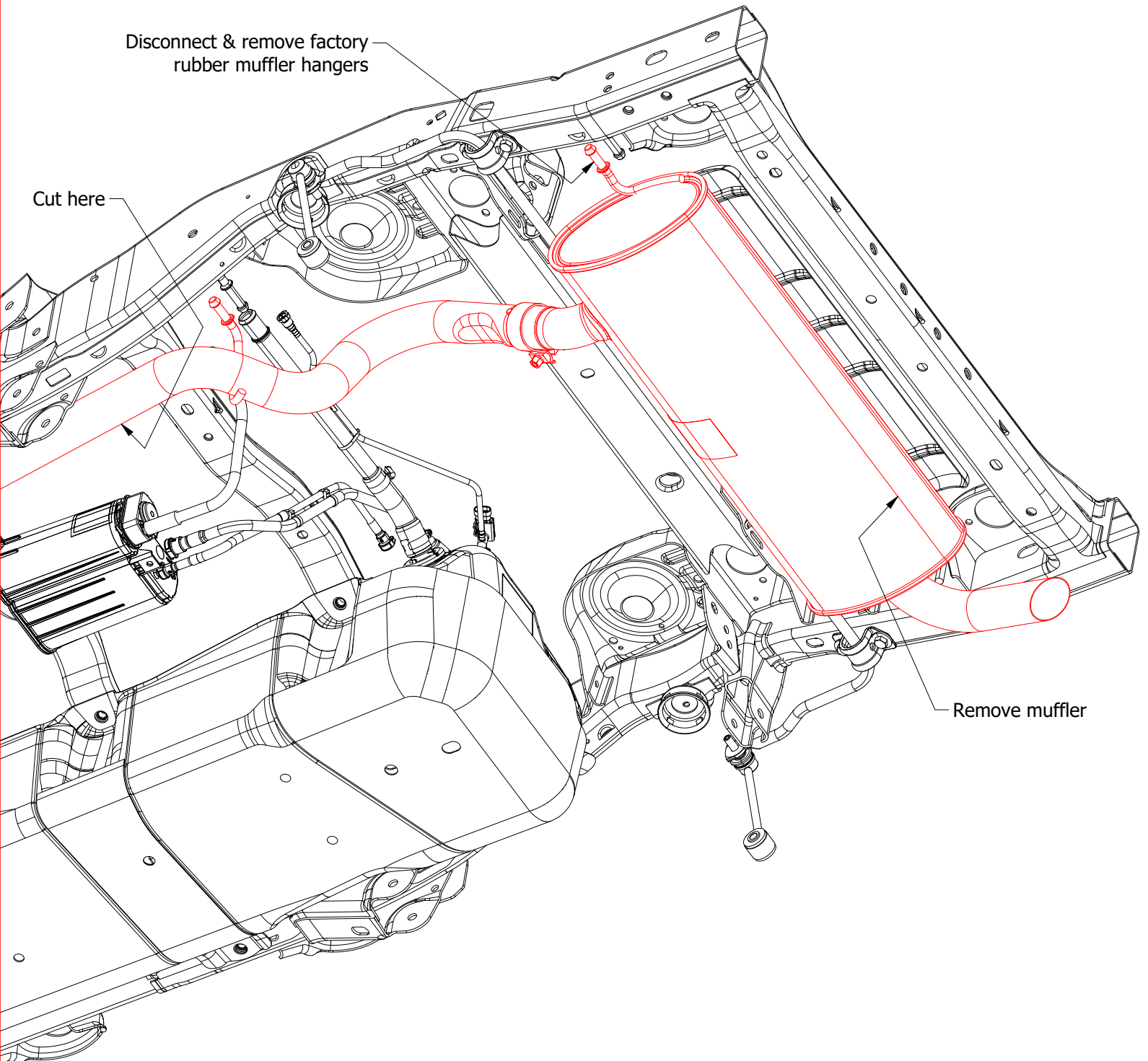
MB5032 - Assembly Instructions Rear Fuel Tank & Skid for Factory Frame**STEP 1
Remove Factory Muffler**

MB5032 - Assembly Instructions Rear Fuel Tank & Skid for Factory Frame**STEP 2
Remove Factory Exhaust Heat Shield**

Remove factory heat shield

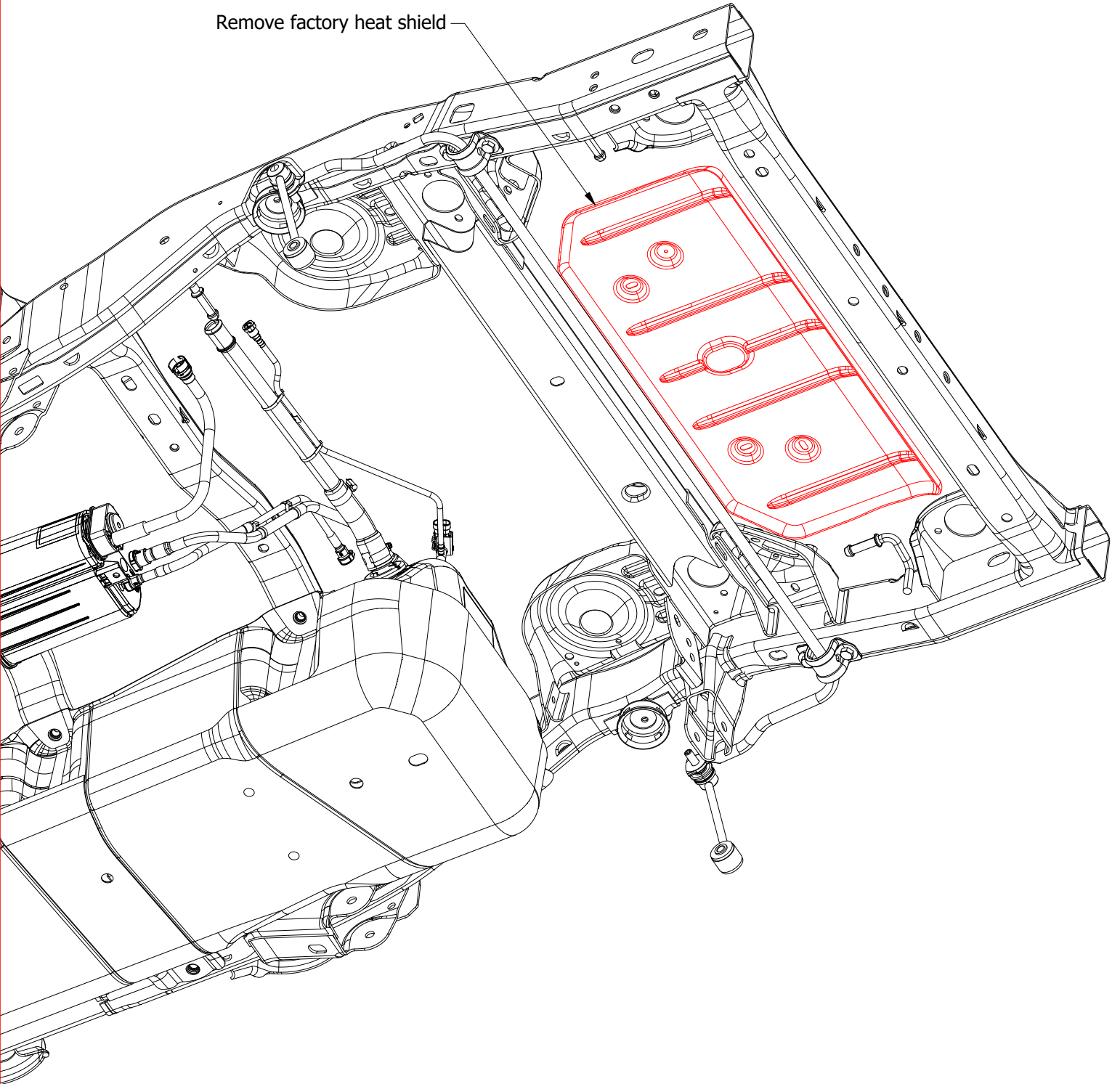

MB5032 - Assembly Instructions Rear Fuel Tank & Skid for Factory Frame**STEP 3
Remove Factory Rear Swaybar**

You will reuse these mounting locations
for the installation of the new tank skid

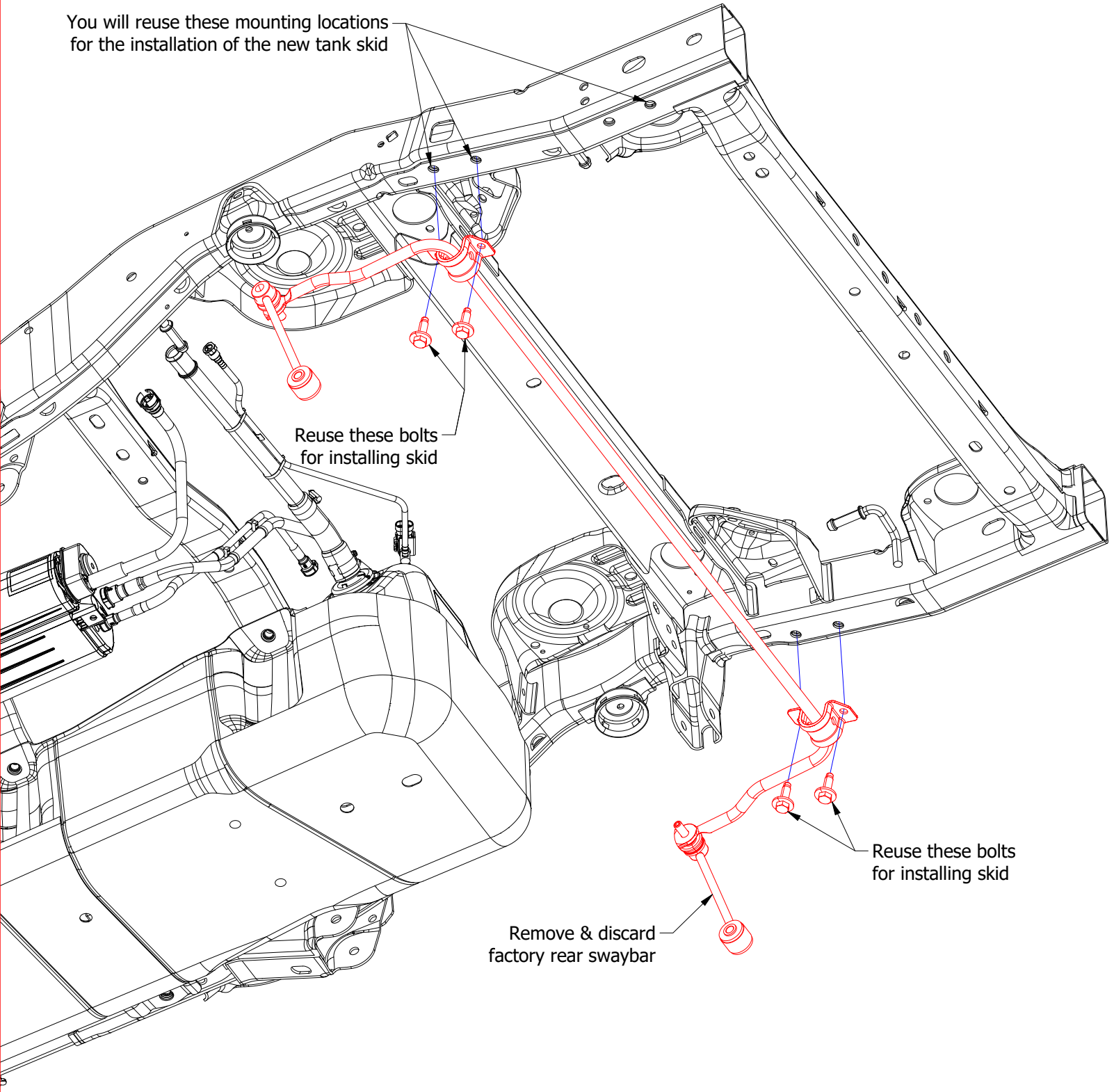

MB5032 - Assembly Instructions Rear Fuel Tank & Skid for Factory Frame**STEP 4**
Disconnect Hoses & Electrical From Fuel Tank

A - Disconnect Fuel Line & Electrical Supply from Fuel Sending Unit

B - Disconnect EVAP Hose to Control Valve

C - Disconnect Purge Sensor from Control Valve

D - Disconnect Rubber Filler Hose from Tank

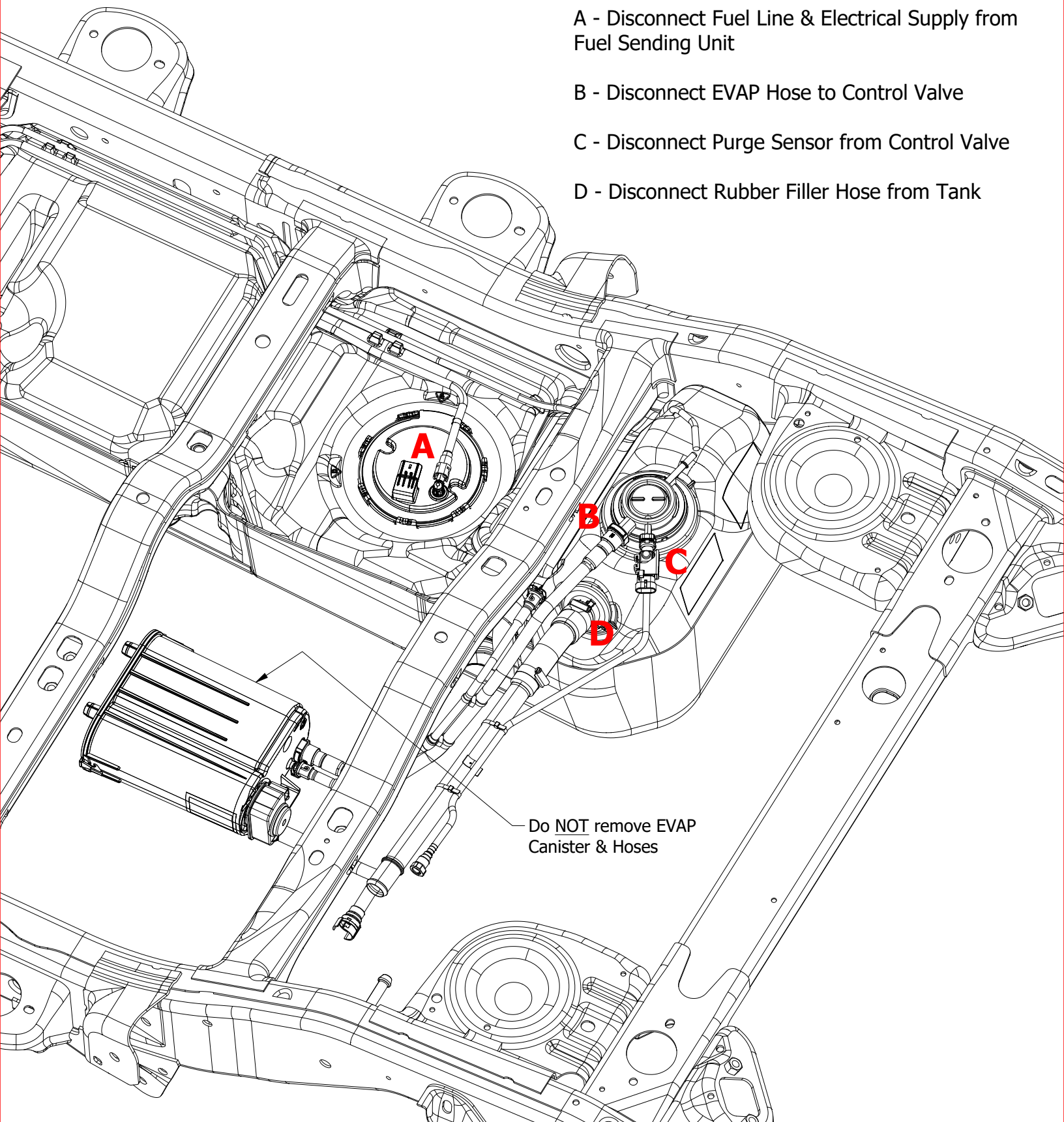

Do NOT remove EVAP
Canister & Hoses

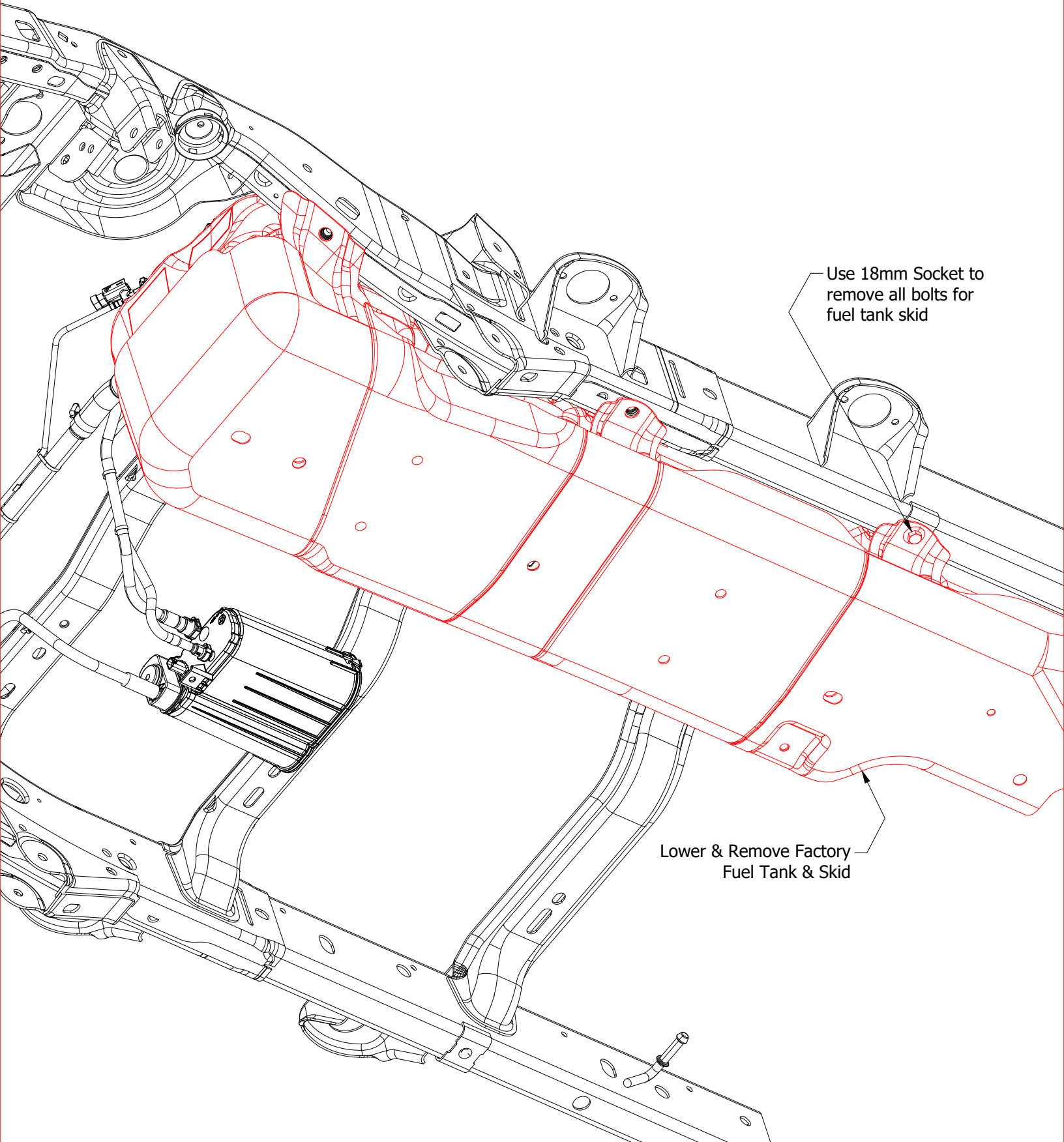
MB5032 - Assembly Instructions Rear Fuel Tank & Skid for Factory Frame**STEP 5**
Remove Factory Fuel Tank & Skid

MB5032 - Assembly Instructions Rear Fuel Tank & Skid for Factory Frame

**STEP 6
Reuse Filler Hose & Purge Sensor**

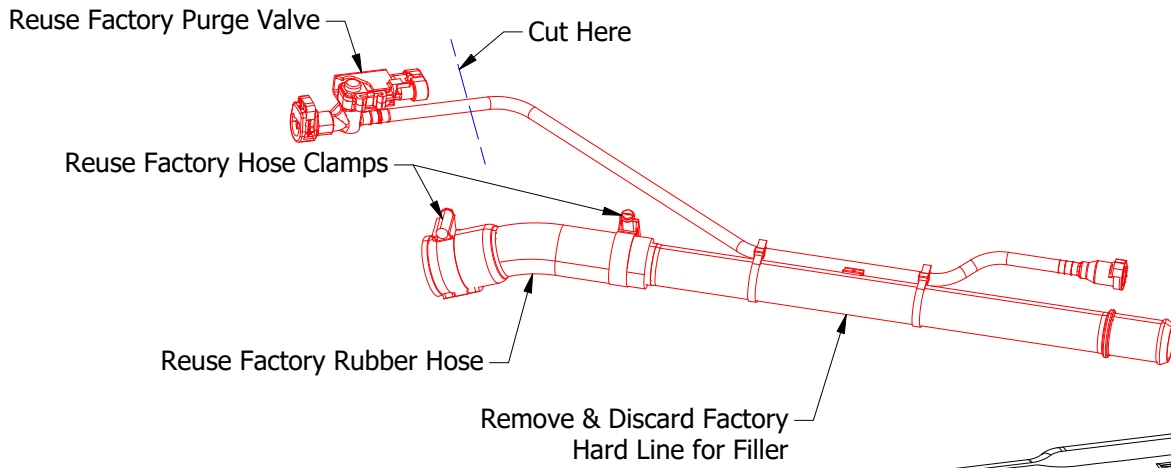

**PARTS CAN BE REUSED
IN A LATER STEP**

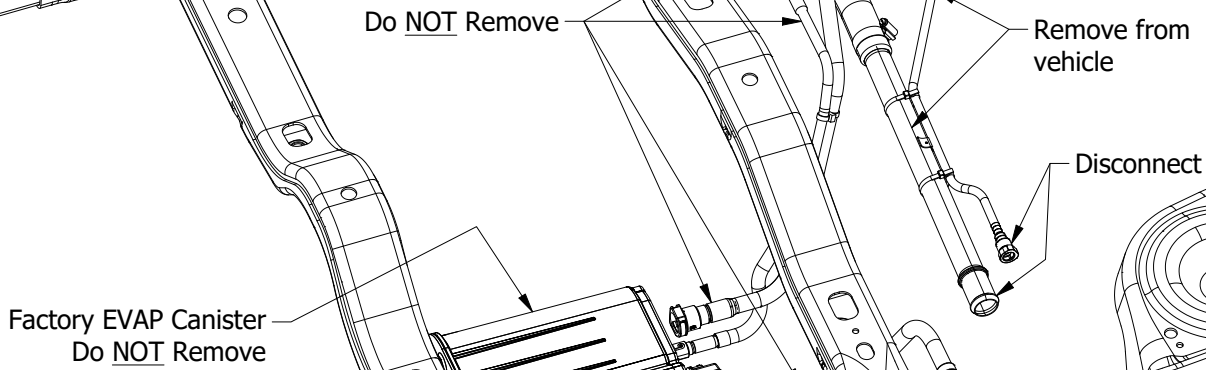

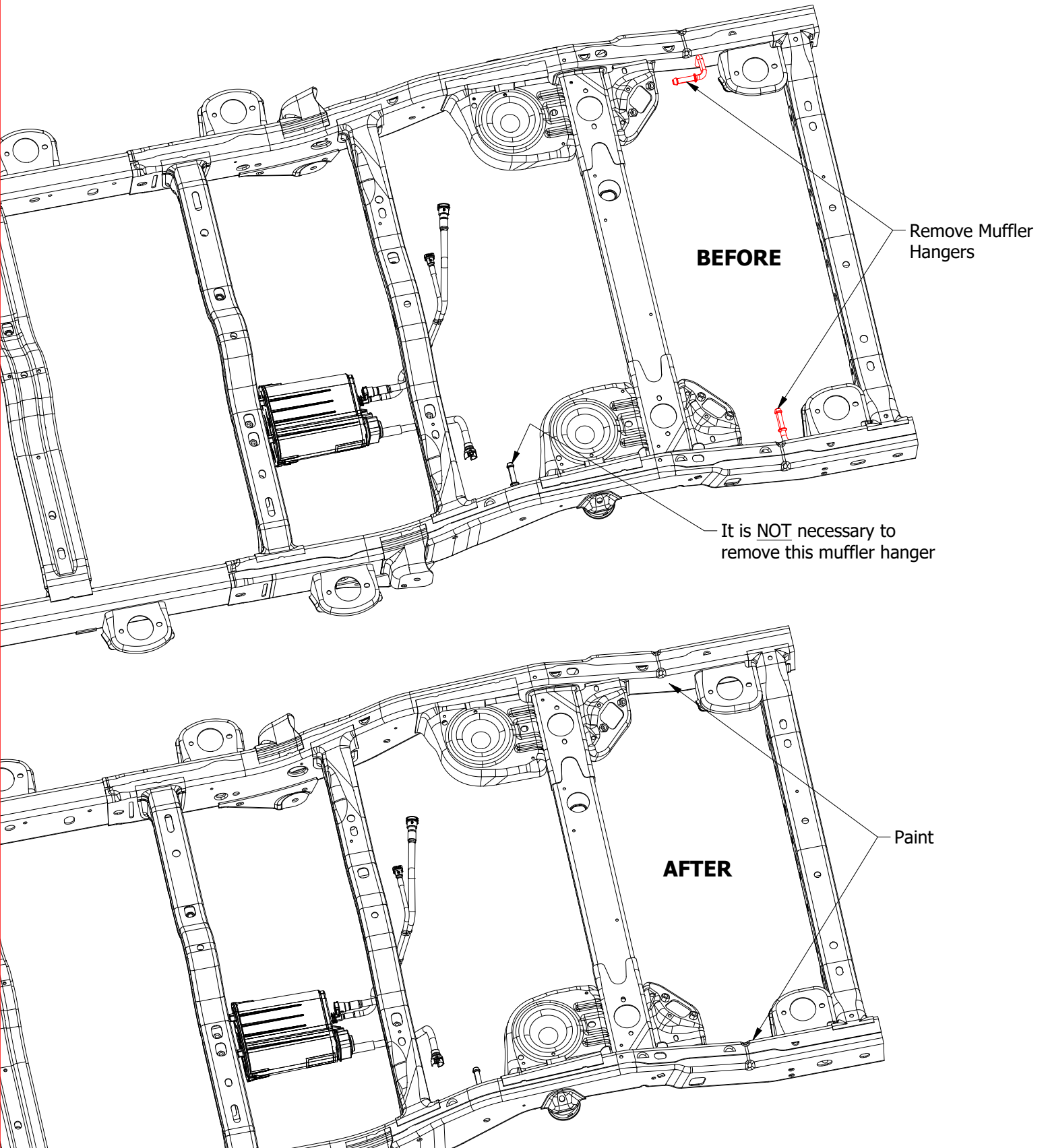
MB5032 - Assembly Instructions Rear Fuel Tank & Skid for Factory Frame**STEP 7
Remove Factory Muffler Hangers from Frame**

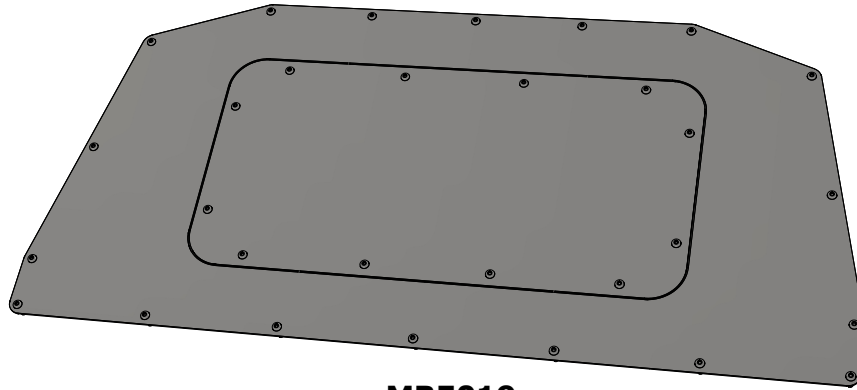
MB5032 - Assembly Instructions Rear Fuel Tank & Skid for Factory Frame**STEP 8
Cut Body (Optional)****MB5019
Fuel Cell Access Hatch Kit
(Sold Separately)**

If you want to have top access to the new MB5032 tank & it's fuel connections you may choose to cut an opening in the body located in the cargo bay area, then consider purchasing & installing our optional MB5019 Fuel Cell Access Hatch Kit. The MB5019 - Assembly Instructions will guide you through all of the steps to cutting an opening in the body & adding a removable cover.

This step is NOT required, but it is a great solution for convenient & quick access to your fuel connections without having to removed the tank.

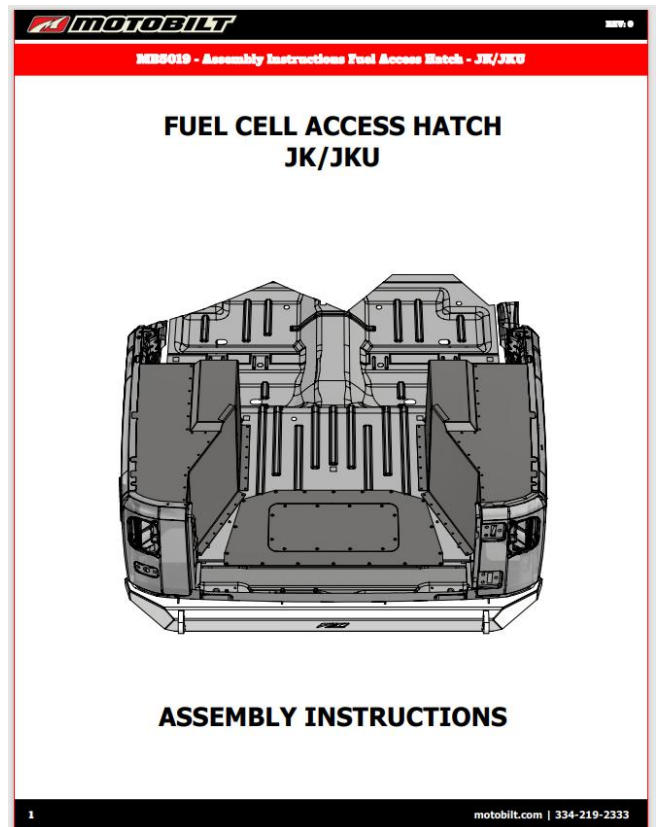
See MB5019 - Assembly Instructions

MB5034 - Assembly JKU Fuel Line & EVAP Modification**STEP 9
Drill Frame for Skid**

Use supplied 7/16" bolt
through factory hole in frame

1. Temporarily install skid where shown, using fasteners as indicated.
2. Mark passenger side frame where indicated.
3. Remove skid.
4. Drill 1/2" diameter hole through underside of frame.

Mark frame
here

Reuse Bolts
from Swaybar

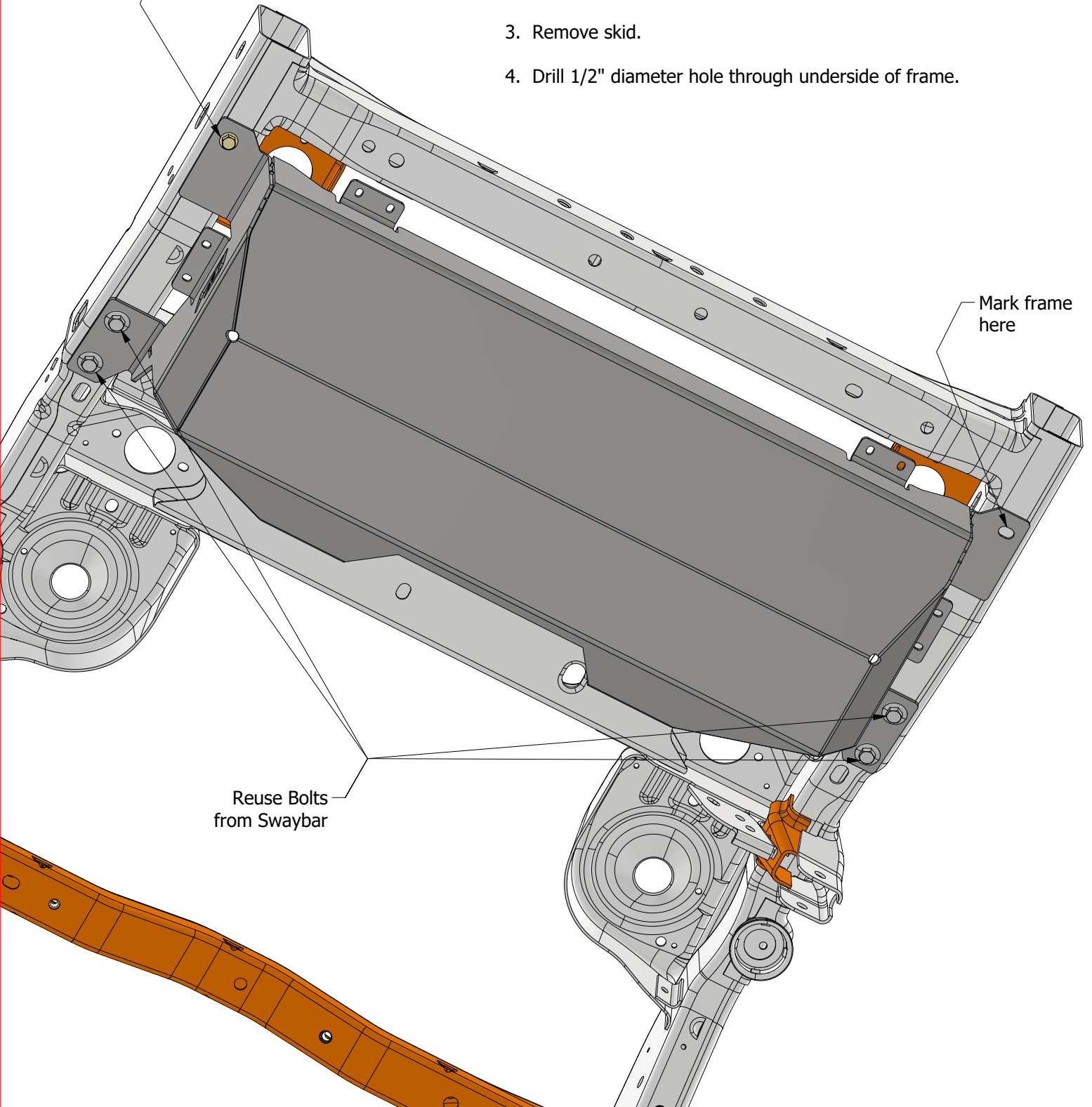

MB5032 - Assembly Instructions Rear Fuel Tank & Skid for Factory Frame

**STEP 10
Modify Fuel Sending Unit**

The factory fuel sending unit is too shallow to function with the MB5032 tank. This kit is included with the MB5032 tank & provides all of the components needed to extend the length of the factory fuel sending unit.

See MB5015 - Assembly Instructions

MOTOBILT REV: 0

MB5015 - Assembly Instructions JK/JKU Fuel Sending Unit Extension Kit

ASSEMBLY INSTRUCTIONS

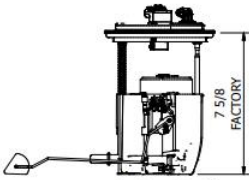

7 5/8
FACTORY

Factory Depth

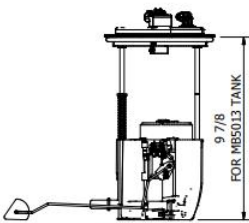

9 7/8
FOR MB5013 TANK

MB5015 Cut for MB5013 Tank Depth

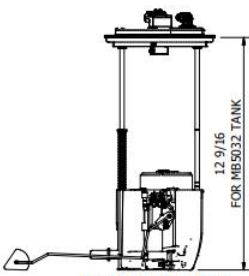

12 9/16
FOR MB5032 TANK

MB5015 Uncut for MB5032 Tank Depth

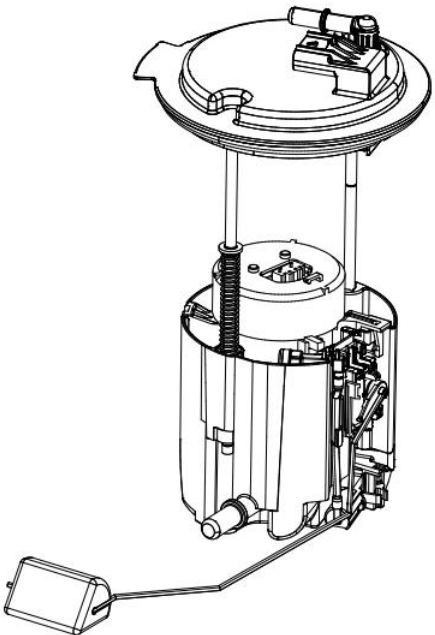

These instructions are intended to extend the physical length of the factory fuel sending unit by changing the rod lengths, extend the wiring & reuse many of the factory components of the fuel sending unit to function with different depths of Motobilt brand of aluminum tanks.

motobilt.com | 334-219-2333

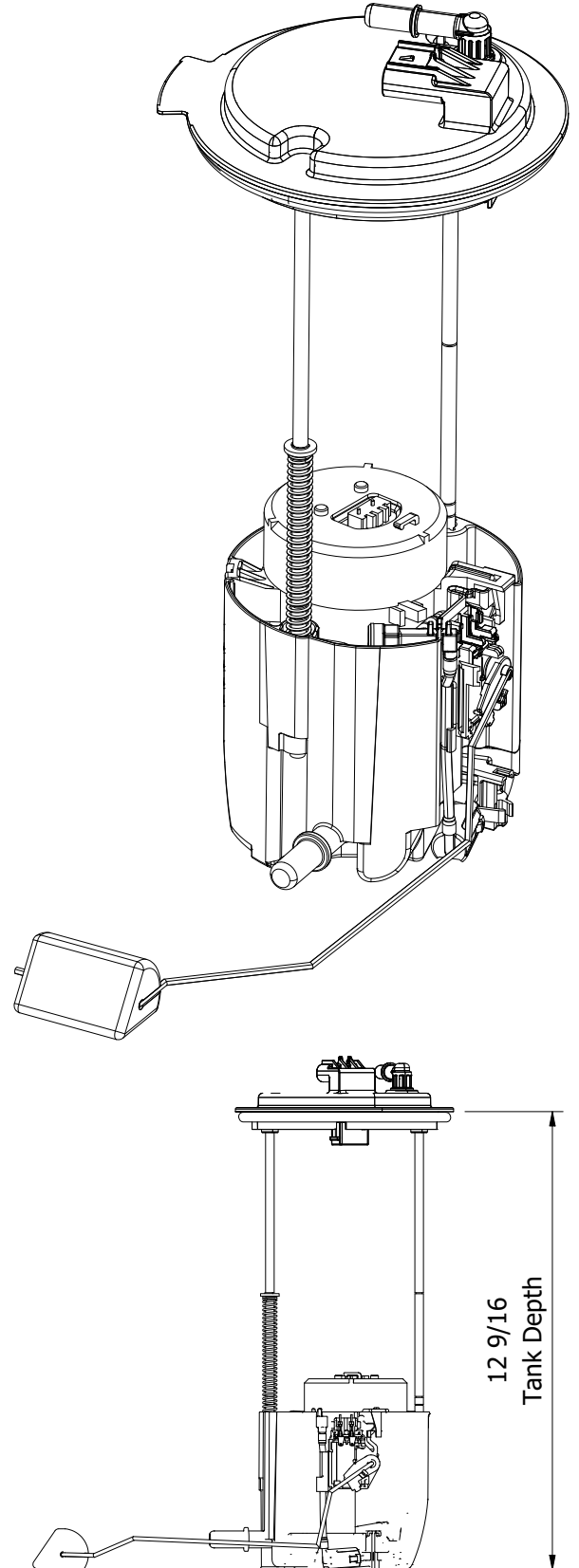

MB5032 - Assembly Instructions Rear Fuel Tank & Skid for Factory Frame

STEP 11
Add Rubber Strips to Skid

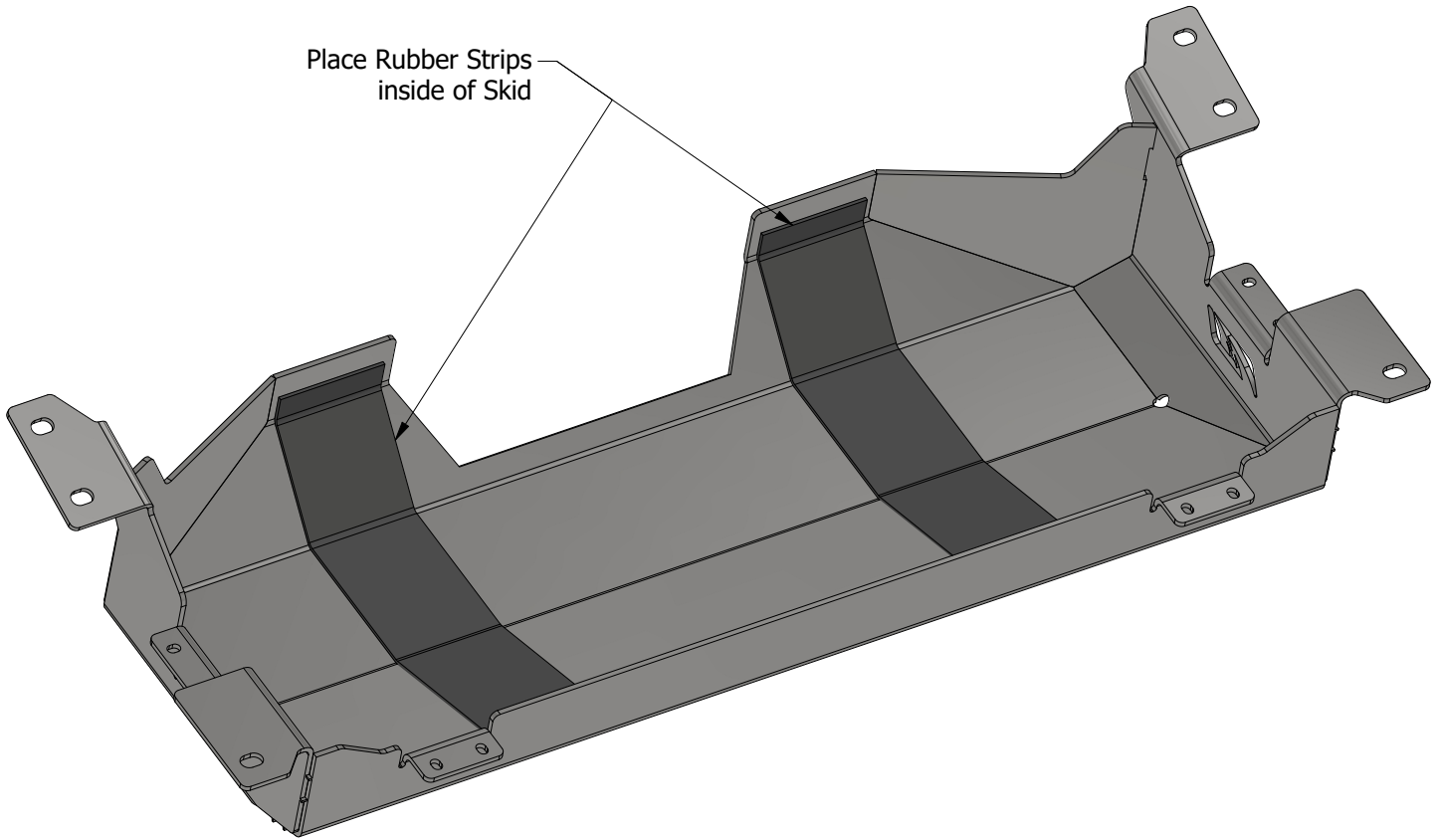

Place Rubber Strips
inside of Skid



Rubber Strip
Qty 2

MB5032 - Assembly Instructions Rear Fuel Tank & Skid for Factory Frame

**STEP 12
Assemble Aluminum Tank**

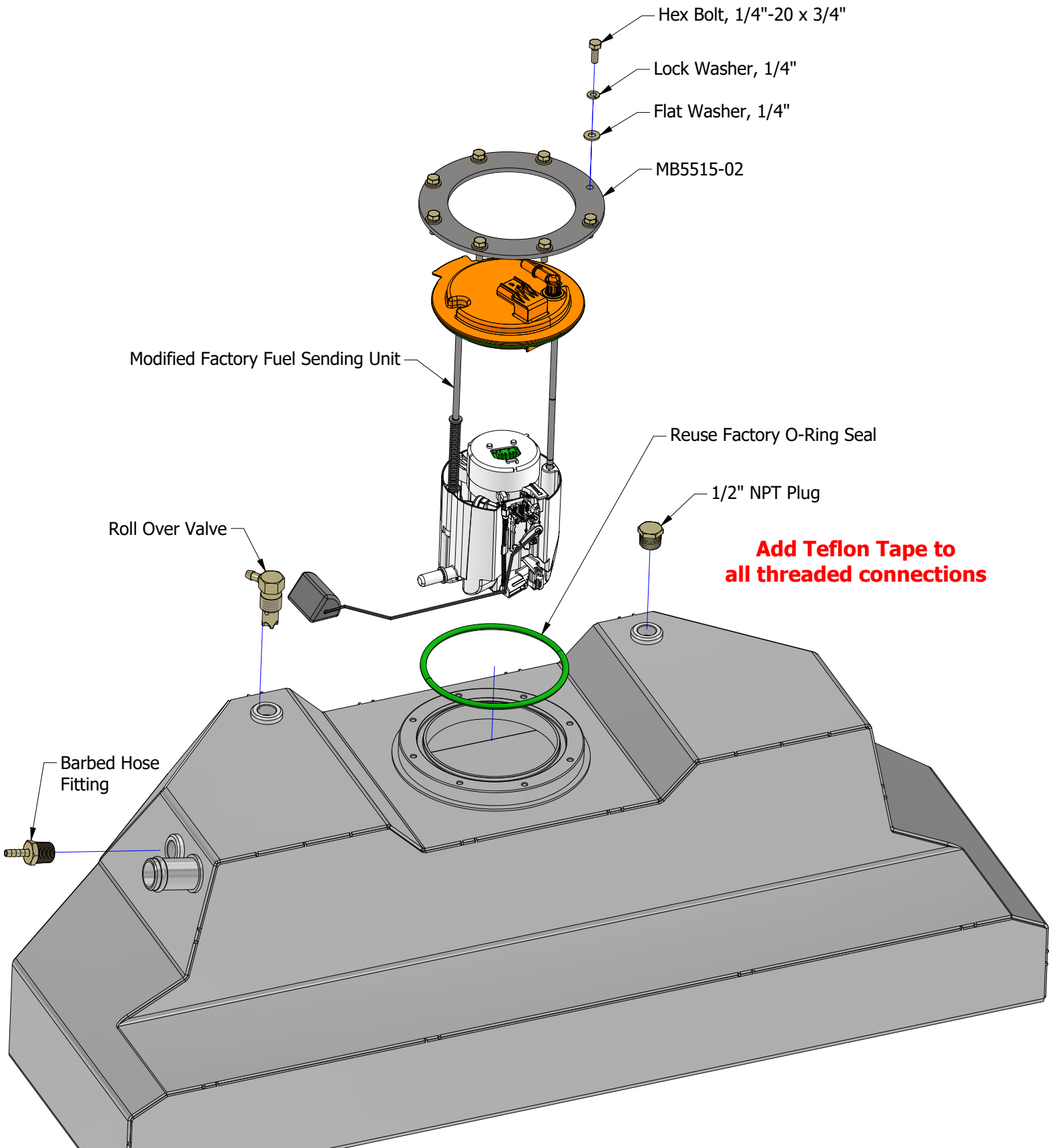

MB5032 - Assembly Instructions Rear Fuel Tank & Skid for Factory Frame

STEP 13
Assemble Tank with Skid

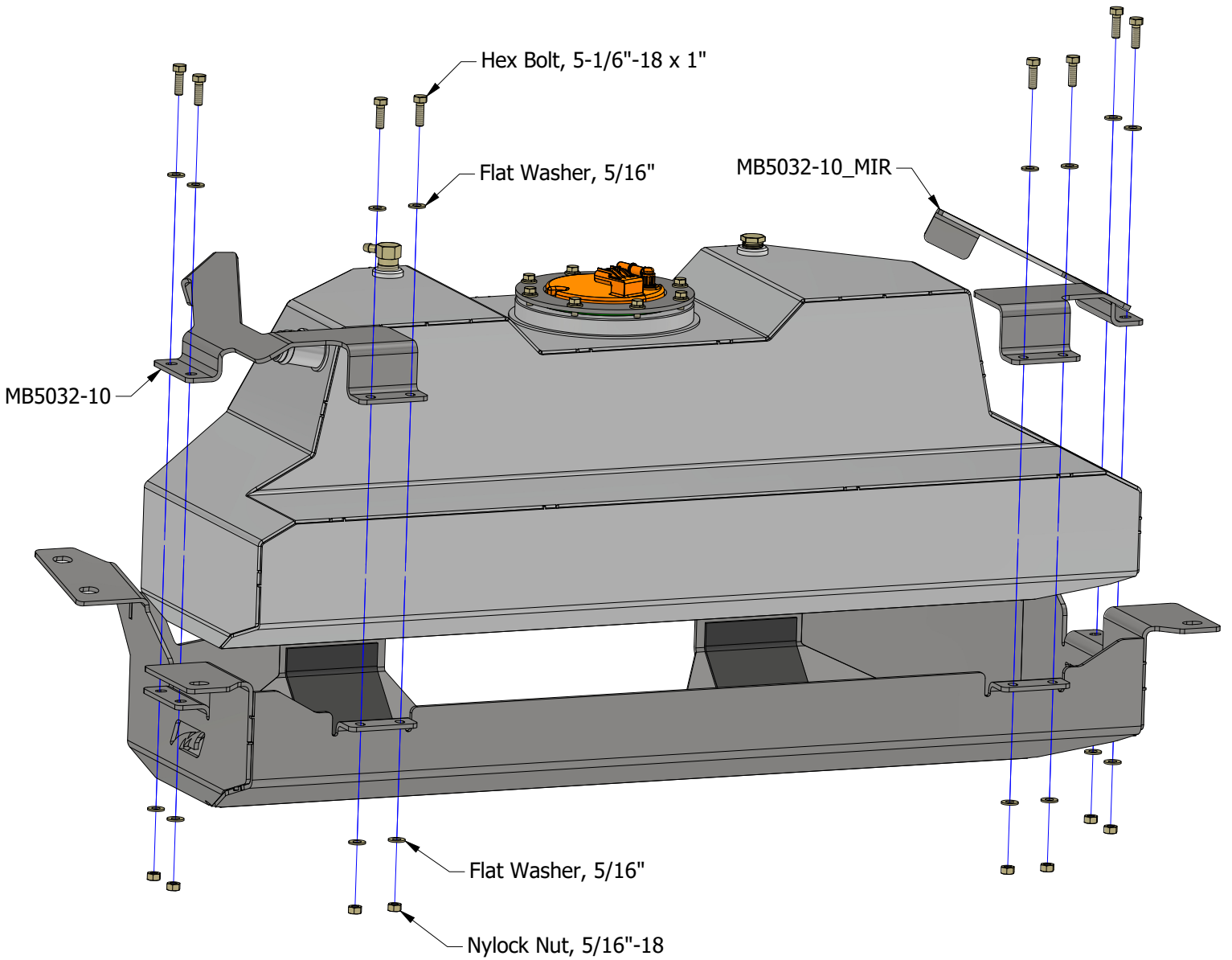

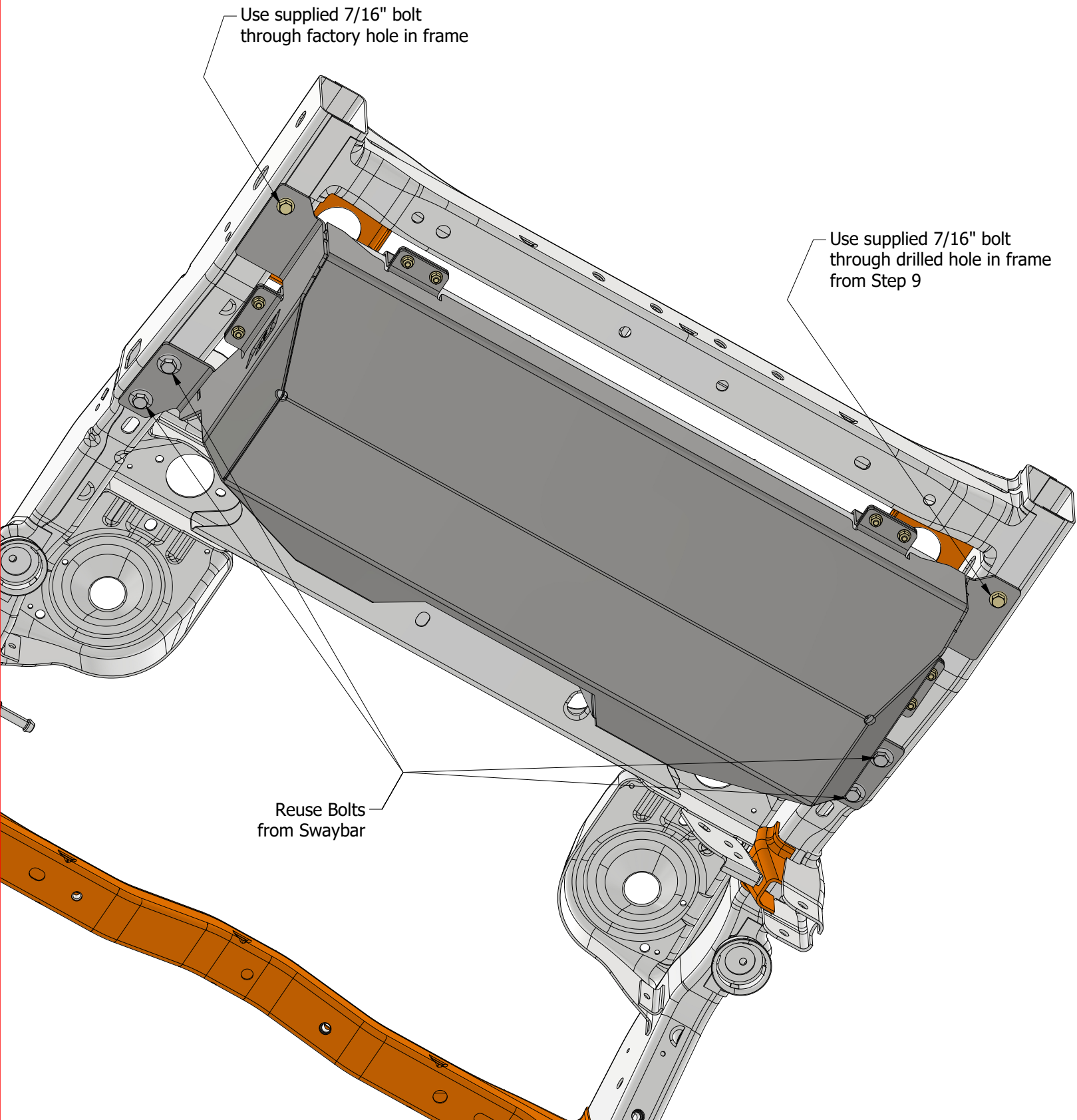
MB5032 - Assembly Instructions Rear Fuel Tank & Skid for Factory Frame**STEP 14A**
Install Tank & Skid to Factory Frame

MB5032 - Assembly Instructions Rear Fuel Tank & Skid for Factory Frame

STEP 14B
Modified Frame for Frame Chop Kit MB1081



See MB1081 - Assembly Instructions

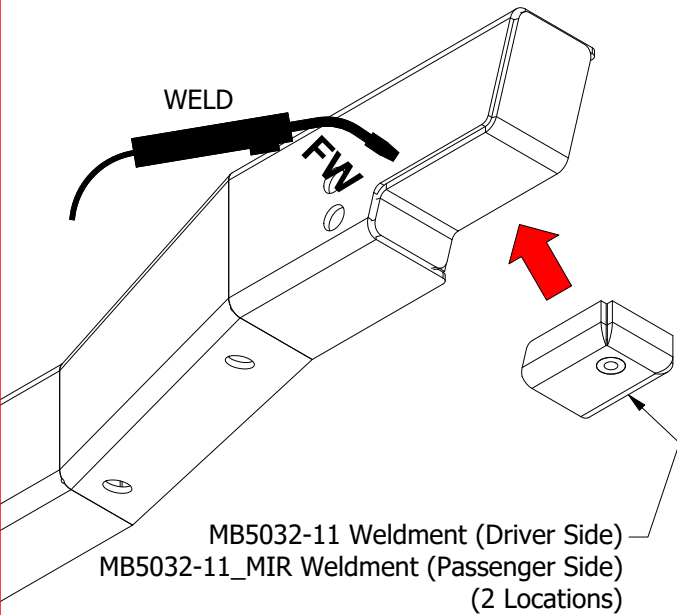

MOTOBILT

FRAME CHOP REAR BUMPER AND CROSS MEMBER FOR JEEP JK / JKU

#MB1081 JK FRAME CHOP REAR BUMPER QTY: 1

#MB302 FRAME CHOP REAR CROSS MEMBER QTY: 1

#MB5032-255 FRAME CUTTING JOG QTY: 1

HEX BOLT 7/16 x 1" GR 8 ZINC QTY: 3

FLAT WASHER 7/16" QTY: 3

#MB5032-12 FRAME RAIL CAP QTY: 2

1 motobilt.com | 334-219-2333

MB5032 - Assembly Instructions Rear Fuel Tank & Skid for Factory Frame

STEP 15
Modify EVAP & Fuel Filler (Optional)

REUSE PARTS FROM STEP 6

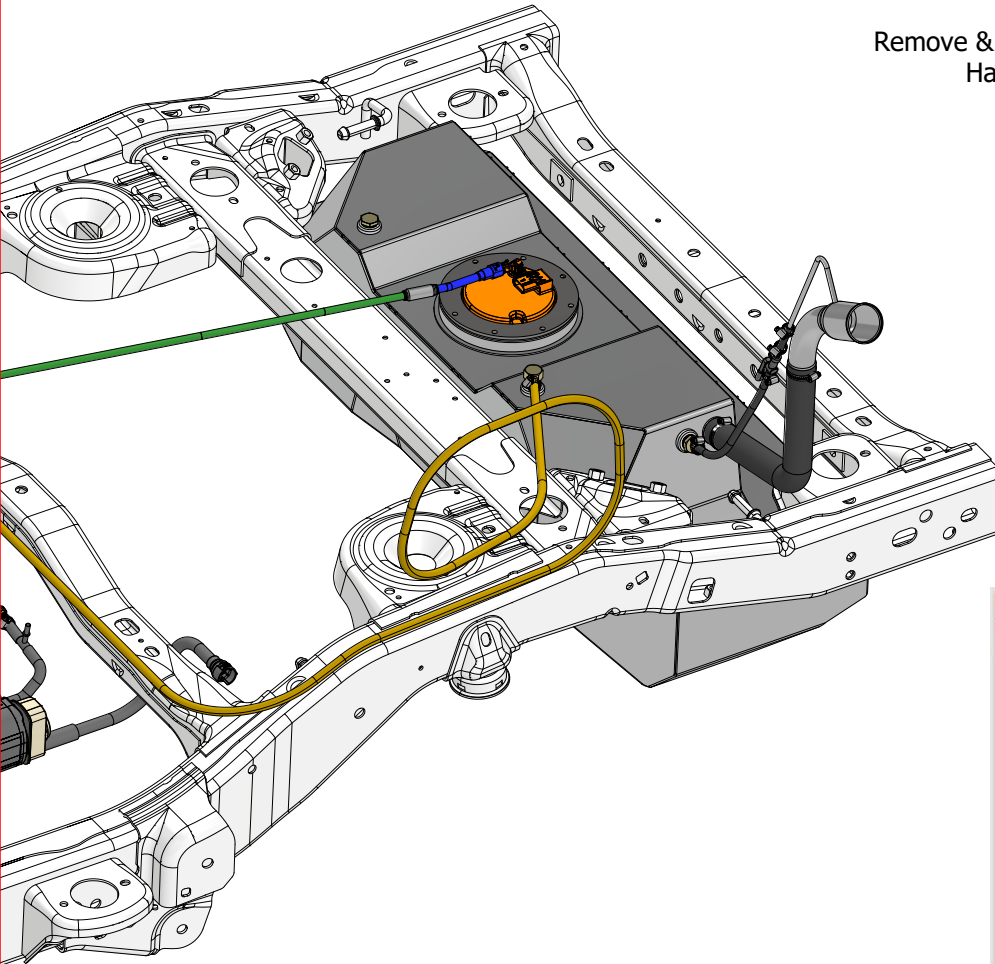
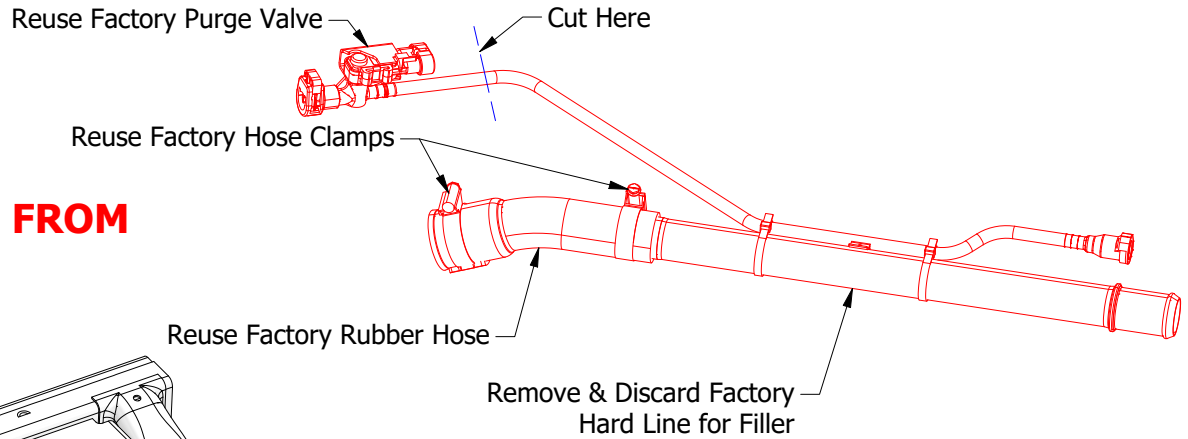

See MB5034 - Assembly Instructions

MOTOBILT REV: 0

MB5034 - Assembly JKU Fuel Line & EVAP Modification

Jeep JKU Fuel Line & EVAP Modification

These instructions are compatible with Jeep JKU 2007 thru 2011 with that factory year of EVAP Canister & factory EVAP hoses. These instructions show you how to make modifications to your EVAP, fuel lines & 12 volt electrical to be compatible with our MB5032 Jeep JKU Rear Aluminum Tank System or similar aftermarket fuel tank.

1

motobilt.com | 334-219-2333

If you want your EVAP & emissions to function using your factory engine, then consider purchasing & installing our MB5034 JK/JKU Fuel Line & EVAP Modification kit (sold separately).

If you are using an aftermarket engine without EVAP & emissions, then you can omit this step. You can still modify your factory fuel filler & hose components. Use MB5034 - Assembly Instructions as a guide for modifying your fuel filler hose.