

MB5015 - Assembly Instructions JK/JKU Fuel Sending Unit Extension Kit**ASSEMBLY INSTRUCTIONS****Factory Depth****MB5015 Cut for
MB5013 Tank Depth****MB5015 Uncut for
MB5032 Tank Depth**

These instructions are intended to extend the physical length of the factory fuel sending unit by changing the rod lengths, extend the wiring & reuse many of the factory components of the fuel sending unit to function with different depths of Motobilt brand of aluminum tanks.

MB5015 - Assembly Instructions JK/JKU Fuel Sending Unit Extension Kit

CONTENTS

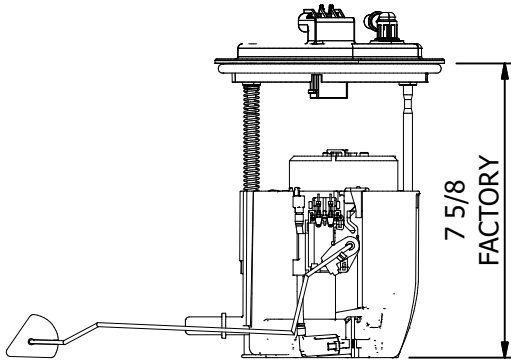
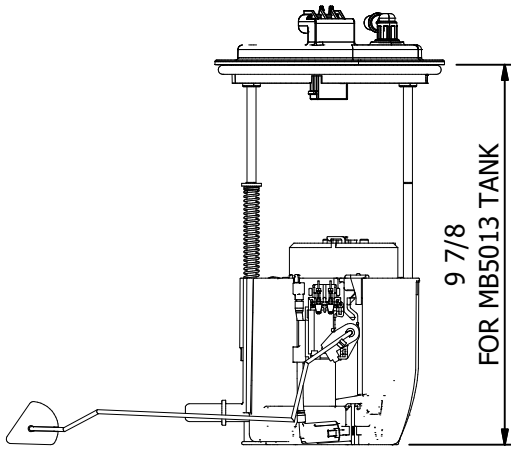
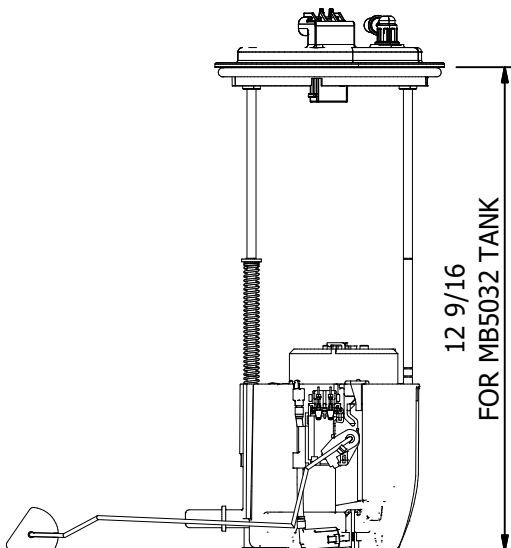
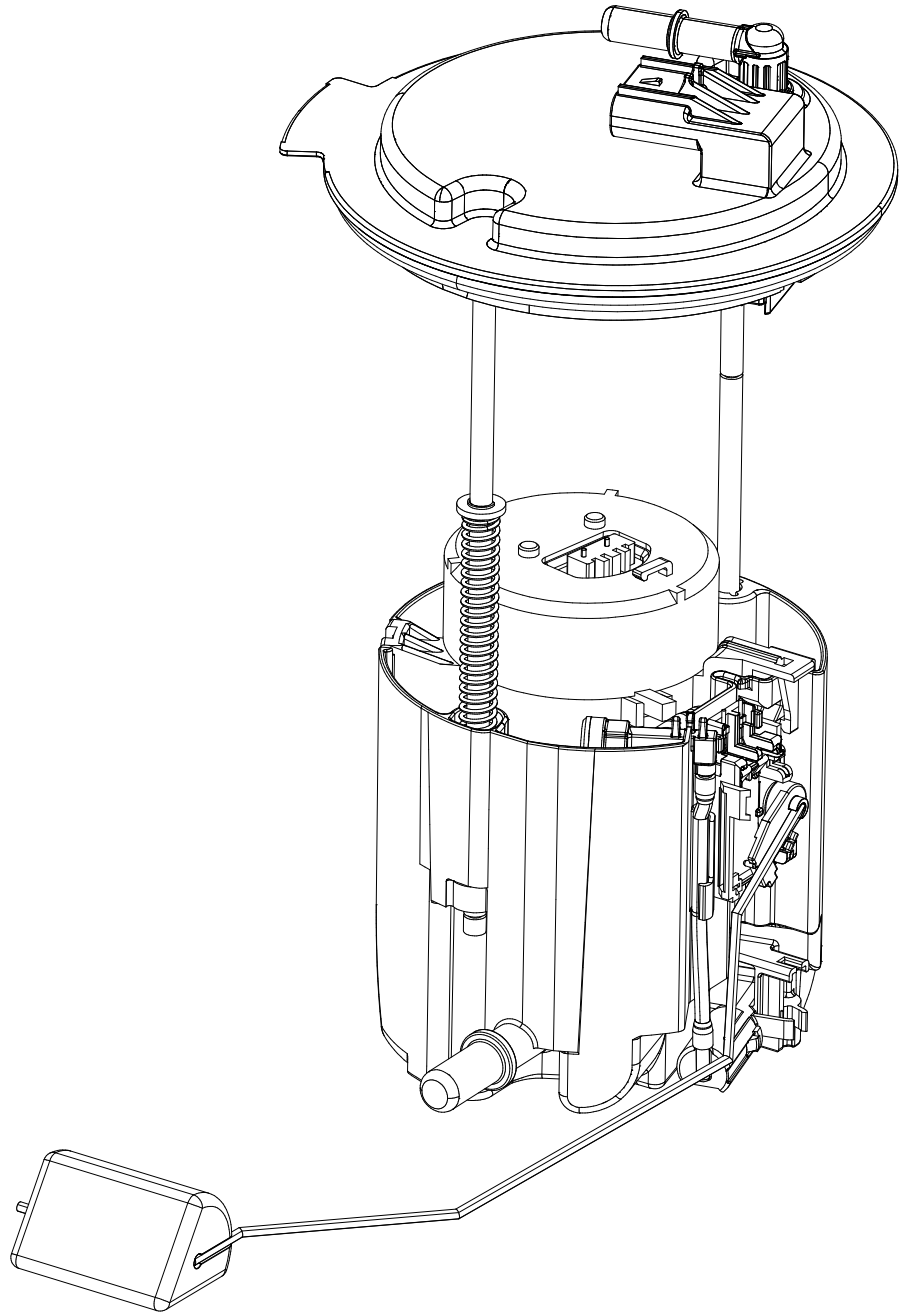
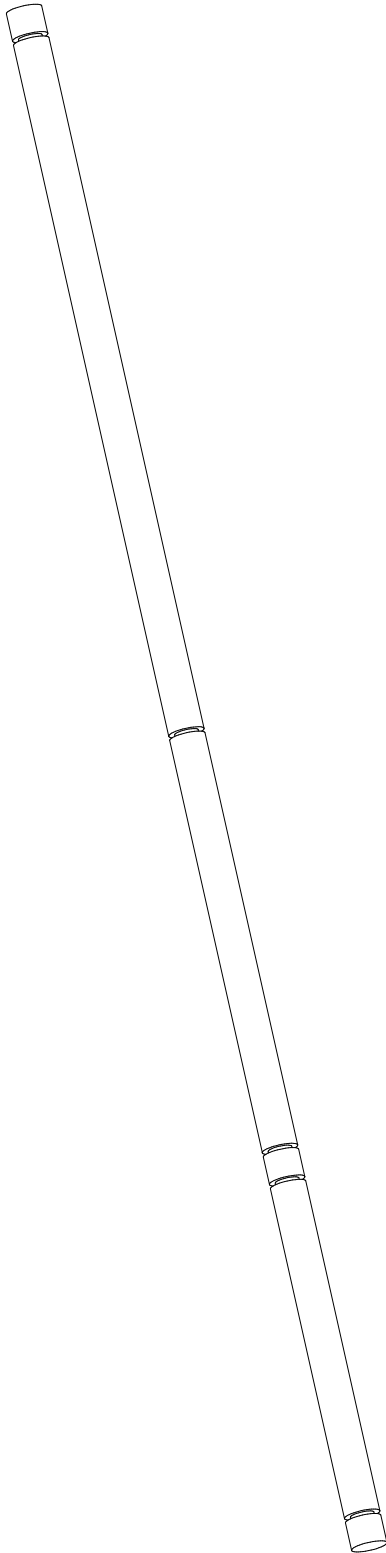

**MB5015
Qty 2**

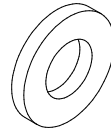

**Flat Washer
M6 Stainless
Qty 1**



**E-Clip
4 mm
Qty 4**

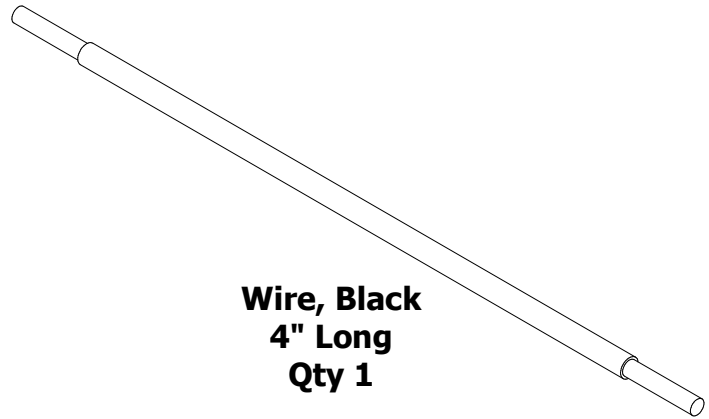

**Wire, Black
4" Long
Qty 1**

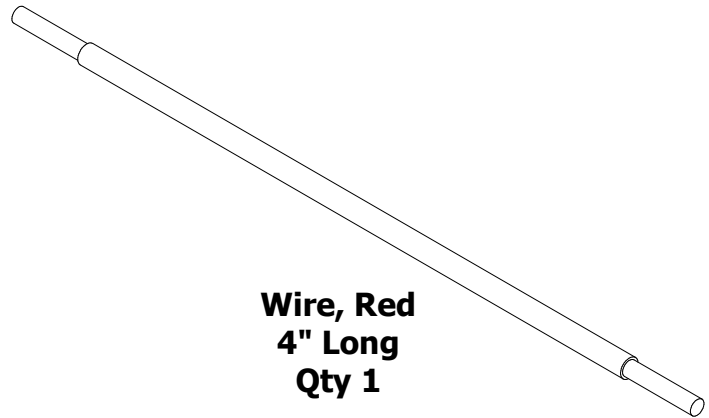

**Wire, Red
4" Long
Qty 1**

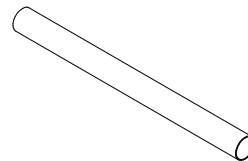

**Butt Connector, Pink
Qty 4**

MB5015 - Assembly Instructions JK/JKU Fuel Sending Unit Extension Kit

**STEP 1
Disassembly of Factory Fuel Sending Unit**

For an overview video of how to disassemble the factory fuel sending unit at MOTOBILT.COM, search for product "MB5015" & the video is in the Description

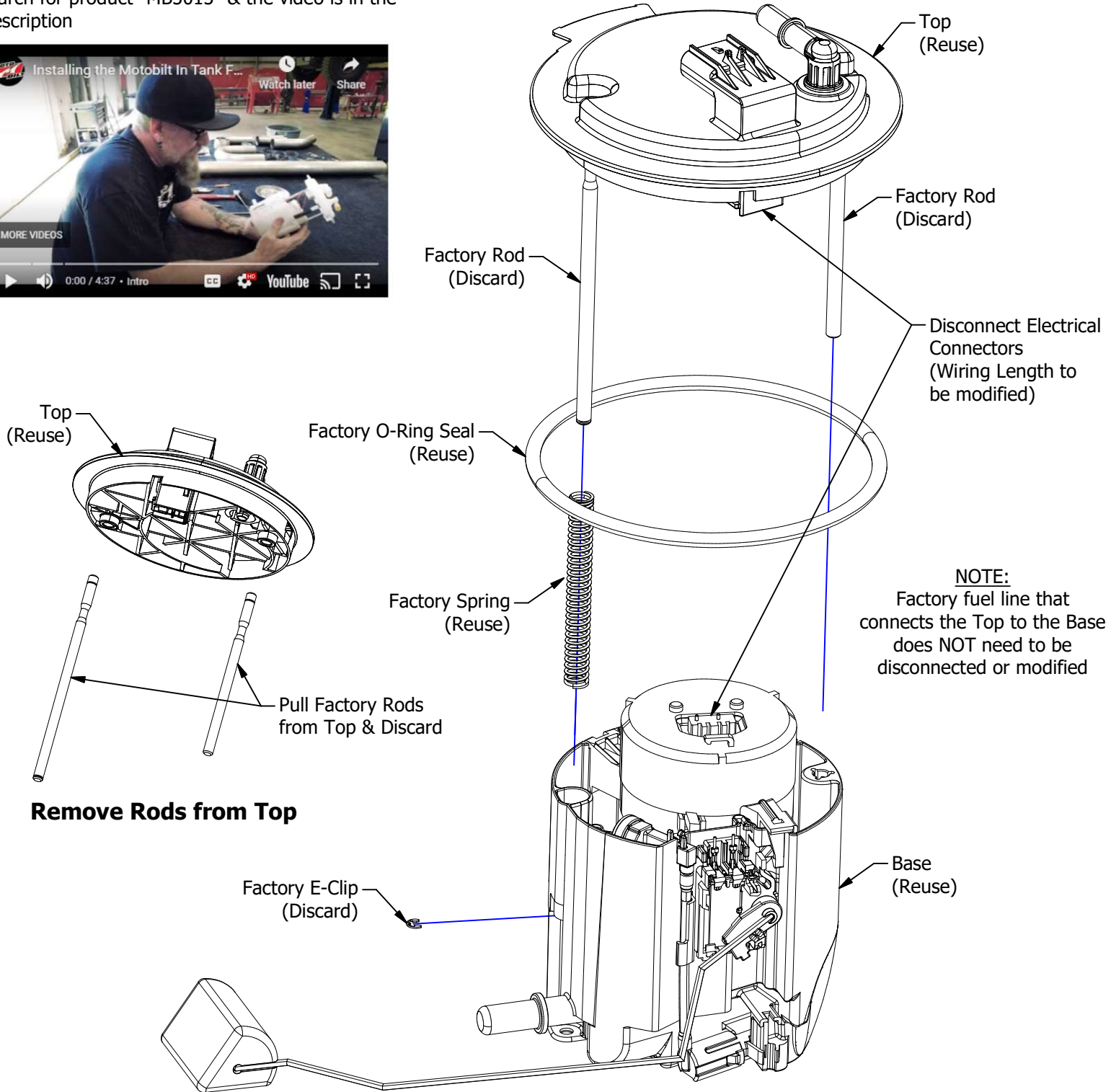
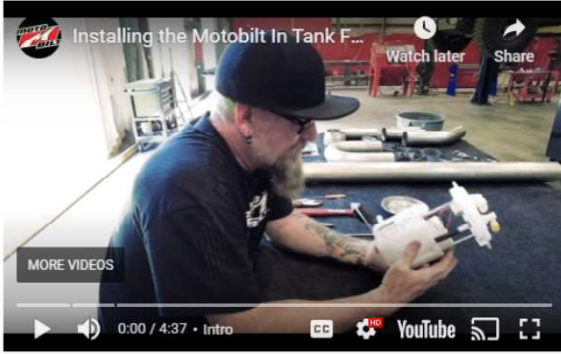

MB5015 - Assembly Instructions JK/JKU Fuel Sending Unit Extension Kit

STEP 2
Determine Motobilt Tank Model & Depth

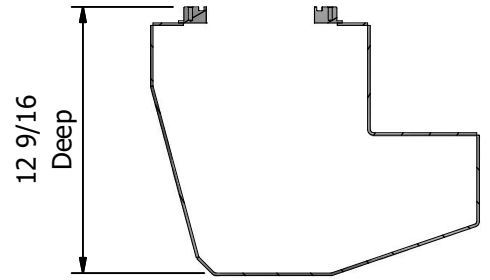
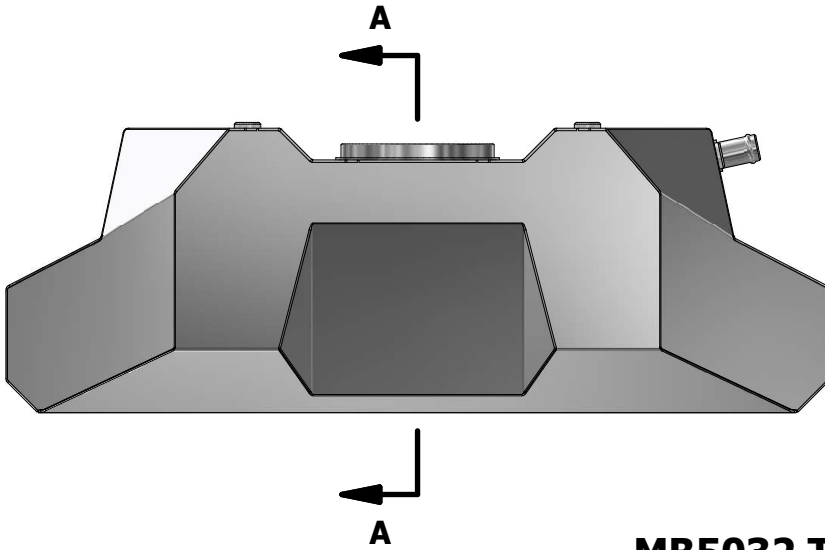

SECTION A-A

MB5032 TANK
GO TO STEP 3

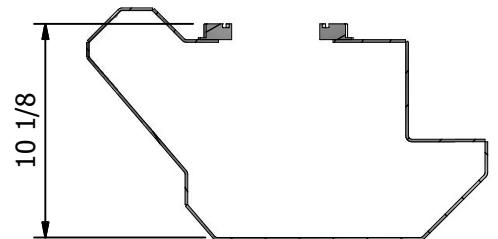
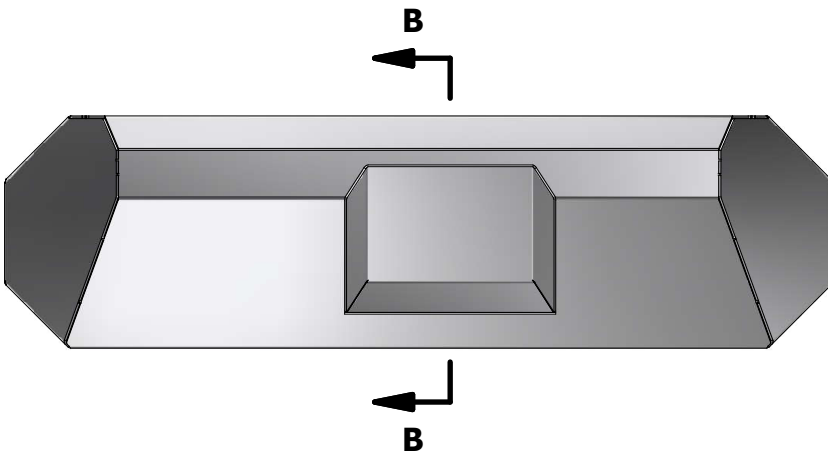

SECTION B-B

MB5013 TANK
GO TO STEP 4

MB5015 - Assembly Instructions JK/JKU Fuel Sending Unit Extension Kit

STEP 3

Modify Factory Fuel Sending Unit for MB5032 Tank Depth

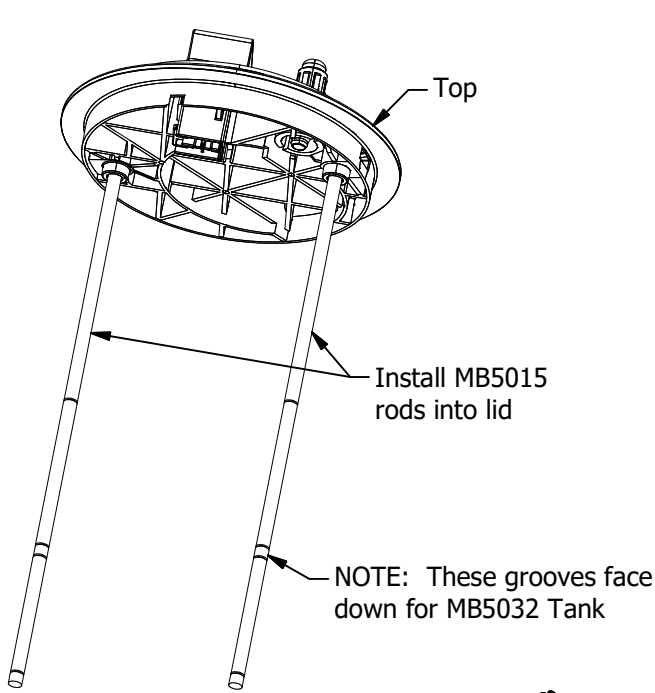

STEP 3A

NOTE: The E-Clip, Washer & Spring get installed with this orientation of the Top

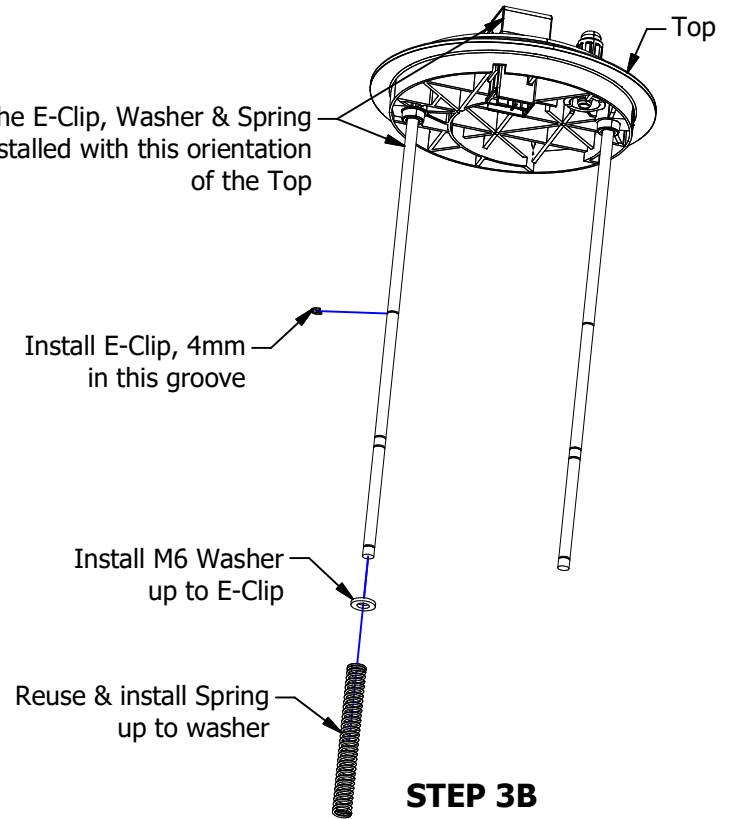

STEP 3B

Install Top assembly to holes in Base

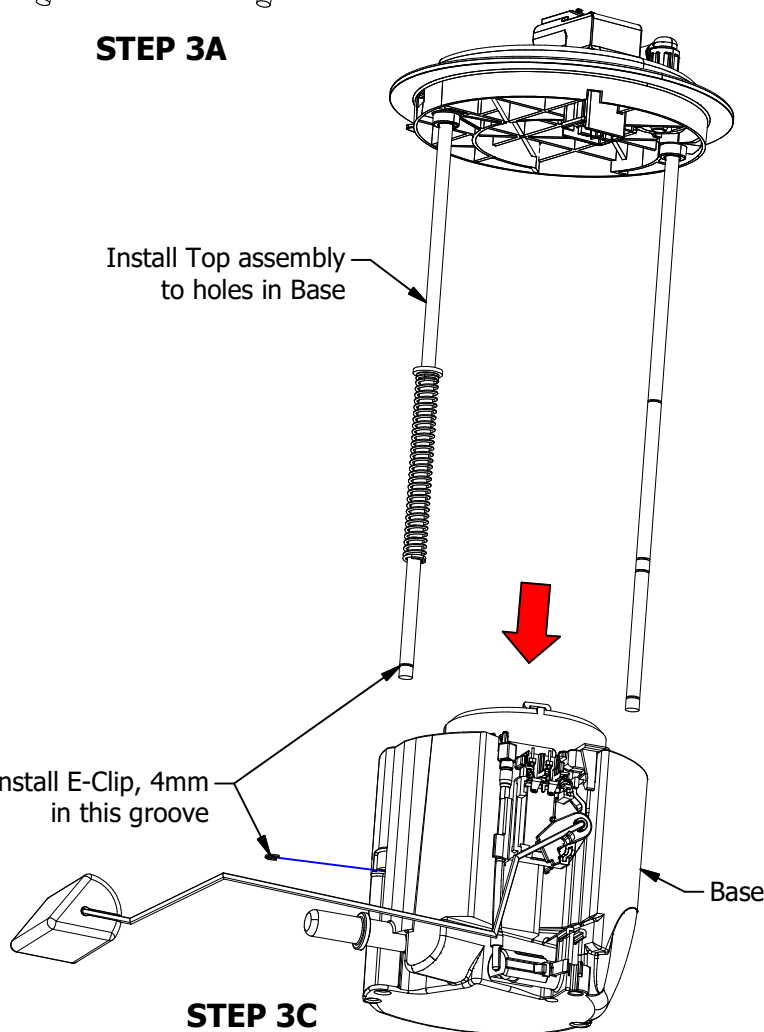

STEP 3C

Extend the wires that connect the Top to the Base using the supplied wires & butt connectors. Reconnect the modified wiring harness to the Top & Base.

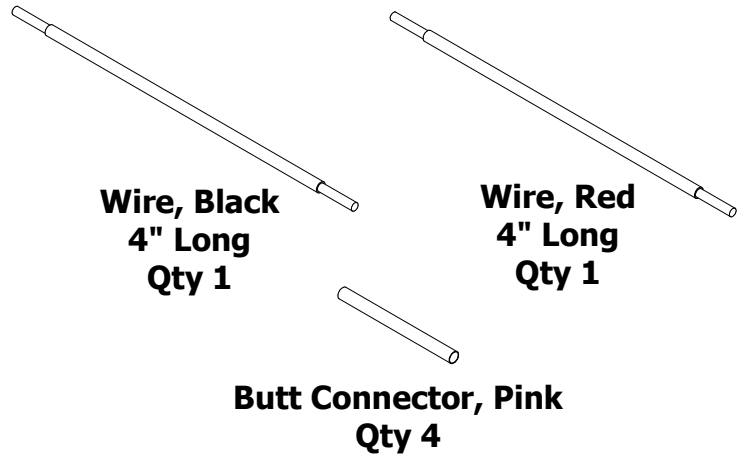

STEP 3D

MB5015 - Assembly Instructions JK/JKU Fuel Sending Unit Extension Kit

STEP 4
Modify Factory Fuel Sending Unit for MB5013 Tank Depth

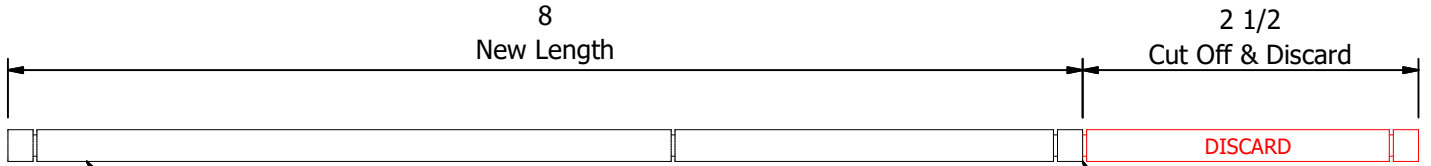

STEP 4A

NOTE: This will be referred to as the CUT END

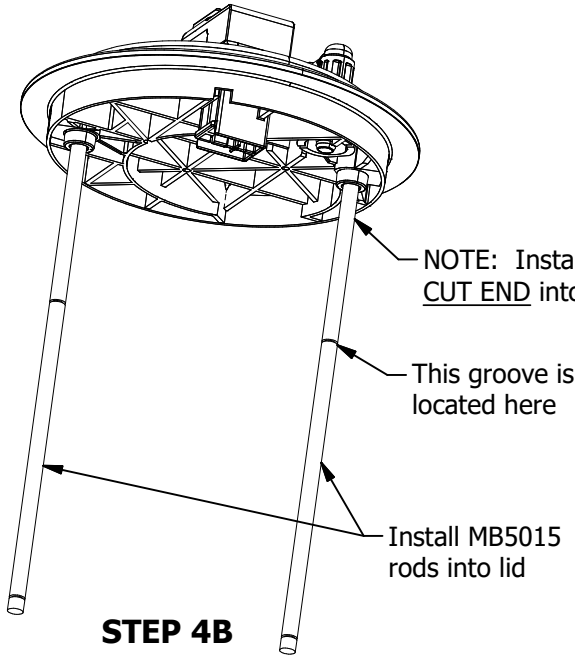

STEP 4B

NOTE: The E-Clip, Washer & Spring get installed with this orientation of the Top

Install E-Clip, 4mm in this groove

Install M6 Washer up to E-Clip

Reuse & install Spring up to washer

STEP 4C

Extend the wires that connect the Top to the Base using the supplied wires & butt connectors. Reconnect the modified wiring harness to the Top & Base.

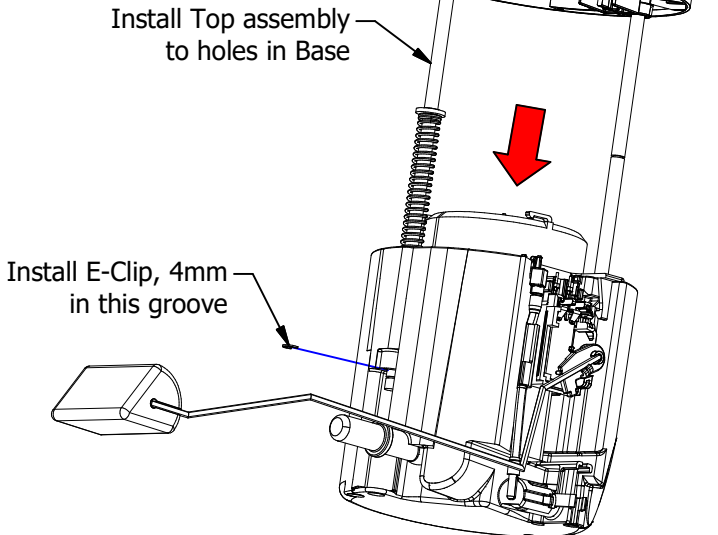

STEP 4D

Wire, Black 4" Long Qty 1

Wire, Red 4" Long Qty 1

Butt Connector, Pink Qty 4

STEP 4E