

**MB5013 - Assembly Instructions JKU Fuel Tank & Skid for Back Half Kit**

**CONTENTS**

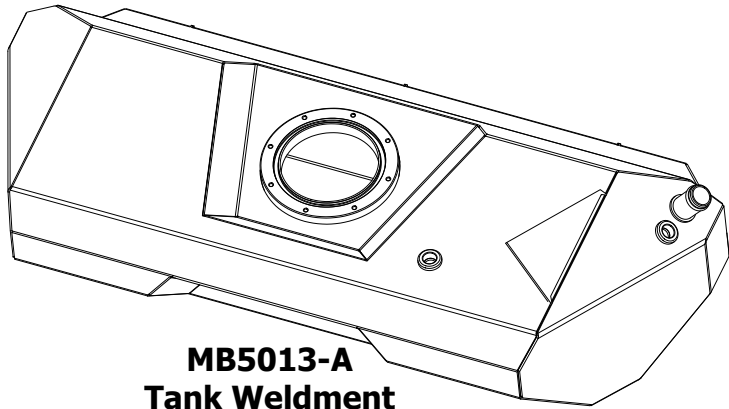

**MB5013-A  
Tank Weldment  
Qty 1**

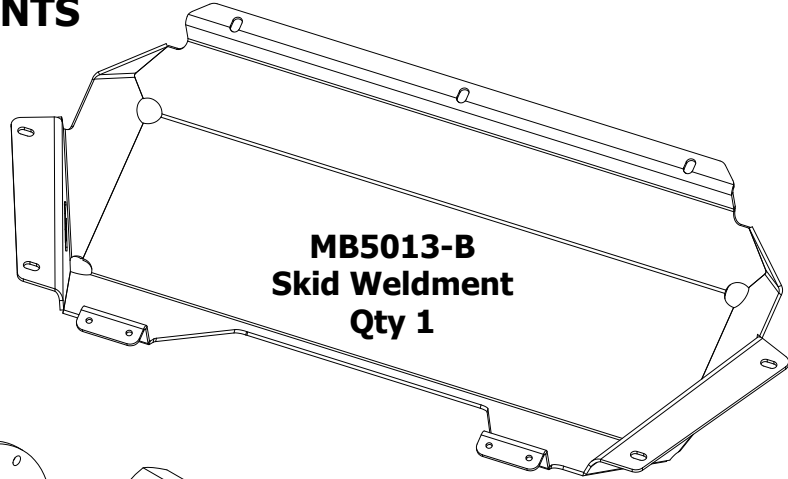

**MB5013-B  
Skid Weldment  
Qty 1**

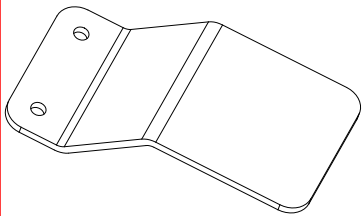

**MB5013-08  
Qty 2**

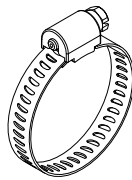

**STEP AP203  
Hose Clamp, 1-1/2"  
Qty 4**

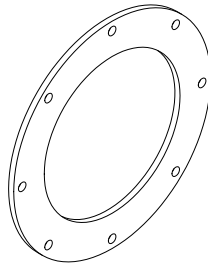

**MB5515-02  
Qty 1**

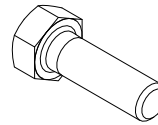

**Hex Bolt  
5/16"-18 x 1-1/4"  
Qty 4**



**Flat Washer  
5/16"  
Qty 8**



**Nylock Nut  
5/16"-18  
Qty 4**

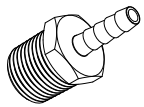

**Barbed Hose Fitting  
Qty 1**

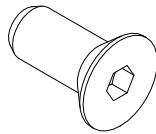

**Countersunk Screw  
7/16"-14 x 1"  
Qty 3**



**Flat Washer  
M6 Stainless  
Qty 1**

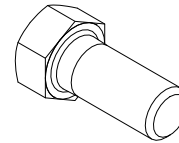

**Hex Bolt  
7/16"-14 x 1"  
Qty 7**

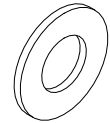

**Flat Washer  
7/16"  
Qty 7**

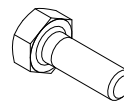

**Hex Bolt  
1/4"-20 x 3/4"  
Qty 8**



**Lock Washer  
1/4"  
Qty 8**



**Flat Washer  
1/4"  
Qty 8**

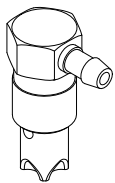

**Roll Over Valve  
Qty 1**

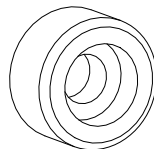

**Rubber Bumper  
1" OD x 7/16" ID without  
Flat Washer inside  
Qty 3**



**MB5015  
Fuel Pump Extension Rod  
Qty 2**



**E-Clip, 4mm  
Qty 4**



**Primary Wire, Black 4"  
Qty 1**



**Primary Wire, Red 4"  
Qty 1**

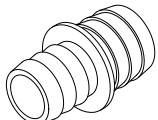

**Fuel Fill Reducer  
Qty 2**

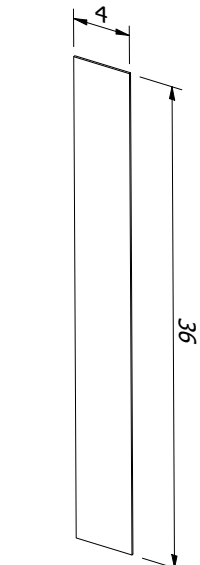

**Rubber Strip  
Qty 2**

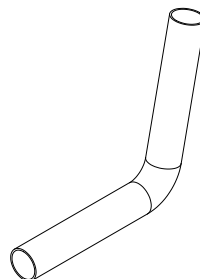

**90 Degree Rubber Hose, 1-1/2"  
Qty 1**



**Butt Connector, Pink  
Qty 4**