

MB5007 - FUEL PUMP CLAMPING RING KIT

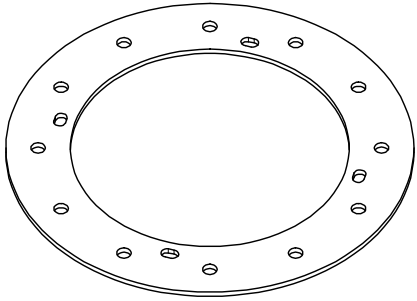

INSTALLATION INSTRUCTIONS

MB5007 - Installation Instructions Fuel Pump Clamping Ring Kit

MB5007-01
Qty: 1

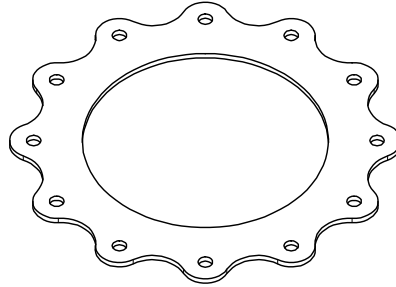

MB5007-02
Qty: 1

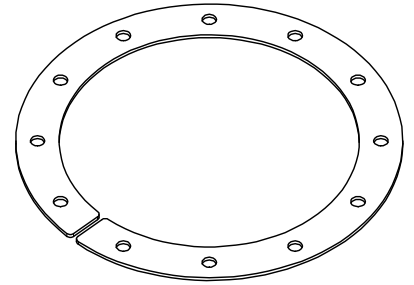

MB5007-03
Qty: 1

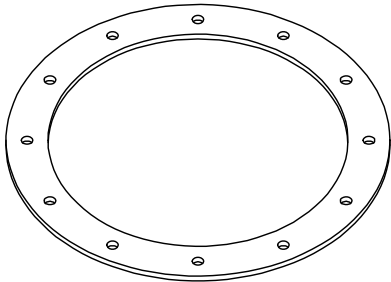

MB5007-GASKET
Qty: 1

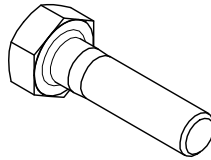

HEX BOLT
1/4"-28 x 1" GR.5
Qty: 12



NYLON WASHER
1/4"
Qty: 12



NYLOCK NUT
1/4"-28
Qty: 12

MB5007 - Installation Instructions Fuel Pump Clamping Ring Kit

NOTE

You can use this template to mark your holes, but confirm it is printed to scale first. Otherwise use the MB5007-01 and MB5007-02 welded assembly to mark the needed holes.

[12X] MARK AND DRILL
USING 5/16" DRILL BIT

MARK AND DRILL
USING 5-1/4" HOLE SAW

7 3/16
CONFIRM TEMPLATE MEASUREMENT BEFORE PROCEEDING

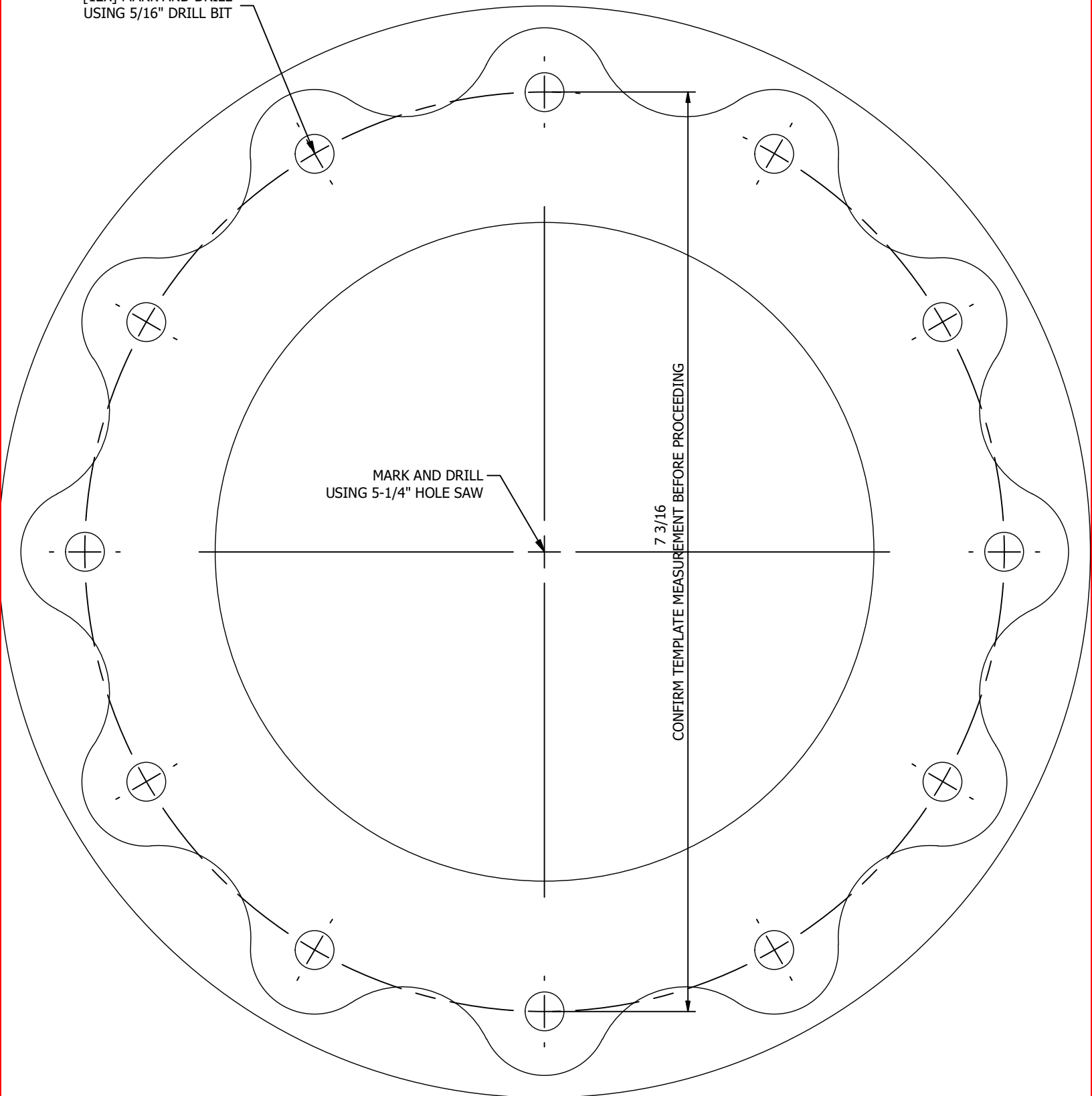

MB5007 - Installation Instructions Fuel Pump Clamping Ring Kit

NOTE

If your fuel cell does not have access inside to reach the Nylock nuts, you can tack weld the 1/4"-28 bolts to MB5007-03 split ring so they are held in place when installing the pump

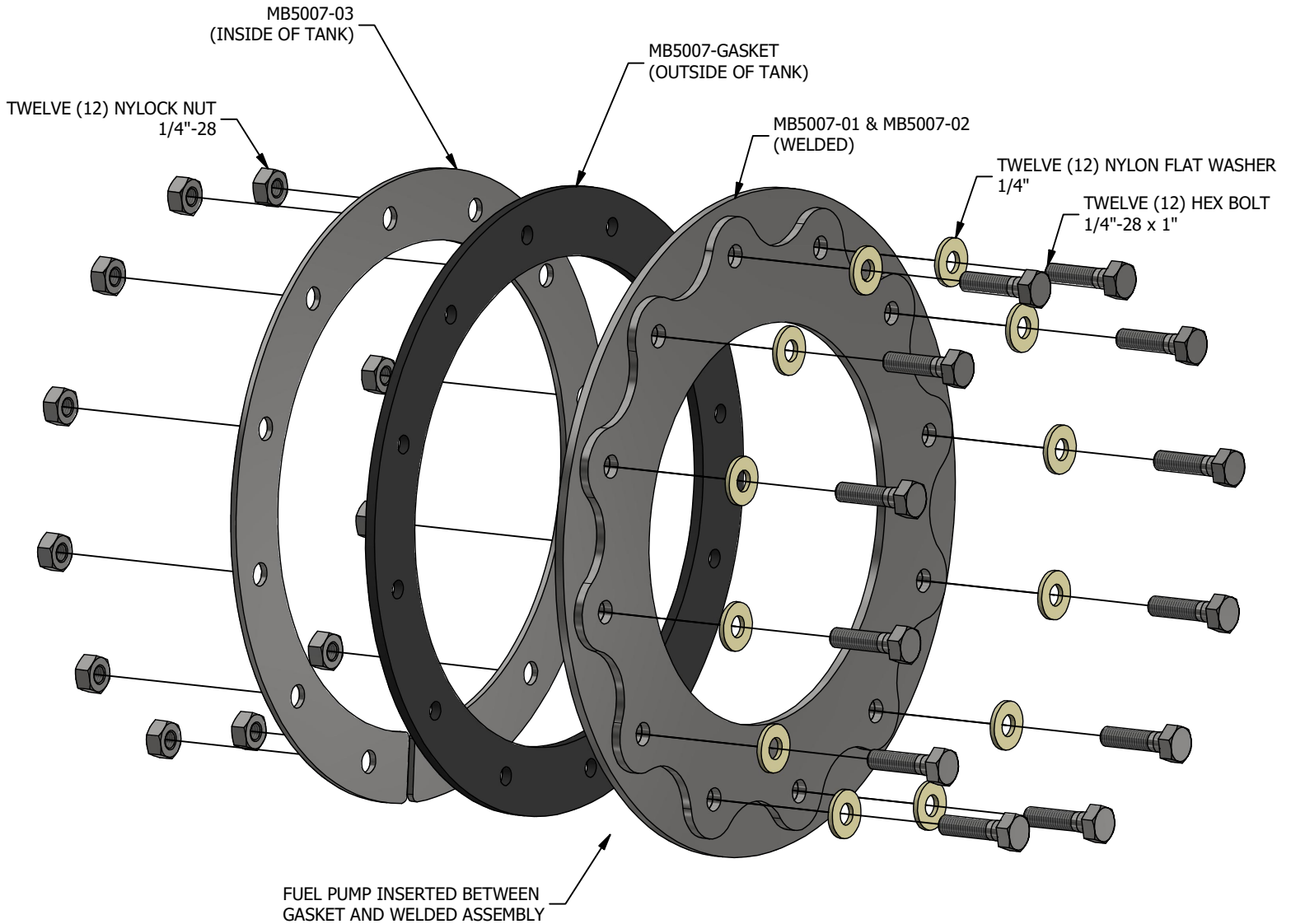

NOTE

We recommend using Permatex 80016 Form-AGasket #2 Sealant to seal the contact surfaces. This is a sealant we have used in the shop numerous times over the years for sealing filler caps on fuel cells. It can be sourced on the web or at your local parts store. Only use on the outside surface of the tank.