

MB4123 Trail Truss, Dana 80 w 4" Axle Tube

**TRAIL TRUSS**  
**FITS ECGS REAR DANA 80 1 TON AXLE**  
**WITH 4"Ø AXLE TUBES**

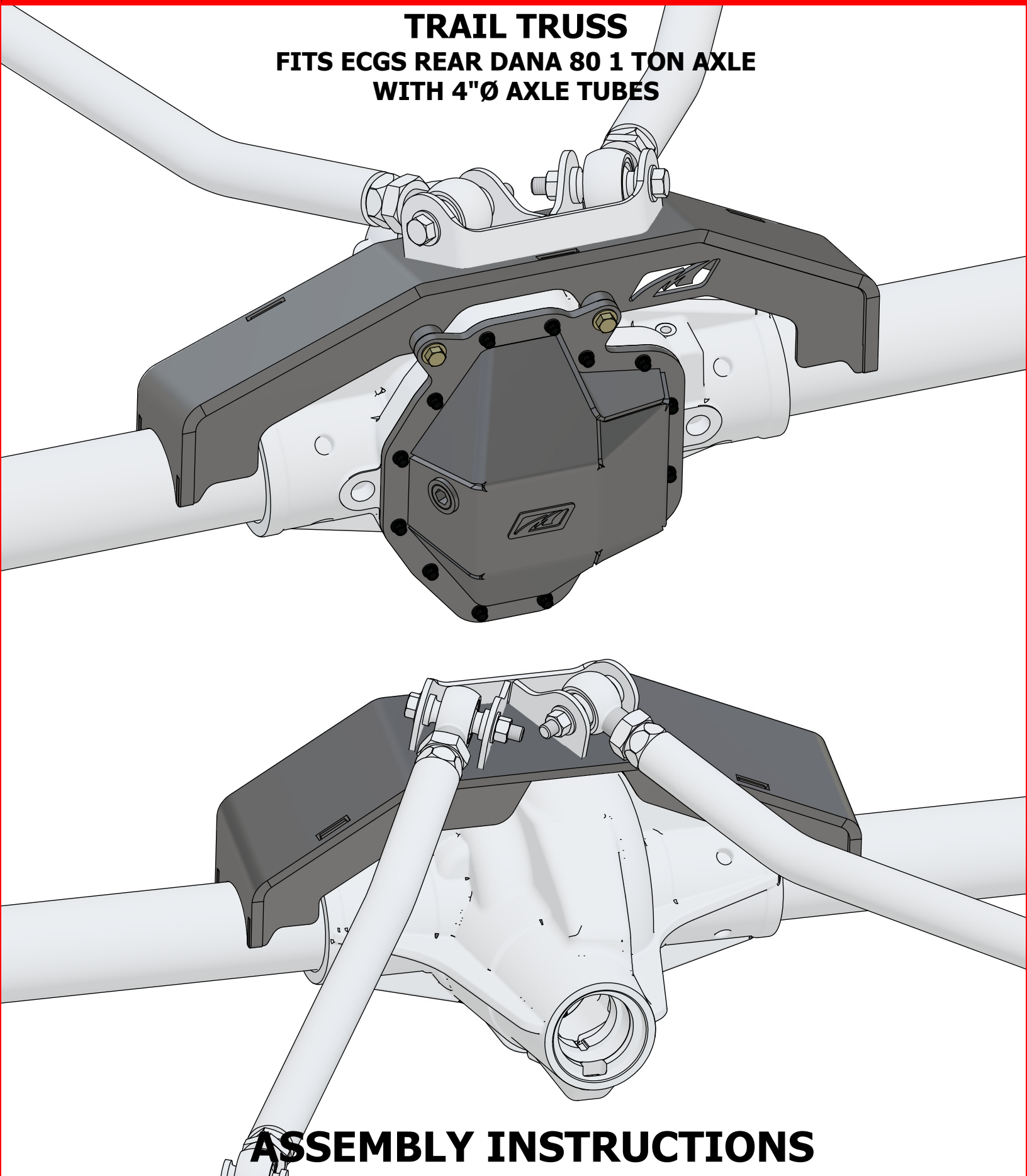

**ASSEMBLY INSTRUCTIONS**

## MB4123 Trail Truss, Dana 80 w 4" Axle Tube

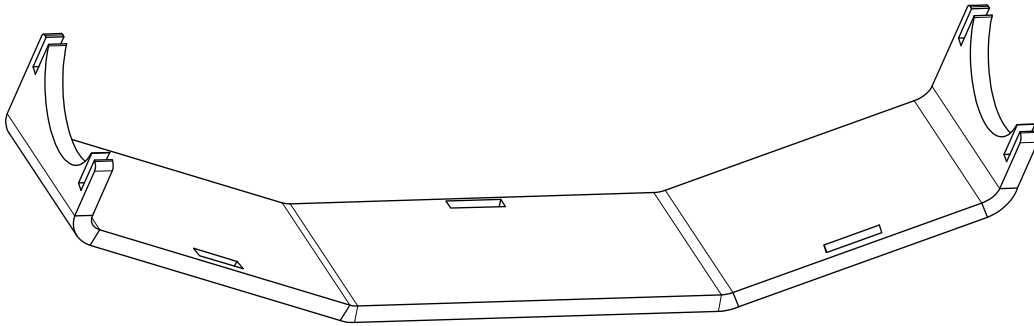
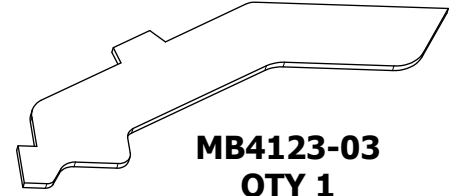
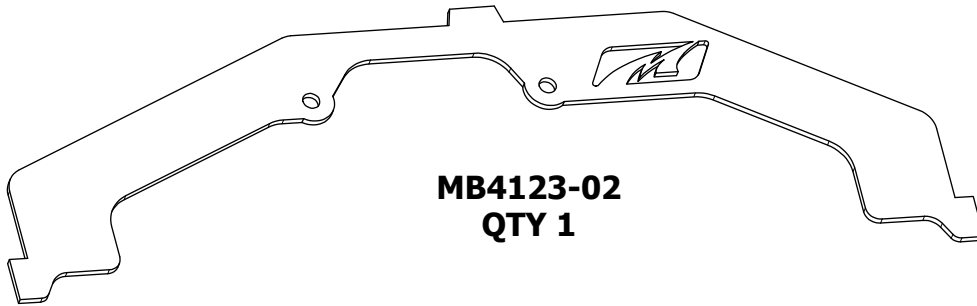
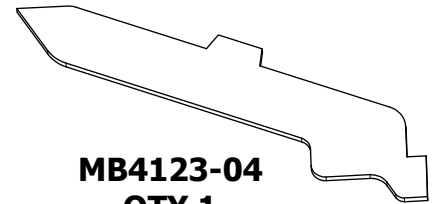
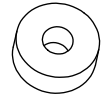
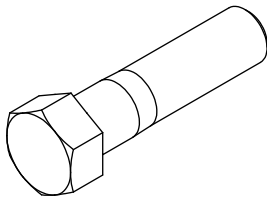
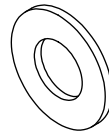
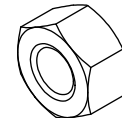
**CONTENTS****MB4123-01**  
QTY 1**MB4123-03**  
QTY 1**MB4123-02**  
QTY 1**MB4123-04**  
QTY 1**MB4123-05**  
QTY 2**HEX BOLT**  
 $\frac{7}{16}$ "-14 x 1- $\frac{3}{4}$ " LONG  
QTY 2**FLAT WASHER**  
 $\frac{7}{16}$ "  
QTY 4**NYLOCK NUT**  
 $\frac{7}{16}$ "-14  
QTY 2

## MB4123 Trail Truss, Dana 80 w 4" Axle Tube

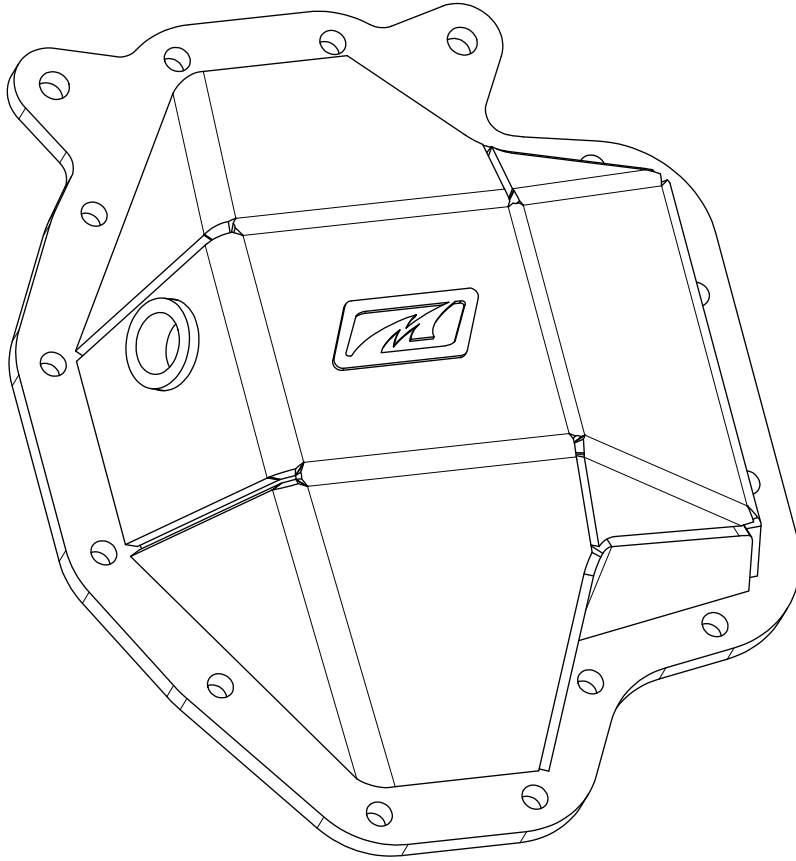
**CONTENTS**

**MB4125  
ECGS D80 DIFF COVER FOR MB4121  
QTY 1**

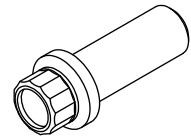

**12 POINT BOLT  
3/8"-16 x 1" LONG  
QTY 14**

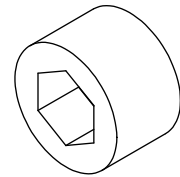

**THREADED BUNG  
FOR DIFF COVER  
QTY 1**

## MB4123 Trail Truss, Dana 80 w 4" Axle Tube

### PREFACE

This kit is specifically designed to work with a rear Dana 80 1 ton axle from East Coast Gear & Supply (ECGS). Contact ECGS for axle information & purchasing.

<https://eastcoastgearsupply.com/>

The function of this kit is to provide a heavy duty top flat mounting surface for you to install your own rear upper link mounts while also providing a physically bolted connection between the heavy duty diff cover & the trail truss to prevent the axle tubes from spinning within the cast differential housing.

We recommend the welding be performed by a qualified welder.

We recommend to tack weld & test fit all parts including your upper & lower link mounts by cycling your suspension from full bump to full extension, as well as, cycling each side of the axle with your tires installed. Check that all parts of the suspension function unimpeded. Once you are satisfied with the function of all components, disassemble the axle from the vehicle, fully weld all components included with this kit, then paint to your desired color.

For the purposes of these installation instructions, we only show how to install the components provided with this kit.

Protect all painted surfaces, glass, mirrors & trim from welding spatter using a fire proof blanket or similar protective masking. Have a fire extinguisher available.

**MB4123 Trail Truss, Dana 80 w 4" Axle Tube**

**STEP 1**

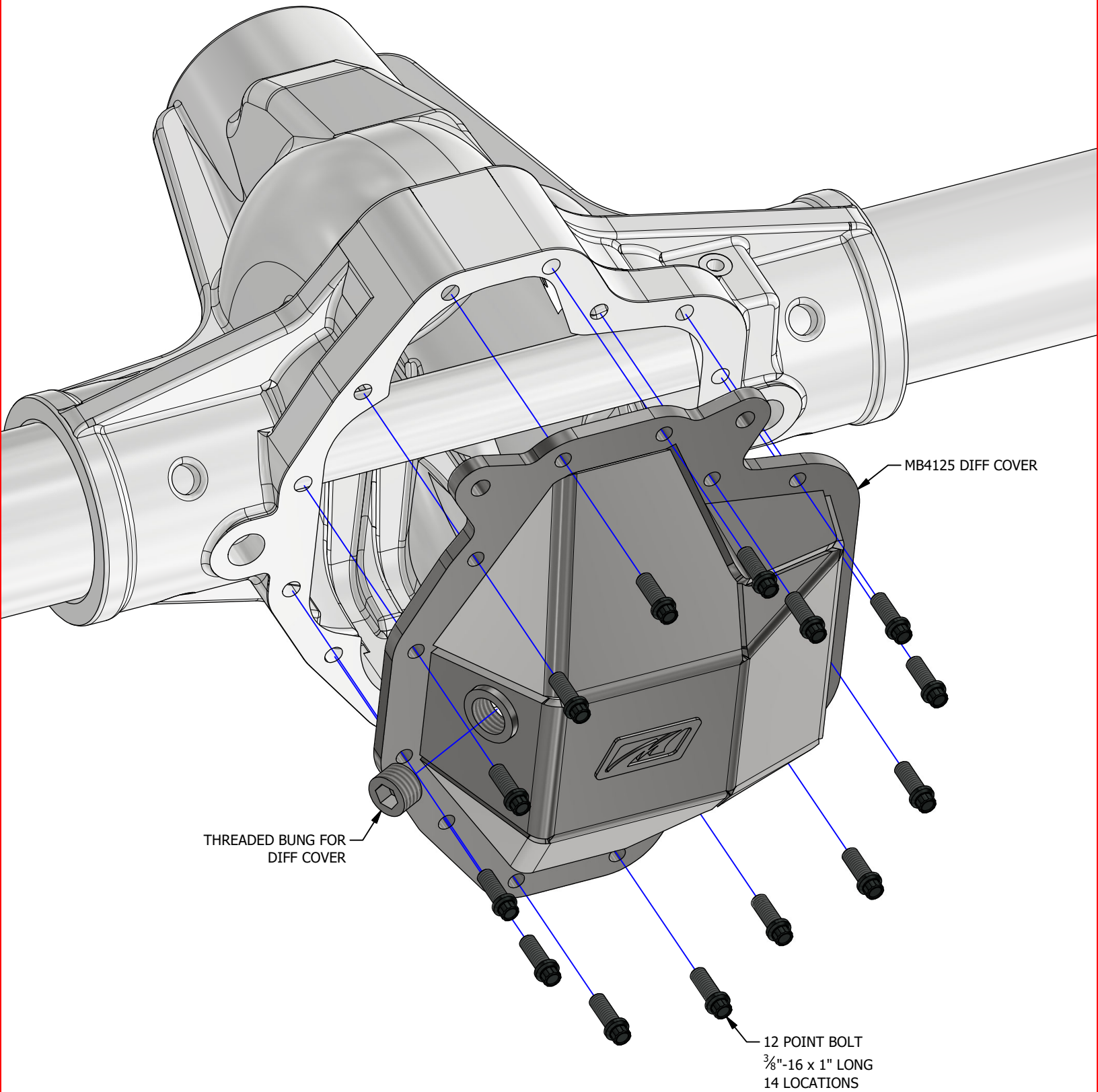

**MB4123 Trail Truss, Dana 80 w 4" Axle Tube**

**STEP 2**

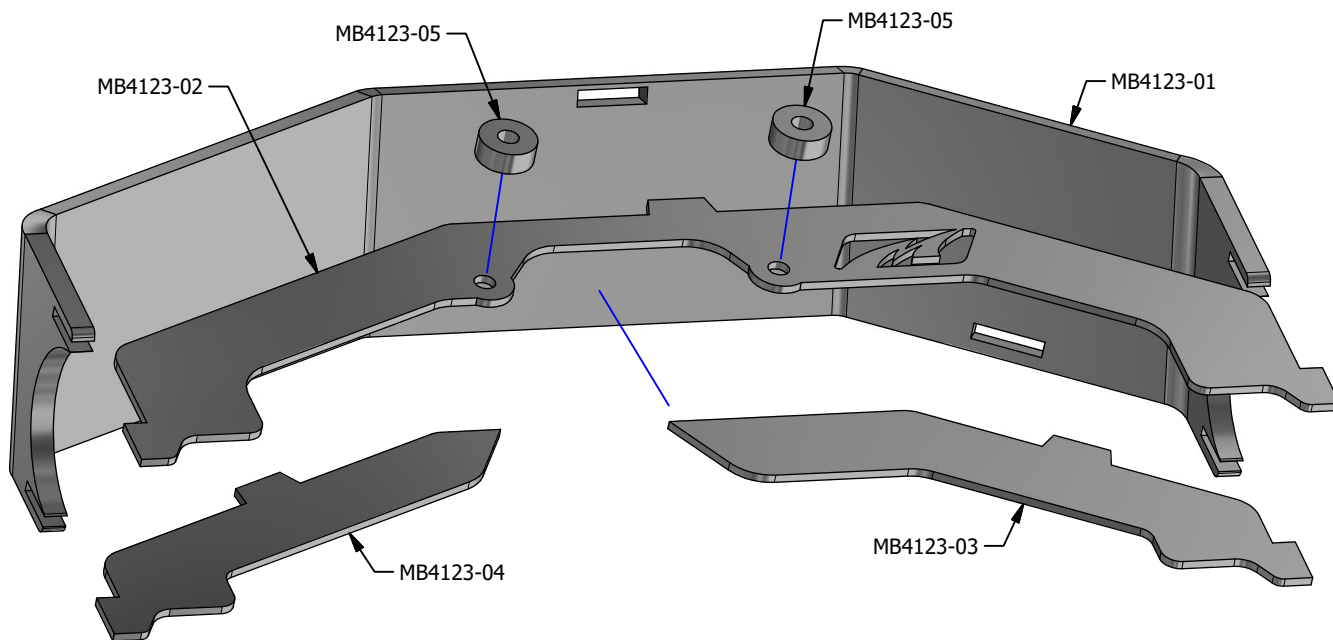

TACK WELD ALL PARTS

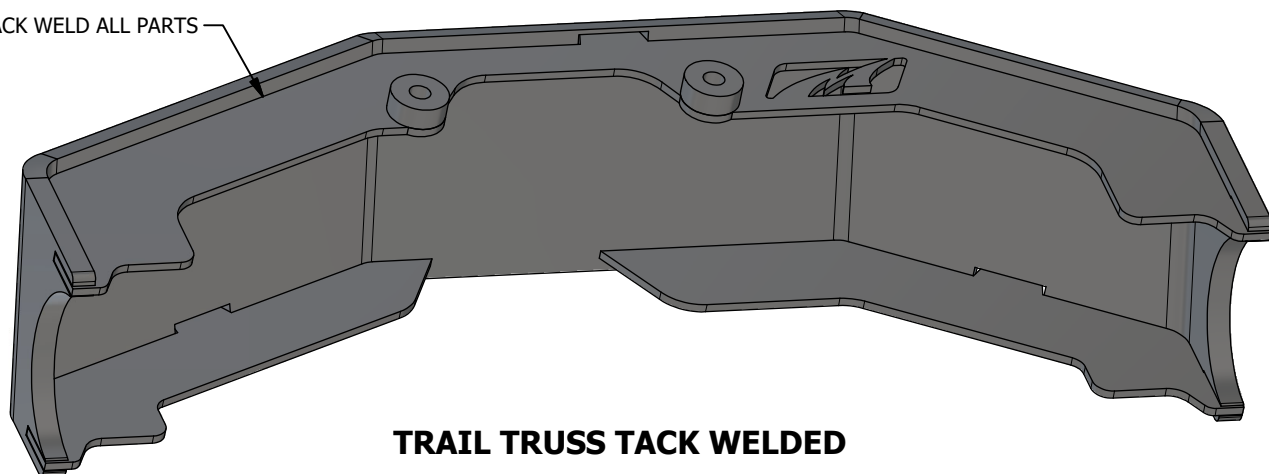

**TRAIL TRUSS TACK WELDED**



**MB4123 Trail Truss, Dana 80 w 4" Axle Tube**

**STEP 3**

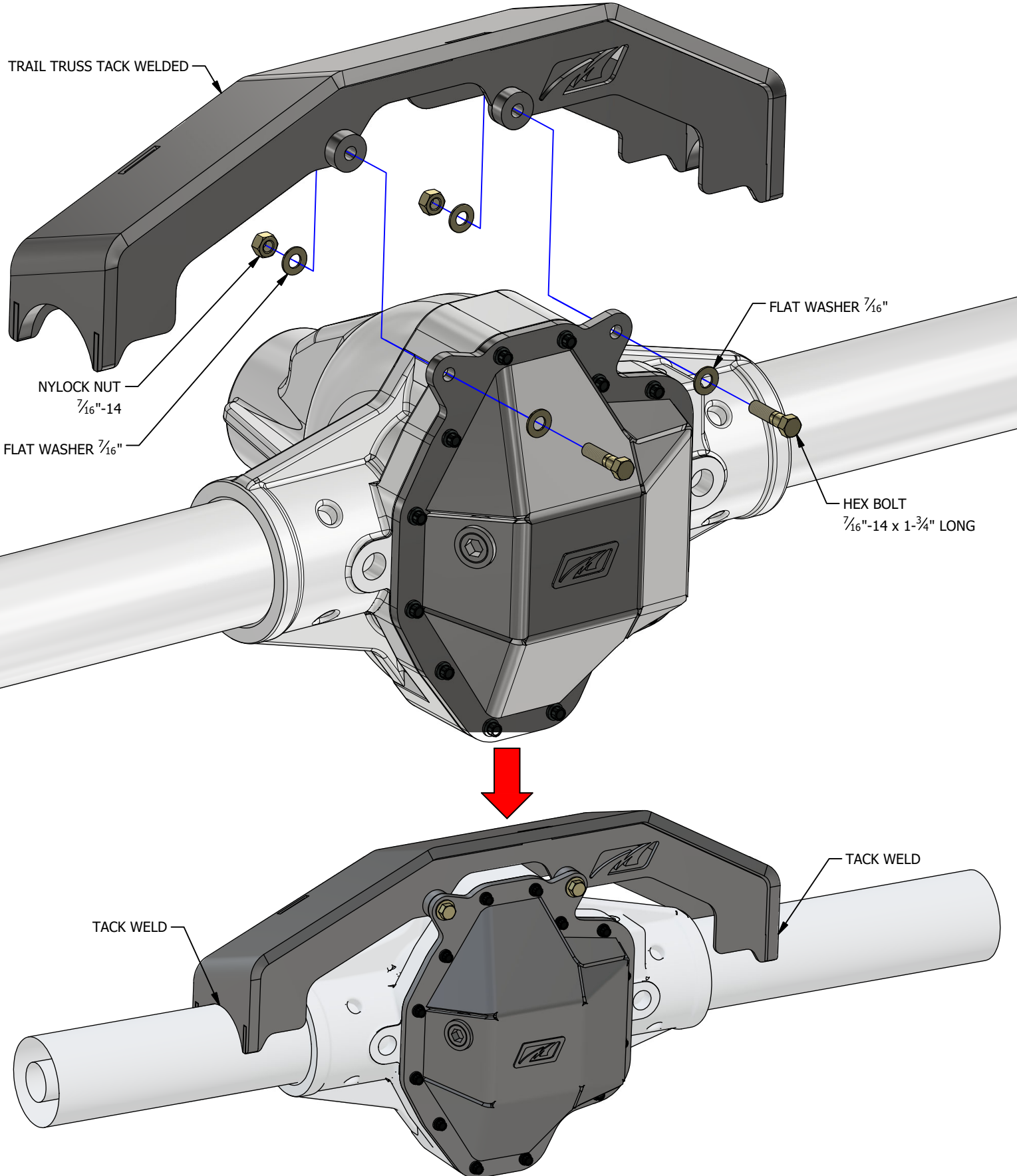

**MB4123 Trail Truss, Dana 80 w 4" Axle Tube****CYCLE SUSPENSION COMPONENTS  
THEN FINAL WELDING**

Once all parts are installed & tack welded, cycle the suspension with the tires installed. Check for binding & adjust when necessary.

Disconnect axle from vehicle. Fully weld all axle truss parts shown.

Paint all raw metal.

Assemble fully welded axle with new truss back into the vehicle.