

## MB2060 Vacuum Pump Relocation Bracket

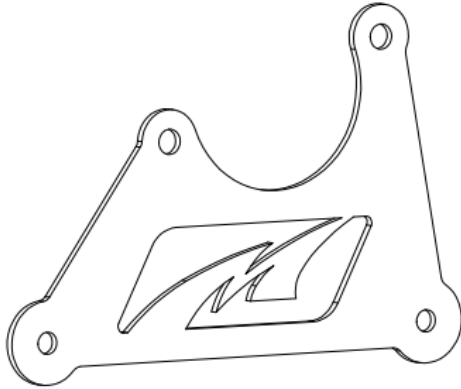

**MB2060-01**  
Qty 1

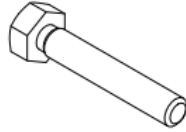

**HEX BOLT**  
6mm - 1.0 x 35mm  
Qty 2



**6mm FLAT WASHER**  
Qty 4



**6mm-1.0**  
Qty 2

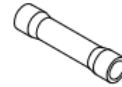

**16GA ELECTRICAL BUTT CONNECTOR**  
Qty 4

**MB2060 Vacuum Pump Relocation Bracket**

- 1** Disconnect vehicle battery
- 2** Remove bumper if you have not already done so
- 3** Remove the vacuum pump by removing the two mounting bolts, two hoses and one electrical connector. Removal of the factory mounting bracket is required for some aftermarket bumpers. Do this now if needed
- 4** Install vacuum pump into Motobilt relocation bracket using the supplied hardware by placing the mount directly over the holes in the pump (see image to the right)
- 5** Install pump & mounting bracket on Jeep using 2 fender bolts closest to the pcm



- 6** Locate the factory vacuum hose split in the engine compartment. Disconnect where shown & set aside for use later. You can remove the hose by gently pulling down on the hose from the original mount location.

**MB2060 Vacuum Pump Relocation Bracket**

**7** Remove quick-connect short hose and check valve from original vacuum hose. You will not need the additional hose from this point on.

**8** Install quick-connect, short hose and check valve to the hose in the engine compartment that you previously removed the splice from.



**9** Connect the hose end quick-connector to the vacuum pump

**MB2060 Vacuum Pump Relocation Bracket**

- 10** At the original mount location, find the two wire connector that powers the vacuum pump. You will need to strip the wire exposing approximately six inches of wire. Cut both wires one at a time in the middle, leaving approximately 3 inches on the connector & 3 inches on the wire harness.



- 11** Strip & splice the included wire into the vehicle's wiring harness on the two wires you just cut. We have supplied heat shrink butt connectors so that you can seal off your splice once this task is completed. Use a torch, heat gun or other source of heat to shrink the connector after clamping. Pay attention to the colors of the wires you connect so that you do not cross them in the following steps.

- 12** Feed the wire up through the engine bay being careful that you do not put it around or through any moving parts
- 13** Connect the factory two wire connector to the supplied wire using the remaining two butt connectors



**MB2060 Vacuum Pump Relocation Bracket**

- 14** Shown here is a tech using a butane torch to shrink the connectors after crimping.

- 15** You may now connect the pump to the newly extended wire using the factory connection.



- 16** Ensure that your wires are not wrapped around any moving parts. Secure away if needed.

- 17** Reconnect the battery to complete the installation.