

## MB1217 - Assembly Drop Down Tailgate for JL/JLU

# MB1217 - DROP DOWN TAILGATE FOR JL/JLU

FITS 2018 - PRESENT



## Preparation and Installation Guide for Your Jeep JL Fold Down Tailgate

Our new fold down tailgate is crafted from high-quality aluminum and shipped in bare metal. To achieve the best possible finish and ensure a flawless fit, we recommend the following procedure:

1. **Initial Fitting:** Before painting, assemble all components to ensure they fit perfectly on your Jeep JL. This step is crucial to avoid adjustments post-painting that could damage the finish.
2. **Disassembly and Cleaning:** Once you confirm the fit, disassemble and thoroughly clean all parts to prepare them for painting.
3. **Professional Painting:** For a superior and durable finish, we advise having the tailgate parts professionally prepared and painted by a reputable auto body shop. This ensures the paint is perfectly matched and applied evenly.
4. **Final Assembly:** After painting, reassemble the parts for the final installation. This process ensures all components align correctly and maintain their pristine condition.

### Additional Recommendations:

**Modification Notice:** Installation of this product involves modifications to your vehicle, including cutting into the body, trimming seals, and adjusting interior panels. After these modifications, it's important to touch up any exposed metal with suitable paint to prevent rust and ensure a seamless look.

By following these steps, you can enhance the aesthetics and functionality of your Jeep JL with confidence that the finish and fit are of the highest quality.

To further protect your investment, consider adding a non-slip marine grade flooring material to the removable interior panel. [Link to Amazon for Marine Grade Flooring](#)

# ASSEMBLY INSTRUCTIONS

**MB1217 - Assembly Drop Down Tailgate for JL/JLU**

**CONTENTS**

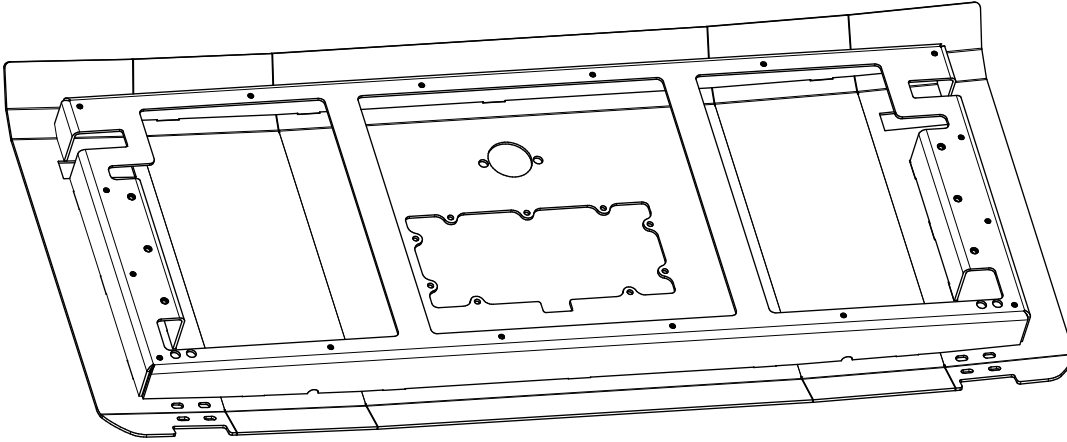

**MB1217 - TAILGATE WELDMENT  
QTY 1**

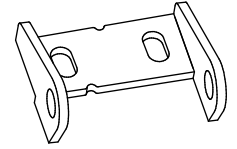

**MB1217 - HINGE DRIVER  
QTY 1**

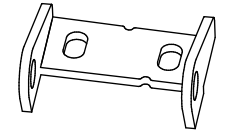

**MB1217 - HINGE PASSENGER  
QTY 1**

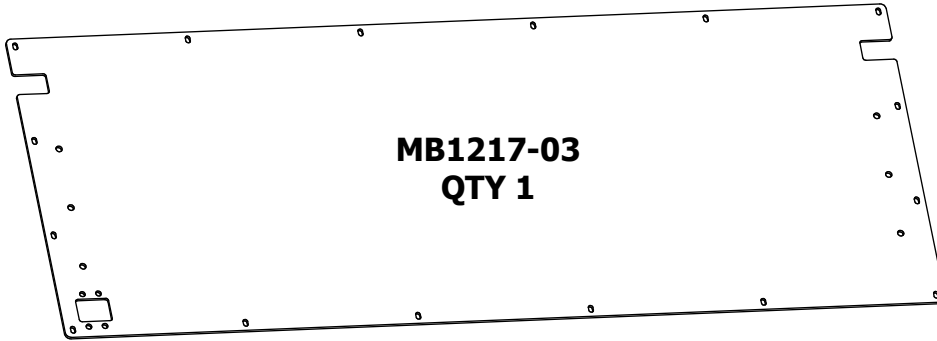

**MB1217-03  
QTY 1**



**MB1217-11  
QTY 2**



**MB1217-22  
QTY 2**



**MB1217-14  
QTY 1**

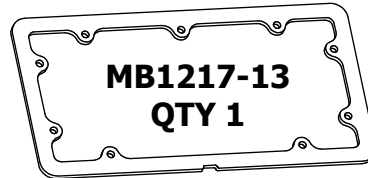

**MB1217-13  
QTY 1**

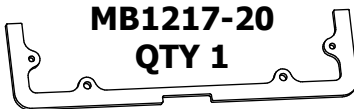

**MB1217-20  
QTY 1**

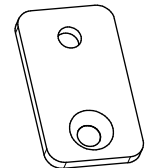

**MB1217-12  
QTY 1**

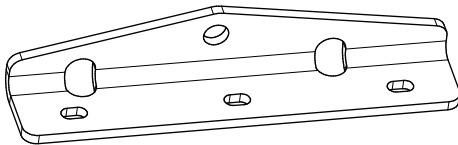

**MB1217-10  
QTY 1**

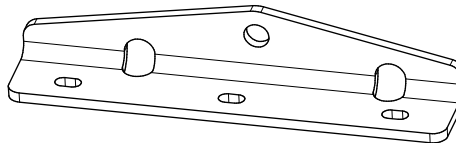

**MB1217-10\_MIR  
QTY 1**

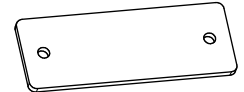

**MB1217-23  
QTY 1**

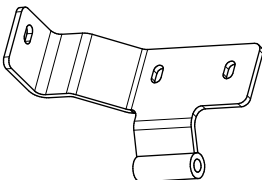

**MB1217 - HINGE PIVOT DRIVER  
QTY 1**

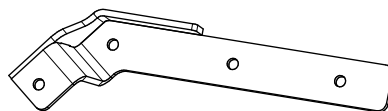

**MB1217 - CABLE MOUNT PASSENGER  
QTY 1**

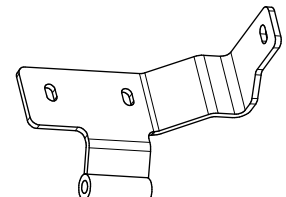

**MB1217 - HINGE PIVOT PASSENGER  
QTY 1**

**MB1217 - Assembly Drop Down Tailgate for JL/JLU**

**CONTENTS**



**MB1217 - EDGE TRIM  
QTY 1 (45" LONG)**

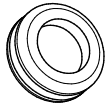

**MB1217 - GROMMET  
QTY 1**

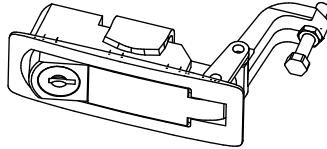

**MB1217 - LATCH  
24-46mm GRIP RANGE  
QTY 2**

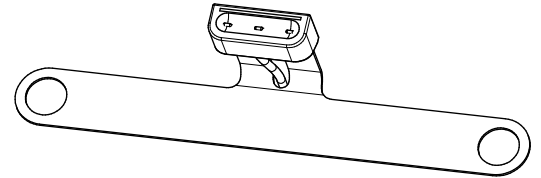

**LD-PL6  
LICENSE PLATE LED LIGHT  
QTY 1**



**MB1217-18  
FACTORY HINGE COVER  
QTY 2**

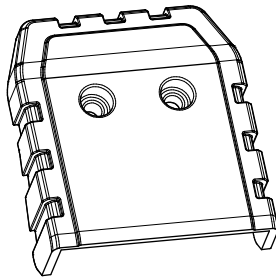

**MB1217-16  
HINGE COVER DRIVER  
QTY 1**

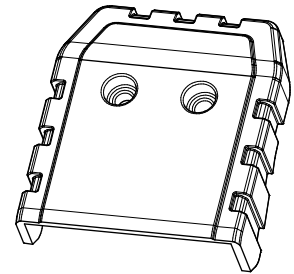

**MB1217-17  
HINGE COVER PASSENGER  
QTY 1**

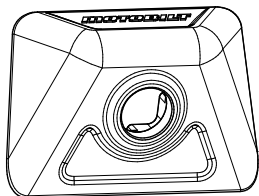

**MB1217-CM1  
CAMERA MOUNT  
QTY 1**

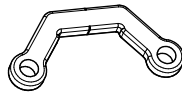

**MB1217-CM2  
CAMERA BRACKET  
QTY 1**

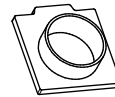

**MB1217-CM3  
CAMERA SPACER  
QTY 1**

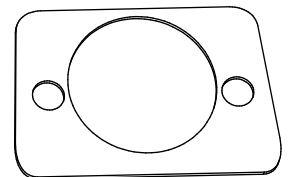

**MB1217 - GASKET  
QTY 1**

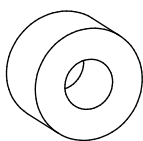

**MB1217 - TUBE SPACER  
QTY 1**

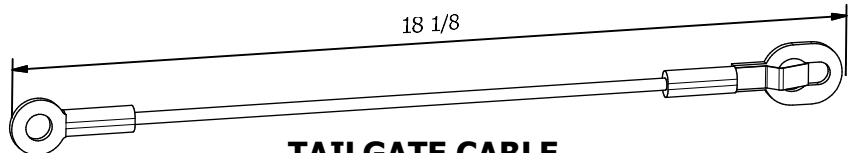

**TAILGATE CABLE  
QTY 2**

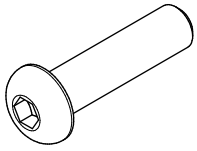
**MB1217 - Assembly Drop Down Tailgate for JL/JLU**
**CONTENTS**

**BUTTON HEAD SCREW**  
 $\frac{1}{4}$ "-20 X 1" LONG  
 QTY 4

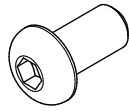

**BUTTON HEAD SCREW**  
 $\frac{1}{4}$ "-20 X  $\frac{1}{2}$ " LONG  
 QTY 5

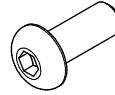

**BUTTON HEAD SCREW**  
 #10-24 X  $\frac{1}{2}$ " LONG  
 QTY 20

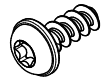

**THREAD FORMING SCREW**  
 M4 x 10mm LONG  
 QTY 4

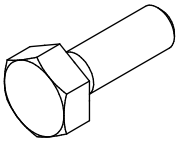

**HEX BOLT**  
 $\frac{1}{4}$ "-20 X  $\frac{3}{4}$ " LONG  
 QTY 10

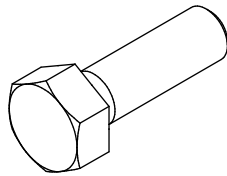

**HEX BOLT**  
 $\frac{5}{16}$ "-18 X 1" LONG  
 QTY 10

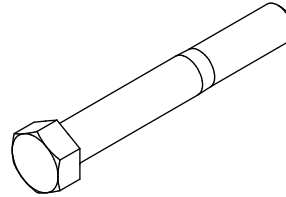

**HEX BOLT**  
 $\frac{3}{8}$ "-16 X 2- $\frac{3}{4}$ " LONG  
 QTY 2

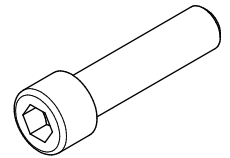

**SOCKET HEAD SCREW**  
 $\frac{1}{4}$ "-20 X  $\frac{3}{4}$ " LONG  
 QTY 4

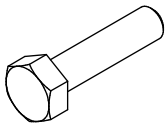

**HEX BOLT**  
 M6 x 1.0 x 25mm LONG  
 QTY 2

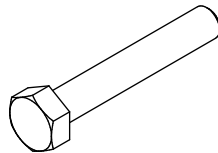

**HEX BOLT**  
 M8 x 1.25 x 50mm LONG  
 QTY 1

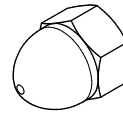

**HIGH CROWN NUT,**  
 $\frac{1}{4}$ "-20, ZINC  
 QTY 8

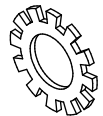

**TOOTH LOCK WASHER,**  
 EXTERNAL,  $\frac{1}{4}$ ", ZINC  
 QTY 8



**FLAT WASHER**  
 M5  
 QTY 2

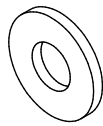

**FLAT WASHER**  
 $\frac{1}{4}$ "  
 QTY 20

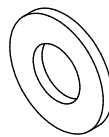

**FLAT WASHER**  
 $\frac{5}{16}$ "  
 QTY 20

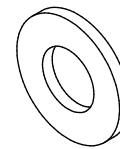

**FLAT WASHER**  
 $\frac{3}{8}$ "  
 QTY 1

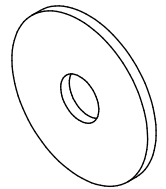

**FENDER WASHER**  
 $\frac{1}{4}$ " x 1- $\frac{1}{4}$ " OD  
 QTY 2



**NYLOCK NUT**  
 #10-24  
 QTY 4

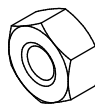

**NYLOCK NUT**  
 $\frac{1}{4}$ "-20  
 QTY 20

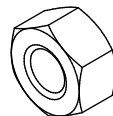

**NYLOCK NUT**  
 $\frac{5}{16}$ "-18  
 QTY 10

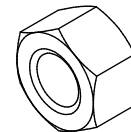

**NYLOCK NUT**  
 $\frac{3}{8}$ "-16  
 QTY 2

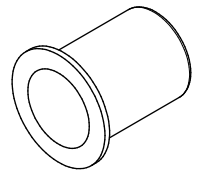

**RIVNUT**  
 $\frac{5}{16}$ "-18  
 QTY 4

THIS FASTENER LIST DOES INCLUDE A FEW SPARES FOR SOME FASTENERS SHOWN, THUS, YOU MAY HAVE SOME EXTRA FASTENERS LEFT OVER AFTER ASSEMBLY

**MB1217 - Assembly Drop Down Tailgate for JL/JLU**

**STEP 1**

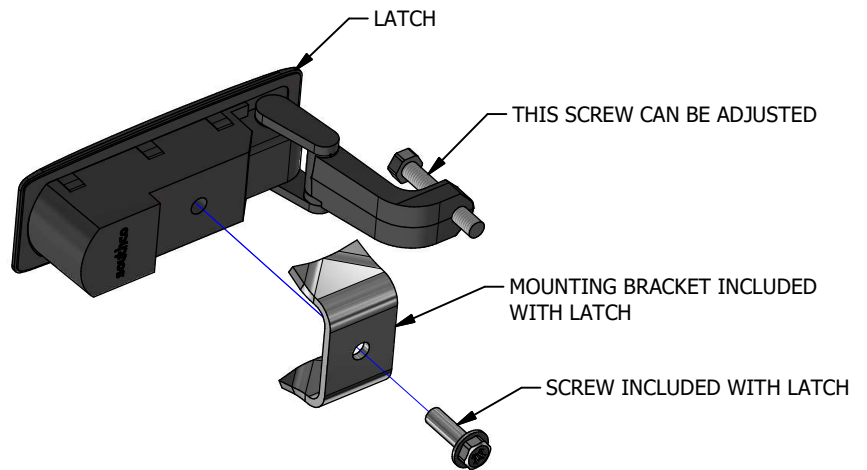
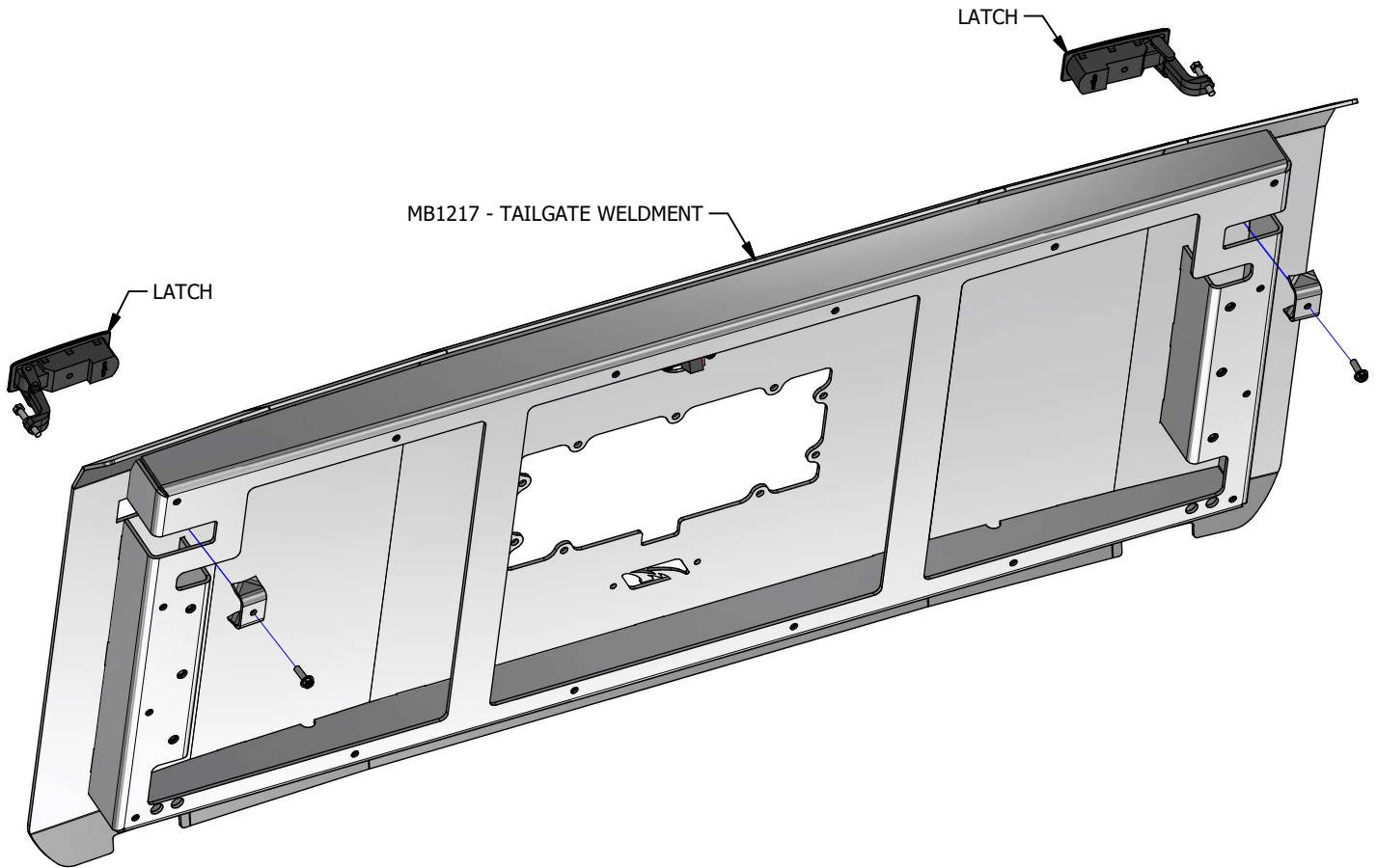

**MB1217 - LATCH**

**MB1217 - Assembly Drop Down Tailgate for JL/JLU**

**STEP 2**

INSTALL BACKUP CAMERA THROUGH CUTOUTS IN THE TAILGATE (SEE TWO DIFFERENT CAMERA STYLES BELOW)



**IDENTIFYING YOUR CAMERA**

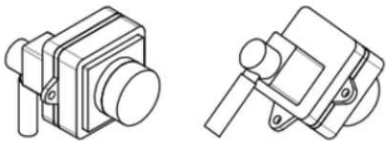

**2018-2020 BACK UP CAMERA**

MOPAR PART# 68452959AB; 68288397AC;  
68414411AA; 68452959AA

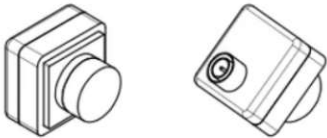

**2021+ BACK UP CAMERA**

MOPAR PART# 04672852AB; 04672852AB

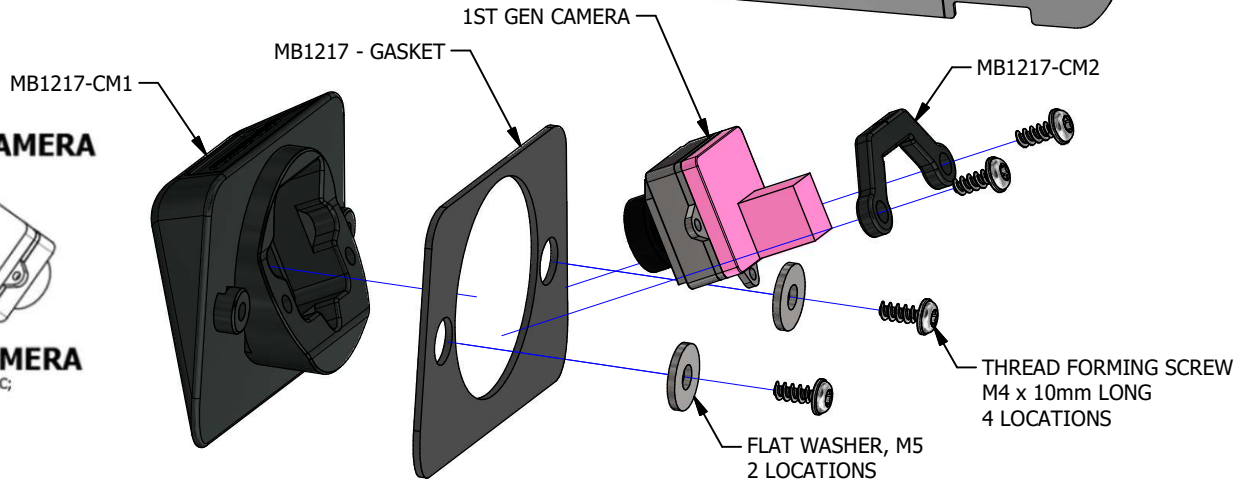

**1ST GEN CAMERA ASSEMBLY**

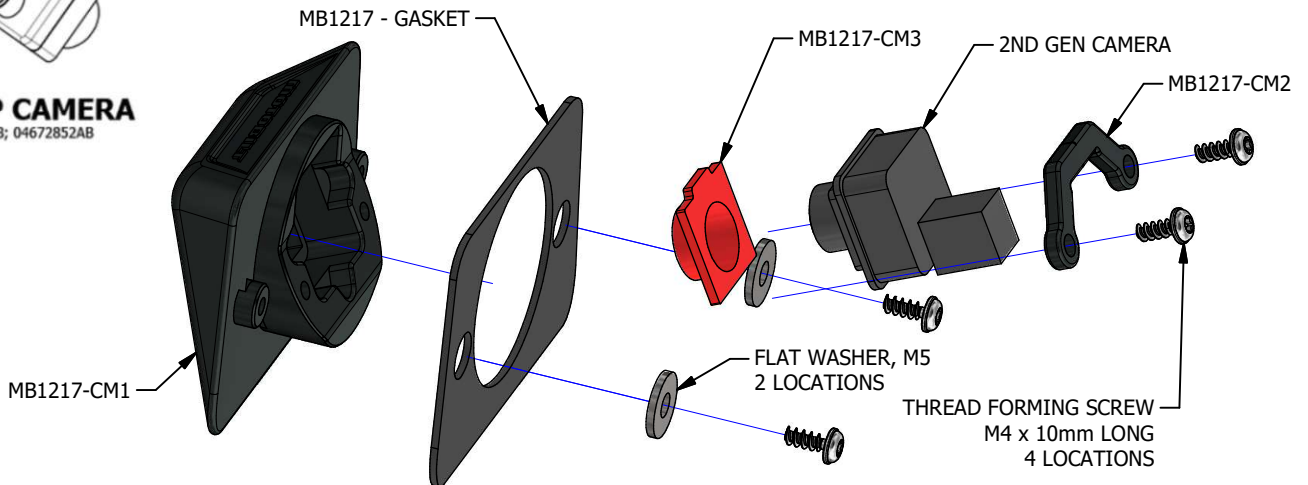

**2ND GEN CAMERA ASSEMBLY**

**MB1217 - Assembly Drop Down Tailgate for JL/JLU**

**STEP 3**

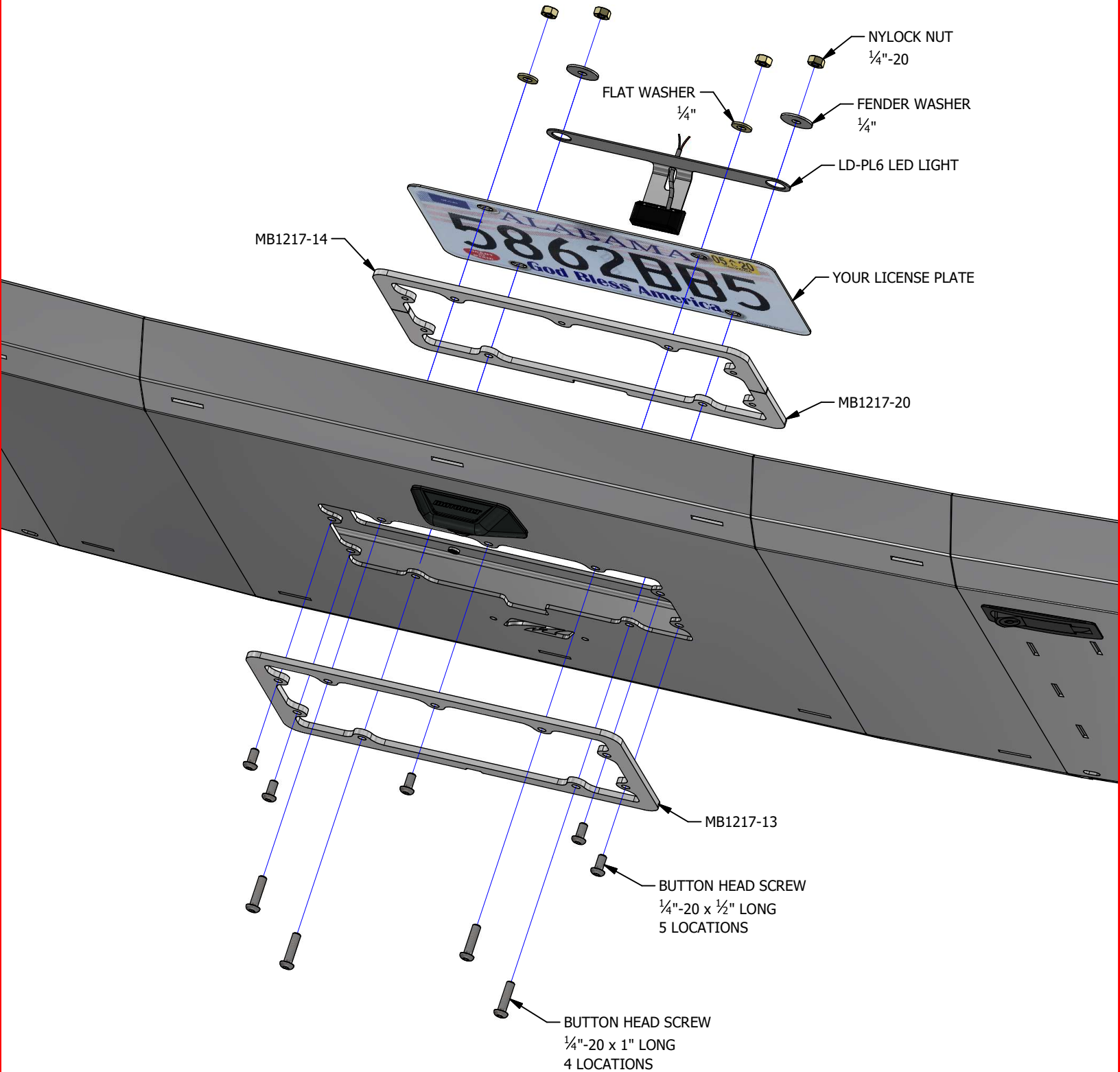

**MB1217 - Assembly Drop Down Tailgate for JL/JLU**

**STEP 4**



HIGH CROWN NUT,  
1/4"-20, ZINC

TOOTH LOCK WASHER,  
EXTERNAL, 1/4", ZINC

MB1217 - HINGE DRIVER

FLAT WASHER  
1/4"

HEX BOLT  
1/4"-20 x 3/4" LONG

REPEAT FOR  
MB1217 - HINGE PASSENGER



**MB1217 - Assembly Drop Down Tailgate for JL/JLU**

**STEP 5**

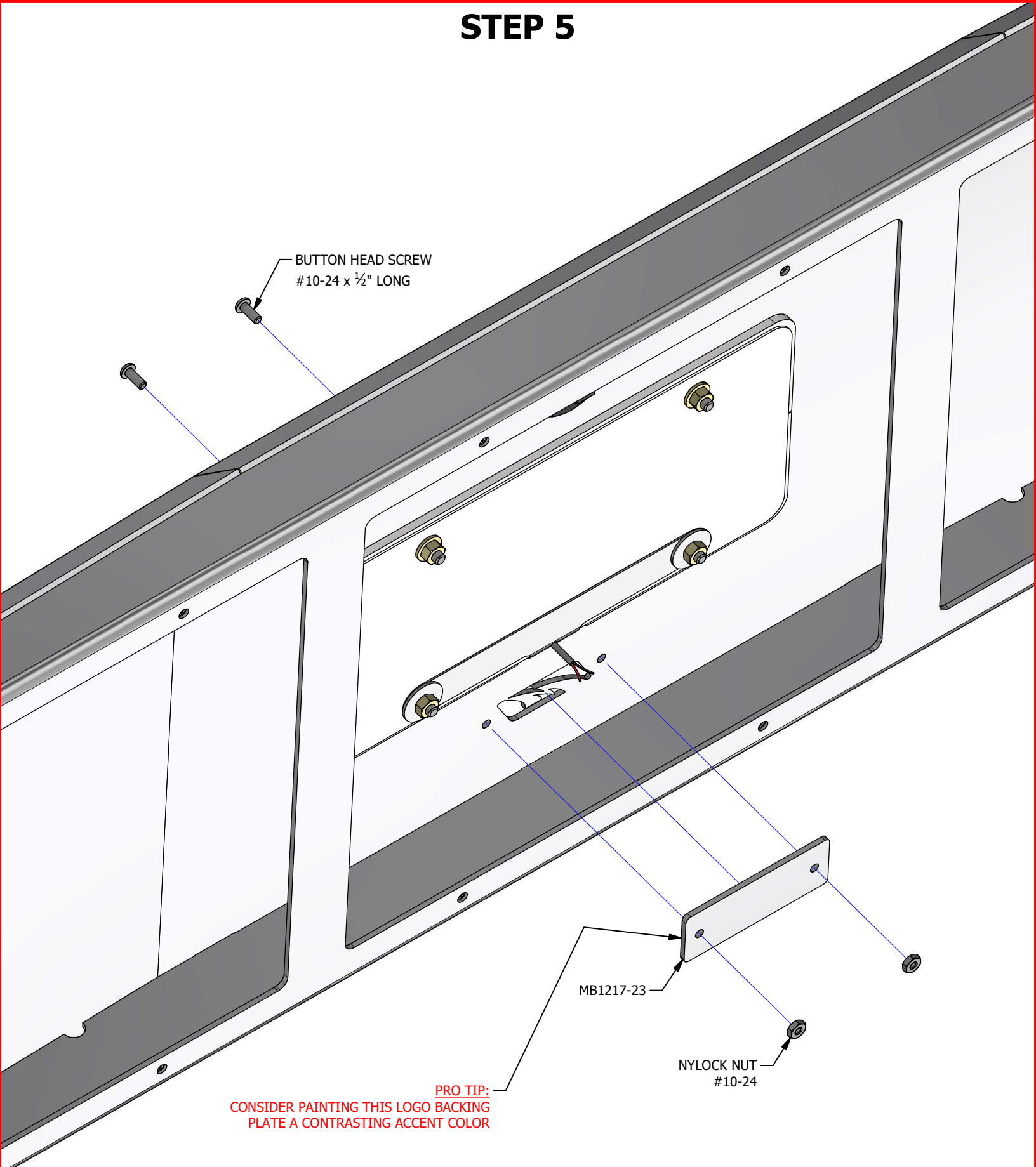

**PRO TIP:**  
CONSIDER PAINTING THIS LOGO BACKING  
PLATE A CONTRASTING ACCENT COLOR

**MB1217 - Assembly Drop Down Tailgate for JL/JLU**

**STEP 6**

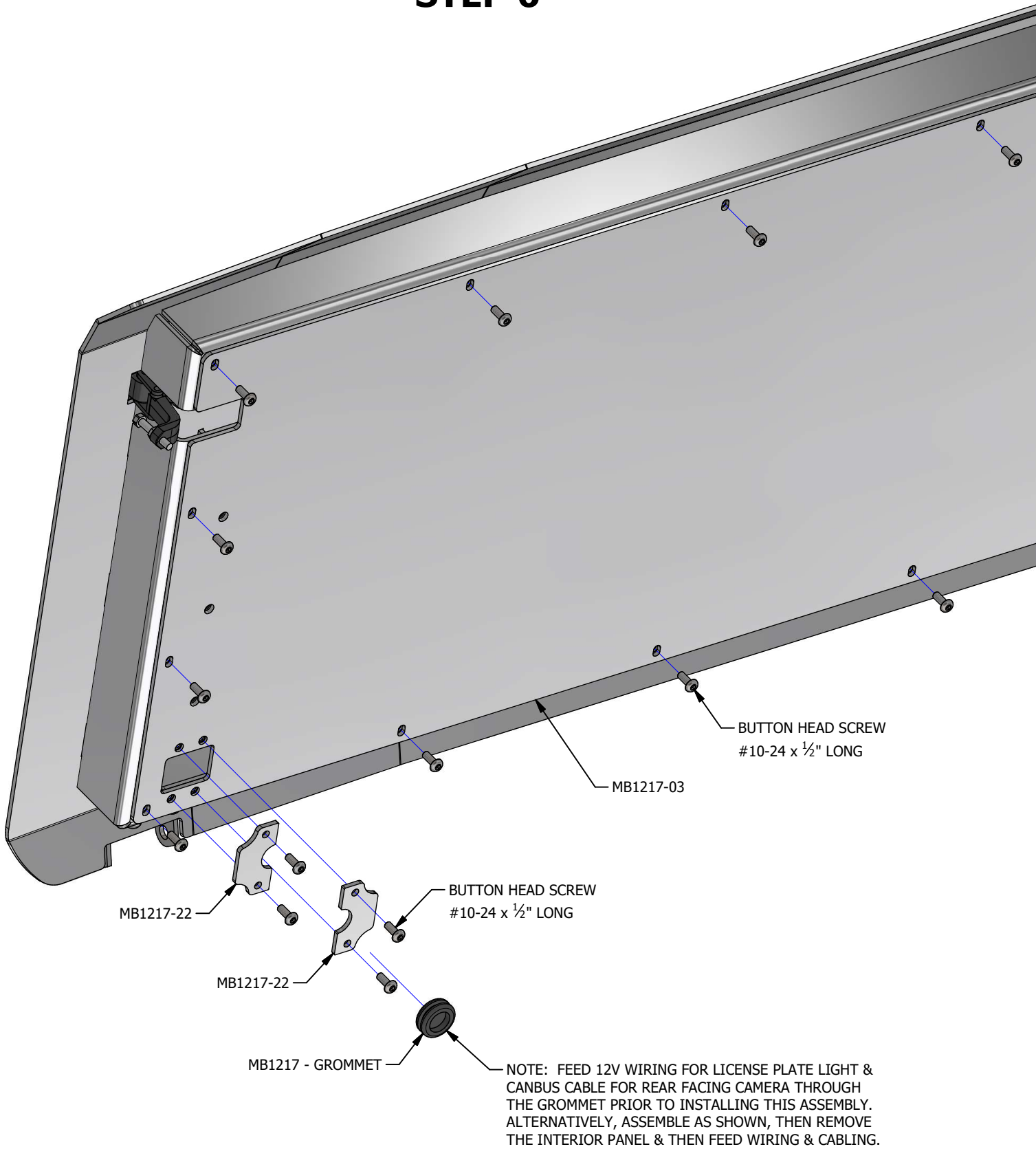

**MB1217 - Assembly Drop Down Tailgate for JL/JLU**

**STEP 7**

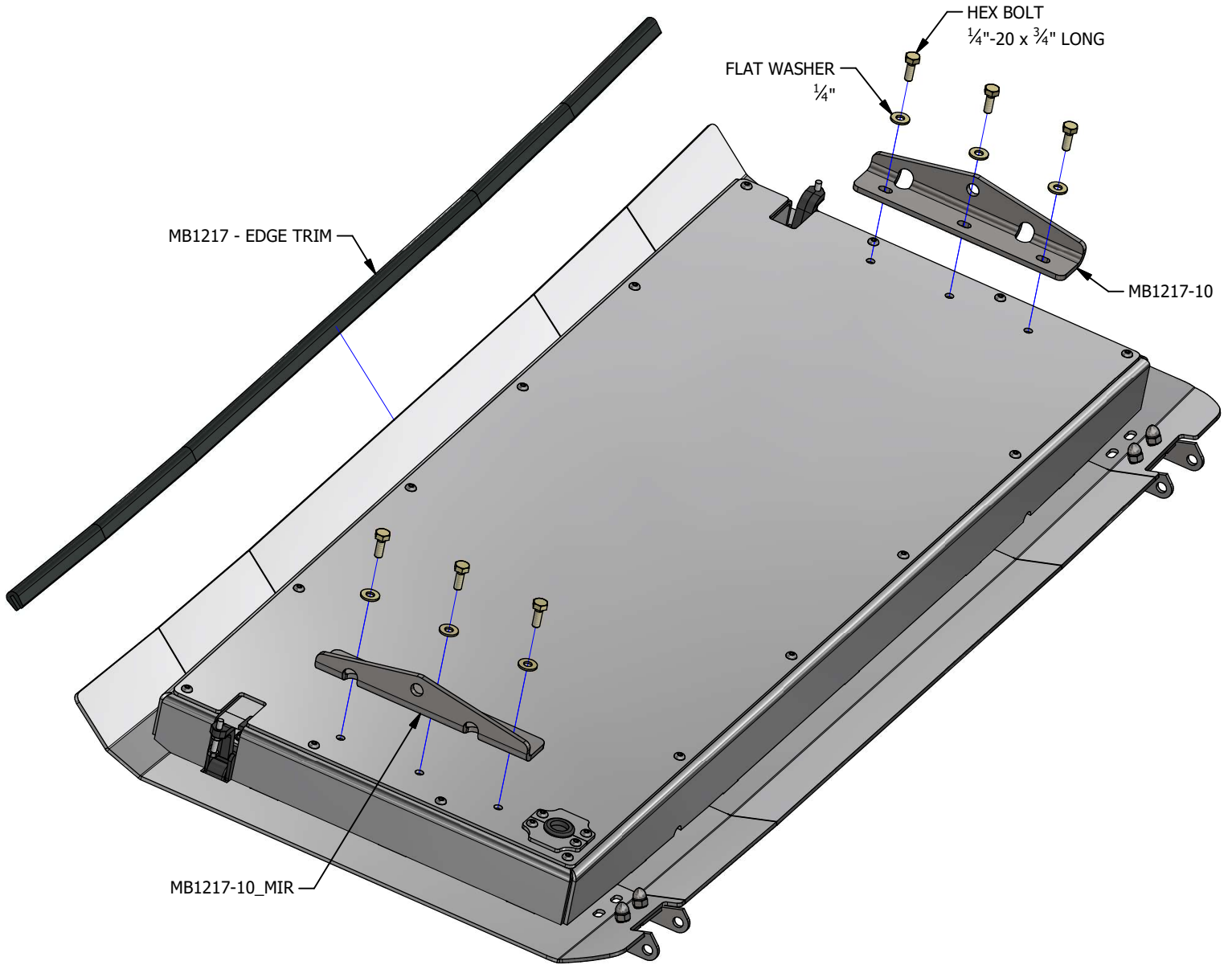

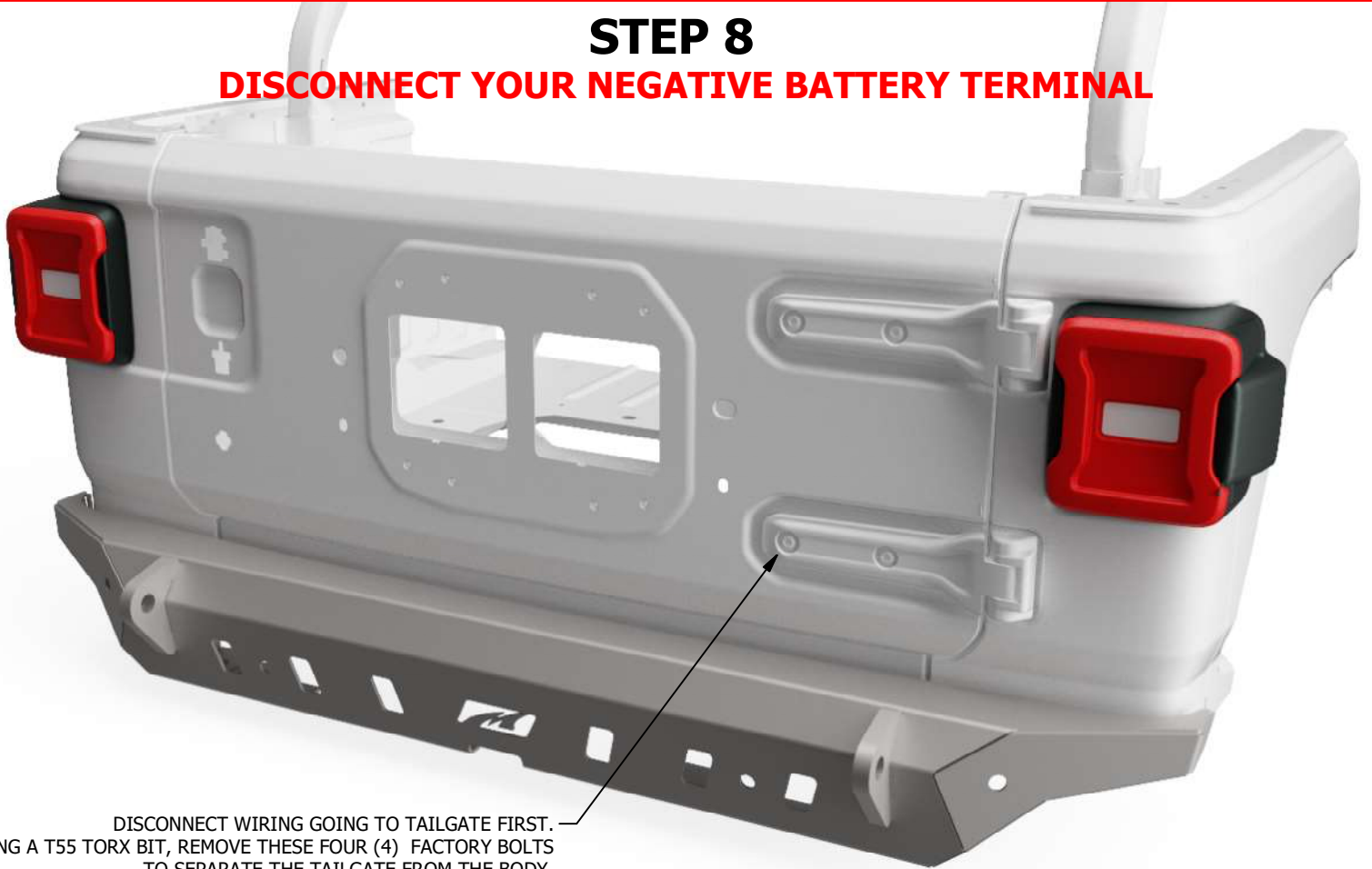
**MB1217 - Assembly Drop Down Tailgate for JL/JLU****STEP 8****DISCONNECT YOUR NEGATIVE BATTERY TERMINAL**

DISCONNECT WIRING GOING TO TAILGATE FIRST. USING A T55 TORX BIT, REMOVE THESE FOUR (4) FACTORY BOLTS TO SEPARATE THE TAILGATE FROM THE BODY. UNLATCH & REMOVE THE FACTORY TAILGATE.

USING A 13mm SOCKET, REMOVE THE INTERNAL BOLTS FOR THE FACTORY TAILGATE HINGES. REMOVE THE FACTORY HINGES FROM THE BODY.

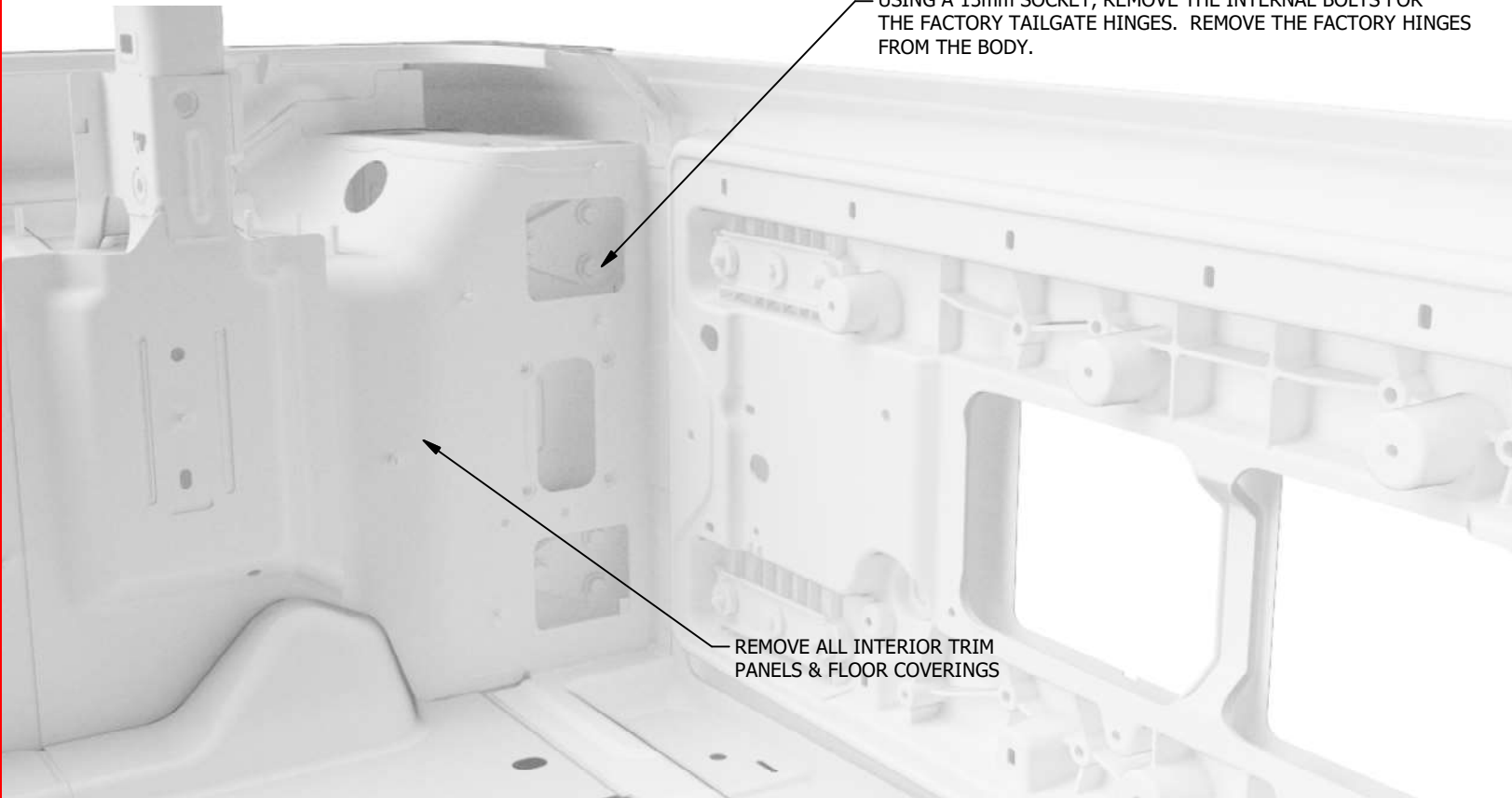

REMOVE ALL INTERIOR TRIM PANELS & FLOOR COVERINGS

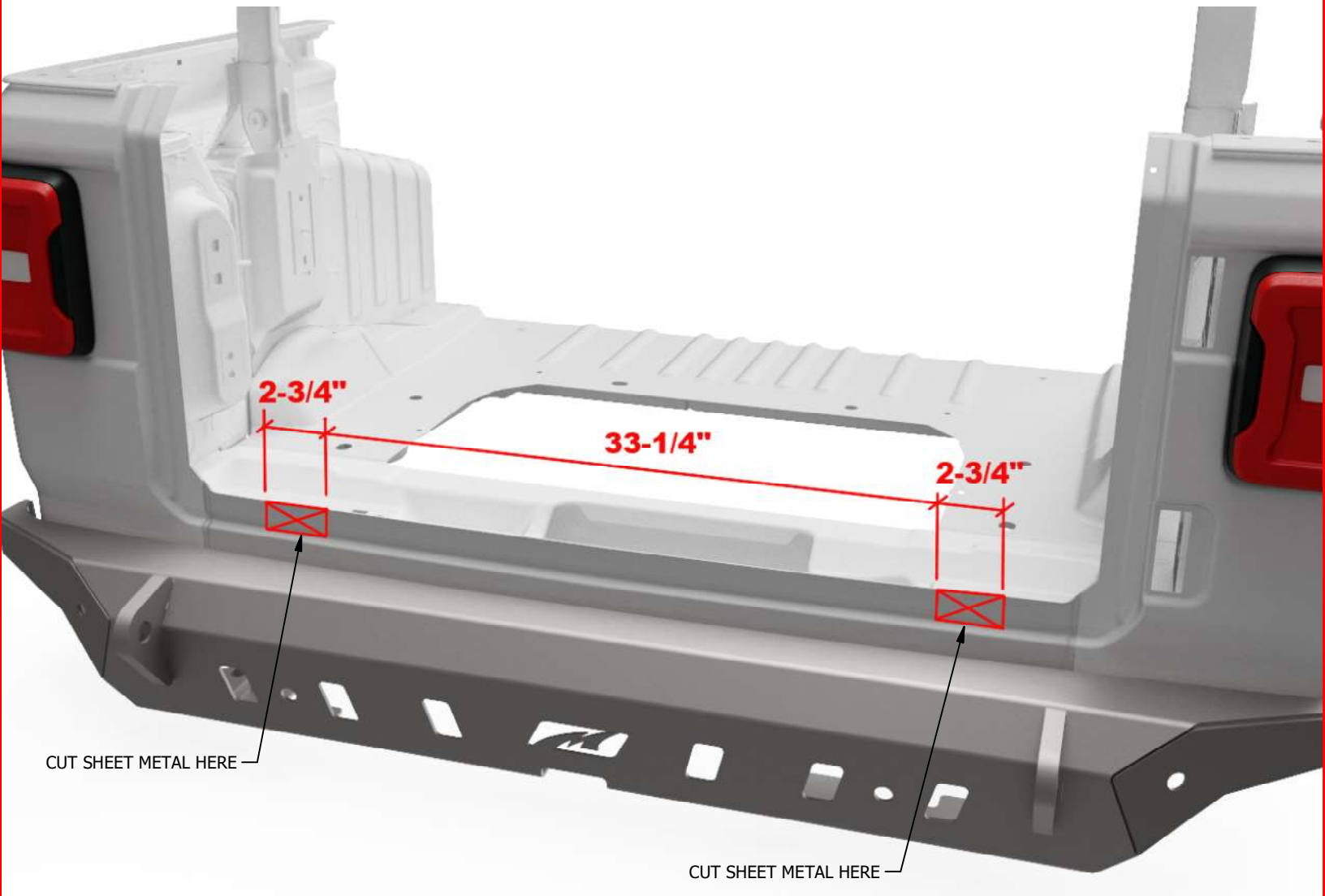
**MB1217 - Assembly Drop Down Tailgate for JL/JLU****STEP 9****LIFT THE FACTORY BULB SEAL. MARK & CUT SHEET METAL AS SHOWN**

**MB1217 - Assembly Drop Down Tailgate for JL/JLU**

**STEP 10**



LOOSELY INSTALL "CABLE MOUNT PASSENGER" USING HEX BOLT, M6 x 1.0 x 25mm LONG & 1/4" FLAT WASHER. THERE ARE TWO FACTORY RIVETS IN THE SHEET METAL IN THIS AREA TO FASTEN THIS BRACKET.

MB1217 - CABLE MOUNT PASSENGER

**AFTER HOLE IS MARKED, REMOVE BRACKET & INSTALL 5/16" RIVNUT, THEN LOOSELY ASSEMBLE ALL PARTS. USE 5/16" FASTENERS FOR "HINGE PIVOT PASSENGER"**

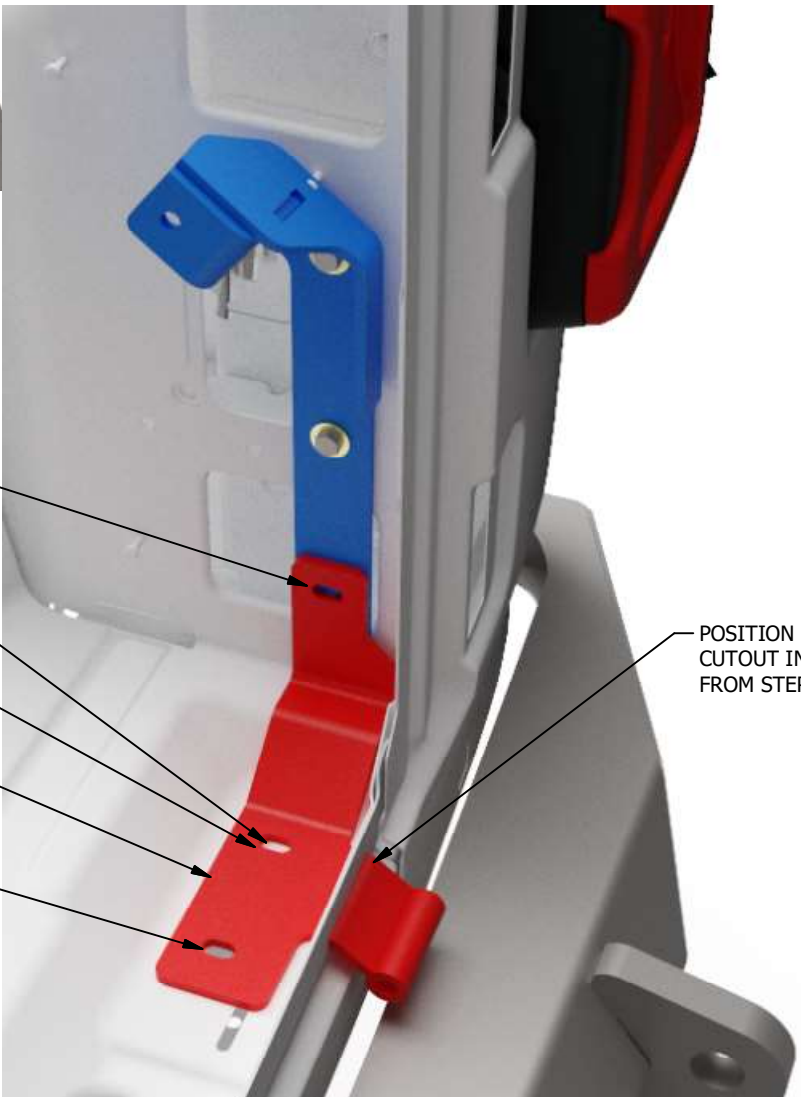

ALIGN SLOT WITH HOLE IN BRACKET

MARK THIS HOLE

DRILL 17/32"Ø HOLE & INSTALL 5/16" RIVNUT HERE

MB1217 - HINGE PIVOT PASSENGER

THERE IS A FACTORY THRU HOLE IN THIS LOCATION. ALIGN SLOT IN BRACKET WITH FACTORY THRU HOLE.

POSITION BRACKET IN THE CUTOUT IN SHEET METAL FROM STEP 9

**MB1217 - Assembly Drop Down Tailgate for JL/JLU**

**STEP 11**

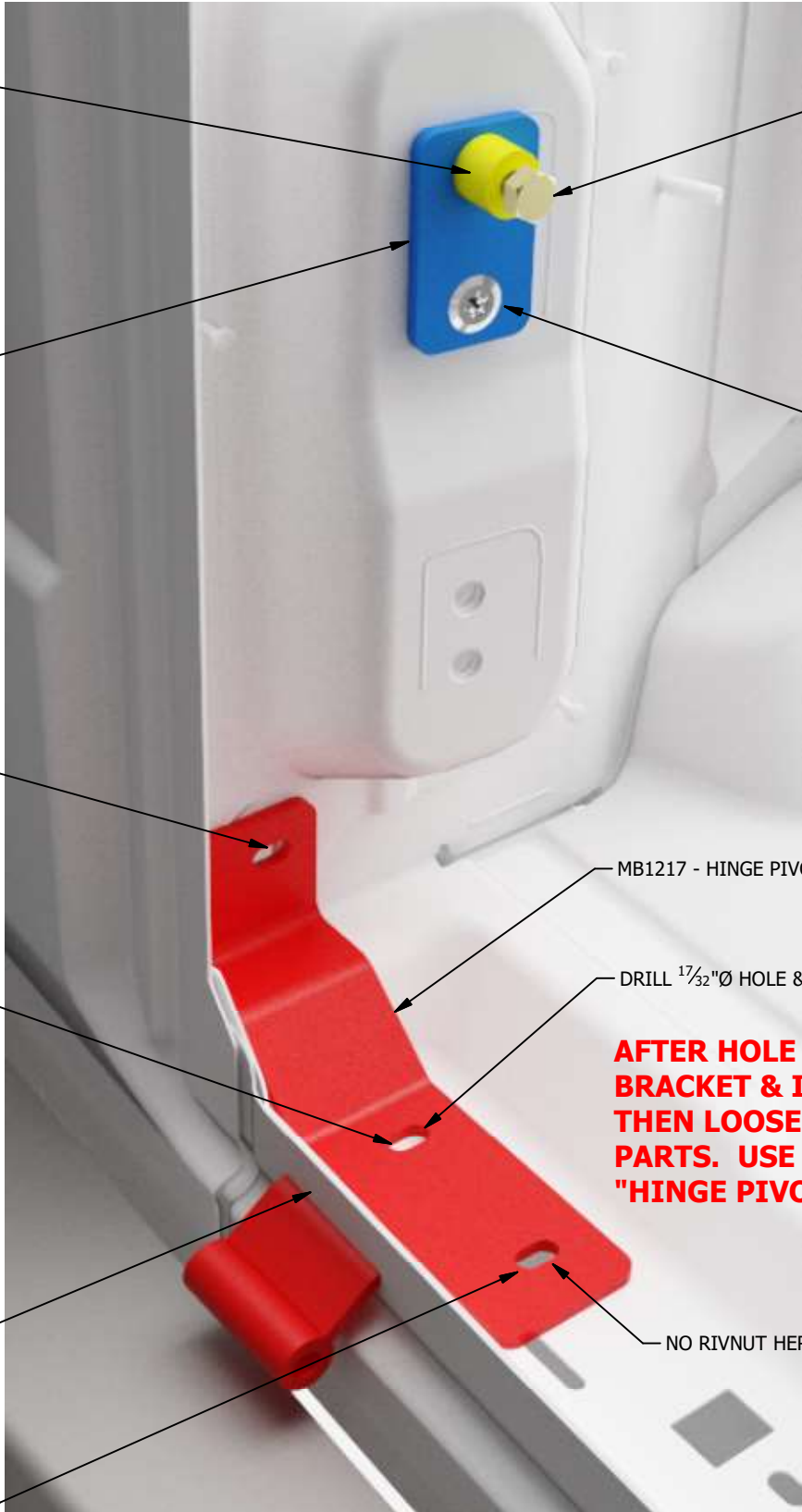

MB1217 - TUBE SPACER

HEX BOLT, M8 x 1.25 x 50mm

MB1217-12

REUSE FACTORY BOLT

ALIGN SLOT WITH HOLE IN BODY

MB1217 - HINGE PIVOT DRIVER

MARK THIS HOLE

DRILL  $1\frac{7}{32}$ "  $\varnothing$  HOLE & INSTALL  $\frac{5}{16}$ " RIVNUT HERE

**AFTER HOLE IS MARKED, REMOVE BRACKET & INSTALL  $\frac{5}{16}$ " RIVNUT, THEN LOOSELY ASSEMBLE ALL PARTS. USE  $\frac{5}{16}$ " FASTENERS FOR "HINGE PIVOT DRIVER"**

POSITION BRACKET IN THE CUTOUT IN SHEET METAL FROM STEP 9

NO RIVNUT HERE. BOLT THRU HOLE.

THERE IS A FACTORY THRU HOLE IN THIS LOCATION. ALIGN SLOT IN BRACKET WITH FACTORY THRU HOLE.

**MB1217 - Assembly Drop Down Tailgate for JL/JLU**

**STEP 12**

**AFTER CHECKING & ADJUSTING ALL GAPS, REVEALS, BODY LINES & LATCH FUNCTIONS, TIGHTEN ALL HINGE BRACKETS**

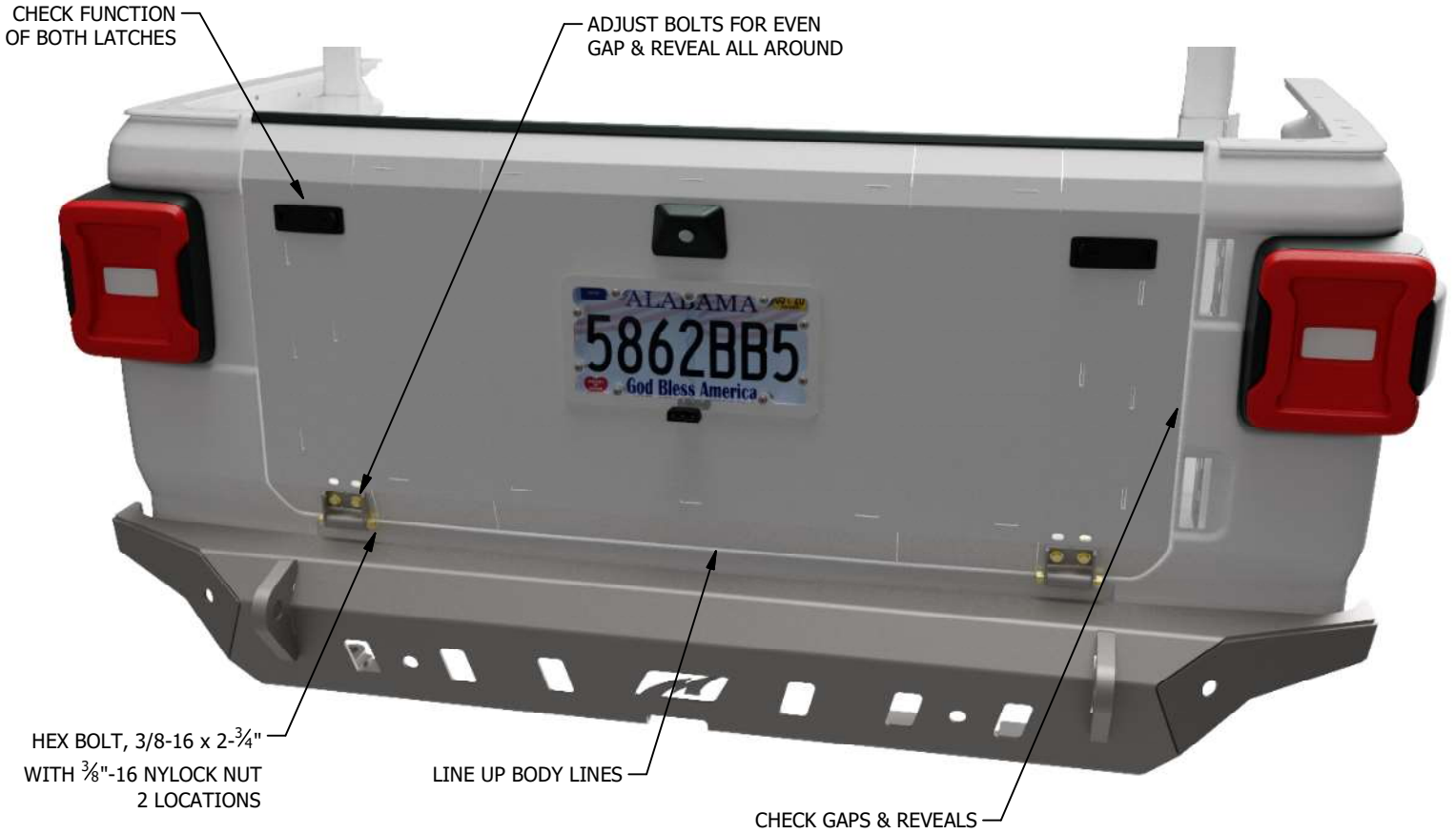



**MB1217 - Assembly Drop Down Tailgate for JL/JLU**



**STEP 13**

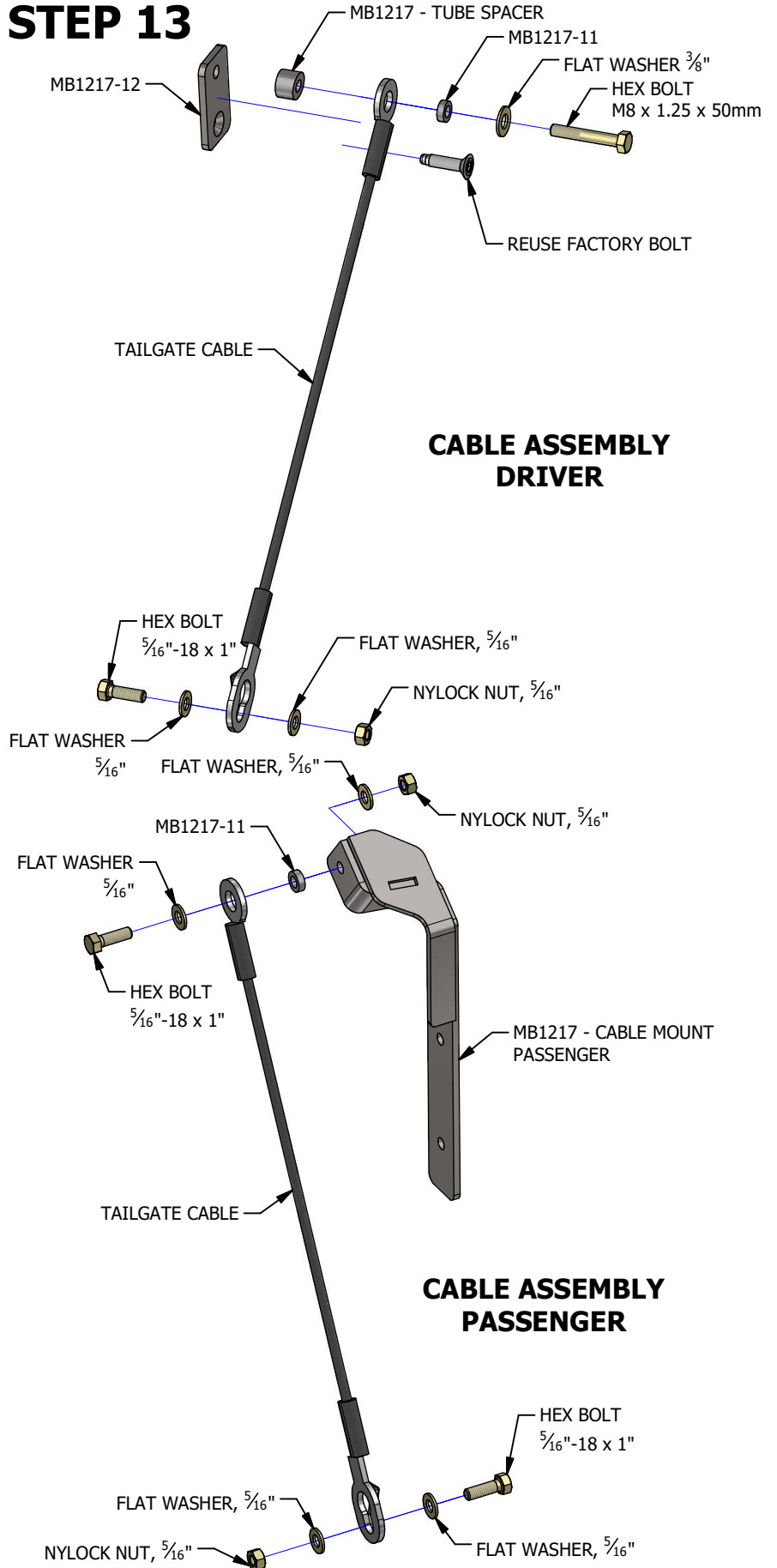

**MB1217 - Assembly Drop Down Tailgate for JL/JLU**

**STEP 14**

**VEHICLE BODY NOT VISIBLE FOR CLARITY.  
THESE PARTS ARE INSTALLED WHILE TAILGATE  
IS INSTALLED ON THE VEHICLE.**

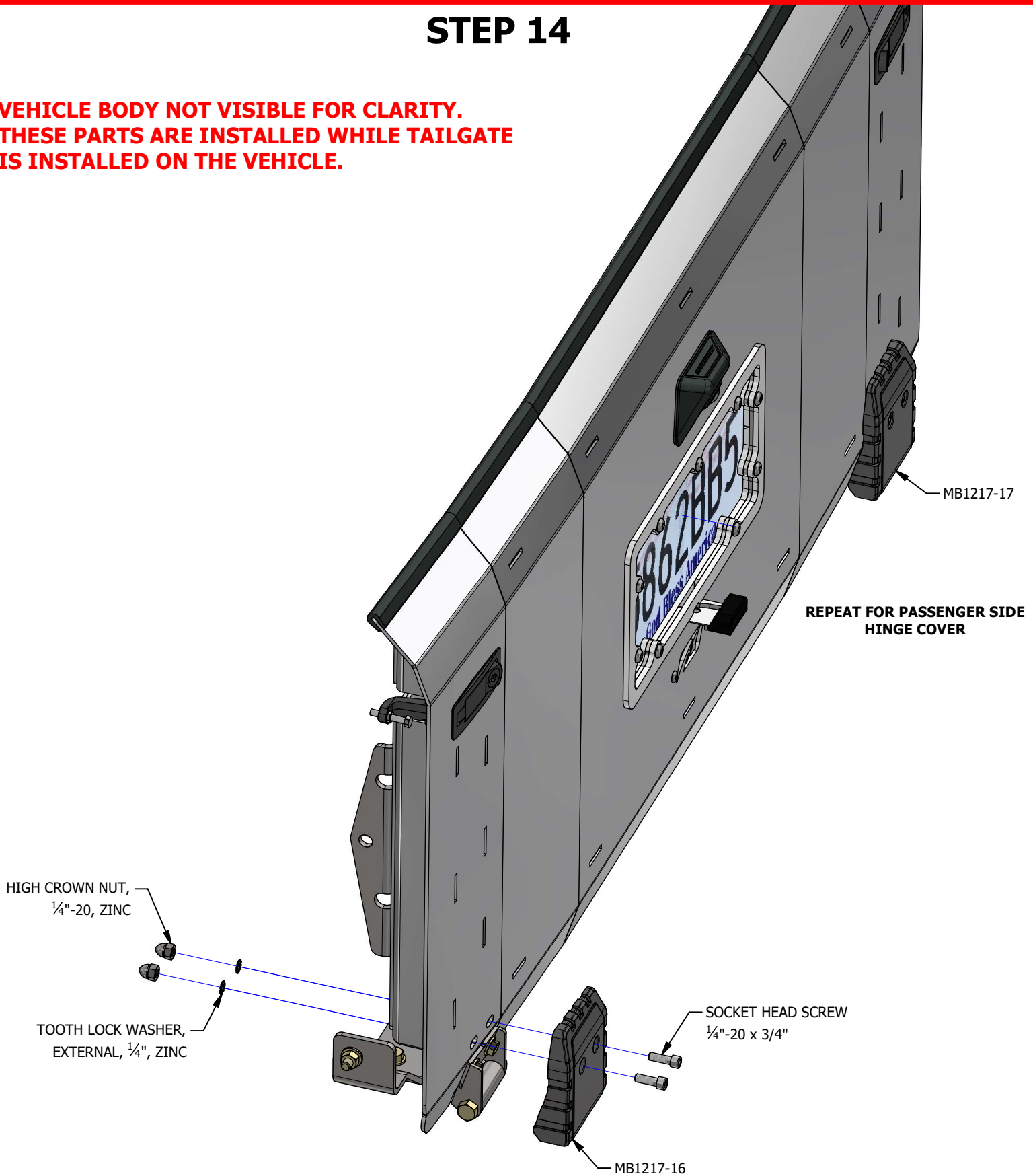

**MB1217 - Assembly Drop Down Tailgate for JL/JLU**

**STEP 15**

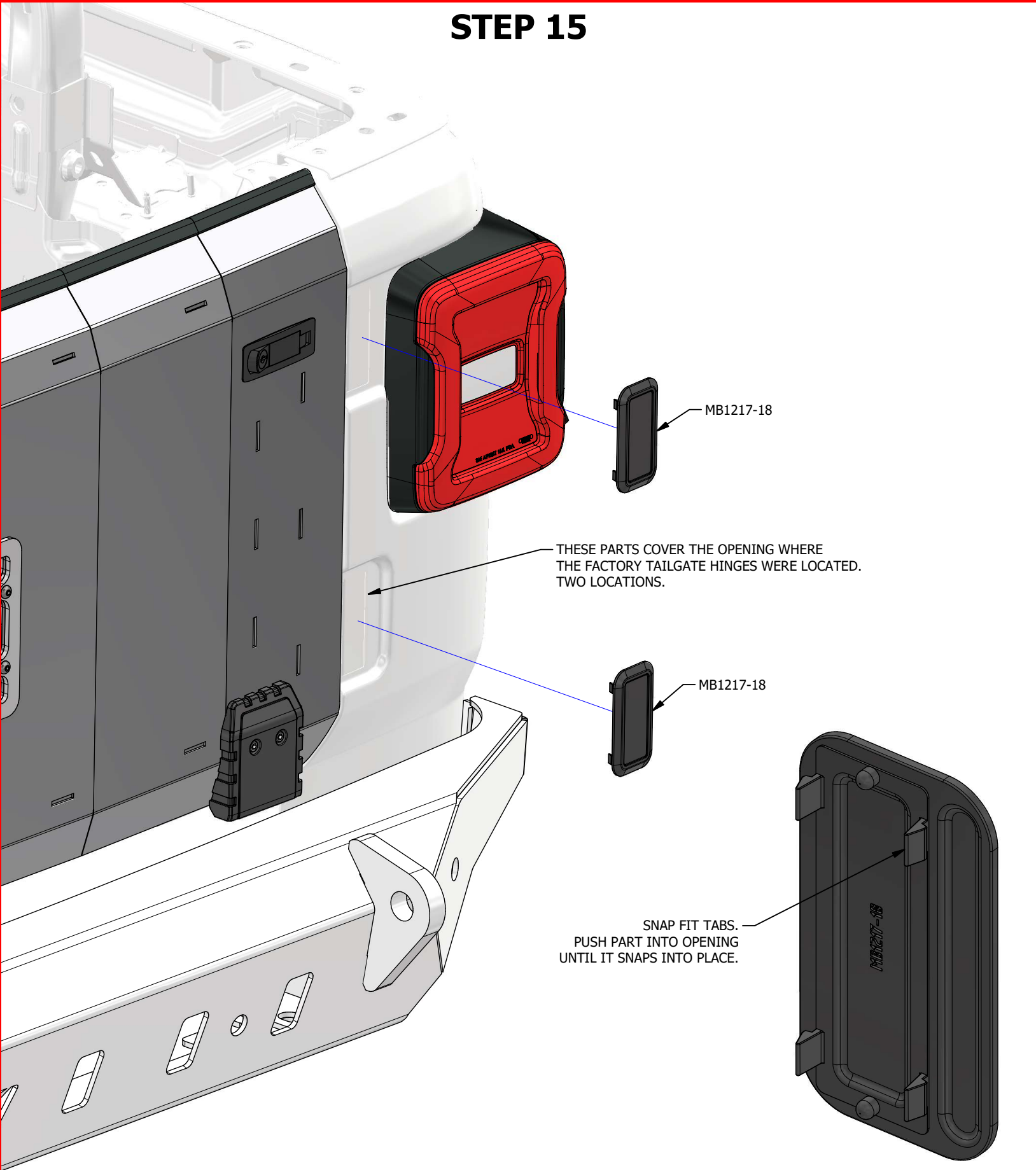

MB1217-18

THESE PARTS COVER THE OPENING WHERE THE FACTORY TAILGATE HINGES WERE LOCATED. TWO LOCATIONS.

MB1217-18

SNAP FIT TABS. PUSH PART INTO OPENING UNTIL IT SNAPS INTO PLACE.

**MB1217 - Assembly Drop Down Tailgate for JL/JLU****STEP 16**

TRIM ALL INTERIOR PANELS &  
RUBBER BULB SEALS TO ENSURE  
LATCHES FUNCTION UNOBSTRUCTED.