

## MB1217 - Assembly JL/JLU Fold Down Tailgate

# MB1217 - JL/JLU FOLD DOWN TAILGATE

FITS 2018 - PRESENT



## Preparation and Installation Guide for Your Jeep JL Fold Down Tailgate

Our new fold down tailgate is crafted from high-quality aluminum and shipped in bare metal. To achieve the best possible finish and ensure a flawless fit, we recommend the following procedure:

1. **Initial Fitting:** Before painting, assemble all components to ensure they fit perfectly on your Jeep JL. This step is crucial to avoid adjustments post-painting that could damage the finish.
2. **Disassembly and Cleaning:** Once you confirm the fit, disassemble and thoroughly clean all parts to prepare them for painting.
3. **Professional Painting:** For a superior and durable finish, we advise having the tailgate parts professionally prepared and painted by a reputable auto body shop. This ensures the paint is perfectly matched and applied evenly.
4. **Final Assembly:** After painting, reassemble the parts for the final installation. This process ensures all components align correctly and maintain their pristine condition.

### Additional Recommendations:

**Modification Notice:** Installation of this product involves modifications to your vehicle, including cutting into the body, trimming seals, and adjusting interior panels. After these modifications, it's important to touch up any exposed metal with suitable paint to prevent rust and ensure a seamless look.

By following these steps, you can enhance the aesthetics and functionality of your Jeep JL with confidence that the finish and fit are of the highest quality.

To further protect your investment, consider adding a non-slip marine grade flooring material to the removable interior panel. [Link to Amazon for Marine Grade Flooring](#)

# ASSEMBLY INSTRUCTIONS

## MB1217 - Assembly JL/JLU Fold Down Tailgate

## CONTENTS

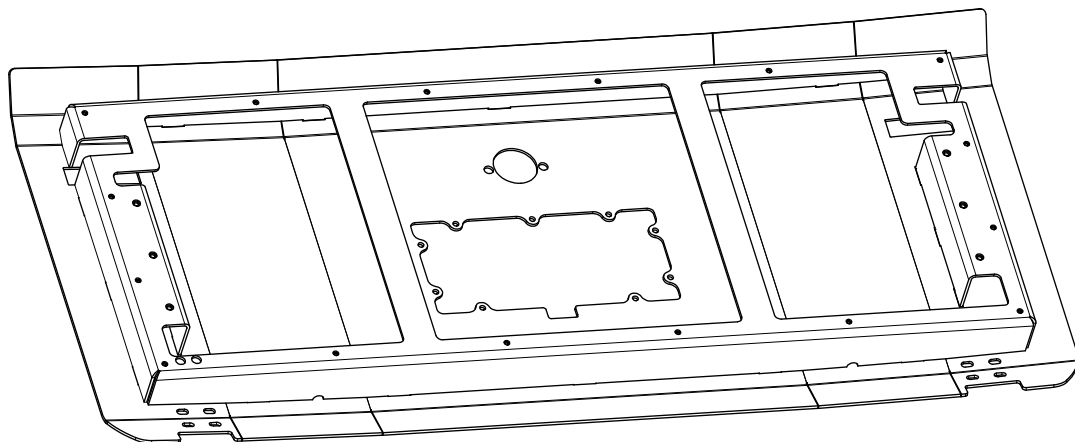
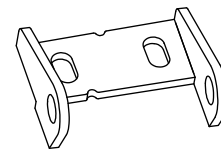
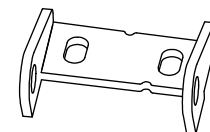
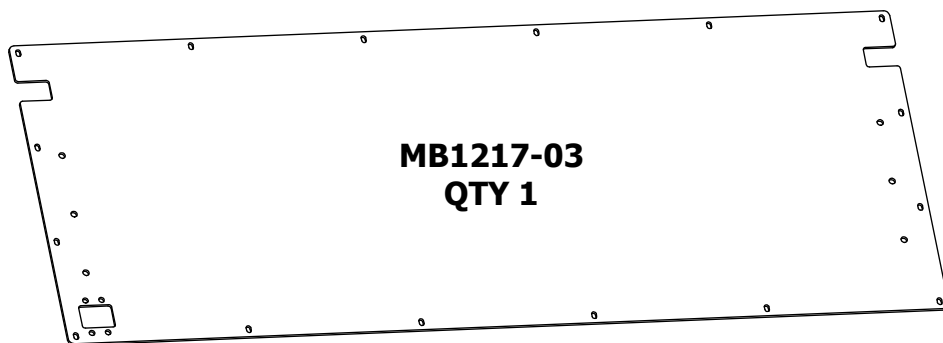
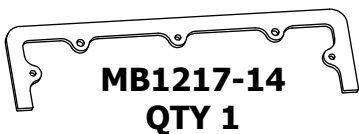
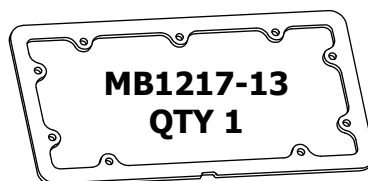
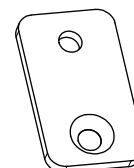
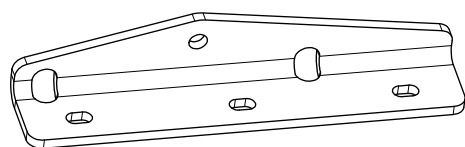
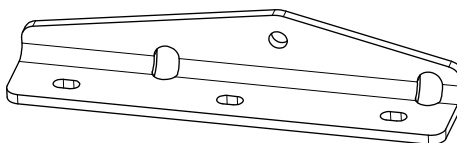
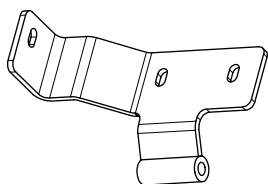
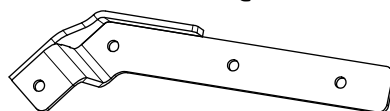
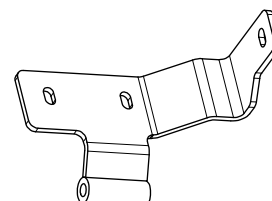
**MB1217 - TAILGATE WELDMENT  
QTY 1****MB1217 - HINGE DRIVER  
QTY 1****MB1217 - HINGE PASSENGER  
QTY 1****MB1217-03  
QTY 1****MB1217-11  
QTY 2****MB1217-22  
QTY 2****MB1217-14  
QTY 1****MB1217-13  
QTY 1****MB1217-20  
QTY 1****MB1217-12  
QTY 1****MB1217-10  
QTY 1****MB1217-10\_MIR  
QTY 1****MB1217-23  
QTY 1****MB1217 - HINGE PIVOT DRIVER  
QTY 1****MB1217 - CABLE MOUNT PASSENGER  
QTY 1****MB1217 - HINGE PIVOT PASSENGER  
QTY 1**

## MB1217 - Assembly JL/JLU Fold Down Tailgate

## CONTENTS



**MB1217 - EDGE TRIM**  
QTY 1 (45" LONG)



**MB1217 - GROMMET**  
QTY 1

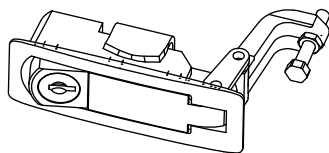

**MB1217 - LATCH**  
QTY 2

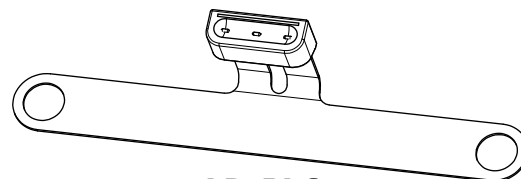

**LD-PL6**  
**LICENSE PLATE LED LIGHT**  
QTY 1



**MB1217-18**  
**FACTORY HINGE COVER**  
QTY 2

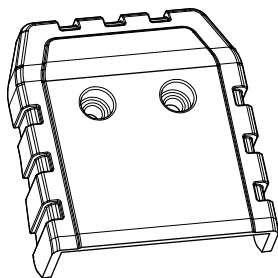

**MB1217-16**  
**HINGE COVER DRIVER**  
QTY 1

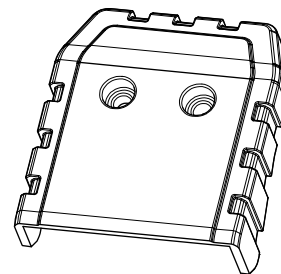

**MB1217-17**  
**HINGE COVER PASSENGER**  
QTY 1

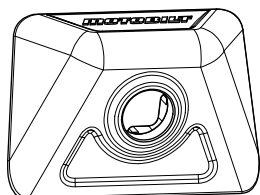

**MB1217-CM1**  
**CAMERA MOUNT**  
QTY 1

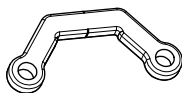

**MB1217-CM2**  
**CAMERA BRACKET**  
QTY 1



**MB1217-CM3**  
**CAMERA SPACER**  
QTY 1

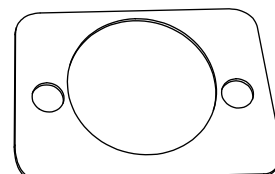

**MB1217 - GASKET**  
QTY 1

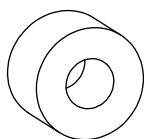

**MB1217 - TUBE SPACER**  
QTY 1

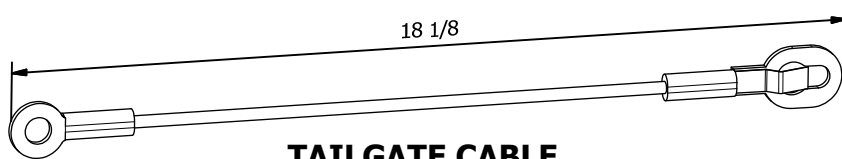

**TAILGATE CABLE**  
QTY 2

**MB1217 - Assembly JL/JLU Fold Down Tailgate**

# CONTENTS

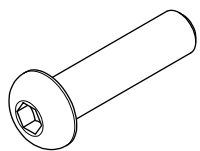

**BUTTON HEAD SCREW**  
 $\frac{1}{4}$ "-20 X 1" LONG  
 QTY 4

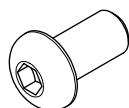

**BUTTON HEAD SCREW**  
 $\frac{1}{4}$ "-20 x  $\frac{1}{2}$ " LONG  
 QTY 5

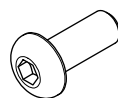

**BUTTON HEAD SCREW**  
 #10-24 x  $\frac{1}{2}$ " LONG  
 QTY 20

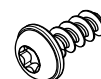

**THREAD FORMING SCREW**  
 M4 x 10mm LONG  
 QTY 4

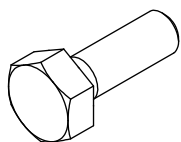

**HEX BOLT**  
 $\frac{1}{4}$ "-20 x  $\frac{3}{4}$ " LONG  
 QTY 10

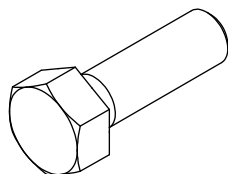

**HEX BOLT**  
 $\frac{5}{16}$ "-18 x 1" LONG  
 QTY 10

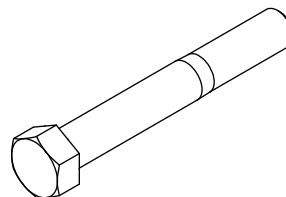

**HEX BOLT**  
 $\frac{3}{8}$ "-16 x 2- $\frac{3}{4}$ " LONG  
 QTY 2

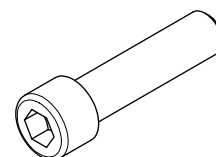

**SOCKET HEAD SCREW**  
 $\frac{1}{4}$ "-20 x  $\frac{3}{4}$ " LONG  
 QTY 4

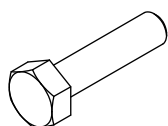

**HEX BOLT**  
 M6 x 1.0 x 25mm LONG  
 QTY 2

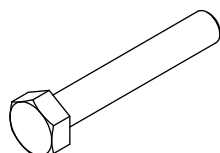

**HEX BOLT**  
 M8 x 1.25 x 50mm LONG  
 QTY 1

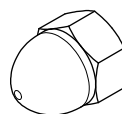

**HIGH CROWN NUT,**  
 $\frac{1}{4}$ "-20, ZINC  
 QTY 4



**TOOTH LOCK WASHER,**  
 EXTERNAL,  $\frac{1}{4}$ ", ZINC  
 QTY 4



**FLAT WASHER**  
 M5  
 QTY 2



**FLAT WASHER**  
 $\frac{1}{4}$ "  
 QTY 20

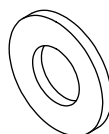

**FLAT WASHER**  
 $\frac{5}{16}$ "  
 QTY 20

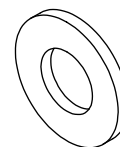

**FLAT WASHER**  
 $\frac{3}{8}$ "  
 QTY 1

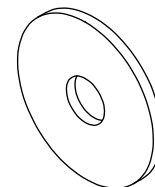

**FENDER WASHER**  
 $\frac{1}{4}$ " x 1- $\frac{1}{4}$ " OD  
 QTY 2



**NYLOCK NUT**  
 #10-24  
 QTY 4

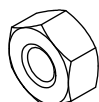

**NYLOCK NUT**  
 $\frac{1}{4}$ "-20  
 QTY 20

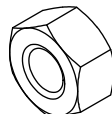

**NYLOCK NUT**  
 $\frac{5}{16}$ "-18  
 QTY 10

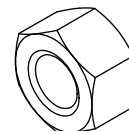

**NYLOCK NUT**  
 $\frac{3}{8}$ "-16  
 QTY 2

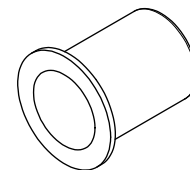

**RIVNUT**  
 $\frac{5}{16}$ "-18  
 QTY 4

THIS FASTENER LIST DOES INCLUDE A FEW SPARES FOR SOME FASTENERS SHOWN, THUS, YOU MAY HAVE SOME EXTRA FASTENERS LEFT OVER AFTER ASSEMBLY

**MB1217 - Assembly JL/JLU Fold Down Tailgate**

**STEP 1**

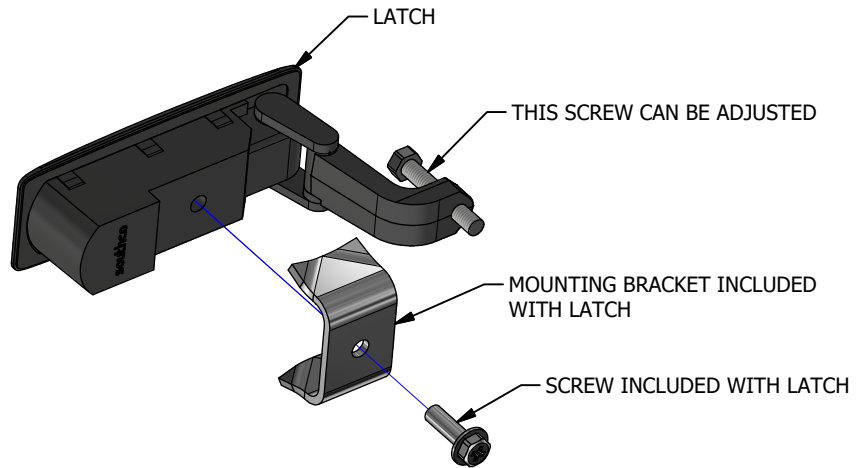
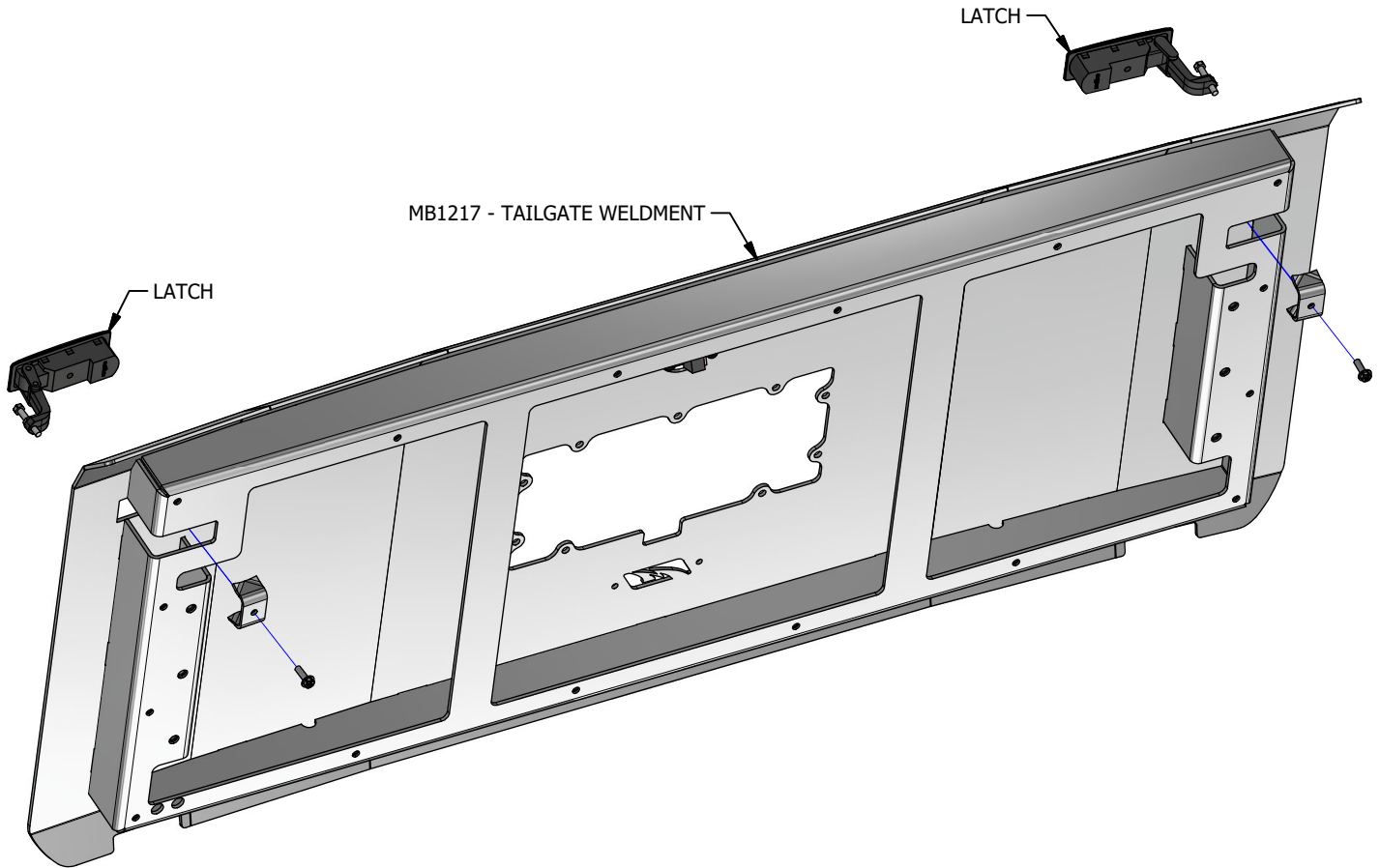

**MB1217 - LATCH**

**MB1217 - Assembly JL/JLU Fold Down Tailgate**

**STEP 2**

INSTALL BACKUP CAMERA THROUGH CUTOUTS IN THE TAILGATE (SEE TWO DIFFERENT CAMERA STYLES BELOW)

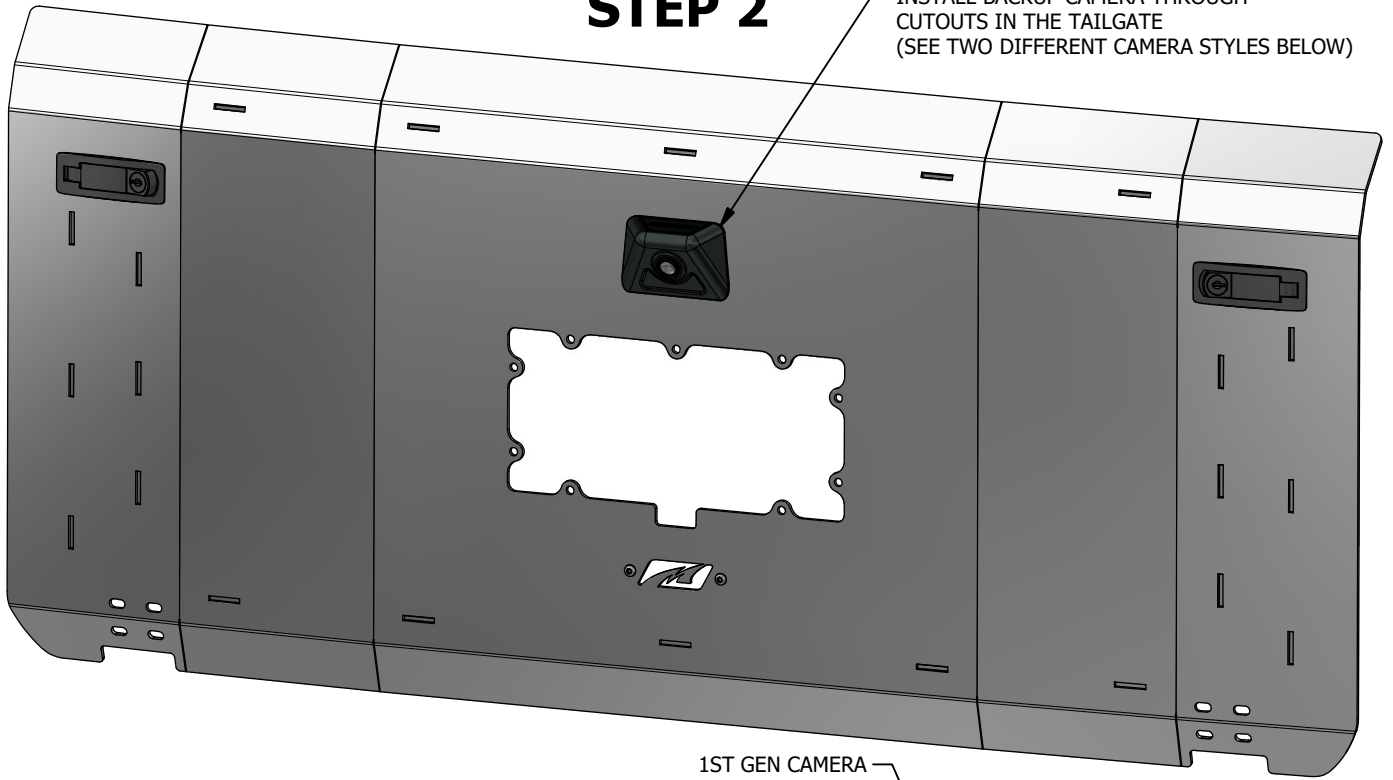

**IDENTIFYING YOUR CAMERA**

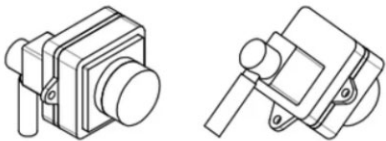

**2018-2020 BACK UP CAMERA**

MOPAR PART# 68452959AB; 68288397AC; 68414411AA; 68452959AA

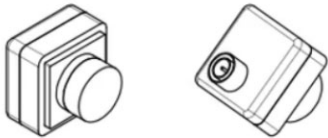

**2021+ BACK UP CAMERA**

MOPAR PART# 04672852AB; 04672852AB

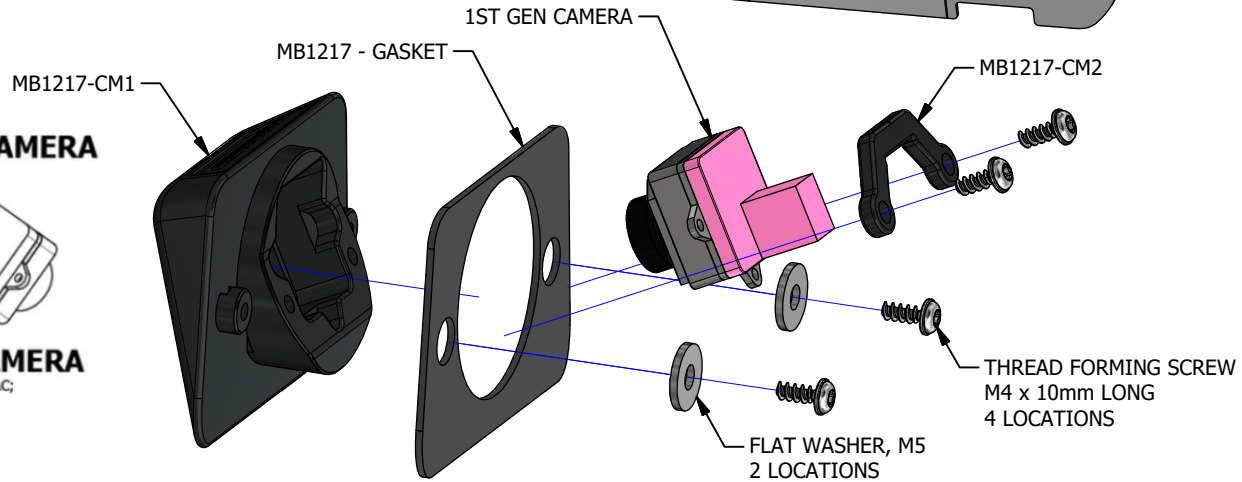

**1ST GEN CAMERA ASSEMBLY**

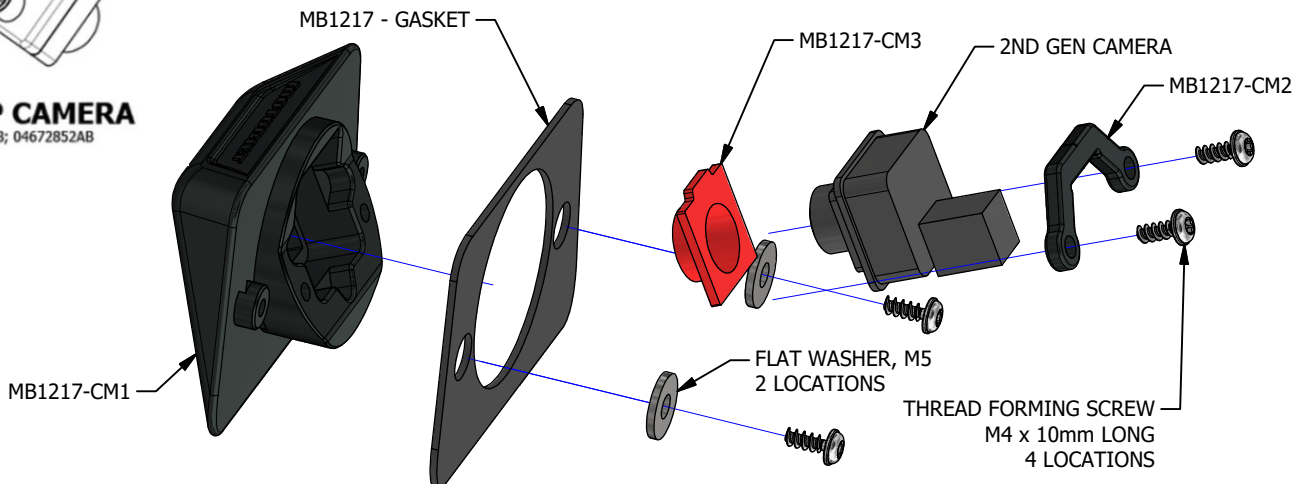

**2ND GEN CAMERA ASSEMBLY**

**MB1217 - Assembly JL/JLU Fold Down Tailgate**

**STEP 3**

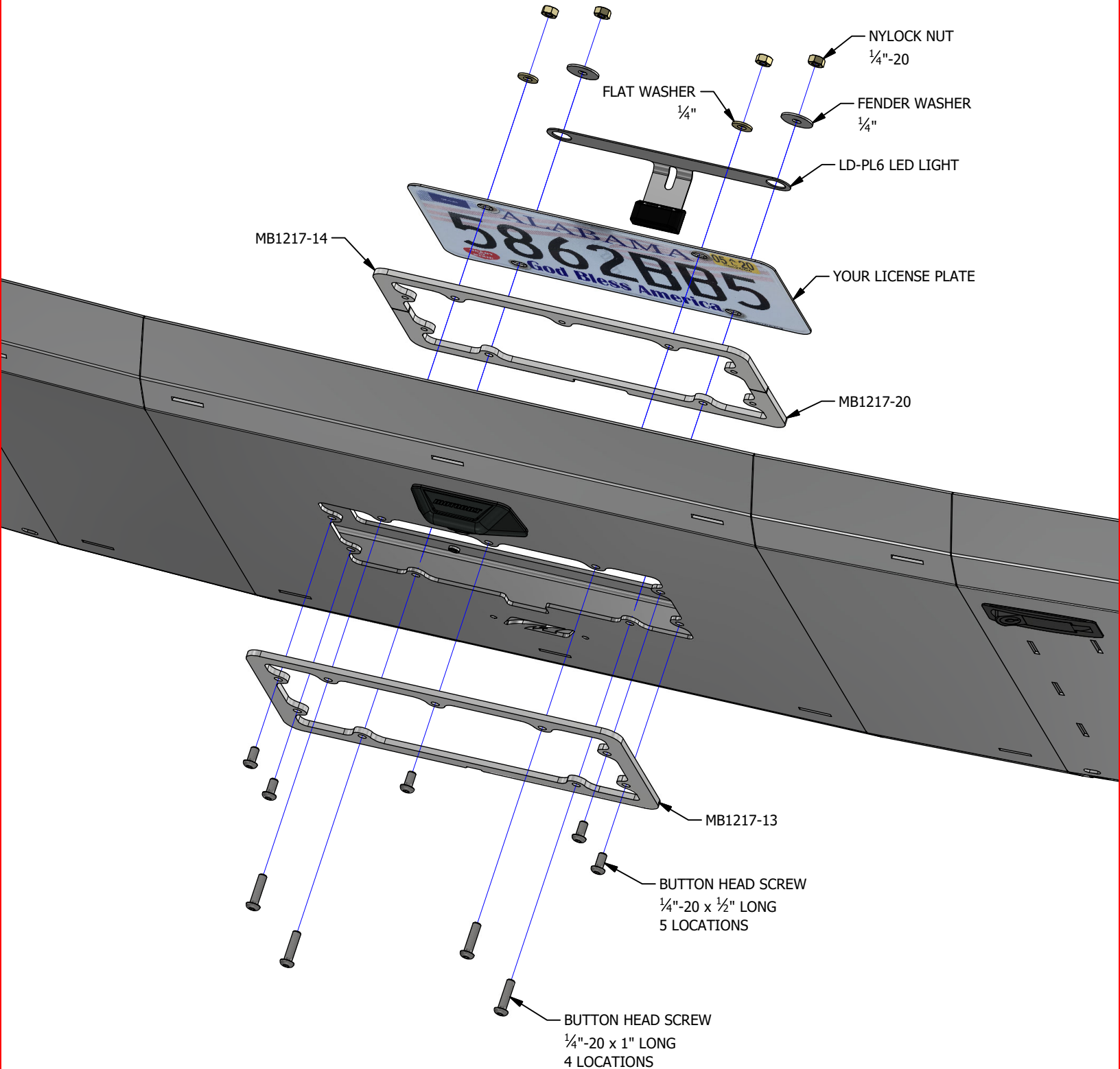

**MB1217 - Assembly JL/JLU Fold Down Tailgate**

**STEP 4**

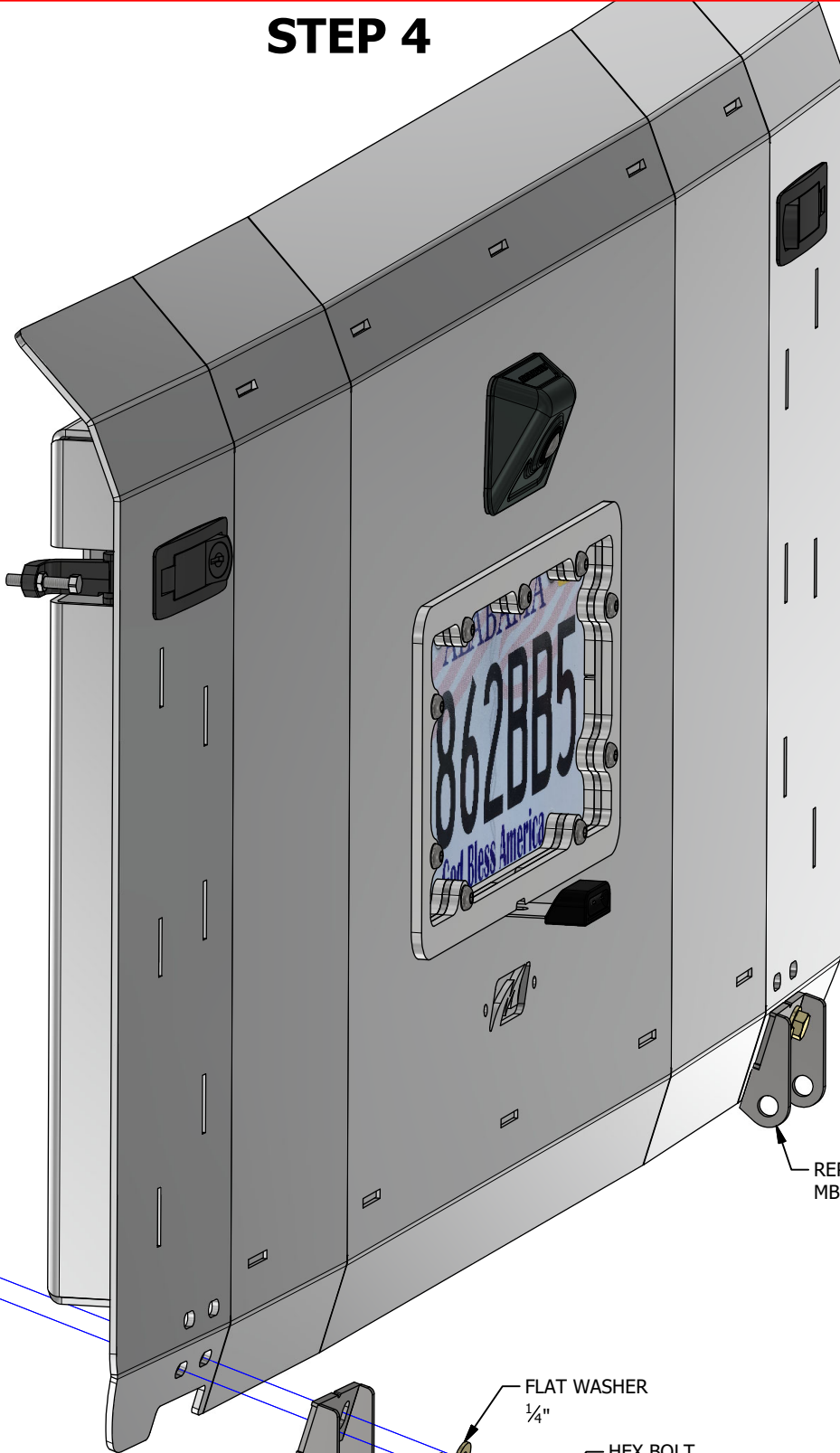

HIGH CROWN NUT,  
1/4"-20, ZINC

TOOTH LOCK WASHER,  
EXTERNAL, 1/4", ZINC

MB1217 - HINGE DRIVER

FLAT WASHER  
1/4"

HEX BOLT  
1/4"-20 x 3/4" LONG

REPEAT FOR  
MB1217 - HINGE PASSENGER



**MB1217 - Assembly JL/JLU Fold Down Tailgate**

**STEP 5**

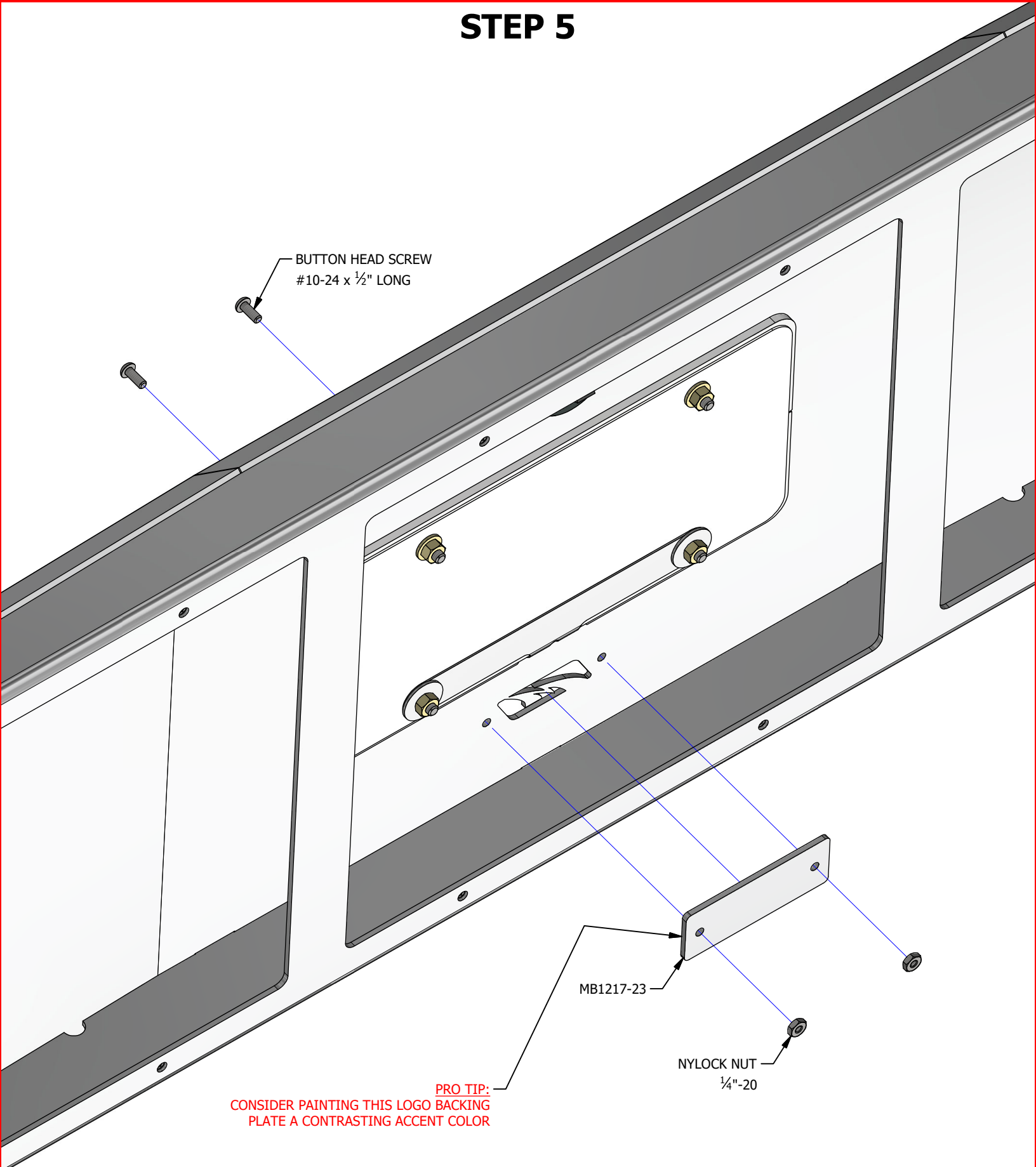

BUTTON HEAD SCREW  
#10-24 x 1/2" LONG

MB1217-23

NYLOCK NUT  
1/4"-20

**PRO TIP:**  
CONSIDER PAINTING THIS LOGO BACKING  
PLATE A CONTRASTING ACCENT COLOR

## MB1217 - Assembly JL/JLU Fold Down Tailgate

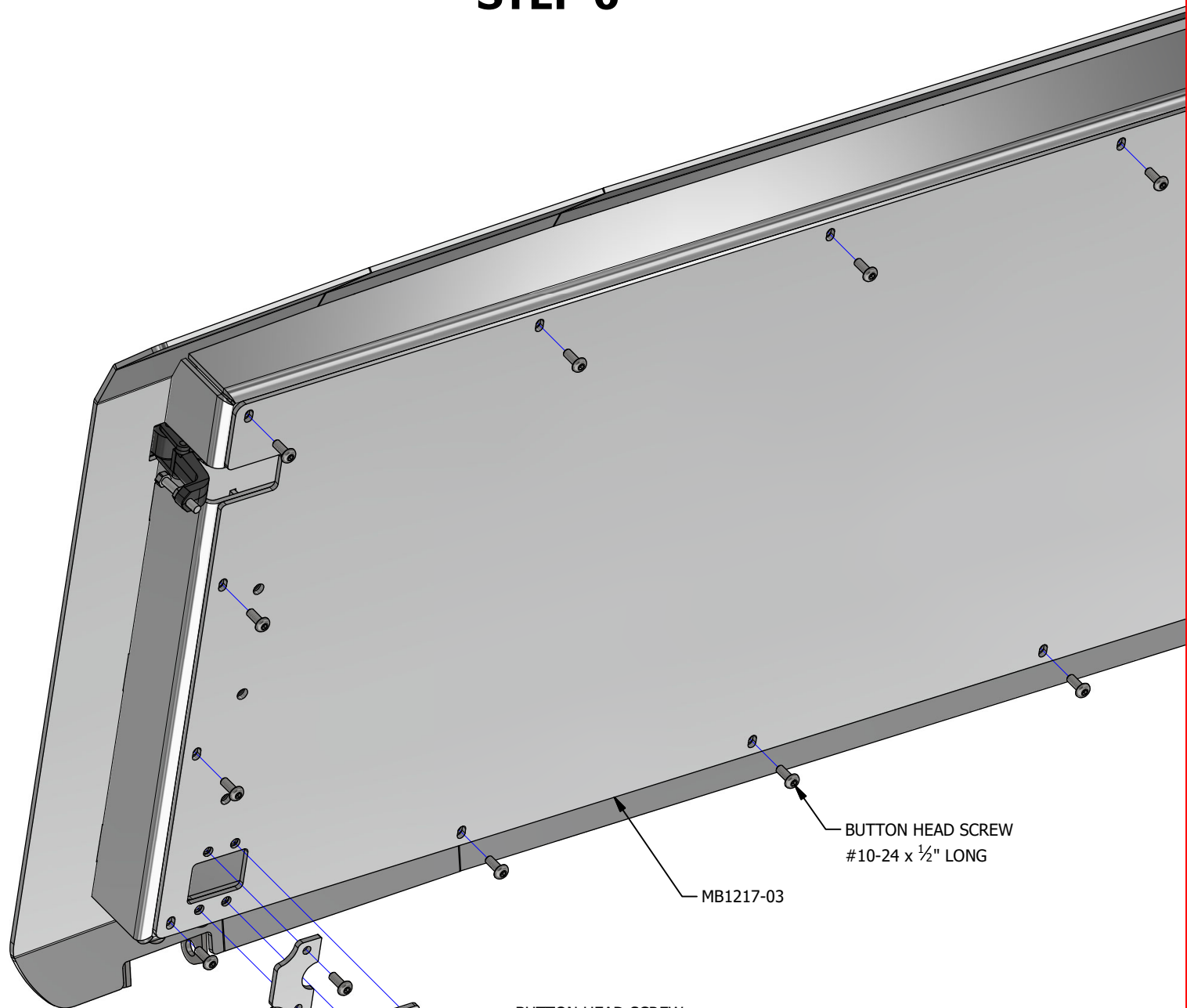
**STEP 6**

— BUTTON HEAD SCREW  
#10-24 x 1/2" LONG

— MB1217-03

— BUTTON HEAD SCREW  
#10-24 x 1/2" LONG

— MB1217-22

— MB1217-22

— MB1217 - GROMMET

NOTE: FEED 12V WIRING FOR LICENSE PLATE LIGHT & CANBUS CABLE FOR REAR FACING CAMERA THROUGH THE GROMMET PRIOR TO INSTALLING THIS ASSEMBLY. ALTERNATIVELY, ASSEMBLE AS SHOWN, THEN REMOVE THE INTERIOR PANEL & THEN FEED WIRING & CABLING.

**MB1217 - Assembly JL/JLU Fold Down Tailgate**

**STEP 7**

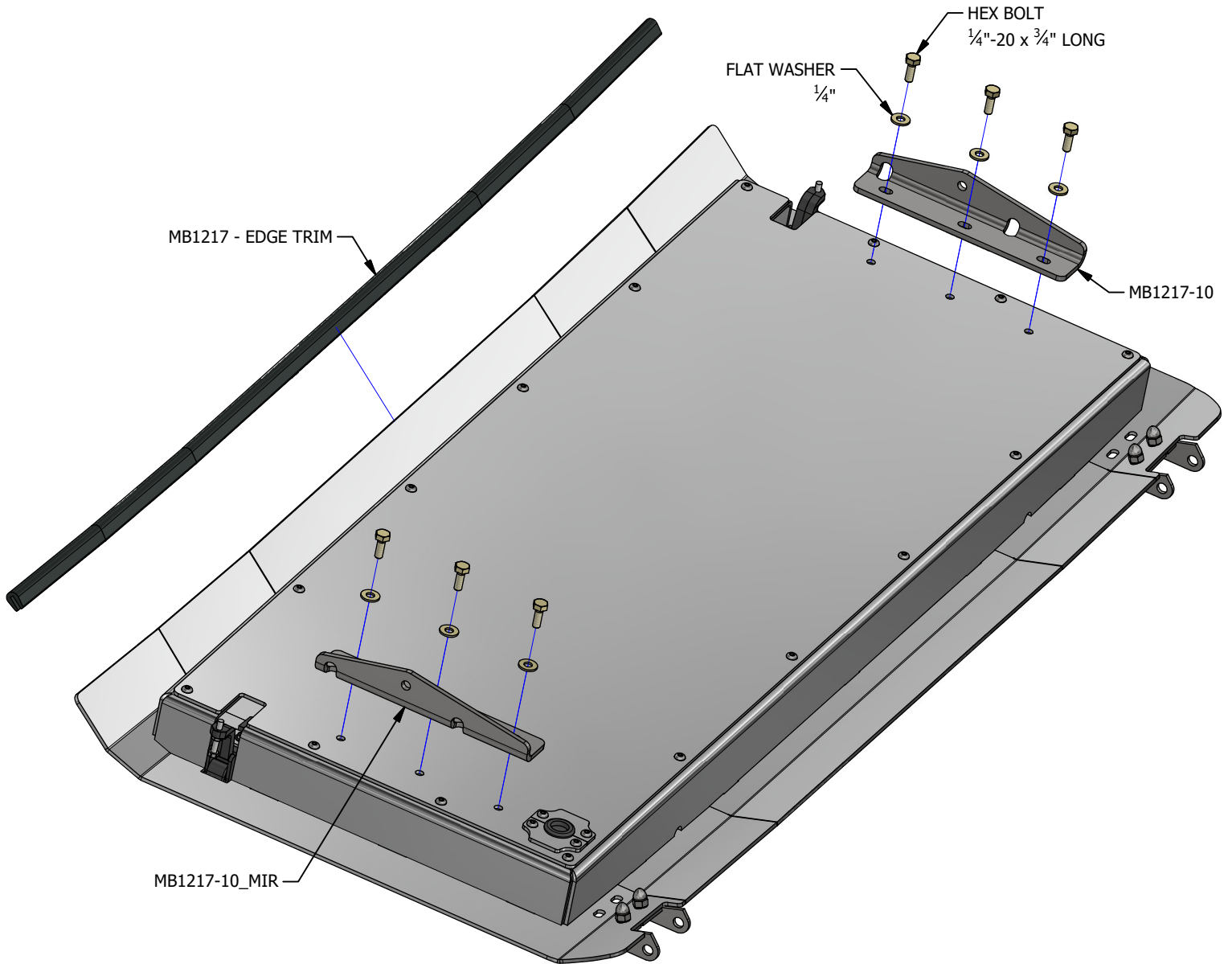

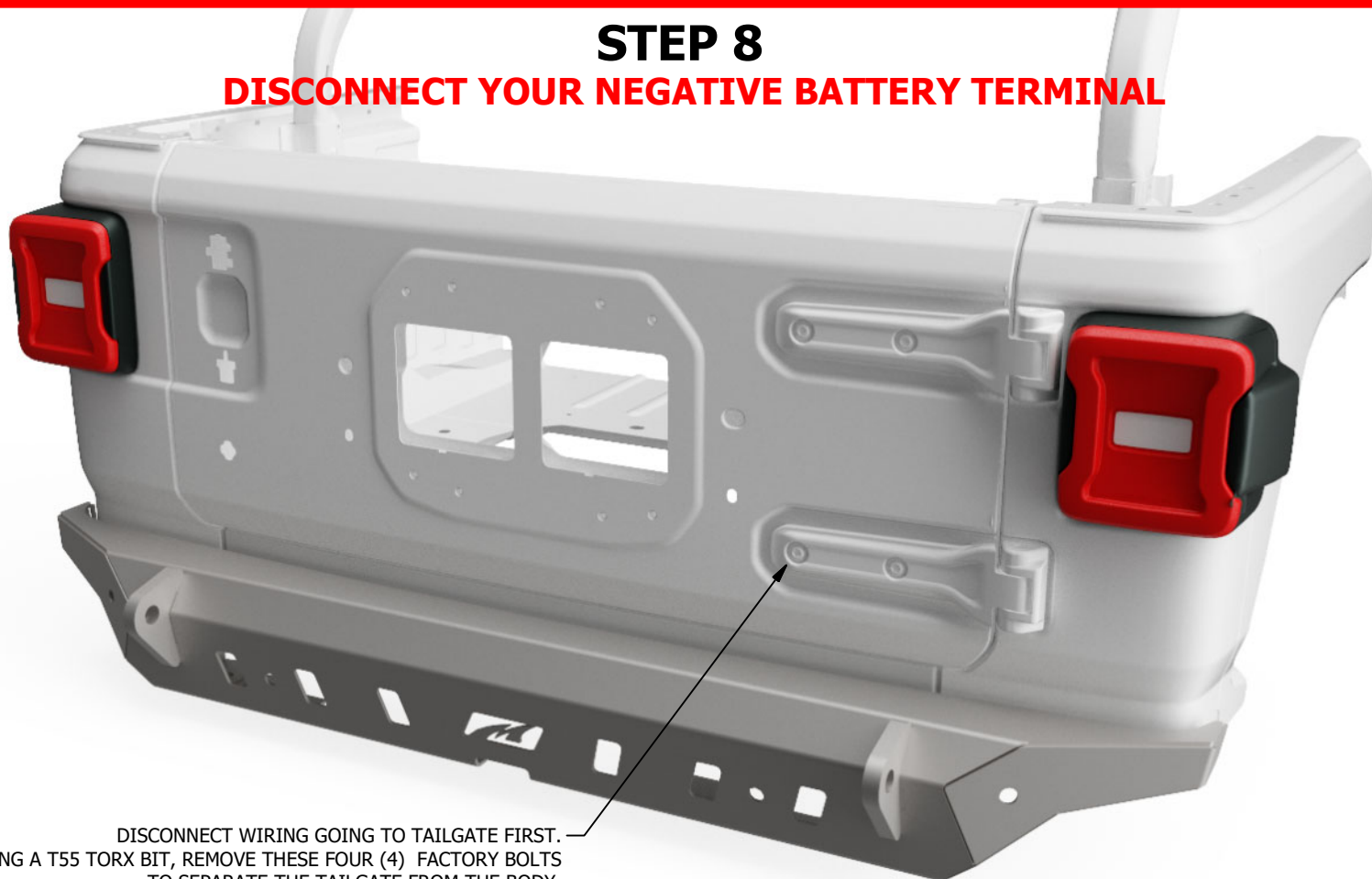
**MB1217 - Assembly JL/JLU Fold Down Tailgate****STEP 8****DISCONNECT YOUR NEGATIVE BATTERY TERMINAL**

DISCONNECT WIRING GOING TO TAILGATE FIRST.  
USING A T55 TORX BIT, REMOVE THESE FOUR (4) FACTORY BOLTS  
TO SEPARATE THE TAILGATE FROM THE BODY.  
UNLATCH & REMOVE THE FACTORY TAILGATE.

USING A 13mm SOCKET, REMOVE THE INTERNAL BOLTS FOR  
THE FACTORY TAILGATE HINGES. REMOVE THE FACTORY HINGES  
FROM THE BODY.

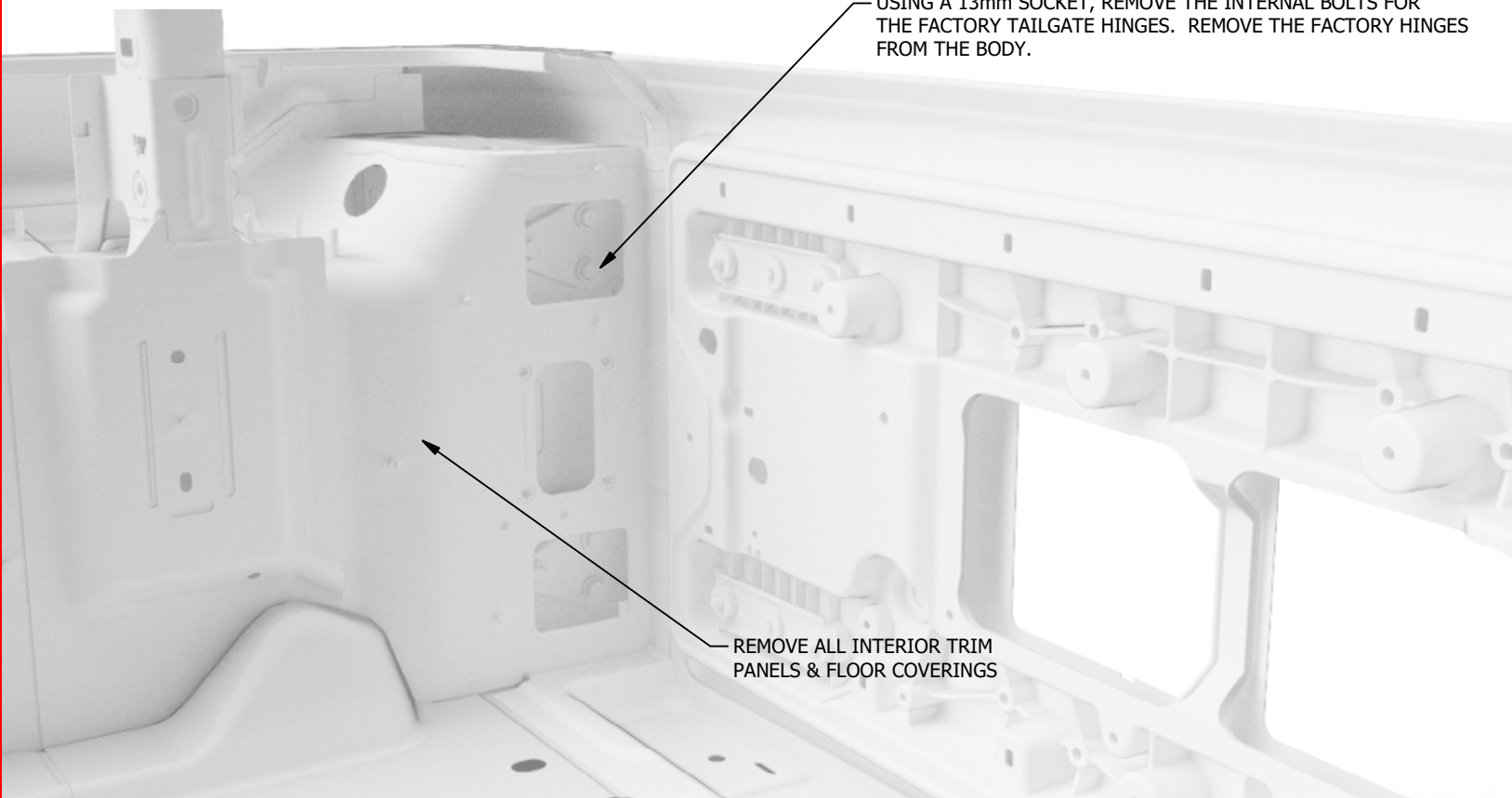

REMOVE ALL INTERIOR TRIM  
PANELS & FLOOR COVERINGS

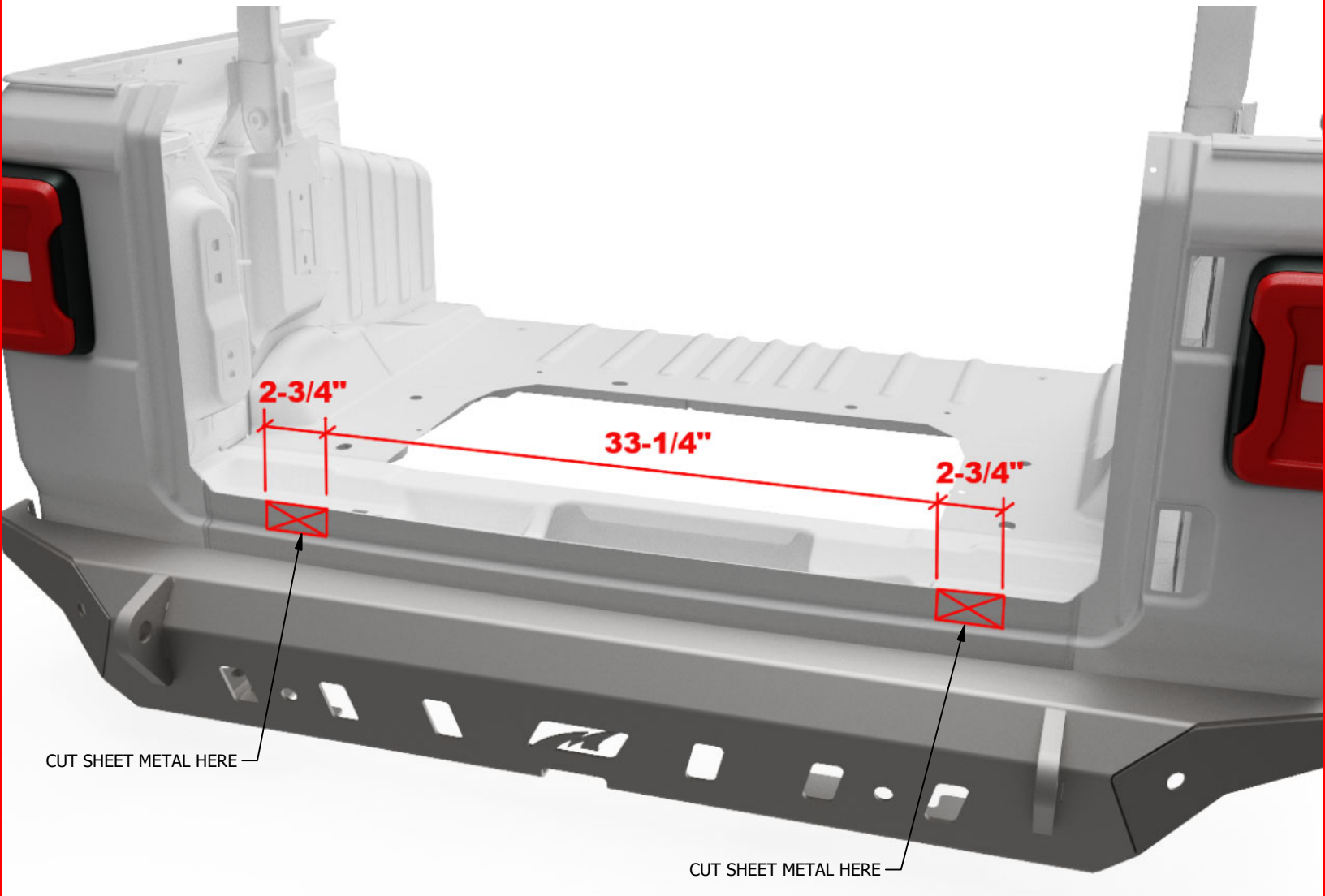
**MB1217 - Assembly JL/JLU Fold Down Tailgate****STEP 9****LIFT THE FACTORY BULB SEAL. MARK & CUT SHEET METAL AS SHOWN**

**MB1217 - Assembly JL/JLU Fold Down Tailgate**

**STEP 10**



LOOSELY INSTALL "CABLE MOUNT PASSENGER" USING HEX BOLT, M6 x 1.0 x 25mm LONG & ¼" FLAT WASHER. THERE ARE TWO FACTORY RIVETS IN THE SHEET METAL IN THIS AREA TO FASTEN THIS BRACKET.

MB1217 - CABLE MOUNT PASSENGER

**AFTER HOLE IS MARKED, REMOVE BRACKET & INSTALL 5/16" RIVNUT, THEN LOOSELY ASSEMBLE ALL PARTS. USE 5/16" FASTENERS FOR "HINGE PIVOT PASSENGER"**

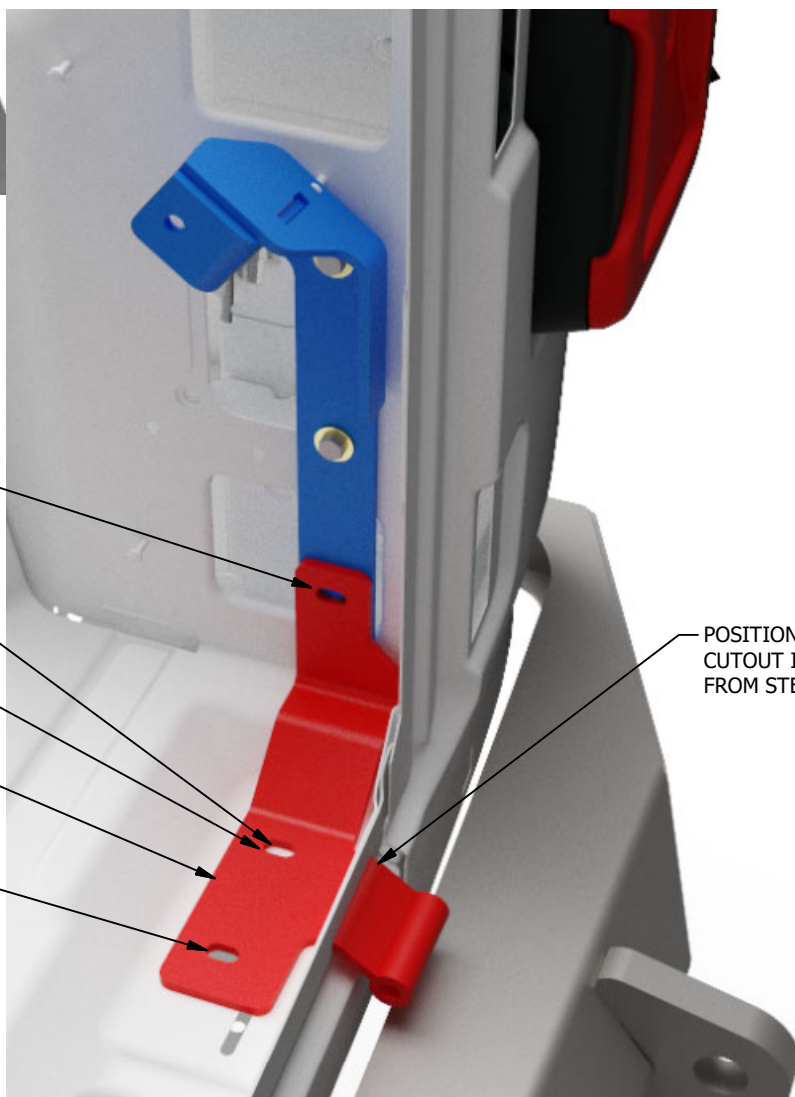

ALIGN SLOT WITH HOLE IN BRACKET

MARK THIS HOLE

DRILL 17/32"Ø HOLE & INSTALL 5/16" RIVNUT HERE

MB1217 - HINGE PIVOT PASSENGER

THERE IS A FACTORY THRU HOLE IN THIS LOCATION. ALIGN SLOT IN BRACKET WITH FACTORY THRU HOLE.

POSITION BRACKET IN THE CUTOUT IN SHEET METAL FROM STEP 9

**MB1217 - Assembly JL/JLU Fold Down Tailgate**

**STEP 11**

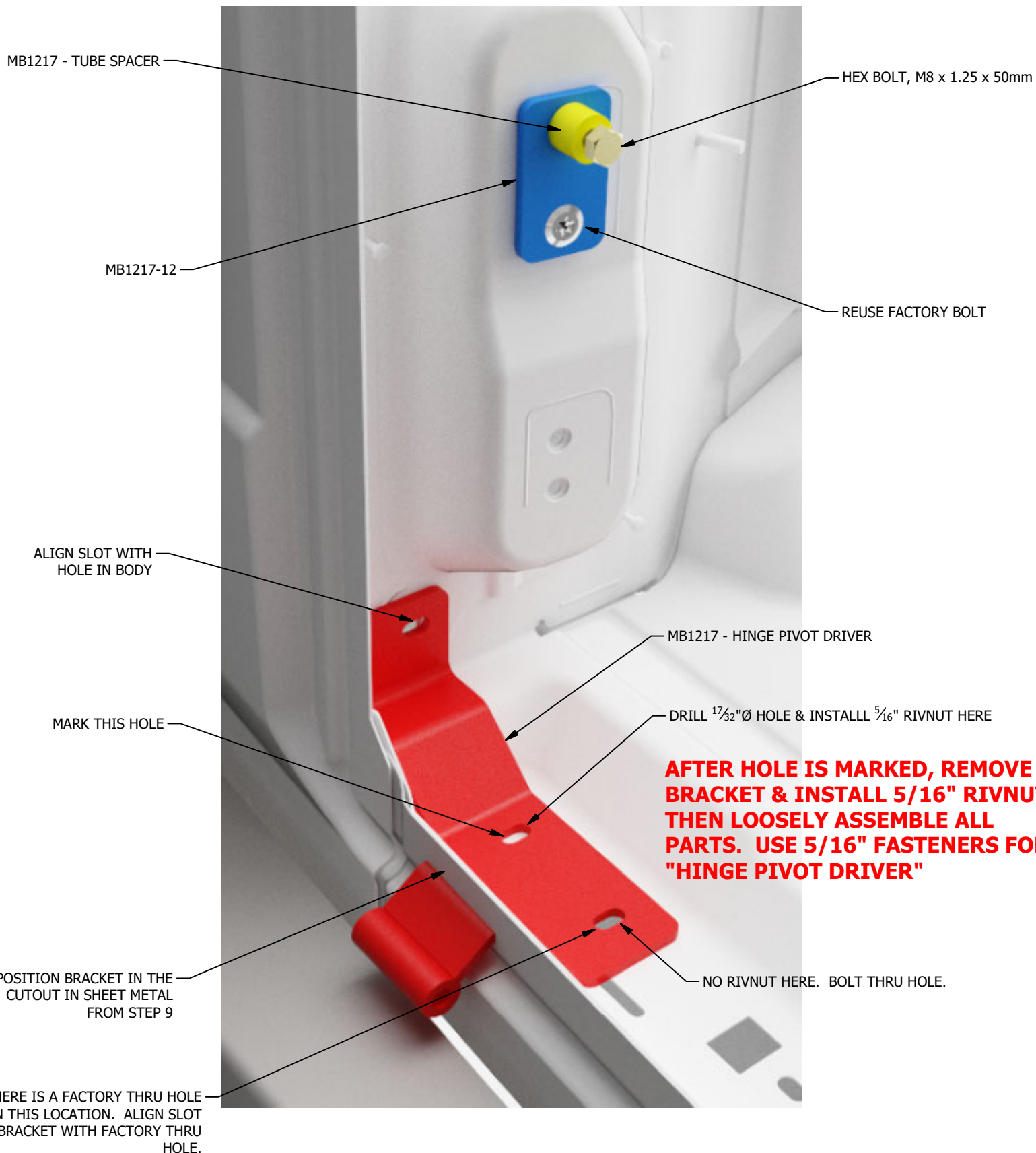

**MB1217 - Assembly JL/JLU Fold Down Tailgate****STEP 12**

**AFTER CHECKING & ADJUSTING ALL GAPS, REVEALS, BODY LINES & LATCH FUNCTIONS, TIGHTEN ALL HINGE BRACKETS**

CHECK FUNCTION  
OF BOTH LATCHES

ADJUST BOLTS FOR EVEN  
GAP & REVEAL ALL AROUND



HEX BOLT, 3/8-16 x 2-3/4"  
WITH 3/8"-16 NYLOCK NUT  
2 LOCATIONS

LINE UP BODY LINES

CHECK GAPS & REVEALS



**MB1217 - Assembly JL/JLU Fold Down Tailgate**

**STEP 13**

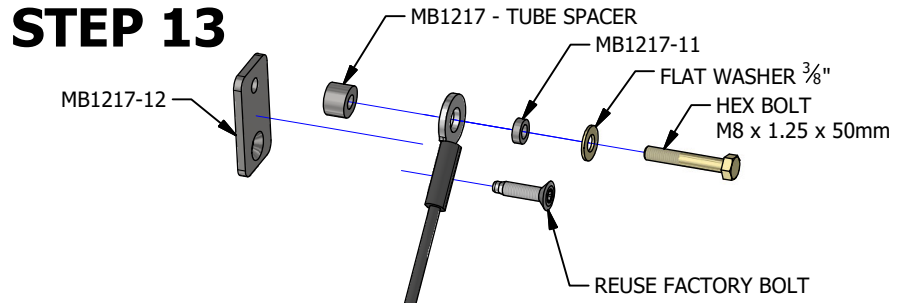

TAILGATE CABLE

**CABLE ASSEMBLY DRIVER**

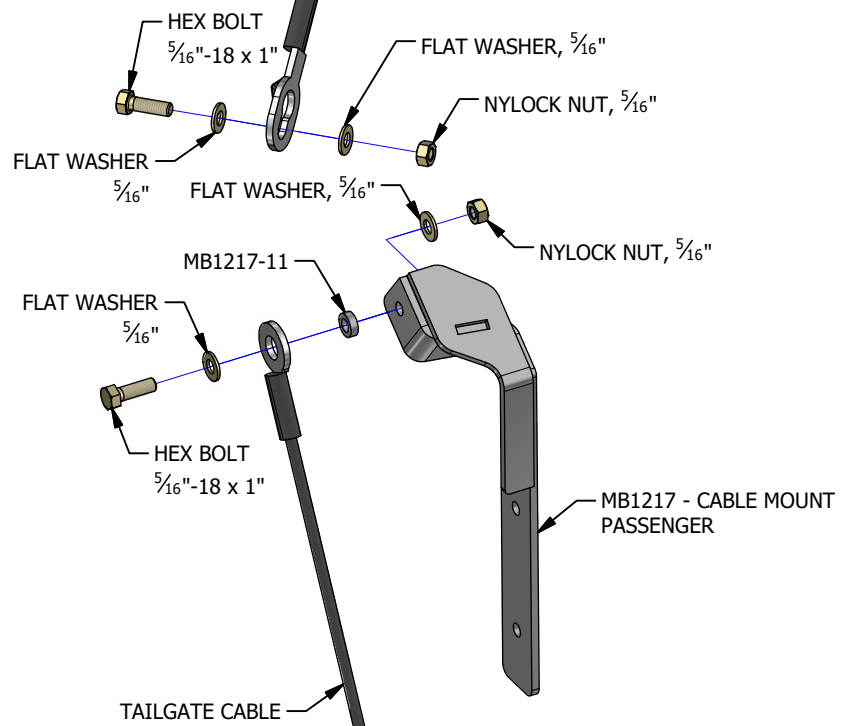

**CABLE ASSEMBLY PASSENGER**

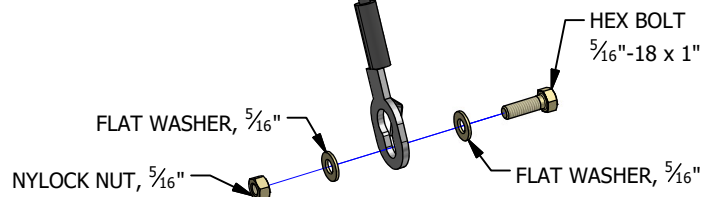

**MB1217 - Assembly JL/JLU Fold Down Tailgate**

**STEP 14**

**VEHICLE BODY NOT VISIBLE FOR CLARITY.  
THESE PARTS ARE INSTALLED WHILE TAILGATE  
IS INSTALLED ON THE VEHICLE.**

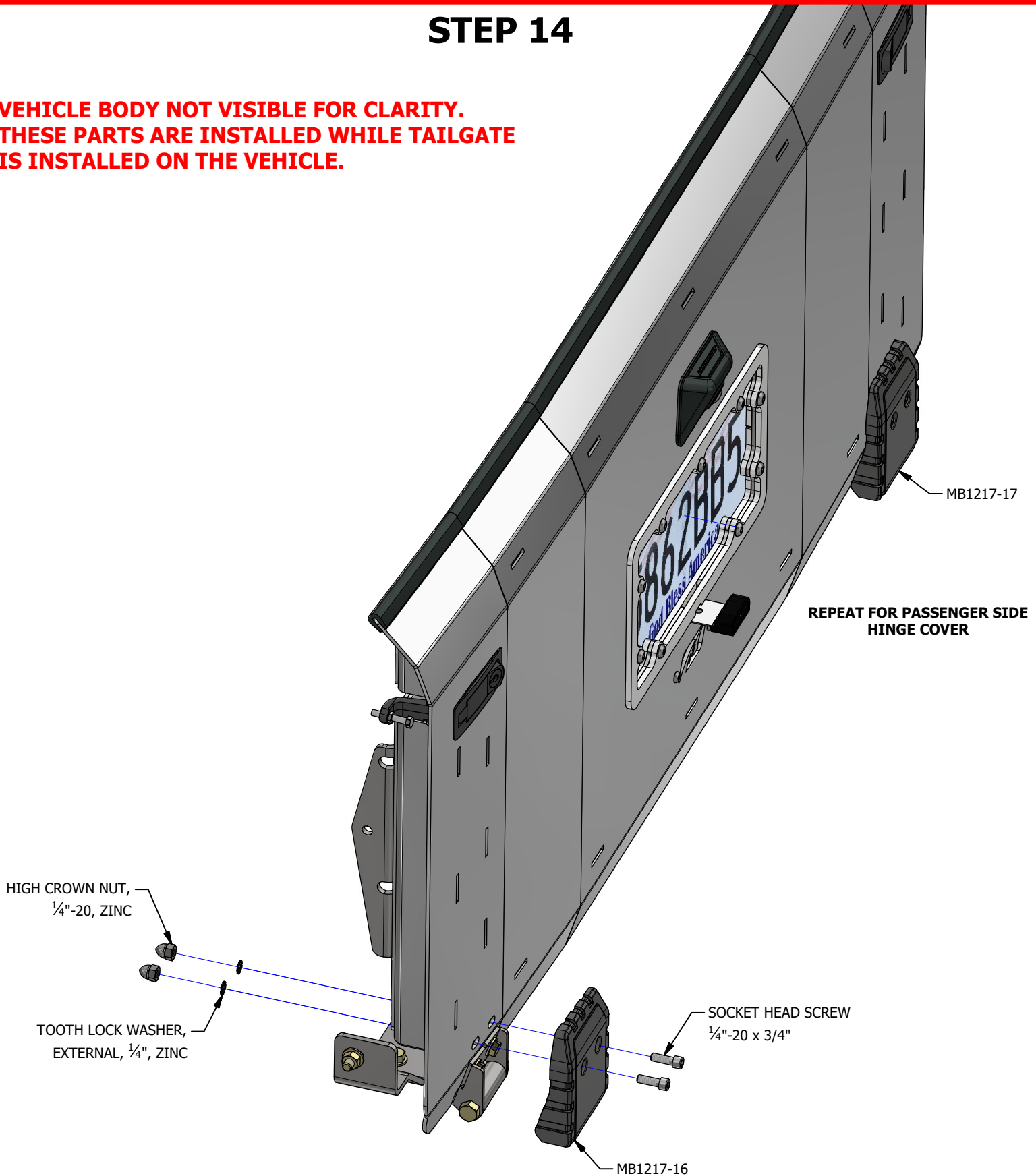

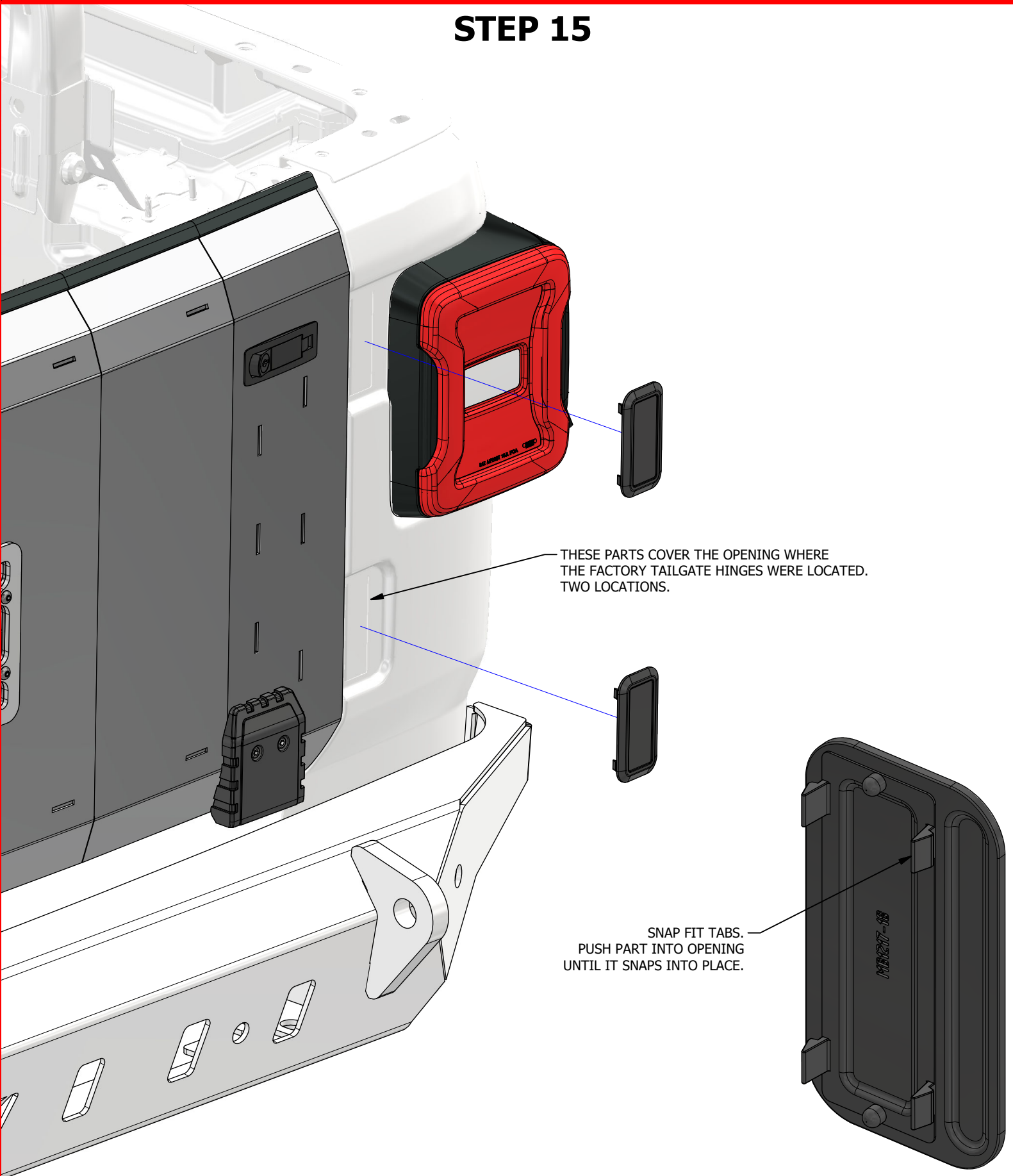
**MB1217 - Assembly JL/JLU Fold Down Tailgate****STEP 15**

**MB1217 - Assembly JL/JLU Fold Down Tailgate****STEP 16**

TRIM ALL INTERIOR PANELS &  
RUBBER BULB SEALS TO ENSURE  
LATCHES FUNCTION UNOBSTRUCTED.