

MB1211 JLU 392 Skid System**ASSEMBLY INSTRUCTIONS**

This product is specifically designed to fit the Jeep JLU 4 Door equipped with **392 ENGINE ONLY** & the factory **392 EXHAUST SYSTEM ONLY**. This product will **NOT** fit other Jeep JLU models with different engines & different exhaust systems.

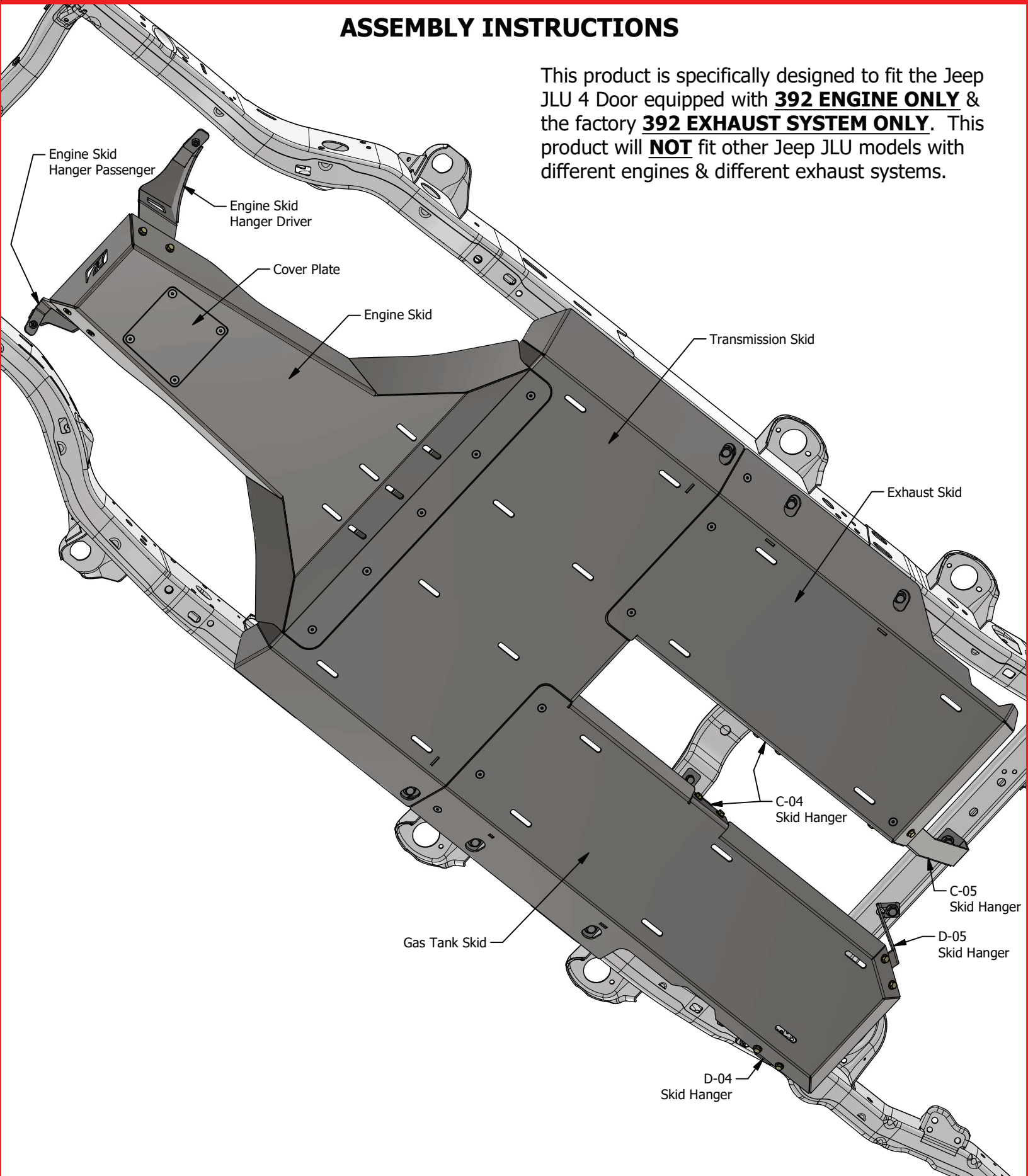
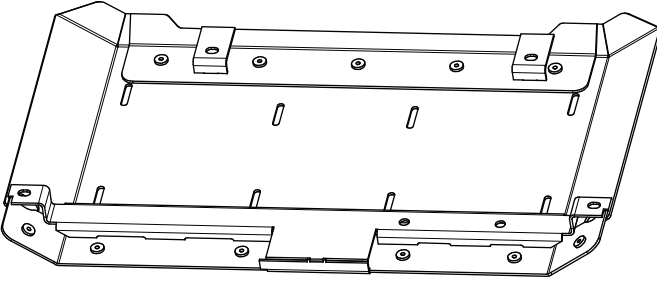

MB1211 JLU 392 Skid System
CONTENTS

**MB1211
Transmission Skid
Qty 1**

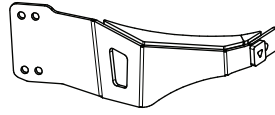

**MB1211
Engine Skid
Hanger Driver
Qty 1**

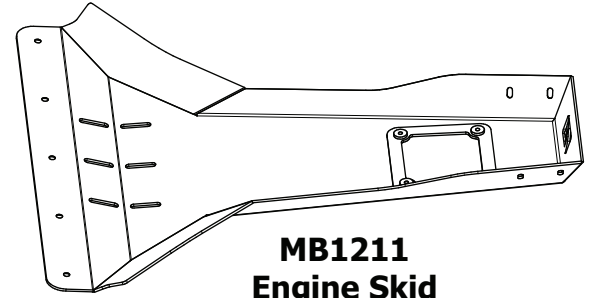

**MB1211
Engine Skid
Qty 1**

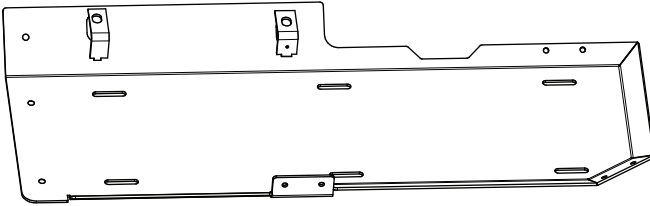

**MB1211
Gas Tank Skid
Qty 1**



**MB1211
Engine Skid
Hanger Passenger
Qty 1**

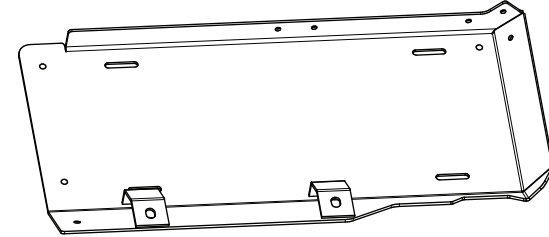

**MB1211
Exhaust Skid
Qty 1**

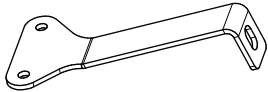

**MB1211-C-04
Skid Hanger
Qty 2**

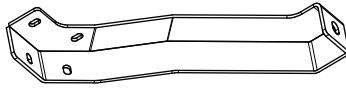

**MB1211-C-05
Skid Hanger
Qty 1**

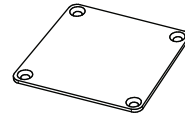

**MB1211-B-01
Cover Plate
Qty 1**

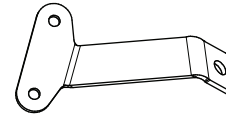

**MB1211-D-04
Skid Hanger
Qty 1**



**MB1211-D-05
Skid Hanger
Qty 1**

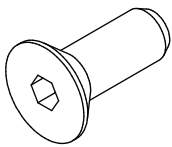

**Countersunk Screw
3/8"-16 x 1.00"
Qty 18
(includes 2 spares)**

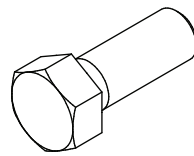

**Hex Bolt
3/8"-16 x 1.00"
Qty 15
(includes 2 spares)**



**Flat Washer
3/8"
Qty 35
(includes 2 spares)**

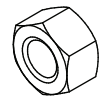

**Nylock Nut
3/8"-16
Qty 18
(includes 2 spares)**

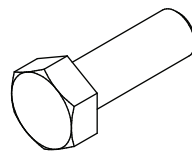

**Hex Bolt
M10 x 1.50 x 25mm
Qty 2**

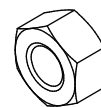

**Nylock Nut
M10 x 1.50
Qty 2**

MB1211 JLU 392 Skid System**ASSEMBLY - STEP 1**

1. We recommend to test fit all Motobilt parts on the vehicle **BEFORE** painting or powder coating them.
2. Remove the factory transmission & transfer case guards, as shown below. NOTE: Save all factory fasteners, as many will be reused to install your new Motobilt Skid System.

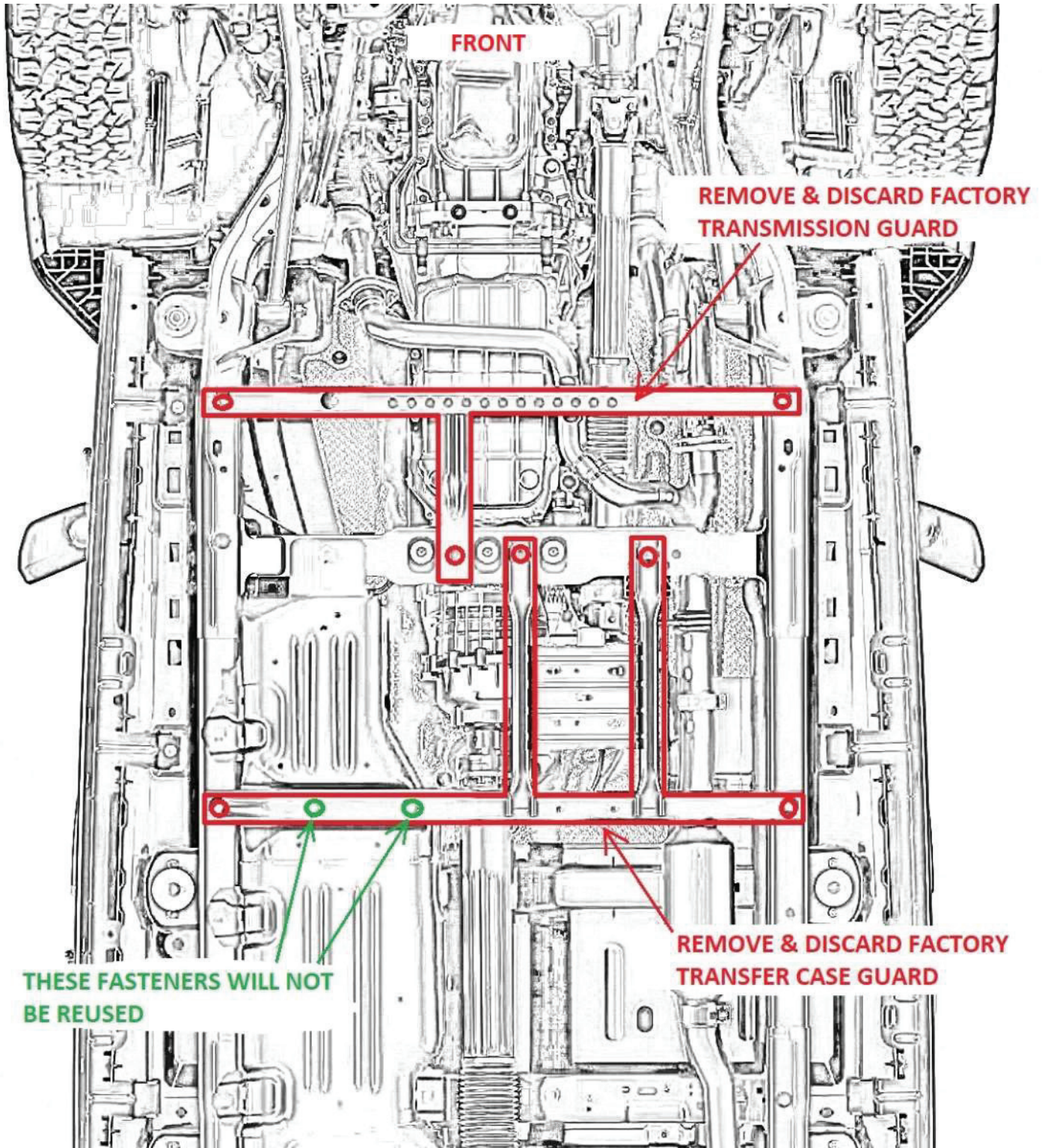

This underside view shows a Jeep JLU with a different engine & exhaust system. This product will only work with the 392 engine & 392 exhaust system. The guards shown to be removed are common with all models of Jeep JLU.

MB1211 JLU 392 Skid System**ASSEMBLY - STEP 2**

1. Using a grinder, remove a small area of material shown below. This will allow the new skid system to fit over the existing fuel tank skid.

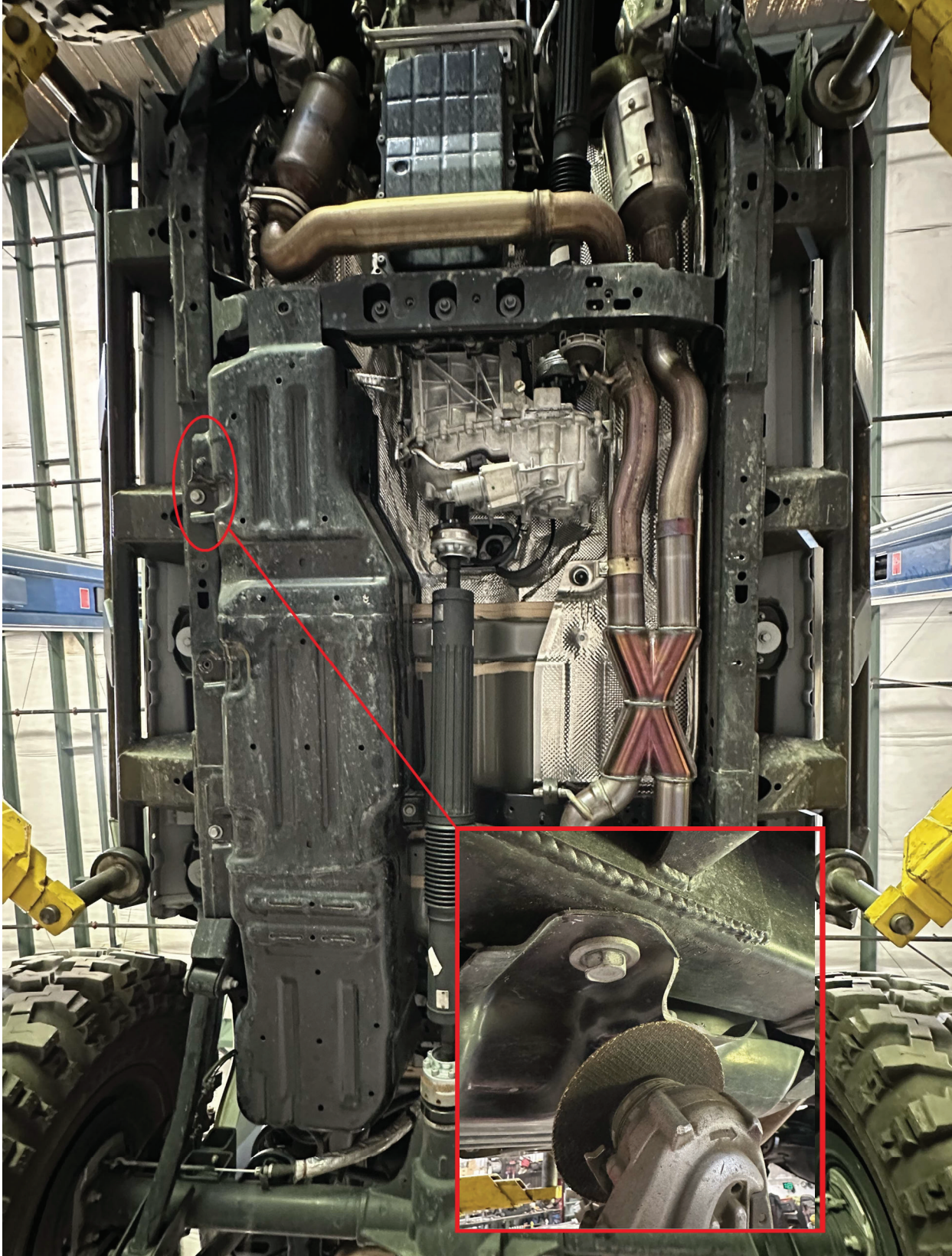

MB1211 JLU 392 Skid System**ASSEMBLY - STEP 3**

1. Raise the TRANSMISSION SKID into position. Fasten skid to frame & factory transmission cross member by reusing factory hardware. Tighten all fasteners.



MB1211 JLU 392 Skid System

ASSEMBLY - STEP 4

TIGHTEN ALL FASTENERS

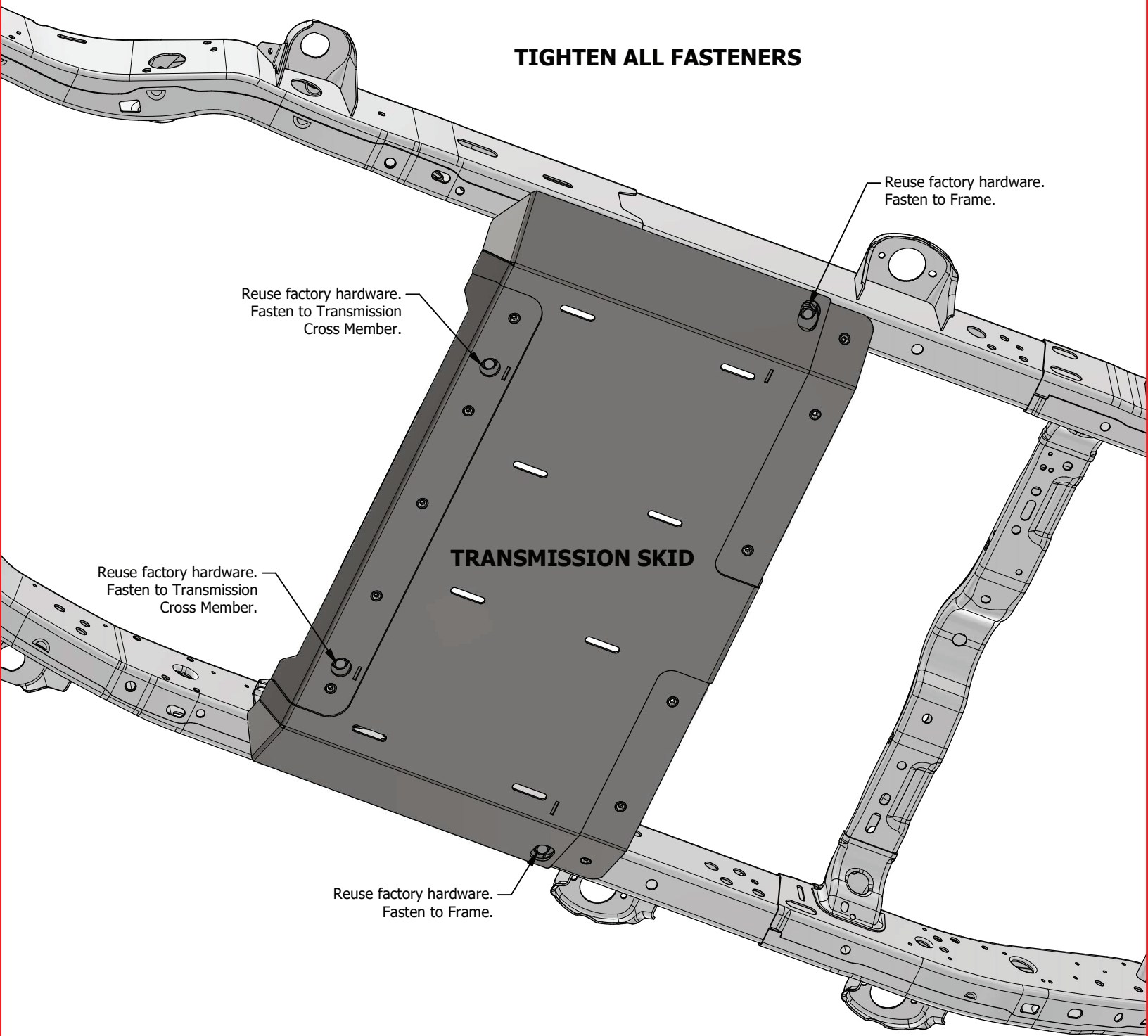

MB1211 JLU 392 Skid System**ASSEMBLY - STEP 5**

1. Raise & support the GAS TANK SKID into position but do NOT fasten yet.



MB1211 JLU 392 Skid System**ASSEMBLY - STEP 6**

1. Loosely install Brackets C-04, D-04 & D-05 to the GAS TANK SKID using the supplied Hex Bolts 3/8"-16 x 1.00", flat washers & nylock nuts. Do NOT tighten fasteners.

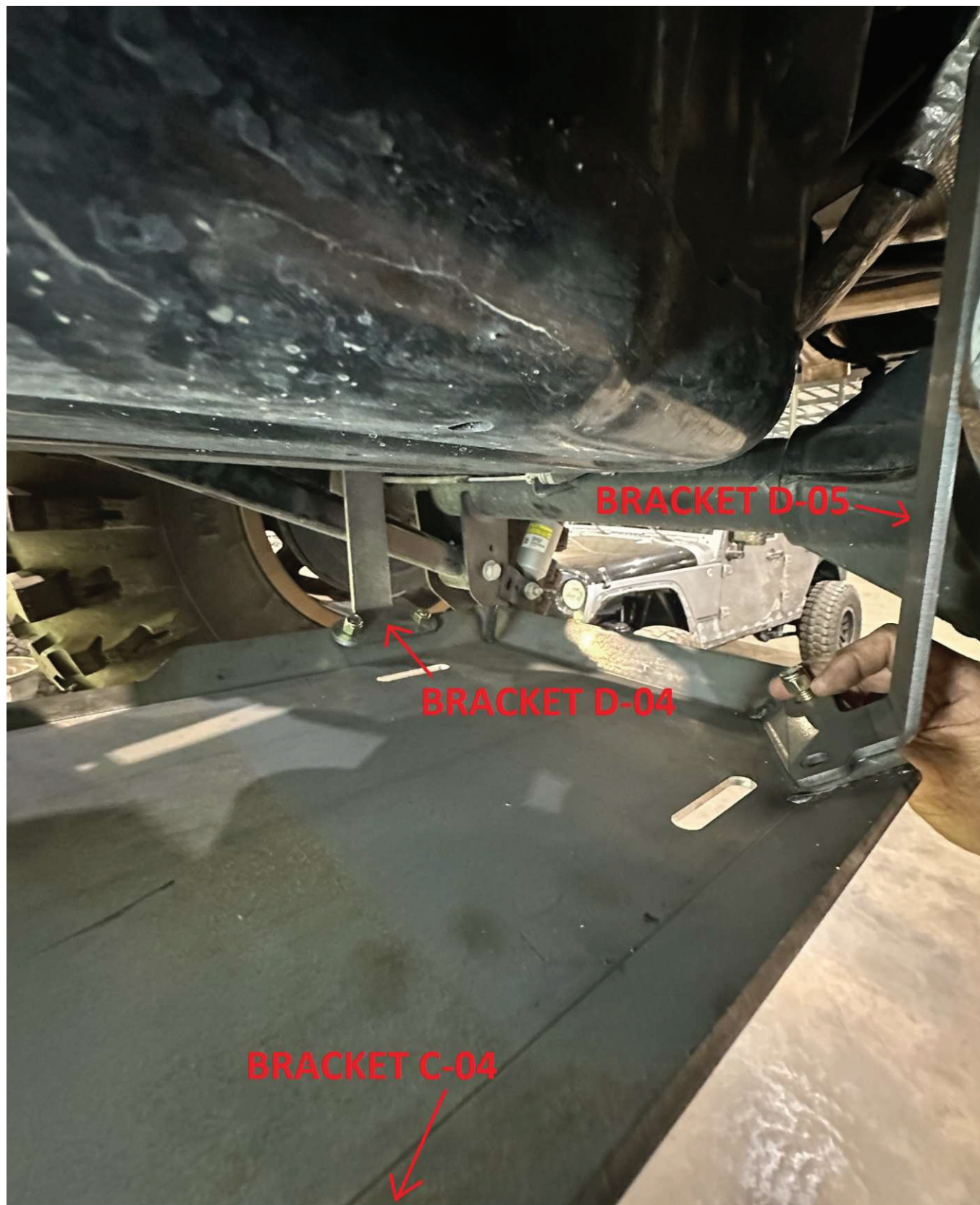

MB1211 JLU 392 Skid System**ASSEMBLY - STEP 7**

1. Raise the GAS TANK SKID. Fasten Bracket D-04 to frame, as shown below. Similarly, fasten Bracket D-05 to frame. Reuse factory hardware for Brackets D-04 & D-05 to fasten to frame. Do NOT tighten fasteners.



MB1211 JLU 392 Skid System**ASSEMBLY - STEP 8**

Loosely install all fasteners. Once all fasteners are in place for the GAS TANK SKID, then tighten all fasteners.

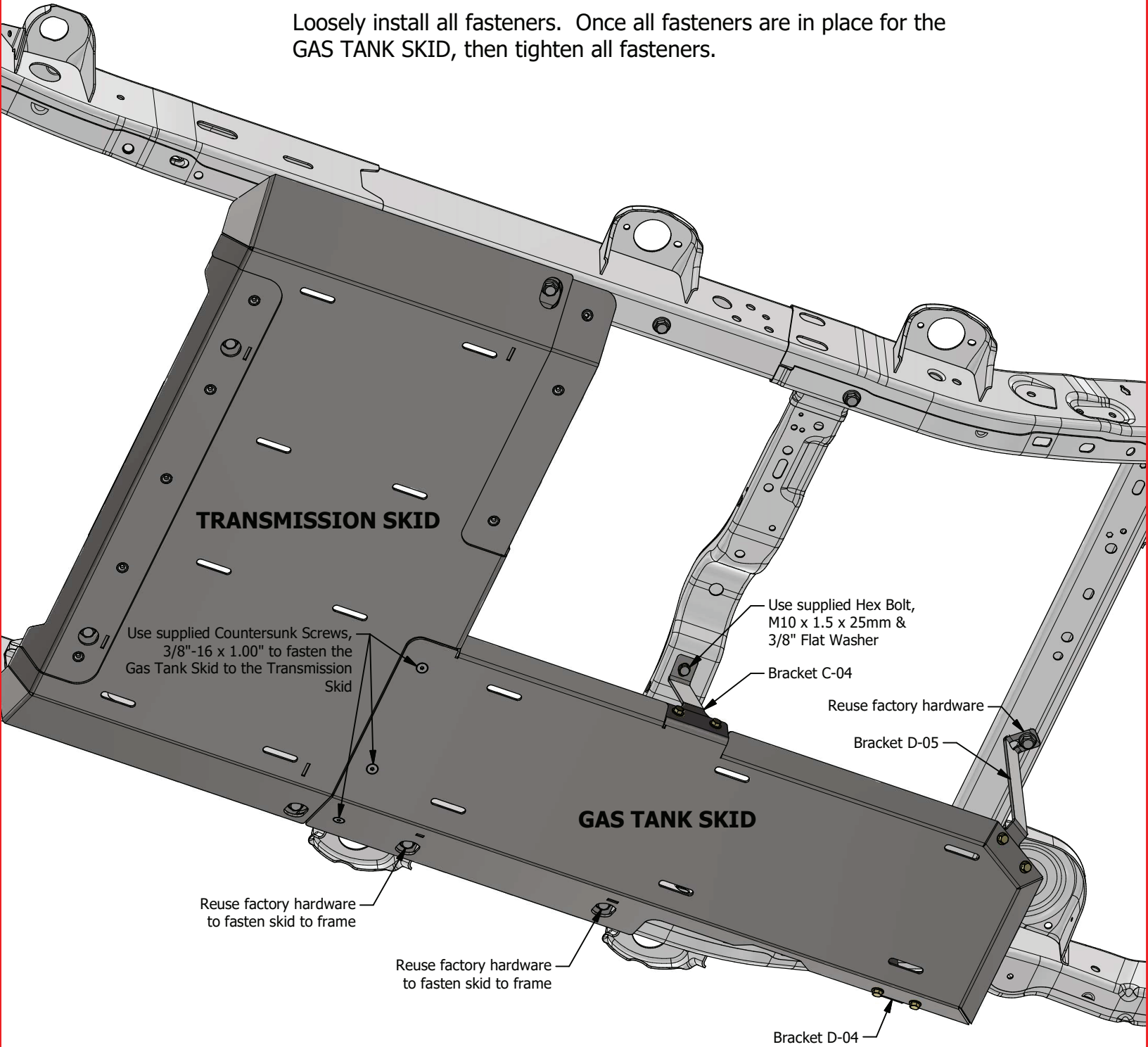

MB1211 JLU 392 Skid System

ASSEMBLY - STEP 9

1. Similar to the GAS TANK SKID, raise & support the EXHAUST SKID. Loosely install Brackets C-04 & C-05 to the MUFFLER SKID. Do NOT tighten fasteners.
2. Raise the EXHAUST SKID into position. See image below for installing Bracket C-05.

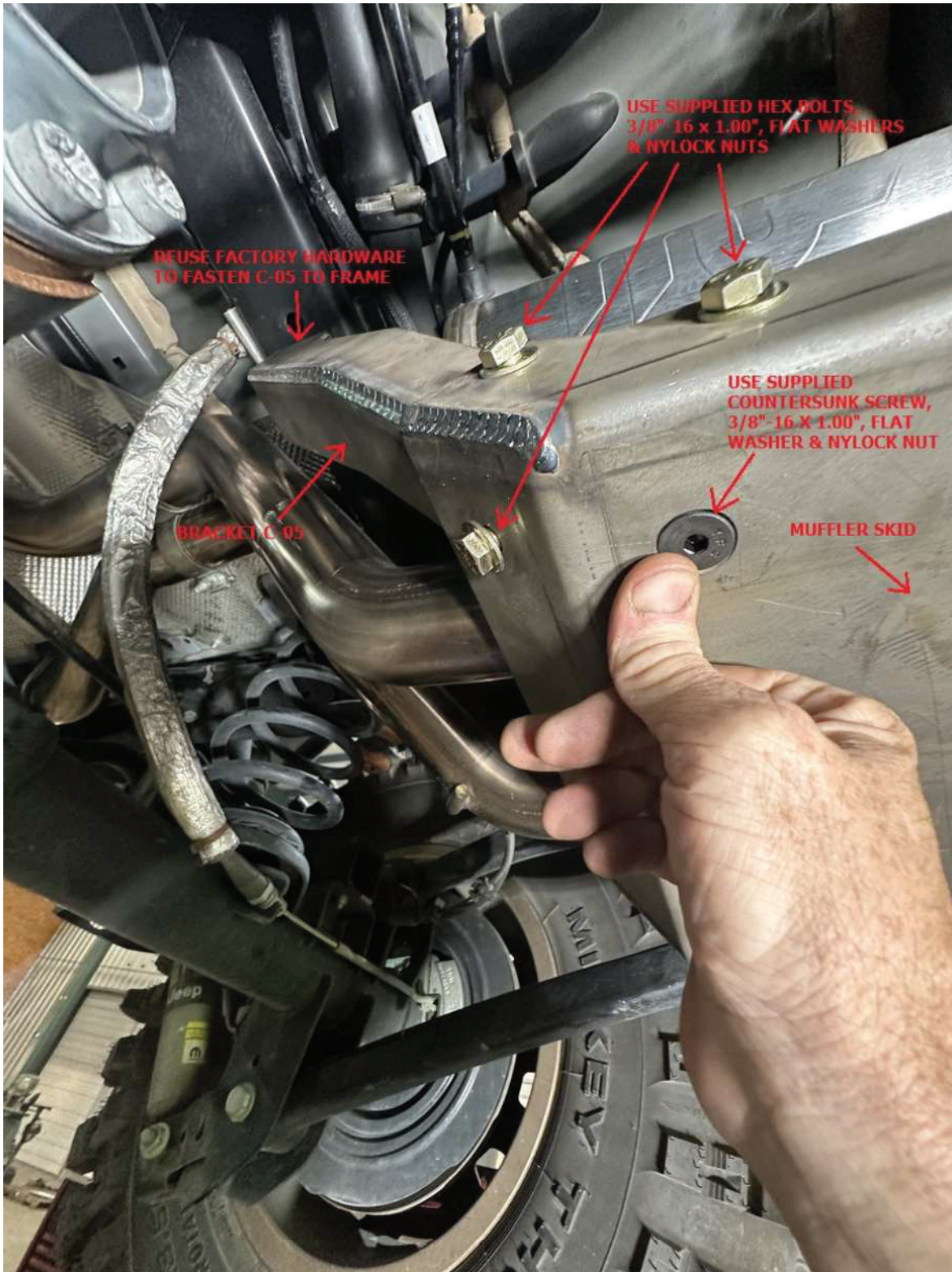

MB1211 JLU 392 Skid System**ASSEMBLY - STEP 10**

1. Fasten Bracket C-04 to frame, as shown below.



MB1211 JLU 392 Skid System**ASSEMBLY - STEP 11**

1. Use supplied countersunk screws, 3/8"-16 x 1.00" to fasten the EXHAUST SKID to the TRANSMISSION SKID.

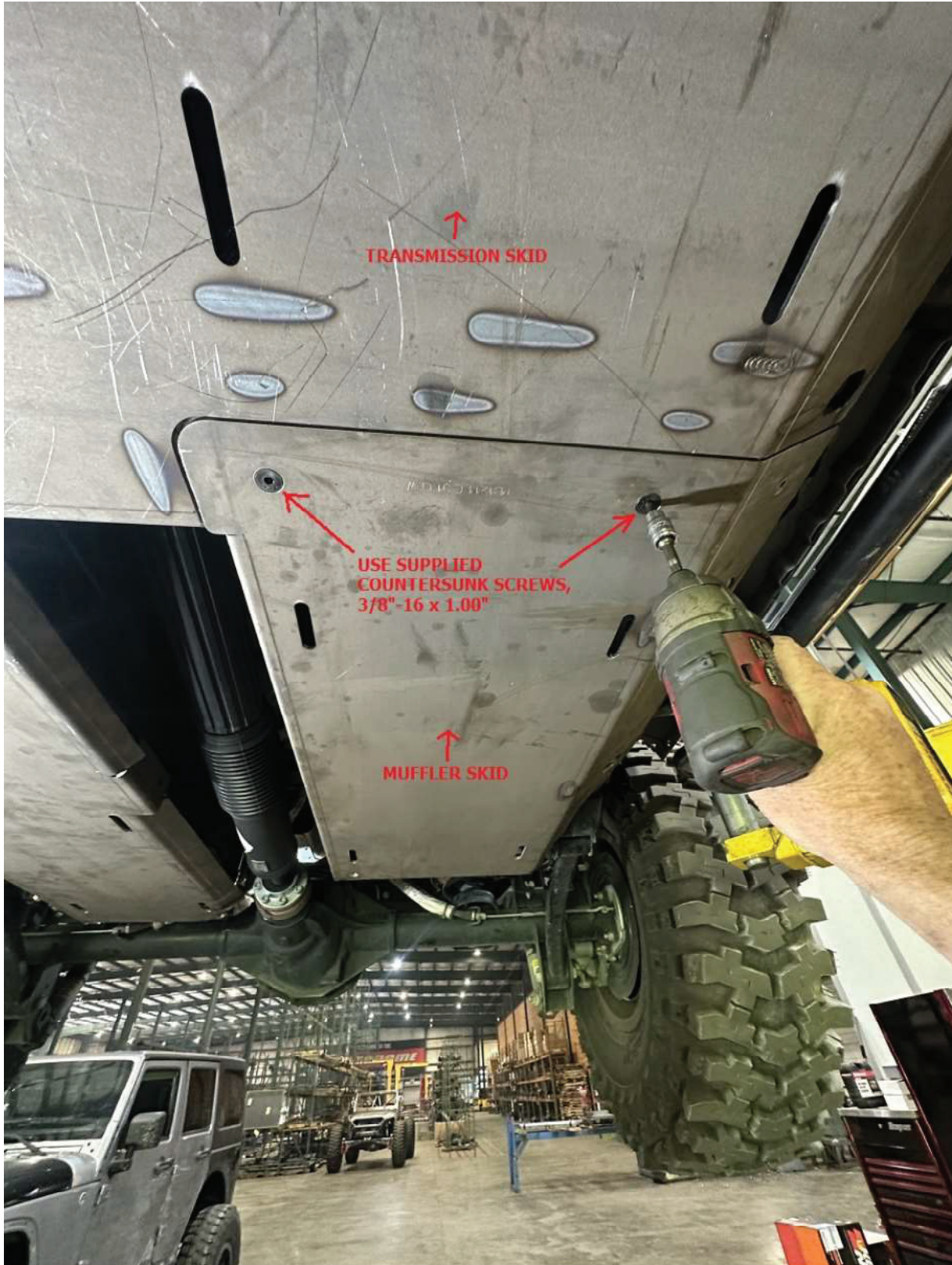

MB1211 JLU 392 Skid System**ASSEMBLY - STEP 12**

Loosely install all fasteners. Once all fasteners are in place for the EXHAUST SKID, then tighten all fasteners.

Use supplied Countersunk Screws, 3/8"-16 x 1.00" to fasten the Muffler Skid to the Transmission Skid

Reuse factory hardware to fasten skid to frame

Reuse factory hardware to fasten skid to frame

TRANSMISSION SKID

EXHAUST SKID

Bracket C-04

Bracket C-05

GAS TANK SKID

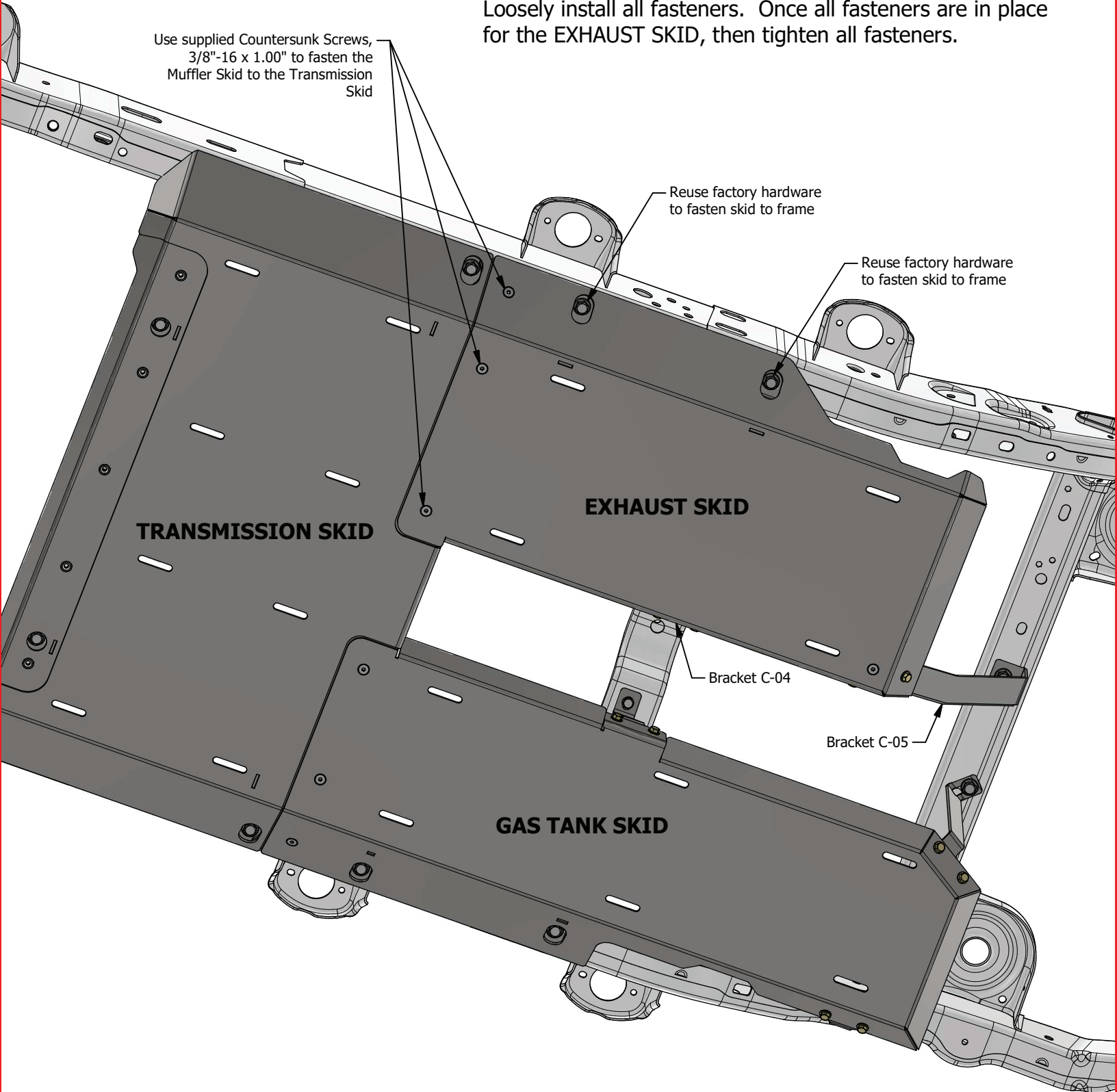

MB1211 JLU 392 Skid System**ASSEMBLY - STEP 13**

1. Raise & support the ENGINE SKID into position. Loosely install five (5) countersunk screws to the TRANSMISSION SKID.



MB1211 JLU 392 Skid System**ASSEMBLY - STEP 14**

1. Early models of the JL with the 392 engine were released with a cast aluminum oil pan. The ALUMINUM oil pan hangs slightly lower. If your 392 engine has the ALUMINUM oil pan, then use the lower mounting holes during assembly.
2. Later models of the JL with the 392 engine were released with a stamped STEEL oil pan. The STEEL oil pan hangs higher than the aluminum oil pan. If your 392 engine has the STEEL oil pan, then use the upper mounting holes during assembly.

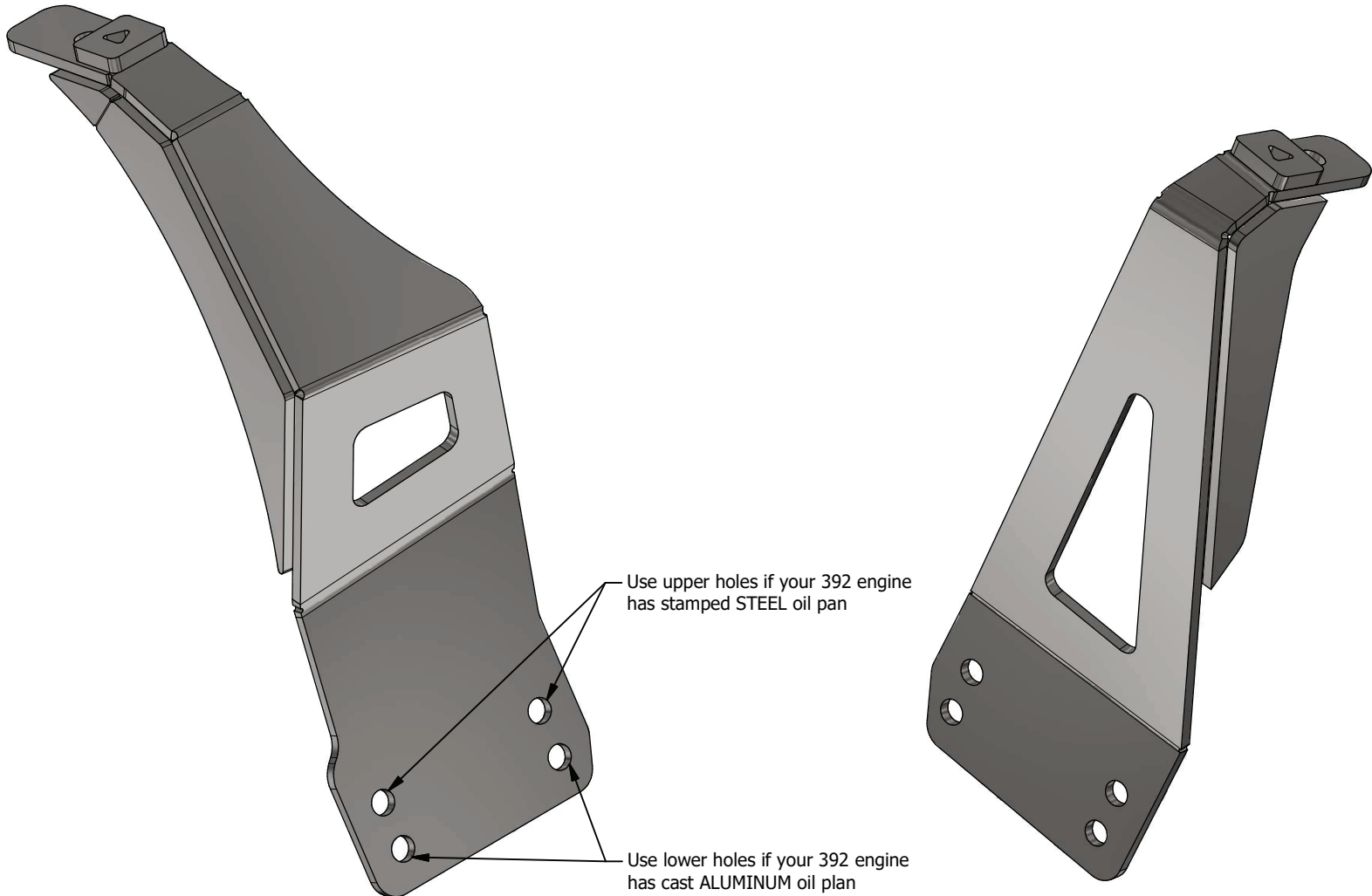
**Engine Skid Hanger
Driver Side****Engine Skid Hanger
Passenger Side**

MB1211 JLU 392 Skid System**ASSEMBLY - STEP 15**

1. Position the top hole in the ENGINE SKID HANGER PASSENGER over the stud located on the underside of the 392 MOTOR MOUNT. Loosely install the fasteners as shown below. Do NOT tighten fasteners.

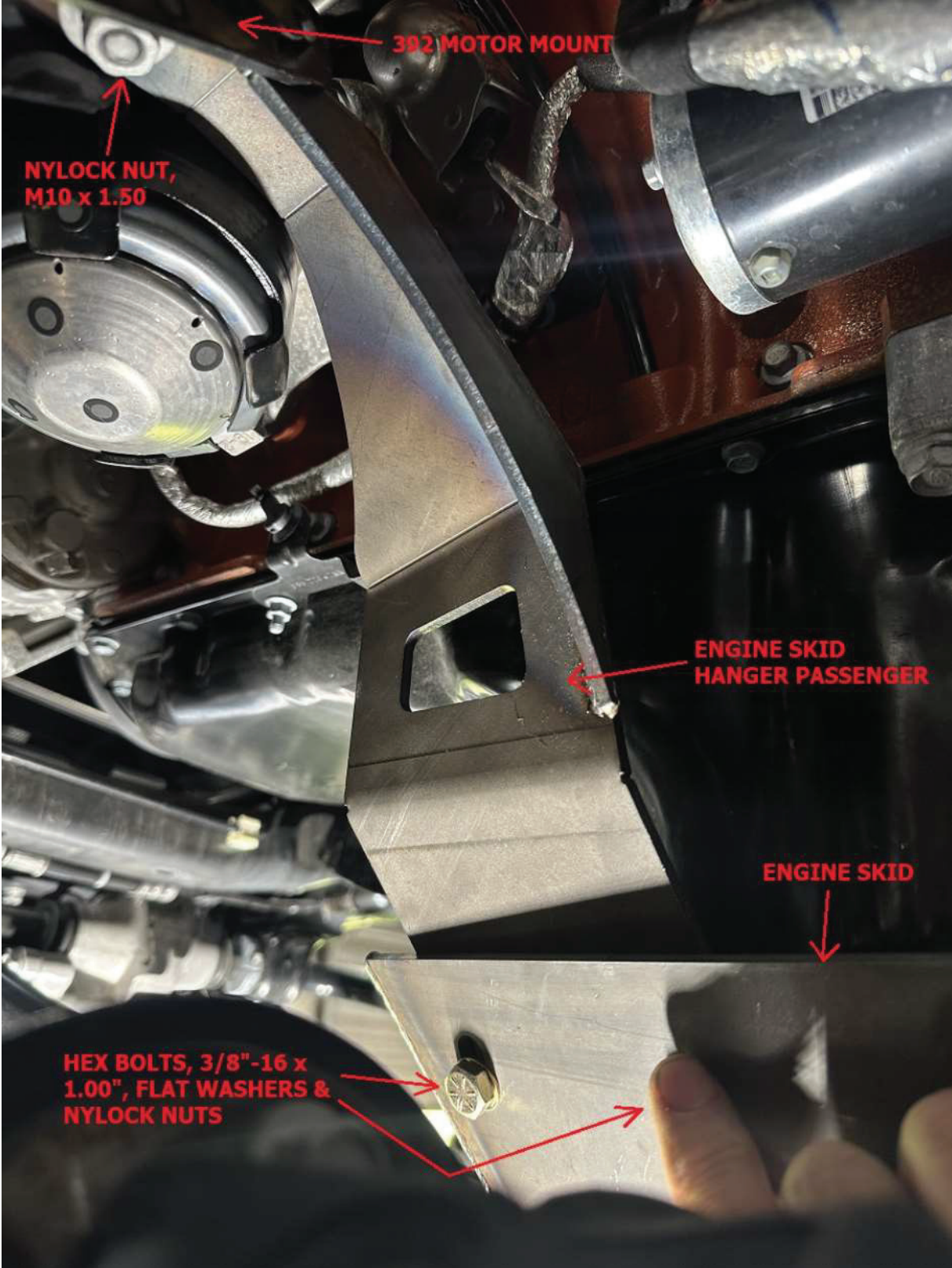

MB1211 JLU 392 Skid System**ASSEMBLY - STEP 16**

1. Position the top hole in the ENGINE SKID HANGER DRIVER over the stud located on the underside of the 392 MOTOR MOUNT. Loosely install the fasteners as shown below. Do NOT tighten fasteners.

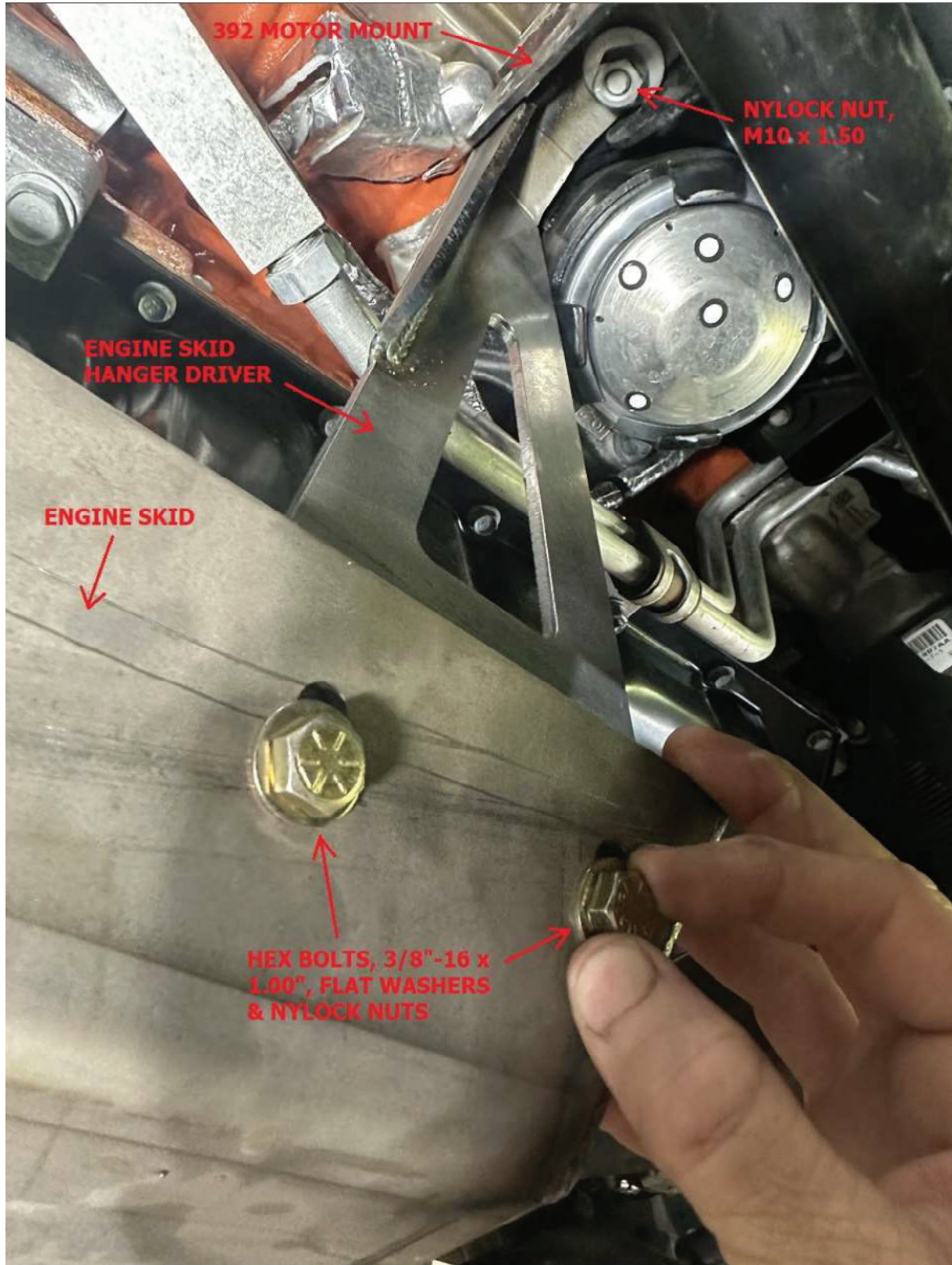

MB1211 JLU 392 Skid System**ASSEMBLY - STEP 17**

1. With all fasteners loosely in place for the ENGINE SKID, ENGINE SKID HANGER PASSENGER & ENGINE SKID HANGER DRIVER, tighten all fasteners, starting with the countersunk screws connecting the ENGINE SKID to the TRANSMISSION SKID.



MB1211 JLU 392 Skid System
ASSEMBLY - STEP 18

1. Now that you have test fit all components of the entire skid system, we recommend to disassemble, paint or powder coat all components. Repeat assembly steps during the final installation after paint. We recommend to use LOCTITE THREADLOCKER BLUE 242 on all fasteners & torque all bolts during final assembly.

