

MB1197 Gladiator Rear Highline Fenders

ASSEMBLY INSTRUCTIONS

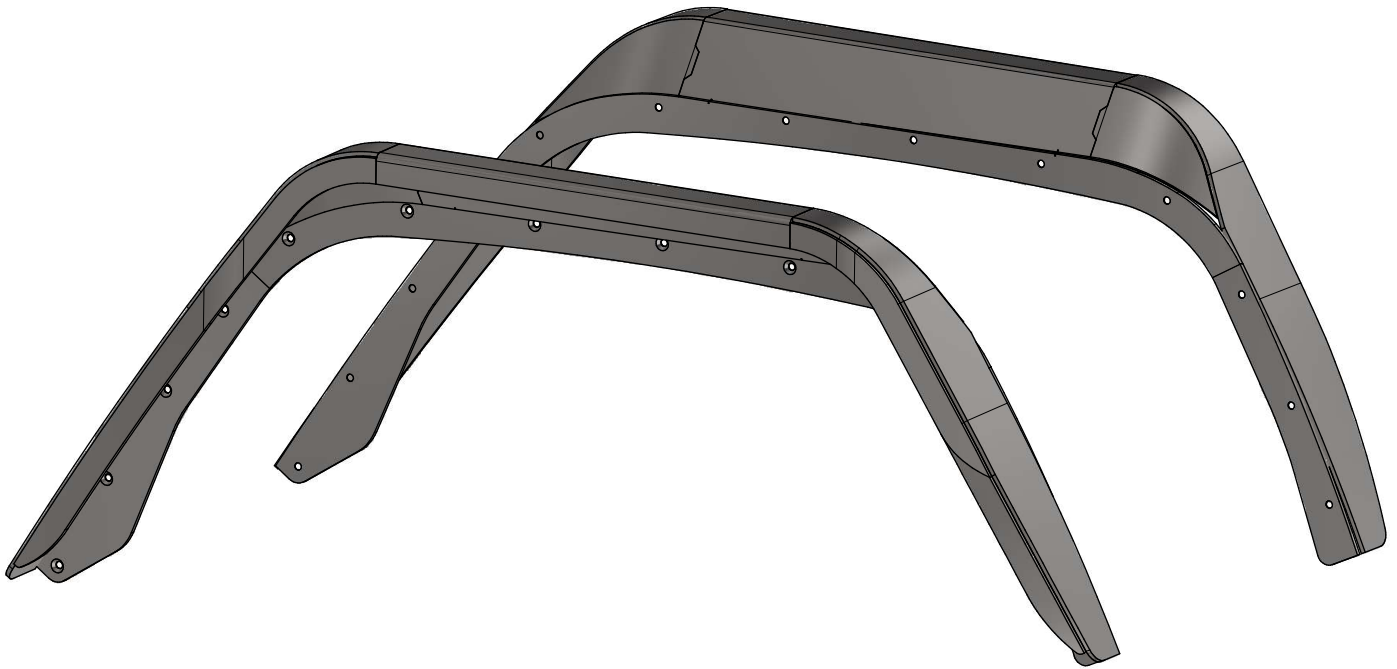

MB1197 - Gladiator Rear Highline Fenders

CONTENTS

FRONT

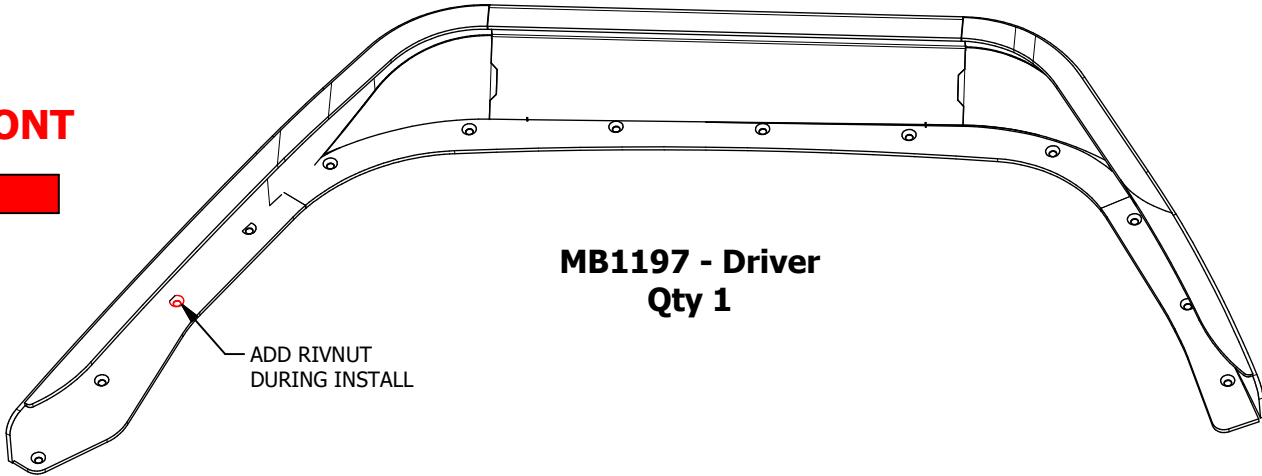
**MB1197 - Driver
Qty 1**

ADD RIVNUT
DURING INSTALL

FRONT

**MB1197 - Passenger
Qty 1**

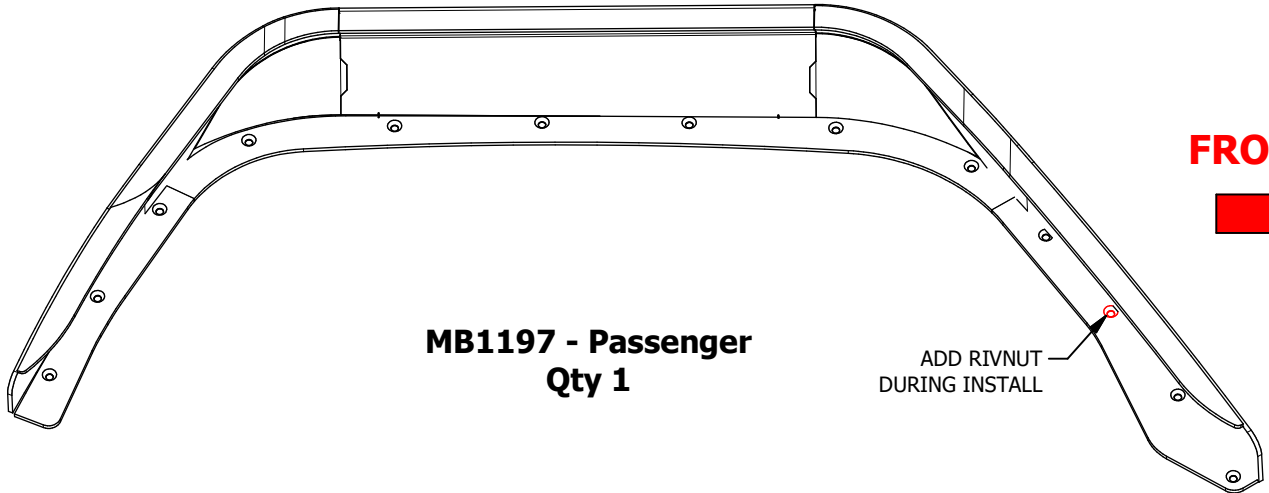
ADD RIVNUT
DURING INSTALL

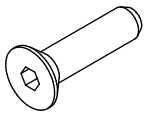

**Countersunk Screw
1/4"-20 x 1" Long
Qty 30
(includes 4 spares)**



**Flat Washer
1/4"
Qty 24**



**Nylock Nut
1/4"-20
Qty 24**

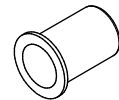

**Rivnut
1/4"-20
Qty 4
(includes 2 spares)**

MB1197 - Assembly

INSTALLATION

1. REMOVE FACTORY FENDER FLARES & FACTORY INNER FENDER LINERS.
2. CLEAN OUTER FENDER SURFACE.
3. NOTE: YOU WILL REUSE ALL OF THE FACTORY HOLES IN THE OUTER BODY **EXCEPT ONE LOCATION AS SHOWN.** YOU WILL INSTALL ONE (1) RIVNUT THAT IS NOT ACCESSIBLE FROM BEHIND TO ADD A NUT & WASHER.
4. POSITION NEW FENDER OVER EXISTING HOLES.
5. INSTALL FASTENERS AS SHOWN.
6. REPEAT FOR PASSENGER SIDE. NOTE: HOLE TO ADD RIVNUT IS LOCATED TOWARDS THE FRONT, THIRD HOLE UP.

