

MB1185 - Assembly Instructions JT Gladiator Long Bed

CONTENTS

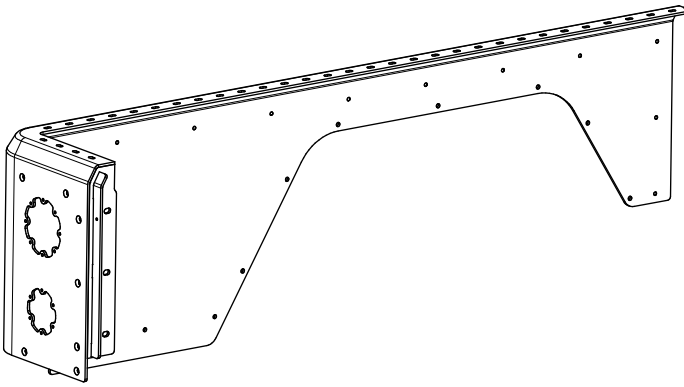

MB1185 - Weldment, Outer Fender Driver Qty 1

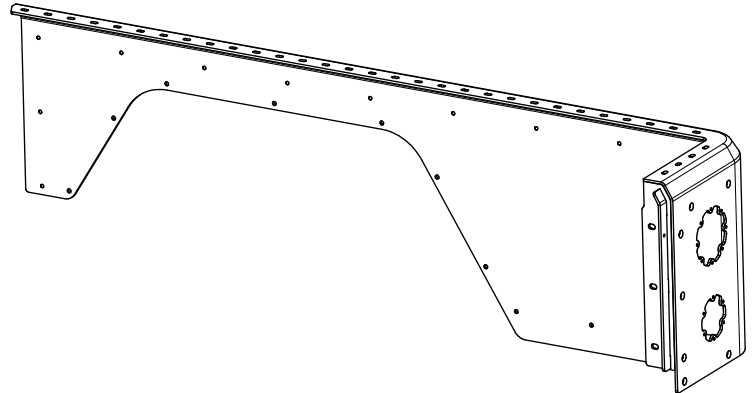

MB1185 - Weldment, Outer Fender Passenger Qty 1

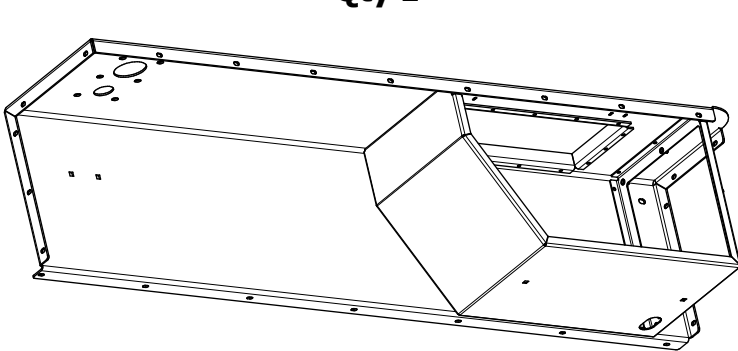

MB1185 - Weldment, Inner Fender Driver Qty 1

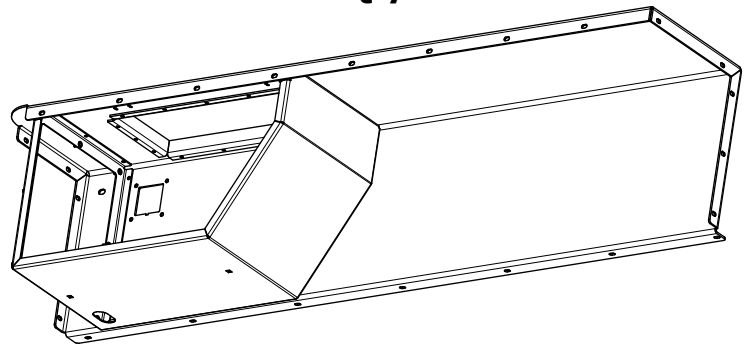

MB1185 - Weldment, Inner Fender Passenger Qty 1

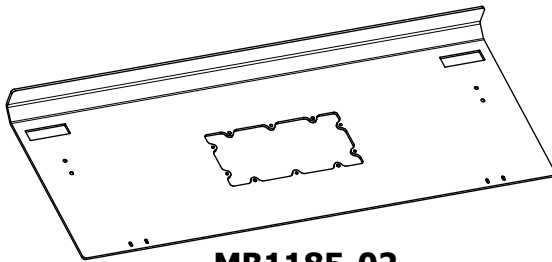

MB1185-02 Qty 1

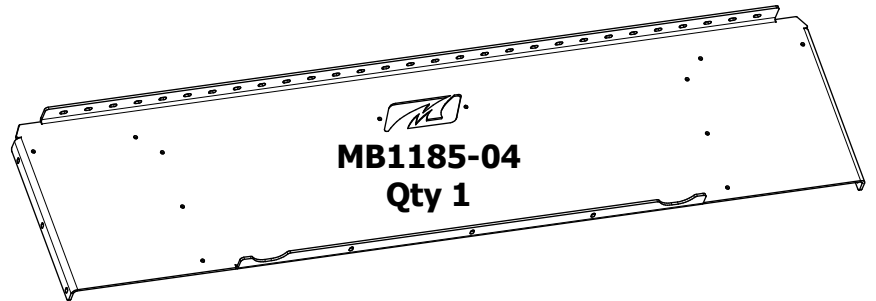

MB1185-04 Qty 1



MB1185 - Weldment, Rear Body Mount 01 Qty 1

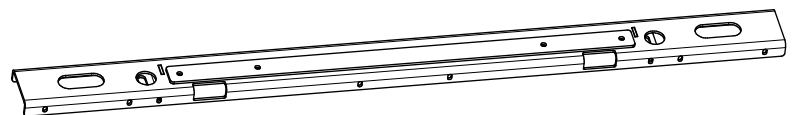

MB1185 - Weldment, Rear Body Mount 02 Qty 1

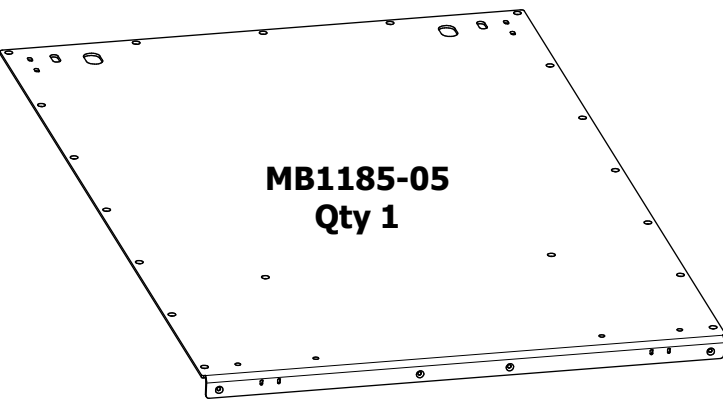

MB1185-05 Qty 1

MB1185 - Assembly Instructions JT Gladiator Long Bed

CONTENTS

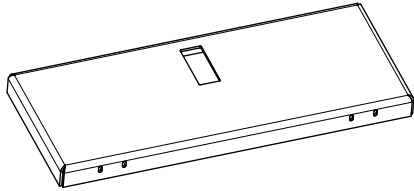

**MB1185-47
Qty 2**



**MB1185-12
Qty 1**

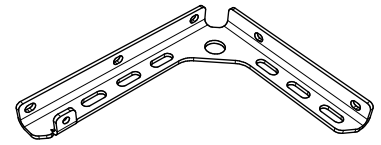

**MB1185-12_MIR
Qty 1**

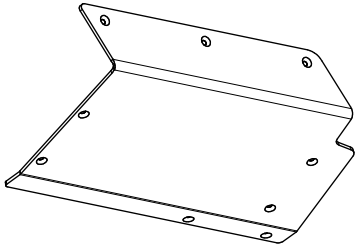

**MB1185-35
Qty 1**

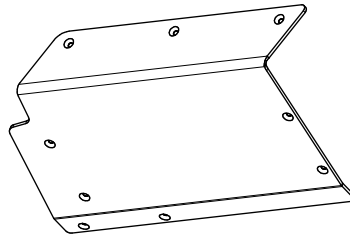

**MB1185-35_MIR
Qty 1**

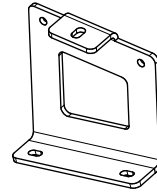

**MB1185-37
Qty 2**

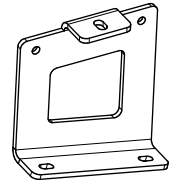

**MB1185-37_MIR
Qty 2**

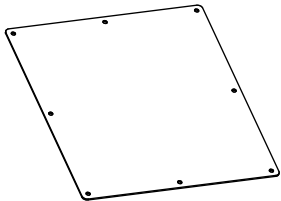

**MB1185-39
Qty 2**

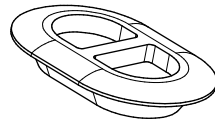

**Rubber Plug
Qty 4**

MB1185 - Assembly Instructions JT Gladiator Long Bed

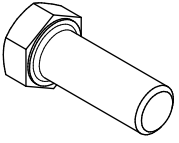
 BAG LABELED AS
1185-KIT01

Hex Bolt
 9/16"-12 x 1-1/2"
 Qty 4

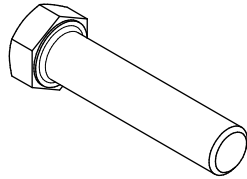

Hex Bolt
 9/16"-12 x 2-1/2"
 Qty 2

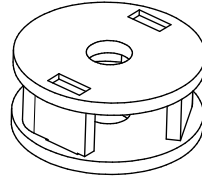

MB1185 - Weldment,
Front Body Mount
 Qty 2



Flat Washer
 9/16"
 Qty 12

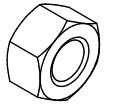

Nylock Nut
 9/16"-12
 Qty 6

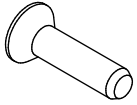
 BAG LABELED AS
1185-KIT02

Countersunk Screw
 1/4"-20 x 3/4"
 Qty 60

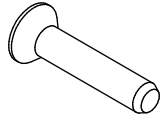

Countersunk Screw
 1/4"-20 x 1-1/4"
 Qty 16

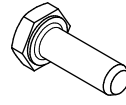

Hex Bolt
 1/4"-20 x 3/4"
 Qty 20



Flat Washer
 1/4"
 Qty 100

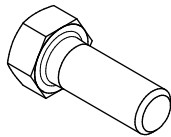

Nylock Nut
 1/4"-20
 Qty 100

 BAG LABELED AS
1185-KIT03

Hex Bolt
 3/8"-16 x 1"
 Qty 10



Flat Washer
 3/8"
 Qty 16

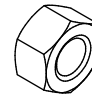

Nylock Nut
 3/8"-16
 Qty 6

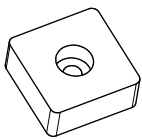
 BAG LABELED AS
1185-KIT04

Rubber Bumper
 Qty 2

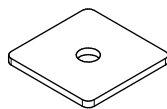

MB1185-32
 Qty 6

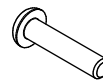

Hex Button Head Screw
 #8-32 x 3/4"
 Qty 2



Machine Nut
 #8-32
 Qty 2

MB1185 - Assembly Instructions JT Gladiator Long Bed

BAG LABELED AS

1185-KIT05

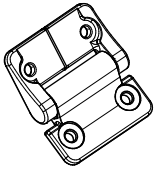

Hinge
Qty 6

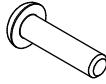

Hex Button Head Screw
#10-24 x 3/4"
Qty 24



Flat Washer
M6
Qty 24



Nylock Nut
#10-24
Qty 24

BAG LABELED AS

1185-KIT06

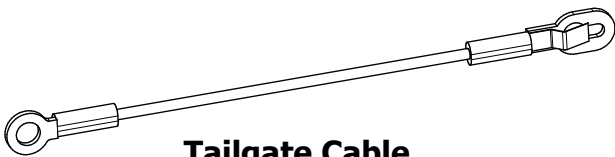

Tailgate Cable
Qty 2

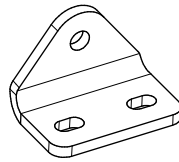

MB1185-26
Qty 2



MB1185-25
Qty 2

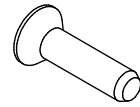

Countersunk Screw
1/4"-20 x 3/4"
Qty 4

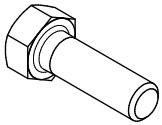

Hex Bolt
5/16"-18 x 1"
Qty 4



Flat Washer
5/16"
Qty 6



Nylock Nut
5/16"-18
Qty 4



Hex Nut
5/16"-18
Qty 2



Flat Washer
1/4"
Qty 4



Nylock Nut
1/4"-20
Qty 4

BAG LABELED AS

1185-KIT07

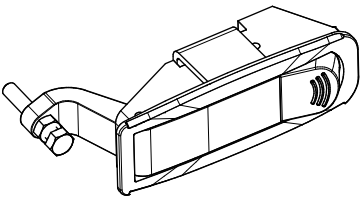

Push Latch
Qty 2

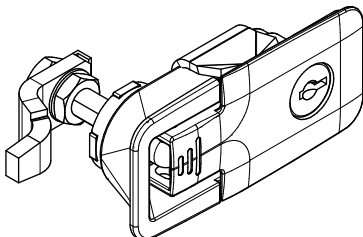

Locking Latch
Qty 2

BAG LABELED AS

1185-KIT08

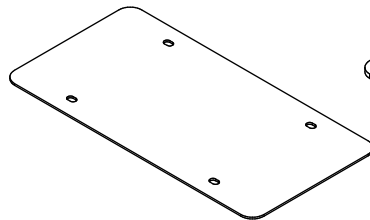

MB1185-29
Qty 1

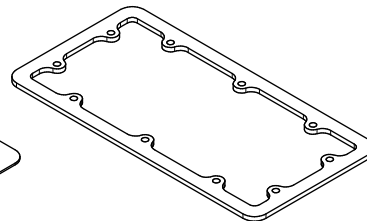

MB1185-24
Qty 1

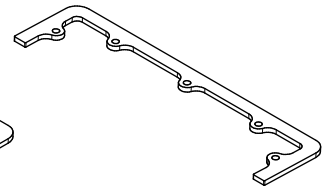

MB1185-31
Qty 2

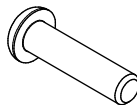

Hex Button Head Screw
1/4"-20 x 1"
Qty 4



Hex Button Head Screw
1/4"-20 x 1/2"
Qty 6



Cap Nut
1/4"-20
Qty 4

MB1185 - Assembly Instructions JT Gladiator Long Bed

BAG LABELED AS
1185-KIT09

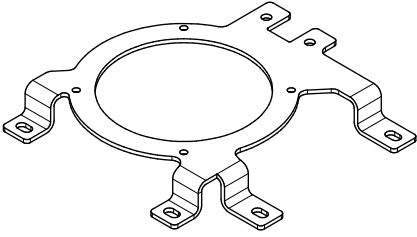

MB1185-22
Qty 1

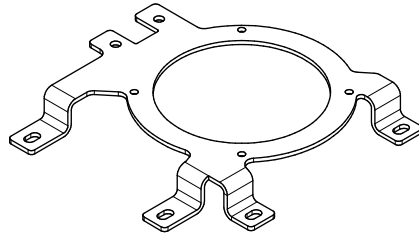

MB1185-22_MIR
Qty 1

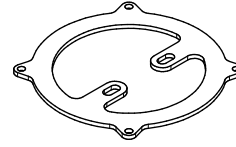

MB1185-30
Qty 2



MB1185-28
Qty 2

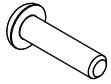

Hex Button Head Screw
#10-24 x 3/4"
Qty 8



Nylock Nut
#10-24
Qty 8

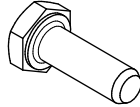

Hex Bolt
1/4"-20 x 3/4"
Qty 4



Flat Washer
1/4"
Qty 4



Nylock Nut
1/4"-20
Qty 4

BAG LABELED AS
1185-KIT10

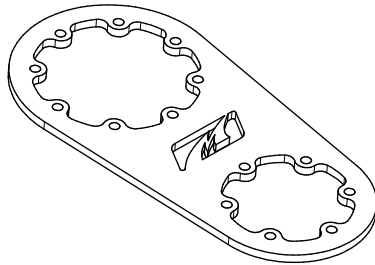

MB1178-23
Qty 2



Hex Button Head Screw
1/4"-20 x 3/4"
Qty 28

BAG LABELED AS
1185-KIT11

Not Applicable

MB1185 - Assembly Instructions JT Gladiator Long Bed

 GASOLINE COMPATIBLE PARTS
SHOWN IN RED

 BAG LABELED AS
1185-KIT12

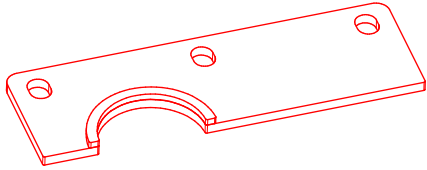
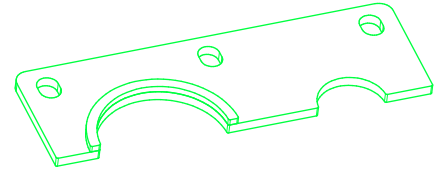
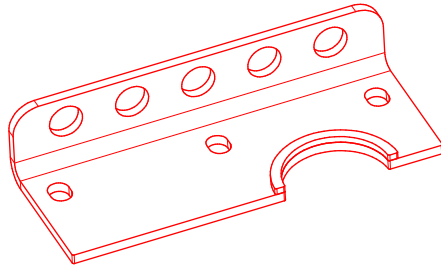
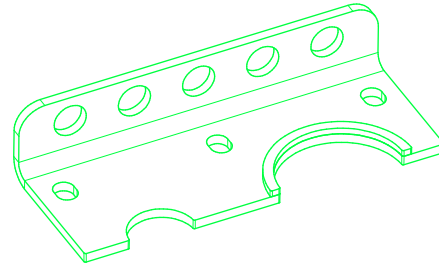
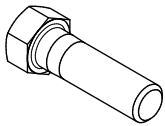
 DIESEL COMPATIBLE PARTS
SHOWN IN GREEN

**MB1185 - Weldment,
Filler Clamp 01 - Gas
Qty 1**

**MB1185 - Weldment,
Filler Clamp 01 - Diesel
Qty 1**

**MB1185 - Weldment,
Filler Clamp 02 - Gas
Qty 1**

**MB1185 - Weldment,
Filler Clamp 02 - Diesel
Qty 1**

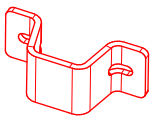
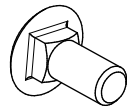
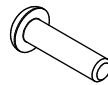
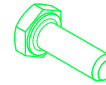
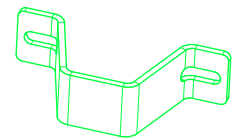
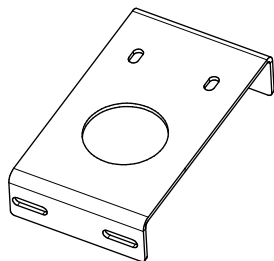
**Hex Bolt
3/8"-16 x 1-1/2"
Qty 6**

**Flat Washer
3/8"
Qty 12**

**Nylock Nut
3/8"-14
Qty 6**

 GASOLINE COMPATIBLE PARTS
SHOWN IN RED

 BAG LABELED AS
1185-KIT13

 DIESEL COMPATIBLE PARTS
SHOWN IN GREEN

**MB1185-46
Nozzle Clamp 01 - Gas
Qty 1**

**Carriage Bolt
5/16" x 3/4"
Qty 6**

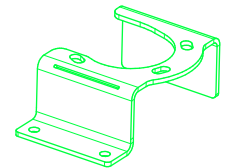
**Hex Button Head Screw
#10-24 x 3/4"
Qty 20**

**Hex Bolt
1/4"-20 x 3/4"
Qty 5**

**MB1185-15
Nozzle Clamp 02 - Diesel
Qty 1**

**MB1185-16
Mounting Plate Clamp
(common to both Gas & Diesel)
Qty 1**

**Flat Washer
5/16"
Qty 6**

**Flat Washer
M6
Qty 20**

**Flat Washer
1/4"
Qty 10**

**MB1185-40
Nozzle Clamp 03 - Diesel
Qty 1**

**Nylock Nut
5/16"-18
Qty 6**

**Nylock Nut
#10-24
Qty 20**

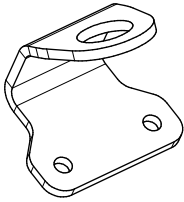
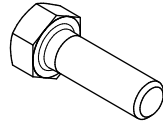
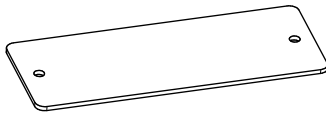
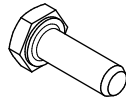
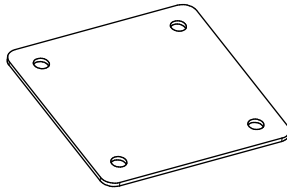
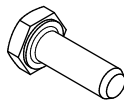
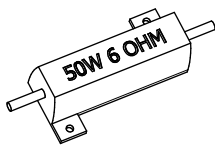
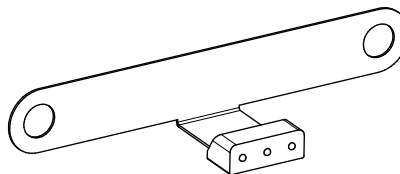
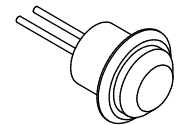
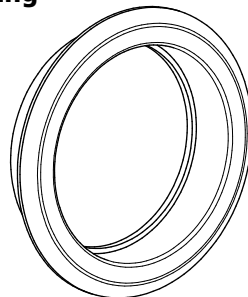
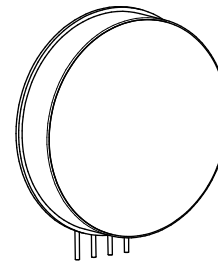
**Nylock Nut
1/4"-20
Qty 5**

MB1185 - Assembly Instructions JT Gladiator Long Bed**BAG LABELED AS
1185-KIT14****MB1185-21
Qty 2****Hex Bolt
5/16"-18 x 1"
Qty 4****Flat Washer
5/16"
Qty 8****Nylock Nut
5/16"-18
Qty 4****BAG LABELED AS
1185-KIT15****MB1185-20
Qty 1****Hex Bolt
1/4"-20 x 3/4"
Qty 2****Flat Washer
1/4"
Qty 2****Nylock Nut
1/4"-20
Qty 2****BAG LABELED AS
1185-KIT16****MB1185-27
Qty 1****Hex Bolt
1/4"-20 x 3/4"
Qty 4****Flat Washer
1/4"
Qty 8****Nylock Nut
1/4"-20
Qty 4****BAG LABELED AS
1185-KIT17****MB5519
Resistor for Non-LED Wiring
Qty 2****Light, License Plate
Qty 1****Side Marker Light
Qty 2****MB6502
Grommet
Qty 2****MB6502
LED Tail Light
Qty 2**

MB1185 - Assembly Instructions JT Gladiator Long Bed

BAG LABELED AS
1185-SPARES

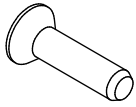

Countersunk Screw
1/4"-20 x 3/4"
Qty 10

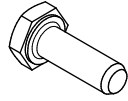

Hex Bolt
1/4"-20 x 3/4"
Qty 10



Flat Washer
1/4"
Qty 10



Nylock Nut
1/4"-20
Qty 10

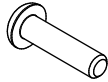

Hex Button Head Screw
#10-24 x 3/4"
Qty 10



Nylock Nut
#10-24
Qty 10



Hex Button Head Screw
1/4"-20 x 1/2"
Qty 10

MB1179 - Assembly Rear Fenders

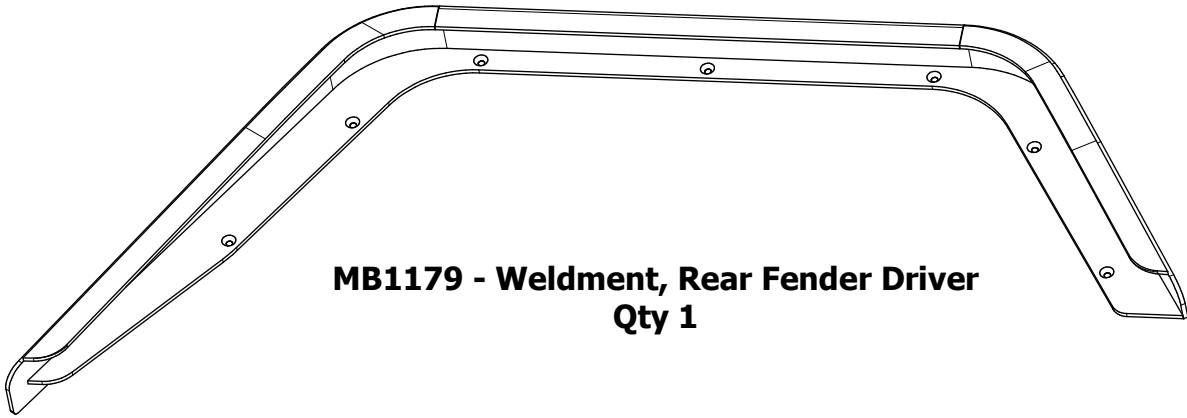

**MB1179 - Weldment, Rear Fender Driver
Qty 1**

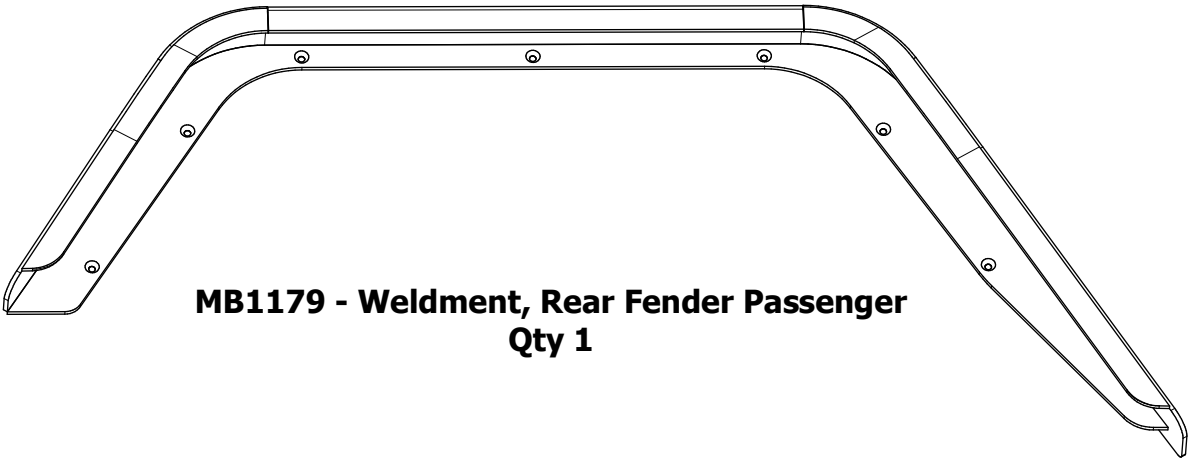

**MB1179 - Weldment, Rear Fender Passenger
Qty 1**

BAG LABELED AS

1179

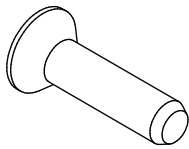

**Countersunk Screw
1/4"-20 x 3/4" Long
Qty 14**



**Flat Washer
1/4"
Qty 14**

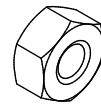

**Nylock Nut
1/4"-20
Qty 14**

MB1187 - Assembly Rear Bumper

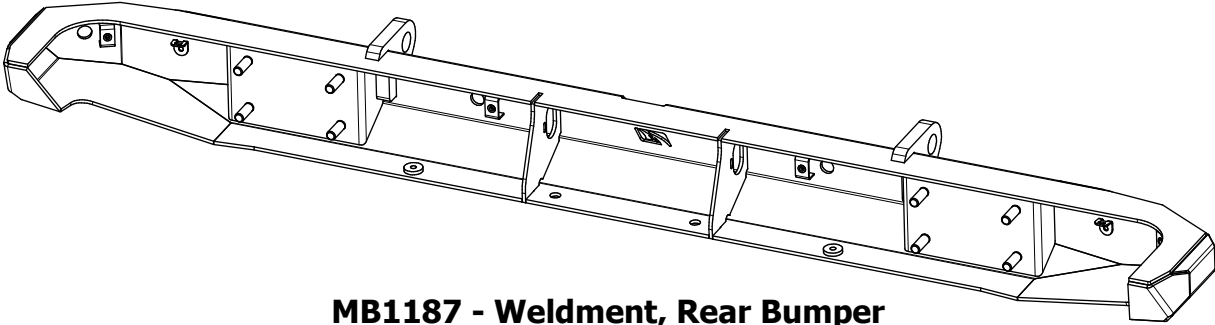

MB1187 - Weldment, Rear Bumper
Qty 1

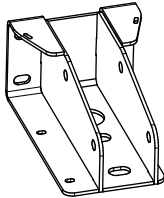

MB1187 - Weldment, Frame Mount Passenger
Qty 1

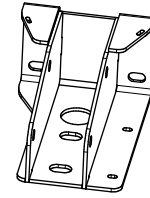

MB1187 - Weldment, Frame Mount Driver
Qty 1

BAG LABELED AS
1187

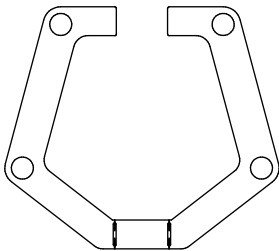

MB1187-12
Qty 2

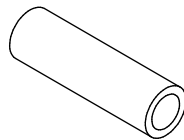

MB1187-Tube 01
Qty 4

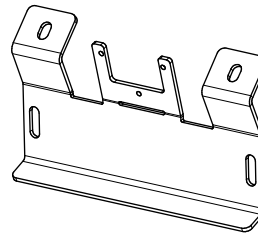

MB1187-11
Qty 1

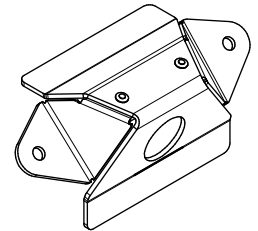

MB1187-Camera Housing
Qty 1

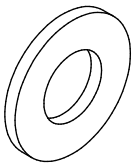

Flat Washer
1/2"
Qty 16



Flat Washer
M6
Qty 2

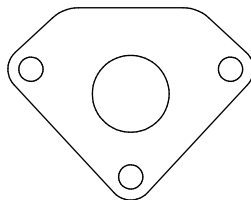

MB2115-08
Qty 1



Nylock Nut
#10-24
Qty 2



Screw
M3-0.5 x 8mm
Qty 3

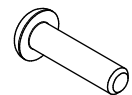

Hex Button Head Screw
#10-24 x 3/4"
Qty 6

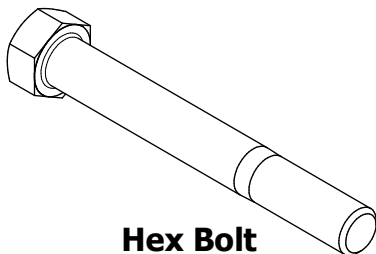

Hex Bolt
1/2"-13 x 4"
Qty 4

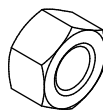

Nylock Nut
1/2"-13
Qty 12

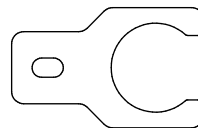

MB2117-01
Qty 4

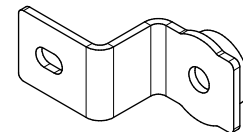

MB2145
Park Sensor Blank Off
Qty 4