

MB1178-A JT Gladiator Bobbed Bed (Aluminum)

CONTENTS

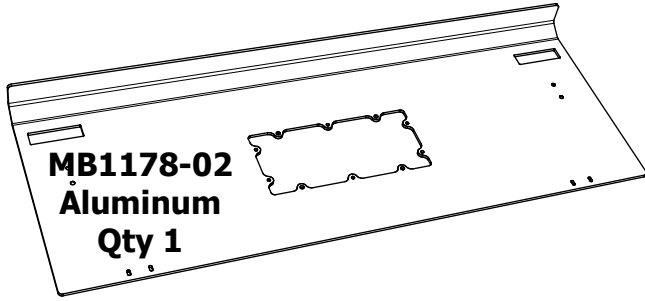

**MB1178-02
Aluminum
Qty 1**



**MB1178-03
Aluminum
Qty 1**

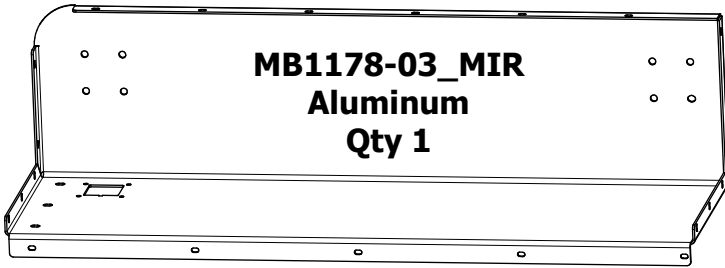

**MB1178-03_MIR
Aluminum
Qty 1**

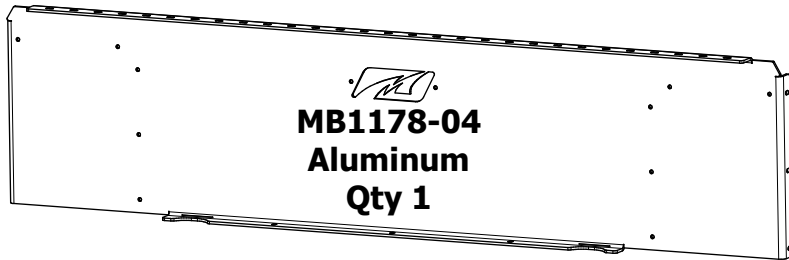

**MB1178-04
Aluminum
Qty 1**

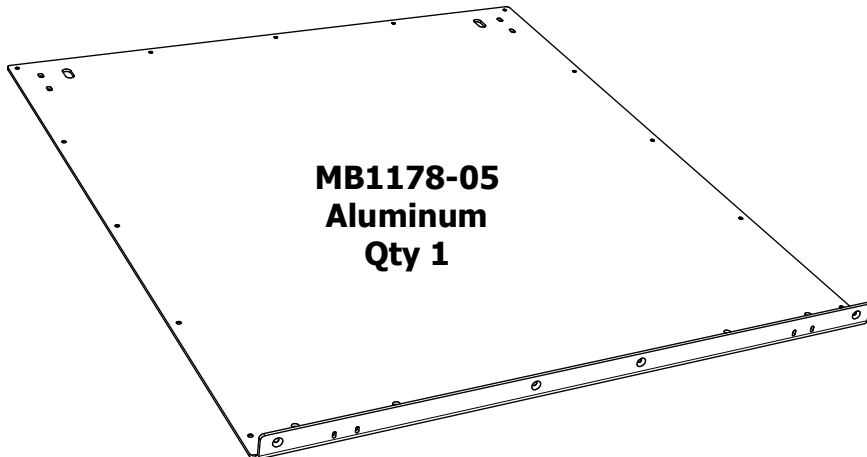

**MB1178-05
Aluminum
Qty 1**

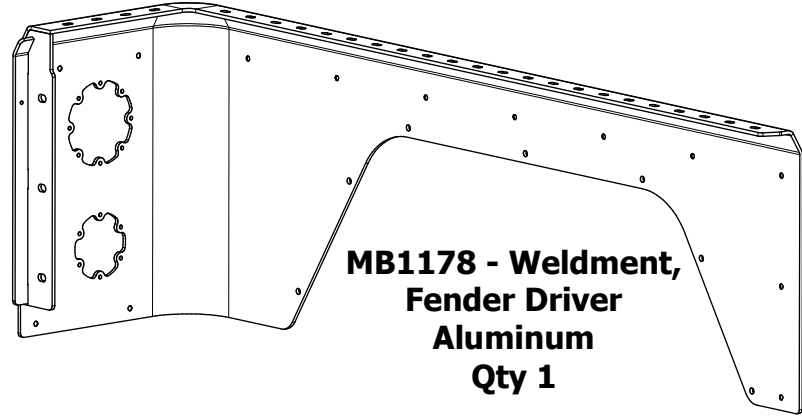

**MB1178 - Weldment,
Fender Driver
Aluminum
Qty 1**

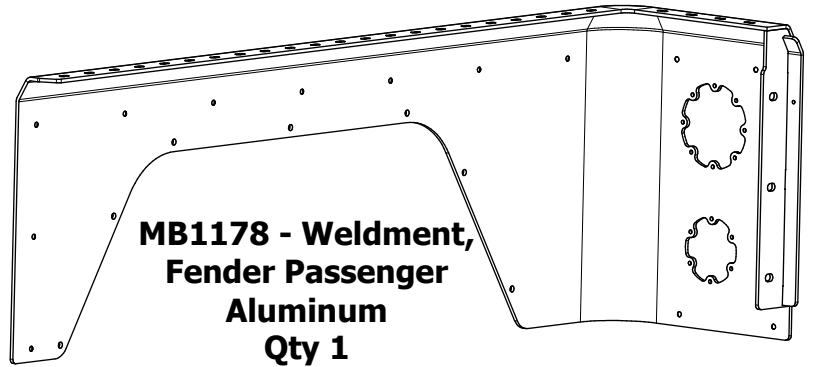

**MB1178 - Weldment,
Fender Passenger
Aluminum
Qty 1**



**MB1178-12
Steel
Qty 1**

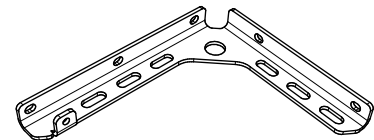

**MB1178-12_MIR
Steel
Qty 1**

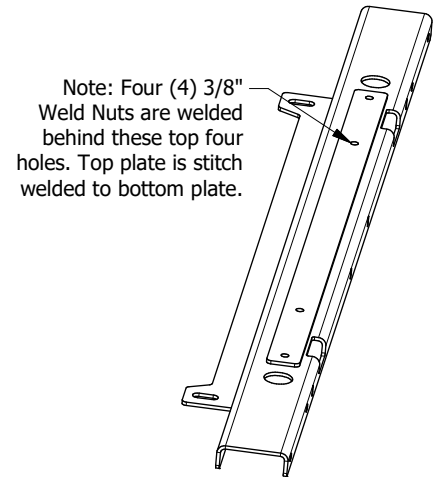

Note: Four (4) 3/8" Weld Nuts are welded behind these top four holes. Top plate is stitch welded to bottom plate.

**MB1178 - Weldment,
Rear Body Mount
Steel
Qty 1**

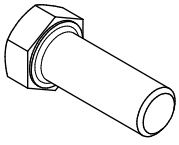
MB1178-A JT Gladiator Bobbed Bed (Aluminum)**BAG LABELED AS
1178-KIT01**

Hex Bolt
9/16"-12 x 1.50"
Qty 2

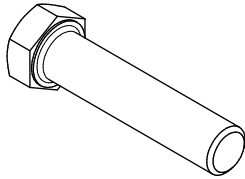

Hex Bolt
9/16"-12 x 2.50"
Qty 2

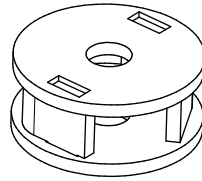

MB1178 - Weldment,
Front Body Mount
Qty 2



Flat Washer
9/16"
Qty 8

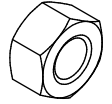

Nylock Nut
9/16"-12
Qty 4

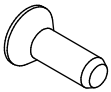
**BAG LABELED AS
1178-KIT02**

Countersunk Screw
1/4"-20 x 0.75"
Qty 40

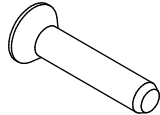

Countersunk Screw
1/4"-20 x 1.25"
Qty 8

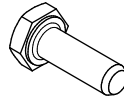

Hex Bolt
1/4"-20 x 0.75"
Qty 10



Flat Washer
1/4"
Qty 60

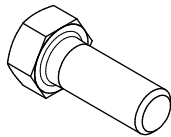

Nylock Nut
1/4"-20
Qty 60

**BAG LABELED AS
1178-KIT03**

Hex Bolt
3/8"-16 x 1.00"
Qty 10



Flat Washer
3/8"
Qty 16

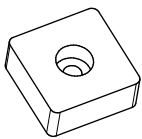

Nylock Nut
3/8"-16
Qty 6

**BAG LABELED AS
1178-KIT04**

Rubber Bumper
Qty 2

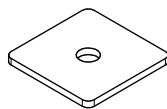

MB1178-32
Qty 6

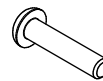

Hex Button Head Screw
#8-32 x 0.75"
Qty 2



Machine Nut
#8-32
Qty 2

MB1178-A JT Gladiator Bobbed Bed (Aluminum)

BAG LABELED AS

1178-KIT05

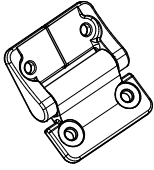

Hinge
Qty 2

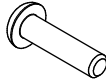

Hex Button Head Screw
#10-24 x 0.75"
Qty 8



Flat Washer
M6
Qty 8



Nylock Nut
#10-24
Qty 8

BAG LABELED AS

1178-KIT06

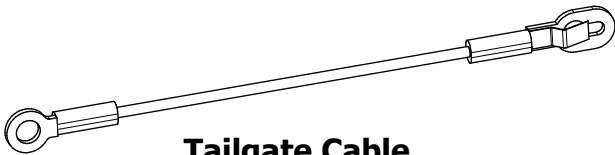

Tailgate Cable
Qty 2

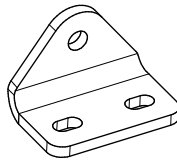

MB1178-26
Qty 2



MB1178-25
Qty 2

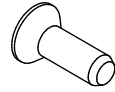

Countersunk Screw
1/4"-20 x 0.75"
Qty 4

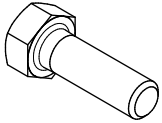

Hex Bolt
5/16"-18 x 1.00"
Qty 4



Flat Washer
5/16"
Qty 6



Nylock Nut
5/16"-18
Qty 4



Hex Nut
5/16"-18
Qty 2



Flat Washer
1/4"
Qty 4



Nylock Nut
1/4"-20
Qty 4

BAG LABELED AS

1178-KIT07

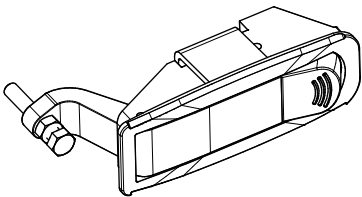

Latch
Qty 2

BAG LABELED AS

1178-A-KIT08

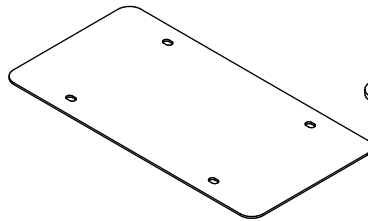

MB1178-29
Aluminum
Qty 1

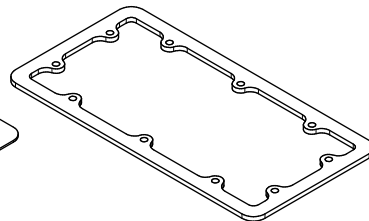

MB1178-24
Qty 1

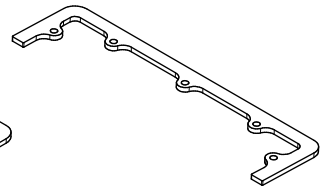

MB1178-31
Qty 2

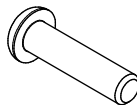

Hex Button Head Screw
1/4"-20 x 1.00"
Qty 4



Hex Button Head Screw
1/4"-20 x 0.50"
Qty 6



Cap Nut
1/4"-20
Qty 4

MB1178-A JT Gladiator Bobbed Bed (Aluminum)

BAG LABELED AS
1178-KIT09

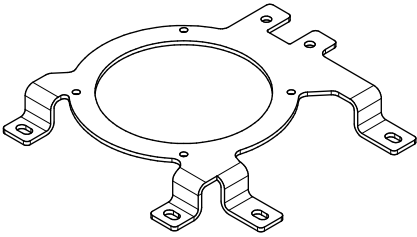

MB1178-22
Qty 1

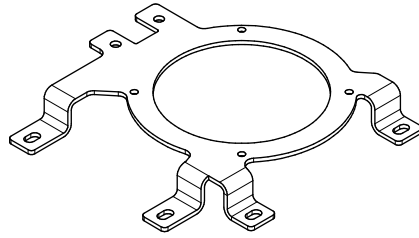

MB1178-22_MIR
Qty 1

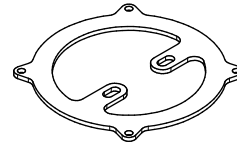

MB1178-30
Qty 2

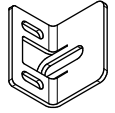

MB1178-28
Qty 2

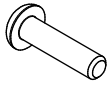

Hex Button Head Screw
#10-24 x 0.75"
Qty 8



Nylock Nut
#10-24
Qty 8

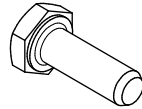

Hex Bolt
1/4"-20 x 3/4"
Qty 4



Flat Washer
1/4"
Qty 4



Nylock Nut
1/4"-20
Qty 4

BAG LABELED AS
1178-KIT10

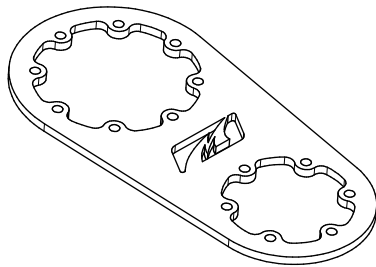

MB1178-23
Qty 2



Hex Button Head Screw
1/4"-20 x 0.50"
Qty 28

BAG LABELED AS
1178-KIT11

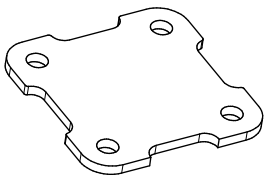

MB1178-33
Qty 6

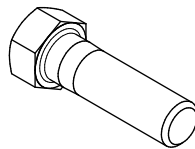

Hex Bolt
3/8"-16 x 1.50"
Qty 12



Flat Washer
3/8"
Qty 24

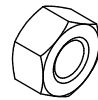

Nylock Nut
3/8"-16
Qty 12

MB1178-A JT Gladiator Bobbed Bed (Aluminum)

 GASOLINE COMPATIBLE PARTS
SHOWN IN RED

BAG LABELED AS

1178-KIT12

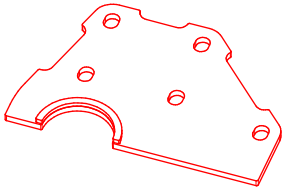
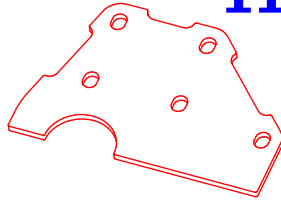
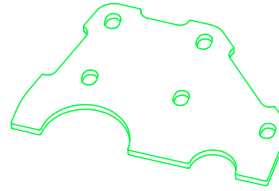
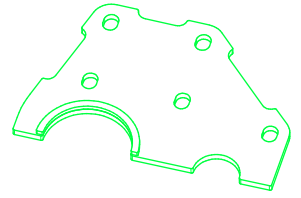
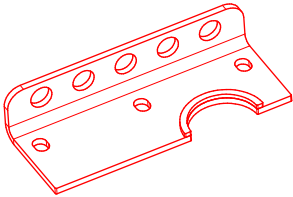
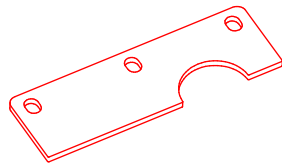
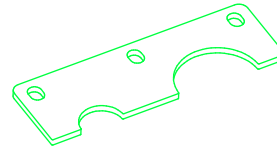
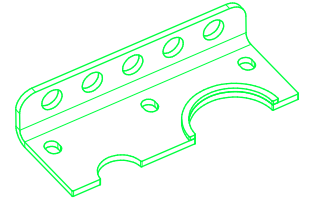
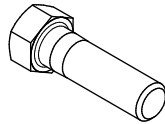
 DIESEL COMPATIBLE PARTS
SHOWN IN GREEN

**MB1178 - Weldment,
Filler Clamp 01 - Gas
Qty 1**

**MB1178-36
Underside Plate 01 - Gas
Qty 1**

**MB1178-13
Underside Plate 03 - Diesel
Qty 1**

**MB1178 - Weldment,
Filler Clamp 03 - Diesel
Qty 1**

**MB1178 - Weldment,
Filler Clamp 02 - Gas
Qty 1**

**MB1178-35
Underside Plate 02 - Gas
Qty 1**

**MB1178-34
Underside Plate 04 - Diesel
Qty 1**

**MB1178 - Weldment,
Filler Clamp 04 - Diesel
Qty 1**

**Hex Bolt
3/8"-16 x 1.50"
Qty 8**

**Flat Washer
3/8"
Qty 16**

**Nylock Nut
3/8"-14
Qty 8**

 GASOLINE COMPATIBLE PARTS
SHOWN IN RED

BAG LABELED AS

1178-KIT13

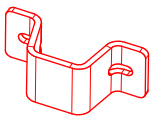
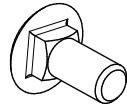
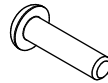
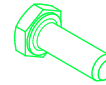
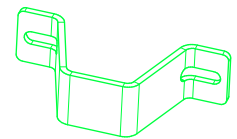
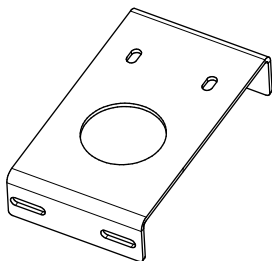
 DIESEL COMPATIBLE PARTS
SHOWN IN GREEN

**MB1178-15
Nozzle Clamp 01 - Gas
Qty 1**

**Carriage Bolt
5/16" x 0.75"
Qty 2**

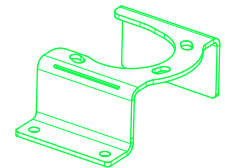
**Hex Button Head Screw
#10-24 x 0.75"
Qty 2**

**Hex Bolt
1/4"-20 x 0.75"
Qty 5**

**MB1178-40
Nozzle Clamp 02 - Diesel
Qty 1**

**MB1178-16
Mounting Plate Clamp
(common to both Gas & Diesel)
Qty 1**

**Flat Washer
5/16"
Qty 2**

**Flat Washer
M6
Qty 2**

**Flat Washer
1/4"
Qty 10**

**MB1178-39
Nozzle Clamp 03 - Diesel
Qty 1**

**Nylock Nut
5/16"-18
Qty 2**

**Nylock Nut
#10-24
Qty 2**

**Nylock Nut
1/4"-20
Qty 5**

MB1178-A JT Gladiator Bobbed Bed (Aluminum)

BAG LABELED AS

1178-KIT14

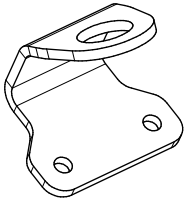

MB1178-21
Qty 2

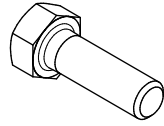

Hex Bolt
5/16"-18 x 1.00"
Qty 4



Flat Washer
5/16"
Qty 8



Nylock Nut
5/16"-18
Qty 4

BAG LABELED AS

1178-A-KIT15

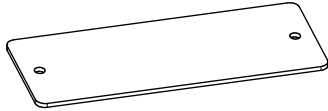

MB1178-20
Aluminum
Qty 1

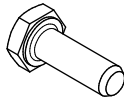

Hex Bolt
1/4"-20 x 0.75"
Qty 2



Flat Washer
1/4"
Qty 2



Nylock Nut
1/4"-20
Qty 2

BAG LABELED AS

1178-A-KIT16

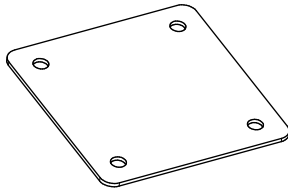

MB1178-27
Aluminum
Qty 1

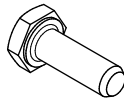

Hex Bolt
1/4"-20 x 0.75"
Qty 4



Flat Washer
1/4"
Qty 8



Nylock Nut
1/4"-20
Qty 4

BAG LABELED AS

1178-KIT17

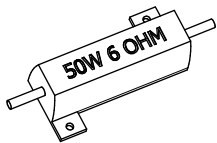

MB5519
Resistor for Non-LED Wiring
Qty 2

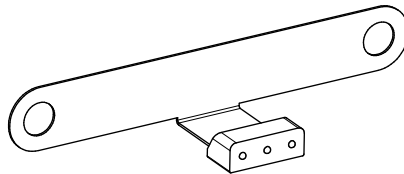

Light, License Plate
Qty 1

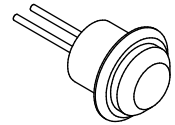

Side Marker Light
Red Color
Qty 2



MB6502
Grommet
Qty 2

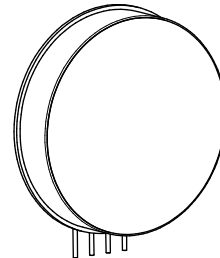

MB6502
LED Tail Light
Qty 2

MB1178-A JT Gladiator Bobbed Bed (Aluminum)

BAG LABELED AS
1178-SPARES

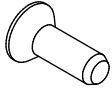

Countersunk Screw
1/4"-20 x 0.75"
Qty 6

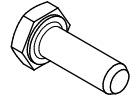

Hex Bolt
1/4"-20 x 0.75"
Qty 6



Flat Washer
1/4"
Qty 6



Nylock Nut
1/4"-20
Qty 6

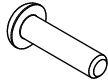

Hex Button Head Screw
#10-24 x 0.75"
Qty 6



Nylock Nut
#10-24
Qty 6



Hex Button Head Screw
1/4"-20 x 0.50"
Qty 6

MB1179-A - Shipping Rear Fenders (Aluminum)

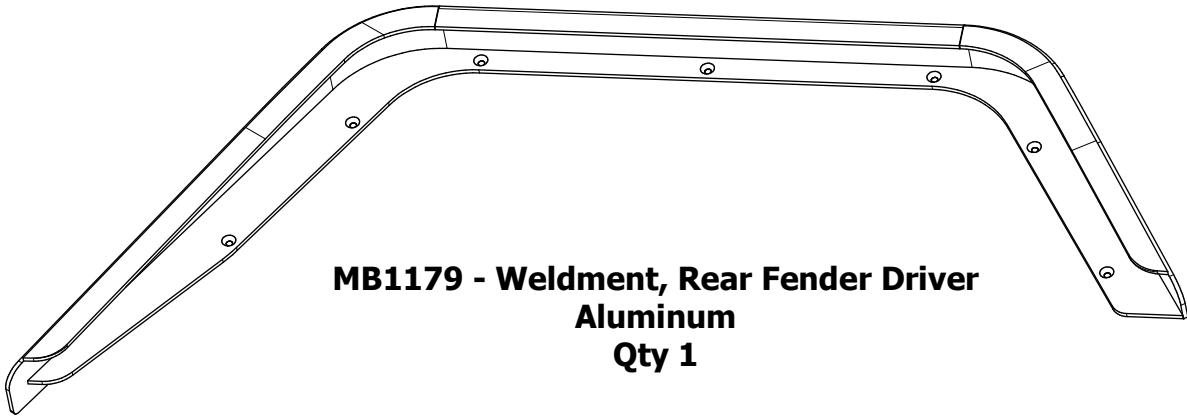

**MB1179 - Weldment, Rear Fender Driver
Aluminum
Qty 1**

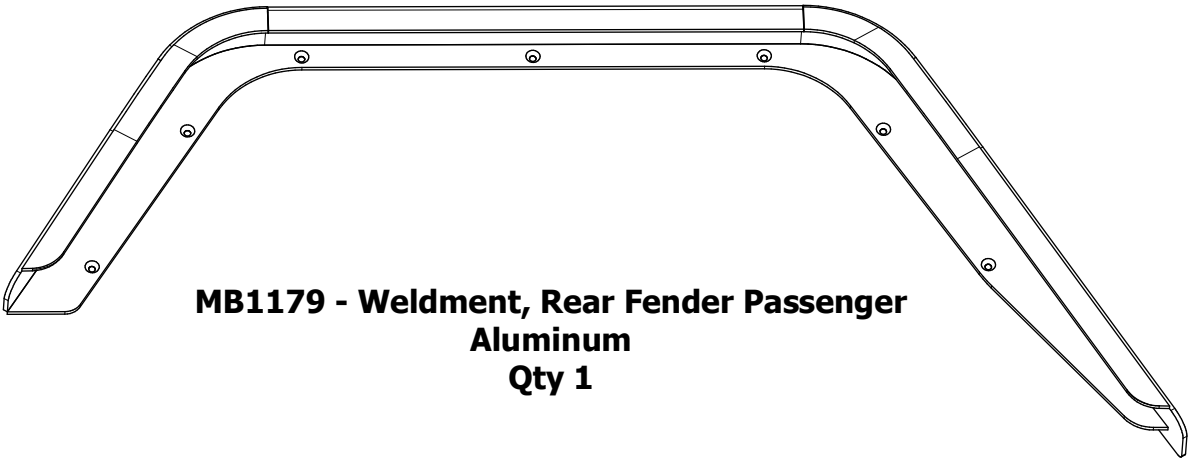

**MB1179 - Weldment, Rear Fender Passenger
Aluminum
Qty 1**

BAG LABELED AS

1179

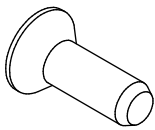

**Countersunk Screw
1/4"-20 x 0.75" Long
Qty 14**



**Flat Washer
1/4"
Qty 14**

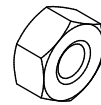

**Nylock Nut
1/4"-20
Qty 14**

MB1180 - Assembly Rear Bumper

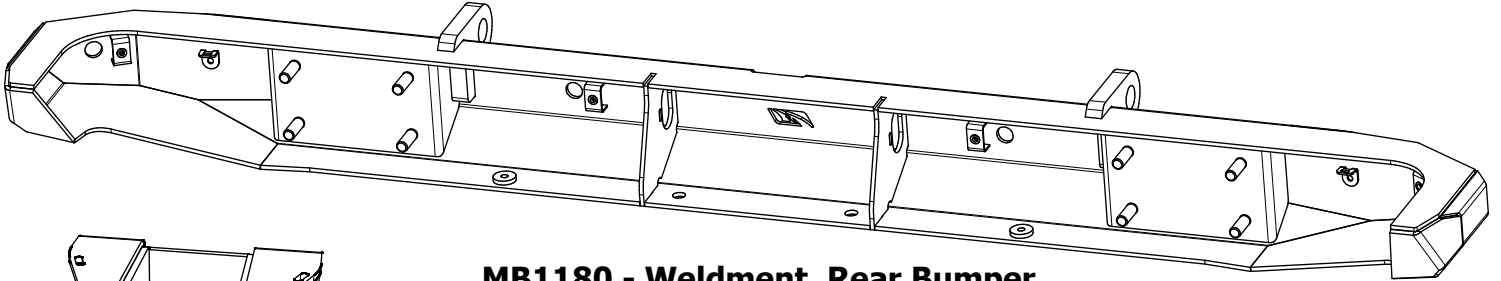

MB1180 - Weldment, Rear Bumper
Qty 1

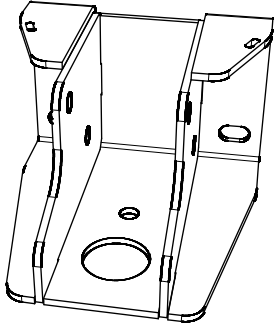

MB1180 - Weldment, Frame Mount
Qty 2

BAG LABELED AS
1180

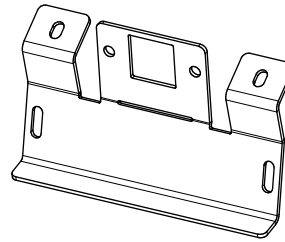

MB1180-14
Qty 1

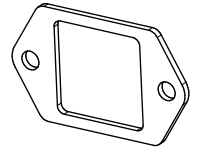

MB1180-15
Qty 1

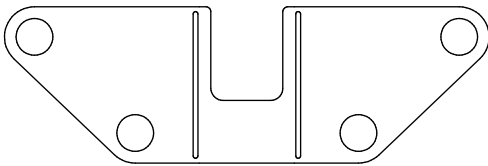

MB1180-12
Qty 2

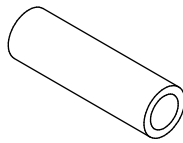

MB1180-Tube 01
Qty 4

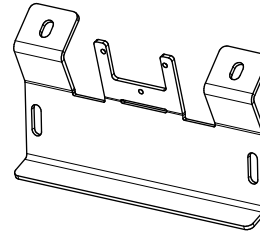

MB1180-11
Qty 1

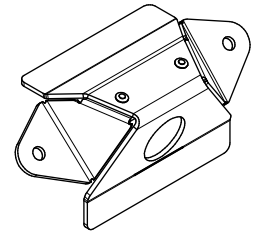

MB1180-Camera Housing
Qty 1

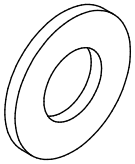

Flat Washer
1/2"
Qty 20



Flat Washer
M6
Qty 4

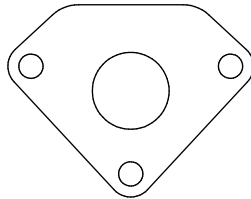

MB2115-08
Qty 1



Nylock Nut
#10-24
Qty 4



Screw
M3-0.5 x 8mm
Qty 3

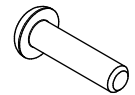

Hex Button Head Screw
#10-24 x 0.75"
Qty 8

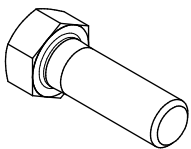

Hex Bolt
1/2"-13 x 1.50"
Qty 2

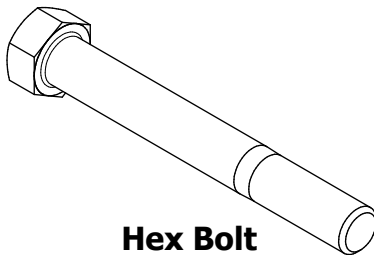

Hex Bolt
1/2"-13 x 4.00"
Qty 4

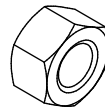

Nylock Nut
1/2"-13
Qty 14

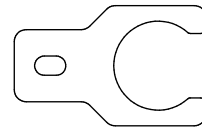

MB2117-01
Qty 4

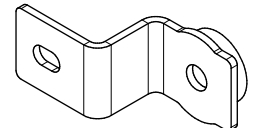

MB2145
Park Sensor Blank Off
Qty 4