

FRONT FENDER FLARES - JL/JLU/JT

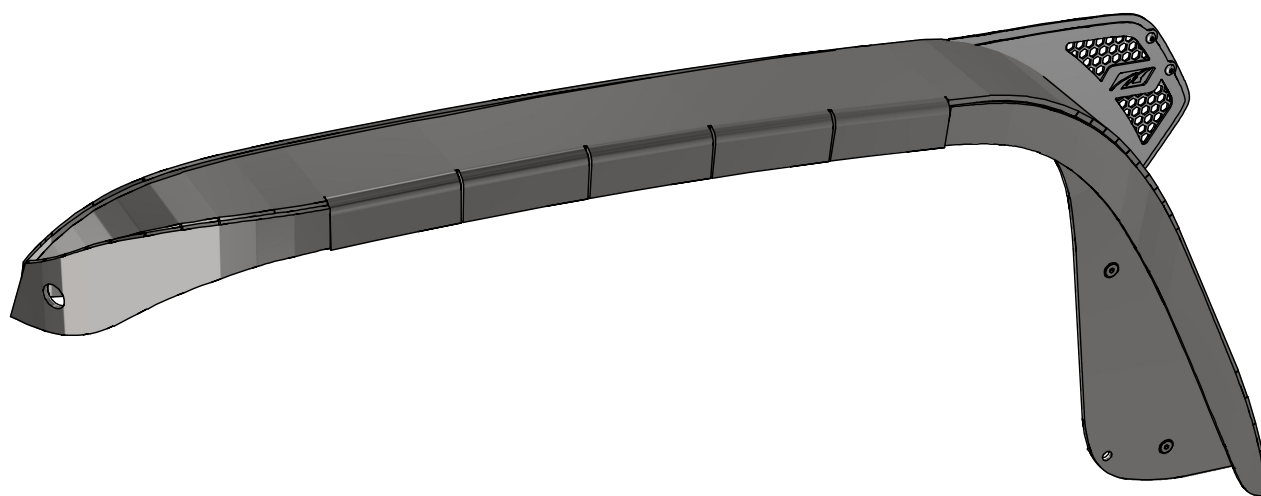

ASSEMBLY INSTRUCTIONS

MB1101 - Assembly Instructions Front Fenders - JL/JLU/JT

KIT COMPONENTS

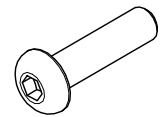
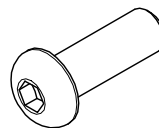
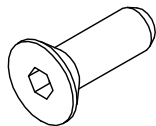
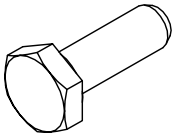
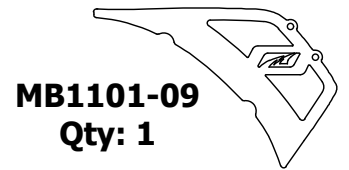
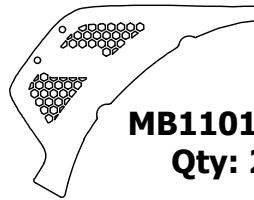
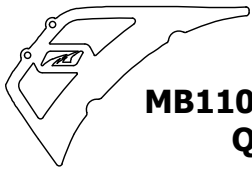
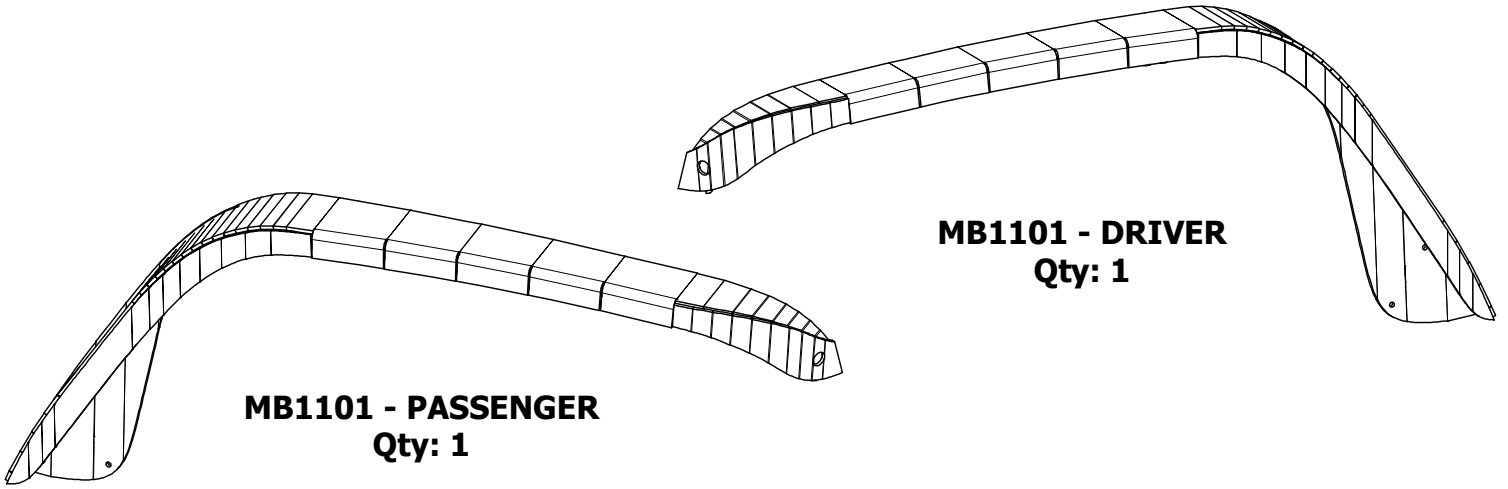

3/4" CLEAR LENS LED
FENDER/SIDE
MARKER LIGHT
2 PACK

MB6500
Qty: 1

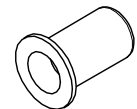
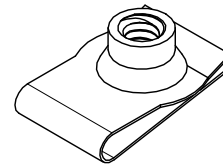
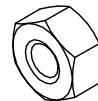
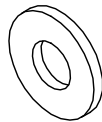

MB1101 - Assembly Instructions Front Fenders - JL/JLU/JT

FENDER STRUCTURE MODIFICATION

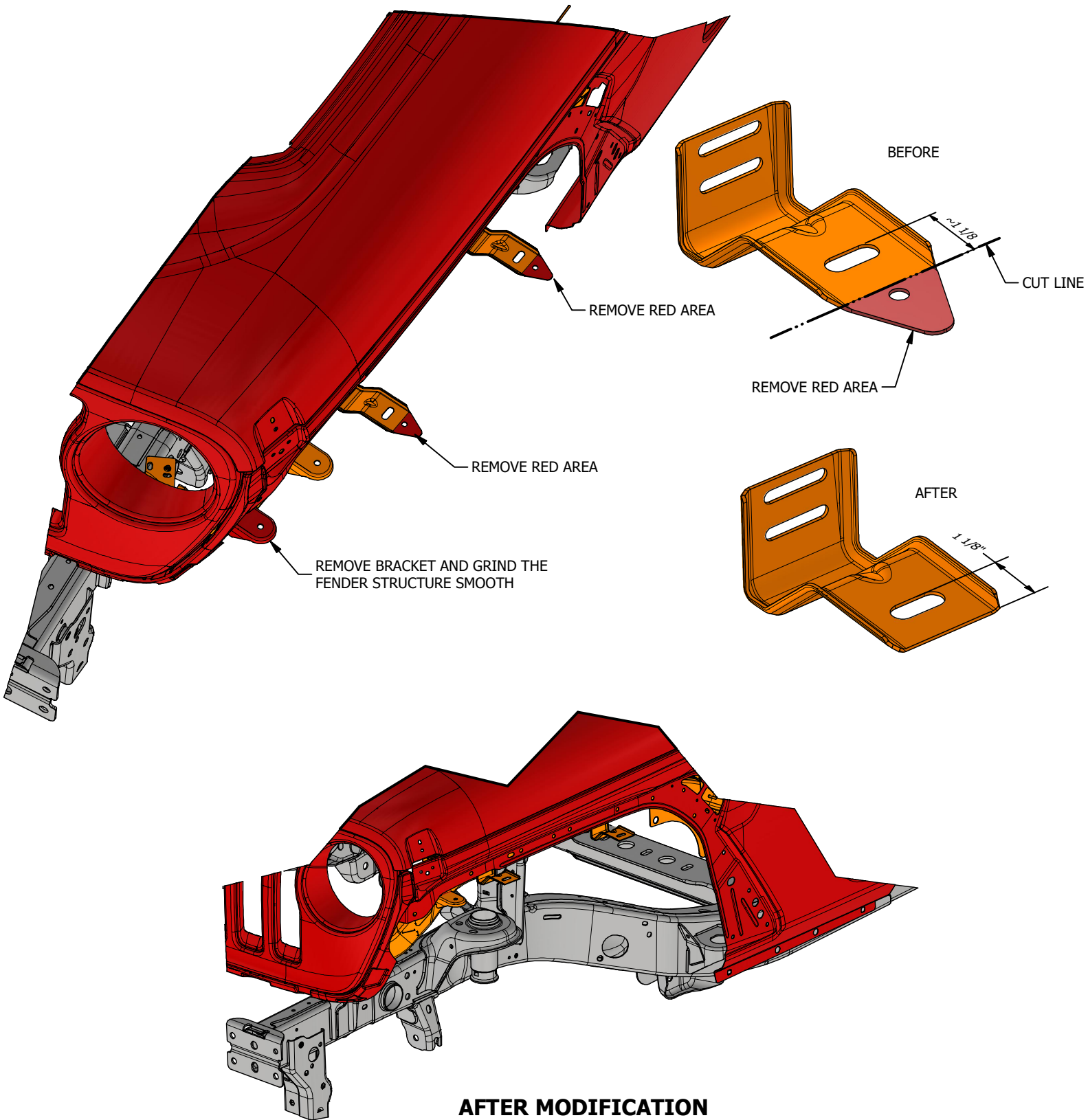

MB1101 - Assembly Instructions Front Fenders - JL/JLU/JT

VENT PLATE INSTALLATION

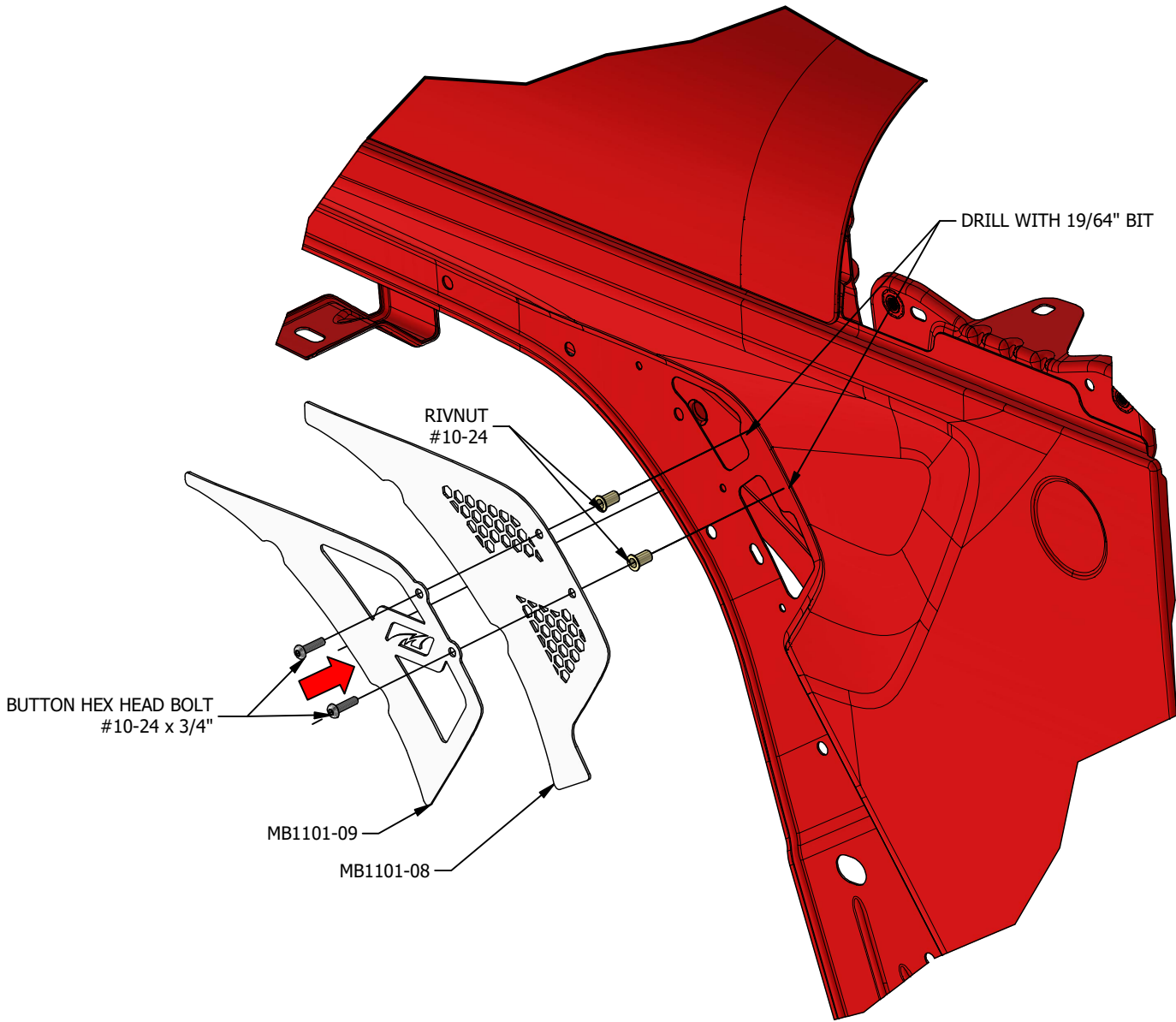

HOLD PLATE MB1101-08 ONTO THE JEEP BODY SO IT SHOWS AN EVEN REVEAL. MARK AND DRILL THE TWO HOLES ON THE JEEP BODY FOR THE RIVNUTS USING A 19/64" BIT.

NOTE THE EVEN REVEAL AROUND THE BODY LINE AND MB1101-08

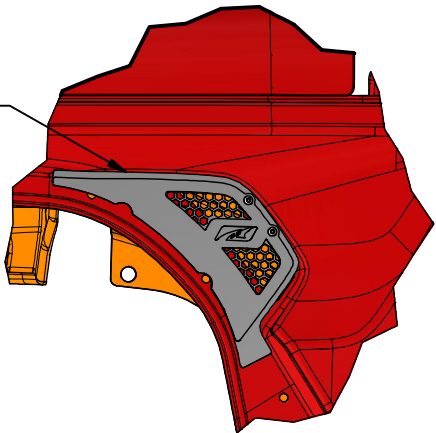

MB1101 - Assembly Instructions Front Fenders - JL/JLU/JT

FENDER PREPARATION

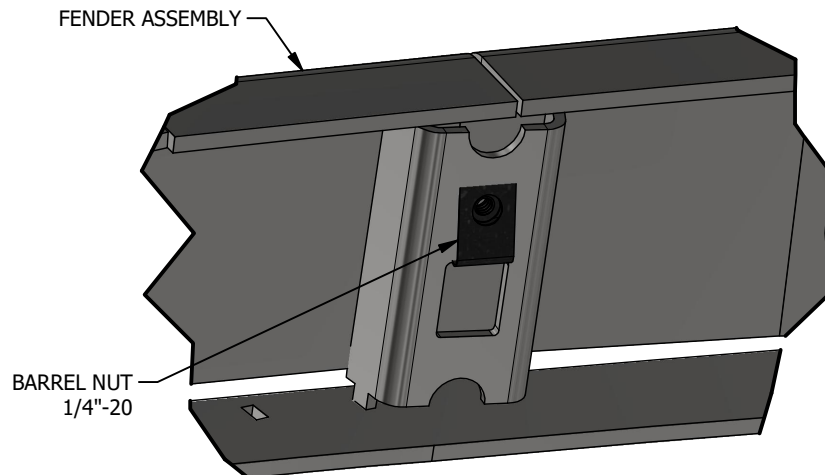
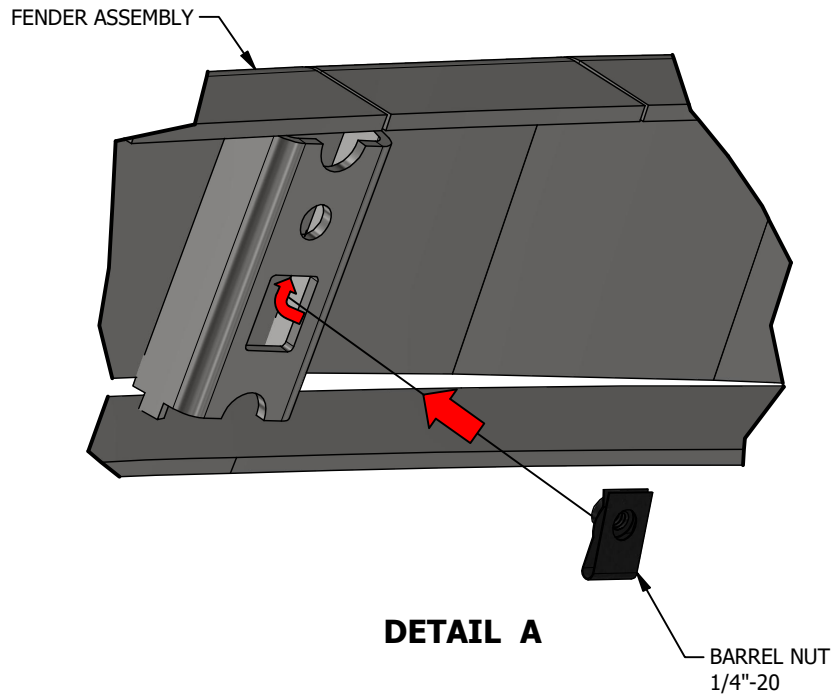
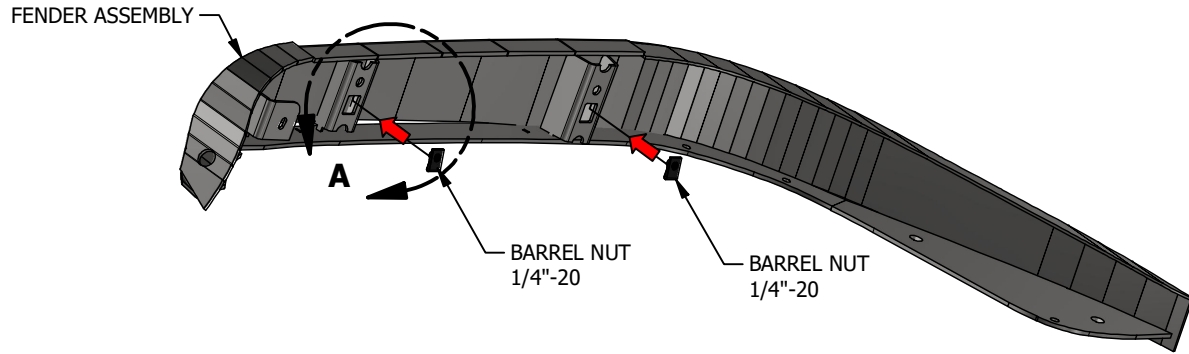

MB1101 - Assembly Instructions Front Fenders - JL/JLU/JT**FENDER PREPARATION**

TEMPORARILY MOUNT THE FENDER AND MARK THE FOUR HOLES (CIRCLED IN RED) ONTO THE JEEP BODY. REMOVE THE FENDER THE DRILL THE FOUR MARKS MADE PREVIOUSLY TO CLEARANCE THE 1/4" HARDWARE.

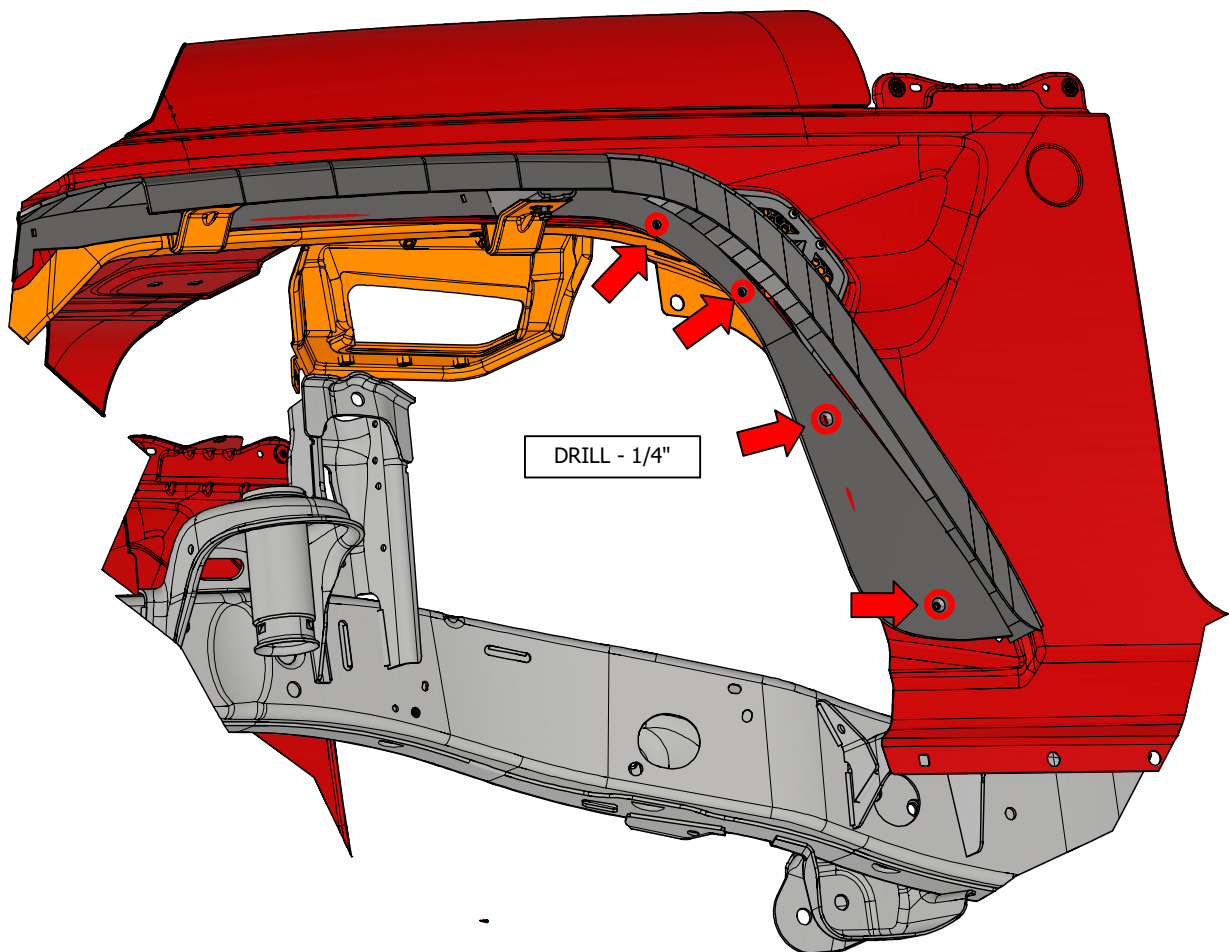

MB1101 - Assembly Instructions Front Fenders - JL/JLU/JT

FENDER INSTALLATION

HARDWARE LIST		
ITEM	PART NUMBER	DESCRIPTION
1	1/4-20 UNC x 0.75	Hexagon Socket Flat Countersunk Head Cap Screw
2	1/4"-20 UNC Barrel Nut	Barrel Nut
3	ANSI B18.2.1 - 1/4-20 UNC - 0.75, HCSI	Hex Cap Screw
4	ANSI B18.22.1 - 1/4 - narrow - Type B	Plain Washer (Inch)Type A and B
5	ANSI B18.2.2 - 1/4 - 20, HNI	Hex Nuts (Inch Series) Hex Nut
6	ANSI B18.3 - 10 - 24 x 3/4, HSBHCSI	Hexagon Socket Button Head Cap Screw
7	ANSI B18.22.1 - 1/4 - narrow - Type A	Plain Washer (Inch)Type A and B
8	ANSI B18.3 - 1/4 - 20 x 3/4, HSBHCSI	Hexagon Socket Button Head Cap Screw

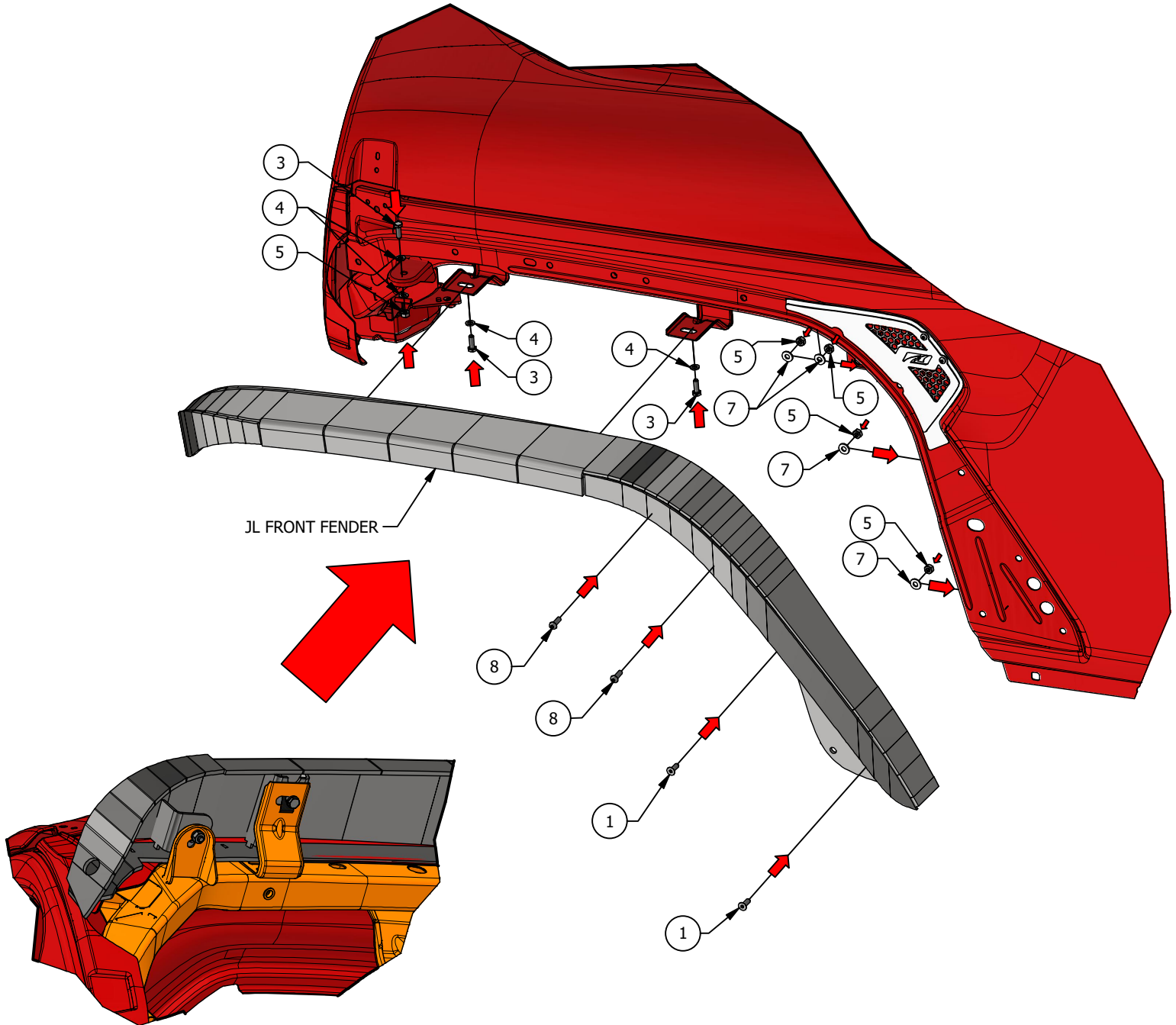

Wire Insertion Side:

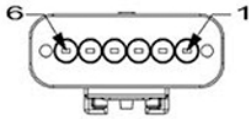

Pin	Circuit	Wire Color	Gauge/Size	Function	Option
1	L552	BG/OG	0.35	RIGHT FRONT LIGHTING FAULT SENSE	PREMIUM
2	L60	WH/BG	0.75	RIGHT FRONT TURN LAMP DRIVER	
3	Z904	BK	0.75	GROUND	
4	L78	WH/OG	0.75	RIGHT FRONT PARK LAMP DRIVER	
5	L59	WH/DB	0.75	RIGHT DRL LAMP DRIVER	
6	Z904	BK	0.75	GROUND	