



Installation instructions for Jeep JL Skid Plate System PN MB1099

MOTO BILT.COM

PARTS LIST			
ITEM	QTY	PART NUMBER	DESCRIPTION
1	1	MB1099-A	JL Belly Skid Weldment
2	9		CS Screw 3/8" UNC x 1.0" lg

UNDERSIDE VIEW OF  
JL SKID SYSTEM #MB1099

**MB1099-A**  
Description:  
**JL Transmission Skid**

Dwg/Part No: **MB1099-A**

Mat'l:

Sheet No: **1** of **4**  
Rev No: **0**

THIS DOCUMENT & THE INFORMATION CONTAINED WITHIN IS THE SOLE PROPERTY OF MOTO BILT INC. THIS DOCUMENT SHALL NOT BE COPIED, STORED, DUPLICATED, REVERSE ENGINEERED OR OTHERWISE REPRODUCED WITHOUT THE EXPRESS WRITTEN CONSENT OF MOTO BILT INC. COPYRIGHT © MOTO BILT INC. COPYRIGHTED MATERIAL IS PROTECTED BY INTERNATIONAL COPYRIGHT LAWS. "MOTO BILT" IS A REGISTERED TRADE NAME.

Remove the two (2) nuts using a 13 mm socket from the transfer case skid plate cross member.



Remove the four (4) bolts using a 14mm socket next as shown.

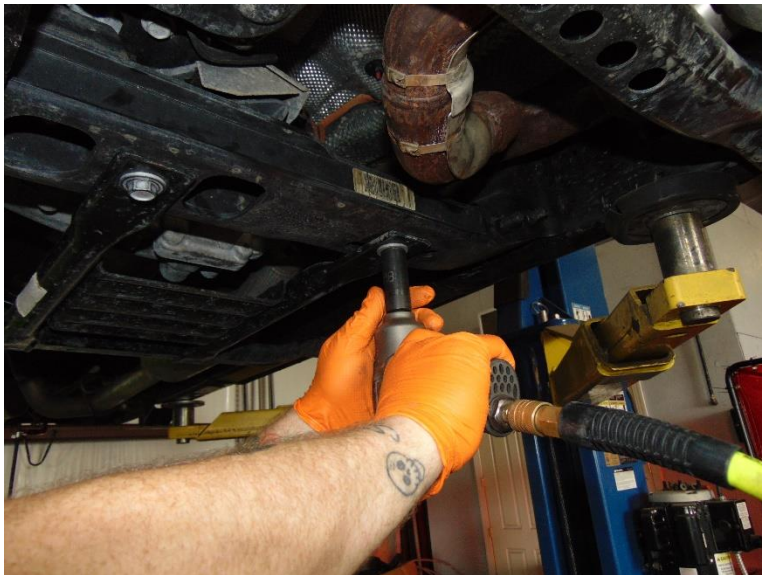

Then the tubular cross member can be removed. Do not remove the transmission cross member.



Remove the three (3), 14 mm bolts using an 18mm socket and then remove the exhaust cross member.

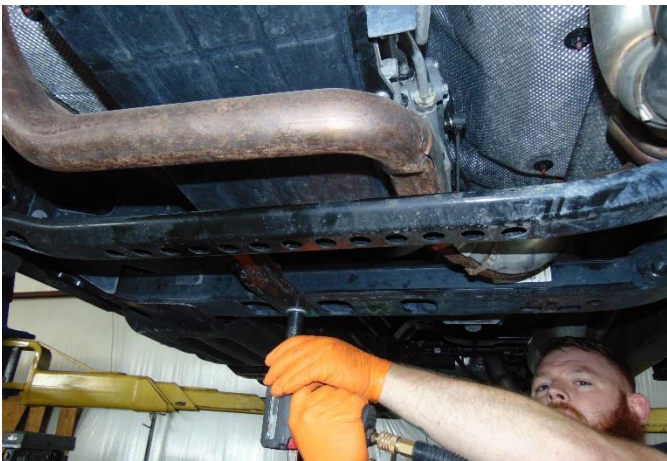

Mark the gas tank skid plate so that 1/2" can be removed to clearance for the new Motobilt skid plate.  
Part Number MB1099-A





A cut off wheel works well to cut the skid plate.



Here you can see approximately 1/2" was removed from the factory skid plate.



Next position the new transfer case skid plate into position. MB1099-A



If installing on the ground, you may use a floor jack to help. We used an adjustable jack stand (shown below) as we were installing using a lift.

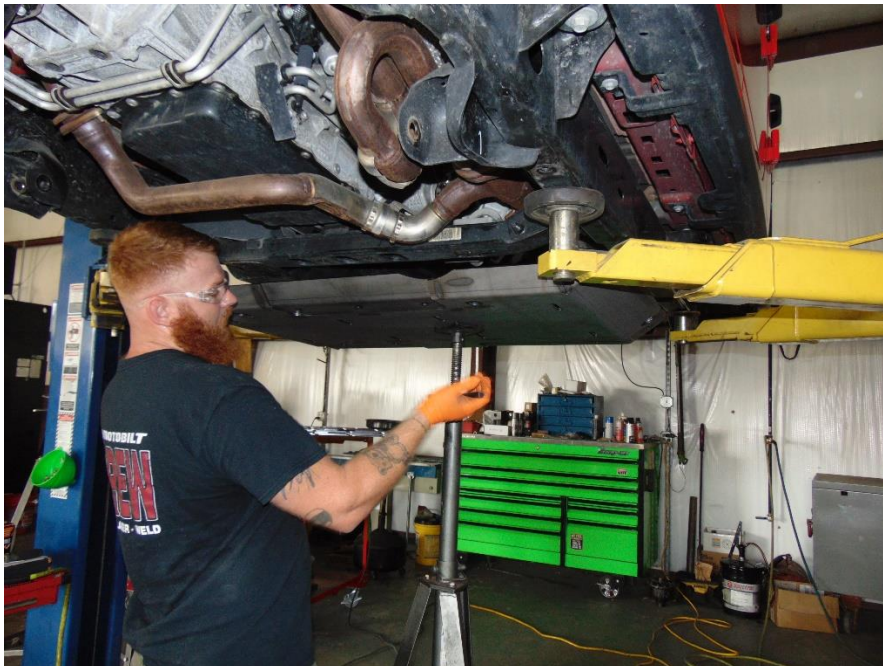



Re install the two (2) nuts back in the factory location using a 18 mm socket.



Use four (4) of the 14 mm bolts that were removed earlier to install around the perimeter of the skid plate loosely. An 18 mm socket is used.



PARTS LIST			
ITEM	QTY	PART NUMBER	DESCRIPTION
1	4		Hex Bolt 1/2" UNC x 1.0" lg
2	4		Nylock Nut 1/2"
3	8		Flat Washer 1/2"
4	4		Hex Bolt 3/8" UNC x 1.0" lg
5	4		Nylock Nut 3/8"
6	4		Flat Washer 3/8"
7	4		CS Screw 3/8" UNC x 1.0" lg
8	1	MB1099-B-01	JL Engine Skid
9	1	MB1099-B-03	Hanger - Driver
10	1	MB1099-B-05	Hanger - Pass

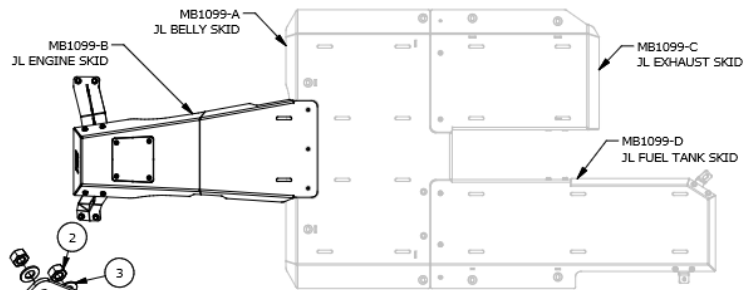

UNDERSIDE VIEW OF  
JL SKID SYSTEM #MB1099

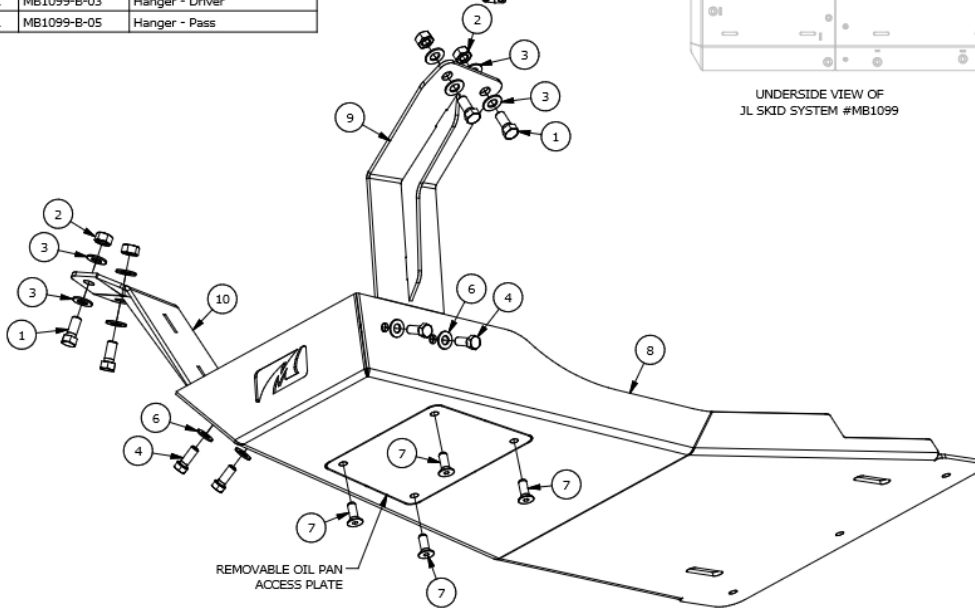

Dwg/Part No:  
**MB1099-B**  
Description:  
**JL Engine Skid**

Sheet No: 2 of 4  
Rev No: 0  
Matl:

On the passenger side install the skid plate hanger (MB1099-B-05) using the existing bolt holes and two (2) grade 8, ½ bolts with flat washers and nyloc nuts. Do not tighten these bolts all the way as you may need some adjustments for the final install

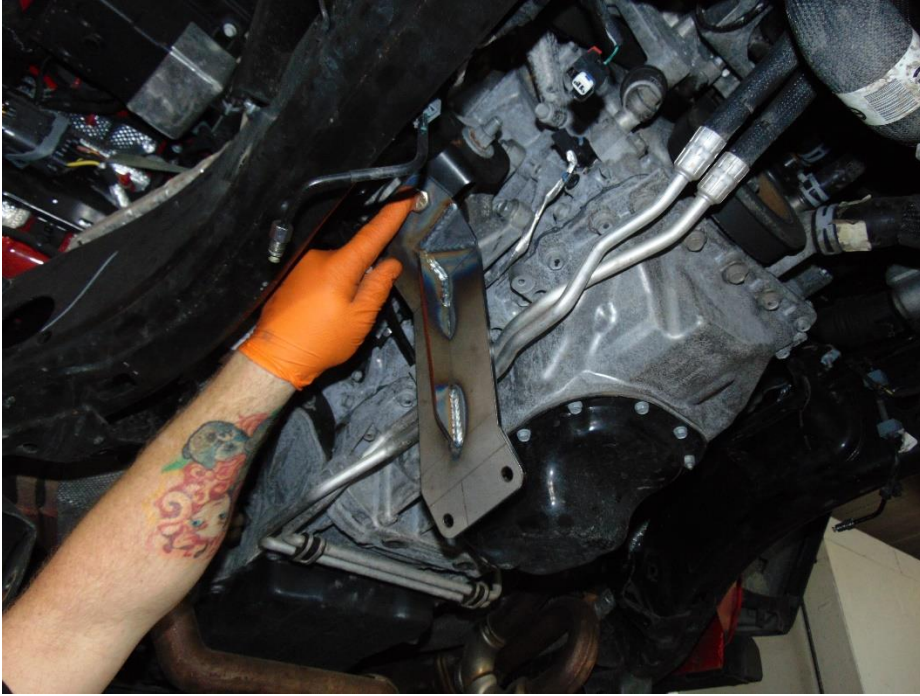

Repeat these same steps for the driver's side. (MB1099-B-03)





Here you can see both hangers installed.

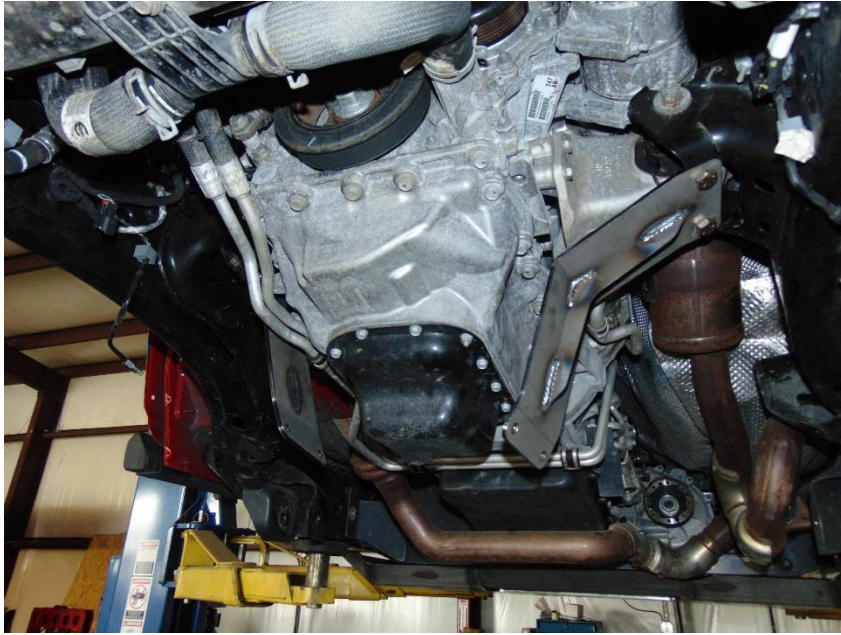

Shown below is the engine skid plate with the inspection panel installed. (MB1099-B)



In the following 2 photos you can see how to slide the skid plate into position.



The engine skid will bolt to the transfer case skid plate using three (3) of the 3/8" x 1" countersunk bolts. The transmission skid plate has pre-installed weld nuts for an easy installation.



Install four (4) of the 3/8" x 1" grade 8 hex head bolts in the front of the engine skid plate to the brackets that were previously installed.

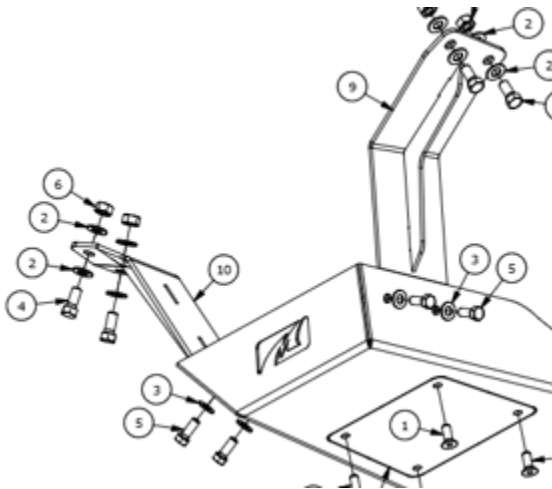

This is how it should look once installed. Now all the bolts can be tightened to 35 ft/lbs.





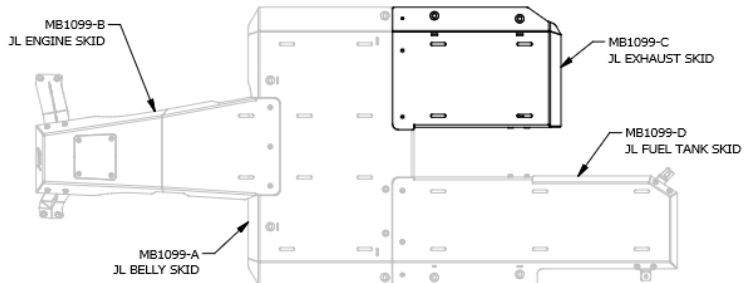

UNDERSIDE VIEW OF  
JL SKID SYSTEM #MB1099

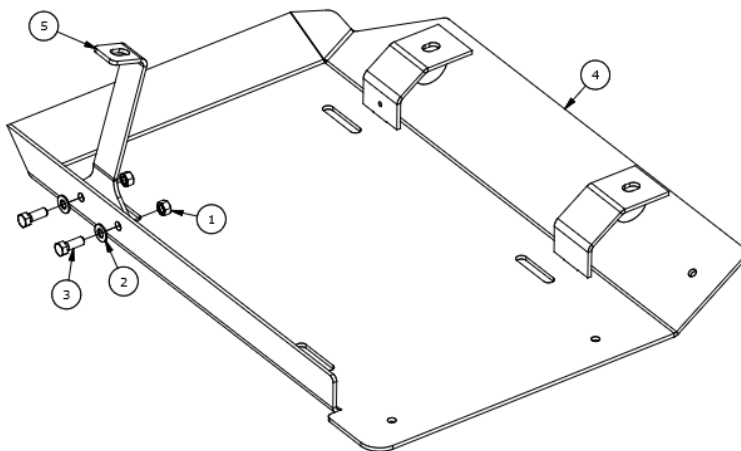

PARTS LIST			
ITEM	QTY	PART NUMBER	DESCRIPTION
1	2		Nylock Nut 3/8"
2	2		Flat Washer 3/8"
3	2		Hex Bolt 3/8" UNC x 1.0" lg
4	1	MB1099-C	JL Exhaust Skid
5	1	MB1099-C-04	Hanger



Dwg/Part No:  
**MB1099-C**  
Description:  
**JL Exhaust Skid**

Sheet No: 3 of 4  
Rev No: 0  
Matl:

Re use the factory 14 mm bolt to attach the exhaust skid plate hanger to the existing cross member.



Next position the exhaust skid plate using either a floor jack or adjustable jack stand if using a lift.



Attach the bracket to the skid plate using 3/8" x 1" grade 8 hex bolts with flat washers and nyloc nuts.

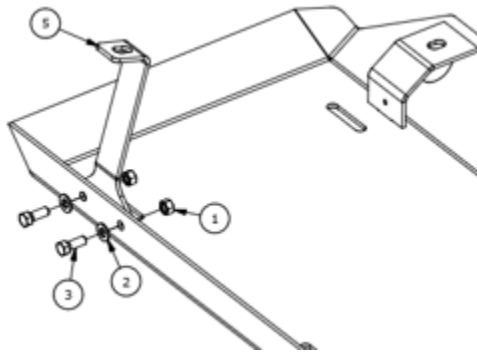

Install the 3/8" x 1" countersunk bolts to attach the skid plates.





Next install the factory 14 mm bolts loosely into the factory locations using an 18mm socket.

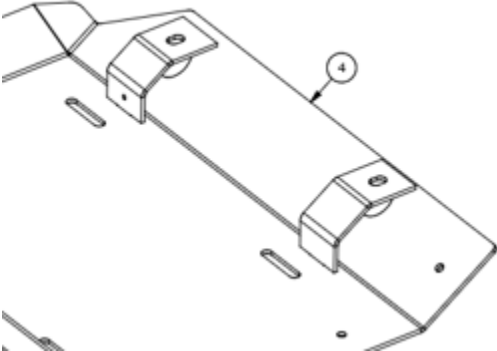

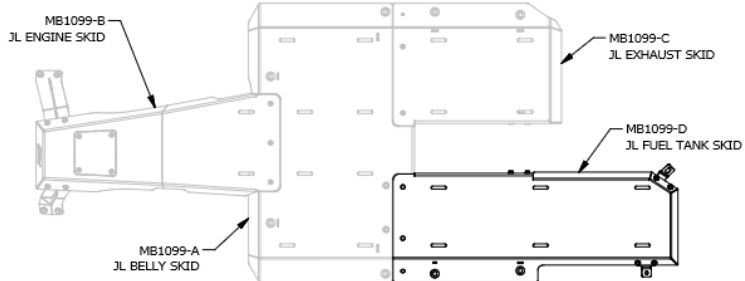

UNDERSIDE VIEW OF  
JL SKID SYSTEM #MB1099

PARTS LIST			
ITEM	QTY	PART NUMBER	DESCRIPTION
1	6		Hex Bolt 3/8" UNC x 1.0" lg
2	6		Nylock Nut 3/8"
3	6		Flat Washer 3/8"
4	1	MB1099-C-04	Hanger
5	1	MB1099-D	JL Fuel Tank Skid
6	1	MB1099-D-04	Hanger
7	1	MB1099-D-05	Hanger

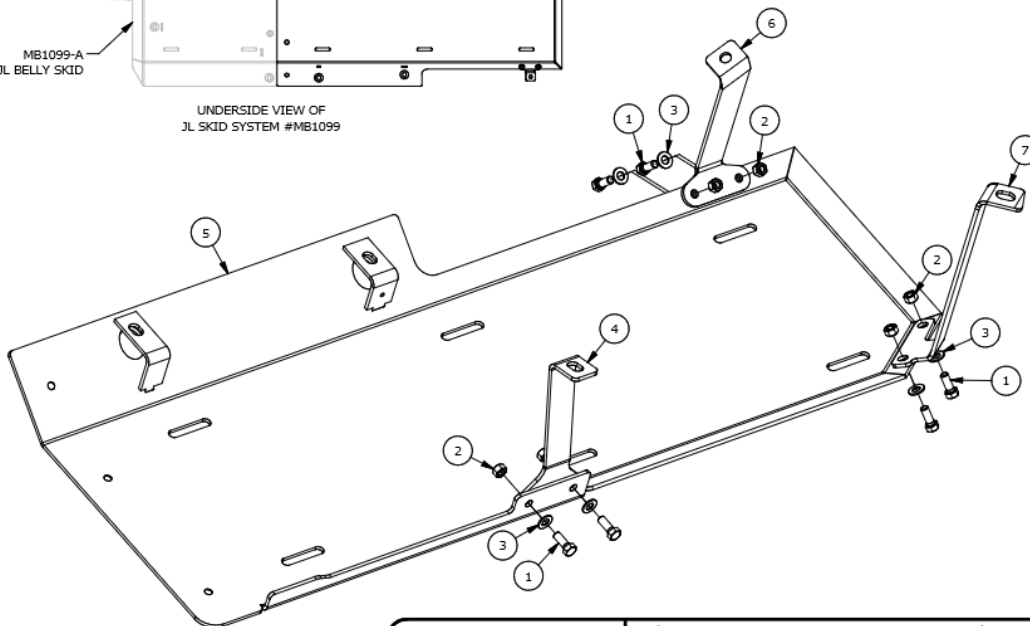

Dwg/Part No:  
**MB1099-D**  
Description:  
**JL Fuel Tank Skid**

Sheet No: **4** of **4**  
Rev No: **0**  
Mat'l:

Remove 4 of the 5 bolts holding the factory gas tank skid plate. Do not remove the 5th inside bolt near the rear of the driveshaft as this will be holding the weight of the fuel tank.



These use an 18 mm socket.







The 5<sup>th</sup> bolt shown on top is the one remaining bolt that will be removed later.



Next position the Motobilt gas tank skid plate. PN# MB1099-D



The Motobilt skid plate was built with cut outs so that a 2-post lift can still be used without removal of the skid plate.



Install the 3/8" x 1" countersunk bolts.



Reinstall the 14 mm bolts using an 18 mm socket back into the factory locations for the gas tank skid plate.





Install the 1099C-4 bracket to the factory cross member using the factory 14 mm bolt with an 18mm socket.

Install 2 of the 3/8" x 1" grade 8 hex bolts to attach the bracket to the skid plate.

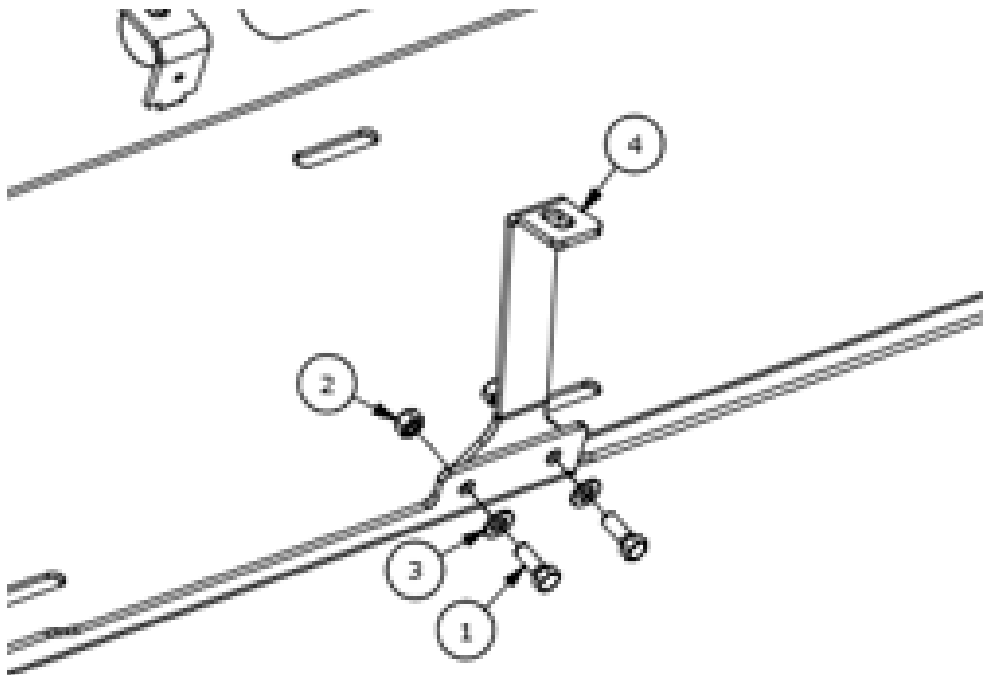
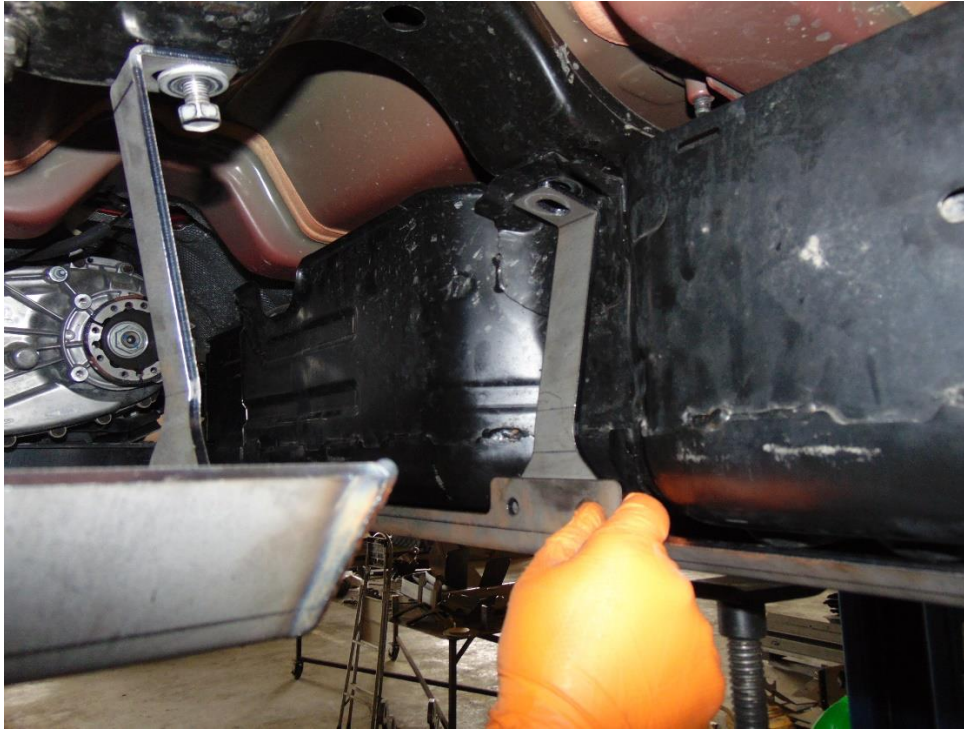

Install the 1099-D-04 bracket to the skid plate using two (2) of the 3/8" x 1" grade 8 hex bolts, washers and nyloc nuts.

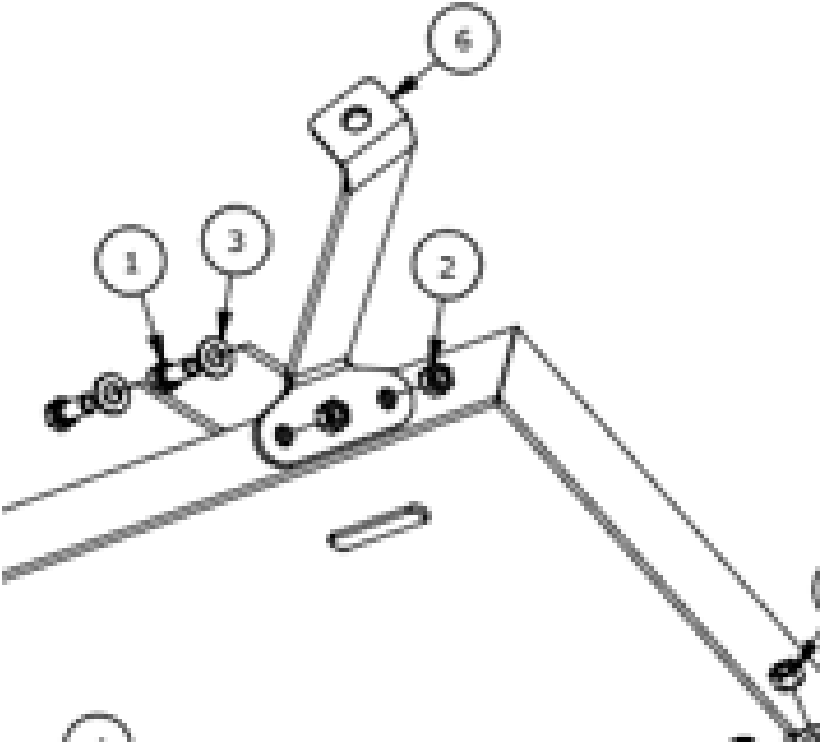

Reinstall the factory 14 mm bolt and hanger MB1099-D-05 into the factory location using an 18 mm socket.



It is now safe to remove the 5<sup>th</sup> factory bolt holding the factory gas tank skid plate so that you may install the new Motobilt bracket. MB1099-D-05

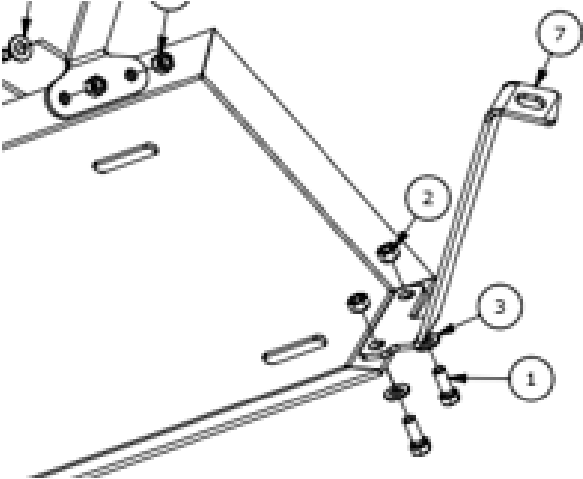



Now the 14 mm bolts can be torqued to 75 ft/lbs using an 18 mm socket.



Final assembly shown.

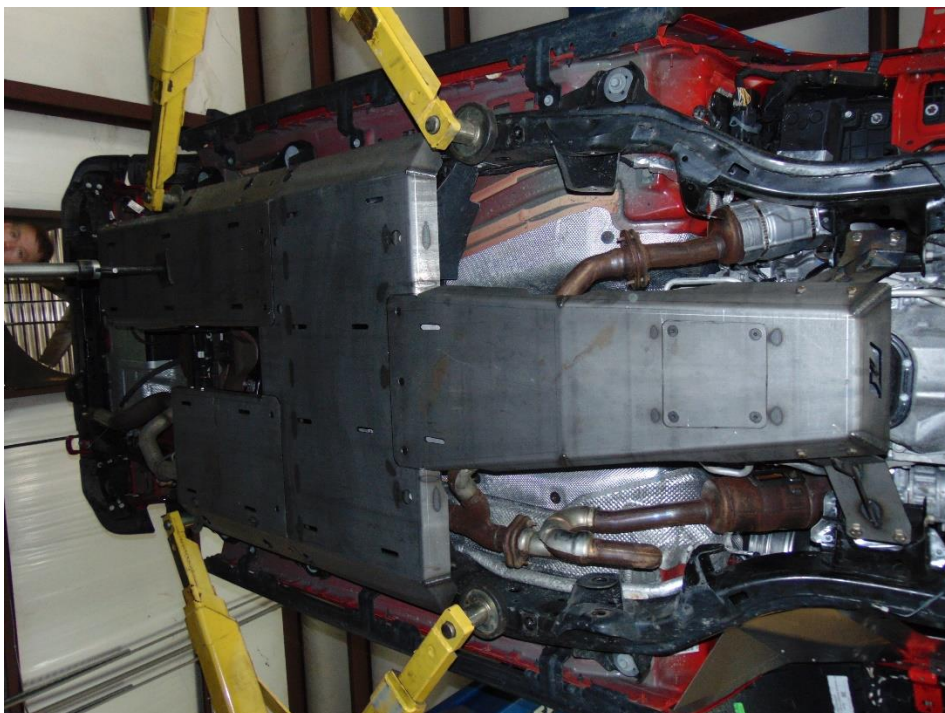

Here you can see the easy access panel for the oil drain plug removed.



The sides of the skid plate leave no bolts exposed.





The boatside style skid plate can be seen clearly below.



This boat side was designed to prevent your Jeep from catching on any obstacles.

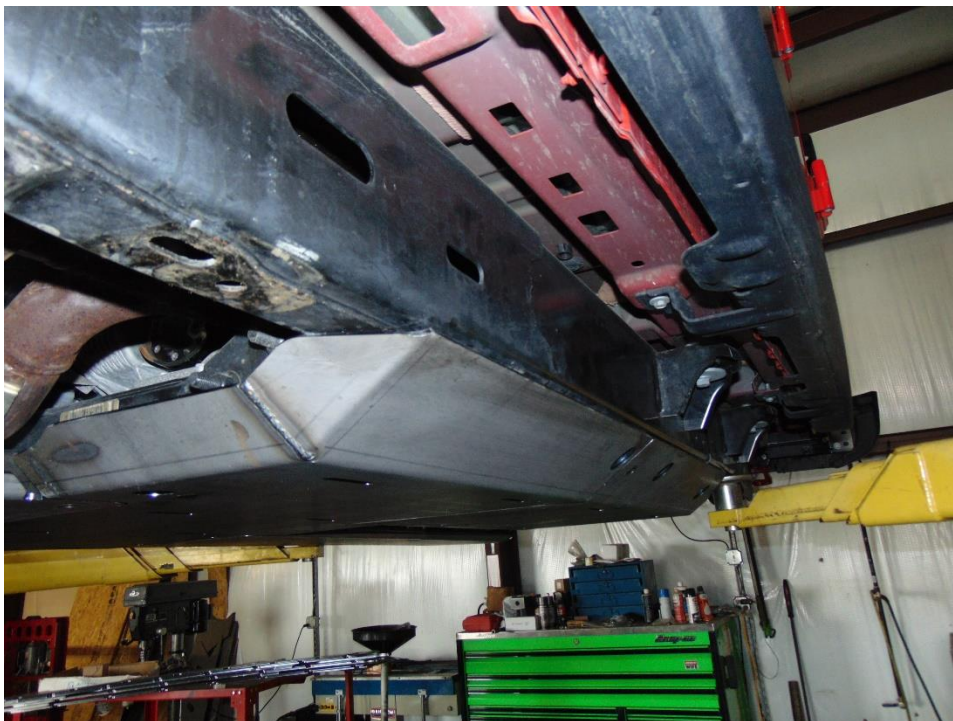

If you have any questions you can email us at [info@motobilt.com](mailto:info@motobilt.com) or call us at 334-219-2333