

INSTALLATION GUIDE



BEFORE YOU BEGIN

Read these instructions completely and carefully

⚠ WARNING

- Must be installed by a qualified electrician.
- Follow all local codes.
- Use only approved wire for input/output connections.
- Turn power off before inspection, installation or removal.
- Properly ground electrical enclosure.

Unit installation

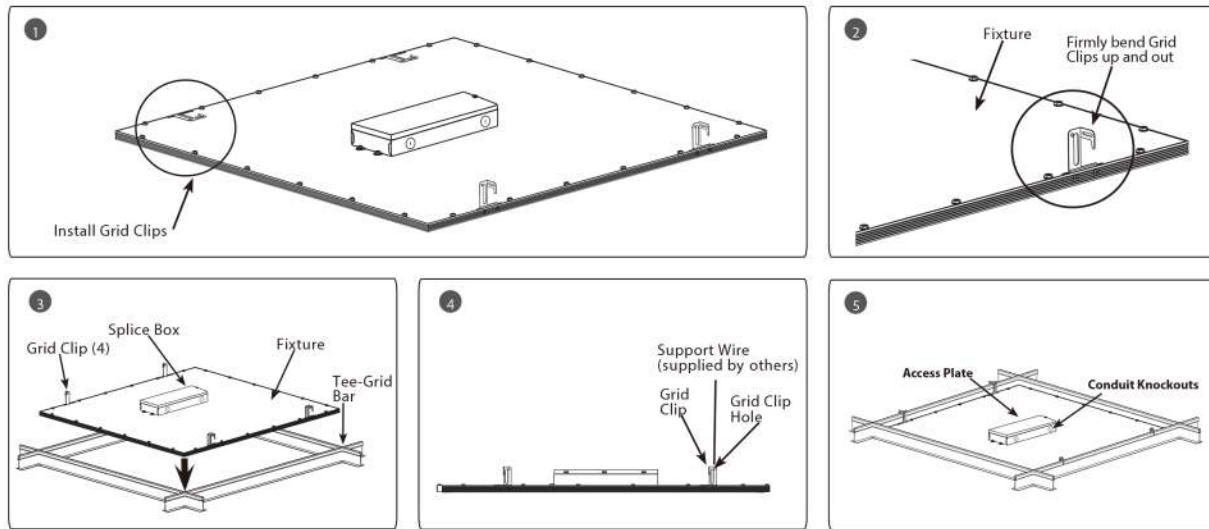

- Turn off the power at the circuit breaker box.
- Remove the fixture from the packaging.
- Rest the Luminaire on the T-Bar of the ceiling suspension system in the desired location .
- Remove the Wire Cover to access the wires .

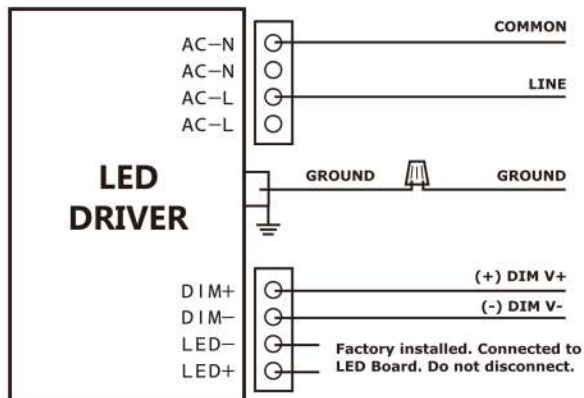

- Thread the Power Supply Wires through the Hole and the Dimming Wires through the Hole in the Wire Cover .
- Plug the stripped incoming L&N wires into the corresponding hot(L), neutral (N) terminal block.
- Connect the supply ground wire to the fixtur ground wire using a wire nut.
- For 0-10V diming, plug the stripped wires of incoming positive (+) and negative (-)dimming-control leads into the corresponding 0-10V Dimming Block.
- Reinstall the Wire Cover back to the Luminaire.
- Restore power at the circuit breaker box.



1050 Crown Pointe Parkway Suite 500 Atlanta, GA 30338

404.870.3543

ecoledmart.com

sales@ecoledmart.com