

STREET LIGHT MOUNTING GUIDE



Installation I : ADJUSTABLE FITTER MOUNTING

Installation Steps:

- 1: Loosen the 4 locking bolts on the slip fitter, connect the wire correctly and put the wire into pole. Then fasten the locking bolts between slip fitter and the pole. (Figure 1-1)
- 2: Loosen the fixing bolts and adjusting bolts, align the fixture to required angle. Tighten adjusting bolt and fixing bolts after the angle is confirmed. (Figure 1-1)

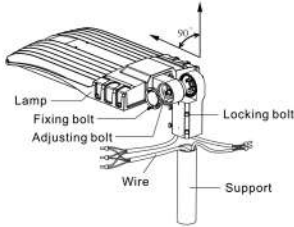

Figure 1-1

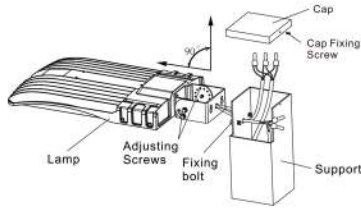

Figure 2-1



Installation II : YOKE MOUNTING

Installation Steps:

- 1: Loosen cap fixing screw and take cap off. Loosen fixing bolt, fixed the fixture on the support and tighten fixing bolts. (Figure 2-1)
- 2: Let the AC wire go through support hole and connected correctly. Close cap and tighten cap fixing screw after AC cable is well placed in the support. (Figure 2-1)
- 3: Loosen adjusting screws, align the fixture to required angle and fasten the screws. (Figure 2-1)

Installation III: DIRECT MOUNTING

Installation Steps:

- 1: Open the side lid of direct bracket, let the power cable go through the direct bracket. Fix the direct bracket to the end of lamp body with bolt. Let the pole cable go through the direct bracket. (Figure 3-1)
- 2: Fix the direct bracket to the square pole with bolt. Connect the power cable to the pole cable, make sure good protection on the wire connection, and put the wire in the direct bracket; close the side lid and tighten it, (Figure 3-2) then finish in installation.
- 3: Notice: Round pole should be with adapting plate. (Figure 3-3)

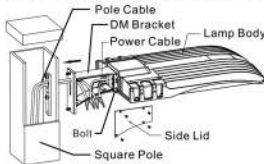

Figure 3-1

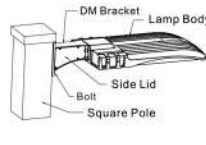

Figure 3-2
-2-

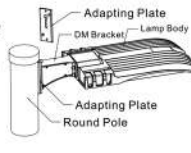

Figure 3-3

Installation IV: FLOOD MOUNTING

Installation Steps:

- 1: Use the electric drill to drill holes on the poles or suspended walls. (The hole pitch should be according to the actual application of products, the hole size should be same as the screw the user has. (Figure 4-1)
- 2: Put the installation bracket on the pole position, and using screws and nuts to fix the light tight, adjust to the desired light angle. (Figure 4-2)
- 3: Connect the wire of the lamp to the mains according to local wiring rules, make good protection on the connection, put the wire into the pole, cover the pole cover, tighten the side screws. (Figure 4-2)

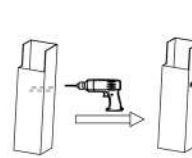

Figure 4-1

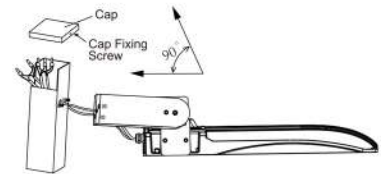

Figure 4-2

Installation V : INSERT MOUNTING

Installation Steps:

- 1: Take off the top bolt on IM bracket. Open side lid on the back part after take IM bracket apart into the front part and the back part. Let the power cable go through the front part of the IM bracket. Fix the front part to the end of lamp body with bolt. Let the pole cable go through the back part of the IM bracket. Fix the back part of the IM bracket to the pole with bolt. (Figure 5-1)
- 2: Let the power cable in the front part of the IM bracket go through the back part. Sheath the front part to the back part and fix them with top bolt. Connect the power cable with pole cable, make sure good protection on the wire connection and put the wire in the back part. Close the side lid and tighten it, (Figure 5-2) then finish installation.
- 3: Notice: Round pole should be with adapting plate. (Figure 5-3)

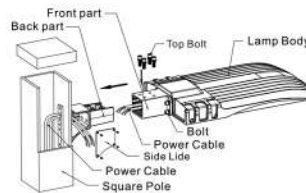

Figure 5-1

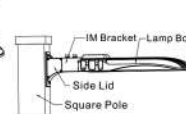

Figure 5-2

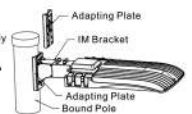

Figure 5-3

-3-



404.870.3543

1050 Crown Pointe Parkway Suite 500 Atlanta, GA 30338

ecoledmart.com

sales@ecoledmart.com