

Brewer

FLEX Access
Exam Table

Installation & Operation Manual

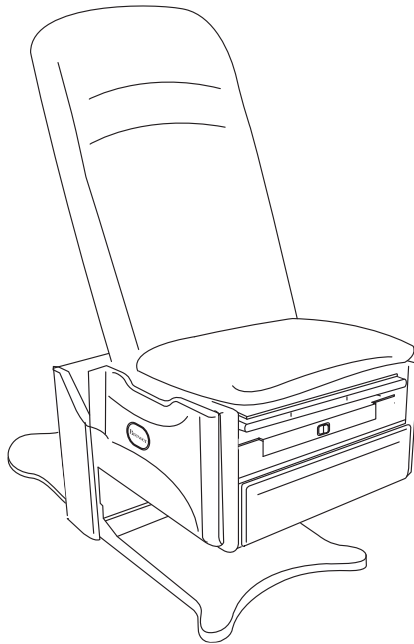

<i>Important Information</i>	2	<i>Operation</i>	12
<i>Safety Information</i>	3	<i>Table Adjustments</i>	18
<i>Component Identification</i>	3	<i>Maintenance</i>	21
<i>Specifications</i>	4	<i>Service</i>	21
<i>Installation</i>	5	<i>Warranty</i>	22
		<i>Accessories</i>	22

The Brewer Company, LLC
N88 W13901 Main Street, Suite 100
Menomonee Falls, WI 53051
P 1.888.Brewer.1
F 262.251.2332
www.brewercompany.com

General

Read and understand all operating instructions, safety information, and maintenance requirements contained in this manual prior to operating the table. Become familiar with all of the table functions before using it with a patient.

The Brewer Flex Access Exam Table Models 5700 and 5800 Series are designed to provide positioning and support of patients during general examinations conducted by qualified medical professionals. The Brewer Flex Access Exam Table is primarily used in examination rooms for general examinations and minor procedures. The wide variety of positions provided by one or two powered motions, and slide-out leg support create a safe and convenient patient positioning table for use in the doctor's office.

The table is easily adjusted to a wide variety of positions using the convenient foot control provided with the table. The table height can be adjusted from 18" to 37". The table seating surface on models 5701 and 5801 can be moved from the normal horizontal position to an angle of 5°. The backrest can be adjusted from a flat lying down position, to an 80° angle for seating.

In addition to the electronically controlled positions noted above, several manual adjustments are available:

Standard Features

- The SafeGlide™ leg support can be extended up to 18" for the patient prone position.
- A removable treatment pan is built-in underneath the leg support pad for use during examinations.
- A storage drawer at the front of the table may be used for supplies.

Optional Features

- Stirrups - may be manually extended through infinite positions and four lateral positions.
- Grab bars - attached to each side of the table may be rotated out of position or removed for improved access to the patient.
- Pass through work surface - stored under the seat, may be pulled out from either side of the table.

Service

If you require assistance with the installation or operation of your Brewer table, call the Brewer Customer Service Department at **(1-888-Brewer1)**. Our trained staff will attempt to assist you in correcting the problem directly over the phone. If service is required, a factory authorized technician will be sent to your location.

Please fill in the following information for use when calling the Brewer Company or your distributor with questions regarding your unit.

Date of Purchase _____

Serial Number _____

Model Number _____

Authorized Dealer Name _____

Dealer Phone Number _____

Dealer Address _____

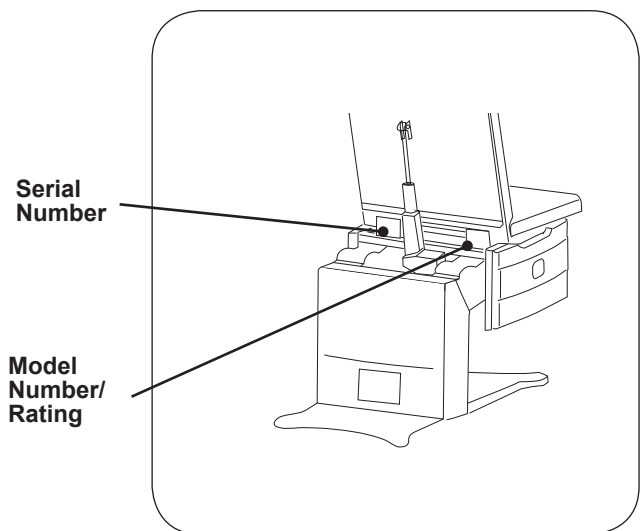

Serial Number and Model Number/Rating Label Location

SAFETY INFORMATION

Safety Information

The primary concern of The Brewer Company is that the equipment is operated and maintained with the safety of the patient and healthcare staff in mind. To ensure safe and reliable operation:

- Read and understand all instructions in this manual before attempting to install or operate the unit.
- Ensure that appropriate personnel are informed on the manual contents. This is the responsibility of the purchaser.
- Ensure that this manual is located near the table, or if possible, permanently affixed to the table.



This is the safety alert symbol. It is used to alert you to potential physical injury hazards. Obey all safety messages that follow this symbol to avoid possible injury or death.



DANGER Indicates a hazardous situation that, if not avoided, will result in death or serious injury.



WARNING indicates a hazardous situation which, if not avoided, could result in death or serious injury.



CAUTION indicates a hazardous situation which, if not avoided, could result in minor or moderate injury.

COMPONENT IDENTIFICATION

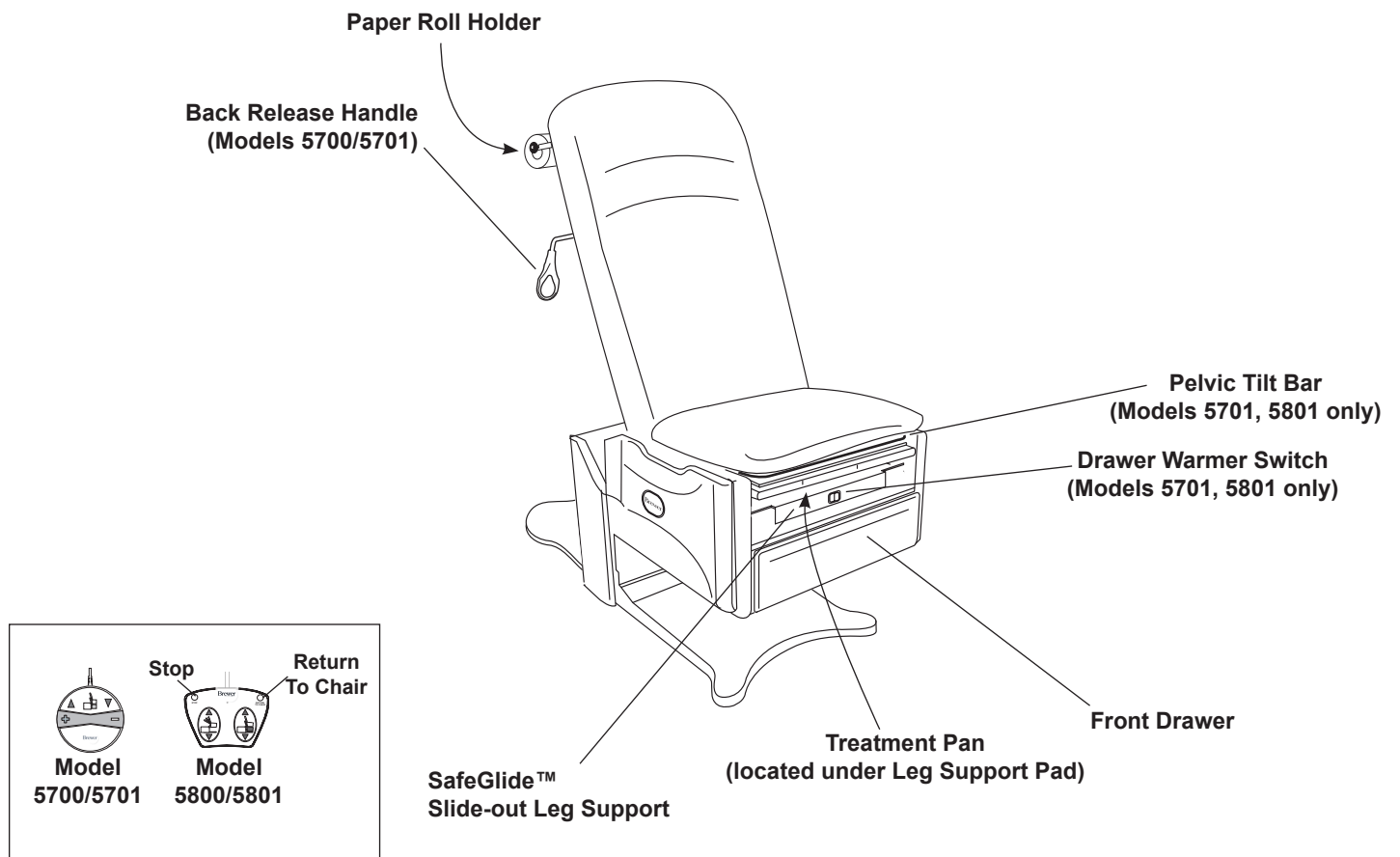

Figure 1. Component Overview

SPECIFICATIONS

Weight of Table 315 lbs

Load Rating (maximum)

- Seat/Back 5700/5701/5800/5801 700 lbs.
- Leg Support 50 lbs.
- Pass Through Work Surface (optional) 15 lbs.
- Grab Bars (optional) 100 lbs.

Range of Motion

- Back Section Range 0° (horizontal) to 75-85°
- Table Top Height Range 18 ± 0.5 in. to 37 ± 1.0 in.
- Pelvic Tilt Range
(Models 5701 & 5801 Only) 0° (horizontal) to 5° (up)

Upholstery Dimensions

- Upholstered Top 24 to 28 in. wide x 60 in. long
- Upholstered Leg Support 18 in. long x 18 in. wide
- Overall Length of Upholstery 60 in. long
- Upholstery with Leg Support Extended 78 in. long

Electrical Rating

- 5700/5800 115 VAC nominal, 60 HZ, 6.0 amps
- 5701/5801 W/Outlet 115 VAC nominal, 60 HZ, 6.0 amps
- Fuse Rating:
- Control Box Fuse Rating 250V/2.5A
- Option/Warmer & Outlet Fuse Rating 250V/3.0A
- Outlet Max Load 2.0A

Duty Cycle (10%)

..... 2 minutes on / 18 minutes off (motor run time)

Power Cord

- Length Extends 70 in. from Table
- Type Detachable
- Conductors 18 AWG / 3 Conductor
- Grade Hospital Grade Plug

Type of protection against electrical shock

- Model 5700 and 5800 Class 2 Double Insulated
- Models 5701 and 5801 Class 1 Grounded
- Patient applied parts (all models) Type B

Type of protection against ingress of water Ordinary

Paper Roll Sizes

- Regular 18 in. x 3.5 in.
- Long 21 in. x 3.5 in.

Certifications* UL60601-1; CAN-CSA C22.2 No. 601.1

Operating Conditions

- Temperature Range 65° to 85°F
- Relative Humidity 10% to 90%

Transportation and Storage

- Temperature -20°F to 150°F
- Humidity 10% to 90%



*Classified in the United States and Canada per the standards listed above.

WARNING	
 	<p style="text-align: center;">Explosion/Fire Hazard</p> <p>Do not use this table in an explosive or oxygen rich atmosphere. Failure to do so may result in serious personal injury or death.</p>

WARNING	
	<p style="text-align: center;">Shock Hazard</p> <p>When performing cauterization or similar treatment, the patient must be insulated from the metal portions of the table by non-conductive material. Failure to do so may result in electrical shock.</p>

NOTICE
<p style="text-align: center;">Certifications</p> <p>This product has been evaluated with respect to electrical shock, fire, and mechanical hazards only in accordance with UL60601-1; CAN/CSA C22.2 No. 601.1</p>

NOTICE
<p style="text-align: center;">Electromagnetic Interference (EMI)</p> <p>This product is designed and built to minimize electromagnetic interference with other devices. However, if interference is noticed between another device and this product, remove the interfering device from the room or plug this product into an isolated circuit.</p>

INSTALLATION

NOTICE

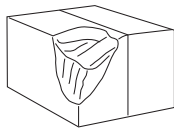

Inspect Carton and Contents

Inspect all boxes and contents for damage. Report any damage to the carrier immediately.

NOTICE



No Sharp Tools

To avoid damaging the table's upholstery or painted surfaces, DO NOT use a knife or other sharp object to open the packaging.

Overview

Perform the following sequence in order when setting up the table:

- Uncrating the table
- Leveling the table
- Adjusting Rear Base Extension
- Installing Power Cord
- Installing Foot Control
- Installing Grab Bars (Optional)

Tools Required

Drill Driver, 7/16" socket bit, or 7/16" wrench, 9/16" wrench, #2 Phillips bit, side cutter and furniture dolly.

NOTICE

Optimum Table Performance

For optimum table performance, allow the table to reach room temperature before operating.

Uncrating

1. Remove stretch wrap surrounding table.
2. Remove the 4 steel shipping brackets securing the table to the pallet (Figure 2). The brackets hook onto the table levelers to hold the table securely to the pallet. Remove the 2 bolts from each bracket using a 7/16" socket or wrench. Take care not to scratch the unit when using the driver or turning the wrench. Remove brackets from levelers once bolts are removed.
3. Remove the 2 screws attaching the spacers on either side of the wooden U-shaped brace located under the front corners of the cabinet (Figure 3). Remove the 2 screws attaching the U-shaped brace to the pallet (Figure 3).

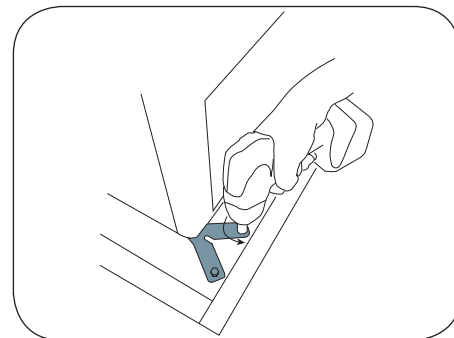

Figure 2. Remove Shipping Brackets

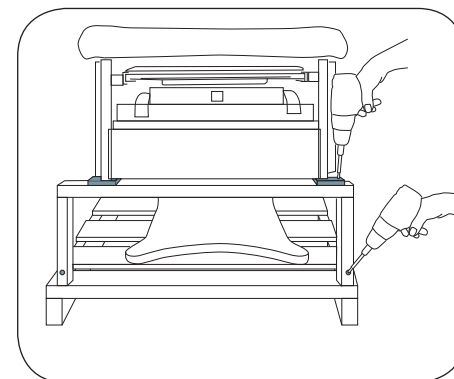

Figure 3. Remove Spacer and U-Brace Screws

NOTICE

Grab Bar Option

If your table was purchased with the Grab Bar option, remove the box from the back of the pallet.

INSTALLATION (continued)

- Cut the shipping strap, and discard strap and foam tube (Figure 4).
- Make sure all shipping materials (except for wooden brace and spacers) and packing foam are removed from the table, pallet and surrounding area.

Note: In order to remove the table from the pallet, you must first power it up and elevate the seat from it's shipping position.

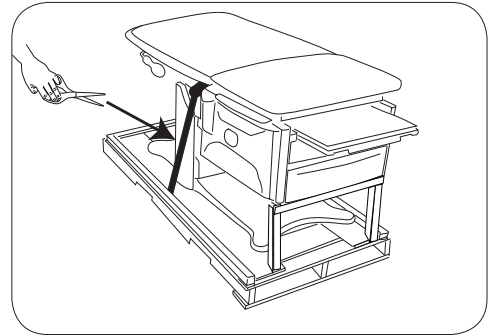

Figure 4. Cut Shipping Strap

NOTICE	
	<p>Avoid Self Activation Damage</p> <p>Plugging table into receptacle prior to the removal of all packaging materials, may cause damage if self activation occurs.</p>

- Remove the foot control and power cord from the front drawer after packing materials have been removed.
- Insert the foot control cord into the receptacle at the bottom of the rear panel (Figure 5). Make sure the tab on the plug is aligned with the slot in the receptacle.

Note: The plug may appear to be fully inserted and yet have some distance to go. Wiggle the foot control plug while pushing it in firmly to ensure that it is fully seated (Figure 6).

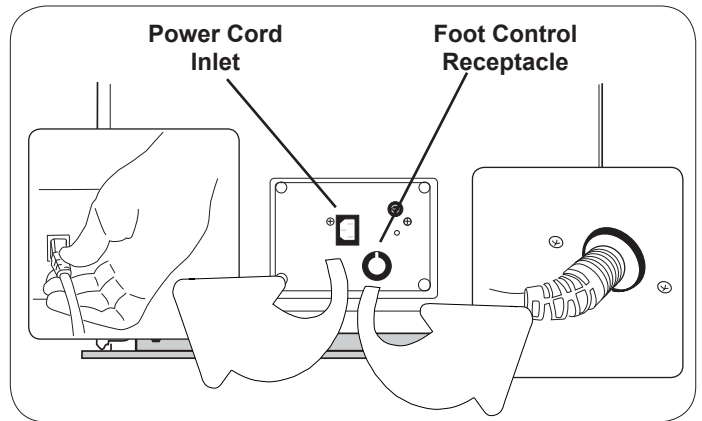

Figure 5. Power Cord and Foot Control Plug-ins

- Remove the gray power cord from the front drawer.

NOTICE
<p style="text-align: center;">Confirm Voltage and Plug Type</p> <p>See Specifications Page for electrical rating of this unit. The three-pronged grounding plug on the table power cord must be plugged into a matching three-pronged, grounded, non-isolated, correctly polarized 115 VAC receptacle.</p>

- Plug the power cord into the receptacle at the bottom of the rear panel (Figure 5). Plug the power cord into a 115 Volt grounded receptacle.

WARNING
<p style="text-align: center;">Area Not Clear Hazard</p> <p>Before initiating movement keep personnel and equipment clear of table to avoid personal injury or damage to the equipment.</p>

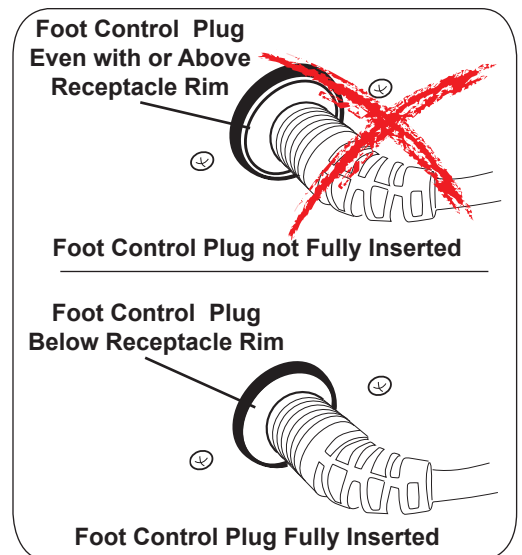

Figure 6. Foot Control Properly Pugged In

INSTALLATION (continued)

10. Press lift up on the foot control to raise the seat approximately 1" (Figure 7). Remove the wooden U-brace and shipping spacers at the front of the table.

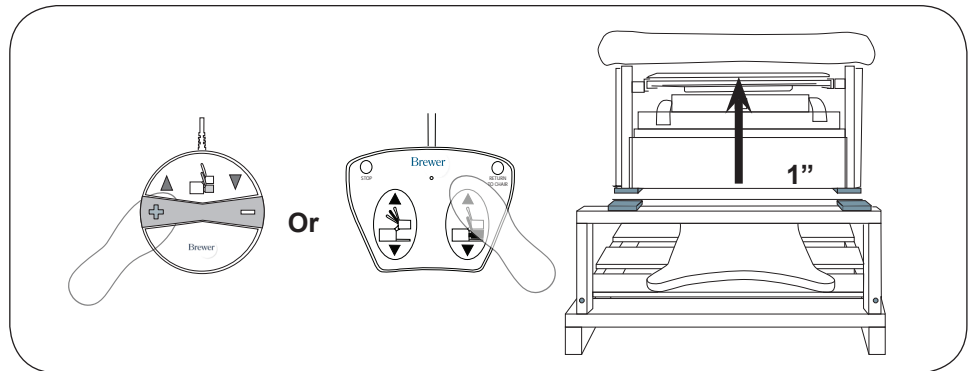

Figure 7. Raise Seat off of Brace

11. Raise the backrest to its full up position (Figure 8).

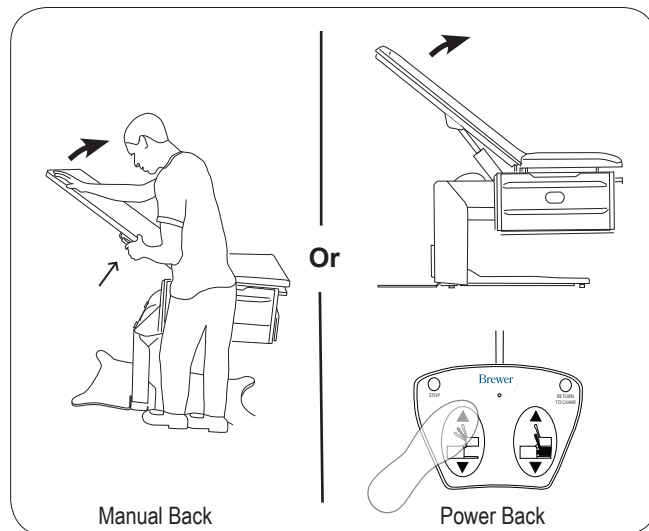

Figure 8. Raise Backrest

12. Unplug foot control and power cord and place into front storage drawer (Figure 9.).

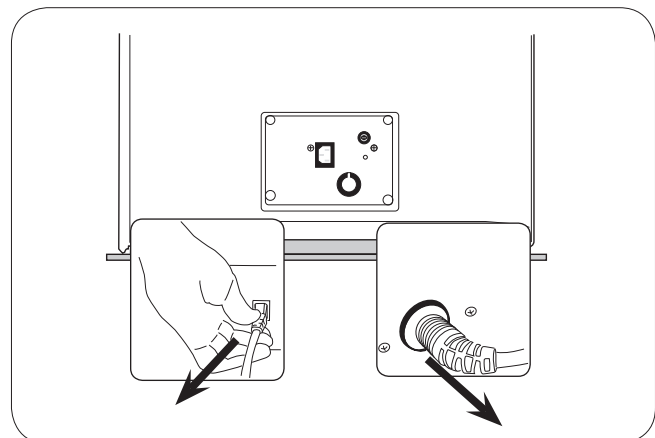

Figure 9. Unplug Foot Control and Power Cords

INSTALLATION (continued)

NOTICE

Avoid Pelvic Tilt and Upholstery Damage

Do not lift or move table by pulling up on the seat upholstery (Figure 10). Lifting by the seat will damage the pelvic tilt mechanism (if equipped) and may damage the upholstery.



Figure 10. DO NOT Lift by Upholstery

NOTICE

Avoid Backrest Actuator and Upholstery Damage

Never push forward on the backrest to move table. Pushing on the backrest will cause backrest actuator damage and may cause upholstery damage (Figure 11).



Figure 11. DO NOT Push on Backrest

NOTICE

Avoid Stirrup Damage

Do not lift or move table by using the stirrups as a hand hold. Lifting or moving table by stirrups can damage the internal indexer housing (Figure 12).

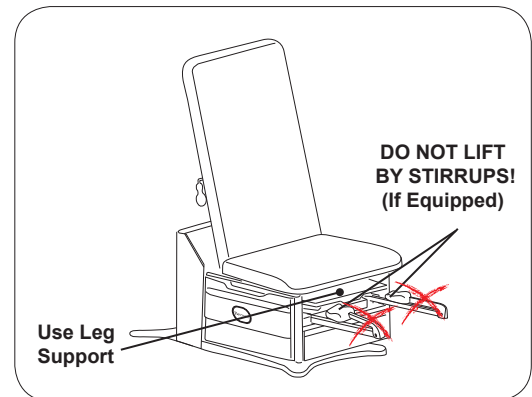

Figure 12. DO NOT lift by Stirrups

INSTALLATION (continued)

13. Tilt table slightly to place the (4) slides under levelers (Figure 13).

NOTICE

Table weighs approximately 315 lbs.

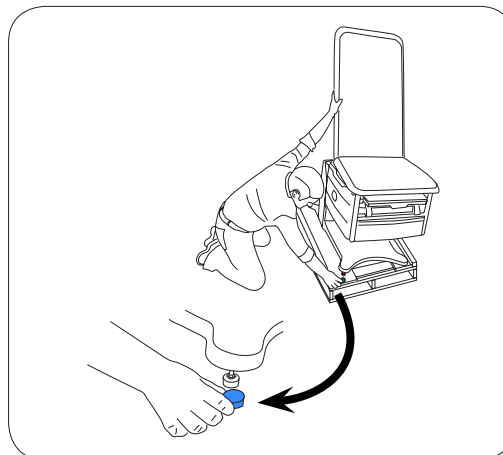

Figure 13. Installing Leveler Slides

14. Use leg support to slide table partially off of pallet. Stop when there is sufficient room to place a furniture dolly beneath base of table. Finish pulling table onto furniture dolly (Figure 14).

Remove the (4) slides under the levelers (Figure 13).

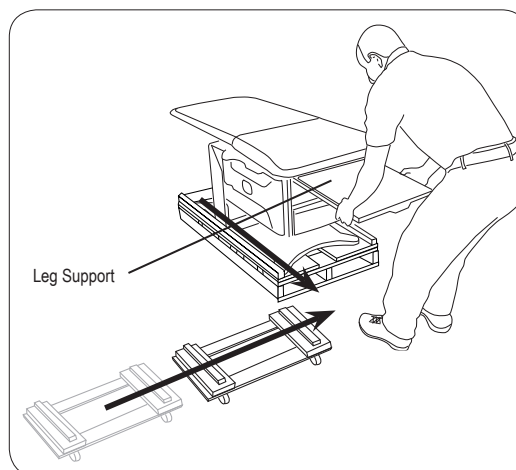

Figure 14. Slide table off of pallet

15. Move table to its final location. Lift off of furniture dolly and set down into position. Do not push or pull sideways on Leg Support when positioning table.



Do not move by fully extended leg support

INSTALLATION (continued)

Leveling the Table

A leveling screw pad (Figure 15) is located in four places under the table's base. Adjust the four leveling pads to achieve a solid, level installation.

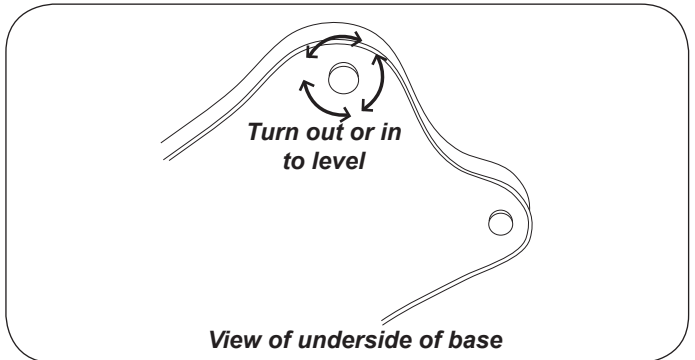

Figure 15. Leveling Screw Pad (located under table)

NOTICE

Prevent Leveler Damage

Levelers must remain in the table and be fully engaged a minimum of (3) turns. If levelers are not fully engaged in the base, damage to the threading in the base and/or leveler can occur.

NOTICE

Prevent Floor Damage and Unwanted Table Movement

Make sure the rubber caps are present on all (4) levelers. Missing caps can allow the table to slide, and the exposed metal portion of the leveler can damage flooring.

Adjusting the Rear Base Extension

After leveling the table, the Rear Base Extension should be brought into contact with the floor (Figure 16).

1. Loosen the two Rear Base Extension adjusting screws.
2. Lower plate until it contacts the floor.
3. Tighten the two Rear Base Extension adjusting screws.

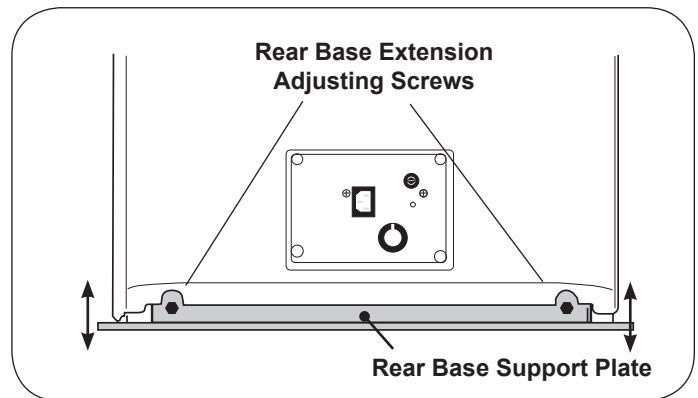

Figure 16. Adjusting the Rear Base Extension

Installing the Power Cord

1. Remove the power cord from the front drawer.
2. Insert the female plug end of the power cord into the receptacle on the table. Make sure the plug is fully seated.

NOTICE

Confirm Voltage and Plug Type

See Specifications Page for electrical rating of this unit. The three-pronged grounding plug on the table power cord must be plugged into a matching three-pronged, grounded, non-isolated, correctly polarized 115 VAC receptacle.

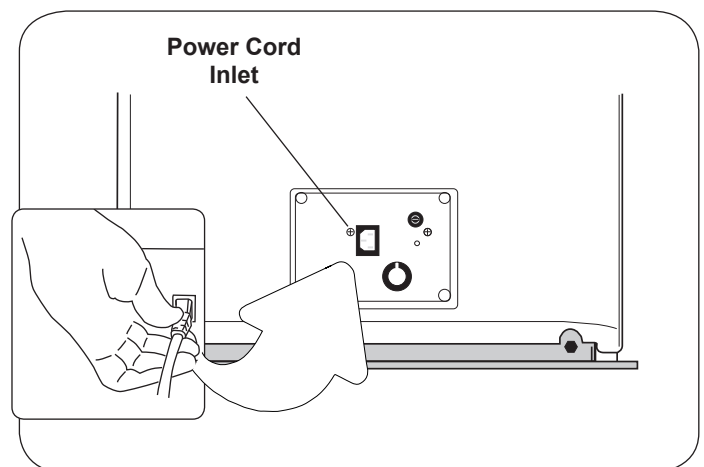

INSTALLATION (continued)

Installing the Foot Control

1. Remove the foot control from the front drawer.
2. Insert the male plug of the foot control cord into the receptacle on the table (Figure 17). Make sure the plug is fully seated. See Figure 6 for proper insertion of the foot control plug. Failure to properly insert the foot control plug can cause some functions to not operate properly

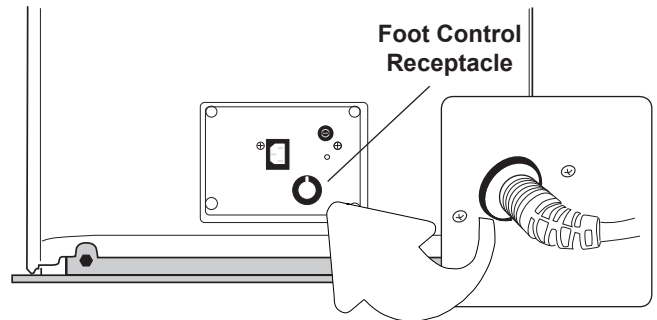

Figure 17. Foot Control and Power Cord Receptacles

NOTICE
Avoid Foot Control Damage
The foot control is moisture resistant and runs on low voltage. However, to avoid temporary or permanent damage to the foot control, do not immerse in water or liquids.

Installing Grab Bars (Optional)

1. Remove grab bars from the carton banded to the pallet.
2. Grab bars are interchangeable and may be installed on either side.
3. Align pin on grab bar shaft with mating slot on side of table. See Figure 18.
4. Push grab bar all the way down and rotate to front of table.
5. Push grab bar down until it engages to prevent left or right movement.

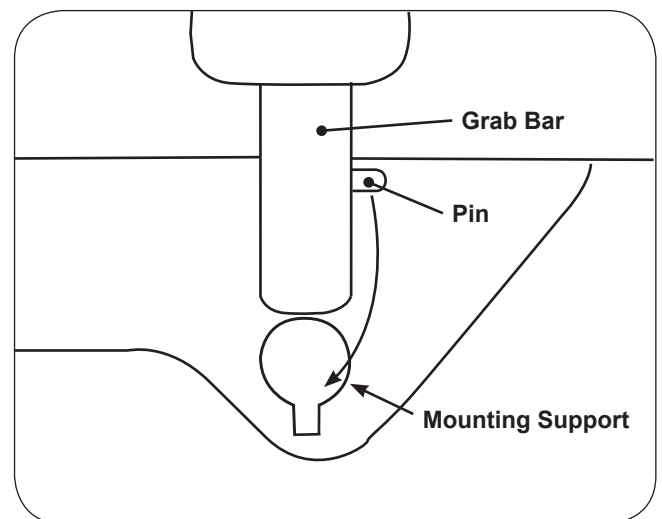

Figure 18. Grab Bar

WARNING	
	<p style="text-align: center;">Shock Hazard</p> <p>After installing or moving table, make sure there are no damaged or exposed wires that could result in electrical shock.</p>

OPERATION

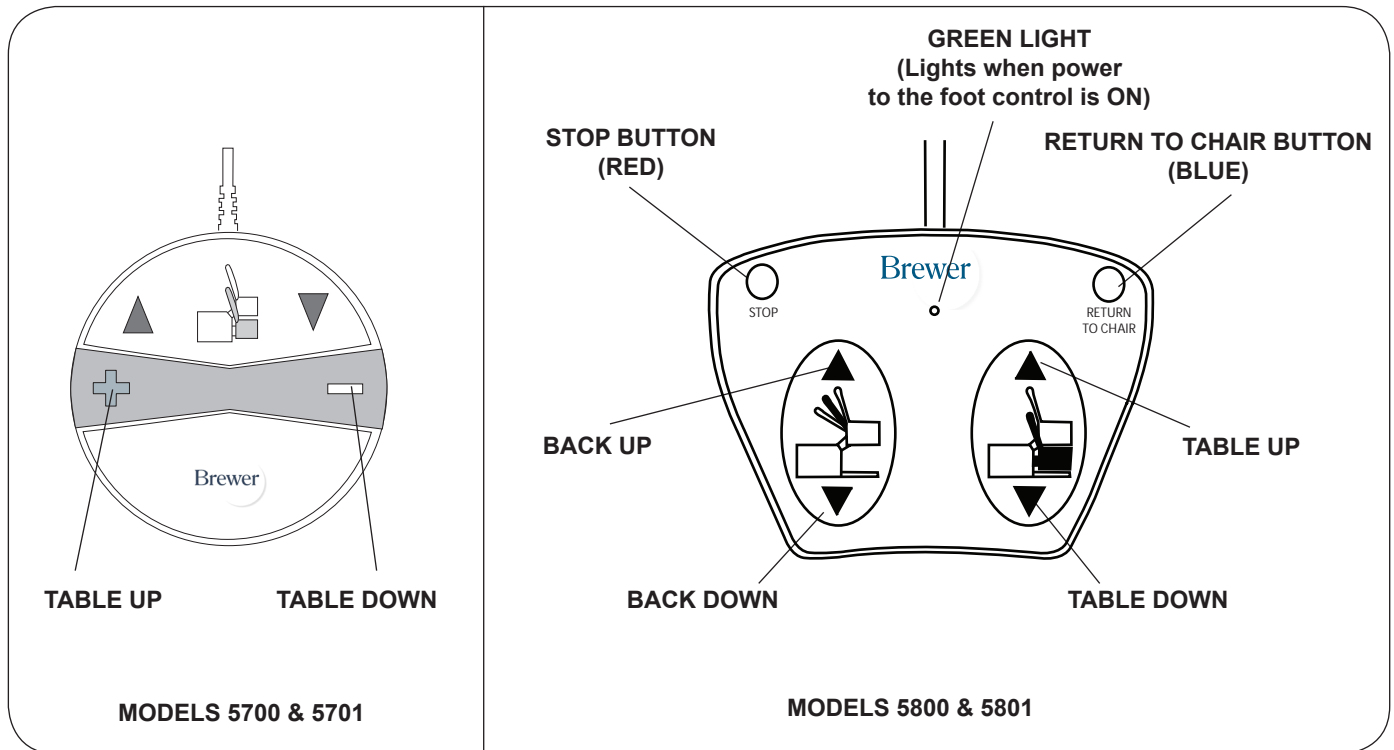

Figure 19. Foot Controls

Models 5700 & 5701

Models 5700 and 5701 are equipped with a single pedal foot control that controls the raising and lowering of the seat.

Models 5800 & 5801

Models 5800 and 5801 are equipped with a dual pedal foot control that controls the raising and lowering of the seat, and the raising and lowering of the seat back. In addition, the foot control features the following:

Return to Chair: When pressed, the table automatically returns to the low chair position. The seat back will rise to the full up position and the table will lower to the full down position and stop. To stop the automatic movement, press the Red Stop Button, or depress any pedal on the foot control.

Stop: When pressed, stops the Return to Chair function.

Green Light: (2 pedal foot controls only) indicates that there is power to the foot control.

NOTICE

Unintended Operation

To avoid unintended operation, keep foreign objects away from foot control. Be sure foot control is not positioned below the front of the table.

NOTICE

Unattended Return to Chair Operation

Remain with and observe patient during Return to Chair operation. Return to Chair feature may need to be momentarily interrupted for patient to readjust him or herself, or for obstacles to be removed before resuming motion. Press the Return to Chair button to resume motion only when patient has situated him or herself, or obstacles have been removed.

OPERATION (continued)

Seat and Backrest Safety Switches

Seat Switch

All models are equipped with switches on the seat bottom (Figure 20) which automatically stop the lowering function of the seat if the seat bottom plate comes into contact with an object as the seat is lowering. To continue lowering the seat, press the "TABLE UP" pedal (Figure 19), clear the obstruction, and continue lowering the seat.

Backrest Switch

All models are equipped with a switch on the top shroud (Figure 20) which automatically stops the lowering function of the seat and back if the switch is contacted by the backrest. To continue lowering the seat:

- **Models 5700 & 5701** Raise the backrest manually to clear the switch. When clear of the switch continue lowering the seat.
- **Models 5800 & 5801** - Depress the "BACK UP" pedal (Figure 19) to clear the switch. When clear of the switch continue lowering the seat.

SafeGlide™ Leg Support

The leg support is located under the seat cushion. (Figure 21). It can be extended 18" for the patient prone position. Pull leg support out to the fully extended position. To return the leg support to its stored position simply push the leg extension in.

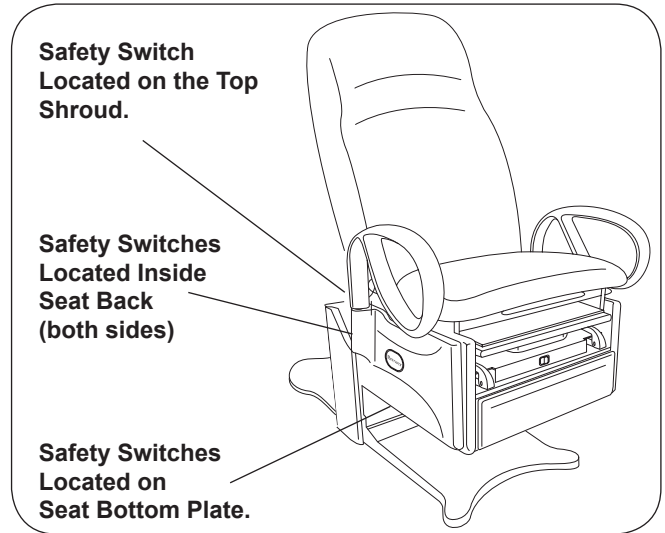

Figure 20. Seat and Backrest Safety Switches

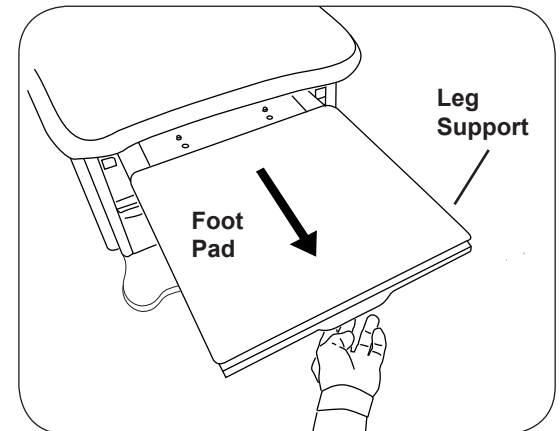

Figure 21. Leg Support Pull Out

WARNING	
	<p style="text-align: center;">Fall Hazard</p> <p>The leg support is rated for 50 lbs and is not intended for use as a seat. Sitting on leg support could cause it to retract, bend, or cause the table to tip forward, creating a fall hazard leading to serious injury.</p>

NOTICE	
Tension Adjustment	
The following is only for tables equipped with Tension Adjustment.	

The SafeGlide™ Leg Support comes with the leg support adjusted for the least amount of resistance. If you find it to glide too freely, the resistance can be increased by turning the thumbscrews (Figure 22) inward. Turn both thumbscrews the same number of turns inward or outward until the desired resistance is obtained.

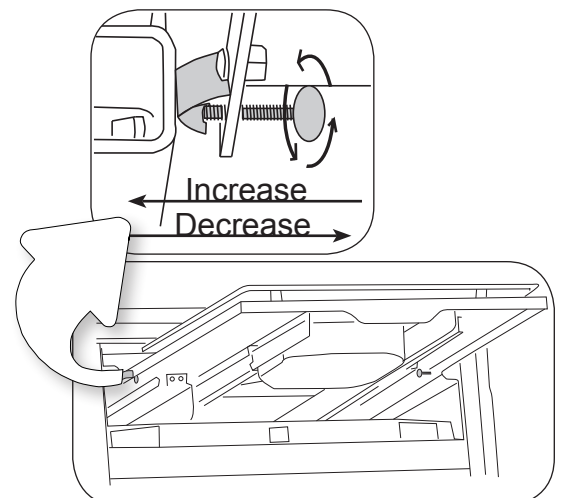

Figure 22. Leg Support Tension Adjustment

OPERATION (continued)

Foot Pad

The foot pad can be slid beneath the seat with the leg support extended for easy access to the treatment pan (Figure 23). Pushing the leg support back in will allow the glides on the foot pad to drop into slots. The foot pad will once again come out with the leg support the next time it is pulled out.

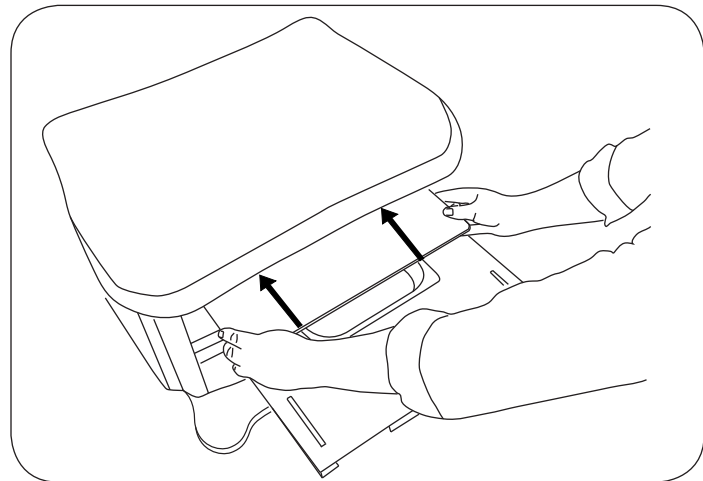

Figure 23. Slide Foot Pad Back

Treatment Pan

A removable treatment pan is built-in underneath the leg support pad for use during examination. Pull the leg support fully out and remove the leg support pad or slide it back under the seat (Figure 23) to access the pan (Figure 24). Remove the treatment pan for cleaning.

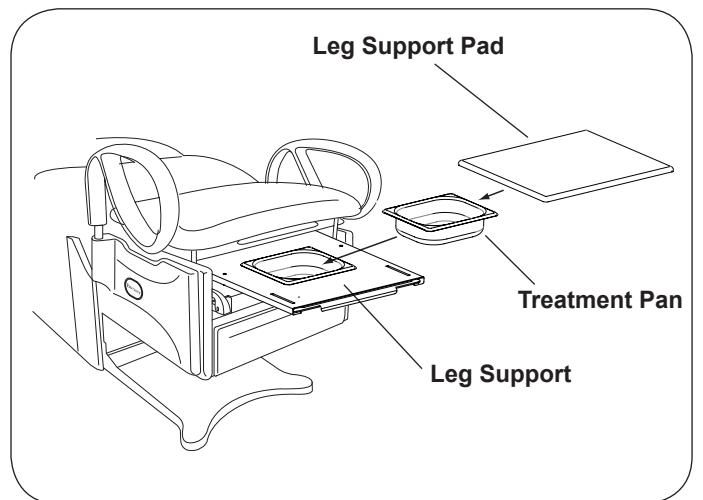

Figure 24. Treatment Pan

Front Drawer

A storage drawer for supplies is located at the front of the table. Models 5701 and 5801 are equipped with a drawer warmer that is turned on by a switch located above the drawer (Figure 25).

NOTE: The warmer element is located above the drawer and applies radiant heat to the drawer contents. Items closer to the element will be warmer than items at the bottom of the drawer. Avoid stacking instruments or allowing instruments to tip and contact the element.

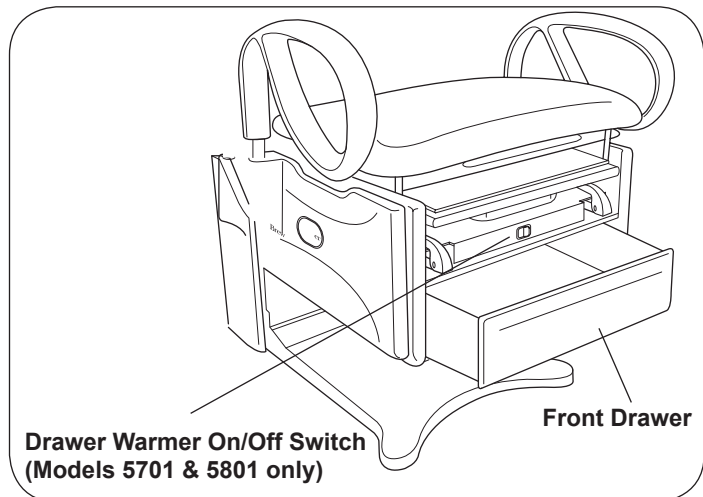

Figure 25. Drawer Warmer Switch and Front Drawer

OPERATION (continued)

Paper Roll Holder

To change a paper roll, remove old paper roll tube, place the paper holder rod into the paper roll tube, and place into paper roll holder "J-Hooks" located on the rear of the seat back (Figure 26). Pull the end of the roll over the top of the seat back and place in the desired position.

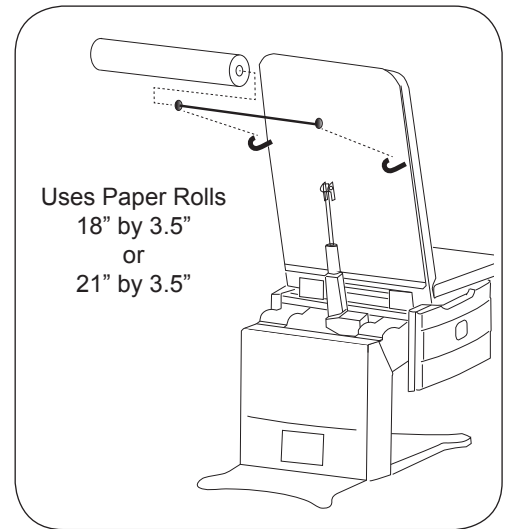



Figure 26. Paper Roll Installation

Pass Through Work Surface (Optional)

A pass through work surface, stored under the seat (Figure 27), may be pulled out from either side of the table. Grasp the edge of the work surface and pull until it is fully extended. Push it fully in to stow after use.

WARNING	
	<p>Fall Hazard</p> <p>The work surface is rated for 15 lbs. and is not intended for use as a seat. Sitting on work surface could cause it to bend or break or cause the table to tip creating a fall hazard leading to injury.</p>

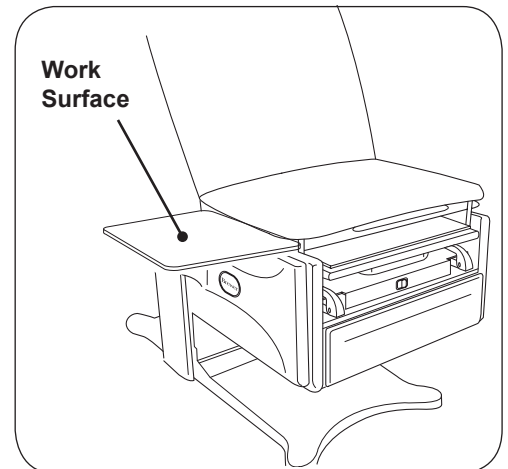

Figure 27. Pass Through Work Surface

Removing the Work Surface for Cleaning

1. Push work surface in, to reveal a white plastic stop screw.
2. Remove the white plastic screw (Figure 28).
3. Pull the work surface toward you and remove it.
4. Reinsert screw after replacing work surface.

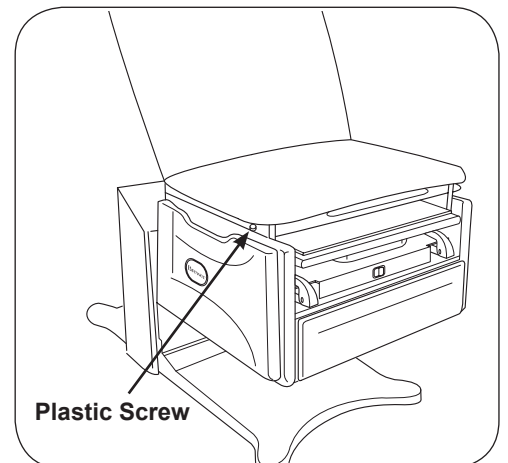

Figure 28. Location of White Plastic Stop Screw

OPERATION (continued)

Adjustable Stirrups (Optional)

Operating the Stirrups (Figure 29)

1. To operate the stirrups, grasp end of stirrup and pull straight out of the table. Lift up slightly while sliding the stirrup out.

NOTE: Applying downward pressure when pulling stirrup from table may make it difficult to move. Resistance is normal and is part of the stirrup friction locking mechanism.

2. Unfold stirrup upward to the fully open position.
3. Adjust the stirrup to the desired length by sliding it in or out.

Stirrup Lateral Adjustment

1. Lift end of stirrup slightly and then rotate outward to desired position.
2. When the desired position is achieved, lower the stirrup to engage the lateral locking mechanism (Figures 29 and 30).
3. Check that lateral locking mechanism is engaged by attempting to move stirrup assembly side-to-side without lifting on the stirrup end.

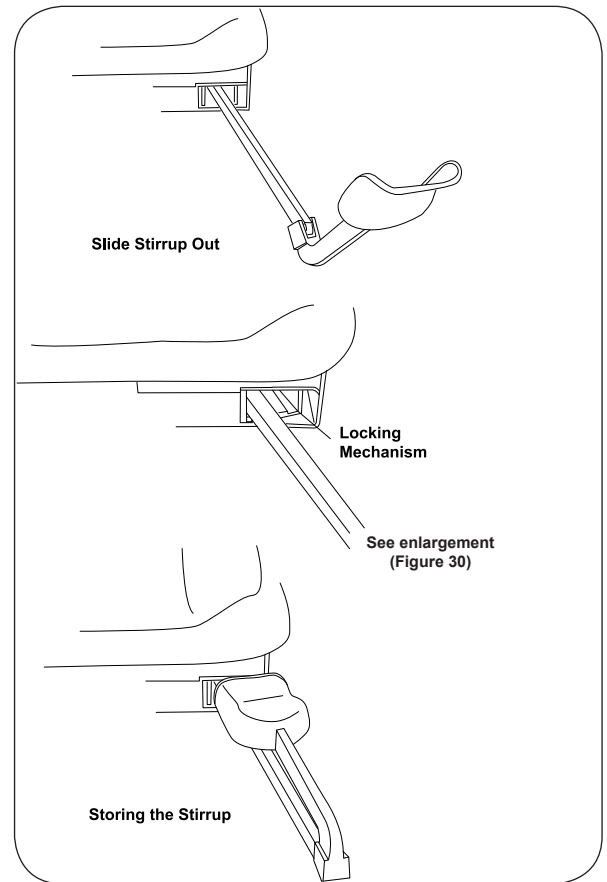

Figure 29. Stirrups

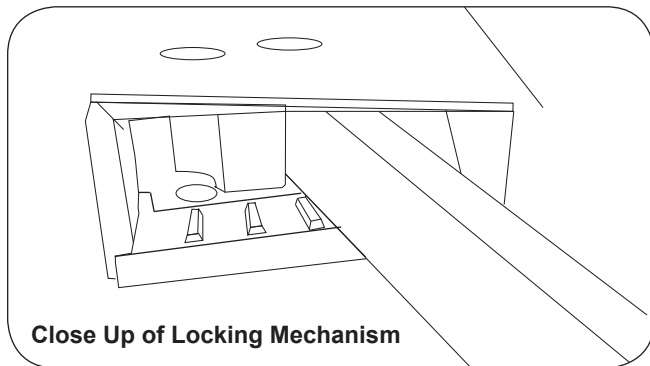

Figure 30. Stirrup Locking Mechanism

Storing the Stirrups

1. To store the stirrups in the table, grasp end of stirrup and pull straight out to its full extension.
2. Fold stirrup down against bar, then rotate it to the inner most lateral position and slide it back into the stowed position.

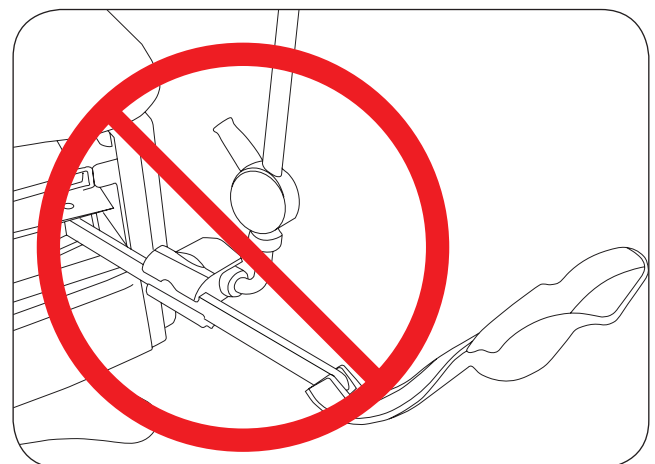

Figure 31. Affix No Attachments!

NOTICE

Use Stirrup Only as Designed

Do not use any part of the stirrup for attachment of any device (Figure 31). Warranty will be voided. If knee crutches are required for use, order mounting adapters and clamps shown in the Accessories Section.

OPERATION (continued)**Grab Bars (Optional)**

In the forward (normal use) position, the grab bars lock into place preventing left or right rotation.

The grab bars can be rotated to the side or toward the back of the table for improved access to and stability of the patient. Pull up on the grab bar and rotate to the desired position. The grab bar locks in the front, side and rear positions (Figure 32).

The grab bar can be removed from the table by pulling up on the grab bar, rotating it to the 90° position and then lifting it out of its holder.

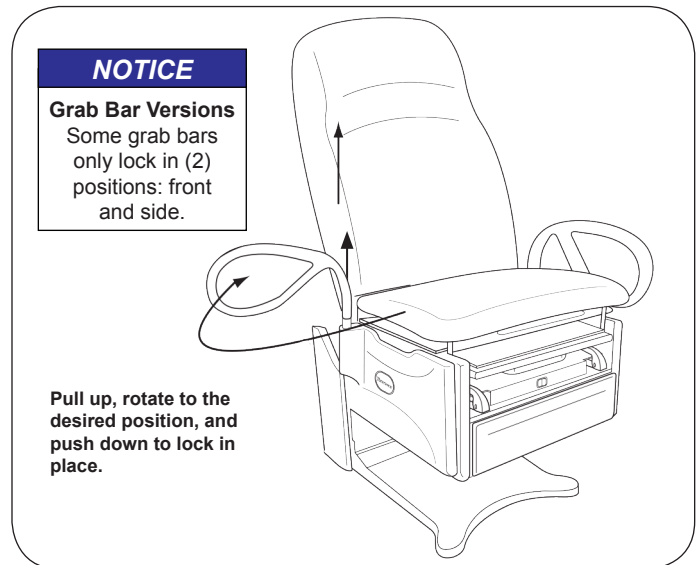

Figure 32. Grab Bar Adjustment

TABLE ADJUSTMENTS

WARNING

Area Not Clear Hazard

Before initiating movement keep personnel and equipment clear of table to avoid personal injury or damage to the equipment.

Table Height

The table can be adjusted to any height between 18" to 37" (Figure 33).

1. To raise the table, depress and hold the Table Up pedal until the desired height is achieved, then release the pedal.
2. To lower the table, raise the backrest to the upright position, then depress and hold the Table Down pedal until the desired height is achieved, then release the pedal.

3. Press the blue button to engage the Return to Chair feature (Figure 34).

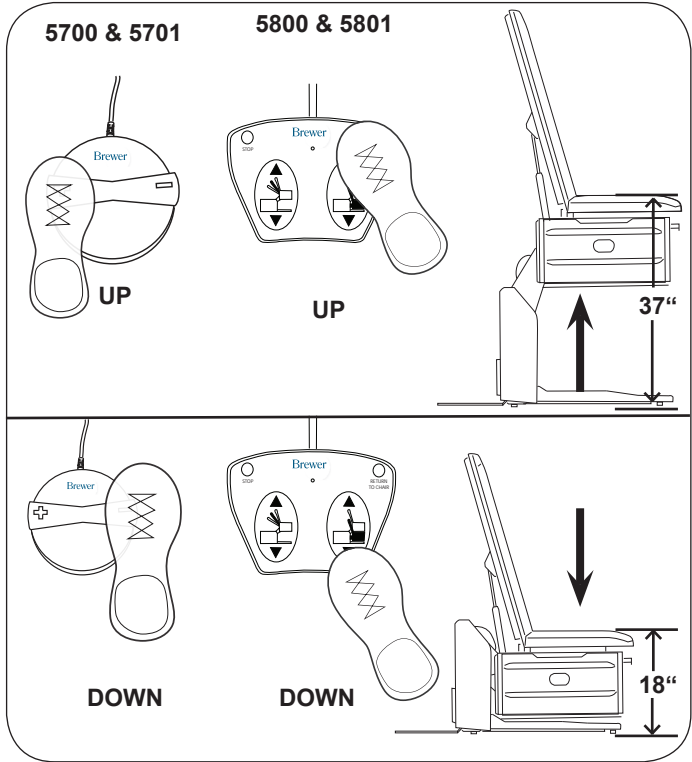

Figure 33. Table Height Positioning

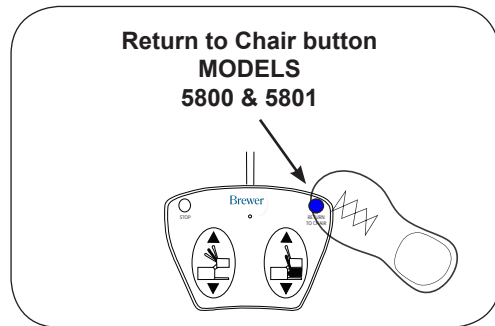

Figure 34. Lowering with Return to Chair

NOTICE

Actuator Travel Limit Protection

Each control function will automatically stop moving when either the UP or DOWN travel limit is reached. If the foot pedal is pressed with travel at its limit, the actuator will not operate. Sensors prevent the actuator motor from operating when travel limit has been reached, preventing wear of the actuator.

NOTICE

Fuse Protected

The control system is protected by a fuse to prevent excessive current draw which could damage the system. If operation does not resume after a cooling period of one hour, contact Brewer 888-Brewer-1 (888-273-9371).

TABLE ADJUSTMENTS (continued)

Seat Back

The back can be adjusted to any angle between horizontal and 80°.

NOTICE

To Lower Backrest Fully

Table must be raised to a height of 28" before the backrest can be lowered to the horizontal position. (See Figure 35).

Pneumatic Manual Backrest (Models 5700 & 5701)

1. To lower the seat back, push down on the seat back while pulling the release handle upward.

CAUTION

Backrest Lowering Hazard

Depressing the manual backrest release handle while a patient is seated on the table can cause the backrest to lower rapidly. Lower the backrest in increments by depressing and releasing the handle. Allowing the backrest to lower in a single motion could cause injury to the patient.



2. To raise the seat back, place hand on the backrest to prevent it from rising rapidly, and then pull the release handle upward. The seat back will lock in the desired position when the handle is released.

NOTE: The pneumatic backrest cylinder does not exert enough force to raise the backrest with a patient lying on the table.

Powered Backrest (Models 5800 & 5801)

1. To lower the seat back, depress and hold the Back Down pedal until the desired angle is achieved, then release the pedal.
2. To raise the seat back, depress and hold the Back Up pedal until the desired angle is achieved, then release the pedal.

NOTICE

Power Back Actuator-Push Only

On power back models, the back is positioned by a "push only" actuator that raises the back. When lowered, the actuator retracts and gravity causes the back to lower.

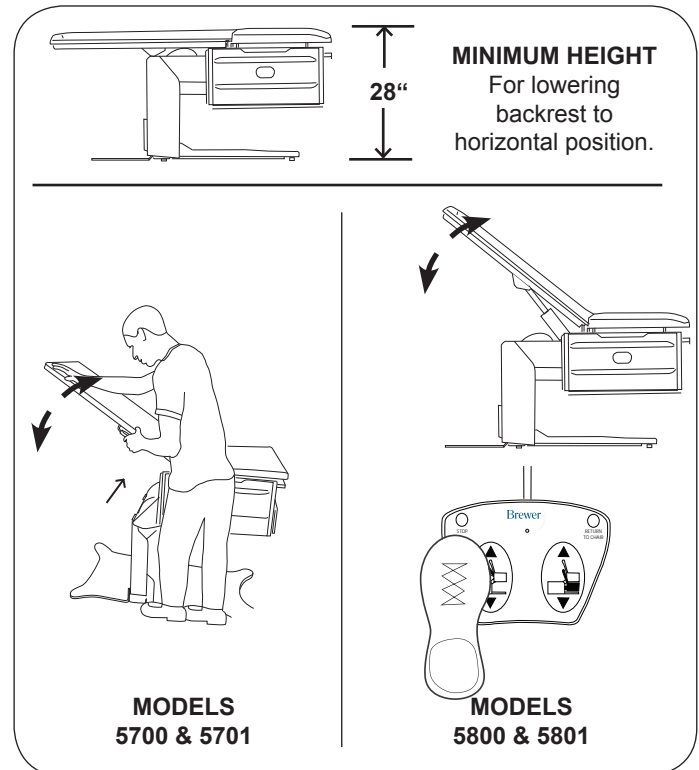

Figure 35. Adjusting Seat Back

NOTICE

Avoid Continuous Operation

The table's control system includes a thermal overload safety switch to protect from overheating. If the table is operated continuously causing the control to exceed its allowable operating temperature, the thermal overload safety switch will shut off. If normal operation ceases, do not attempt to operate the table. Allow the table to cool for 10-15 minutes before attempting to use again. The thermal overload switch will automatically reset when it has reached a safe operating temperature.

TABLE ADJUSTMENTS (continued)

**Manual Pelvic Tilt
 (Models 5701 and 5801)**

The manual pelvic tilt feature sets the seat angle at 0° (horizontal) or 5° (up) position.

Pull up on the front of the seat and the pelvic tilt automatically travels to the locked tilt position (Figure 36).

NOTICE

Engaging the Pelvic Tilt Mechanism

Pulling up with excessive force can damage the pelvic tilt mechanism. Lift only with enough force to engage mechanism.

To lower seat, lift the adjustment lever and lower the seat to the horizontal position.

NOTICE

Lowering the Pelvic Tilt Mechanism

Patient must be removed from table prior to lowering the pelvic tilt mechanism.

**Front Drawer Warmer
 (Models 5701 and 5801)**

Models 5701 and 5801 are equipped with a drawer warmer that is turned on by a switch located above the drawer (Figure 37).

NOTICE

Proper Loading of the Front Drawer

Do not stack instruments in the front drawer. Place instruments in one layer in the bottom of the drawer.

**Outlet
 (Models 5701 and 5801)**

Models 5701 and 5801 are equipped with an Outlet (Figure 38). The maximum total load that can be plugged into the outlet is 2 amps.

NOTICE

Maximum Outlet Rating

Plugging a device into the outlet on the side of the table with rating higher than 2 amps may cause the fuse at the back of the table to blow.

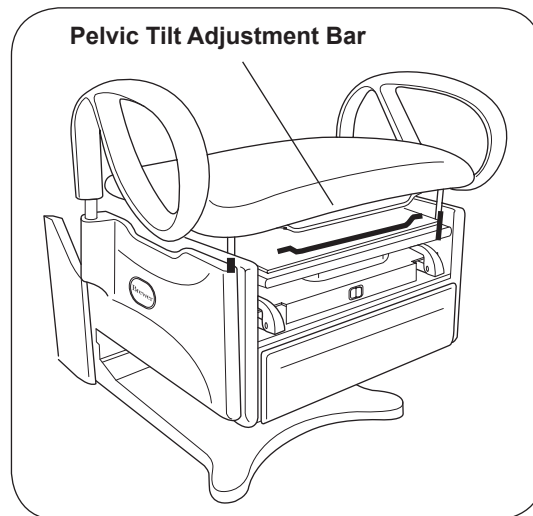

Figure 36. Pelvic Tilt Adjustment

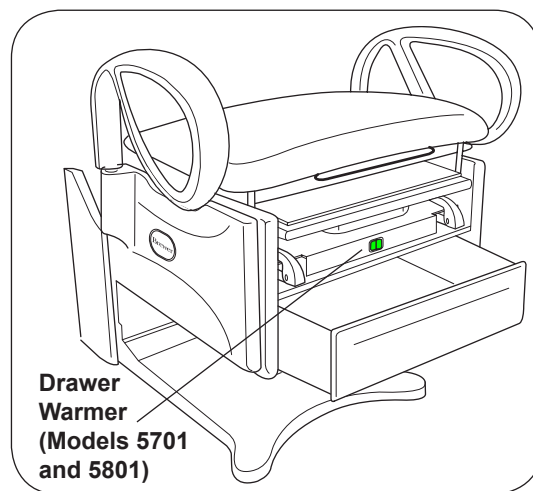

Figure 37. Front Drawer Warmer Switch

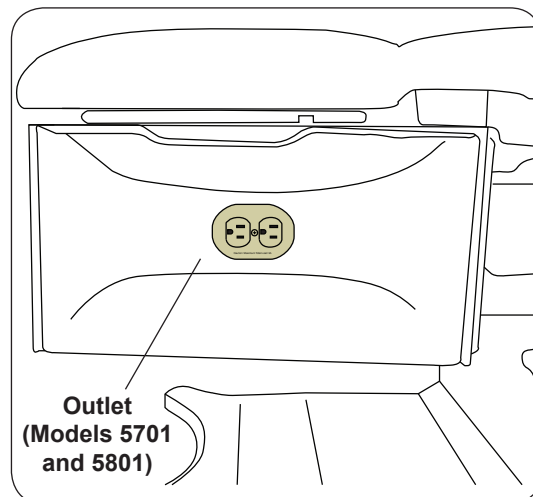

Figure 38. Table Outlet

MAINTENANCE

Preventative Maintenance

NOTICE

Loose Fasteners and Damaged Components

Failure to perform periodic inspections of the table could result in equipment damage.

- Inspect table every 6 months.
- Periodically inspect the electrical and foot control cords to ensure they are free of cuts or damage.
- Inspect the mechanical functions to ensure satisfactory operation.
- Check fasteners to make sure they are present and tightened securely.
- Lubricate the backrest hinge with a food grade silicon lubricant (Figure 39). Cover surrounding area with cloth to protect from overspray and wipe excess.

NOTICE

Table Malfunction

If table malfunctions, immediately remove your foot from the controls, unplug the power cord from the receptacle, and assist the patient from the table. Service the table prior to use.

Table Care

NOTICE

Wipe Spills Immediately!

The upholstery material is resistant to most medicinal type stains, but may be damaged by solvents and dyes. Remove any spilled fluids from the upholstery immediately.

For the latest in Cleaning Guidelines visit:
www.brewercompany.com

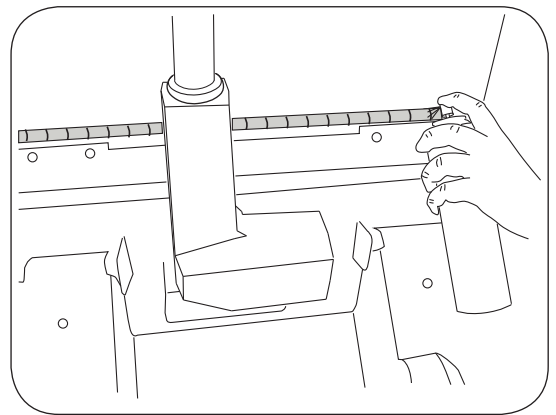

Figure 39. Lubricating the Backrest Hinge

SERVICE

**Fuse Replacement
Drawer Warmer and Outlet
(Models 5701 and 5801)**

1. Unplug table from wall receptacle.
2. Fuse is located at the back of the table near the power cord.
3. Push the fuse holder cap in with a flat screwdriver and rotate 1/4 turn counterclockwise to remove cap and fuse (Figure 40).
4. Replace fuse with Brewer 2102490, 3A 250V fuse.
5. Push new fuse into cap.
6. Push cap with fuse into holder and rotate 1/4 turn clockwise to install.
7. Plug table into wall receptacle.
8. Check drawer warmer and outlet for proper function.

WARNING



Shock Hazard

Disconnect power by removing plug from wall receptacle before servicing table.

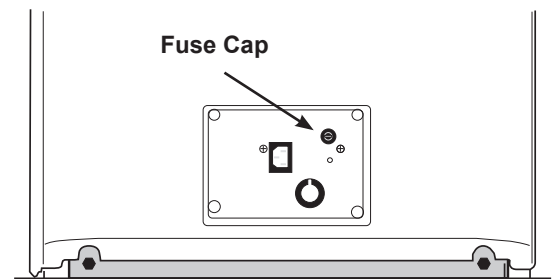

Figure 40.

WARRANTY

For Brewer Warranty Information:

Visit www.brewercompany.com or contact the Brewer Customer Service Department at (1-888-Brewer1).

ACCESSORIES

Listed below are the accessories which are authorized for use with this table.

Description	Order No.	Use/Restrictions
Urology Tray w/Hose & Bucket	100253	Conveniently and safely captures fluids during urology procedures.
Front Drawer Organizer	100407	Optional front drawer dividers for separation and organization.
Stainless Steel Treatment Pan	98464	Stainless Steel Treatment Pan for collecting debris and/or fluids during procedures.
Welch Allyn III Light Bracket (customer installed)	100881	For mounting of Welch Allyn III light.
Welch Allyn IV Light Bracket (customer installed)	102032	For mounting of Welch Allyn IV light.
Grab Bar Kit	2102895	Contains two grab bars, decorative side shrouds and supports.
Stirrup Kit (for tables with no outlet)	2102898	Contains two Stirrups and hardware for adding Stirrups to tables without outlets.
Stirrup Kit (for tables with outlet)	2102897	Contains two Stirrups and hardware for adding Stirrups to tables with outlets.
Work Surface-Pass Through	2102896	Work surface that stows beneath seat upholstery - passes to either side providing a surface for lab work, paper work etc.
Armrest Hole Cap	101872	Covers hole created when user chooses to remove grab bars.

The following items are required for the Articulating Knee Crutch accessory:

Deluxe Articulating Knee Crutches	99504	Allows leg positioning for ease of examination. Contains one LH and one RH Knee Crutch.
Knee Crutch Adapters (field install)	100550	Provides attachment point for Knee Crutch Clamps. Contains two Adapters.
Knee Crutch Clamp	99502	Clamps Knee Crutch to adapter. Contains one clamp.