

Bear

USER MANUAL

Foldable Kettle Jug

ZDH-A06G1

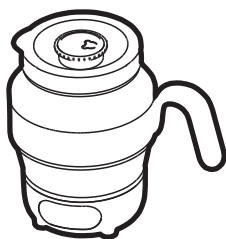
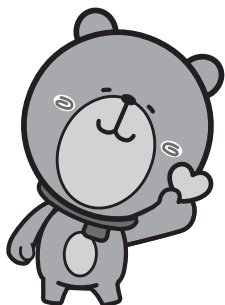

190467-24

Please read and save the instruction to ensure safe and effective use of this appliance.



IMPORTANT SAFETY PRECAUTIONS

In order to prevent accidents or injuries to the user, other people, and damage to property, please follow the instructions below and keep this instruction for future use.

1. This product is intended for household use only.
2. Please read the operating instructions carefully to ensure safe and correct operations.
3. Before use, please check the rated voltage that marked on the product rating label is consistent with the voltage you use.
4. Use power supply with ground protection to prevent any mishap.
5. Press gently on the power button.
6. Do not use the appliance on the carpet, plastic or other none heat-resistant materials.
7. Never place the unit in water or any other liquid, nor rinse it under the tap. Clean the outside of the kettle body and base with a moist cloth.
8. The appliance is for boiling water only. Do not use it for boiling any drink with food materials, soup or reheat drinks.
9. Do not pour water on the base or wash directly with water to avoid electric shock.
10. Do not use the unit under high temperature environment or nearby the stove.
11. Please do not insert / put anything in the unit base to avoid mal-function.
12. Please do not touch or operate the power cord and socket with wet hand to avoid electric shock.
13. Please do not repair, modify or disassemble the unit to avoid accident.

13. Please stop using this product if power cord is broken and take this product to After Sales Center for repair.
14. Never leave the appliance in operation unattended.
15. Do not fill the kettle with water exceeding MAX mark.
16. Please keep this unit out of reach of children and children are not allowed to operate this product.
17. Plug off the product immediately when it runs out of water and wait for it to cool down before handling it.
18. Do not touch hot surface of the product and keep away from hot steam to avoid getting burnt.
19. Hold the glass kettle handle to pour water after work, never touch the glass kettle directly when it is hot.
20. Do not open the lid immediately after boiling, open it several minutes later when hot steam is dissipated.
21. Do not move the appliance when it is full of hot water. Take off the glass body from base before moving the unit.
22. The base is used for this unit only.
23. The glass kettle can be only heated up on this unit base.
24. This unit cannot be operated by an individual timer or remote set.
25. Please unplug the unit, clean it and store in cool and dry places if it will not use for long time.
26. This appliance is not intended for use by persons (including children) with reduced physical, sensory or mental capability, or lack of experience and knowledge, unless they have been given supervision or instruction concerning use of the appliance by a person responsible for their safety.

PART IDENTIFICATION AND SPECIFICATION

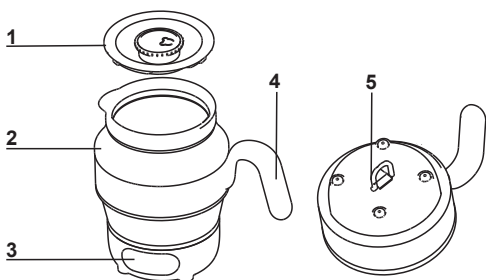

- 1. Lid
- 2. Kettle Body
- 3. Display
- 4. Handle
- 5. Pull-tab

NOTE: Picture for reference only.

SPECIFICATIONS



Model No.	ZDH-A06G1
Voltage	220-240V~
Frequency	50-60Hz
Power	500-600W
Capacity	0.6 L

OPERATING INSTRUCTIONS

Display

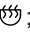

Function Choice

- Boil function, indication mark ;
- Dechlorination function, indication mark ; the appliance will keep boiling for more 3min than boil function at the mode.
- Keep Warm function, indication mark .

Button Operation

- FUNCTION / CANCEL
 - At setting mode: press this button to choose function;
 - At working mode: press this button to stop work and the appliance return to standby mode.
- KEEP WARM / TEMP
 - Press this button to start keep warm mode directly;
 - At setting mode: press this button to adjust temperature of keep-warm. Default temperature is 60℃, adjustable temperature range is 40~90℃; temperature increases 5℃ for each press.
 - At working mode: Press this button for the first time, display shows the setting temperature; adjust the temperature from the second press of this button, the unit will automatically confirm the temperature change when no operation is done after 10s.
 - The appliance can keep warm for 8h, after 8h, it returns back to standby mode automatically.

Usage

CAUTION:

- Hold the lid and pull-tab to stretch the kettle when it is folded.
- Fill the kettle with water to max level and boil for once, pour out the water and clean the kettle inside before use for the first time.

1. Open the lid and pour water into the pot body. Keep the main body dry when adding water. Make sure water inside is below the MAX level mark. Lock the lid after water is added.

Note:

- Please ensure the water level is over the MIN level to avoid dry heating.
- Do not fill water over the MAX level mark to avoid overflow during working.

2. Plug in the unit, all indicator lights light up for 1s and turn off then, and the display shows “---”.

3. Press the FUNCTION / CANCEL button to set function.

4. Press the KEEP WARM / TEMP button to set keep warm temperature, if necessary.

5. The appliance starts working after 10s without any operation.

6. When the boiling work is finished, the unit will beep as “di di...” and shift to keep warm mode automatically.

7. If it is running out of water, the unit will beep three long sound of “di”, and the display shows “E00”. Fill the appliance with cold water to make it cool down and return back to standby mode.

8. If you need keep-warm without boiling the water, press the KEEP WARM / TEMP button directly and adjust the temperature after plug in.

9. Press the FUNCTION / CANCEL button during work can stop working.



CLEANING AND MAINTENANCE

- Before cleaning and maintenance, switch off and disconnect the appliance, wait for it to cool down.
- Do not immerse the unit into liquid.
- Do not use stainless steel brush, nylon brush or any other abrasive tools to clean the parts. Wipe with sponge or soft cloth.
- Wash the kettle inside with household detergent, rinse with water and dry with a piece of soft cloth.
- Wipe the body outside with a dry or slightly damped cloth, dry it thoroughly.
- To avoid deformation or cracking, do not use benzine, thinner or liquid cleaners.
- Chemical cloth may cause the change in color of the unit.
- Clean the product and store it in a dry place if it would not be used for a long time.

Method of Scale Removal

- Descale the kettle body regularly.
- Fill the kettle with vinegar and water to Max mark, ratio of vinegar and water is 1:2.
- Boil the liquid mixture and keep it for 24 hours in the kettle before pour it away.
- Fill the kettle with clean water to MAX mark and boil it.
- Pour away all boiled water and clean the kettle body, filter and lid with clean water. Then the scale removal work is finished.



This marking indicates that this product should not be disposed with other household wastes throughout the nation. To prevent possible harm to the environment or human health from uncontrolled waste disposal; recycle it responsibly to promote the sustainable reuse of material resources. To return your used device, please use the return and collection systems or contact the retailer where the product was purchased. They can take this product for environmentally safe recycling.

E Warranty Registration

Please complete the on-line registration warranty form below. There is no further requirement to send us any hard copy as part of our efforts to save the environment.

In accordance with the terms and conditions of this limited warranty as stated below, PowerPac Electrical Pte Ltd, at its expense shall provide free services for the appliance within the warranty period from its date of purchase from our Authorised dealers.

This warranty will be honoured subject to the customer's registration of the warranty inclusive of original invoice or valid purchase receipt. Failure to present these documents will result in denial of service. However, if the customer still requests that the defective appliance be repaired, PowerPac Electrical Pte Ltd may, at its discretion, repair the appliance but impose a labour charge, as well as the costs of the replacement parts, to be borne solely by the customer

E-Register scan



Product Serial No



Refer rating label at bottom of product

 follow us on face book

PowerPacSG

 follow us on tiktok

@powerpacsg



ITE

← Simei / Tampines Simei Ave Expo →

96111 (Bus No. 31 / 118)

Changi Fire Station

Upper Changi RD

No.1 No.3 Mapletree No.5 ARALOGOS

WE ARE HERE (LEVEL 3)

Kian Ann

SG5

Orn Wah

PROLOGIS

Flex

Goodrich Global

85079 (Bus No 2/9/10/48)

85071 (Bus No 2/9/10/48)

Simpang Bedok

Entrance

OFFICE / SERVICE CENTER

PowerPac Electrical Pte Ltd Tel: 6214 9555
Address: 5 Changi South Lane, #03-01 S(486045)

 Tanah Merah Stn Exit B »» Bus No. 2/9/48(Stop ID: 85091)
»» 5 min (4 stops) »» Bef Changi Fire Stn (Stop ID: 85071)
»» Walk About 6 min, 500m

 Simei MRT »» Bus No. 9 (Stop ID: 85079)»» 6 min (3 stops)
»» Flextronic (Stop ID: 96161) »» Walk About 6 min, 500m

PowerPac Electrical Pte Ltd

✉ sales@powerpac.com.sg  PowerPacSg

🌐 www.powerpac.com.sg  @PowerPac4

小熊电器股份有限公司
BEAR ELECTRIC APPLIANCE CO.,LTD.