



Q-Box™ Revealing a better way

Tools Needed for Installation:
1/4" Nut driver, Small flat blade screwdriver

IMPORTANT SAFETY INSTRUCTIONS

Q-Box should be installed by a qualified, licensed electrician. Modifying the product or altering the product voids UL Certification Listing. Failure to follow these instructions could result in death, bodily injury, fire, or electrical shock.

- Wet location rated only when cover is closed
- For use only on walls or ceilings
- Not intended for use with ceiling fans or other heavy/large fixtures
- Q-Hub ETL Listed, Conforms to UL Std. 5A, Certified to CAN/CSA C22.2 #62.1

MOUNTING THE Q-HUB

Inboard Mounting

WARNINGS

- Must use supplied mounting screw (#9-15x2", 1/4" Hi-hex w/shoulder & EPDM bonded washer, Type S, Shield Coated) or equivalent.
- If using any other screw type, care must be taken to seal around screw head in interior of junction box with an appropriate sealant to ensure a watertight seal.
- Failure to follow these instructions voids wet location rating of junction box and may damage wires.

NOTE: Q-Hub must be attached to a structural part of the building, such as a rafter

1. Ensure bonded washer is present on supplied screw.
2. Position Q-Hub onto mounting surface.
3. Secure Q-Hub to mounting surface by running supplied screw in until bonded washer is compressed and makes a watertight seal.
4. Ensure screw is properly seated to make a watertight seal as shown in Figure 1.
5. If desired, a second screw can be used in alternate boss that is provided inside junction box. When using a second screw, ensure watertight seal is made either by adding silicone (or equal) or using screw with bonded rubber washer.
6. If pre-installed mounting screw is removed from box to use outboard mounting, seal hole in box with appropriate material, such as silicone, to ensure a watertight seal.



Figure 1 - Inboard Mounting

Outboard Mounting

NOTE: Outboard mounting screws are not provided. Q-Hub must be attached to a structural part of the building, such as a rafter

1. Position Q-Hub onto mounting surface.
2. Secure Q-Hub to mounting surface using locations provided on Q-Hub as shown in Figure 2.
3. It is recommended to use an appropriate screw for the environment, with a shoulder large enough to avoid any slip through the mounting locations.

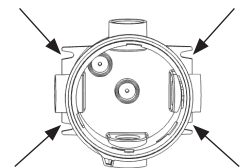
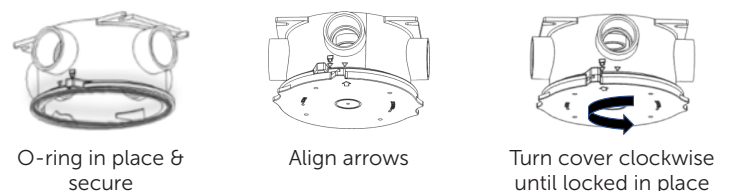

Figure 2 - Outboard Mounting Locations

Attaching Cover

1. Verify O-ring is in place and secured in gasket groove in Q-Hub. An O-ring that is removed and/or not properly secured in groove may cause water ingress inside Q-Hub.
2. Make sure O-ring is free from any debris, as this can compromise proper compression of the O-ring, resulting in a leak point.
3. Position cover so alignment arrows line up. Alignment arrows are located on cover, directly to the left of locking hole in Q-Hub. The cover should seat completely into Q-Hub when lined up as described.
4. Lock cover into place by turning cover clockwise until a click is heard from cover locking into place. You should feel and hear cover lock into place. Verify cover is locked into place. Figure 3

Figure 3 - Attaching Cover



Removing Cover

1. Remove cover from the Q-Hub by placing a screwdriver into the slot of the locking mechanism and prying the cover counter-clockwise until released from the lock. Figure 4

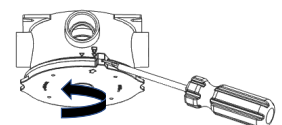

Figure 4 - Pry cover counter-clockwise to unlock



Conduit Openings



WARNING

- All unused openings must be plugged with a UL Approved adapter.

Two conduit openings are intentionally left open to provide the fastest install. If more openings are needed, simply knockout the plug in the Q-Hub using a screwdriver or another tool, as shown in Figure 5. When using knockout feature, ensure knockouts are smooth and free of burrs or other sharp edges that may damage wires.

Nonmetallic fittings can be used in the conduit openings, but they must be a UL approved fitting. In order to maintain a watertight seal, installing a watertight UL approved fitting is required. Only glues stated in this instruction manual (under "Gluing" section) should be used.

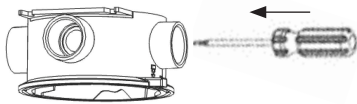

Figure 5 - Conduit Openings

Alternate Opening

A target location is provided in the center of the Q-Cover for an alternate fitting opening. When using the alternate opening, drill either a 1/2" or 3/4" hole, whichever is appropriate, for use with a wet location listed cable gland adapter or other wet location certified adaptor, fitting, or device to ensure a watertight seal. When mounting devices to the Q-Cover use a coarse thread screw of a length that does not penetrate the inside of the cover. If screw penetrates cover use a proper method of sealing.

Gluing



WARNING

- Use of an unapproved glue may result in connection failure and voids all safety certifications

To ensure proper adhesion and seal, use the approved glues (or equivalent) listed below:

- Oatey All Purpose Cement #30821 For use with PVC, CPVC & ABS
- Oatey ABS to PVC Green Transition Cement #30900
- Oatey Purple Primer #30756 For use with CPVC & PVC
- Oatey Heavy Duty Gray PVC Cement
- Oatey Rain-R-Shine Medium Blue PVC Cement