

Ecophon Akusto™ One

To increase the sound absorption in the room this system gives you the possibility to install Ecophon Akusto™ One on the wall. The systems give design possibilities, working with different formats and colours to create various patterns.

Three possibilities exist to fix Akusto™ One, Connect™ One trim, Connect™ One hook fixing or Connect™ One fixing. Akusto One is available in various sizes with a weight of 2,0-4,5 kg. The panel is manufactured from high density glass wool. The visible surface has a glass fibre fabric Texona in colours and is also available with a painted surface (Akutex™ FT). The back of the panel is covered with glass tissue. The edges are straight cut and painted in white.



Helsingborg, Sweden

System range



Size, mm	Ø592	592x592	Ø792	1192x292	1192x592
Special Fixing	•	•	•	•	•
Thickness	40	40	40	40	40
Inst. Diagr.	M372	M371	M372	M371	M371



Akusto One panel



Installation with Connect™ One trim and Connect™ Absorber Anchor One



Installation with Connect™ One hook fixing

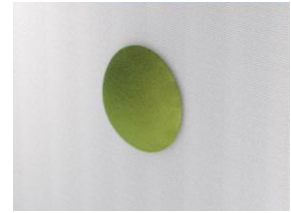

Installation with Connect™ One fixing



acoustic

The values in the diagram refer to a single unit. If the units are arranged in a cluster with distances between units less than 0,5 metres, the Aeq per unit will be slightly reduced.

Sound absorption:

Test results according to EN ISO 354.

A_{eq}, Equivalent absorption area per unit (m² sabin)

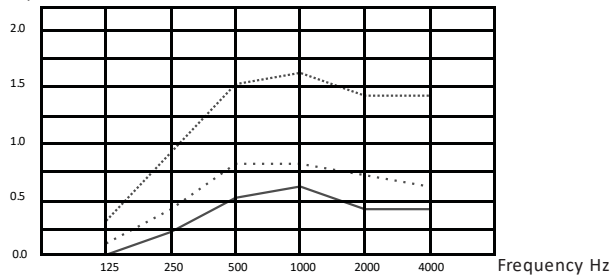

— Akusto One Ø592, 48 mm o.d.s.

··· Akusto One Ø792, 48 mm o.d.s.

o.d.s = overall depth of system

A_{eq}, Equivalent absorption area per unit (m² sabin)

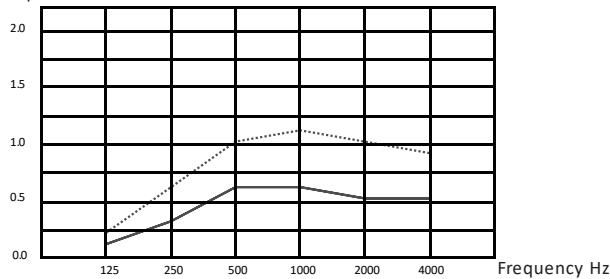

— Akusto One 592x592, 48 mm o.d.s.

··· Akusto One 1192x292, 48 mm o.d.s.

--- Akusto One 1192x592, 48 mm o.d.s.

o.d.s = overall depth of system

	THK mm	o.d.s. mm	A _{eq} , Equivalent absorption area per unit (m ² sabin)					
			125 Hz	250 Hz	500 Hz	1000 Hz	2000 Hz	4000 Hz
Ø592	40	48	0.00	0.20	0.50	0.60	0.40	0.40
Ø792	40	48	0.10	0.40	0.80	0.80	0.70	0.60
592x592	40	48	0.10	0.30	0.60	0.60	0.50	0.50
1192x292	40	48	0.10	0.30	0.60	0.60	0.50	0.50
1192x592	40	48	0.20	0.60	1.00	1.10	1.00	0.90



Indoor Climate

Certificate / Label

French VOC, A+

Finnish M1



environmental influence

Fully recyclable.



Fire safety

Country	Standard	Class
Europe	EN 13501-1	A2-s1,d0

The glass wool core of the tiles is tested and classified as non-combustible according to EN ISO 1182.



Influence of climate

The units should be installed in areas/premises where the ambient relative humidity (RH) and the temperature does not exceed 70% and 25°C respectively.



Visual appearance

Akusto Wall in white has high light reflectance. Light reflectance and nearest NCS colour sample for all the different colours: See Ecophon Colours and surfaces.



Cleanability

Daily dusting, vacuum cleaning and weekly wet wiping (Akutex FT surface). Weekly dusting and vacuum cleaning (Texona) as required.



accessibility

The tiles are easily demountable.



Installation

Installed according to installation diagrams, installation guides and drawing aid. For information regarding minimum overall depth of system see quantity specification.



mechanical properties

No additional live load is allowed.



Ce

Ecophon ceiling systems are CE marked according to the European harmonized standard EN13964:2014. CE marked construction products are covered by a Declaration of Performance (DOP) which enables customers and users to easily compare performance of products available on the European market.

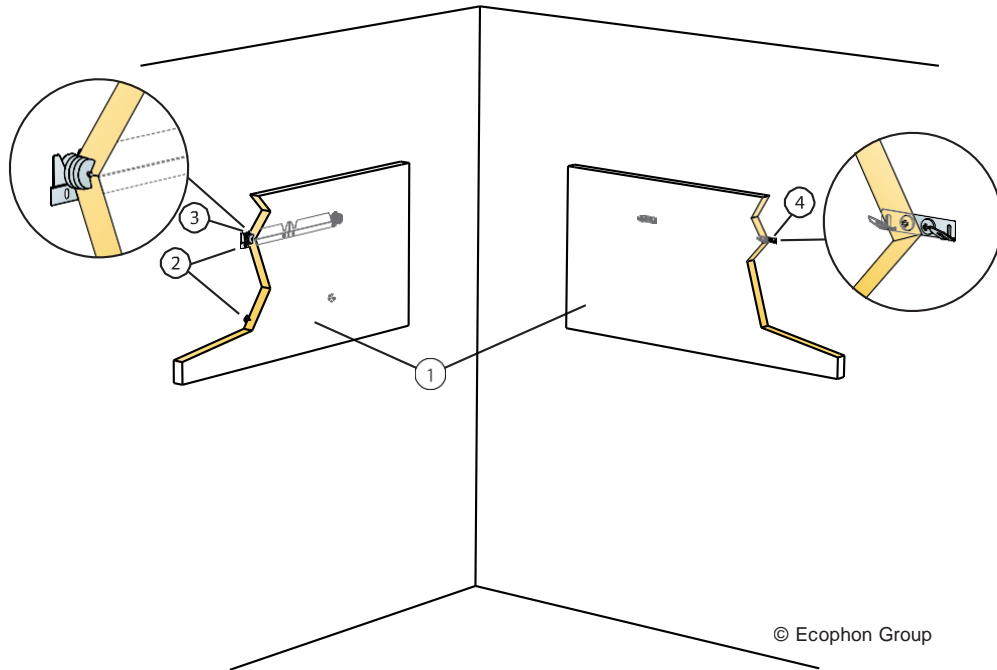

Quantity specification (Excl. wastage)

	Size, mm		
	592x592	1192x292	1192x592
1 akusto one	2,8/m ²	2,8/m ²	1,4/m ²
2 alt. 1 connect one trim (wall distance included)	1/panel	1/panel	1/panel
3 alt. 1 connect absorber anchor one	2/panel	2/panel	2/panel
4 alt. 2 connect one hook fixing	2/panel	2/panel	2/panel
Δ min. overall depth of system: Δ1 48 mm / Δ2 44 mm			

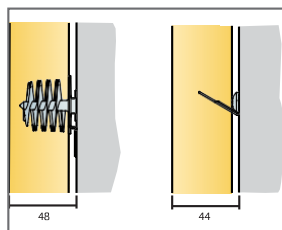

see Quantity specification

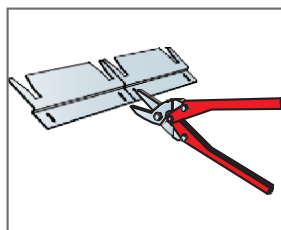

connect one trim can be divided into two suspension trims

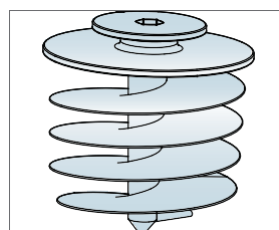

connect absorber anchor one used together with connect one trim

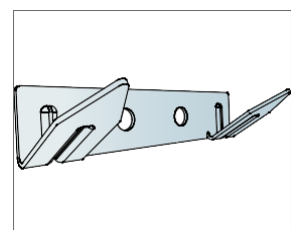

connect one hook fixing

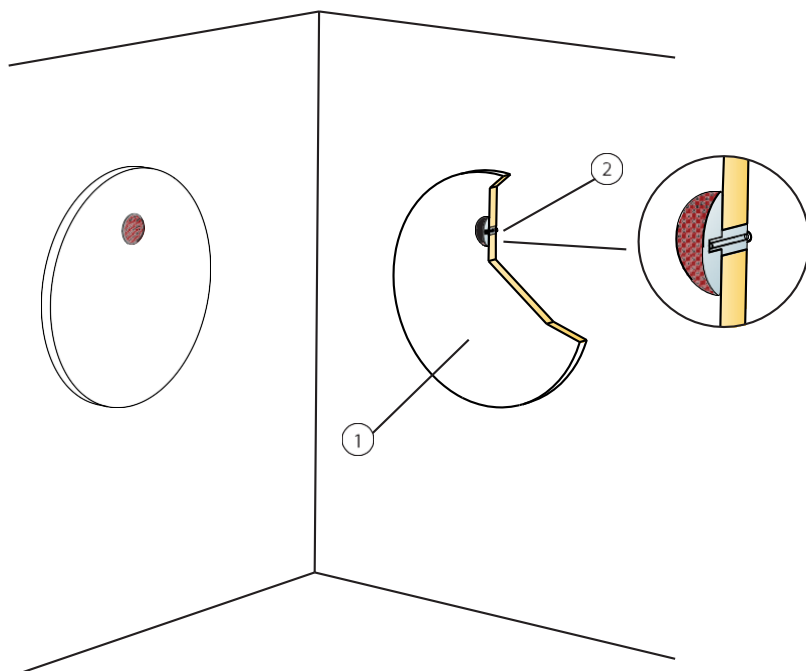

Quantity specification (Excl. wastage)

		Size, mm		
		Ø592	Ø792	Ø1192
1	akusto one	3,5/m ²	2/m ²	0,9/m ²
2	connect one fixing	1/panel	1/panel	1/panel

Δ min. overall depth of system: 40 mm

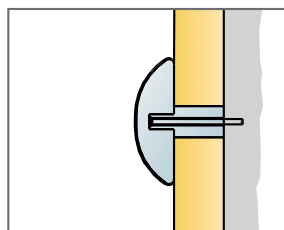

see Quantity specification

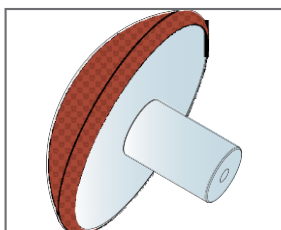

connect one fixing available in 4 different colours

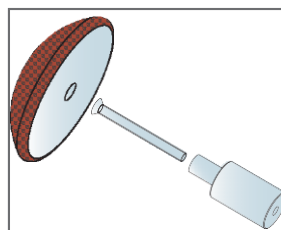

Installation with connect one fixing

