

# INSTALLATION INSTRUCTIONS



COLOR  
**6000K**  
(PURE WHITE)

LIFESPAN  
**50,000**  
HRS

TOTAL POWER  
**65W**  
EACH

VOLTAGE  
**9~32V**

RATING  
**IP-67**  
↓



# C29 HIGH OUTPUT

QUANTITY 2PCS

# LED HEADLIGHT CONVERSION KIT

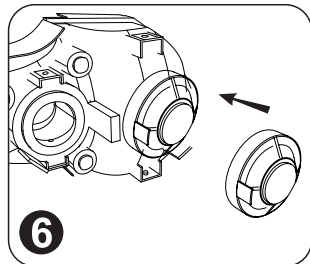
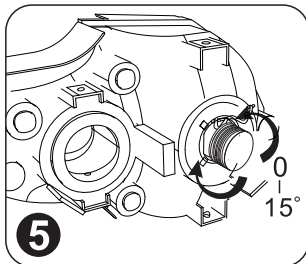
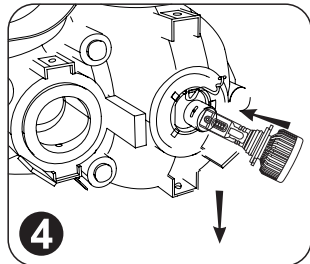
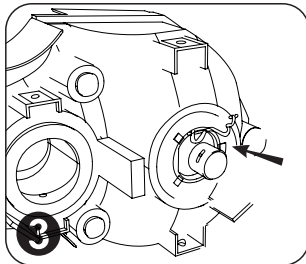
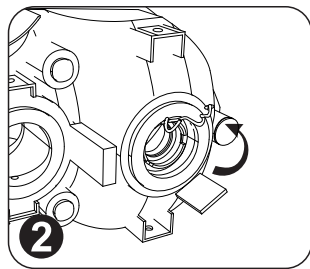
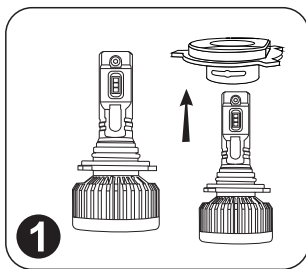

For installation of the below models:

H1 H3 H4 H7 9007  
H13 9004 5202/H16EU  
H13 - NO SHIELD

Airflow is required for these high output lights to stay cool. Removal of dust covers or drilling holes into the dust cover is highly recommended.

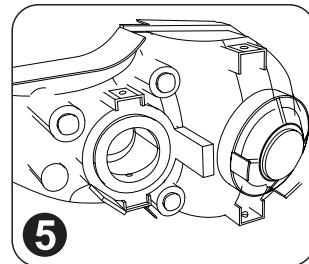
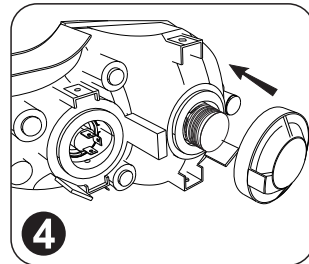
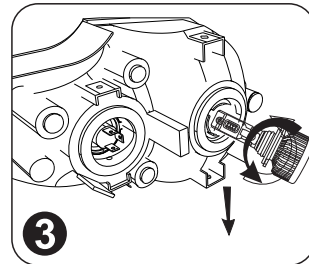
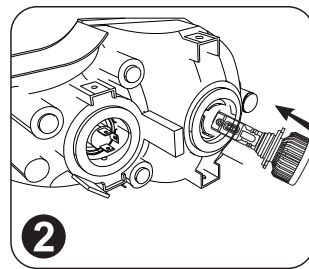
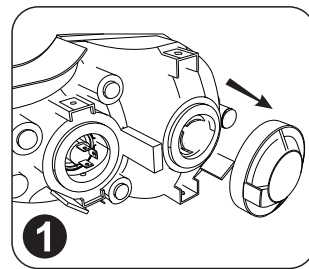

For installation of the below models:

H11/H16JP 9005/H10 9006  
9012 880/881 9140/9145

Airflow is required for these high output lights to stay cool. Removal of dust covers or drilling holes into the dust cover is highly recommended.

# WARRANTY

A 5 Year Warranty is given from the date of purchase to the original purchaser. The warranty is for free repair or replacement and covers manufacturing faults only. Labor costs are not covered by warranty. You have 60 days to register for the warranty.

- This warranty is solely for the original purchaser/customer.
- Repair or replacement, as provided under this warranty, is the exclusive remedy to the customer. We shall not be liable for any incidental or consequential damages for breach of any stipulation in this warranty.

## WARRANTY EXCLUSIONS:

- Any damages caused from improper operation or connecting voltages to other than 9~32 VDC.
- The product appears to have excessive physical damage.
- Damage to light(s) from excessive heat due to lack of air flow.
- Light(s) failure from mud/dirt.
- Light(s) not registered for warranty.

## Register Online for Warranty

[plashlights.com/pages/warranty-registration-form](http://plashlights.com/pages/warranty-registration-form)

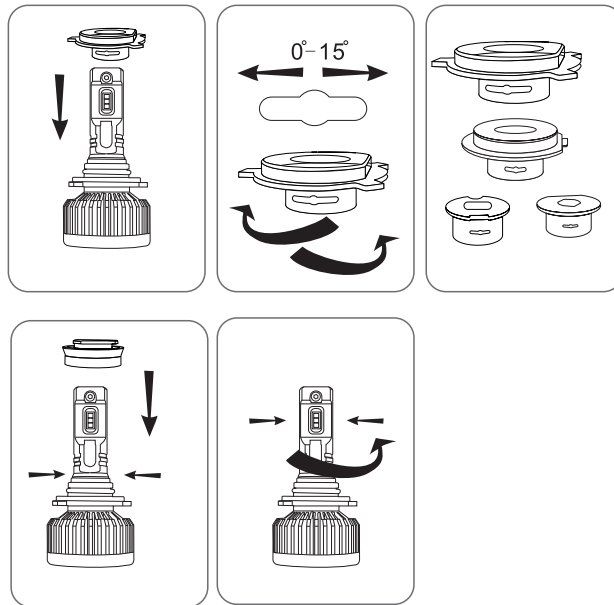

PLASHLIGHTS LLC  
3304 N WYOMING AVE,  
DICKINSON, TX 77539  
PLASHLIGHTS.COM  
1-855-661-1002

Please contact PlashLights LLC should you have any questions about the installation process at 855-661-1002 ext 3 (10a-5p CST) or email: [support@plashlights.com](mailto:support@plashlights.com)



## GENERAL NOTES

1. Reference your vehicles manual for instructions on accessing bulb.
2. Air flow is required for proper operation and longevity.
3. Lights installed with a dust cover in place that are not vented will not be covered under warranty.
4. Ensure extra wiring is not in contact with the light housing. Secure all wiring in place with a zip tie.
5. In some applications, it may be required to rotate the bulb body in relation to locking ring to achieve desired & optimal beam pattern.
6. When operating, the cooling fan will produce noise. This is normal.
7. These lights are for "Off-Road Use Only". PlashLights LLC will not be liable for any tickets or legal action.