

# TRACKER CUSTOM SR

Upgrade your SR.  
This is a custom tracker style  
popular with street bikers!



Super Tracker Handlebar

P/No.	Desc.	Price
023060-ST	Stainless	¥6,090
023060-06	Black chrome	¥4,725



Super Tracker Handlebar w/Brace

P/No.	Desc.	Price
023061-03	Chrome	¥5,040
023061-06	Black coating	¥4,725

Long cable/brake hose set required if attaching this handlebar.

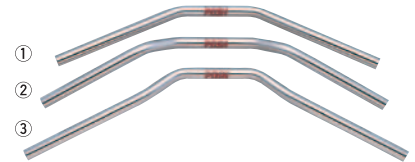

Stainless Steel Handlebar

P/No.	Type	Price
① 010064	Flat	¥4,725
② 010065	Continental	¥4,725
③ 010069	England	¥5,670



SR400 ('01~'07) EARL'S Brake Hose Set  
(accelerator/clutch/decompression)

P/No.	Price
010021-60	¥16,800

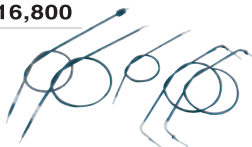

SR400/500  
( '88 to CV carburetor model)  
Long Cables

P/No.	Price
010011-60	¥9,450

Four item 10cm long cable set:  
accelerator/clutch/brake/de-  
compression



## Short Cables

■ Short Accelerator Cables (open:10cm short, close:13cm short)

P/No.	Model (year)	Carburetor type	Price
010023-AC	SR400 ('01~'07)	Stock carburetor models	¥4,410
010013-AC	SR400 ('88~'00)	CV carburetor models	¥4,410
010033-AC	SR400 VM carburetor/FCR models		¥4,410

■ Short Brake Cables/Hoses (10cm short)

P/No.	Model (year)	Price
010013-BR	SR400 ('88~'00)	¥1,890
* Short brake hose for '01 and later models		¥9,450

■ Short Clutch Cable (10cm short)

P/No.	Model (year)	Price
010013-CL	SR400 ('88~'07)	¥1,890

■ Short Decompression Cable (10cm short)

P/No.	Model (year)	Price
010013-DC	SR400 ('88~'07)	¥1,890

\*Short decompression cable cannot be used with some separated handles. Use a decompression lever kit sold separately sold in that case.

## Long Cables

■ Long Accelerator Cables (10cm long)

P/No.	Model (year)	Carburetor type	Price
010021-AC	SR400 ('01~'07)	Stock carburetor models	¥4,410
010011-AC	SR400 ('88~'00)	CV carburetor models	¥4,410
010031-AC	SR400 VM carburetor/FCR models		¥4,410

■ Long Brake Cables/Hoses (10cm long)

P/No.	Model (year)	Hose type	Price
010011-BR	SR400 ('88~'00)		¥2,100
552065-F1	SR400 ('01~'06)	Mesh hose	¥9,450

■ Long Clutch Cable (10cm long)

P/No.	Model (year)	Price
010011-CL	SR400 ('88~'07)	¥2,100

■ Long Decompression Cable (12cm long)

P/No.	Model (year)	Price
010011-DC	SR400 ('88~'07)	¥1,890

## Repair Cables (stock length)

■ Accelerator Cables

P/No.	Model (year)	Carburetor type	Price
010022-AC	SR400 ('01~'07)	Stock carburetor models	¥3,780
010012-AC	SR400 ('88~'00)	CV carburetor models	¥3,780
010032-AC	SR400 VM carburetor/FCR models		¥3,780

■ Brake Cables

P/No.	Model (year)	Price
010012-BR	SR400 ('88~'00)	¥1,575
552065-F	SR400 ('01~'07)	¥9,450

■ Clutch Cable

P/No.	Model (year)	Price
010012-CL	SR400 ('88~'07)	¥1,890

■ Decompression Cable

P/No.	Model (year)	Price
010012-DC	SR400 ('88~'07)	¥1,575

# New Vintage Spirit



*It all starts with having fun.  
These parts are for those who see life positively,  
and who love England and the British way of life.*

The British energy originates from that positive outlook. Laugh like everyone else, and have a passion for originality. The theme of this new vintage style - With Boys Racers Heart Directed by MOTO/POSH - lies in having fun one's self. It is the policy and passion of single-cylinder bike aficionados to enjoy the motorcycle, dress it up as a hobby, and make their machine look its best by adding major improvements to it. And the number of people with this outlook has been on the rise.



## SR400/500 (~'07) Handle Stopper

P/No.	Price
010041	¥1,890



## SR400/500 (~'07) Decompression Lever Kit

P/No.	Price
010127	¥6,090

The decompression cable must be replaced and the lever moved when changing the handlebar. Removing the decompression cable makes the handle area look cleaner.



## SR400/500 (~'07) Horizontal Long Headlight Stays

P/No.	Fork diameter	Price
010189	φ35mm	¥12,600

Made of aluminum alloy with a buffed finish.  
\* Use with a handle stopper.



## SR400/500 (~'07) Rockers Type Light Stays

P/No.	Desc.	Price
907112	Stainless	¥9,450

\* Use with a handle stopper.



## SR400/500 (~'07) Bar End Mirror Attachment

P/No.	Price
010070	¥3,150

Enthusiasts can't stand from a design standpoint the marks left from bar handle attachment when attaching a clip-on handle on the stock SR400/500.\* Bar end mirror not included.



## SR400/500 (~'07) Dummy Damper Knob TYPE 2

P/No.	Year	Price
010073-00	(~'00)	¥8,190
010073-01	('01~'07)	¥8,190

Head part is machined aluminum with a Chrome plated finish.



### SR400/500 (~'07) Tachometer Gear Cap

P/No.	Price
010074-03	¥840

Hole cover for tachometer gear part.

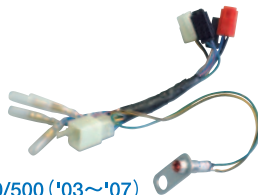

### SR400/500 ('03~'07) Indicator Harness Kit with Immobilizer

P/No.	Price	Includes immobilizer light.
010461	¥3,045	Stay is steel with chrome plating finish.



### LED-Back-light Four Indicator Mini Meter

P/No.	Color	Price
000014-80	White panel	¥10,500
000014-81	Blue panel	¥10,500
000014-82	Red panel	¥10,500
000014-83	Yellow panel	¥10,500
000014-86	Black panel	¥10,500

○Blue: High beam ○Red: Oil lamp  
○Green: Neutral ○Yellow: Turn signal  
\* Oil lamp will not light on models without an oil lamp.\* 140 km/h display with trip meter\* Four indicators within the panel\* Troublesome wiring work unnecessary if using indicator panel kit for specific models.

### SR400/500 Indicator Harness Kit

P/No.	Year	Price
010460	('94~'02)	¥1,050
010461	('03~'07)	¥3,045



### SR400/500 (~'02) Main Key Side Mount Kit

Kit for relocating main key to under left side of the gas tank  
\* Handle lock will no longer be usable.

P/No.	Price
010045	¥4,725

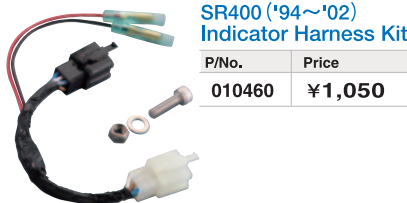

### SR400 ('94~'02) Indicator Harness Kit

P/No.	Price
010460	¥1,050



### SR400/500 (~'07) Pipe Single Meter Stay

Change the stock two-meter instrument panel to a single meter. (Works with both stock meter and mini meter.)  
\* Steel with chrome plating finish

P/No.	Price
010076	¥1,890



### SR400/500 Indicator Kit

P/No.	Year	Price
010401-93	(~'93)	¥4,725
010401-94	('94~'02)	¥4,725

\* Includes bolt-on coupler \* Not compatible with '03 and later models



### SR400/500 (~'07) Bates Light Stay

P/No.	Color	Price
010177-03	SILVER	¥2,415
010177-06	BLACK	¥2,415

Aluminum with alumite finish  
Only works with 4.5-inch Bates lights. (Will not work with 5.5-inch.) Stock meter can be used.  
Stock turn signals cannot be used.  
\* Separate turn signal base stay required for attaching turn signals.



### SR400/500 (~'07) Neo-classic Oil Temperature Gauge

P/No.	Color	Price
010024	Chrome	¥5,250
010024-03	SILVER	¥5,250
010024-07	Bronze	¥5,250
010024-12	C.Gold	¥5,250

A neo-classic design, just like the name says. Old-fashioned yet new to fit today's machines.

**About display panel direction**  
Please be aware that the display may be tilted or backwards when attached to the motorcycle.



### SR400/500 (~'07) Front fork Case

P/No.	Color	Price
010377-06	BLACK	¥1,890

Just cover the inner tube with this to give the front end a reserved, black look.

### Chrome plated Horn

P/No.	Desc.	Price
913901	UNIVERSAL	¥2,940



\*For 12V motorcycles  
Approx. 93mm outer diameter



### Bates Light Stay Type II

P/No.	Desc.	Price
010277-ST	Stainless	¥2,940
010277-06	Steel black	¥2,625

\* Light position raised 20mm over original and set 30mm forward.  
\* Works with 4.5- and 5.5-inch Bates lights. 3mm thick stainless steel and steel give both excellent durability and vibration resistance! Stock meter can be used.  
Stock turn signals cannot be used.  
\* Separate turn signal base stay required for attaching turn signals.

### \* Caution!

When attaching our 5.5-inch Bates type headlights, the headlight and body of SR400s with immobilizers interfere with each other, so the following POSH parts are required.  
■ Part No. 121506 Universal collars M6-15T (one set)  
■ Part No. 900625 M6 X 25mm cap bolts (one set)  
<Applicable SR400 models>  
3HTF ('03), 3HTG ('04), and later



### SR400/500 (~'07) Turn Signal Stay Base

P/No.	Color	Price
010096-ST	Stainless	¥1,575
010196	Chrome	¥1,260
010096	BLACK	¥1,260

Necessary for moving the turn signals to the front underbracket area.



### Megajoint Turn Signal Stay

P/No.	Price
010101-MS	¥2,415

Stainless steel ultra-short stay  
Stay part total length: 19mm (excluding threaded part), M-10 thread diameter.  
(for models up to 2006)

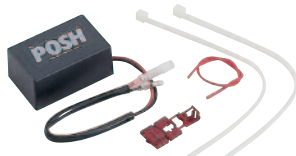

### SR400/500 (~'00) Batteryless Conversion Kit

P/No.	Price
010068	¥5,040

\* Reverse connection damage prevention circuit included.  
Cannot be used with '01 or later models due to digital C.D.I. ignition.

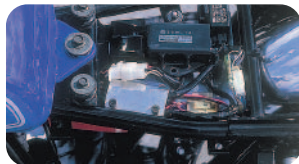

### SR400/500 ('88~'00) Batteryless Conversion Plate

P/No.	Price
010269	¥9,975

Keep the exposed harness and electrical parts neatly together on the batteryless conversion plate when the air cleaner is removed for attaching the batteryless conversion kit. Made of stainless steel.

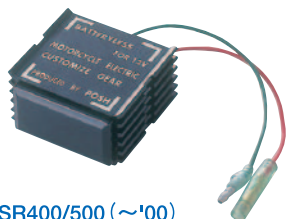

### SR400/500 (~'00) Batteryless Conversion Kit Type 2

P/No.	Price
010168	¥5,250

\* Reverse connection damage prevention circuit included.  
Cannot be used with '01 or later models due to digital C.D.I. ignition.



### SR400/500 ('88~'07) Stainless Mud Guard

P/No.	Price
010167	¥5,250

Cannot be used with stock air cleaner, stock battery box, tool box, and side cover. (Stainless steel with buffed finish)



### SR400 ('01~'07) AIS Plate

P/No.	Price
010120	¥4,725

This is a stay for moving the AIS. (Holes must be made in the filter)  
Includes blow-by gas return hose.

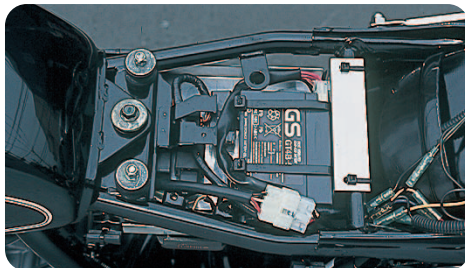

### SR400 ('94~'07) Battery Plate (Compatible with stock battery.)

P/No.	Price
010269-01	¥10,500

Digital C.D.I. ignition introduced from '01 SR400, so batteryless conversion kit cannot be used. So, for riders who want that open look, we have produced a battery plate for attaching a stock small battery sideways under the seat. \* Made of stainless steel.

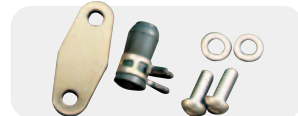

### SR400 ('01~'07) AIS Canceling Plate

P/No.	Price
010121	¥1,890

This is a set that includes a plate and rubber cap to block the hose after removing the secondary intake device.

\* Use when replacing with a racing carburetor and not using an AIS (secondary intake device).



### SR400/500 (~'00) DNA Air Filter

P/No.	Price
023018-DN	¥4,725

\* Opening diameter: 51mm



### SR400 ('01~'07) DNA Air Filter

P/No.	Price
059018-DN	¥5,775

\* Compatible with AIS \* Opening diameter 51mm  
Use with AIS plate. (Holes must be made)



### SR400/500 (~'00) DNA Breather Filter

P/No.	Price
010119-DN	¥3,150

Can be installed on '01 and later models, but does not have return function.

\* Inner diameter: 19mm



### 6 Oversized Main Jet

P/No.	Color	Price
720740	SR400 ('01~'07) #180~#205	¥1,155
720728	SR400/500 VMCarb. #285~#310	¥1,155
720729	SR400/500 CVCarb. #165~#190	¥1,155
720730	SR400/500 CVCarb. #195~#220	¥1,155

### 3 Oversized Pilot Jet

P/No.	Color	Price
761002	SR400 ('01~'07) #25, #27.5, #30	¥1,260
761001	SR400/500 CVCarb. #48, #50, #52.	¥1,260



### SR400 ('01~'07) Su-ka Tune kit (Compatible with stock battery)

with Main Jet

P/No.	Price	Contents	P/No.	Price
011002-DN	¥22,155	Filter	059018-DN	¥5,775
		Plate	010269-01	¥10,500
		AIS Plate	010120	¥4,725
		Main Jet	720740	¥1,155

### SR400/500 ('94~'00) Su-ka Tune kit (Compatible with stock battery)

with Main Jet

P/No.	Price	Contents	P/No.	Price
010002-DN	¥19,530	Filter	023018-DN	¥4,725
		DNA Breather	010119-DN	¥3,150
		Plate	010269-01	¥10,500
		Main Jet	720729	¥1,155

### SR400/500 ('88~'00) Su-ka Tune kit (Compatible Batteryless)

with Main Jet

P/No.	Price	Contents	P/No.	Price
010203-DN	¥24,225	Filter	023018-DN	¥4,725
		DNA Breather	010119-DN	¥3,150
		Plate	010269	¥9,975
		Batteryless	010168	¥5,250
		Main Jet	720729	¥1,155

### SR400 ('01~'07) Su-ka Tune kit

(Compatible with stock battery)

with Main Jet & Pilot Jet

P/No.	Price	Contents	P/No.	Price
011003-DN	¥23,100	Filter	059018-DN	¥5,775
		Plate	010269-01	¥10,500
		AIS Plate	010120	¥4,725
		Main Jet / Pilot Jet	720002	¥2,100

### SR400/500 ('94~'00) Su-ka Tune kit

(Compatible with stock battery)

with Main Jet & Pilot Jet

P/No.	Price	Contents	P/No.	Price
010003-DN	¥20,475	Filter	023018-DN	¥4,725
		DNA Breather	010119-DN	¥3,150
		Plate	010269-01	¥10,500
		Main Jet / Pilot Jet	792001	¥2,100

### SR400/500 ('88~'00) Su-ka Tune kit

(Compatible Batteryless)

with Main Jet

P/No.	Price	Contents	P/No.	Price
010204-DN	¥25,200	Filter	023018-DN	¥4,725
		DNA Breather	010119-DN	¥3,150
		Plate	010269	¥9,975
		Batteryless	010168	¥5,250
		Main Jet / Pilot Jet	792001	¥2,100



Photo is TW mini battery spec.



Photo is TW batteryless spec.



SR400/500 (~'07) Flat Short Seat (Mesh Leather)

P/No.	Price
010102-ML	¥33,600

The base plate is vacuum molded synthetic resin instead of FRP. The seat front leather is attached with a tackler, so it can be replaced. Waterproof sheet is used to prevent water intrusion at seat stitching.



SR400/500 (~'07) Flat Short Seat (Tuck-Roll)

P/No.	Price
010102-TR	¥35,700

The base plate is vacuum molded synthetic resin instead of FRP. The seat front leather is attached with a tackler, so it can be replaced. Waterproof sheet is used to prevent water intrusion at seat stitching.



SR400/500 Cafe' Three Tank Cover

P/No.	Desc.	Price
904101	For '93~'00 Tank cap	¥27,300
904102	For '01~'07 Tank cap	¥27,300

Just cover the stock tank with this to get a long tank position. However, you will need to change to a special seat (cafe' three seat for tank cover). \* Product is finished in a black gel coat.



SR400/500 (~'07) '70S Seat Type I

P/No.	Type	Price
901102	Standard	¥39,900

Slightly thinner than the Type II.



SR400/500 (~'07) '70S Seat Type II

P/No.	Type	Price
901103	Thick	¥39,900

Same thickness as stock.



SR400/500 (~'07) '70S Seat Type III

P/No.	Type	Price
901104	Thin	¥39,900

The thinnest of the seventies seats.



SR400/500 (~'07) Semi-double Seat

P/No.	Piping color	Price
010101	White	¥29,400
010103	Black	¥29,400

The base plate is vacuum molded synthetic resin instead of FRP. The seat front leather is attached with a tackler, so it can be replaced. Waterproof sheet is used to prevent water intrusion at seat stitching.

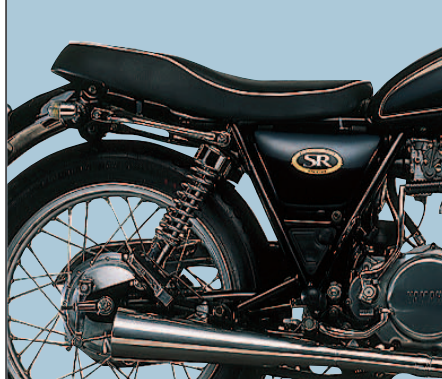

SR400/500 (~'07) Traditional Seat

P/No.	Price
010100	¥36,750

The ultimate seat for raising the classical mood with the SR400/500.



SR400/500 (~'07) Reflecting Seat

P/No.	Price
901111	¥42,000

Without the "SR" letters. The side lines and piping reflect headlight beams at night to stand out in bold relief.



SR400/500 (~'07) Reflecting Seat

P/No.	Price
901110	¥42,000

Highly reflective UNITIKA reflective cloth is sewn into the piping, side lines, and tail area at accenting feature for a fashionable look. Improves visibility at night.



SR400/500 Assisting Grips

P/No.	Desc.	Price
010071	Chrome	¥2,100
010071-ST	Stainless	¥3,150
010071-06	BLACK	¥2,100



### SR400/500 Cafe' Five Tank Cover

P/No.	Desc.	Price
904109	For '93~'00 Tank cap	¥27,300
904200	For '01~'07 Tank cap	¥27,300

Just cover the stock tank with this to get a long tank position.

However, you will need to change to a special seat (cafe' five seat for tank cover)

\* Product is finished in a black gel coat.



### SR400/500 (~'07) Cafe' Five Seat (for tank cover)

P/No.	Price
901113	¥40,950

This is a seat exclusively for the cafe' five tank cover.

\* Can be installed with stock tank, but a large gap will remain. \* Single seat, so it cannot be used for two-up riding.



### SR400/500 (~'07) Cafe' Five Seat (for stock tank)

P/No.	Price
901112	¥40,950

\*Single seat, so it cannot be used for two-up riding.



### SR400/500 Cafe' Four Tank Cover

P/No.	Desc.	Price
904107	For '93~'00 Tank cap	¥27,300
904108	For '01~'07 Tank cap	¥27,300

Just cover the stock tank with this to get a long tank position. However, you will need to change to a special seat (cafe' three seat for tank cover). \*Product is finished in a black gel coat.



### SR400/500 (~'07) Cafe' Three Seat (for tank cover)

P/No.	Piping color	Price
901107	Black	¥39,900
901108	White	¥39,900



### SR400/500 (~'07) Cafe' Three Seat (for stock tank)

P/No.	Piping color	Price
901105	Black	¥39,900
901106	White	¥39,900



### SR400/500 (~'07) Imola Type Side Covers

P/No.	Price
904104	¥16,800

Made of FRP, and finished in a gel coat.

\* Air cleaner box and battery must be removed to install.



### SR400/500 (~'07) Classical Side Covers

P/No.	Desc.	Price
010110	FRP and finished in a black gel coat.	¥10,290

These classic type side covers sport a dummy oil cap.



### SR400/500 (~'07) Roll Type Cafe' Three Seat (for stock tank)

P/No.	Piping color	Price
901100	Black	¥39,900
901101	White	¥39,900



### SR400/500 (~'07) Seat Guard II

P/No.	Price
909102	¥3,150

This is a special lock system for SR seats to prevent theft. Can only be used with seats that use the stock bolts.



### SR400/500 (~'07) Classical Step Rubber

P/No.	Price
010172	¥1,890 (2pcs/set)

### Classical Gear Shift Rubber

P/No.	Price
010173	¥630 (2pcs/set)



### Front Fender Plate

P/No.	Desc.	Color	Price
010015-06	UNIVERSAL	Black	¥2,940

\* Holes must be drilled to install.



## POSH Catalyzer Mufflers

These are our mufflers for the SR400 equipped with catalytic converters. The SR400 traditionally has not required a catalytic converter. But we at POSH decided to add a catalytic converter for cleaner exhaust in light of current driving conditions, environmental issues, and the future environment concerning motorcycles. Sound is kept to the 94db regulated volume while keeping the thumping sound typical of single-cylinder engines. Power output is increased over stock mainly in the low- to mid-speed range, and maximum power even exceeds stock. This can be applied to all SR400 models including those the 1999 exhaust regulations apply to and BC-RH-01 to 1JR and 2H6 models. Certified by JMCA. Close-range exhaust volume is 94db.



SR400 (~'07)  
PCM Stainless Triumph Type Muffler (with catalytic converter)

P/No.	Price
010150-CA	¥44,100

\* A center stand stopper (010141: ¥1,050) is required to mount muffler.



SR400 (~'07)  
PCM Stainless Cabton Type Muffler (with catalytic converter)

P/No.	Price
010151-CA	¥44,100

\* A center stand stopper (010141: ¥1,050) is required to mount muffler.

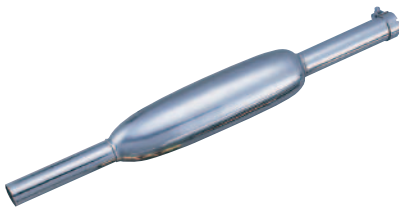

SR400 (~'99JMCA)  
Triumph Type Muffler

P/No.	Price
010057	¥19,950

(Connector part inner diameter: 42mm)(Overall length: 775mm)  
Made of steel with a chrome plating finish. A center stand stopper (010141: ¥1,050) is required to mount muffler. Certified by JMCA.

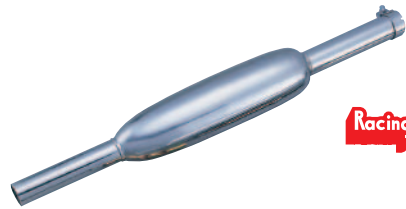

SR400/500 (~'07)  
Triumph Type Muffler

P/No.	Price
010050	¥16,800

(Connector part inner diameter: 42mm)(Overall length: 775mm)  
Made of steel with a chrome plating finish. A center stand stopper (010141: ¥1,050) is required to mount muffler. Not certified by JMCA.

**Racing Use Only**



**Racing Use Only**

SR400/500 (~'07) BSA Type Muffler

P/No.	Price
010052	¥18,900

(Connector part inner diameter: 42mm)(Overall length: 800mm)  
Made of steel with a chrome plating finish. A center stand stopper (010141: ¥1,050) is required to mount muffler. Not certified by JMCA.

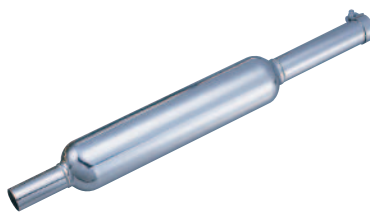

SR400 (~'99JMCA) Cabton Type Muffler

P/No.	Price
010058	¥18,900

(Connector part inner diameter: 42mm)(Overall length: 715mm)  
Made of steel with a chrome plating finish. A center stand stopper (010141: ¥1,050) is required to mount muffler. Certified by JMCA.

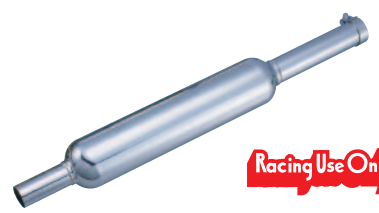

**Racing Use Only**

SR400/500 (~'07) Cabton Type Muffler

P/No.	Price
010051	¥14,700

(Connector part inner diameter: 42mm)(Overall length: 715mm)  
Made of steel with a chrome plating finish. A center stand stopper (010141: ¥1,050) is required to mount muffler. Not certified by JMCA.



**SR400/500 (~'07)**  
Stainless Steel Exhaust Pipe (42.7mm diameter)

P/No.	Price
010155-5	¥20,790

(Stock bend type) (Insert hole: 41.5mm diameter)  
\* This has a larger inner diameter than double-pipe stock type. You'll love the coloration as it burns in. Can be attached to POSH Triumph type, Cabton type



**SR400/500 (~'07)**  
England Type Exhaust Pipe (42.7mm diameter)

P/No.	Price
010155-6	¥20,790

\* Stainless steel (Insert hole: 41.5mm diameter)  
This is an English-type exhaust pipe. The silencer attachment position is the same as stock.



**SR400/500 (~'07)**  
Center Stand Stopper

P/No.	Price
010141	¥1,050

When changing the muffler, it will interfere with the center stand, so this part is necessary.

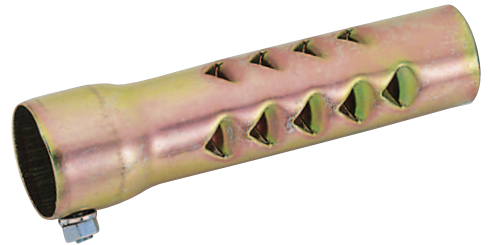

**Semi-universal Inner Silencer**

P/No.	Price
010059	¥525

\* Maximum outer diameter: 37.5mm  
\* Can be used with POSH 010050, 010051, 010052 (SR) 016050, 016051 (Estrella)  
Can also be used on Triumph/Cabton. (Cannot be used with PCM)

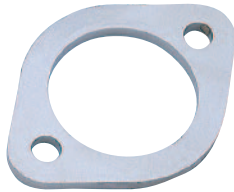

**Repair Exhaust Pipe Flange**

P/No.	Price
010050-F1	¥2,100

This is the flange included with the SR400/500 exhaust pipe 010055-5/6.  
\* Stainless steel



**Repair Muffler Band**

P/No.	Price
010050-B	¥840

This is the band included with POSH SR/GB/Estrella mufflers. Cannot be used with PCM catalytic converter equipped mufflers.

**Repair Muffler Spacer**

P/No.	Price
010050-C	¥525

This is the spacer included with POSH SR/GB/Estrella mufflers.



**Repair Muffler L Stay**

P/No.	Price
010050-L	¥378

This is the stay included with Triumph/Cabton type mufflers for SR.



**Initial Adjuster TYPE 2**

■ '86~'93			
P/No.	Color	Price	
010066-03	SILVER	¥10,290	
010066-07	BRONZE	¥10,290	
■ '94~'07			
P/No.	Color	Price	
010067-03	SILVER	¥10,290	
010067-07	BRONZE	¥10,290	



**SR400/500 (~'07) EARL'S Oil Cooler Kit**

Desc.	Price
<7 Row>	¥52,500
<10 Row>	¥54,600





This is a fenderless conversion kit that uses 25mm diameter pipe. With long holes for affixing to the frame, it can be moved back and forth up to 50mm.

### SR400/500 (~'07) Loop Pipe Fenderless Conversion Kit

P/No.	Desc.	Price
010490	Lucas tail lamp	¥11,550
010490-06	Vintage round tail lamp, black	¥12,075

### SR400/500 (~'07) Steel Flat Rear Fender

P/No.	Desc.	Price
010039-06	Black coating	¥13,440
010090-06	With mini cat's-eye tail lamp	¥19,950
010390-03	With vintage round tail lamp, chrome	¥19,950
010390-06	With vintage round tail lamp, black	¥19,950

This 6-inch wide steel flat rear fender is the standard for tracker customs. You'll have a hard time finding something else at this price already coated black.

### Mini Cat's Eye Tail Lamp Kit

P/No.	Desc.	Price
090040-90	UNIVERSAL With license plate base. * Stainless steel	¥6,510

\* Holes must be drilled in the fender to attach steel flat rear fender.



### SR400/500 (~'06) Lucas Type Tail Lamp Kit

P/No.	Price
010190	¥8,190

Has aluminum casting base and buffed finish. This tail light needs no words to explain it.

Repair parts	Price
010190-1: Bracket base	¥4,725
010190-2: Tail lamp assy	¥1,890
010190-3: Harness	¥525



### Vintage Round Tail Lamp

Lens diameter approx. 64mm

P/No.	Desc.	Price
090042-03	UNIVERSAL Chrome	¥6,510
090042-06	UNIVERSAL Black	¥6,510
090042-16	UNIVERSAL Combination	¥7,035



Lens diameter: approx. 80mm

### SR400/500 Round Tail Lamp Kit

P/No.	Price
010290	¥9,975

\*Has aluminum casting base and buffed finish. Includes middle joint harness and reflector stay.

Repair parts	Price
010290-1: Bracket base	¥5,775
010290-2: Round Tail Lamp	¥3,990
010290-4: Lens, lamp	¥630



### SR400/500 (~'07) Fenderless Tail Light Kit (CEV Type)

P/No.	Price
906105	¥12,075

\* For cafe' three seat and reflex seat. Cannot be attached with other seats.



### SR400/500 (~'07) Fenderless Tail Light Kit (Lucas Type)

P/No.	Price
906104	¥11,550

\* For cafe' three seat and reflex seat. Cannot be attached with other seats.

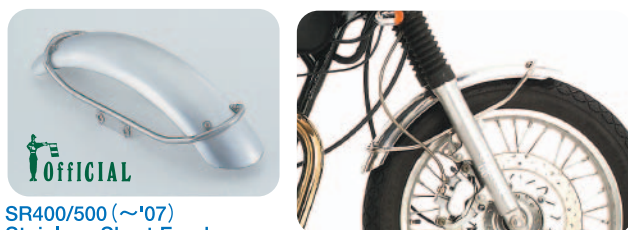

### SR400/500 (~'07) Stainless Short Fender

P/No.	Price
910116-ST	¥25,200

\* May cause interference depending on the tire used.

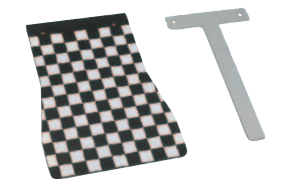

### Checked Mudflap

P/No.	Desc.	Price
010111	UNIVERSAL	¥2,310



### SR400/500 (~'07) Bolt-on Tail Lamp

P/No.	Type of tail lamp	Price
① 906101	Lucas large	¥7,875
② 906102	Lucas small	¥7,875
③ 906103	Round	¥7,875

Bolt-on tail lamp made of FRP.



### SR400/500 (~'07) Short Fender (FRP)

P/No.	Desc.	Price
010106-WG	White gelcoat	¥12,600
010106-BG	Black gelcoat	¥12,600

\* For use with stock tires.