

INSTRUCTIONS

- 1 Ensure the knob is set to the "Off" position
- 2 Slide the neoprene foam sleeve over the CO2 cartridge
- 3 Thread on the CO2 cartridge tightly to break the cartridge seal
- 4 Push the head of the CO2 inflator onto the presta valve stem / Thread the head of the CO2 inflator onto the schrader valve stem
- 5 Slowly turn the knob to "Inflate" to release CO2
- 6 Turn the knob to "Off" to stop the release of CO2
- 7 Pull / unthread CO2 inflator from the valve stem*

* CO2 inflator could be tight and hard to remove when inflator surface is frozen, please be careful when attempting to remove CO2 inflator from valve stem.

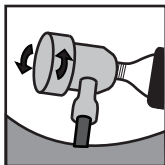
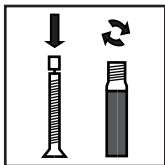
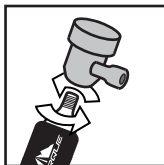

WARNING



- Do not exceed max tire pressure
- Do not point the CO2 inflator toward face/body
- Keep CO2 cartridge out of reach of children
- CO2 inflator only works with threaded cartridges
- Always use the foam sleeve and do not touch CO2 cartridge or inflator during inflation
- Do not store CO2 cartridge in temperature above 120°F
- Always empty the CO2 cartridge before removing the cartridge from CO2 inflator.