



Screen Doors

Product specifications Installation Manual



UBI carries the best standard and specialty-sized screen doors. However, we can build virtually any size screen door to meet your needs. Additionally, UBI custom builds decorator doors to add beauty and elegance to your enclosure or home. Lastly, UBI builds custom-made sliding screen doors to be used in sliding glass door environments.

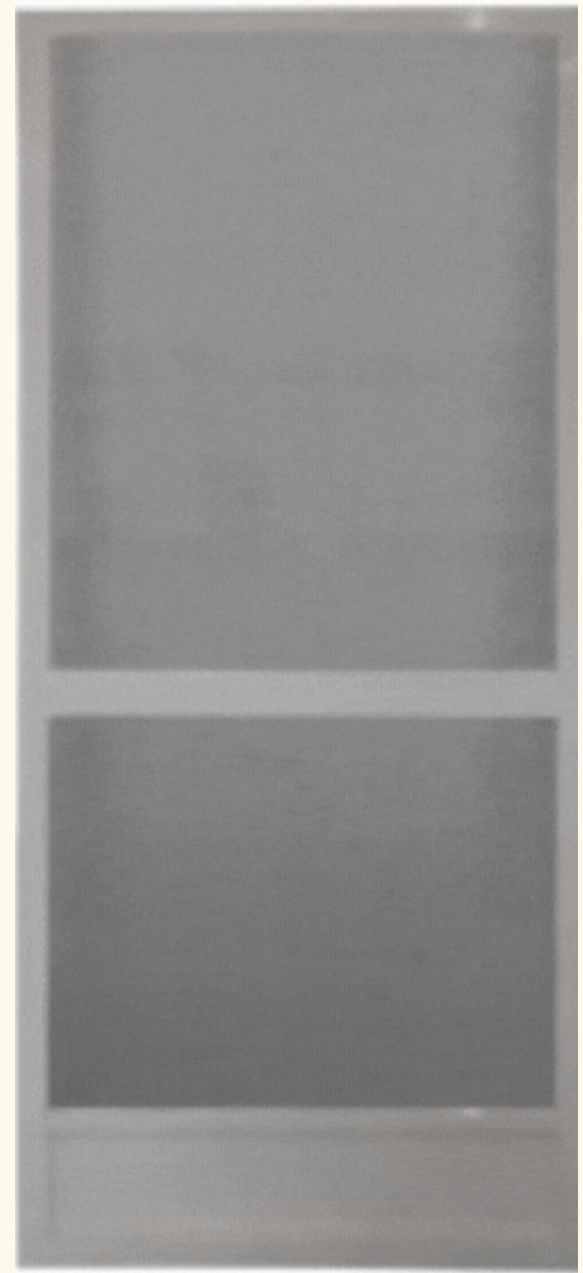

INTRODUCTION

A screen door allows you to enjoy all the sights and sounds of the great outdoors without the pesky bugs getting inside. You'll often find them constructed with wood or aluminum frames, and they generally have simple hardware and hinges. The screened opening can span most of the length of the door or just the top half.



What is Screen Doors?

A **SCREEN DOOR**, also known as a storm door or a mesh door, is a door containing mesh in the middle of a frame. It is often installed on the exterior doors to prevent insects and bugs from entering in, and also to give security to the house without obstructing the outside view and air. Basically, the mesh works as a screen to keep insects from entering, to keep your pets and children safe, and to allow proper ventilation by allowing fresh air to flow into your house.

OUR OFFERINGS

Standard Door

COLOR OPTIONS:



SIZE:

36x80, 48x80, 36x90,
48x96

Screen Mesh Type:

- 18/14 standard fiberglass mesh
- 20/20 Small Insect/No See-Um Screen
- P3 Hybrid Pool and Patio Plus Screen
- 17/14 Premium Polyester Supreme Screen
- 17/20 Premium Polyester Supreme Screen
- Specialty screen - Florida Glass
- Specialty Screen - Pet Screen
- Specialty Screen - Solar Scree

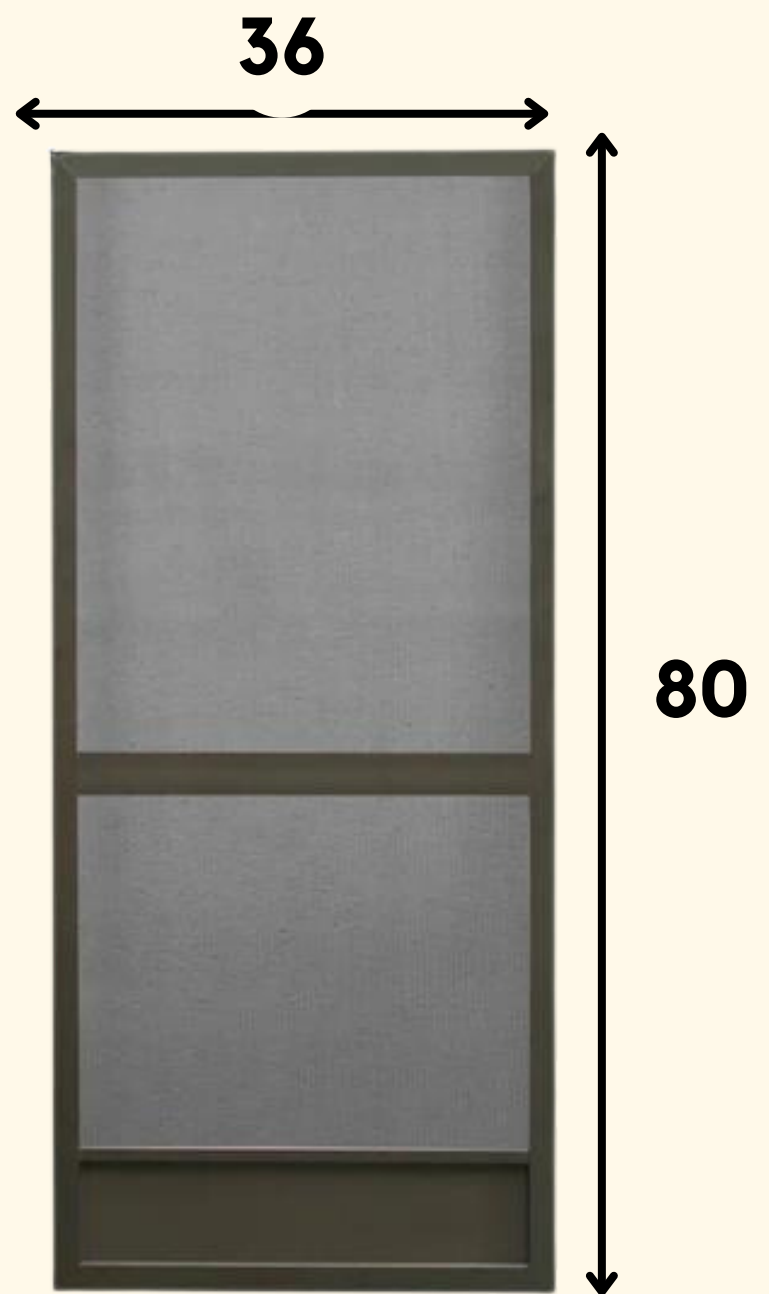

Custom Door

COLOR OPTIONS:



Door Options:

2 options: Door Blank and
Door Blank + Complete set

SIZE:

Custom doors can be
cut from top or bottom
Cannot be smaller than
16"



Insights To Customized Your Door

A Step by Step Guide

Measure Your Doorway

Measure the height of your doorway to ensure a perfect fit.

Choose You Length

Start by selecting the screen door size that fits your doorway.



We Offer Two Standard Height

80

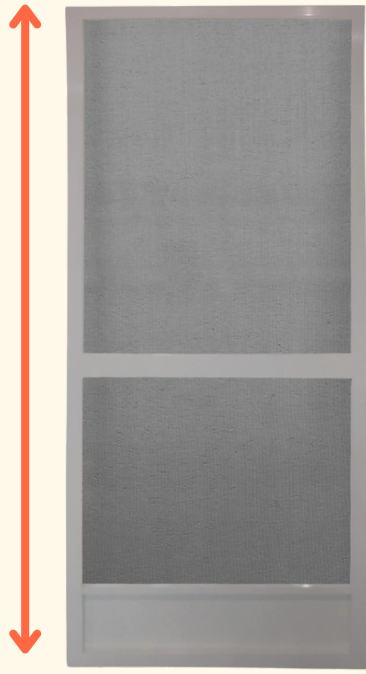

96

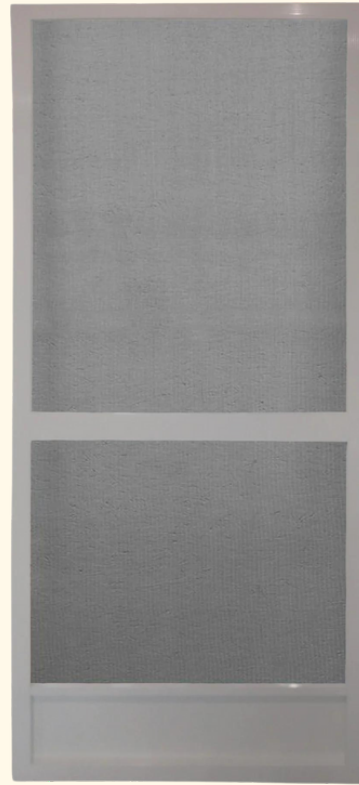

Tailor Your Screen Door To Perfection

When it comes to customizing your screen door, we understand that one size doesn't fit at all

That's why we Offer you to flexible options:

Cut From Top

Create extra space at the bottom by cutting from top. Enjoy a roomier lower section while keeping your kickplate intact.

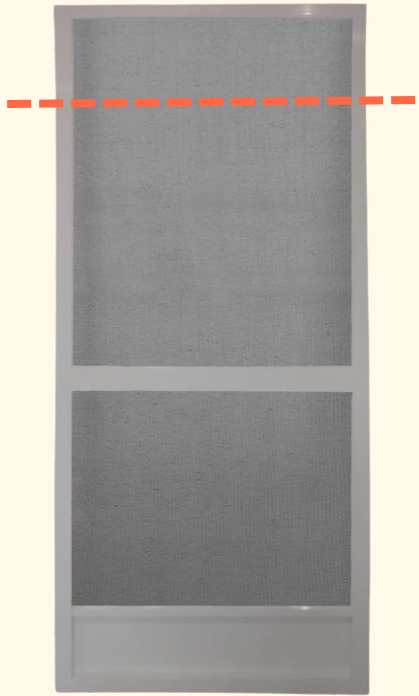

Cut From Bottom

Maximize your view by cutting from the bottom. Enjoy a sleek top with unobstructed outdoor views.

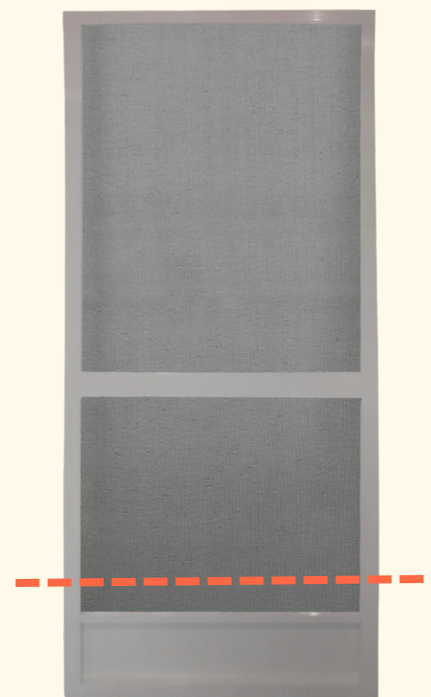

Customize Width To Fit Your Space

Customizing the width of your screen door is easy:

- Minimum Width: 36 inches
- Maximum Width: 48 inches

Achieve the perfect fit for your doorway effortlessly!

36-48

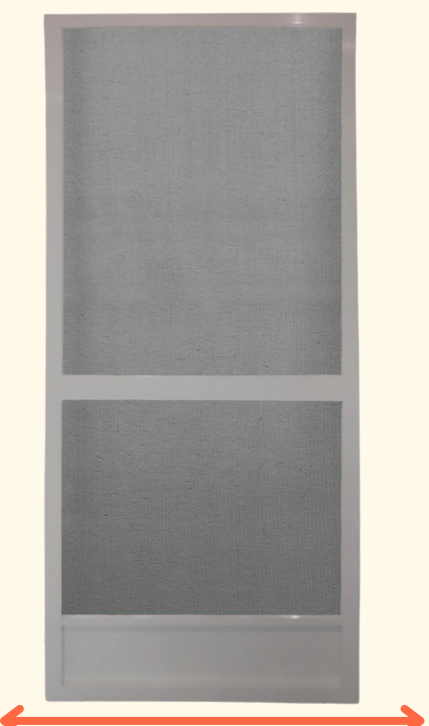

Decorative Door

COLOR OPTIONS:



Design Options:

Dolphin, Heron, Palm Tree

Hinge Position:

Left, Right

Airbrushed:

Option to select air brushed with additional charge.

SIZE:

Custom doors can be cut from top or bottom
Cannot be smaller than 16"



ACTUAL PICTURES / DESIGNER COLLECTION



Decorator Screen Doors
Plantation Collection

Single Dolphin Dolphin Flamingo

This Collection features true to life 3- Dimensional Figurines

Dolphin, Flamingo, Golfer, (Male & Female) Heron, Manatee, Marlin, Palm Tree, Pelican, Sailboat, Seahorse

Sailboat Palm Tree Double Palm Tree

Decorator Screen Doors
Plantation Collection

Single Heron Heron Manatee

Custom Airbrushing available on all figurines

Dolphin, Flamingo, Golfer, (Male & Female) Heron, Manatee, Marlin, Palm Tree, Pelican, Sailboat, Seahorse

Marlin Pelican Single Pelican

You can ask more custom design options for special orders. Delivery might take longer.

Additional Components

Button Push Lock with Key White

Push button lockout devices are used to cover and lock out buttons, switches, and other energy points to prevent unauthorized use and accidental energization.



Bug Sweep Bronze

It works by covering the gap between the door bottom and threshold. For the best protection against insects and bugs, a nylon brush sweep works better than vinyl or neoprene ones.



Screen Door Hinge Bronze

Door hinges are the hardware elements to fix a door to its frame. The hinge is the pivot point for closing or opening the door in your home or office.



Aircloser Angle Plastic Bracket

An angle bracket or angle brace or angle cleat is an L-shaped fastener used to join two parts generally at a 90 degree angle.

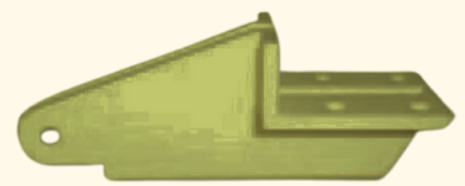

Methods for Screen Door Hinge

Hold the door in place, using blocks under the bottom to support it if necessary. Line up the two hinge plates so that the ones on the door match the ones in the jamb. Slide the hinge pins into place, and remove the blocks from the door. Test the door to make sure it works, and you're finished!

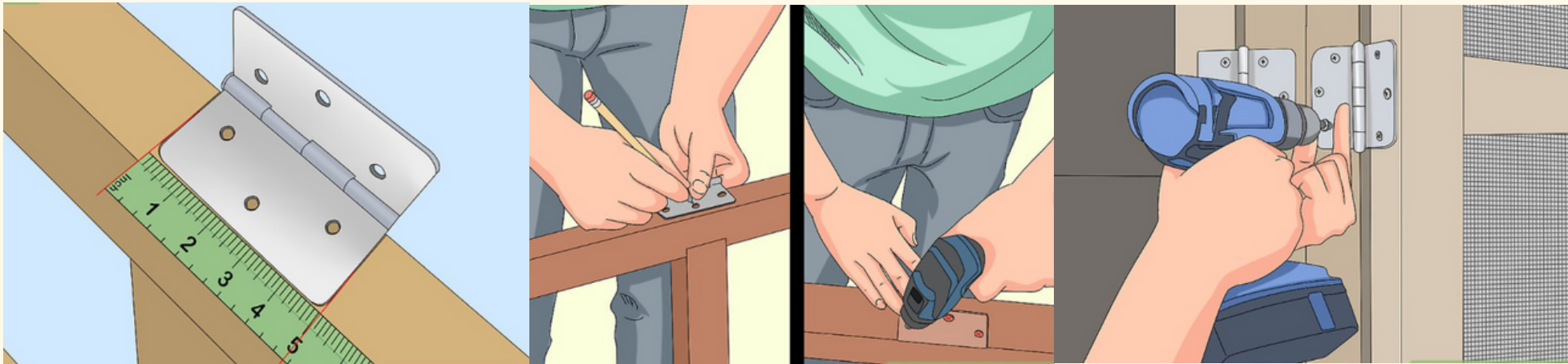

Here are some additional tips for installing Screen Door Hinge:

- Determine the General Placement of the Hinges.
- Establish the Work Area.
- Mark the Hinge Placement on the Door.
- Cut the Outline With the Knife.
- Sharpen the Chisel.
- Mortise the Hinge.
- Check the Hinge Depth.
- Install the Hinges.

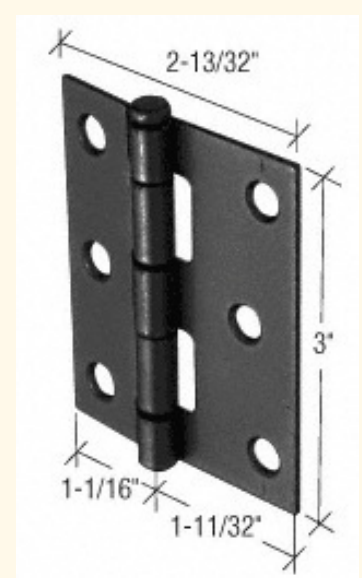
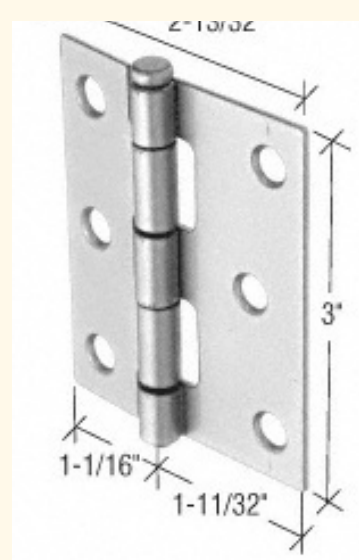

Why is Screen Doors are Important?

The No. 1 reason to add a screen door to your home is to allow more light and air into your home. With screen doors on your entryways, you can open up your home on beautiful days to let in fresh air and more light, without letting in bugs or other pests.

Promote Airflow

Screen doors use a thin mesh in their frame to create a screen that accesses the outside even when you don't open the screen door. This means you can open your inner, solid door while leaving the front door closed, which lets air flow in and out of the house through the screen. This is perfect for those warmer days when you want to cool down. Getting one door for at least two external doors means you can open both and really help air flow through your home.

Letting In Natural Light

Because of the open nature that comes with these doors, you can open the front door to let in the natural light that filters through the screen. This is great for any room, as natural light can make a place look and feel amazing. This is a great way to increase the natural lighting in your external-facing rooms without needing to create a new window in your walls.

Window to Outside

One of the most incredible benefits of installing these screen doors in your home is that you now have a window to the outside that you didn't have before. You can set up a sitting area around the screen door to easily look outside your home while staying comfortable inside. This is perfect for anyone who wants to enjoy the weather or watch their children while remaining comfortable.

Opening Up the Space

Many homes struggle to seem open as the walls can cut the place short and make it seem much smaller than you'd like. These screen doors can help alleviate this by letting you open your doors to the outside while still being indoors. This will open up the space and make your room more appealing to you and your guests. This is similar to the natural lighting that screen doors bring in, as it really makes the space look good.

Increasing the "Welcome Home" Feeling

Most people don't consider the coziness of their home when making changes to their house design, but that's a mistake. You want to live in a place where you feel welcome and safe. While it may not work for everyone, a screen door could be exactly what you need to make your house feel like a home to you. The openness of the space, extra light, and combination of nature and the indoors can make your place welcoming to you and your loved ones.

Protecting From Bugs

Another reason you should consider a screen door for your home is that it'll help protect your entire house from bugs. While these little critters can get into your home from any crack, the brief moments when you open the door can become a highway for them. That's why a screen door can be so helpful, as you let in all the good things from outside while keeping out the pests and insects that want to come into your home through an open doorway.

Stopping Light Debris

Debris is another big problem for anyone who opens their door, but a screen door can help alleviate this issue. Debris can fly into your home when you open your door, as the wind blows in small things like leaves and dirt. This can become a big hassle, and is why many people don't like to leave their doors open as you need to deal with all these small items. The screen door can catch and keep these items out of your house, preventing ongoing debris-related problems.

Better Cleanliness

Not only will the screen door help keep debris out of your house, but it'll also help with dust and dirt finding its way into your home. This is an excellent benefit as people will spend a lot of time cleaning in the summer months because of all the dirt from open doors. This way, you can enjoy the weather while keeping your home clean and saving time.

Keeping Animals Inside

Just as these doors can keep things outside, they can also keep some things inside. Screen doors are an extra barrier in your house that animals will struggle to get past without your help. This can be the difference between your dog running out of the house because of an open door or you catching it by the collar. While you shouldn't rely on these doors for the extra animal corralling, you can see it as a small obstacle that can help keep your animals safe in your home.

Improving Home Security

There are many ways you can try to improve your home security, but it's not always easy to do successfully. This is why it may seem odd that a screen door can improve it, but it can help deter criminals who want to break in. It's more difficult to access a home with a screen door when you're in a rush, and the screen itself can protect your door, which makes it harder to break in.

Increasing Door Longevity

One of the most significant benefits of using a screen door is the protection it offers to your doors. While your external doors can take a beating, storms and flying debris can make a massive impact on these doors over time. This damage will wear down your door and can cause it to break down without proper care. However, a screen door helps protect your door and extends its lifetime, which is very important for people who invest in more expensive door options.

Do-It-Yourself

How to Install Screen Door Safely

Here are the steps to follow when installing Screen Door:

- Measure the door frame
- Trim any excess with a hacksaw
- Attach your hinges to the door frame
- Match the door up to the hinges
- Secure the door in place
- Put on the top and/or bottom fittings
- Attach any other necessary hardware

FAQs

About Screen Doors Installation

1. What materials can be used for Screen Door installation?

Screens are available in various materials. Fiberglass and aluminum, however, are the most commonly used material for screen doors. A standard screen door may have an 18×16 mesh size. This means, it has 18 strands per inch in either horizontal or vertical directions and 16 strands per inch in the reverse direction.

2. How often should I do maintenance to my screens?

We recommend cleaning the screen doors once or twice a season to eliminate any small dust particles in the mesh:

3. What is your screen made of?

We use charcoal-colored fiberglass mesh in all of our screen doors. You can order any door with our standard fiberglass screen at no additional charge, or choose to upgrade to the Fiberglass Plus or Super Screen instead.