

20

19

18

17

16

15

14

13

12

11

10

9

8

7

6

5

4

3

2

1

0

1

2

3

4

5

6

7

8

9

10

11

12

13

14

15

16

17

18

19

20

1. Using tape, attach the provided template in the location you want your sound bar.

A l'aide de ruban adhésif, attachez le gabarit à l'endroit où vous souhaitez installer votre barre de son.

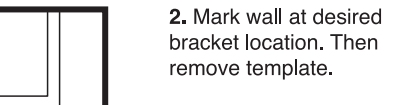

2. Mark wall at desired bracket location. Then remove template.

Marquez le mur à l'emplacement souhaité pour le support. Ensuite, retirez le gabarit.



3. Install both Hangman No Stud brackets at marked locations using provided nails and level.

Installez les deux support No Stud Hangers à l'emplacement marqué en utilisant les clous et le niveau fourni.



4. First, remove bubble level from track. Then, insert and engage both speaker bar brackets into the No Stud wall brackets.

Retirez d'abord le niveau à bulle du rail. Ensuite, insérez et accrochez les deux supports de la barre de son dans le No Stud Hanger.

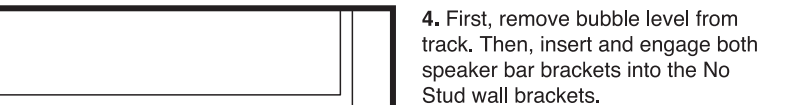

5. Place your speaker bar so that it lays across both speaker bar hangers.

Placez vos barres de son afin qu'elles soient posées sur les deux supports d'enceinte.

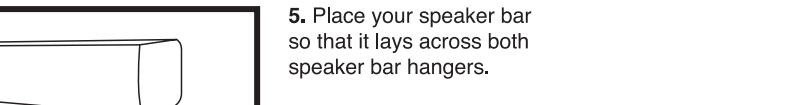

6. Enjoy! Profitez!



PLACE LEVEL CLIP HERE
Placez le niveau ici.

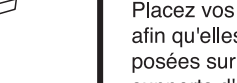

For instructional video scan here
Pour la video didactique, scannez ici.
Or call our customer service line:
Ou appelez notre service clientele
+1(818) 610-0487
LUNDI-VENRDEDI
M-F 8am-5pm

HANGMAN
www.hangmanproducts.com

NO STUD SOUND BAR SHELF™

HANGMAN®

Three Easy Steps:

(All Hardware & Level Included)

1

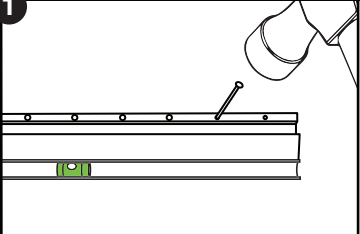

Level and attach the wall bracket using a hammer and the provided picture nails.

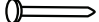

Pro-Tip
Install center nail first. Once level, install the rest.

Tools Needed:

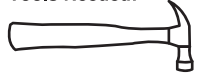

Yep, that's it.

2

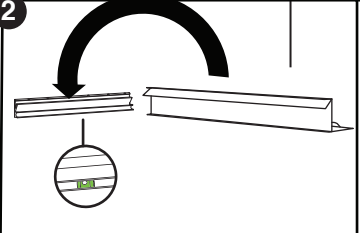

Engage the No Stud Sound Bar Shelf with the wall bracket.

Shelf Interlocks With Wall Bracket

3

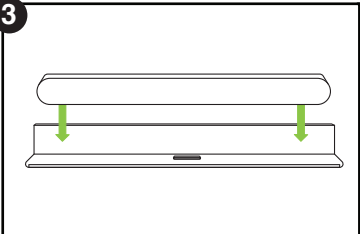

Rest your sound bar across the shelf. Easy right?

