

ERGOPIXEL

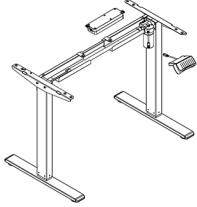

Technical data

Column Number	2
Maximum Load	70kg
Max Speed	25mm/s
Input Voltage	100-240V
Lowest Position	710mm
Highest Position	1210mm
Desktop Size	1600 (width) x 800 (depth)
Duty Cycle	Continuous operation for 2 mins at rest after power for 15 mins
Applicable Temperature	0-40°C



Part list

No.	Part	Qty	No.	Part	No.	Part	Qty
1	Handset	2	2	Left Column	1	Right Column	1
2	Supporting beam	1	3	Transmission rod	1	Side bracket	2
3	Column	2	4	Control box	1	Power cable	1
4	Baffle	2	5	Handset screw	1	Control box screw	2
5	Transmission rod	1	6	Handset screw	1	Control box screw	2
6	Handset screw	1	7	Control box screw	1	Control box screw	2
7	Control box screw	1	8	Control box screw	1	Control box screw	2
8	Control box screw	1	9	Control box screw	1	Control box screw	2
9	Control box screw	1	10	Control box screw	1	Control box screw	2
10	Control box screw	1	11	Control box screw	1	Control box screw	2
11	Control box screw	1	12	Control box screw	1	Control box screw	2
12	Control box screw	1	13	Control box screw	1	Control box screw	2

Installation instruction

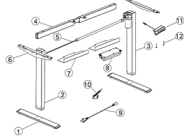

1 Install (1), (2) & (3) together, using the 5 x 5 allen key (A) to tighten the screws (E).

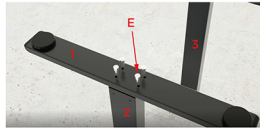

2 Unscrew the 4 screws on supporting beam (4) with the 4x4 allen key (A).

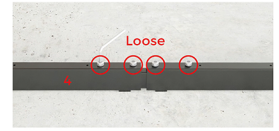

3 Pull out the supporting beam (4).

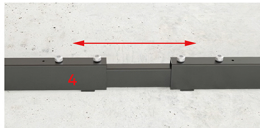

4 Install supporting beam (4) on the columns (2/3). Tighten the screws (F) with the 5x5 allen key (A).

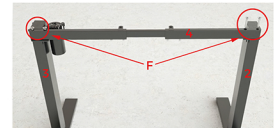

5 Loosen the screws on transmission rod (5) and insert to column (2).

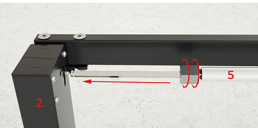

6 Rotate and insert the transmission rod to (3) and use 2.5 x 2.5 allen key (A) to tighten it.

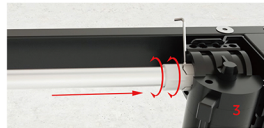

7 Connect side bracket (6) with column (3). Use the 5x5 allen key (A) to tighten the screws (C).

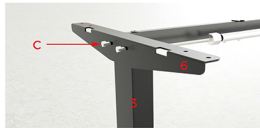

8 Connect side bracket (6) with column (2). Use the 5x5 allen key (A) to tighten the screws (C).

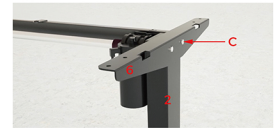

9 Attach the desktop with screws (D), the distance between supporting beam (4). Both sides shall not be greater than 200mm.

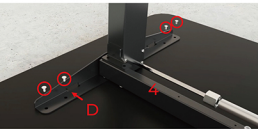

10 Install the control box (8) with screws (D) as shown in the image below.

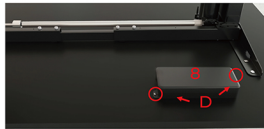

11 Install the handset (11) with handle screws (12) as shown in the image below.

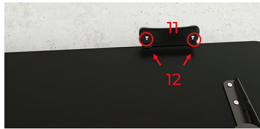

12 Tighten all screws on transmission rod (5) and attach the desktop with screws (D), the distance between supporting beam (4).

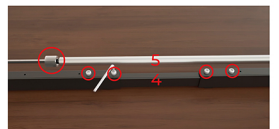

13 Install the baffle (7) on both side of the supporting beam (4) with the screws (B), and then use 2.5x2.5 allen key (A) to tighten.

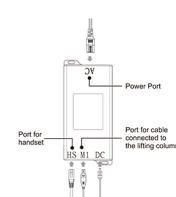
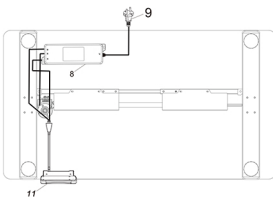
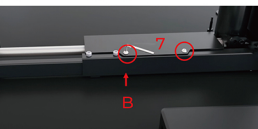

Assembly Video:



Common fault treatment

The following tips will help you detected and eliminate the common fault and error. If the error you meet is not on the list, please contact our customer service.

Error	Method
No response while pressing	Check if all the cables well connected;
The desktop moving towards the opposite direction as ordered	Reset;
Rising in a low speed	Check if overloaded, max loading: 70kg;
The desk moving downwards without any operation	Check if overloaded, max loading: 70kg;
Automatically Self-Reset	Check whether the power wire is still well connected;
Overload Operation	Restart after suspend for 18mins while connecting with power;
Can't reach the min or max height	Reset;

ATTENTION!

- Power supply: AC100V-240V/50/60Hz
- Service Environment: 0-40°C
- Unplug the power plug before cleaning, wipe the dust on surface with slight wet dishcloth when cleaning, be careful not to let the drops into the internal parts, not loose the connector.
- The electric box contains electronic components, metals, plastics, wires etc., so dispose of it in accordance with each country's environmental legislation, not the general household waste.
- Check carefully to ensure correct and complete assembly before using.
- Be familiar with all functions and program settings of the product before first use.
- Children are forbidden to play on the product because of unforeseen action when playing, so any dangerous consequences caused by this improper action will not be on manufacturers.
- Slight noise caused by the V-ribbed belt or brake system due to structure will not have any effect on the use of the equipment.
- Corrosive or abrasive materials are forbidden to clean the equipment. Must ensure that the cleaner used will not pollute the environment.
- This appliance can be used by children aged from 8 years and above and persons with reduced physical, sensory or mental capabilities or lack of experience and knowledge if they have been given supervision or instruction concerning use of the appliance in a safe way and understand the hazards involved. Children shall not play with the appliance.
- Cleaning and user maintenance shall not be made by children without supervision.
- If the supply cord is damaged, it must be replaced by the manufacturer, its service agent or a similarly qualified person in order to avoid a hazard.
- Please make sure there is no hazard sources in your operating environment. e.g., do not litter the tools around. Always be careful to treat the packaging materials in order to avoid any possible danger, e.g. plastic bag may lead to choking hazard to children.
- Keep the original package of the equipment. If necessary in case of the future use in transportation.