

PACKAGE CONTENTS

1. Chair Backrest X1
2. Seatbase & Armrests(2) X1
3. Backrest Recline Lever X1
4. 5-Star Wheelbase X1
5. M8 Allen Key X1
6. M6 Allen Key X1
7. Caster (Wheels) X5
8. Side Covers X2
9. Hydraulic Piston X1
10. M8 Screws X10
11. Lumbar Support X1
12. Neck Pillow X1

6 Slide the backrest bracket on the right side down onto the right recline bracket until it stops. Insert the M8 screws previously removed from the backrest only halfway.



10 Line up the grooves inside the lever handles with the notches and insert until it clicks into place.



CAUTION: Do not adjust the recline lever until the backrest has been securely installed. Doing so may cause the backrest spring forward.

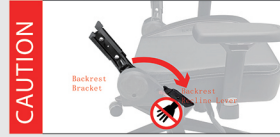

3 Turn the wheelbase the right side up and insert the hydraulics piston. Slide the hydraulics sleeve over the piston.



7 Insert the M8 screws, then tighten all 4 fully on both sides of the backrest using the long Allen key. After tightening all screws, you can attach the side cover on both side.



11 Lift up the assembled wheelbase and insert the hydraulic piston into the socket of the tilt mechanism.



1 Remove all parts from the box, while taking care to avoid the backrest recline lever and backrest bracket.



4 Tighten 3 screws on each side with M8 screws and Allen Key.



8 Lift the chair and gently set it facing downwards.



12 Carefully tilt the chair upwards while holding the wheelbase and position it upright. Congratulations! You have assembled your Ergopixel Chair!



2 Lay out the foam sheets found in the package on a flat surface. Place the wheelbase upside down on top of foam and insert the 5 casters.



5 Remove the 4 M8 screws that are pre-installed in the backrest using the hex side of the screwdriver or Allen key.



9 Attach the multi-tilt mechanism to the bottom of the seatbase using the 4 M8 screws. Ensure the mechanism is in the correct direction.



Assembly Video



USAGE INFORMATION



Backrest Recline

Pull the lever FULLY and lean back slowly until desired angle is achieved, then slowly return the lever to its starting position. Ensure the lever locks back in place.



4D Armrests

Press and hold the 1) front button to adjust front, back and angle, 2) inner side button to adjust sideways, and 3) lever on the outside of the armrest to adjust height.



Tilt Tension

Turn the knob clockwise to loosen the rocking tension of the chair, anti-clockwise to tighten. Adjust according to your weight.



Armrests Adjustment

The distance between armrests can be adjusted. Loosen the M8 screws at the bottom of the armrests and move to the desired position, then tighten to secure.



Multi-tilt Mechanism

Right lever: Pull up to adjust height.
Left lever: Push down/pull up to lock/unlock the tilt mechanism.

Warning

1. This product is a gaming chair, please do not use it for other purpose.
2. Do not step on the chair or using the chair as a ladder.
3. Do not use the chair with more than one person to avoid any danger.
4. Do not move the chair around when it is carrying heavy objects.
5. Do not put this product under high temperature environment.
6. When cleaning the chair simply use wet paper towel to wipe it.
7. Do not randomly disassemble parts such as hydraulics piston after installed.

SAFETY INFORMATION

