

Mason Assembly Instructions

Parts List:

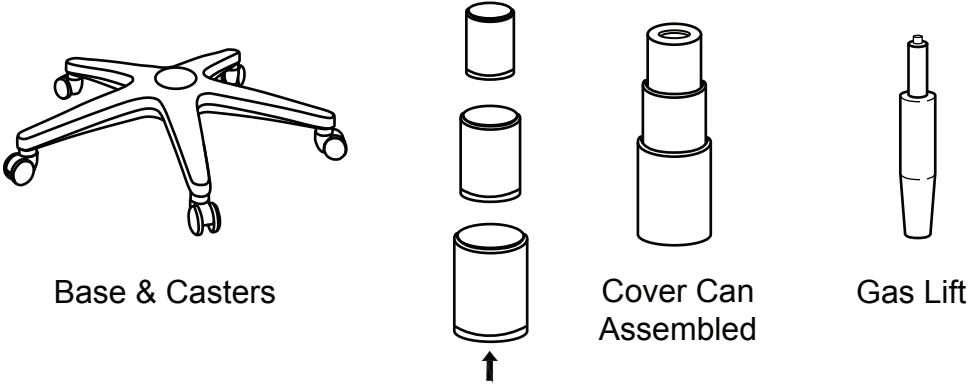

Assembly Steps:

Step 1: Insert Gas Lift into Base

The diagram for Step 1 shows the 'Cover Can Assembled' component positioned above the 'Base & Casters'. A downward-pointing arrow indicates that the gas lift assembly should be inserted into the central hole of the base.

Step 2: Attach Gas Lift to Seat

The diagram for Step 2 shows a chair seat with a wire mesh backrest positioned above the 'Base & Casters' assembly. A downward-pointing arrow indicates that the seat should be lowered onto the gas lift assembly that is already attached to the base.