



24" Washing Machine



MWM2214W

Congratulations on the purchase of your new Marathon Washing Machine!

To activate your Warranty, please register your appliance at **www.stirlingmarathon.com** or by completing and mailing the enclosed Warranty Registration Card. We are confident you will have years of hassle-free enjoyment and ask that you please retain the Use & Care Guide for future reference and your safety.

Before installing please, read your Use & Care Guide carefully and pay special attention to the Safety & Warning information outlined in the following pages.

For immediate assistance: 1-844-309-9777
www.stirlingmarathon.com

Appliance Safety

Your safety and the safety of others are very important.

We have provided many important safety messages in this manual and on your appliance. Always read and obey all safety messages.



The safety alert symbol will be followed by a signal word that calls attention to a safety message or messages or a property damage message or messages, and designates a degree or level of hazard seriousness.



DANGER

Danger indicates a hazardous situation that, if not avoided, will result in death or serious injury.



WARNING

Warning indicates a hazardous situation that, if not avoided, could result in death or serious injury.



CAUTION

Caution indicates a hazardous situation that, if not avoided, could result in minor or moderate injury.

All safety messages will alert you to what the potential hazard is, tell you how to reduce the chance of injury, and let you know what can happen if the instructions are not followed.

Disposal of your old machine



The symbol on the product or on its packaging indicates that this product may not be treated as household waste. Instead it shall be handed over to the applicable collection point for the recycling of electrical and electronic equipment. By ensuring this product is disposed of correctly, you will help prevent potential negative consequences for the environment and human health, which could otherwise be caused by inappropriate waste handling of this product. For more detailed information about recycling of this product, please contact your local city office, your household waste disposal service or the shop where you purchased the product.

Important Safety Instructions

- Do not install your machine on a carpet or such grounds that would prevent the ventilation of its base.
- Call the nearest authorized service centre for a replacement if the power cord malfunctions.
- Use only the new water inlet hose coming with your machine when making water inlet connections to your machine. Never use old, used or damaged water inlet hoses.
- Children should not play with the appliance. Cleaning and user maintenance should not be done by children without supervision.



WARNING



RISK OF BURNS

- Do not touch the drain hose or any discharged water while your Washing Machine is running. The high temperatures involved pose a burn risk.

RISK OF DEATH FROM ELECTRICAL CURRENT

- Do not connect your Washing Machine to the main electricity supply using an extension cord.
- Do not insert a damaged plug into a socket.
- Never remove the plug from the socket by pulling the cord. Always hold the plug.
- Never touch the power cord/plug with wet hands as this could cause a short circuit or electric shock.
- Do not touch your Washing Machine if your hands or feet are wet.
- A damaged power cord/plug can cause fire or give you an electric shock. When damaged it must be replaced, this should only be done by qualified personnel.
- Connect to Individual Branch-Circuit.

FLOOD RISK

- Check the speed of water flow before placing the drain hose in a sink.
- Take necessary measures to prevent the hose from slipping.
- Water flow may dislodge the hose if it is not properly secured.
- Make sure the plug in your sink does not block the plug hole.

DANGER OF FIRE

- Do not store inflammable liquids near your machine.
- The sulphur content of paint removers may cause corrosion. Never use paint removing materials in your machine.
- Never use products that contain solvents in your machine.
- Please ensure that garments loaded into your Washing Machine are free from foreign objects such as nails, needles, lighters and coins.

Important Safety Instructions

RISK OF FALLING AND INJURY

- Do not climb on your Washing Machine.
- Make sure hoses and cables do not cause a trip hazard.
- Do not turn your Washing Machine upside down or on its side.
- Do not lift your Washing Machine using the door or detergent drawer.

*** The machine must be carried by at least 2 people.**

CHILD SAFETY

- Do not leave children unattended near the machine. Children might lock themselves in the machine resulting in risk of death.
- Do not allow children to touch the glass door during operation.
- Keep packaging material away from children.
- Poisoning and irritation may occur if detergent and cleaning materials are consumed or come into contact with the skin and eyes. Keep cleaning materials out of the reach of children.



WARNING



To reduce the risk of fire, electric shock, or injury to persons when using your appliance, always follow basic precautions, including the following:

Read all instructions before using the appliance.

1. Do not wash articles that have been previously cleaned in, washed in, soaked in, or spotted with gasoline, dry-cleaning solvents, or other flammable or explosive substances, as they give off vapours that could ignite or explode.
2. Do not add gasoline, dry-cleaning solvents, or other flammable or explosive substances to the wash water. These substances give off vapours that could ignite or explode.
3. Under certain conditions, hydrogen gas may be produced in a hot-water system that has not been used for 2 weeks or more. HYDROGEN GAS IS EXPLOSIVE. If the hot-water system has not been used for such a period, before using the washing machine, turn on all hot-water faucets and let the water flow from each for several minutes. This will release any accumulated hydrogen gas. As the gas is flammable, do not smoke or use an open flame during this time.
4. Do not allow children to play on or in the appliance. Close supervision of children is necessary when the appliance is used near children.
5. Before the appliance is removed from service or discarded, remove the door.
6. Do not reach into the appliance if the tub or agitator is moving.
7. Do not install or store this appliance where it will be exposed to the weather or outdoors.
8. Do not tamper with controls.
9. Do not repair or replace any part of the appliance or attempt any servicing unless specifically recommended in the user-maintenance instructions or in published user-repair instructions that you understand and have the skills to carry out.
10. To reduce the risk of electric shock, disconnect this appliance from the power supply before attempting any user maintenance. Turning the controls to the OFF position does not disconnect this appliance from the power supply.

Important Safety Instructions

Grounding Instructions

This appliance must be grounded. In the event of malfunction or breakdown, grounding will reduce the risk of electric shock by providing a path of least resistance for electric current. This appliance is equipped with a cord having an equipment-grounding conductor and a grounding plug. The plug must be plugged into an appropriate outlet that is properly installed and grounded in accordance with all local codes and ordinances.



WARNING



Improper connection of the equipment-grounding conductor can result in a risk of electric shock. Check with a qualified electrician or serviceman if you are in doubt as to whether the appliance is properly grounded.

Do not modify the plug provided with the appliance – if it will not fit the outlet, have a proper outlet installed by a qualified electrician.

Your machine is for domestic use only. Using it for commercial purposes will void warranty.

This manual has been prepared for more than one model therefore your appliance may not have some of the features described within. For this reason, it is important to pay particular attention to any figures whilst reading the operating manual.

General Safety Warnings

- The necessary ambient temperature for operation of your Washing Machine is 15-25°C / 59-77 °F.
- Where the temperature is below 0°C /32 °F, hoses may split or the electronic card may not operate correctly.
- Please ensure that garments loaded into your Washing Machine are free from foreign objects such as nails, needles, lighters and coins.
- It is recommended that for your first wash, you select the 90°C /194 °F Cotton program without laundry and half fill compartment II of the detergent drawer with a suitable low sudsing detergent. (eg. 1/2 tbs of Persil / Forever New detergent)
- Residue may build up on detergent and softeners exposed to air for a long period of time. Only put softener or detergent in the drawer at the beginning of each wash.
- Unplug your Washing Machine and switch off the water supply if the Washing Machine is left unused for a long time. We also recommend that you leave the door open to prevent build up of humidity inside the Washing Machine.
- Some water may be left in your Washing Machine as a result of quality checks during production. This will not affect the operation of your Washing Machine. The packaging of the machine could be hazardous to children. Do not allow children to play with the packaging or small parts from the Washing Machine.

Important Safety Instructions

General Safety Warnings

- Keep the packaging materials in a place where children cannot reach them, or dispose of them appropriately.
- Use pre-wash programs only for very dirty laundry.
- **Never open the detergent drawer while the machine is running.**
- In the event of a breakdown, unplug the machine from the mains supply and turn the water supply off. Do not attempt to carry out any repairs. Always contact an authorised service agent.
- Do not exceed the maximum load for the washing program you have chosen.
- **Never force the door open when your Washing Machine is running.**
- Washing laundry containing flour may damage your machine.
- Please follow the manufacturers' instructions regarding the use of fabric conditioner or any similar products that you intend to use in your Washing Machine.
- Make sure that the door of your Washing Machine is not restricted and can be opened fully.
- Install your machine in a location that can be fully ventilated and preferably has constant air circulation.

Door emergency opening function

When the machine is running, any power cut or when the program is not yet complete, the door will remain locked.

1. Please turn off the machine. Take out the power plug from the main socket.
2. To drain the waste water, follow the instructions given in cleaning the pump filter section.
3. Pull down the emergency opening mechanism with the help of a tool and open the door at the same time.
4. Move the emergency opening handle to the open position after being closed again, if the door remains locked.

During Use

- Keep pets away from your machine.
- Please check the packaging of your machine before installation and the outer surface of the machine once the packaging has been removed. Do not operate the machine if it appears damaged or if the packaging has been opened.
- Your machine must only be installed by an authorized service agent. Installation by anyone other than an authorized agent may cause your warranty to be void.
- Only use your machine for laundry that is labelled as suitable for washing by the manufacturer.
- Your warranty does not cover damage caused by external factors such as fire, flooding and other sources of damage.
- Please do not throw away this user manual; keep it for future reference and pass it onto the next owner.

NOTE: Specifications for the machine may vary depending on the product purchased.

OVERVIEW

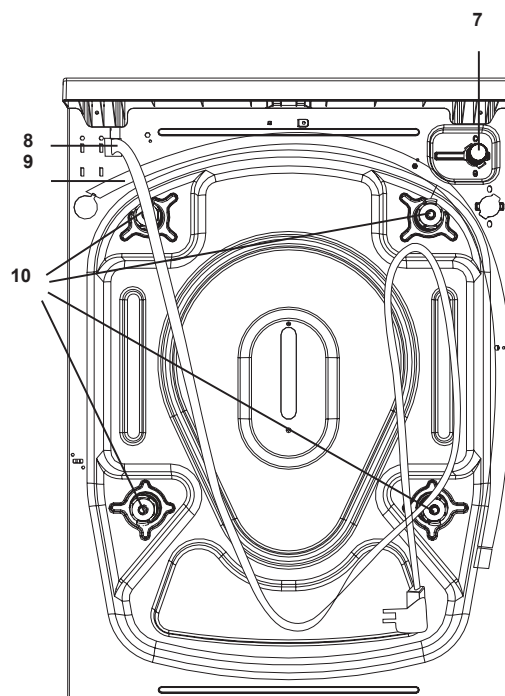
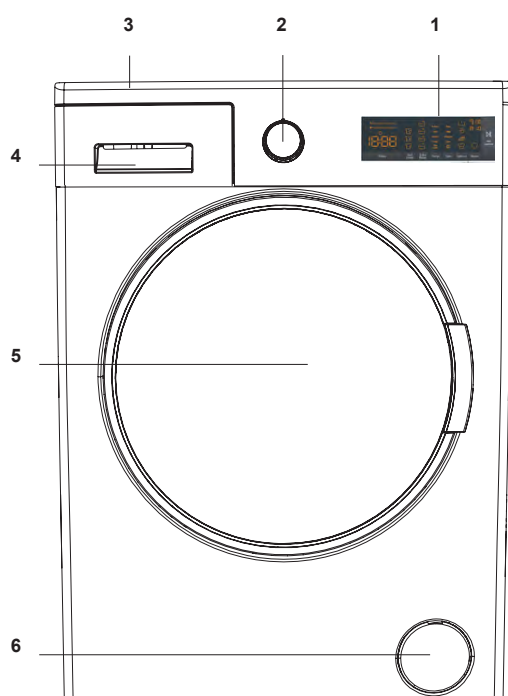

- 1. Electronic Display
- 2. Program Dial
- 3. Upper Tray
- 4. Detergent Drawer
- 5. Drum

- 6. Pump Filter Cover
- 7. Water Inlet Valve
- 8. Power Cable
- 9. Discharging Hose
- 10. Transit Bolts

Installation

Before operating the washing machine, remove the 4 transit bolts and rubber spacers from the rear of the machine. If the bolts are not removed they may cause heavy vibration, noise and malfunction of the machine and will void warranty.

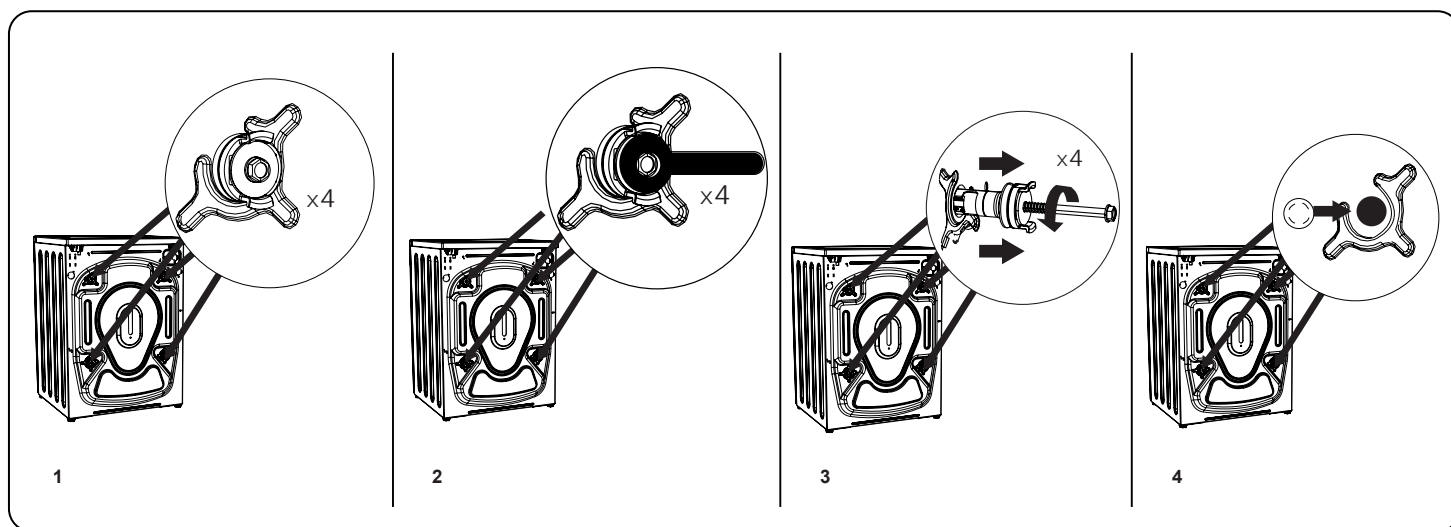

Removing the Transit Bolts

1. Loosen the transit bolts by turning them counter clockwise with an appropriate spanner.
2. Remove the transit bolts with a straight pull.
3. Fit the plastic blanking caps supplied in the accessories bag into the gaps left by the removal of the transit bolts. The transit bolts should be stored for future use.



NOTE: Remove the transit bolts before using the machine for the first time. Faults occurring due to the machine being operated with transit bolts fitted are out of the scope of the warranty.

Installation

Levelling the Appliance

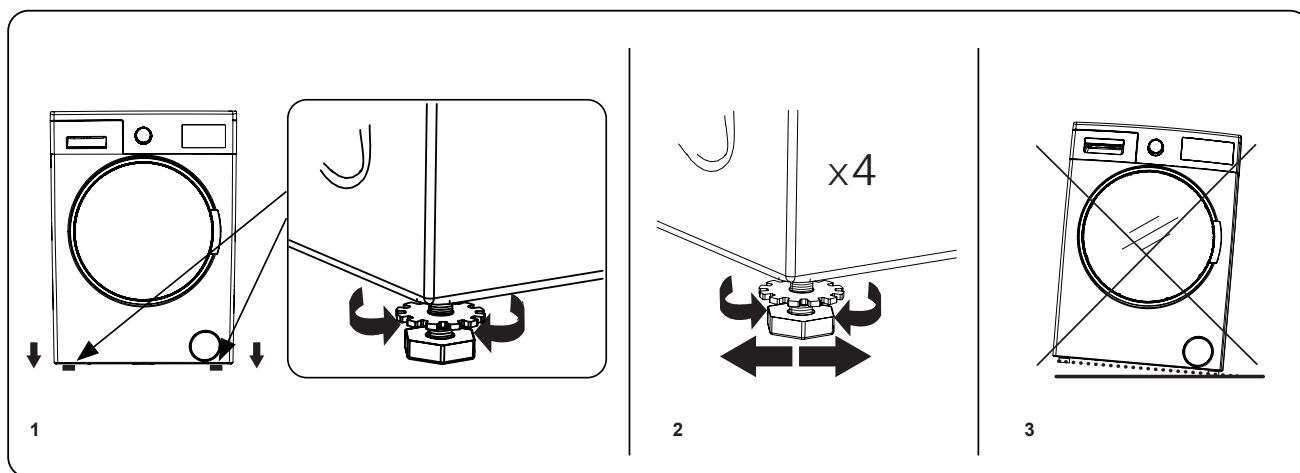

1. Do not install your machine on a surface (such as carpet) that would prevent ventilation at the base.
 - To ensure silent and vibration-free operation of your machine, install it on a firm surface.
 - You can level your machine using the adjustable feet.
 - Loosen the plastic locking nut.
2. To increase the height of the machine, turn the feet clockwise. To decrease the height of the machine, turn the feet anticlockwise.
 - Once the machine is level, tighten the locking nuts by turning them clockwise.
3. Never insert cardboard, wood or other similar materials under the machine to level it.
 - When cleaning the ground on which the machine is located, take care not to disturb the level of the machine.

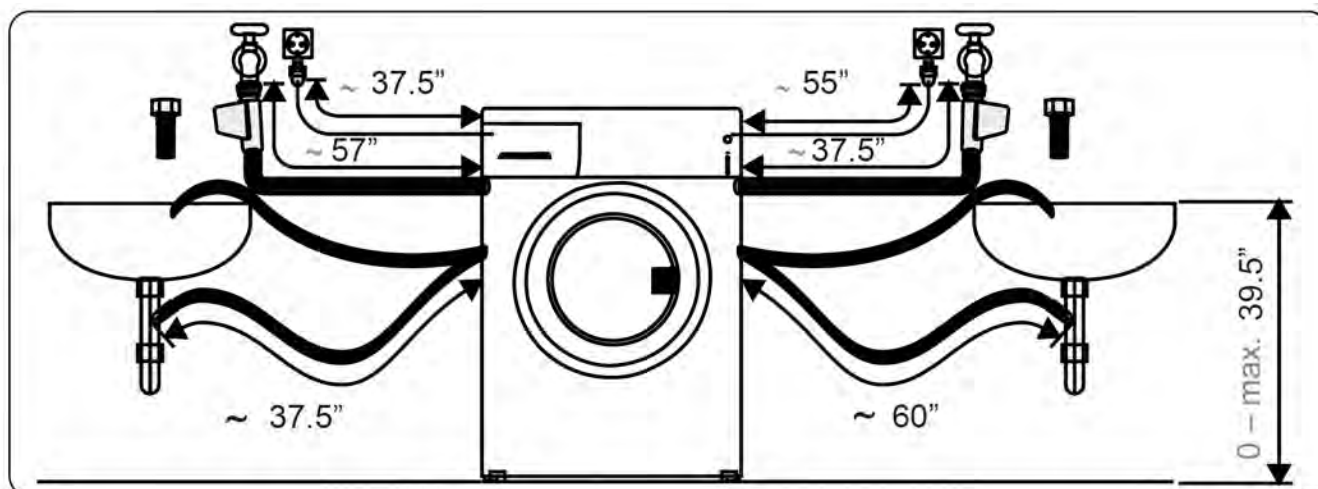

Installation

Electrical Connection

- Your Washing Machine requires a 110 -120 V ~/60Hz main supply.
- The power cord of your washing machine is equipped with an earthed plug. This plug should always be inserted to an earthed socket of 10 amps.
- If connected to a circuit protected by fuses, use time-delay fuses with this appliance.
- If you do not have a suitable socket and fuse conforming with this, please ensure the work is carried out by a qualified electrician.
- We do not take responsibility for damage that occurs due to the use of ungrounded equipment.

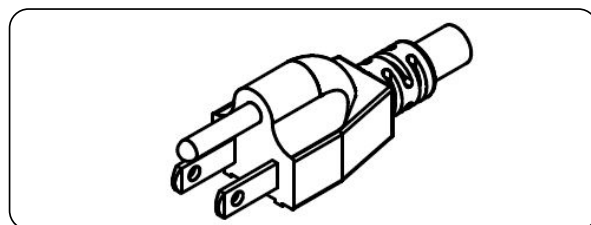

Water Inlet Hose Connection

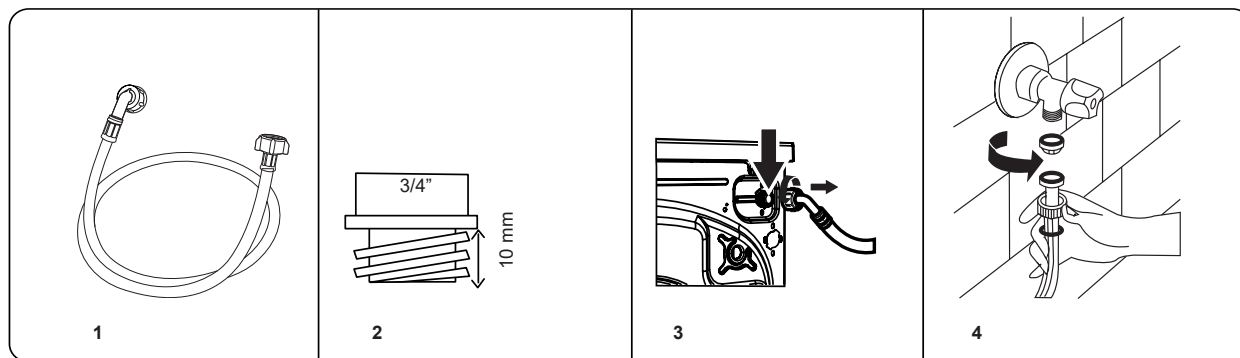

1. Your machine has a double water inlet connection (hot and cold). The red capped hose should be connected to the hot water inlet. To prevent water leaks at the joints, either 1 or 2 nuts (depending on your machine's specifications) are supplied in the packaging with the hose. Fit these nuts to the end(s) of the water inlet hose that connect to the water supply.
2. Connect new water inlet hoses to a $\frac{3}{4}$ ", threaded tap. Connect the white capped end of the water inlet hose to the white water inlet valve on the rear side of the machine and the red capped end of the hose to the red water inlet valve (if applicable).
 - Hand tighten the connections. If there is any doubt, consult a qualified plumber.
 - If your machine has a hot water inlet connection, the temperature of the hot water supply should not be higher than 70°C / 158°F.
3. Once you have made all of the connections, carefully turn the water supply on and check for leaks.
4. Ensure that the new water inlet hoses are not trapped, kinked, twisted, folded or crushed.

Installation



NOTE: Your Washing Machine must only be connected to your water supply using the supplied new fill hose. Old hoses must not be reused.

Water Discharge Connection

- Connect the water drain hose to a standpipe or to the outlet elbow of a household sink, using additional equipment.
- Never attempt to extend the water drain hose.
- Do not put the water drain hose from your machine into a container, bucket or bathtub.
- Make sure that the water drain hose is not bent, buckled, crushed or extended.

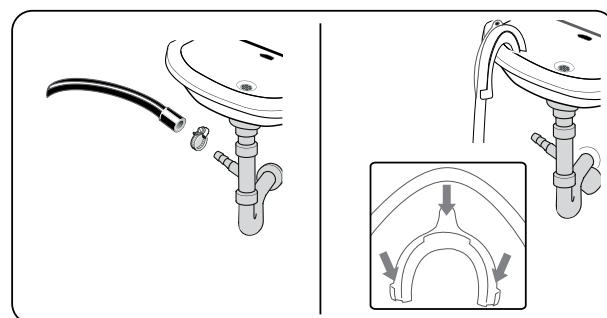

The water drain hose must be installed at a maximum height of 39.5" from the ground.

Control Panel Overview

1. Detergent Drawer
2. Program Dial
3. Electronic Display

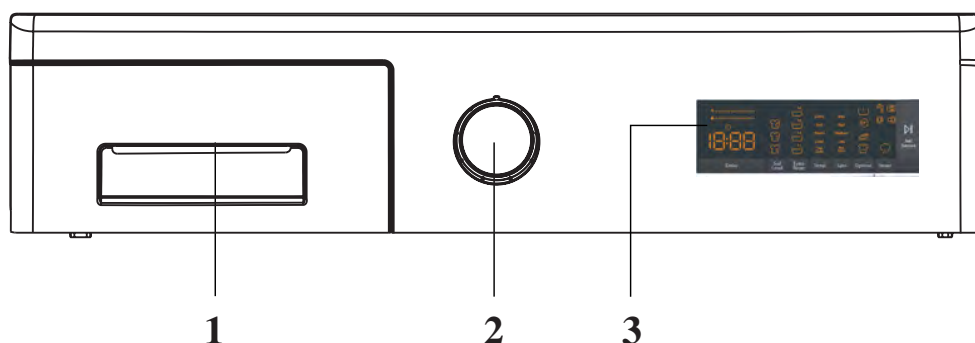

Detergent Drawer

1. Liquid Detergent Attachments
2. Main Wash Detergent Compartment
3. Softener Compartment
4. Pre-Wash Detergent Compartment
5. Powder Detergent Levels
6. Powder Detergent Scoop (*)

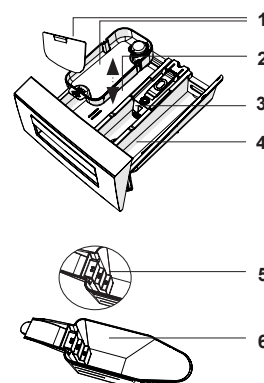
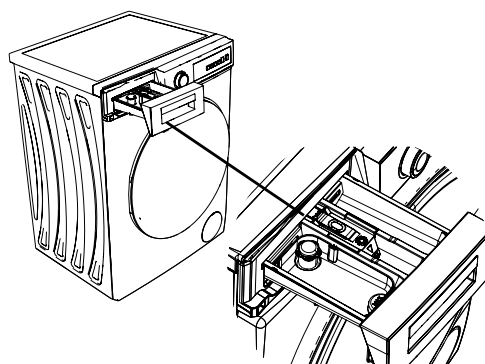

Main wash detergent compartment:

This compartment is for liquid or powder detergents or limescale remover. The fluid detergent level plate will be supplied inside your machine. (*)

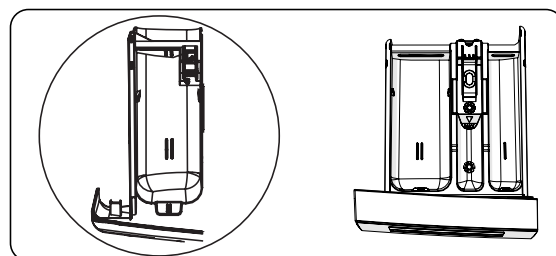

Fabric conditioner, starch, detergent compartment:

This compartment is for softeners, conditioners or starch. Follow the instructions on the packaging. If softeners leave residue after use, try diluting them or using a liquid softener.

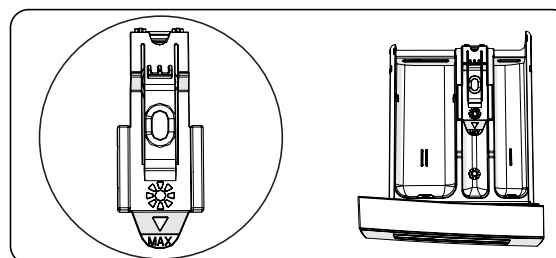

Pre-wash detergent compartment:

This compartment should be used only when the pre-wash feature is selected. We recommend that the pre-wash feature is used only for very dirty laundry.

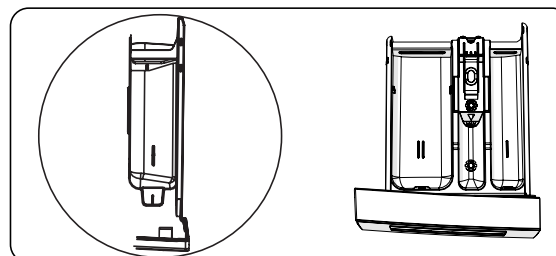

(*) Specifications may vary depending on the machine purchased.

Display

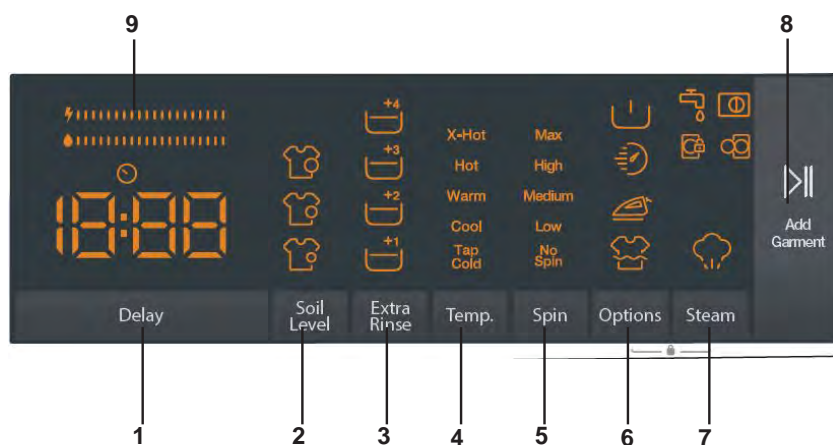

1. Delayed start auxiliary function
2. Selecting the level of soiling
3. Extra rinse auxiliary function
4. Selecting the washing water temperature
5. Spin speed selection
6. Options
7. Steam auxiliary function
8. Start Pause Button
9. Energy/Water Efficiency Bar

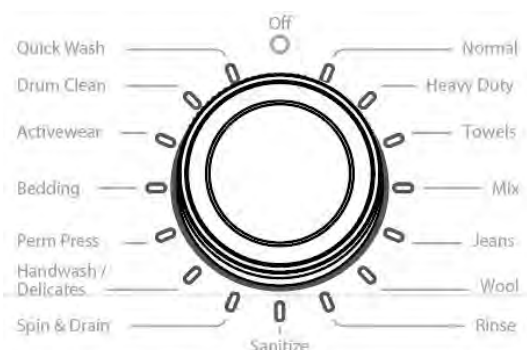

To select the desired program, turn the program dial either clockwise or anti-clockwise until the marker on the program dial points to the chosen program. Make sure that the program dial is set exactly to the program you want.

Using Your Washing Machine

Operating Instructions

1. Plug your machine in to the main power supply.
2. Turn on the water supply.
3. Open the machine door.
4. Load each item of laundry separately. Evenly spread your laundry in the machine.
5. Check that no items of laundry are trapped between the rubber seal and the door.
6. Gently push the door until it clicks shut. Make sure the door is fully closed, otherwise the program will not start.
7. Add detergent and softener in each compartment
8. Select the most appropriate program for your laundry.
9. Select Auxiliary Functions
10. Press Start button

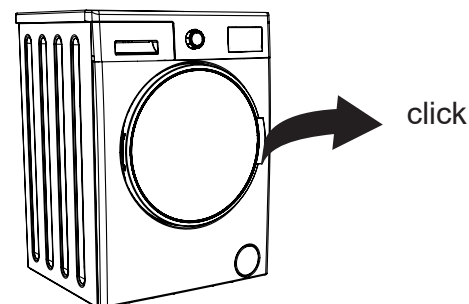





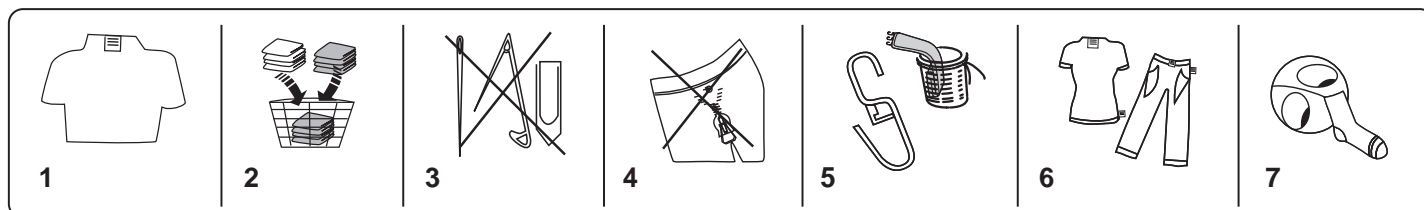







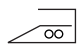

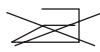
Using Your Washing Machine

Preparing Your Laundry



CAUTION: Any malfunctions which occur due to foreign materials damaging your machine are not covered by the warranty.

1. Follow the instructions given in the care labels on the clothing.
2. Separate your laundry according to type (cotton, synthetic, sensitive, wool etc.), washing temperature and the degree of dirtiness.
3. Never wash coloured and white laundry together.
4. Dark textiles may contain excess dye and should be washed separately several times.
5. Ensure that there are no metallic materials on your laundry or in the pockets; if so, remove them.
6. Close zips and fasten any hooks.
7. Remove the metallic or plastic hooks of curtains or place them in a washing net or bag.
8. Reverse textiles such as pants, knitwear, t-shirts and sweat shirts.
9. Wash socks, handkerchiefs and other small items in a washing net.

| | | | | | |
|--|--|---|--|--|--|
|  Can be bleached |  Do not bleach |  Normal washing |  Maximum ironing temperature 150°C / 302°F |  Maximum ironing temperature 200°C / 392°F |  Do not iron |
|  Can be dry cleaned |  No dry cleaning |  Dry flat |  Drip dry |  Hang to dry |  Do not tumble dry |
|  Dry cleaning in gas oil, pure alcohol and R113 is allowed |  Perchloroethylene R11, R13, Petroleum |  Perchloroethylene R11, R113, Gas oil | | | |

Using Your Washing Machine

Putting Laundry in the Machine

1. Open the door of your machine.
2. Spread your laundry evenly in the machine.

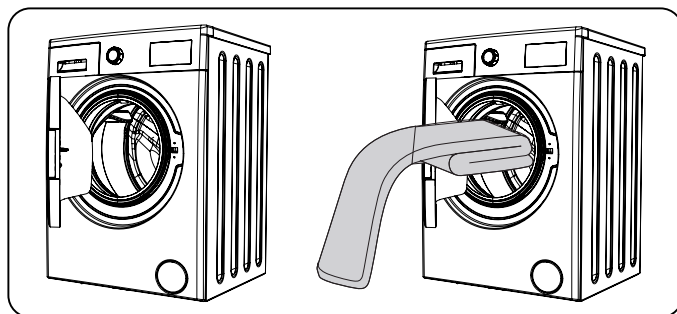

NOTE: Take care not to exceed the maximum load of the drum as this will give poor wash results and cause creasing. Refer to the washing program tables for information on load capacities. The following table shows approximate weights of typical laundry items:

| LAUNDRY TYPE | WEIGHT (gr) |
|--------------|-------------|
| Towel | 200 |
| Linen | 500 |
| Bathrobe | 1200 |
| Quilt cover | 700 |
| Pillow slip | 200 |
| Underwear | 100 |
| Tablecloth | 250 |

Half-Load Detection System

Your machine features a half-load detection system. If you put less than half the maximum load of laundry into your machine it will automatically set the half-load function, regardless of the program you selected. This will take place once the machine begins operation and adjusts the time depending on the load. This means that the selected program will take less time to complete and will use less water and energy.

Using Your Washing Machine

Use HE detergent only

Use only High Efficiency detergents. The package will be marked “HE” or “High Efficiency.” Low-water washing creates excessive sudsing with a non-HE detergent. Using non-HE detergent will likely result in longer cycle times and reduced rinsing performance. It may also result in component failure and, over time, buildup of mold or mildew. HE detergents should be low-sudsing and quick-dispersing to produce the right amount of suds for the best performance. They should hold soil in suspension so it is not redeposited onto clean clothes. Not all detergents labeled as High Efficiency are identical in formulation and their ability to reduce suds. Always follow the detergent manufacturer’s instructions to determine the amount of detergent to use.



Adding Detergent to the Machine

The amount of detergent you will need to put in your machine will depend on the following criteria:

- If your clothes are only slightly soiled, do not pre-wash. Put a small amount of detergent (as specified by the manufacturer) into compartment II of the detergent drawer.
- If your clothes are excessively soiled, select a program with pre-wash and put ¼ of the detergent to be used into compartment I of the detergent drawer and the rest in compartment II.
- Use detergents produced for automatic washing machines. Follow the manufacturer’s instructions on the amount of detergent to use.
- In areas of hard water, more detergent will be required.
- The amount of the detergent required will increase with higher washing loads.
- Put softener in the middle compartment of the detergent drawer. Do not exceed the MAX level.
- Thick softeners may cause clogging of the drawer and should be diluted.
- It is possible to use fluid detergents in all programs without a pre-wash. To do this, slide the fluid detergent level plate (*) into the guides in compartment II of the detergent drawer. Use the lines on the plate as a guide to fill the drawer to the required level.

(*) Specifications may vary depending on the machine purchased.

Using Your Washing Machine

Additional Functions

Before starting the program, you can select additional functions if you prefer.

- Press the key of the auxiliary function you want to select.
- If the symbol of the auxiliary function is continuously on in the electronic display, the selected auxiliary function will be enabled.
- If the symbol of the auxiliary function is flashing in the electronic display, the selected auxiliary function will not be enabled.

I cannot enable an additional function. Here is why:

- That additional function might not be available for the selected washing program.
- The machine might have passed the step where that auxiliary function could be applied.
- The auxiliary function might be incompatible with another auxiliary function you have previously selected.

Delayed Start Function

You can use this function to delay the start time of the washing cycle for 1 to 23 hours.

To use the delay function:

- Press the delay key once.
- "1h" will be displayed.  will turn on in the electronic display.
- Press the delay key until you reach the time after which you want the machine to start the washing cycle.
- If you have skipped the delay time you would like to set, you can keep pressing the delay key until you reach that time again.
- To use the time delay function, you need to press the Start/Pause key to start the machine.



NOTE: After selecting the delay function, you can select other functions without touching the "Start/Pause" key to enable time delay.:

To cancel the delay function

- If you did not press the Start/Pause key, keep touching the delay key until the electronic display shows the duration of the program you have selected. Once you see the program time on the electronic display, this means that the delay has been cancelled.
- If you have pressed the Start/Pause key to start the machine, you just need to touch the delay key once.  will go off on the electronic display, press "Start/Pause" key to start the washing cycle.

Using Your Washing Machine

Selecting the Soil Level

You can wash your laundry in shorter or longer durations, at lower or higher temperatures by selecting a soiling level. Soiling levels are automatically set in some programs. You can make changes at your discretion.

NOTE: If there are no changes in the level when you touch the soiling level key, it means there is no soiling level selection in the program you have selected.



Extra Rinse Function

You can use this function for extra rinsing of your laundry. To enable the extra rinse function, keep pressing the options key until the extra rinse symbol turns on. If the extra rinse LED is constantly on in the electronic display, it means that the function is selected.

NOTE: When you want to select the extra rinse function, if it does not appear on the display, this means that this feature is not available in the selected washing program.



Selecting the Water Temperature

You can use the washing water temperature setting key to set the temperature of the washing water for your laundry.

- When you select a new program, the selected program's maximum temperature will be displayed on the washing water temperature display.
- You can press the washing water temperature setting key to decrease the washing water temperature gradually between the maximum water temperature of the selected program and cold water wash.
- If you have skipped the washing water temperature you wanted to set, keep pressing the washing water temperature key to find the desired temperature again.

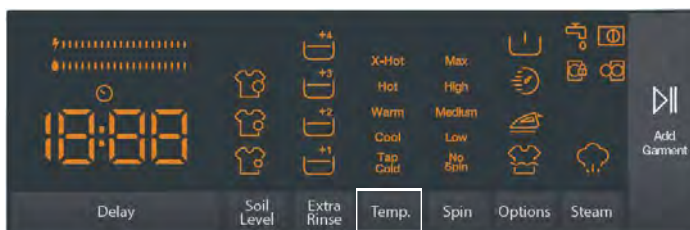

Using Your Washing Machine

Spin Speed Selection

You can use the speed setting key to set the spin speed for your laundry. When you select a new program, the selected program's maximum spin speed will be displayed on the spin speed display.

You can press the spin speed setting key to decrease the spin speed gradually between the selected program's maximum spin speed and the spin cancelled option.

If you have skipped the spin speed you wanted to set, you can keep pressing the spin speed key to find the desired speed again.



Options

You can use auxiliary functions to make the best washing selection for your laundry. To do this, you can touch the options key on the display panel to enable the following:

- Prewash auxiliary function**
- Rapid wash auxiliary function**
- Easy ironing auxiliary function**
- Rinse hold auxiliary function**



Prewash Function

You can use this function to perform a wash before the main wash cycle for your highly soiled laundry. When you use this function, you need to add detergent into the prewash dispenser of the detergent drawer.

To enable the prewash auxiliary function, press the options key until the prewash symbol turns on. If the prewash LED is constantly on in the electronic display, it means that the auxiliary function is selected



NOTE: When you want to select the prewash auxiliary function, if does not appear on the display, this means that this feature is not available in the selected washing program.

Using Your Washing Machine

Rapid Wash Function

You can wash your laundry in a shorter time, using less energy and water by selecting this function. To enable the rapid wash function, press the options key until the rapid wash symbol turns on. If the rapid wash LED is constantly on in the electronic display, it means that the auxiliary function is selected.



We recommend that you only use this option if you are washing less than half the maximum dry load for the selected program.

NOTE: If you put less than half the maximum load of laundry into your machine the half-load function will be automatically set, some of the program you selected. This means that the selected program will take less time to complete and will use less water and energy. When your machine detects half load, the symbol is displayed automatically. When you want to select the rapid wash function, if it does not appear on the display, this means that this feature is not available in the selected washing program.

Easy Ironing Function

This function allows you to have less creased clothes after washing. To enable the easy ironing auxiliary function, press the options key until the easy ironing symbol turns on. If the easy ironing LED is constantly on in the electronic display, it means that the auxiliary function is selected.



NOTE: When you want to select the easy ironing auxiliary function, if it does not appear on the display, this means that this feature is not available in the selected washing program.

Using Your Washing Machine

Rinse Hold Function

Rinse hold can be activated in programs where the soaking is needed. This has become active when the symbol on the electronic display. When this function is selected; Your machine keeps your laundry in the last rinse water. While your machine is keeping your laundry in the last rinse water, the symbol will flash on the electronic display. When you want to empty your laundry; Press the “Start / Pause” button. Your machine will empty the water in it and finish the program without spinning



NOTE: When you want to select the rinse hold auxiliary function, if does not appear on

Steam Function

Owing to the steam system ironing has become quick and as easy. The steam function penetrates and loosens the fibres, eliminates creases and leaves our clothes soft and delicate.



NOTE: When you want to select the steam system auxiliaryfunction, if does not appear on the display, this means that this feature is not available in the selected washing program.

Start/Pause button

By pressing on the Start/Pause button, you may start the program you have selected or suspend a running program. If you switch your machine to the standby mode, the Start/Pause led on the electronic display will blink.



Using Your Washing Machine

Child Lock

The Child Lock function allows you to lock the buttons so that the wash cycle you have chosen cannot be changed unintentionally. To activate child lock, press and hold button "options" and "steam" simultaneously for at least 3 seconds. "CL" will flash on the electronic display for 2 seconds when the child lock is activated.

If any button is pressed or selected program is changed by the program dial while the child lock is active, the "CL" symbol will flash on the electronic display for 2 seconds.



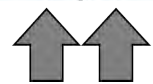

If the child lock function is active and a program is running, when the program dial is turned to the "Off" position and another program is selected the previously selected program continues from where it was left.



To deactivate the child lock, press and hold button "option" and "steam" simultaneously for at least 3 seconds until the "CL" symbol on the electronic display disappears

NOTE: Door remains unlocked in case when child lock is active and electricity is cut off.

If you want to pause/cancel a running program or add laundry:

-  symbol key allows you to pause or restart the selected program. When you want to add laundry, you can use this function.
- Touch  symbol button for this. If  is displayed on the screen, you can open the loading door and add laundry.
- If  is displayed on the screen, the step where you can add laundry has passed.
- If you want to cancel a running program, turn the program knob to "OFF" position. Your machine will stop washing process and the program will be cancelled. To drain the water in the machine, turn the program knob to any program position. Your machine will drain the water and cancel the program. You can select a new program and start the machine.

Using Your Washing Machine

Program End

Your machine will automatically stop when the selected program ends.

- “End” will appear on the electronic display.
- You can open the door and take out the laundry.

After taking out the laundry, leave the door open so that the inside of the machine can dry.

1. Turn the program knob to OFF position.
2. Unplug the machine.
3. Turn off the water tap.



Using Your Washing Machine

| Program | Washing temperature (°C) | Maximum dry laundry amount (kg / lb) | Detergent compartment | Program duration (Min.) | Laundry Type / Description |
|-----------------------|-------------------------------|--------------------------------------|-----------------------|-------------------------|---|
| (**) NORMAL | X-Hot-Hot-Warm*-Cool-Tap Cold | 10 / 22.05 | 2 | 113 | Normally soiled cotton and linen fabrics. (Underwear, linen, tablecloth, towel (maximum 5,0 kg / 11 lb), bedclothes, etc.) |
| HEAVY DUTY | X-Hot-Hot*-Warm-Cool-Tap Cold | 10 / 22.05 | 2 | 131 | Very dirty cotton and flax textiles. (Underwear, linen, tablecloth, towel (maximum 5,0 kg / 11 lb), bedclothes, etc.) |
| TOWELS | X-Hot-Hot*-Warm-Cool-Tap Cold | 5 / 11.02 | 1&2 | 113 | Dirty towel and flax textiles. (Underwear, linen, tablecloth, towel (maximum 2,5 kg / 5.5 lb), bedclothes, etc.) |
| MIX | Hot*-Warm-Cool-Tap Cold | 3.5 / 7.716 | 2 | 118 | Dirty mix fibres, synthetics, colour and flax textiles can be washed together. |
| JEANS | Warm*-Cool-Tap Cold | 3.5 / 7.716 | 2 | 100 | Black and dark items, mixed fibre or jeans wash inside out. Jeans often contains excess dye and may run during the first few washes. Wash light and dark coloured items separately. |
| WOOL | Warm*-Cool-Tap Cold | 2.5 / 5.512 | 2 | 58 | Woollen laundry with machine wash labels. |
| RINSE | Tap Cold* | 10 / 22.05 | - | 35 | Provides an additional rinse to any type of laundry after the washing cycle. |
| SANITIZE | X-Hot* | 5 / 11.02 | 2 | 200 | Baby laundry |
| SPIN & DRAIN | ** - -" | 10 / 22.05 | - | 17 | You can use this program for any type of laundry if you want an additional spin step after the washing cycle./ You can use the drain program to drain the water accumulated inside the machine (adding or removing laundry). To enable the drain program, turn the program knob to the spin/drain program. After you select "spin cancelled" using the auxiliary function key, the program will start to run. |
| HAND WASH / DELICATES | Warm*-Cool-Tap Cold | 2.5 / 5.512 | 2 | 100 | Laundry recommended for hand wash or sensitive laundry. |
| PERM PRESS | Hot*-Warm-Cool-Tap Cold | 3.5 / 7.716 | 2 | 120 | Outdoor Clothing |
| BEDDING | Hot*-Warm-Cool-Tap Cold | - | 2 | 113 | For washing a fibre duvet with a machine washable label. (max.2,5 kg 5.5 lb) |
| ACTIVEWEAR | Warm*-Cool-Tap Cold | 3.5 / 7.716 | 2 | 100 | Sportswear. |
| DRUM CLEAN | X-Hot* | - | 2 | 90 | For cleaning the drum. |
| (***) QUICK WASH | X-Hot-Hot-Warm-Cool*-Tap Cold | 2 / 4.409 | 2 | 12 | In a short time of 12 minutes, Lightly soiled, cotton, colored and linen textiles your can wash. |

Using Your Washing Machine

NOTE: PROGRAM DURATION MAY CHANGE ACCORDING TO THE AMOUNT OF LAUNDRY, TAP WATER, AMBIENT TEMPERATURE AND SELECTED ADDITIONAL FUNCTIONS.

(*) Washing water temperature of the program is the factory default.

(**) Normal program is most energy efficiency program with all wash temperature selections.

(***) Due to the short washing time of this program, we recommend that less detergent is used. The program may last longer than 12 minutes if your machine detects an uneven load. You can open the door of your machine 2 minutes after the completion of a washing operation. (The 2 minute period is not included in the program duration).



MWM2214W

User Maintenance Instructions

WARNING

To reduce the risk of electric shock, disconnect this appliance from the power supply before attempting any user maintenance. Turning the controls to the OFF position does not disconnect this appliance from the power supply. Turn your mains power supply off and remove the plug from the socket before carrying out maintenance and cleaning of your machine. Turn off the water supply before starting maintenance and cleaning of your machine.

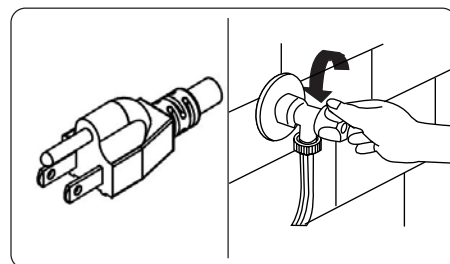

CAUTION: Do not use solvents, abrasive cleaners, glass cleaners or all-purpose cleaning agents to clean your Washing Machine. They may damage the plastic surfaces and other components with the chemicals they contain.

- Replacement of drive belt, only by authorized service.
- Only original spare belt must use.

User Maintenance Instructions

Water Inlet Filters

Water inlet filters prevent dirt and foreign materials from entering your machine. We recommend that these filters are cleaned when your machine is unable to receive sufficient water, although your water supply is on and the tap is open. We recommend that you clean your water inlet filters every 2 months.

- Unscrew the water inlet hose(s) from the Washing Machine.
- To remove the water inlet filter from the water inlet valve, use a pair of long-nosed pliers to gently pull on the plastic bar in the filter.
- A second water inlet filter is located in the tap end of the water inlet hose. To remove the second water inlet filter, use a pair of long-nosed pliers to gently pull on the plastic bar in the filter.
- Clean the filter thoroughly with a soft brush and wash with soapy water and rinse thoroughly. Re-insert the filter by gently pushing it back into place.

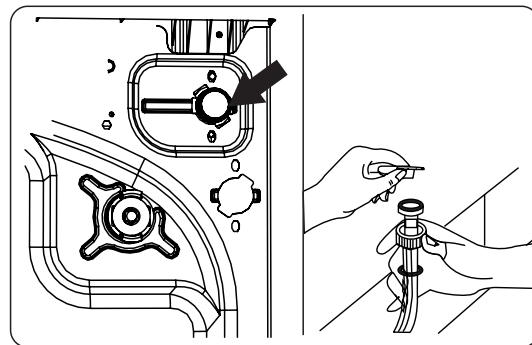

CAUTION: The filters at the water inlet valve may become clogged due to water quality or lack of required maintenance and may break down. This may cause a water leak. Any such breakdowns are out of the scope of the warranty.

User Maintenance Instructions

The pump filter system in your Washing Machine prolongs the life of the pump by preventing lint from entering your machine. We recommend that you clean the pump filter every 2 months.

The pump filter is located behind the cover on the front-lower right corner.

To clean the pump filter:

1. You may use the washing powder spade (*) supplied with your machine or liquid detergent level plate to open the pump cover.
2. Lodge the end of the powder spade or liquid detergent level plate in the opening of the cover and gently press backwards. The cover will open.
3. Before opening the filter cover, place a container under the filter cover to collect any water left in the machine.
4. Loosen the filter by turning anticlockwise and remove by pulling. Wait for the water to drain.
5. Remove any foreign materials from the filter with a soft brush.
6. After cleaning, re-fit the filter by inserting it and turning clockwise.
7. When closing the pump cover, ensure that the mountings inside the cover meet the holes on the front panel side.
8. Close the filter cover.

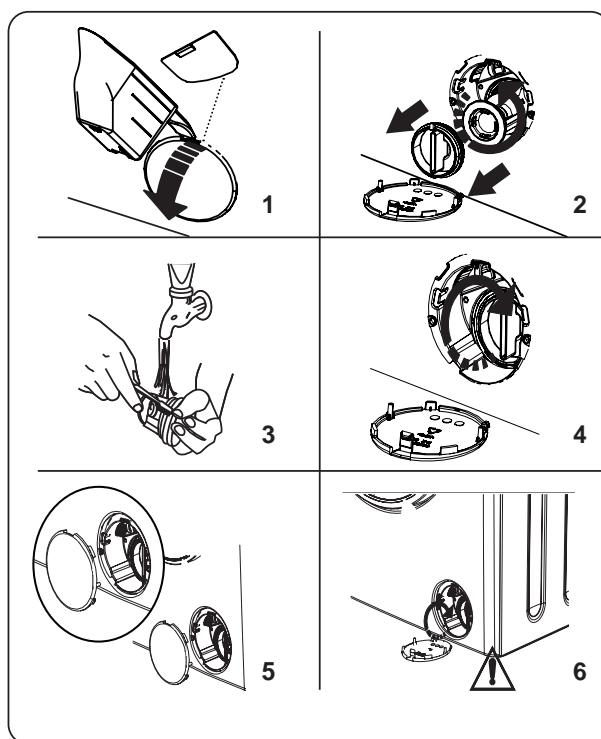

WARNING: The water in the pump may be hot, wait until it has cooled down before carrying out any cleaning or maintenance.

(*) Specifications may vary depending on the machine purchased.

User Maintenance Instructions

Detergent Drawer

The use of detergent may cause residual build up in the detergent drawer over time. We recommend that you remove the drawer every 2 months to clean the accumulated residue.

*** Do not wash your detergent drawer in a dishwasher.**

To remove the detergent drawer

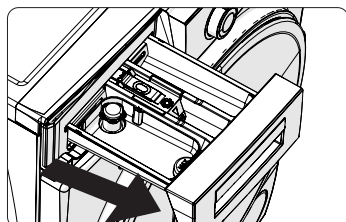

- Pull the drawer forwards until it is fully extended.
- Press the region shown below inside the detergent drawer you have pulled all the way back, and continue pulling and remove the detergent drawer from its place

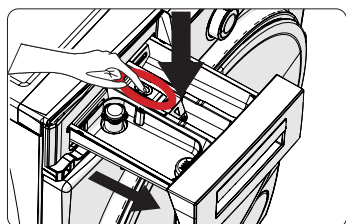

- Remove the detergent drawer and disassemble the flush stopper. Clean thoroughly to completely remove any softener residue. Refit the flush stopper after cleaning and check that it is seated properly.

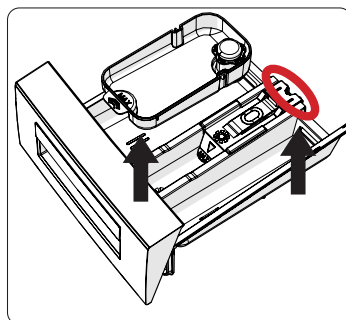

- Rinse with a brush and lots of water.
- Collect the residues inside the detergent drawer slot so that they don't fall inside your machine.
- Dry the detergent drawer with a towel or dry cloth and place it back



Liquid detergent apparatus*

For the cleaning and maintenance of the liquid level detergent apparatus, remove the apparatus from its location as shown in the picture below, and thoroughly clean the remaining detergent residues. Replace the apparatus. Make sure that no residual material remains inside the siphon.

(*) Specifications may vary depending on the machine purchased.

Automatic Fault Warnings

Your Washing Machine is equipped with a built-in fault detection system, indicated by a combination of flashing wash operation lights. The most common failure codes are shown below.

| TROUBLE CODE | POSSIBLE FAULT | WHAT TO DO |
|--|--|---|
| E01  | The door of your machine is not shut properly. | Shut the door properly until you hear a click. If your machine persists to indicate fault, turn off your machine, unplug it and contact the nearest authorised service agent immediately. |
| E02  | The water pressure or the water level inside the machine may be low. | Check the tap is fully turned on. Mains water may be cut-off. If the problem still continues, your machine will stop after a while automatically. Unplug the machine, turn off your tap and contact the nearest authorised service agent. |
| E03  | The pump is faulty or pump filter is clogged or electrical connection of the pump is faulty. | Clean the pump filter. If the problem persists, contact the nearest authorised service agent. (*) |
| E04 | Your machine has excessive amount of water. | Your machine will discharge water by itself. Once the water has drained, turn off your machine and unplug it. Turn off the tap and contact the nearest authorised service agent. |

(*) See the chapter regarding maintenance and cleaning of your machine.

Troubleshooting

You can solve many common refrigerator problems easily, saving you the cost of a possible service call. Try the suggestions below to see if you can solve the problem before calling for service.

| FAULT | POSSIBLE CAUSE | TROUBLESHOOTING |
|---|--|---|
| Your machine does not start. | Machine not plugged in. | Plug machine in. |
| | Fuses are faulty. | Replace the fuses. |
| | No mains power supply. | Check mains power. |
| | Start/Pause button not pressed. | Press the Start/Pause button. |
| | Program dial 'off' position. | Turn the program dial to the desired position. |
| | The machine door is not completely closed. | Close the machine door. |
| Your machine does not intake water. | Water tap is turned off. | Turn tap on. |
| | Water inlet hose may be twisted. | Check water inlet hose and untwist. |
| | Water inlet hose clogged. | Clean water inlet hose filters. (*) |
| | Inlet filter clogged. | Clean the inlet filters. (*) |
| | The machine door is not completely closed. | Close the machine door. |
| Your machine does not discharge water. | Drain hose clogged or twisted. | Check the drain hose, then either clean or untwist. |
| | Pump filter clogged. | Clean the pump filter. (*) |
| | Laundry is too tightly packed together in the drum. | Spread your laundry in the machine evenly. |
| Your machine vibrates. | The feet have not been adjusted. | Adjust the feet. (**) |
| | Transit bolts fitted for transportation have not been removed. | Remove the transit bolts from the machine. (**) |
| | Small load in the drum. | This will not prevent operation of your machine. |
| | Your machine is overloaded with laundry or laundry is unevenly spread. | Do not overload the drum. Spread laundry evenly in the drum. |
| | Your machine rests on a hard surface. | Do not set up your Washing Machine on a hard surface. |
| Excessive foam is formed in the detergent drawer. | Excessive amount of detergent used. | Press the Start/Pause button. To stop the foam, dilute one tablespoon of softener into 1/2 litre of water and pour into the detergent drawer. Press the Start/Pause button after 5-10 mins. |
| | Wrong detergent used. | Only use detergents produced for automatic Washing Machines. |

Troubleshooting

| FAULT | POSSIBLE CAUSE | TROUBLESHOOTING |
|--|--|--|
| Unsatisfactory washing result. | Your washing is too dirty for the program selected. | Use the information in the program tables to select the most appropriate program. |
| | Amount of detergent used insufficient. | Use the amount of detergent as instructed on the packaging. |
| | There is too much laundry in your machine. | Check that the maximum capacity for the selected program has not been exceeded. |
| Unsatisfactory washing result. | Hard water. | Increase the amount of detergent following the manufacturer's instructions. |
| | Your laundry is too tightly packed together in the drum. | Check that your laundry is spread out. |
| As soon as the machine is loaded with water, water discharges. | The end of water drain hose is too low for the machine. | Check that the drain hose is at a suitable height. (**) . |
| No water appears in the drum during washing. | No fault. Water is in the unseen part of the drum. | |
| Laundry has detergent residue. | Non-dissolving particles of some detergents may appear on your laundry as white spots. | Perform an extra rinse, or clean your laundry with a brush after it dries. |
| Grey spots appear on the laundry. | There is untreated oil, cream or ointment on your laundry. | Use the amount of detergent as instructed on the packaging in the next wash. |
| The spin cycle does not take place or takes place later than expected. | No fault. The unbalanced load control system has been activated. | The unbalanced load control system will try to spread your laundry. The spinning cycle will begin once your laundry is spread. Load the drum evenly for the next wash. |

(*) See the chapter regarding maintenance and cleaning of your machine.

(**) See the chapter regarding installation of your machine.

For any questions or concerns, please contact us at customerservice@stirlingmarathon.com or visit us at www.stirlingmarathon.com



2 Years Limited Warranty

When operated and maintained according to the instructions in the Use & Care Guide, MARATHON a registered trademark of Stirling Marathon Limited agrees to repair this product for 2 years from the date of original purchase and/or agrees to pay for parts and service/labour required to correct defects in materials or workmanship. Any Service must be approved and provided by an Authorized Stirling Marathon Service provider. YOUR EXCLUSIVE REMEDY UNDER THIS LIMITED WARRANTY SHALL BE PRODUCT REPAIR OR REPLACEMENT AT THE SOLE DISCRETION OF STIRLING MARATHON LIMITED AS PROVIDED HEREIN. This limited warranty is valid only in Canada and the Continental United States with proof of original purchase and confirmed warranty registration.

| TERMS OF WARRANTY BY PRODUCT | Capacity/Type | Warranty Type |
|------------------------------|-----------------------|---------------|
| Refrigeration & Freezer | Less than 6 cu.ft | Carry-In |
| Refrigeration & Freezer | Greater than 6 cu.ft. | In-Home |
| Washer & Dryers | All Sizes | In-Home |

How to Obtain Service

Carry-In: The original purchaser must deliver or ship the defective product to an authorized Stirling Marathon Service present a copy of the original bill of sale or Warranty Registration Confirmation.

In-Home: Contact Authorized Service Center and provide a copy of the Original bill of sale or Warranty Registration Card. If you are in a remote area or the closest Authorized Service Center is further than 100 km (60 miles), you will be required to deliver the appliance to the closest Service Center at your expense.

Stirling Marathon is not responsible or liable for any spoilage or damage to food or other contents of this appliance, whether due to any defect of the appliance, or its use, whether proper or improper.

Items Excluded from Warranty

- Damages due to shipping or improper installation.
- Damages due to misuse or abuse.
- Content losses due to failure of the unit.
- Commercial or Rental Use Limited to 90 days Parts & Labour.
- Plastic parts such as door bins, panels, door shelves, racks, light bulbs, etc.
- Punctures to the evaporator system due to improper defrosting of the unit.
- Service or Repair by a unauthorized service technicians.
- Service calls that do not involve defects in material and workmanship such as instruction on the proper use of the product, door reversal or improper installation.
- Replacement or resetting of house fuses or circuit breakers.
- Delivery costs incurred as the result of a unit that fails.
- Expenses for travel and transportation for product service if your appliance is located in a remote area where service by an unauthorized service technician is not available.
- The removal and reinstallation of your appliance if it is not installed correctly or is in an inaccessible location, as per the published installation instructions.
- Liability under this warranty is limited to repair, replacement or refund. If a replacement unit is not available or the unit cannot be repaired, liability is limited to the actual.
- Purchase price paid by the consumer.
- This warranty applies only to the original purchaser and does not extend to any subsequent owner(s) and is non-transferable.
- No warranty or insurance herein contained or set out shall apply when damage or repair is caused by any of the following: accident, alteration, abuse or misuse of the appliance such as inadequate air circulation in the room or abnormal operating conditions (extremely high or low room temperature).
- Use for commercial or industrial purposes (i.e. If the appliance is not installed in a domestic residence). Fire, water damage, theft, war, riot, hostility, acts of God such as hurricanes, floods etc.
- Service calls resulting in customer education.
- Improper installation (ie. Building-in of a free-standing appliance or using an appliance outdoors that is not approved for outdoor application).

For any questions or concerns, please contact us at
customerservice@stirlingmarathon.com or visit us at **www.stirlingmarathon.com**

V.04/2024