

CARE & CLEANING

L2

This quick reference guide is provided for informational purposes only and does not replace, modify or change in any manner the User Manual & Installation Instructions.

To ensure your washer operates as designed, follow the Care and Cleaning instructions detailed below.

CLEANING THE PUMP FILTER

NOTE: Clean the pump filter every 6 months or sooner if the washer is not draining properly.

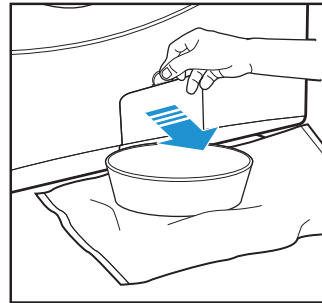

1 Open the access door by inserting a coin or screwdriver into the door notch, and then pull down the pour spout.

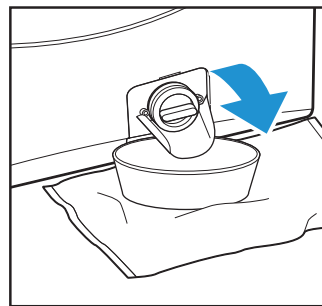

2 Place a towel and shallow container under the pump access door to protect the floor. It is normal for up to a quart of water to drain from the filter.

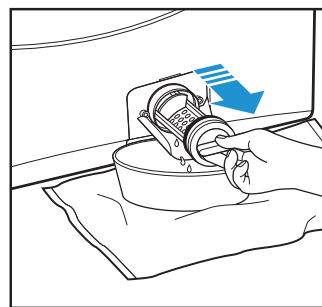

3 Turn the pump filter counterclockwise, and then pull out slowly to let the water drain.

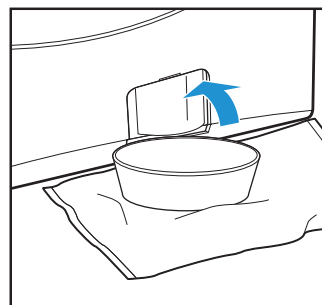

4 Clean the debris from the filter.

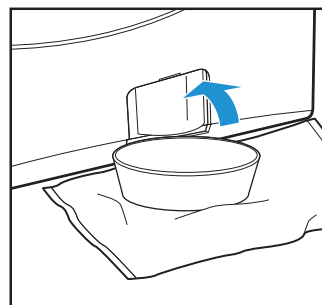

5 Replace the filter by pushing in firmly and turning clockwise until tightened.



6 Flip up the pour spout and close the access door.

CLEANING THE WASHER INTERIOR

1 Remove any garments or objects from the washer and make sure the tub is empty.

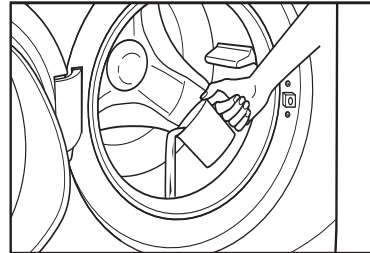

2 Open the washer door, and then pour one cup (250 ml) of liquid bleach or other washing machine cleaner into the tub.

3 Close the door, and then select the Tub Clean cycle.

4 Push the START button.

5 After the cycle is complete, leave the washer door ajar for ventilation.

NOTES:

- The Tub Clean cycle takes about 90 minutes to complete. During the Tub Clean cycle, the time remaining will appear in the display.
- Do NOT interrupt the cycle.

Tub Clean may be interrupted by pressing the START/PAUSE button in between cycles. When interrupted, be sure to run a complete Tub Clean cycle before using the washer.

For more information on the Tub Clean feature, refer to your User Manual & Installation Instructions.

CLEANING THE DOOR GASKET

1 Open the washer door.



2 Press down on the door gasket and pull down on the interior gasket with your fingers.

3 Remove any foreign objects trapped inside the interior gasket.

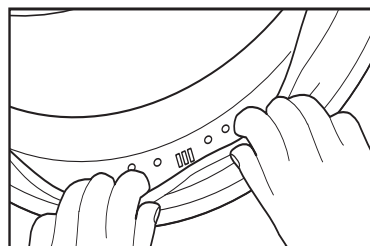

4 When finished cleaning, release the gasket to return to operating position.

NOTE: Make sure nothing is blocking the holes behind the gasket.

YOUR FRONT LOAD WASHER

L2

FRONT LOAD WASHERS - THE FACTS

There is not enough water to properly wash my clothes.	MYTH	Significantly less water is required to thoroughly wash and rinse each load, because front load washers do not require the tub to fill with water. You will NOT see a visible water line on the washer door glass except during certain cycles like "Hand Wash" and "Tub Clean."
My frontload washer may add time or run longer than the original displayed time.	TRUE	It is normal operation for the washer to add time to the cycle to rebalance the load and reduce vibration. Common causes of out-of-balance loads resulting in longer cycle times are a clogged pump filter (see Cleaning the Pump Filter), unlevel legs, or overloading the washer.
I should see suds/foam during a wash cycle in the front load washer	MYTH	HE detergents have been formulated to clean effectively without causing a buildup of suds. If you add detergent until a visible suds level is reached, you may be using too much detergent and negatively impacting washer performance. REMEMBER , use only HE detergents in your front load washer, and more suds does not equal more cleaning power. Follow the instructions on the HE detergent label.
It is best to wash full loads and like fabrics together.	TRUE	Wash multiple similar garments at one time for best results. Washing single items can cause an out-of-balance condition.
I need to keep the washer level for proper operation and to reduce vibration.	TRUE	If the washer is not level, adjust the leveling legs so that they are firmly touching the floor, and tighten the lock nuts. Leveling is especially important if the washer is installed on a pedestal. Leveling the legs on the washer or the pedestal requires the same steps.
It is impossible to overload a frontload washer.	MYTH	Although a frontload washer allows for larger loads than a top load washer, do NOT overload the wash basket. The wash drum may be fully loaded with LOOSELY added items. Overloading the washer can lead to reduced wash performance and clothes becoming trapped between the door glass and the gasket, possibly causing damage to the gasket or your clothes.
If not regularly cleaned, my wash basket and gasket may not smell fresh.	TRUE	This is true for all washers, not just frontload. Regularly run a Tub Clean cycle and clean around the rubber door gasket. When not in use, leave the door slightly ajar for the inside of the washer to air dry. Close supervision is necessary if this appliance is used by or near children. See the "Cleaning the Interior of the Washer" and "Cleaning the Door Gasket."
Frontload washers have a "pump filter" that needs to be cleaned periodically.	TRUE	Due to the nature of the frontload washer, it is possible for small articles to pass to the drain pump. The washer has a filter to capture lost items so they do not damage the drain pump. To retrieve lost items, clean out the pump filter. See the "Cleaning the Pump Filter." Indicators of a clogged pump are long drain and cycle times, wet clothes at the end of a cycle, incomplete cycles or washer pausing in the middle of a cycle.
I cannot add items to a wash cycle once it has started.	MYTH	To add items after the washer has started, press START/PAUSE and wait until the door is unlocked. The drain pump may run briefly before door is unlocked. Do not try to force open the door when it is locked. After the door unlocks, open slowly. Add items, close the door and press START/PAUSE to restart.
Items left in pockets can cause damage to the rubber door gasket.	TRUE	This is true for all front load washers. Remove all loose items from your clothes.



DO NOT DISCARD. RETAIN FOR FUTURE USE.

QUICK INSTALLATION GUIDE

L2

This quick reference guide is provided for informational purposes only and does not replace, modify or change in any manner the User Manual & Installation Instructions.

⚠ WARNING

For your safety

- To reduce the risk of fire, electric shock, or injury to persons when using or installing the product, read and obey all safety information provided in the User Manual & Installation Instructions that accompanied the product.
- Do not install or store appliance in an area where it will be exposed to dripping water or outside weather conditions. See Location of Your Washer section in the User Manual & Installation Instructions.
- **NOTE:** This appliance must be properly grounded and installed as described in these steps and the User Manual & Installation Instructions. Electrical service to the washer must conform with local codes and ordinances and the latest edition of the national Electrical Code, ANSI/NFPA 70.

1 UNPACK YOUR WASHER

Parts supplied



Cable Tie



Screen Washers (2)

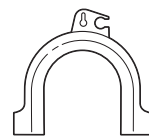

hose guide

Tools needed

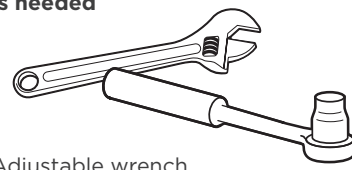

Adjustable wrench or 1/2" socket with ratchet

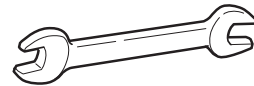

Adjustable wrench or 3/16" open-end wrench

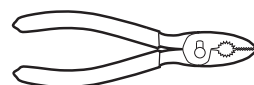

Channel-lock adjustable pliers



Carpenter's level

2 REMOVE SHIPPING HARDWARE

IMPORTANT: Save all bolts and spacers for future use.

1. Once the washer is within 4 feet of its final location, use an adjustable or 1/2" socket wrench to remove the following from the back of the washer:
 - 4 shipping bolts
 - 4 plastic spacers (including rubber grommets)
 - 4 power cord retainers
2. Insert the hole caps into the bolt holes after the shipping bolts and spacers have been removed.

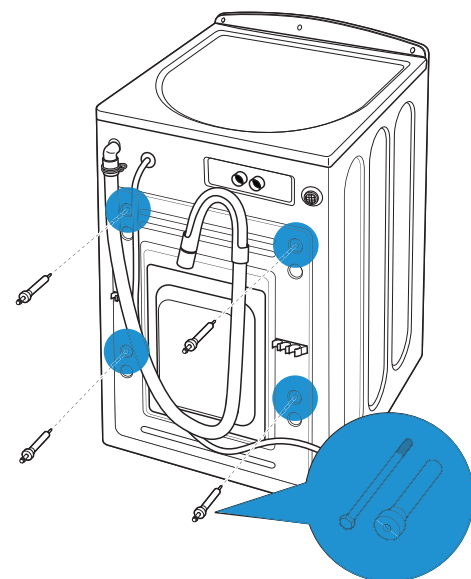

QUICK INSTALLATION GUIDE CONT.

L2

3 CONNECT HOSES TO WASHER

1. Run water from both faucets to flush the lines and remove particles that might clog the water valve screens.
2. Ensure that a rubber washer is in the end of the hot and cold hoses.
3. Connect the inlet hoses to the hot "H" outlet and cold "C" outlet.
4. Hand-tighten, and then tighten the connections another 1/8 turn using pliers.

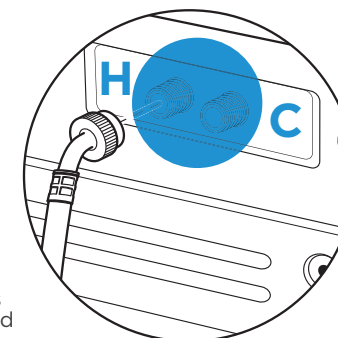

4 CONNECT HOSES TO WATER SUPPLY

1. Ensure that a screen washer is inserted into the faucet end of both hoses. If a rubber washer is already inserted, remove before inserting screen washer.
2. Connect the inlet hose from the "H" outlet to the hot faucet and the inlet hose from the "C" outlet to the cold faucet.
3. Hand-tighten, and then tighten the connections another 1/8 turn using pliers.
4. Turn on the water and check for leaks.

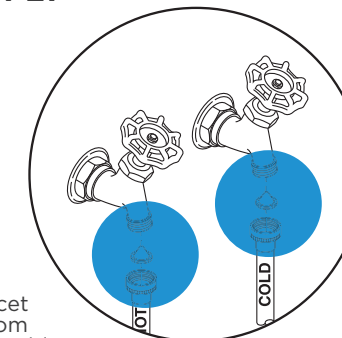

5 LEVEL YOUR WASHER

1. Rock the washer into final location, ensuring inlet hoses do not become kinked.
2. Place level on top of washer.
3. Adjust the front leveling legs up or down using a 3/16" wrench.
4. Level washer both side-to-side and front-to-back.
5. Turn lock nuts on leveling legs up toward the base of the washer, and then tighten with the 3/16" wrench.

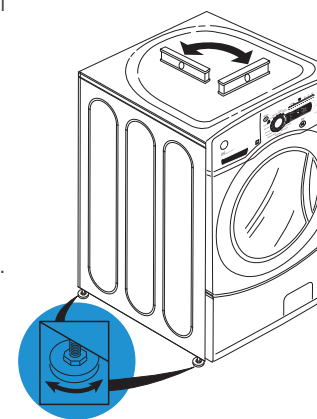

6 INSTALL DRAIN HOSE AND CONNECT TO POWER SUPPLY

1. Attach U-shaped hose guide to end of drain hose.
2. Place drain hose in laundry tub or standpipe and secure with cable tie.
3. Plug washer into a grounded outlet. Do not use an extension cord or adapter plug.

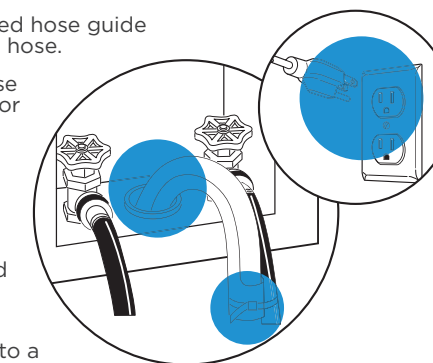

7 INSTALLATION CHECKLIST

- Main power is turned on.
- The washer is plugged in.
- Water hoses are connected securely.
- Faucets are turned on.
- Washer is level and all legs are on the floor.
- Shipping bolts and spacers are removed.
- Drain hose is placed in tub or standpipe and secured with a cable tie.

8 TEST CYCLE

1. Wash a load of clothes in the SPEED WASH cycle.
2. Check for leaks.
3. When the load is spinning at high speed, make sure the washer and leveling legs are stable.
4. If necessary, adjust the front leveling legs while the washer is in the spin cycle until the washer is level.