

OA29OPT1

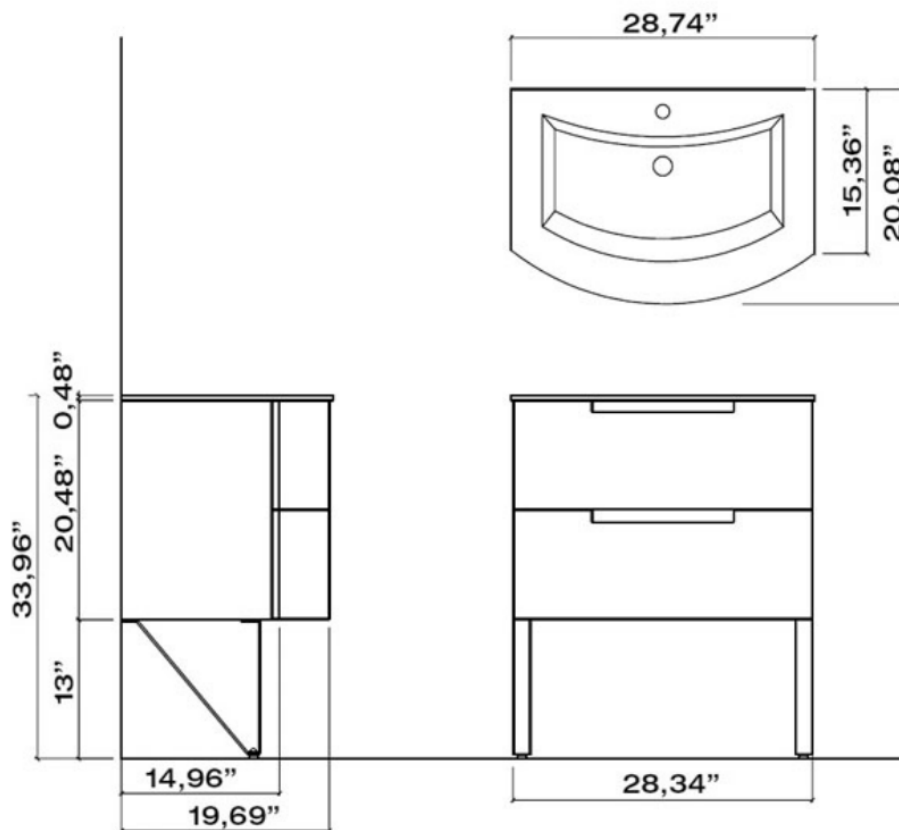

Oasi 29" Vanity
28.74" x 20.08" x 20.96"
WT: 91LBS
Includes: L035 (vanity), LV047 (sink)

SPECIFICATION SUBMITTAL



Bath/Vanities

OA29OPT1

Oasi 29" Vanity

STANDARDS

- Compliant with ASME A112.18.1-B125.1
- Compliant with AB1953
- Compliant with ANSI NSF61 – Annex G
- Certified by CSA International
- Compliant with ANSI A117.1

Finishes	OA29OPT1B	OA29OPT1W	OA29OPT1R	OA29OPT1G	OA29OPT1T	OA29OPT1S
Black Glossy	X					
White Glossy		X				
Red Glossy			X			
Grey Glossy				X		
Slate Glossy					X	
Sand Glossy						X

Features	OA29OPT1B	OA29OPT1W	OA29OPT1R	OA29OPT1G	OA29OPT1T	OA29OPT1S
Two (2) Soft Close Drawers	X	X	X	X	X	X
Tekorlux Sink Top With Overflow	X	X	X	X	X	X
Wall Mounted Unit (hardware included)	X	X	X	X	X	X
Legs Available OA-AM-LEGS (sold sep.)	X	X	X	X	X	X
Step-by-Step Installation Instructions	X	X	X	X	X	X
Limited Lifetime Warranty	X	X	X	X	X	X

1-866-668-6690
 1571 MAIN RD
 NEWFIELD, NJ 08344

www.paini-usa.com

