

BOCCHI
IL BAGNO PER TUTTI

EN WALL HUNG WC PAN INSTALLATION GUIDE BOOK (Hidden installation-From side)

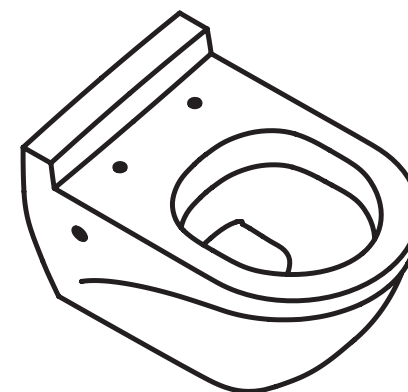

EN WALL HUNG WC PAN INSTALLATION GUIDE BOOK

"Parts 1 and 2 are mounted on the product at the factory."

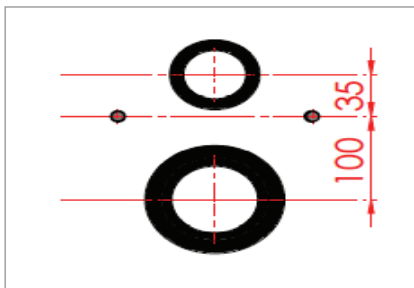

Figure-1:

WARNING :

- ◆ THE DISTANCE BETWEEN THE INSTALLATION HOLES SHOULD BE 180 mm.
- ◆ THE DISTANCE BETWEEN CENTER OF THE INSTALLATION HOLES AND CENTER OF THE WATER INLET HOLE MUST BE 35 mm.
- ◆ THE DISTANCE BETWEEN CENTER OF THE INSTALLATION HOLES AND CENTER OF THE WATER OUTLET HOLE MUST BE 100 mm.

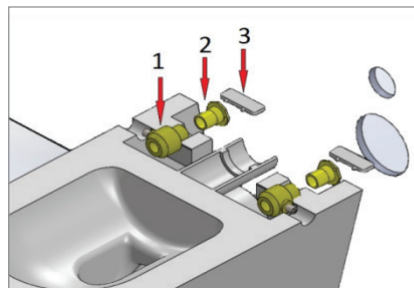

Figure-2:

Tighten parts no:1 and no:2 that are placed in the installation holes by using the wrench no:3.

*NOTE: some models will have a vertical bolt orientation rather than an horizontal one. In these cases, no: 1 goes in first (closest to the floor)

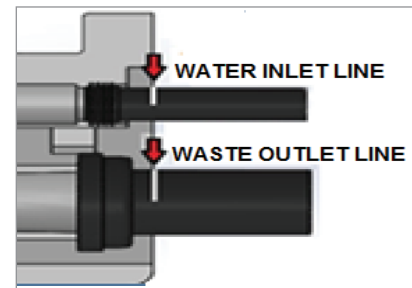

Figure-3:

Place water inlet and drain outlet pipes on the corresponding holes on the toilet body. Mark the pipes on the point where they meet the toilet body.

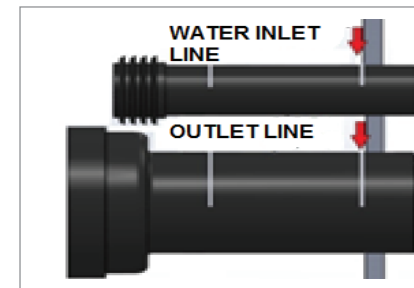

Figure-4:

Water inlet and drain outlet pipes are placed into the installation holes on the wall. Mark the points on the both pipes where they meet the wall.

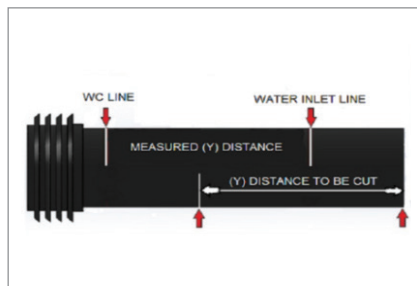

Figure-5:

Measure the distance between the two marks on water inlet pipe (Y) and cut this length from the end of the pipe as shown in the picture. Thereby preparing the pipe for installation.

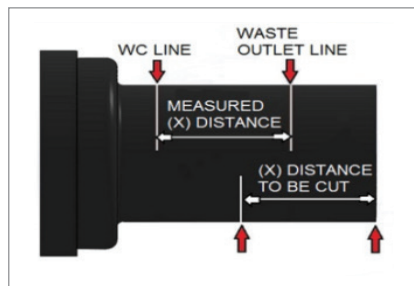

Figure-6:

Measure the distance between the marked lines of the outlet pipe (X). Use this measurement to cut the pipe from the end of it as shown in the picture so that it will be the exact size needed for the installation

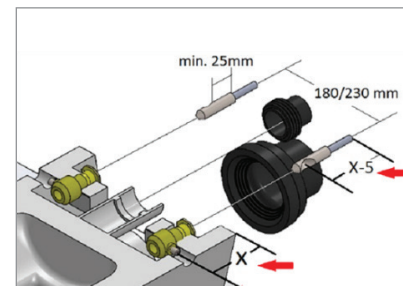

Figure-7:

Measure the distance on the WC pan which is marked as (X) in the picture. Adjust the mounting screw so that the center of the head piece is 5 mm. less than the measured distance (X-5).

WARNING : IN ORDER TO ACHIEVE A LEAK-PROOF CONNECTION NO SILICON SHOULD BE APPLIED TO THE SEALING GASKETS.

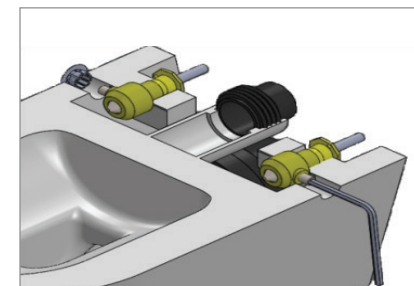

Figure-8:

Put the toilet in its place as shown above. Place the allen wrench at the hole. Finalize the installation by tightening the screws on the pivot bolt*.

NOTE: some models will have a vertical orientation to the pivot bolts but the tightening process will be the same.