

New

Furo SL Walk-in

The product in other colour variants can be found on p. 80

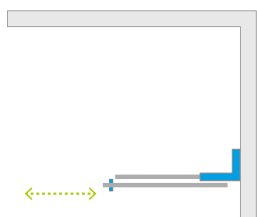

Profile finish:

Glossy:

Matte:



01 Chrome 09 Gold 54 Black

Brushed:

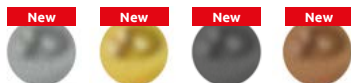

91 Nickel 99 Gold 92 GunMetal 93 Copper



Furo Walk-in + Kyntos F Black

In the article number, the symbol "XX" should be replaced with the symbol of the selected colour: 09, 91, 92, 93, 99

Shower enclosure set consists of 2 parts: shower door and front wall. Please specify all the article numbers when making an order.

Model	Nazwa elementu	TRANSPARENT GLASS		
		profile finish: CHROME Art. No.	profile finish: BLACK Art. No.	Art. No.
SL Walk-in 80 L	Door 438 L	10306438-01-01L	10306438-54-01L	10306438-XX-01L
	Front wall 394	10110394-01-01	10110394-01-01	10110394-01-01
SL Walk-in 80 R	Door 438 R	10306438-01-01R	10306438-54-01R	10306438-XX-01R
	Front wall 394	10110394-01-01	10110394-01-01	10110394-01-01
SL Walk-in 90 L	Door 488 L	10306488-01-01L	10306488-54-01L	10306488-XX-01L
	Front wall 444	10110444-01-01	10110444-01-01	10110444-01-01
SL Walk-in 90 R	Door 488 R	10306488-01-01R	10306488-54-01R	10306488-XX-01R
	Front wall 444	10110444-01-01	10110444-01-01	10110444-01-01
SL Walk-in 100 L	Door 538 L	10306538-01-01L	10306538-54-01L	10306538-XX-01L
	Front wall 494	10110494-01-01	10110494-01-01	10110494-01-01
SL Walk-in 100 R	Door 538 R	10306538-01-01R	10306538-54-01R	10306538-XX-01R
	Front wall 494	10110494-01-01	10110494-01-01	10110494-01-01
SL Walk-in 110 L	Door 588 L	10306588-01-01L	10306588-54-01L	10306588-XX-01L
	Front wall 544	10110544-01-01	10110544-01-01	10110544-01-01
SL Walk-in 110 R	Door 588 R	10306588-01-01R	10306588-54-01R	10306588-XX-01R
	Front wall 544	10110544-01-01	10110544-01-01	10110544-01-01
SL Walk-in 120 L	Door 638 L	10306638-01-01L	10306638-54-01L	10306638-XX-01L
	Front wall 594	10110594-01-01	10110594-01-01	10110594-01-01
SL Walk-in 120 R	Door 638 R	10306638-01-01R	10306638-54-01R	10306638-XX-01R
	Front wall 594	10110594-01-01	10110594-01-01	10110594-01-01

TECHNICAL DRAWINGS

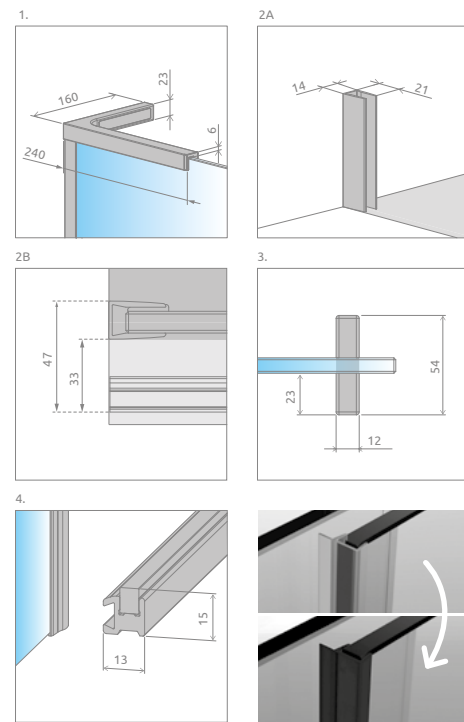
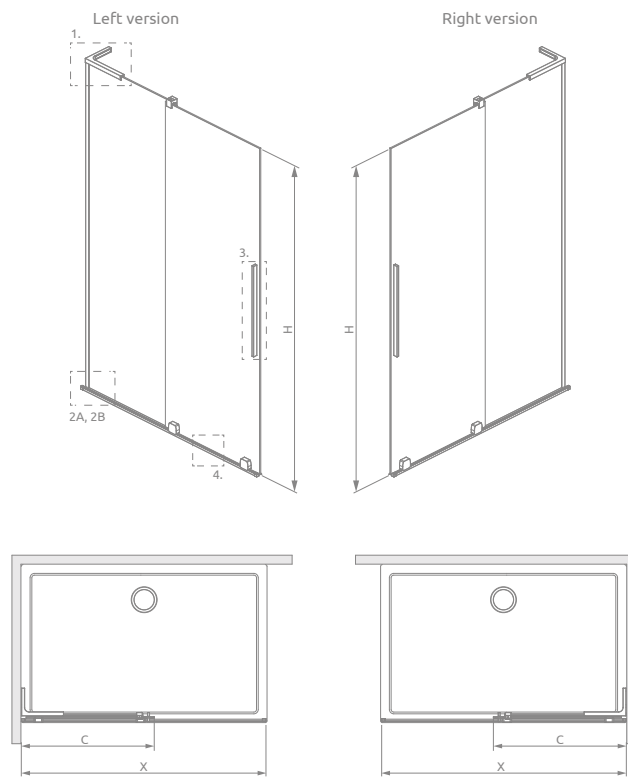

When installed on a shower tray – the minimum width of the edge of the shower tray is 43 mm, and its slope max 1 mm.

Model	X1	C	H
Walk-in 80	790-800	453-463	2000
Walk-in 90	890-900	503-513	2000
Walk-in 100	990-1000	553-563	2000
Walk-in 110	1090-1100	603-613	2000
Walk-in 120	1190-1200	653-663	2000



It is possible to make the product with a railing handle ¹⁾ which also functions as a towel hanger.

There is a possibility of a paid replacement of transparent gaskets (vertical and horizontal) for black gaskets. This option should be clearly stated in the order.



It is possible to extend the entrance by 30 mm by replacing the vertical handle with a round one ²⁾. Please contact the non-standard cabins department.

ADDITIONAL OPTIONS

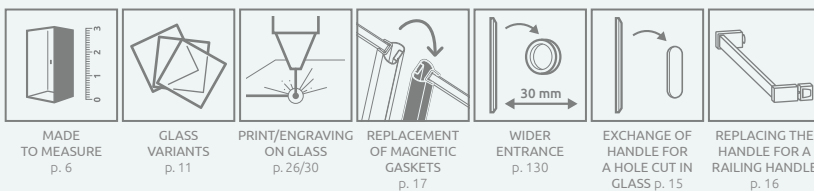

Possibility of replacing the standard handle with a 35x120 mm hole cut in the glass pane.

NAVIGATION

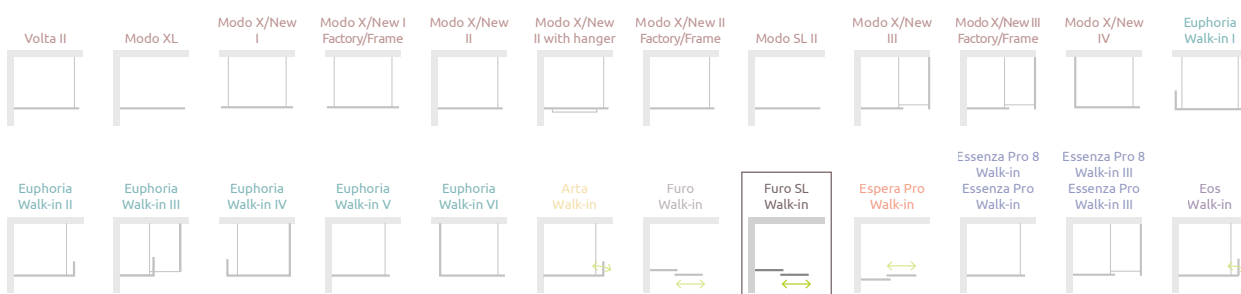

¹⁾ only chrome, gold and black colour ²⁾ only chrome and black colour
Dimensions are given in mm.