

# **INSTRUCTION MANUAL**

## **Freezer or Fridge Hybrid Appliance**

**Freezer Configuration  
Model No.: P1271185MFZIN**

**Fridge Configuration  
Model No.: P1271185MRIN**

Thank you for choosing your New PowerPoint appliance. Please make sure to register your warranty at  
[www.powerpointappliances.ie](http://www.powerpointappliances.ie)

If you have any aftersales service issues we can be contacted at [service@shomar.ie](mailto:service@shomar.ie)

## I. SAFETY



### WARNING!

It is hazardous for anyone other than authorized service personnel to carry out servicing or repairs which involves the removal of covers. To avoid the risk of an electric shock do not attempt to repair this appliance yourself.

### WARNING!

Risk of fire / flammable materials.



### Safety tips

Do not use electrical appliances such as a hair dryer or heater to defrost your Fridge/Freezer.

Containers with flammable gases or liquids can leak at low temperatures.

Do not store any containers with flammable materials, such as spray cans, fire extinguisher refill cartridges etc. in the Fridge/Freezer.

Do not place carbonated or fizzy drinks in the Freezer compartment. Ice lollies can cause "Frost/Freeze burns". If consumed straight from the Fridge/Freezer.

Do not remove items from the Fridge/Freezer compartment if your hands are damp/wet, as this could cause skin abrasions or "Frost/Freezer burns". Bottles and cans must not be placed in the Freezer compartment as they can burst when the contents freeze.

Manufacturer's recommended storage times should be adhered to. Refer to relevant instructions.

Do not allow children to tamper with the controls or play with the Fridge/Freezer. The Fridge/Freezer is heavy. Care should be taken when moving it. It is dangerous to alter the specification or attempt to modify this product in any way.

Do not store inflammable gases or liquids inside your Fridge/Freezer.

If the power cable is damaged, it must be replaced by the manufacturer, its service agent or similarly qualified persons in order to avoid a hazard.

This appliance can be used by children aged from 8 years and above and persons with reduced physical, sensory or mental capabilities or lack of experience and knowledge if they have been given supervision or instruction concerning use of the appliance in a safe way and understand the hazards involved. Children shall not play with the appliance. Cleaning and user maintenance shall not be made by children without supervision.

This refrigerating appliance is not intended to be used as a built-in appliance.

This appliance is intended to be used in household and similar applications such as

- staff kitchen areas in shops, offices and other working environments;
- farm houses and by clients in hotels, motels and other residential type environments;
- bed and breakfast type environments;
- catering and similar non-retail applications.

Keep ventilation openings, in the appliance enclosure or in the built-in structure, clear of obstruction.

**D**o not use mechanical devices or other means to accelerate the defrosting process, other than those recommended by the manufacturer.

**D**o not damage the refrigerant circuit.

**D**o not use electrical appliances inside the food storage compartments of the appliance, unless they are of type recommended by the manufacturer.

**D**o not store explosive substances such as aerosol cans with a flammable propellant in this appliance.

**T**his appliance is not intended for use by persons (including children) with reduced physical, sensory or mental capabilities, or lack of experience and knowledge, unless they have been given supervision or instruction concerning use of the appliance by a person responsible for their safety. Children should be supervised to ensure that they do not play with the appliance.

– **WARNING:** Keep ventilation openings, in the appliance enclosure or in the built-in structure, clear of obstruction.

– **WARNING:** Do not use mechanical devices or other means to accelerate the defrosting process, other than those recommended by the manufacturer.

– **WARNING:** Do not damage the refrigerant circuit.

– **WARNING:** Do not use electrical appliances inside the food storage compartments of the appliance, unless they are of the type recommended by the manufacturer.

– **WARNING:** Refrigerating appliances – in particular a refrigerator-freezer Type I – might not operate consistently (possibility of defrosting of contents or temperature becoming too warm in the frozen food compartment) when sited for an extended period of time below the cold end of the range of temperatures for which the refrigerating appliance is designed;

– **WARNING:** The necessity that, for doors or lids fitted with locks and keys, the keys be kept out of the reach of children and not in the vicinity of the refrigerating appliance, in order to prevent children from being locked inside.

– **WARNING:** The refrigerant used in your appliance and insulation materials requires special disposal procedures.

– **WARNING:** When positioning the appliance, ensure the supply cord is not trapped or damaged.

– **WARNING:** Do not locate multiple portable socket-outlets or portable power supplies at the rear of the appliance

Children aged from 3 to 8 years are allowed to load and unload refrigerating appliances.

To avoid contamination of food, please respect the following instructions:

– Opening the door for long periods can cause a significant increase of the temperature in the compartments of the appliance.

– Clean regularly surfaces that can come in contact with food and accessible drainage systems.

– Clean water tanks if they have not been used for 48 h; flush the water system connected to a water supply if water has not been drawn for 5 days.

– Store raw meat and fish in suitable containers in the refrigerator, so that it is not in contact with or drip onto other food.

– Two-star frozen-food compartments are suitable for storing pre-frozen food, storing or making ice-cream and making ice cubes.

– One-, two- and three-star compartments are not suitable for the freezing of fresh food.

– If the refrigerating appliance is left empty for long periods, switch off, defrost, clean, dry, and leave the door open to prevent mould developing within the appliance.

## Electrical Connection

### **⚡WARNING⚡**

The power cord of this appliance is equipped with a plug which mates with the standard wall outlets to minimize the possibility of electrical shock.

Under any circumstances, ensure that the power cord is grounded.

This refrigerator appliance requires a standard 220-240VAC 50/60Hz electrical outlet with grounding.

The power cord should be secured behind the appliance and not left exposed or dangling to prevent accidental injury.

Never unplug the refrigerator by pulling the power cord. Always grip the plug firmly and pull straight out from the receptacle.

## Climate Range

The information about the climate range of the appliance is provided on the rating plate. It indicates at which ambient temperature (that is, room temperature, in which the appliance is working) the operation of the appliance is optimal (proper).

Climate range	Permissible ambient temperature
SN	from +10°C to +32°C
N	from +16°C to +32°C
ST	from +16°C to +38°C
T	from +16°C to +43°C

Note: Given the limit values of the ambient temperature range for the climate classes for which the refrigerating appliance is designed and the fact that the internal temperatures could be affected by such factors as location of the refrigerating appliance, ambient temperature and the frequency of door opening, the setting of any temperature control device might have to be varied to allow for these factors, if appropriate.

 Note: When operating in an environment other than the specified climate type (i.e., beyond the rated ambient temperature range), the appliance may not be able to maintain the desirable compartment temperatures.

### Locks

If your Refrigerator is fitted with a lock, keep the key out of reach and not in the vicinity of the appliance to prevent children being entrapped. When disposing of an old Refrigerator, break off any old locks or latches as a safeguard.

### Freon-free

The freon-free refrigerant (R600a) and the foaming insulation material (cyclopentane) that is environmentally friendly are used for the refrigerator, causing no damage to the ozone layer and having a very small impact on the global warming. R600a is flammable, and sealed in a refrigeration system, without leakage during normal use. But, in case of refrigerant leakage due to the refrigerant circuit being damaged, be sure to keep the appliance away from open flames and open the windows for ventilation as quickly as possible.

## II. Product Features

This is an upright single-door inverter refrigerator with electronic control. It features switchover between the fridge mode and the freezer mode; under the freezer mode, it can be used for the preservation of fish, meat, etc. that need be frozen for the long-term storage; and under the fridge mode, it can be used for fresh food storage, such as fruits, vegetables, eggs, milk, etc.

#### ★Computer control

Adopting the electronic temperature control mode, the refrigerator is designed with a LED display screen, by which the temperature and working parameters can be managed and set.

#### ★Inverter technology

Integrated with precise frequency conversion, noise reduction, energy saving, precise temperature control and other technologies, the refrigerator boasts of superior performances. Furthermore, working efficiency of the inverter compressor **can be automatically adjusted according to the ambient temperature and the set temperature, so as to keep the refrigerator operating in its optimal state.**

#### ★Green technology

The freon-free refrigerant and foaming insulation material are used for the refrigerator, causing no damage to the ozone layer and having a very small impact on the global warming, so it is the environmentally friendly product.

#### ★More user-friendly designs

Such functions as wide working voltage range, automatic temperature control, power-cut memory, power-on delay, automatic alarm, fast freezing, and Fast cooling, etc. are available.

#### ★Switchable between refrigerator and freezer.

BD-380W

No.	Description
1	Freezer drawer flips
2	Freezer drawers
3	Leveling feet

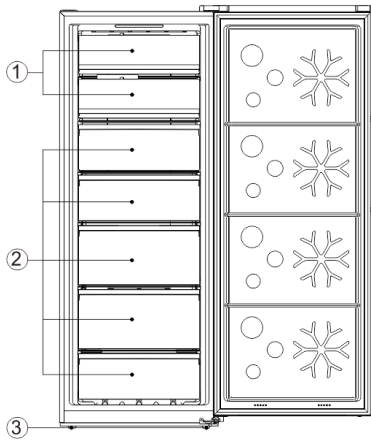

BD-380W

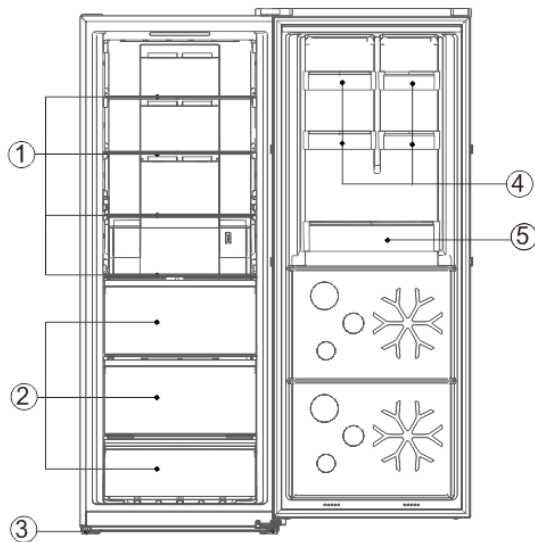

No	Description
1	Glass shelves
2	Freezer drawer
3	Adjustable Feet
4	Little Bottle racks
5	Bottle rack

Due to technological innovations, the product descriptions in this manual may not be completely consistent with your refrigerator. Detailed information is in accordance with the final product.

### III. Preparations for use

#### Installation location:

##### 1. Ventilation condition

The position you select for the refrigerator installation should be well-ventilated and has less hot air. Do not locate the refrigerator near a heat source such as cooker, and avoid it from direct sunlight, thus guaranteeing the refrigeration effect while saving energy consumption. Do not locate the refrigerator in the damp place, so as to prevent the refrigerator from rusting and leaking electricity. **The result of the refrigerant charge amount of the refrigerator being divided by the total space of the room in which the refrigerator is installed shall be less than 8g/ m<sup>3</sup>.**

Note: The amount of refrigerant charged for the refrigerator can be found on the nameplate.

##### 2. Heat dissipation space

When working, the refrigerator gives off heat to surroundings. Therefore, at least 30mm of free space should be spared at the top side, more than 100mm on both sides, and above 50mm at the back side of the refrigerator.

Dimensions in mm:

W	D	H	A	B	C(° )	E	F	MODEL
710	770	1855	1297	1407	130±5	50	100	

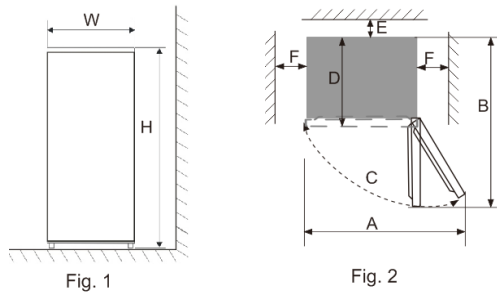

Note: Figure 1, Figure 2 only illustrate the space demand of the product.

### 3. Level ground

Place the refrigerator on the solid and flat ground (floor) to keep it stable, or else, it will give rise to vibration and noise. When the refrigerator is placed on such flooring materials as carpet, straw mat, polyvinyl chloride, the solid backing plates should be applied underneath the refrigerator, so as to prevent color change due to heat dissipation.



Unobstructed ventilation shall be maintained around the appliance or in an embedded structure.

## Preparations for use

### 1. Standing time

After the refrigerator is properly installed and well cleaned, do not switch it on immediately. Make sure to energize the refrigerator after more than 1 hour's standing, so as to ensure its normal operation.

### 2. Cleaning

Confirm the accessory parts inside the refrigerator and wipe the inside with a soft cloth.

### 3. Power-on

Insert the plug into the solid socket to start the compressor. After 1 hour, open the refrigerator door, if the temperature inside the refrigerator compartment drops obviously, it indicates the refrigeration system is working normally.

### 4. Storage of food

After the refrigerator runs for a period of time, the internal temperature of the refrigerator will be automatically controlled according to the user's temperature setting. After the refrigerator is fully cooled, put in foods, which usually need 2~3 hours to be fully cooled. In summer, when the temperature is high, it takes more than 4 hours for the foods to be fully cooled (Try to open the refrigerator door as less as possible before the internal temperature cools down).



If the refrigerator is installed in the moisture place, make sure to check whether the ground wire and leakage circuit breaker are normal. If vibration noises are produced due to the refrigerator contacting the wall or if the wall gets blackened by air convection around the compressor, move the refrigerator away from the wall. Setting up the refrigerator may cause jamming noise or image chaos to the mobile phone, fixed-line telephone, radio receiver, television surrounding it, so try to keep the refrigerator as far away as possible in such case.

## IV. Functions

The display panel is illustrated as following:

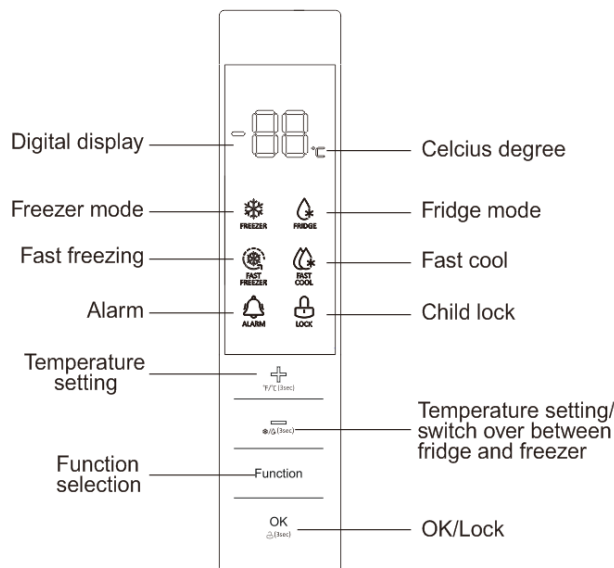



**CAUTION:** This is a convertible refrigerator that can function either as a fridge or a freezer. Please check whether it is set at the fridge mode or the freezer mode when powering it on.

When the refrigerator system is connected to power supply for the first time, all icons on the display panel gets illuminated for 2s, and the system runs in the freezer mode at  $-18^{\circ}\text{C}$  by default. When all the doors are close, the display gets extinguished automatically if no key operation within 3 minutes. When the display is off, it will light up if any door is opened or any key is pressed.

The following key operations are valid only when the keys are unlocked and gets illuminated on the display. (Refer to 1.6 for unlocking the keys)

## 1. Functions

### 1.1 Switchover between fridge/freezer mode

Press and hold the '-' key for 3s, then switchover between the fridge mode and the freezer mode can be realized.

### 1.2 Temp. Setting

Press the '+' or '-' for the first time, with the icon of Temp. flickering, and then press the '+' or '-' key again to adjust the temperature to desired value, finally press the OK key or wait for 5s to validate the above temperature setting.

Temperature setting ranges cycle as follows:

In the fridge mode:  $2^{\circ}\text{C} \leftrightarrow 3^{\circ}\text{C} \leftrightarrow 4^{\circ}\text{C} \leftrightarrow 5^{\circ}\text{C} \leftrightarrow 6^{\circ}\text{C} \leftrightarrow 7^{\circ}\text{C} \leftrightarrow 8^{\circ}\text{C}$ ;

In the freezer mode:  $-16^{\circ}\text{C} \leftrightarrow -17^{\circ}\text{C} \leftrightarrow -18^{\circ}\text{C} \leftrightarrow -19^{\circ}\text{C} \leftrightarrow -20^{\circ}\text{C} \leftrightarrow -21^{\circ}\text{C} \leftrightarrow -22^{\circ}\text{C} \leftrightarrow -23^{\circ}\text{C} \leftrightarrow -24^{\circ}\text{C}$ ;

### 1.3 Fast Freezing

1) When the Fast Freezing function is enabled, the compartment temperature will be controlled at  $-32^{\circ}\text{C}$  automatically, and after 26 hours of running, the Fast Freezing function gets exited. Cooling down the freezer temperature in a rapid manner is beneficial to the prevention of food nutrition against lost and the preservation of freshness.



Under the Fast-Freezing mode, the freezer temperature is subjected to no adjustment.



The Fast-Freezing function can be enabled only in the freezer mode.

#### 2) Enabling the Fast Freezing function

◆ In the freezer mode, press the Function key to select Fast Freezing until the corresponding icon gets flickering, and then press the OK/Lock key within 5s for confirmation. If the OK/Lock key is not pressed within 5s, the setting will be invalidated.

#### 3) Exiting the Fast Freezing function

◆ "After a cumulative running period of 26 hours, the Fast Freezing function will exit automatically.

◆ Under the Fast Freezing mode, press the Function key to select Fast Freezing until the corresponding icon gets flickering, and then press the OK/Lock key for confirmation, the Fast Freezing function will get exited.

### 1.4 Fast Cooling

1) When the Fast Cooling function is enabled, the compartment temperature will be controlled at  $2^{\circ}\text{C}$  automatically. Cooling down the compartment temperature in a rapid manner is beneficial to the prevention of food nutrition against lost and the preservation of freshness.



Under the Fast Cooling mode, the temperature is subject to no change.



The Fast-Cooling function can be enabled only in the fridge mode.

#### 2) Enabling the Fast Cooling function

◆ In the fridge mode, press the Function key to select Fast Cooling until the corresponding icon gets flickering, and then press the OK/Lock key within 5s for confirmation. If the OK/Lock key is not pressed within 5s, the setting will be invalidated.

#### 3) Exiting the Fast Cooling function

◆ Under the Fast Cooling mode, press the Function key to select Fast Cooling until the corresponding icon gets flickering, and then press the OK/Lock key for confirmation, the Fast Cooling function will get exited.

### 1.5 Child Lock

1) When the Child Lock function is enabled, the temperature and function are subjected to no change to prevent maloperation.

2) In case of no key operation within 3 minutes, the Child Lock function will be enabled automatically.

#### 3) Enabling/exiting the Child Lock function manually

◆ Press and hold down the OK/Lock for 3s, then the Child Lock function can be enabled/disabled.

### 1.6 Door open alarm

If any door is open for more than 3 minutes, buzzer alarms will be continuously issued, which can be stopped when any key is pressed, but will be restored after 3 minutes if the door keeps open. The alarms will not be lifted until the door is closed.

### 1.7 Power-cut memory

In case of power failure, the refrigerator will maintain the operating state before power failure when power supply is restored.

### 1.8 Power-on delay

In order to protect the refrigerator compressor from being damaged in the case of short-time power failure (i.e., less than 5 minutes), the compressor will not be started immediately after it is powered on.

### 1.9 Over-temperature alarm (only after power outage)

When the refrigerator system is powered on, if it is set in the freezer mode and the compartment temperature is higher than  $-10^{\circ}\text{C}$ , digits of temperature get flickering on the display. The temperature at which the system is energized can be displayed when any key is pressed, and the normal display will be restored when any key is pressed again or after 5s.

#### 1.10 Fault alarm

In case E0, E1, E2, EH, or EC is displayed on the operation panel, it indicates fault with the refrigerator. Please contact the aftersales person for visiting service in such case.

## V. Instructions for food storage

### Precautions for use

- The appliance might not operate consistently (there is possibility of defrosting or temperature becoming too warm in the frozen food compartment) when sited for an extended period of time below the cold limit of the temperature range for which the refrigerating appliance is designed
- The information of climate type of the appliance is provided on the rating plate.
- The internal temperature could be affected by such factors as the location of refrigerating appliance, ambient temperature, and frequency of door open, etc., and if appropriate, a warning that setting of any temperature control device might have to be varied to allow for these factors should be made.
- Effervescent drinks should not be stored in the freezer compartment or the low-temperature compartment, and some products such as water ices should not be consumed too cold.

### Food storage

In the fridge mode: It is suitable for the storage of such foods as need not to be frozen, the cooked food, beer, eggs, some condiments that need cold preservation, milk, fruit juice, etc.

In the freezer mode, it is suitable for the storage of ice cream, frozen food and the foods to be preserved for a long time.

Fridge shelf: When removing the shelf, lift it up first, and then pull it out; and when installing the shelf, place it into position before putting it down.

Crisper box: Pull out the crisper box for access to food.

### Cautions for food storage (in the fridge mode)

You'd better clean the foods and wipe them dry before storing them inside the refrigerator. Before foods are put in the refrigerator, it is advisable to seal them up, so as to prevent water evaporation to keep fresh fruits and vegetables on one hand, and prevent taint of odor on the other hand.

Do not put too many or too weight foods inside the refrigerator. Keep enough space between foods; if too close, the cold air flow will be blocked, thus affecting the refrigeration effect. Do not store excessive or overweight foods, to avoid the shelf from being crushed. When storing the foods, keep a distance away from the inner wall; and do not place the water-rich foods too close to the fridge rear wall, lest they get frozen on the inner wall.

Categorized storage of foods: Foods should be stored by category, with the foods you eat every day placed in front of the shelf, so that the door open duration can be shortened and food spoilage due to expiration can be avoid.

Energy-saving tips: Allow the hot food cool down to the room temperature before putting it in the refrigerator. Put the frozen food in the fresh food compartment to thaw, using the low temperature of the frozen food to cool the fresh food, thus saving energy.

### Storage of fruits and vegetables

In the case of refrigerating appliances with chill compartment, a statement to the effect that some types of fresh vegetables and fruits are sensitive to cold and therefore are not suitable for storage in this kind of compartment should be made.

In the freezer mode

The freezer temperature is controlled below  $-18^{\circ}\text{C}$ , and it is advisable to store the food for long-term preservation in the freezer compartment, but the storage duration indicated on the food packaging should be adhered to.

The freezer drawers are used to store food that needs to be frozen. Fish and meat of large block size should be cut into small pieces and packed into fresh-keeping bags before they are evenly distributed inside the freezer drawers.

### Fast freezing

- (1) Refer to the description about fast freezing function in the "Function" section.
- (2) Compared with the normal freezing, fast freezing enables food to pass through the maximum ice crystal formation zone at the fastest speed. Fast freezing can freeze the food water content into fine ice crystals, without damaging the cell membrane, so cell juice will not be lost when thawing, and the original freshness and nutrition of food can be maintained.
- (3) The fast-freezing function is designed to preserve nutrition of the frozen food, with the food thoroughly frozen in the shortest time. Fast freezing consumes more energy than the normal freezing does.

★ Allow the hot foods to cool down to the room temperature before putting them in the freezer compartment.

★ Do not put a glass container with liquid or the canned liquid that is sealed in the freezer compartment, so as to avoid burst due to volume expansion after the liquid gets frozen up.

★ Divide the food into appropriately small portions

★ You'd better pack the food up before freezing it, and the packing bag used should be dry, in case the packing bags are frozen together. Foods should be packed or covered by such suitable materials as are firm, tasteless, impervious to air and water, non-toxic and pollution-free, to avoid cross-contamination and transfer of odor.

### How to use the ice-making box

Place the ice-making box in the upper position of the freezer compartment, so that it ices up as soon as possible.

### Tips for shopping the frozen foods



1. When you are buying frozen food, look at the Storage Guidelines on the packaging. You will be able to store each item of frozen food for the period shown against the star rating. This is usually the period stated as "Best to use them before", found on the front of the packaging.
2. Check the temperature of the frozen food cabinet in the shop where you buy the frozen foods.
3. Make sure the frozen food package is in perfect condition.
4. Always buy frozen products last on your shopping trip or visit to the supermarket.
5. Try to keep frozen food together whilst shopping and on the journey home, as this will help to keep the food cooler.
6. Don't buy frozen food unless you can freeze it straight away. Special insulated bags can be bought from most supermarkets and hardware shops. These keep the frozen foods cold longer.
7. For some foods, thawing before cooking is unnecessary. Vegetables and pasta can be added directly to boiling water or steam cooked. Frozen sauces and soups can be put into a saucepan and heated gently until thawed.
8. Use quality food and handle it as little as possible. When foods are frozen in small quantities, it will take less than for them to freeze up and thaw.
9. Estimate the amount of food to be frozen up. When freezing large amounts of fresh food, adjust the temperature control knob to the low mode, with the freezer temperature lowered. So, foods can be frozen up in fast manner, with the food freshness well kept.

## VI. Tips for special needs

Moving the refrigerator/freezer

•Location

Do not place your refrigerator/freezer near a heat source, e.g., cooker, boiler or radiator. Avoid it from direct sunlight in out-buildings or sun lounges.

•Leveling

Make sure to level your refrigerator/freezer using the front leveling feet. If not level, the refrigerator/freezer door gasket sealing performance will be affected, or even it may lead to the operating failure of your refrigerator/freezer.

After locating the refrigerator/freezer in position, wait for 4 hours before using it, so as to allow the refrigerant to settle.

•Installation

Do not cover or block the vents or grilles of your appliance.

When you are out for a long time

- If the appliance will not be used for several months, turn it off first, and then unplug the plug from the wall outlet.
- Take out all foods.
- Clean and dry the interior thoroughly. To prevent odor and mold growth, leave the door ajar: block it open or have the door removed if necessary.
- Keep the cleaned appliance in a dry, ventilated place and away from the heat source, place the appliance smoothly, and do not place heavy objects on top of it.
- The unit should not be accessible to child's play.

## VII. Maintenance and cleaning

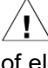
 Before cleaning, unplug the power plug first; Do not plug in or plug out the plug with wet hand, because there is a risk of electric shock and injury. Do not spill water directly on the refrigerator, to avoid rust, electricity leakage and accidents. Do not stretch your hands into the bottom of the refrigerator, since you might be scratched by sharp metal corners.

### Internal cleaning and external cleaning

The food residuals in the refrigerator are liable to produce bad odor, so the refrigerator must be cleaned regularly. The fresh food compartment is usually cleaned once a month.

Remove all shelves, crisper box, bottle racks, cover board, and drawers etc., and clean them with a soft towel or sponge dipped in warm water or neutral detergent.

Clear off the dusts accumulated on the rear panel and side plates of the refrigerator often.

After using detergent, be sure to rinse it with clean water, and then wipe it dry.

 Do not use bristle brush, steel wire brush, detergent, soap powder, alkaline detergent, benzene, gasoline, acid, hot water and other corrosive or soluble items to cleanse the cabinet surface, door gasket, plastic decorative parts, etc., so as to avoid damage.

Carefully wipe dry the door gasket, clean the groove using a wooden chopstick wrapped with cotton string. After the cleaning, fix the four corners of the door gasket first, and then embed it segment by segment into the door groove.

Interruption of power supply or failure of the refrigerating system

- Take care of the frozen foods in the event of an extended non-running of the refrigerating appliance (such as interruption of power supply or failure of the refrigerating system).
- Try to open the refrigerator door as less as possible, in this way can food safely and freshly kept for hours even in hot summer.
- If you get the power outage notice in advance:
  - 1) Adjust the thermostat knob to the high mode an hour in advance, so that foods get fully frozen (Do not store new food during this time!). Restore the temperature mode to the original setting when power supply becomes normal in a timely manner.
  - 2) You can also make ice with a watertight container, and put it in the upper part of the freezer, so as to extend the time for fresh food to be stored.

 Note: Once the refrigerator is used, you'd better use it continuously; and under normal circumstance, do not stop its

use, so as not to affect the service life.

**Defrosting**

This appliance is designed with automatic defrosting function, thus no need to defrost it manually.

**Changing the lamp**

The LED lamp is used by the refrigerator for lighting, which features low energy consumption and long service life. In case of any abnormality, please contact the after-sales personnel for visiting service.

**Lamp type: LED light.**

**Energy efficiency level: G**

Is the power plug firmly inserted into the socket?

Is the power plug abnormally over heat?



Note: Electric shock and fire accident may be caused in case the power cord or plug is damaged or stained by dust. If any abnormality, please unplug the power plug and get in contact with the vendor.

How to disassemble the Refrigerator shelf:

Hold the bottle rack with both hands, and then push it up.

Flip cover:

Keep the flip cover in the vertical direction, align its right side with the revolving shaft opening, and then pull out with force to disassemble the flip cover.



Note: It is forbidden to close the door when the flip cover is opened, otherwise the refrigerator door may be damaged.

**VIII. Simple fault analysis and elimination**

With regard to the following small faults, not every failure needs to be fixed by the technical service personnel; you can try to solve the problem.

Case	Inspection	Solutions
•Completely non-refrigeration	<ul style="list-style-type: none"> <li>•Is power plug off?</li> <li>•Are breakers and fuses broken?</li> <li>•No electricity or line trip?</li> </ul>	<ul style="list-style-type: none"> <li>•Re-plug</li> <li>•Opening the door and checking whether the lamp is lit.</li> </ul>
•Abnormal noise	<ul style="list-style-type: none"> <li>•Is refrigerator stable?</li> <li>•Does refrigerator contact the wall?</li> </ul>	<ul style="list-style-type: none"> <li>•Adjusting refrigerator's leveling feet.</li> <li>•Off the wall.</li> </ul>
•Poor refrigerating efficiency	<ul style="list-style-type: none"> <li>•Do you put hot food or too much food?</li> <li>•Do you open the door frequently?</li> <li>•Do you clip food bag to the door gasket?</li> <li>•Direct sunlight or near a furnace or stove?</li> <li>•Is it well-ventilated?</li> <li>•Temperature setting in too high?</li> </ul>	<ul style="list-style-type: none"> <li>•Putting food into refrigerator when hot food becomes cool.</li> <li>•Checking and closing the door.</li> <li>•Removing the refrigerator from the heat source.</li> <li>•Emptying the distance to maintain good ventilation.</li> <li>•Setting to the appropriate temperature.</li> </ul>
•Peculiar smell in refrigerator	<ul style="list-style-type: none"> <li>•Any spoiled food?</li> <li>•Do you need to clean refrigerator?</li> <li>•Have you packed food of strong flavors?</li> </ul>	<ul style="list-style-type: none"> <li>•Throwing away spoiled food.</li> <li>•Cleaning refrigerator.</li> <li>•Packing food of strong flavors.</li> </ul>
•No key response	<ul style="list-style-type: none"> <li>•Check whether the Child Lock function is enabled on the display panel.</li> </ul>	<ul style="list-style-type: none"> <li>•Press &amp; hold the "OK/LOCK" key for 3 seconds to unlock the key, and then conduct the key operation. (For details, refer to the Child Key function.)</li> </ul>
•Temperature setting impossible	<ul style="list-style-type: none"> <li>•Check whether the Fast Freezing or Fast Cooling function is enabled on the display panel.</li> </ul>	<ul style="list-style-type: none"> <li>•Exit the special function mode, and then set up the temperature (for details refer to the Functions section)</li> </ul>
•Temperature digits flickering on the display	<ul style="list-style-type: none"> <li>Is power cut before?</li> </ul>	<ul style="list-style-type: none"> <li>•Press any key to lift the alarm (refer to the Overtemperature alarm function), and then check the foods stored inside get spoiled.</li> </ul>
•Frost formation on the refrigerator top side	<ul style="list-style-type: none"> <li>Does the refrigerator door sink?</li> </ul>	<ul style="list-style-type: none"> <li>•Adjust the lower hinge shaft to raise the refrigerator door, so that the door gasket sealing performance can be improved.</li> </ul>
•Too high or too low temperature of the refrigerator	<ul style="list-style-type: none"> <li>•Are temperature modes of the refrigerator set properly?</li> </ul>	<ul style="list-style-type: none"> <li>•Be sure to set the fridge temperature to be 2-8, and the freezer temperature mode - 16 °C - 24 °C.</li> </ul>
•Heating on the left and right sides of the refrigerator	<ul style="list-style-type: none"> <li>•When the refrigerator works, heat is dissipated outwards through the condenser attached to the inside of the</li> </ul>	<ul style="list-style-type: none"> <li>•It is normal that the temperature of the side plates is high.</li> </ul>

	side plate of the refrigerator and through the anti-sweat pipe, so the temperature of side plates is high in summer when the ambient temperature is high.	
•Refrigerator light Off	<ul style="list-style-type: none"> <li>•Is the refrigerator powered up?</li> <li>•Is the door open for more than 10 minutes?</li> <li>•Is the lamp damaged?</li> </ul>	<ul style="list-style-type: none"> <li>•Insert the power cord plug firmly.</li> <li>•Reopen the door after closing it.</li> <li>•Replace the LED lamp</li> </ul>
•The refrigerator door unable to close properly	<ul style="list-style-type: none"> <li>•Does any food package get stuck in the door?</li> <li>•Is too much food put in?</li> <li>•Is the refrigerator placed askew?</li> </ul>	<ul style="list-style-type: none"> <li>•Do not store excessive foods inside.</li> <li>•Place the refrigerator in a stable manner.</li> </ul>

( Note: If the above descriptions are inapplicable to troubleshooting, do not disassemble and repair it yourself. Repairs carried out by inexperienced persons may cause injury or serious malfunctioning. Contact the local store where your purchase was made. This product should be serviced by an authorized engineer and only genuine spare parts should be used.

When the appliance is not in use for long periods, disconnect from the electricity supply, empty all foods and clean the appliance, leaving the door ajar to prevent unpleasant smells.)

## Reversing the door

To dismantle the refrigerator door

- a) Use a tool to remove the screws from the upper hinge cover, remove the upper hinge, and install the communication wire into the hole on the top of the refrigerator.

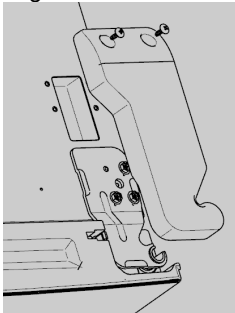

- b) Screw off the three bolts on the upper hinge, remove the upper hinge, and pry off the upper hinge cover, door sleeve, magnet.

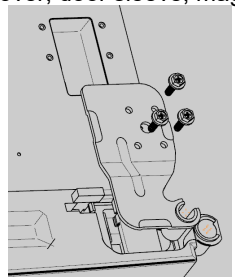

- c) Put the door communication wire into the hole on the door, and then cover it.

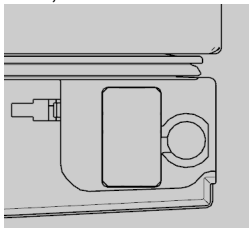

- d) Remove the three bolts from the hinge cover on

the left-side top of the refrigerator, remove the hinge cover, take out the wire harness in the hole, and install the door shaft sleeve.

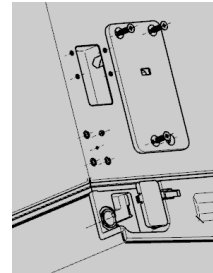

- e) Lift the refrigerator door up by 50mm to remove the refrigerator door.

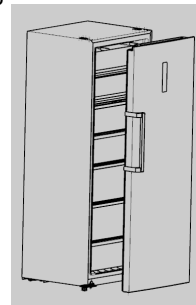

- f) Remove the left front adjustable foot, screw off the 5 screws fixing the hinge with a tool, and then remove the hinge assembly.

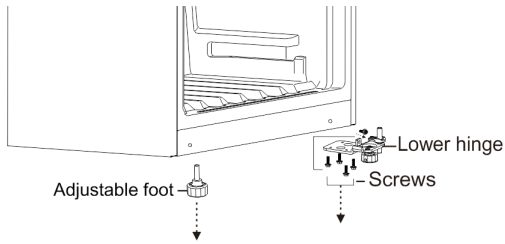

- g) Relocate the door stopper and the lower hinge shaft to the left side of the hinge. Follow the steps below:

- 1) Remove the screw fixing the stopper with a cross screwdriver;
- 2) Remove the nut and washer fixing the hinge shaft with a wrench.

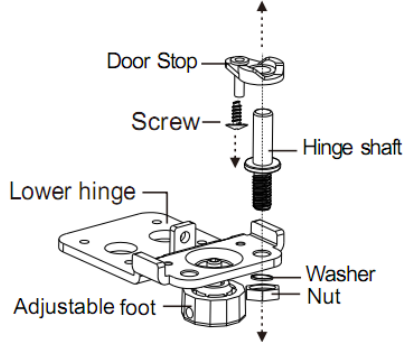

- 3) Put the hinge shaft into the hole on the left side of the lower hinge and fix it firmly with the removed nut and washer.
- 4) Align the door stopper hole with the hinge shaft, install them properly, and then fix the stopper with the removed screw

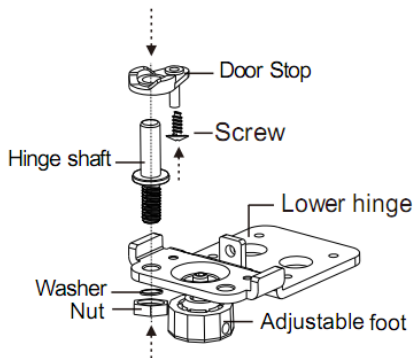

- h) Install the adjusted lower hinge assembly to the left bottom side of the cabinet, and install the left front adjustable foot to the right bottom side of the cabinet.

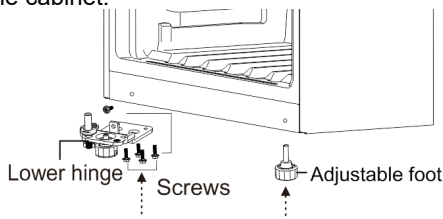

- i) Remove the door stopper and door closer from the door, take out the door closer from the accessory bag, and install it on the left side of the door.

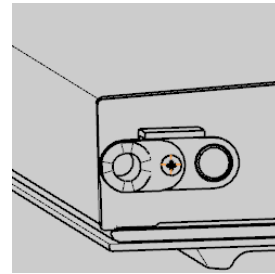

- j) Install the door onto the door cabinet.

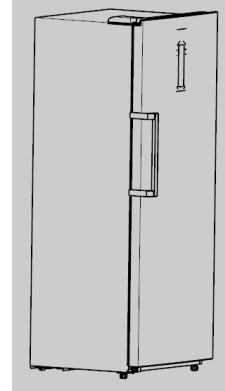

- k) Take out the upper left hinge from the accessory bag, fix it into the door using bolts, and then connect the wire harness.

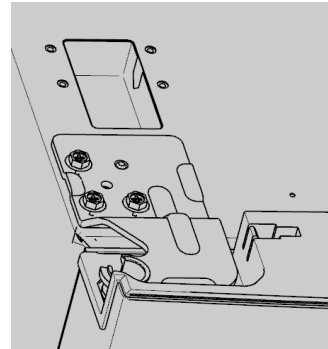

- l) Remove the upper left hinge cover, connect the wire harness, and install it on the cabinet.

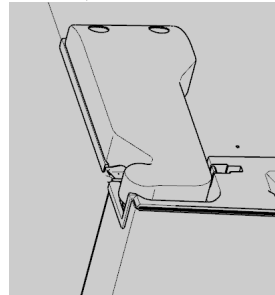

- m) Remove the magnet from the door right side, and install it on the door left side

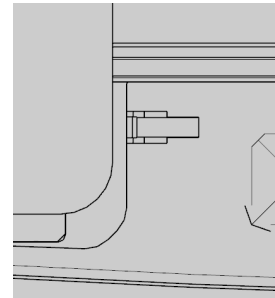

- n) Remove the handle cover, screw off the screws

fixing the handle, and remove the handle. Illustrated as below:

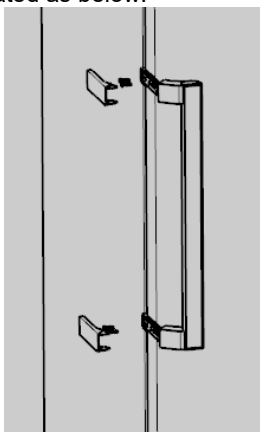

- o) Install the handle on the other side of the door: rotate the handle by 180° degrees vertically, and install it on the opposite side of the door, as shown by the figure:

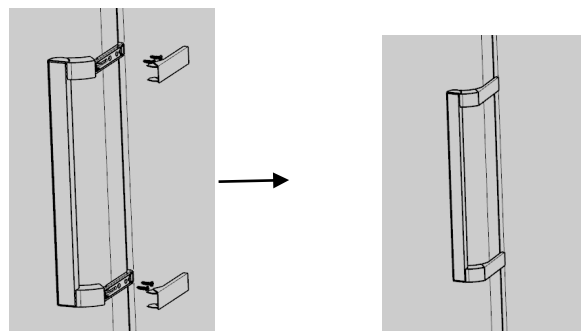

- p) After the door handle is installed, the door reversing operation is finished.

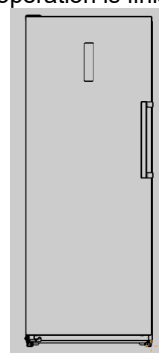

- ✧ For installation of the door handle, please refer to the above Item n.

## IX. Certifications

### Electrical information

This electrical appliance must be grounded

This product is equipped with a plug, which is suitable for all houses equipped with sockets meeting the current specifications

If the fitted plug is not suitable for your socket outlets, it should be cut off and carefully disposed of. To avoid a possible shock hazard, do not insert the discarded plug into a socket.

This product complies with the EEC directives:

## X. Safe recovery instructions

### Disposal

Old appliances still have some surplus value. An environmentally friendly approach will ensure that valuable raw materials are recycled.

The refrigerants used in your equipment and insulation materials require special handling procedures. Make sure there is no pipe damage on the back of the equipment before handling.

Up-to-date information on the options for disposing of old equipment and packaging from old equipment can be obtained from the local municipal office.

Correct Disposal of this product	
	<p>This marking indicates that this product should not be disposed with other household wastes throughout the EU. To prevent possible harm to the environment or human health from uncontrolled waste disposal, recycle it responsibly to promote the sustainable reuse of material resources. To return your used device, please use the return and collection systems or contact the retailer where the product was purchased. They can take this product for environmentally safe recycling.</p>

### Warnings for disposal

- Refrigerant and cyclopentane foaming material used for the refrigerator are flammable. Therefore, when the refrigerator is scrapped, it shall be kept away from any fire source and be recovered by a special recovering company with corresponding qualification other than be disposed by combustion, so as to prevent damage to the environment or any other harm.
- When the refrigerator is scrapped, disassemble the doors, and remove gasket of door and shelves; put the doors and shelves in a proper place, so as to prevent trapping of any child.