

Tall Freezer

P125514FFINOX –P125517FFINOX

INSTRUCTIONS:

Please read and keep safe for future use.

INSTALLATION AND USER INSTRUCTIONS

Features.....

Transportation instructions.....

Introduction & safety warnings.....

Electrical Requirements/Installation.....

Food Storage.....

Defrosting.....

Arrangement of Food/ Temperature Control

Cleaning and Care/Top Tips.....

Problem Solving.....

Health and Safety.....

Warranty Information.....

II. Product Features

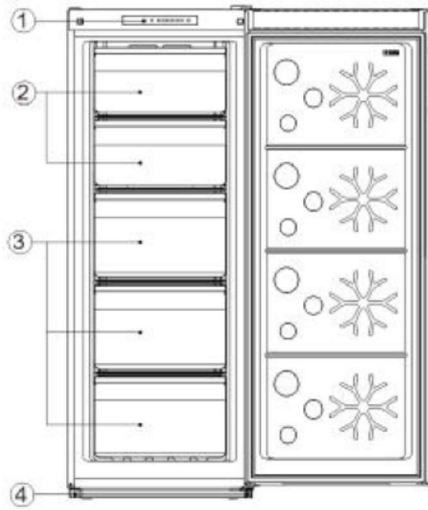

No	Description
1	Control panel
2	Flip cover
3	Freezer drawers
4	Adjustable Feet

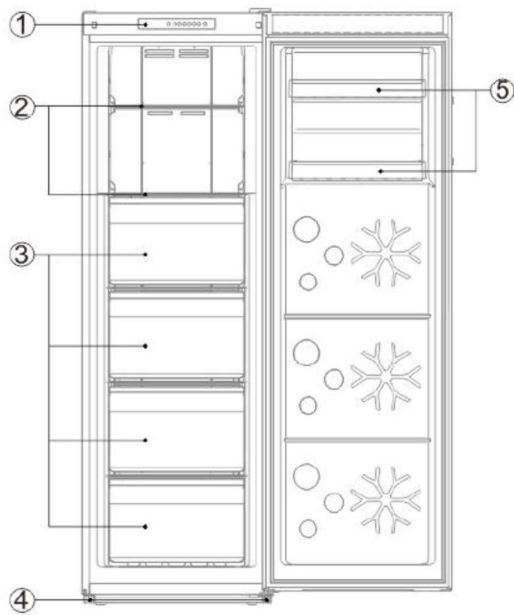

No	Description
1	Control panel
2	Freezer Glass Shelves
3	Freezer drawers
4	Adjustable Feet
5	Bottle racks

Transportation of your Appliance

- When transporting, never tilt to more than 45 degrees
- The appliance should be transported only in a vertical upright position
- The packaging as supplied must be intact during transportation
- If during the course of transport the appliance has to be transported horizontally, it must only be laid on its left hand side when standing in front of the appliance. After bringing it to the upright position, it must not be operated for at least 4 Hours to allow the system to settle. The manufacturer will not be held Responsible if these instructions are disregarded.
- The appliance must be protected against rain and moisture
- When positioning your appliance take care not to damage your flooring, Kitchen furniture, related parts and doors, pipes, wall coverings etc.
- Do not move the appliance by pulling the door
- Hold the base and lift carefully
- Never hold the door handle as support
- Never place the freezer upside down or lie it down
- Move by using its two hind roller feet as an axis and then tilting it slightly

IMPORTANT:

Care must be taken while cleaning/carrying the appliance to avoid Touching the bottom of the condenser metal wires at the back of the Appliance as you might injure your fingers and hands.
Make sure that mains cable is not caught under the appliance During and after carrying/ moving the appliance, to avoid the mains Cable becoming cut or damaged.

Before First Use

IMPORTANT!

DO NOT connect your appliance to the electricity supply until all packing and Transit protectors have been removed.

- Leave to stand for at least 4 hours before switching on to allow compressor oil to settle if transported horizontally
- This freezer must only be used for its intended purpose i.e. the and freezing of Edible foodstuff
- Do not dispose of the appliance on a fire
- Take care not to damage the cooling circuit, if damaged immediately ventilate the room where the appliance is situated
- This appliance should not be used in an unheated, cold room i.e. Garage, conservatory, annex, shed, out-house etc.
- Ensure that the plug remains readily accessible
- Failure to observe these instructions may invalidate your right to free service

During the guarantee period

- We recommend a separate switch be used to ensure easy switch on/off.
- Children should be supervised to ensure that they do not play with the appliance
- This appliance is intended to be used in a household environment
- Do not use mechanical devices or other means to accelerate the defrosting Process

WARNING: Keep ventilation openings clear of obstruction.

Electrical Requirements

Before inserting the plug into the wall socket make sure that the voltage and Frequency shown in the rating plate inside the appliance corresponds to your electricity supply. We recommend that this appliance is connected to the mains supply via a suitable switched and fused socket in a readily accessible position. Keep the electrical cable away from the compressor and condenser to allow insulation function to operate correctly.

Should the mains lead of the appliance become damaged or should it need Replacing at any time, it must be replaced by a special purpose made mains Lead which can only be obtained from the supplier.

WARNING! THIS APPLIANCE MUST BE EARTHED

If the fitted plug is not suitable for your socket, then the plug should be removed And an appropriate plug fitted. Destroy the old plug which is cut off as a plug With bared cord could cause a shock hazard if inserted into a socket. The plug on This appliance incorporates a 13 A fuse. Should the fuse need to be changed the Same rating must be used. Ensure that the fuse cover is refitted.

Installation Instructions

****Door Reversal instructions on back pages of user manual ****

1. Install the freezer on a flat surface in order to prevent vibration and noise.
2. Choose a dry well-ventilated place. A space of no less than 10cm must be left around the freezer.
3. Minimum space in the room where the freezer is being installed should be 10 Cubic metres.
4. Choose a location where there is no heat source. Keep the freezer away from Direct sunlight, oven etc. Minimum surrounding temperature of the appliance Should be 10 degrees Celsius.
5. Do not place the appliance near cookers, radiators or in direct sunlight as This will cause your appliance to work harder. If installed next to a source of heat maintain the following minimum side clearances:
From Cookers 50 mm
From Radiators 300 mm
6. Insert the plug into the wall socket and switch on the electricity supply.
7. You will hear a noise as the compressor starts up. The liquid and gases sealed Within the refrigeration system may also give rise to noise whether the Compressor is running or not which is quite normal.
8. Turn the thermostat knob to the "MED" position, and plug the freezer into the wall outlet. The compressor will begin to run.
9. Check after 30 minutes of operation, to ensure that the freezer is getting cold.
10. Front edges of the cabinet may feel warm. This is normal.
11. Do not load the appliance immediately it is switched on. Wait until the correct storage temperature has been reached. We recommend that you Check the temperature with an accurate thermometer.

Before you start using the freezer check that:

1. The interior is dry and air can circulate freely at the rear of the cabinet.
2. The interior is cleaned as recommended under "Cleaning and Care".

Food Storage

- Pre-packed commercially frozen food should be stored in accordance with the Frozen food manufacturer's instructions for a frozen food storage compartment
- To ensure that the high quality achieved by the frozen food manufacturer and The food retailer is maintained, the following should be observed:
 - Put packets in the freezer as quickly as possible after purchase
 - Ensure that contents are labelled and dated
 - Do not exceed "Use By" or "Best Before" dates on the packaging
- If there is a power failure do not open the door. Frozen food should not be Affected if the failure lasts for less than 14 hrs. If the failure is longer, then the

Food should be checked and either eaten immediately or cooked and then Refrozen.

Quick Freezing

Fast Freezing -16c when the fast freeze function is enabled the compartment temperature can be cooled down in a rapid manner, which is beneficial to the prevention of food Nutrition loss and the insurance of freshness. After a running time period of 26 hours

Freezing Fresh Food:

- Do not freeze too large a quantity at any one time. The quality of the food is best preserved when it is frozen right through as quickly as possible
- Do not exceed the freezing capacity of your appliance in 24 h which is 4 kg (9 lb)
- Placing warm food into the freezer compartment causes the refrigeration Compressor to operate continuously until the food is frozen solid

Defrosting

This Freezer will defrost automatically or manually,

In the Event the Freezer is not defrosting automatically the defrost can be selected manually by holding down 'SET' key for 15 seconds, when all the indicator lights illuminate freezing stops and defrost heating starts, at any time if you wish to exit the manual defrosting hold down the 'SET' key for 3 seconds or you can wait until the defrosting programme exits automatically.

When Alarm indicator keeps flashing it indicates fault please contact Shomar aftersales on

01 4505327

WARNINGS!

The fan inside the freezer compartment circulates cold air.

Never insert any object through the guard.

Do not allow children to play with the freezer fan.

Never store products that contain inflammable propellant gas (e.g. dispensers, spray cans etc.) or explosive substances.

Don't cover the shelves with any protective materials, which may obstruct air circulation.

Do not allow children to play with the appliance or tamper with the controls.

Do not obstruct the freezer fan guard to ensure that you obtain the best possible performance from your appliance.

Arrangement of Food in the Freezer

The following guidelines and recommendations should be followed to obtain the best results:

1. The freezer compartment is rated and suitable for the freezing and storage of pre frozen food. The recommendation for storage as stated on the food packaging should be observed at all times.
2. Do not leave frozen food at room temperature to thaw; the best way to defrost Food is to put it in a fridge to thaw slowly.
3. For hygiene reasons, always wrap food using a suitable packaging material before storing in your appliance to avoid contact with the appliance surface.

Temperature Control



When the Refrigerator system is connected to power supply the first time all icons on the display panel illuminate for 2 seconds the default system runs at -18 C

The temperature can be adjusted by pressing the 'SET' key, every time the set key is pressed the current mode indicator lights up to the selected mode setting if set key not pressed with 5 seconds the mode setting is invalid press set to control after setting is complete temperature will immediately controlled as per the mode setting.

The temperature mode cycle as follows -16c -18c -20c-22c-24c



Fast Freezing -16c when the fast freeze function is enabled the compartment temperature can be cooled down in a rapid manner, which is beneficial to the prevention of food nutrition loss and the insurance of freshness. After a running time period of 26 hours the fast freezing function will exit automatically, with the temperature mode restored to original setting.

Cleaning and Care

- We recommend that you switch off the appliance at the socket outlet and pull Out the mains plug before cleaning
- Never use any sharp abrasive instrument, soap, household cleaner, detergent or wax polish for cleaning
- Use lukewarm water to clean the cabinet of the appliance and wipe it dry
- Wipe the inside and outside of your freezer with a damp soft cloth, a soft cloth with a mild detergent may also be used if required
- Excess deposits of ice should be removed on a regular basis with the handle of a spoon. Large accumulation of ice will impair the performance of the appliance
- Check door seals regularly to ensure they are clean and free from food particles

If you are going away on holiday or for any other reason, wish to leave the freezer idle for any period of time, proceed as follows:

- Disconnect from the electric power supply by removing the plug from the wall

Socket

- Remove all food
- Clean and dry the inside as per Cleaning & Care instructions
- Leave the doors open to prevent any unpleasant smells from building up

Top Tips

- Clean and defrost your appliance regularly
- Use a thermometer to check that the temperature is correct
- Store commercially frozen food in accordance with the instructions given on the packets that you buy
- Wrap frozen food when you buy it and put it in to the freezer as soon as possible

- Prepare fresh food for freezing in small portions to ensure rapid freezing
- Don't store poisonous or any dangerous substances in your appliance
- Don't leave the door open for long periods as this will make the appliance more costly to run and cause excessive ice formation
- Don't put hot food into the appliance
- Don't put liquid-filled bottles or sealed cans containing carbonated liquids into the freezer as they may burst
- Don't exceed the maximum freezing loads (4 kg in any 24 hours) when freezing fresh food
- Don't give children ice-cream and water ices direct from the freezer. The low temperature may cause 'freezer burns' on lips
- Don't freeze fizzy drinks
- Keep electrical cable away from all sources of heat / high temperature
- To maintain efficiency keep door opening to a minimum
- Keep ventilation openings clear of obstructions
- The appliance should only be used indoors and should not be exposed to rain or moisture

ENERGY SAVING TIPS

- Ensure your appliance is installed in a well-ventilated area. If the ambient temperature is low (but in no case lower than 10 degrees C), then the energy saving will be more
- Ensure the time between buying chilled/frozen food and placing them in your appliance is kept at minimum, particularly in summer. We recommend you use
A cool bag or a special carrier bag to carry frozen food
- Do not leave the doors of your appliance open longer than necessary and ensure that they are closed properly after each opening

Problem Solving

Check the following:

- That the plug is inserted properly in the socket and that the power supply is on
- That the fuse has blown/circuit breaker has tripped/main distribution switch has been turned off
- That the temperature control has been set correctly
- That the plug is wired correctly if you have changed the fitted plug

Working Defects and Failures

Symptom: **Appliance will not work at all.**

Cause: The power supply plug is not inserted in the wall socket or the plug and the outlet is loose.

To test the supply socket a lamp or small electrical appliance may be used to check that the socket is working.

Symptom: **Noisy running.**

Cause: The appliance has not been properly levelled.

The Freezer is in contact with the wall or the accessories are placed in the wrong position.

Symptom: **Appliance does not cool sufficiently.**

Cause: Door has been opened too often, or for too long a time

Symptom: **All indicator lights on, on display panel.**

Cause: Is the defrosting function enabled

The following are normal:

- Refrigerant running in pipes gives a gentle sound of water running in pipes
- In high humidity the outer surface of the freezer may be covered with condensation that should simply be wiped away
- The compressor and the rear condenser will become hot and should not be touched.

Health & Safety

The use of any electrical appliance requires the following common sense safety rules. There is danger of injury or death and damage to the appliance.

Location

- This appliance is intended to be used in household and residential type environments. It is not suitable for use in shops, offices and other working environments.
- Do not use outdoors or in a bathroom
- Do not place appliance on a highly polished wooden surface as damage may occur

to the surface

- Do not place the appliance on or near a hot surface
- This appliance should not be used in an unheated, cold room i.e. Garage, conservatory, annex, shed, out-house etc.

Mains Cable

- Do not let the lead run across an open space
- Do not let the cable run across a cooker or hot area which may damage the cable

- The mains cable should reach from the socket to the base unit without straining the connections
- The power cord cannot be replaced

Personal Safety

- Avoid touching moving parts. Keep hands, hair and clothing and utensils away from the appliance and fan to prevent personal injury and/or damage to the appliance.
- To protect against the risk of electric shock ensure the electrical connections are kept dry
- This appliance is not intended for use by persons (including children) with reduced physical, sensory or mental capabilities

Children

- Children should be supervised to ensure that they do not play with this appliance
- Teach children to be aware of dangers in the kitchen
- Do not allow children to play with the appliance or tamper with the controls.

Other Safety Considerations

- Do not operate any appliance with a damaged cord or plug or after the appliance malfunctions or has been damaged in any manner
- The use of attachments or tools not pertaining to this appliance may cause fire, electric shock or injury
- Do not use the appliance for anything other than its intended purpose
- Unplug from the outlet when not in use or unattended and before assembling, disassembling and cleaning
- Make sure the appliance is switched off before connecting to or disconnecting from the mains supply

- If the appliance is dropped or damaged in any manner, return the appliance to the nearest authorized dealer or after-sales service centre for examination, repair, electrical or mechanical adjustment

Warranty Information

Registering Your 2 Year Guarantee

Your standard one year guarantee is extended for an additional 1 years when you register the product within 28 days of purchase with the supplier Shomar Ltd. If you do not register the product with Shomar Ltd within 28 days, your product is guaranteed for 1 year. To validate your 2 year guarantee register with us by visiting www.powerpointappliances.ie

Please refer to the one year guarantee for more information.

One Year Guarantee

It is important to retain the retailer's receipt as proof of purchase. Staple your receipt to this back cover for future reference.

Please quote the following information if the product develops a fault. These numbers can be found on the product.

Model no.

Serial no.

Subject to the exclusions set out below (see Exclusions), the faulty appliance will then be repaired or replaced. If for any reason, this item is replaced during the guarantee period, the guarantee on the new item will be calculated from original purchase date. Therefore it is vital to retain your original till receipt or invoice to indicate the date of initial purchase.

To qualify for the 1 year guarantee, the appliance must have been used according to the instructions supplied.

Exclusions

Shomar Ltd shall not be liable to replace or repair the goods under the terms of the guarantee where:

1. The fault has been caused or is attributable to accidental use, misuse, negligent use or used contrary to the manufacturer's recommendations or where the fault has been caused by power surges or damage caused in transit.
2. The appliance has been used on a voltage supply other than that stamped on the products.
3. Repairs have been attempted by persons other than our service staff.
4. The appliance has been used for hire purposes or non-domestic use.
5. The appliance is second hand.

This guarantee does not confer any rights other than those expressly set out above and does not cover any claims for consequential loss or damage. This guarantee is offered as an additional benefit and does not affect your statutory rights as a consumer.

This guarantee is valid in Ireland and the UK only.

PowerPoint products are intended for household use only. See usage limitations within the location safety instructions.

Shomar Ltd has a policy of continuous improvement in product quality and design. The company, therefore reserves the right to change the specification of its models at any time.

Contact Details

The After Sales Division for PowerPoint Appliances is located at the offices of the Brand owner and Distributor – Shomar Ltd, Unit 9 Western Industrial Estate, Dublin 12, Republic Of Ireland.

Helplines (office hours) & Spare Parts contact number is 01-450 5327 or email service@shomar.ie

Reversing Door Instructions

Reversing the Door Swing

1. Make sure that your refrigerator is unplugged.
2. Pry the hinge cover up and off, remove the three screws that secure the upper hinge to the door, then remove the hinge.



3. Remove the freezer compartment door from the cabinet.

4. Remove the screws that secure the lower hinge to the right side of the cabinet, then remove the hinge.

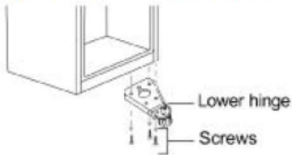

5. Remove the washer and nut that secure the pin shaft to the right hole on the lower hinge, then remove the shaft

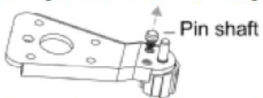

6. Insert the pin shaft into the left hole on the lower hinge, then secure the shaft with the washer and nut.



7. Install the lower hinge on the left side of the cabinet.
10. Remove the screw that secures the door stop from the bottom right of the freezer compartment door, then remove the door stop and install to the bottom left side.

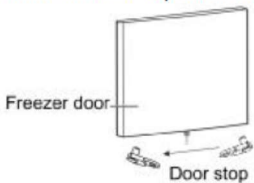

8. Install the freezer compartment door.
9. Move the door bushing from the top right side of the freezer door to the top left side of the door. And move the left hole cover to the right side.

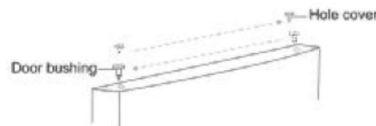

10. Remove the screw that secures the hinge screw hole cover from the top left side of the cabinet, remove the cover and secure the cover on the top right side of the cabinet.

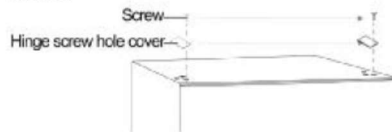

11. Secure the upper hinge to the top left side of the cabinet with the three screws you removed previously. Before you tighten the upper hinge screws, make sure that the top of the door is level with the cabinet and that the rubber gasket makes a good seal.

20. Install the hinge cover over the hinge on the top left side of the cabinet.

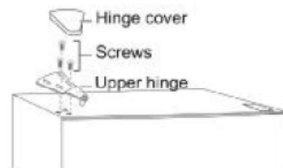

12. Remove the left hole plugs, screw off the bolts, and remove the right hole plugs.

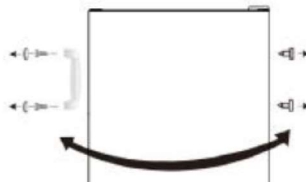

13. Install the right hole plugs on the left side of the door, and install the handle on the right side of the door.



