

# STEALTH



OPERATION MANUAL  
H1-STH

# HELMETS SAVE LIVES!

Always wear a properly fitted helmet that complies with CPSC or CE safety standards when you ride your E-Scooter.

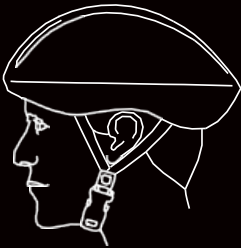

**Correct Fit:**

Make sure your helmet covers your forehead.



**Incorrect Fit:**

Forehead is exposed and vulnerable to serious injury.

## **WARNING**

As with all mechanical components, the Hover-1 Stealth is subject to wear and high stresses. Different materials and components may react to wear or fatigue in different ways. If the design life of a component has been exceeded, it may suddenly fail, possibly causing injuries to the rider. Any form of crack, scratch or change of coloring in highly stressed areas indicate that the life of the component has been reached and it should be replaced. Do not ride in an abusive manner.

## **CAUTION**

In this manual, the CAUTION sign indicates a hazardous situation which, if not avoided, can cause minor or moderate injury.

## **WARNING**

In this manual, the WARNING sign indicates a hazardous situation which, if not avoided, can cause death or serious injury.

## **WARNING**

Great care should be taken with the Hover-1 Stealth when folding or unfolding it. Moving and folding parts can cut skin or pinch if mishandled.

**DO NOT RIDE YOUR HOVER-1 STEALTH WITHOUT THE STEERING COLUMN, FOLDING HINGE, AND HANDLEBARS SECURELY LOCKED IN PLACE.**

# **WARNING!**

## **PLEASE READ THE USER MANUAL THOROUGHLY.**

**Failure to follow the basic instructions and safety precautions listed in the operation manual can lead to damage to your device, property damage, serious bodily injury, and even death.**

Thank you for purchasing the Hover-1 Stealth. Please read all instructions carefully before using it and retain this manual for future reference.

- To avoid collisions, falls, and loss of control, please learn how to ride the Stealth safely.
- You can learn how to ride the Stealth by reading the operation manual and watching videos.
- All users are responsible for any consequences caused by violating warning contents or proper operations. Hover-1 can not be held liable.

## **ATTENTION**

1. Only use the supplied charger from Hover-1 with this E-Scooter.
2. The operating temperature range of the Stealth is 32°F - 104°F (0°C - 40°C).
3. The operating temperature range of the charger is 32°F - 104°F (0°C - 40°C).
4. Do not ride on icy or slippery surfaces.
5. Read the operation manual and warning labels before riding.
6. Store the Stealth in a dry, ventilated environment.
7. When transporting the Stealth, avoid violent crashes or impact.

## **LOW TEMPERATURE WARNING**

Low temperatures will affect the lubrication of moving parts inside the Stealth, increasing internal resistance. Additionally, the discharge capacity and capacity of the battery will be significantly decreased.

Use caution when riding the Stealth in cold temperatures (below 40°F/4°C). Doing so may increase the risk of mechanical failures of the E-Scooter, which may lead to damage to your device, property damage, serious bodily injury, and even death.

## **SAFETY INSTRUCTIONS**

- Keep the E-Scooter away from heat sources, direct sunlight, humidity, water, and any other liquids.
- Do not operate the E-Scooter if it has been exposed to water, moisture, or any other liquids to prevent electric shock, explosion, and/or injury to yourself and damage to the E-Scooter.
- Do not use the E-Scooter if it has been dropped or damaged in any way.
- Repairs to electrical equipment should only be performed by the manufacturer. Improper repairs void the warranty and may place the user at serious risk.
- Do not puncture or harm the exterior surface of the E-Scooter in any way.
- Keep the device free from dust, lint, etc.
- Do not use this E-Scooter for anything other than its intended use or purpose. Doing so may damage the E-Scooter or lead to property damage, injury, or death.
- This product is not a toy. Keep out of reach of children.
- Do not expose the batteries to excessive heat such as direct sunlight or an open flame.
- Do not allow hands, feet, hair, body parts, clothing, or similar articles to come in contact with moving parts, wheels, or the drivetrain while the Stealth is running.

- Do not operate or allow others to operate the Stealth until the user understands all instructions, warnings, and safety features described in this manual.
- Check with your doctor if you have a medical condition that could affect your ability to use the Stealth.
- Persons with head, back, neck ailments, or prior surgeries to those areas of the body are not recommended to use the Stealth.
- Do not operate if you are pregnant or have a heart condition.
- Persons with any mental or physical conditions that may make them susceptible to injury or impair their physical or mental capabilities to recognize, understand, and perform all of the safety instructions and assume the hazards inherent in operation should not use the Stealth.

## SERIAL NUMBER

Please keep the serial number on file for warranty claims as well as proof of purchase. Your serial number is stamped on the bottom of the E-Scooter platform. Record the serial number in the designated area of the "WARRANTY" section of this manual in the event that your Hover-1 Stealth is lost or stolen.

## WARNING!

**WARNING:** Prolonged exposure to UV rays, rain and the elements may damage the enclosure materials. Store indoors when not in use.

# INTRODUCTION

The Stealth is a personal transporter. Our production processes are developed with strict testing for each Stealth E-Scooter. Operating the Stealth without following the contents of this manual may lead to damage to your Stealth E-Scooter or bodily injury.

## WARNING

Make sure you read this complete manual before riding your Hover-1 Stealth. Failure to do so, or failure to follow its guidelines could lead to serious injury or death.

### PACKAGE CONTENTS

- Hover-1 Stealth Electric Scooter
- Charging Cable
- Charger

# SAFETY PRECAUTIONS

- The first rule in safe riding is to use common sense.
- Different localities and countries have different laws governing riding electric transportation devices on public roads. You should check with local officials to ensure you are complying with local traffic law requirements.
- Hover-1 is not liable for tickets or violations given to riders who do not follow local laws and regulations.
- For your safety, always wear a helmet that meets CPSC or CE safety standards. In the event of an accident, a helmet can protect you from serious injury and in some cases, even death.

- Obey all local traffic laws. Obey red and green lights, one-way streets, stop signs, pedestrian crosswalks, etc.
- Ride with traffic, not against it.
- Ride defensively; expect the unexpected.
- Give pedestrians the right-of-way.
- Do not ride too close to pedestrians. Alert them if you intend to pass them from behind.
- Slow down at all street intersections, and look to the left and right before crossing.
- Your Stealth electric scooter is not equipped with reflectors. It is not recommended that you ride in low-visibility conditions.
- If you are riding your Stealth in low-visibility conditions, ensure your LED headlight is turned on and that you are wearing bright, reflective clothing.

## **WARNING**

When you ride in low-visibility conditions such as fog, dusk, or night, you might be difficult to see, which could lead to a collision. To increase your level of safety, be sure wear bright, reflective clothing when riding in low-visibility conditions.

- Do not ride above your skill level. Ensure you have had enough practice with all functions and features of your Stealth.
- Do not ride too fast – with increased speed comes increased risk. If you are moving at a higher speed, small bumps can create strong impacts, leading to a higher risk of injury.
- Do not ride with pets.
- Before stepping on your Stealth, make sure it is placed flat on level ground.



- Do not try to open or modify your Stealth. Doing so voids the manufacturer warranty and may cause your Stealth to fail, resulting in injury or death.
- Do not use the Stealth in a manner that would put people or property in danger.
- If you are riding near other riders, be sure to maintain a safe distance between each other to prevent collisions.
- Be sure to keep your feet on the Stealth at all times. Moving your feet off your Stealth while driving is dangerous and may cause the Stealth to stop suddenly or veer sideways.
- Do not operate the Stealth while under the influence of drugs or alcohol.
- Do not operate the Stealth when you are restless or sleepy.
- Use your best judgment to keep yourself out of dangerous situations with your Stealth.
- Do not ride your Stealth off of curbs, ramps, or attempt to operate in a skate park, empty pool, or in any way similar to a skateboard. Misuse of your Stealth voids the manufacturer warranty and may lead to injury or damage.
- Do not abuse your Stealth. Doing so can damage your unit and cause failure to the operating system, which may lead to injury. Physical abuse, including dropping your Stealth, voids the manufacturer warranty.
- Do not operate in or near puddles of water, mud, sand, stones, gravel, debris, or near rough and rugged terrain.
- The Stealth can be used on paved surfaces that are flat and even. If you encounter uneven pavement, lift your Stealth over and past the obstruction.
- Do not ride in inclement weather: snow, rain, hail, sleet, on icy roads, or in extreme heat or cold.
- Bend your knees when riding on bumpy pavement to absorb the shock and vibrations. This will help you keep your balance.
- If you are unsure if you can safely ride on a specific terrain, step off

## **WARNING**

Proper use of your brake is vital to ensure safe, efficient stopping. To avoid misuse and potential injury, do not apply sudden or excessive force to your brakes. Apply your brakes gradually and give yourself enough room to come to a complete stop safely.

and carry your Stealth. Always be on the side of caution.

- Do not attempt to ride over bumps or objects greater than ½ inch, even when prepared and bending your knees.
- Pay attention. Look where you are riding and be conscious of the road conditions, people, property, and objects around you.
- Do not operate the Stealth in crowded areas.
- Operate your Stealth with extreme caution when indoors, especially around people, property, and narrow spaces.
- Do not operate the Stealth while talking, texting, or looking at your phone.
- Do not ride your Stealth where it is not permitted.
- Do not ride your Stealth near motor vehicles or on public roads.
- Do not travel up or down steep hills.
- The Stealth is intended for use by a single individual, DO NOT attempt to operate the Stealth with two or more people.
- Do not carry anything while riding the Stealth.
- Individuals with lack of balance should not attempt to operate the Stealth.
- Young children and the elderly should not operate the Stealth.
- At higher speeds, always take longer stopping distances into consideration.
- Do not attempt to jump on or off your Stealth.
- Do not attempt any stunts or tricks with your Stealth.

- Do not ride the Stealth in dark or poorly lit areas.
- Do not ride the Stealth near or over potholes, cracks, or uneven pavement or surfaces.
- Do not operate your Stealth off-road.
- Do not turn sharply, especially at high speeds.
- Do not exceed the maximum weight limit of 264 lbs (120 kg).
- Avoid driving the Stealth in unsafe places, including areas with flammable gas, steam, liquid, dust, or fiber that could cause fire and explosion accidents.
- Do not operate near swimming pools or other bodies of water.
- Maintain a safe braking distance during wet conditions.

## **WARNING**

There may be additional risk of injury if you use your E-Scooter incorrectly. This includes, but is not limited to:

- Jumping your E-Scooter
- Riding over debris or obstacles
- Performing stunts
- Riding in off-road terrain
- Riding fast
- Racing other riders
- Riding in unusual manner

The aforementioned examples add stress to each part of your E-Scooter and can lead to long term damage of the device. Damage to your E-Scooter can lead to an accident or increase your risk of injury. To decrease your risk of injury, use your E-Scooter correctly.

## WARNING

To reduce the risk of injury, adult supervision is required. Never use in roadways, near motor vehicles, on or near steep inclines or steps, swimming pools or other bodies of water. Always wear shoes, and never allow more than one rider.

## CARE & MAINTENANCE

- To avoid damage to the Stealth's internal circuitry, do not expose it to liquid, moisture, or humidity.
- Do not use abrasive cleaning solvents to clean the Stealth.
- Do not expose the Stealth to extremely high or low temperatures, as this will shorten the life of the device, destroy the battery, and/or distort certain plastic parts.
- Do not dispose of the Stealth in fire as it may explode or combust.
- Do not let the Stealth come into contact with sharp objects, as this will cause scratches and damage.
- Do not let the Stealth fall from high places, as doing so may damage the internal circuitry.
- Do not attempt to disassemble the Stealth.
- Only use the charger provided by Hover-1.
- Only use the manufacturer's authorized replacement parts.

## WARNING

Avoid using water or other liquids for cleaning. If water or other liquids enter the Stealth, it will cause permanent damage to the internal components.

## WARNING

Users who disassemble the Stealth E-Scooter without permission will void the warranty.

# BATTERY CARE / MAINTENANCE

## BATTERY SPECIFICATIONS

Battery Type: Rechargeable lithium-ion battery

Charge Time: Up to 10 hours

Battery Voltage: 36V

Battery Capacity: 13Ah

Working Temperature: 32°F - 104°F (0°C - 40°C)

Charging Temperature: 32°F - 104°F (0°C - 40°C)

Storage Time: 1 year

Storage Temperature: 32°F - 104°F (0°C - 40°C)

Storage Humidity: 5% - 95%

## BATTERY MAINTENANCE

- The lithium-ion battery is built into the E-Scooter. Do not disassemble the E-Scooter to remove the battery or attempt to separate it from the E-Scooter.
- When charging the E-Scooter, only use the enclosed 1-pin charging cable provided by Hover-1. Use of any other charger or cable may lead to damage to the E-Scooter, overheating, and risk of fire. Use of any other charger or cable voids the manufacturer warranty.
- Do not connect or attach the E-Scooter or the battery to a power supply plug or directly to a car's cigarette lighter.
- Do not place the E-Scooter near a fire or leave it out in direct sunlight. Heating the E-Scooter can break or ignite the battery inside the device.
- Do not continue charging the battery if it does not recharge within the specified charging time. Doing so may cause the battery to become hot, rupture, or ignite.
- To preserve natural resources, please recycle or dispose of batteries properly. This product contains lithium-ion batteries. Local, state, or federal laws may prohibit disposal of lithium-ion batteries in ordinary trash. Consult your local waste authority for information regarding available recycling and/or disposal options.

## WARNING

Failure to follow the safety precautions listed below could lead to serious bodily injury and/or death.

- Do not attempt to modify, change, or replace your battery.
- Do not use your device if the battery begins to emit odor, overheats, or begins to leak.
- Do not touch any leaking materials or breathe fumes emitted.
- Do not allow children or animals to touch the battery.
- The battery contains dangerous substances. Do not open the battery or insert anything into the battery.
- Do not attempt to charge the device if the battery has discharge or emits any substances. In that case, immediately distance yourself from the battery in case of fire or explosion.

 **WARNING**

SEEK IMMEDIATE MEDICAL ASSISTANCE IF  
YOU ARE EXPOSED TO ANY SUBSTANCE  
THAT IS EMITTED FROM THE BATTERY.

# SPECIFICATIONS

Model:	H1-STH
Net Weight:	40 lbs (18 kg)
Max Supported Weight:	220 lbs (100 kg)
Max Speed:	Up to 20 mph (32 km/h)
Max Range:	Up to 30 miles (48 km)
Battery Type:	Lithium-ion
Motor Power:	500W Brushless Motor
Battery Voltage:	36V
Battery Capacity:	13Ah
Charge Time:	Up to 10 hours
Power Requirement:	100V-240V, 50Hz/60Hz
Folding Size:	43.7 in. x 18 in. x 21.5 in. (111 cm x 45.7 cm x 54.6 cm)
Open Size:	43.7 in. x 18 in. x 50.7 in. (111 cm x 45.7 cm x 128.7 cm)
Tire Type:	Tubeless Tires
Tire Size:	10" Front & Rear
Brake Type:	Front & Rear Disc Brakes
UL Certification:	UL2272 certified

# PARTS LIST

- A. Stealth E-Scooter
- B. Torx Flat Head Screw (5)
- C. Charger + Charging Cable
- D. Battery Key
- E. Torx Key

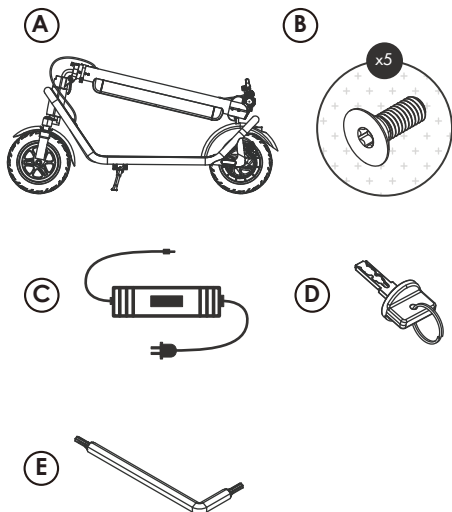

# HOVER-1 STEALTH DIAGRAM

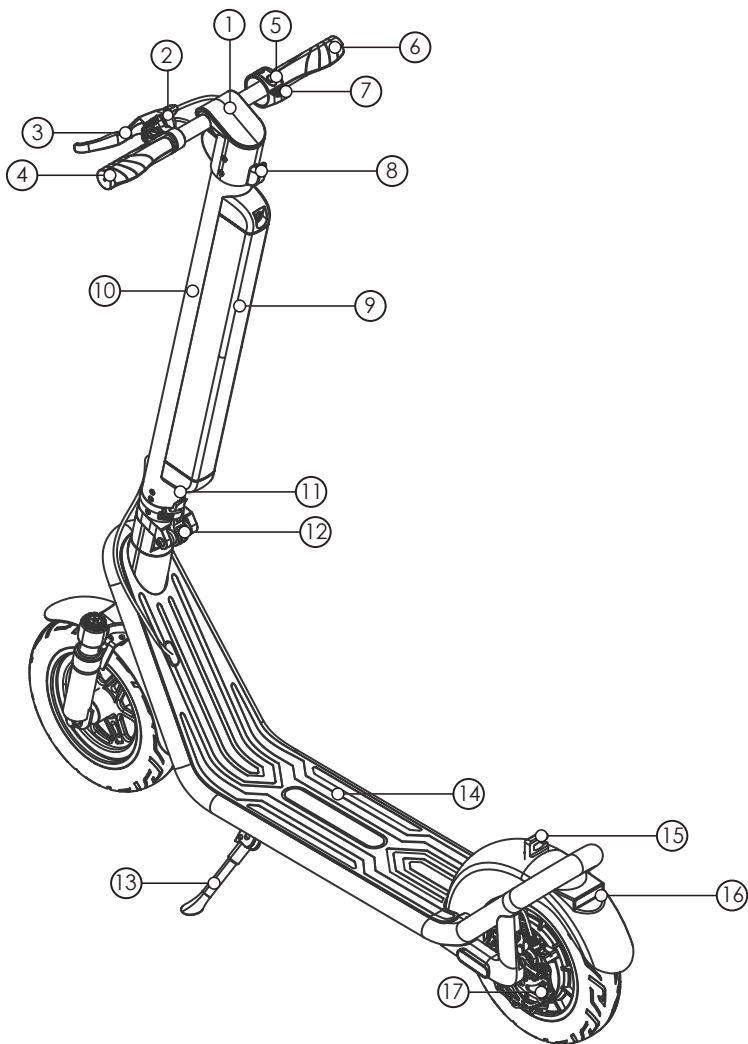

## FEATURES/PARTS

- |                  |                      |
|------------------|----------------------|
| 1. LCD Display   | 9. Removable Battery |
| 2. Bell          | 10. Steering Column  |
| 3. Brake Handle  | 11. Charging Port    |
| 4. Handlebar (L) | 12. Folding Lock     |
| 5. Power Button  | 13. Kickstand        |
| 6. Handlebar (R) | 14. Footdeck         |
| 7. Throttle      | 15. Fender Hook      |
| 8. Folding Hook  | 16. Taillight        |
|                  | 17. Rear Disc Brake  |



# HOVER-1 STEALTH DIAGRAM

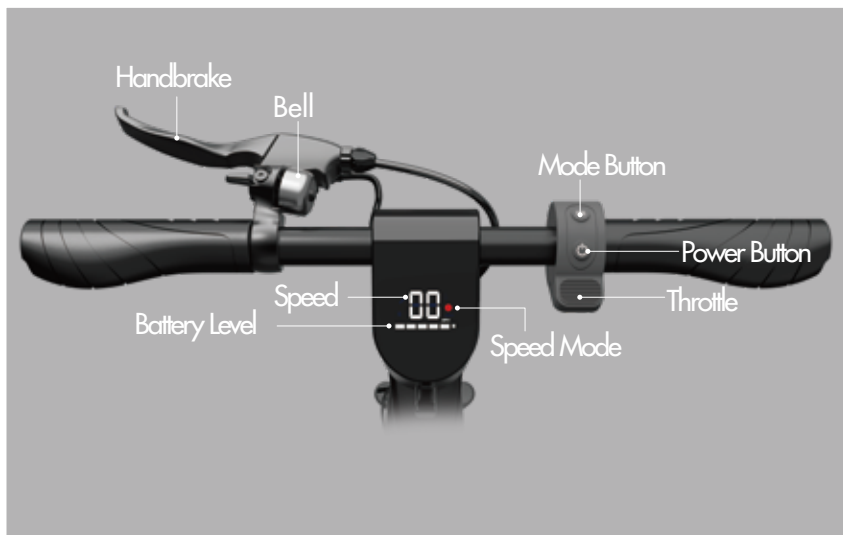

## LCD DISPLAY

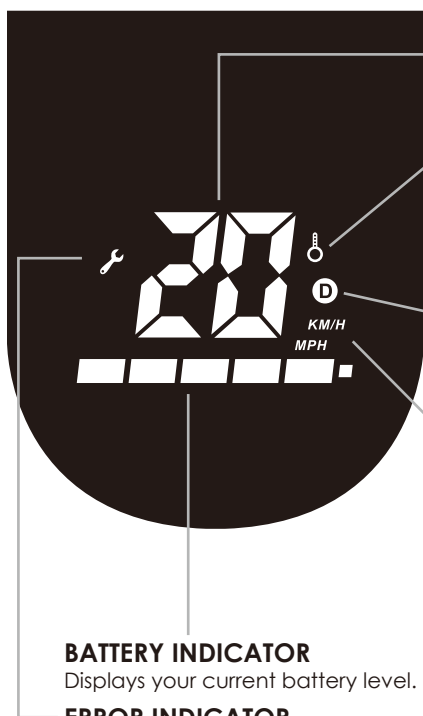

### SPEEDOMETER

Displays your current speed

### HIGH TEMPERATURE ALERT ICON

When the temperature of the device's control board is too high, this icon will flash on your display. Stop riding immediately, turn off your E-Scooter, and allow it to cool for 30 minutes before riding again.

### SPEED MODE ICON

Indicates current speed mode:  
Off = Low Speed Mode  
White = Touring Mode  
Red = Sport Mode

### SPEED UNITS

Indicates MPH or KM/H.

### BATTERY INDICATOR

Displays your current battery level.

### ERROR INDICATOR

Indicates issues with the E-Scooter.

# SETTINGS MENU

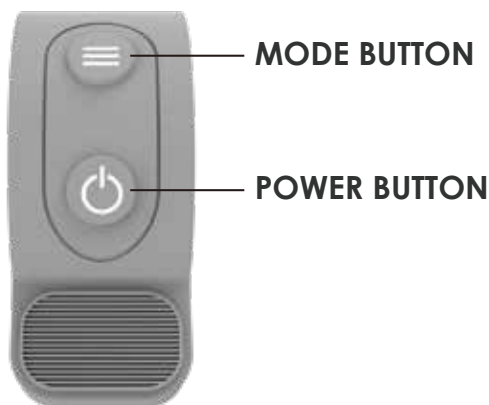

## Menu Navigation

1. Press and hold the power button and the mode button at the same time to enter the settings menu
2. Press the mode button to cycle through settings (from P0 to P2)
3. Press the power button to select the displayed P setting
4. Press the mode button to modify the selected P setting
5. Press the power button to confirm and exit the selected P setting
6. Press the power button and the mode button at the same time to exit the settings menu

## P0 - P2 Settings

Item	Function	Description
P0	Speed Units	Km/h - 0   Mph - 1 (1 by default)
P1	Cruise Control	0 - OFF   1 - ON (1 by default)
P2	Kick to Start	0 - OFF   1 - ON (1 by default)

# CHARGING YOUR STEALTH

## CHARGING THE DEVICE

- Ensure that the charging port is clean and dry.
- Make sure that there is no dust, debris, or dirt inside the port.
- Plug the charger into a grounded wall outlet.
- Connect the cable with the power supply (100V-240V; 50 Hz/60 Hz).
- Align and connect the 1-pin charging cable into the charging port of the Stealth (DO NOT FORCE OR BEND THE CHARGING CABLE AS IT MAY CAUSE THE PRONGS TO BEND OR BREAK).
- The charging indicator light on the charger itself should change to red, indicating that your E-Scooter is now being charged.
- When the red indicator light on your charger changes to green, your E-Scooter is fully charged.
- After fully charging your E-Scooter, unplug the charger from your device and from the wall outlet.
- If the E-Scooter is not used for an extended period of time, you may need to recharge the battery every 2 months to maintain the battery life.

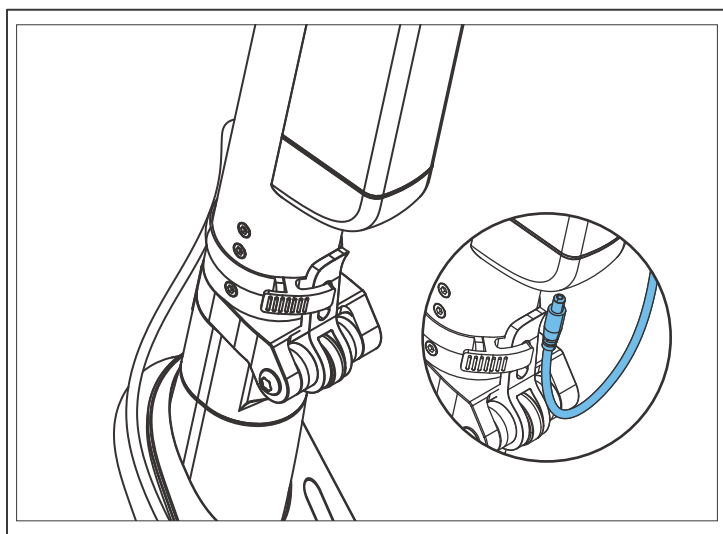

## CAUTION

Only use the included charging cable and charger to charge your Hover-1 Stealth. Using any other unauthorized charger may damage your Hover-1 Stealth.

# ASSEMBLING YOUR STEALTH

PLEASE READ THE FOLLOWING INSTRUCTIONS CAREFULLY

## ATTACHING THE HANDLEBAR ASSEMBLY

1. Make sure the wiring in the steering column is connected, then attach the handlebar assembly to the top of the steering column.
2. Screw the 5 Torx screws into the holes pictured below. There are two holes on each side of the steering column and one hole under the headlight.
3. Tighten each screw and ensure the handlebar assembly is securely attached.

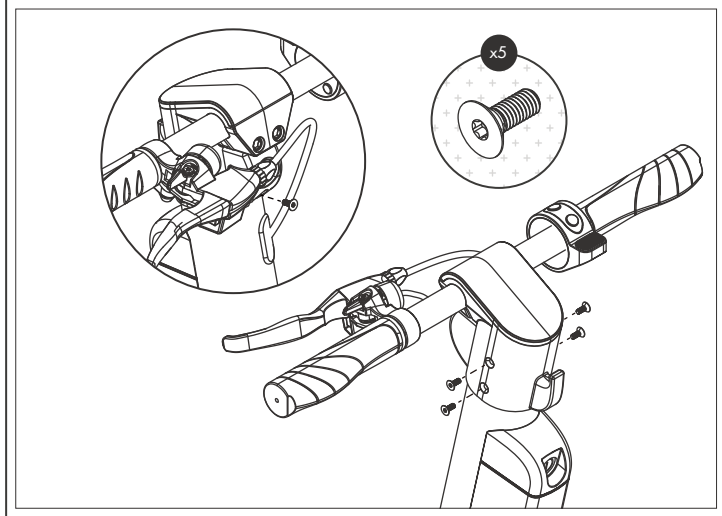
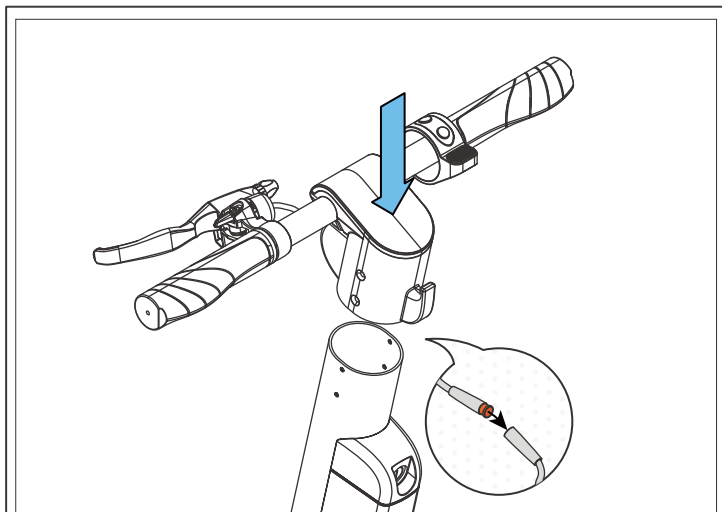

## PINCH POINTS

Some parts of your Stealth can injure you if mishandled. Moving and folding parts can cut skin. Clamps and pivoting parts such as brake levers can pinch. When folding and unfolding your Stealth, please watch for pinch points where injury may be sustained. Do not leave your hand in these areas during the folding or unfolding process.

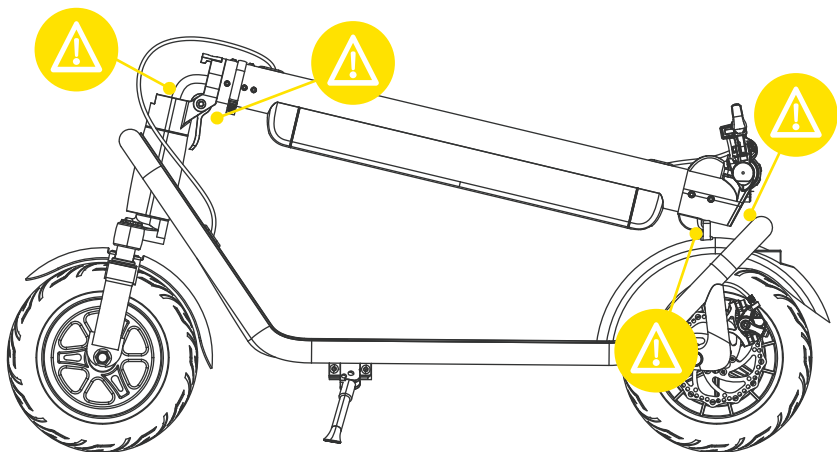

## INSERT/REMOVE THE BATTERY

To remove the battery, insert the included key into the battery key hole and turn it clockwise. Pull the battery out after it ejects. The battery can be charged while it is removed from the Stealth.

To place the battery back into the Stealth, insert the bottom end of the battery in first, then push the top end of the battery into the the steering column. The battery will lock in place. Make sure the battery is secure before riding.

## TURN HEADLIGHT/TAILLIGHT ON/OFF

While the Stealth is powered on, press the mode button twice to turn the headlight and taillight on or off.

# FOLDING & UNFOLDING

## FOLDING & UNFOLDING YOUR STEALTH

To fold your Stealth, use your thumb to push the twist lock counter-clockwise until it is no longer in front of the folding lock. Grab the folding lock with one hand and hold the steering column with the other. Pull the folding lock down and push the steering column down to the foot deck. Thread the folding hook into the fender hook.

To unfold your Stealth, remove the folding hook from the fender hook and raise the steering column until it is standing up. Pull the folding lock up and press it against the steering column. Use your thumb to push the twist lock until it is positioned in front of the folding lock. Ensure the steering column is secure.

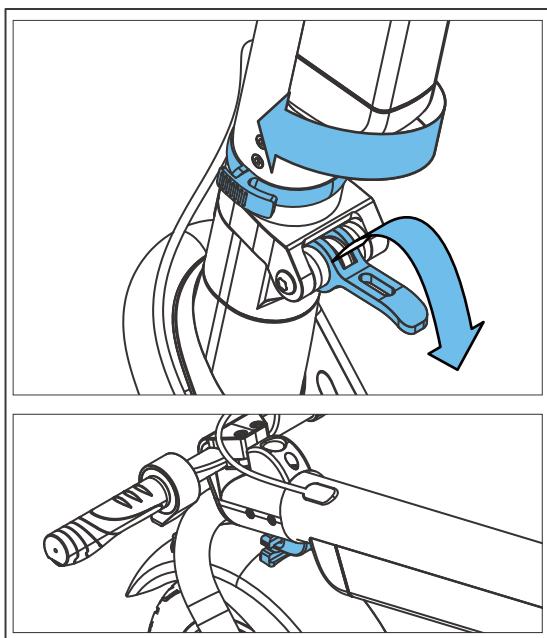

## SPEED MODES

The Stealth will be set to low speed mode by default. To change speed modes, power on the Stealth, then press the mode button once. The speed mode indicator should light up white on your display to indicate Touring mode is activated. Press it once more and the light will change to red to indicate Sport mode is activated.

## KICK TO START

For safety reasons, the Stealth will not accelerate unless it is already moving at least 1.8 mph (3 km/h). You must first kick off the ground to get a rolling start and then press the throttle in order to ride the Stealth. Kick to start can be disabled in the settings menu.

## CRUISE CONTROL

Cruise control will automatically activate while riding if you maintain a constant speed for 5 seconds. You will hear a beep when it activates. Cruise control allows you to ride at a constant speed without using the throttle. Press the throttle down once or engage the brake to cancel cruise control. Cruise control can be disabled in the settings menu.

## BEFORE RIDING

### WARNING

Any Stealth E-Scooter that does not work properly can cause you to lose control and fall. Do not ride a Stealth with a part that is damaged. Replace the damaged part before riding.

Before each use, the E-Scooter operator shall perform the pre-operation checks as specified below:

- The area that the unit is to be operated in is safe and suitable for safe operation.
- The braking system is functioning properly.
- All safety labels are in place and understood by the operator.
- Any and all axle guards, chain guards, or other covers and guards supplied by the manufacturer are in place and in serviceable condition.
- The tires are in good condition, inflated properly, and have sufficient tread remaining.

It is important that you fully understand all the functions of your Stealth E-Scooter. If these functions are not used correctly, you will not have full control of your Stealth.

Practice using your Stealth at slower speeds in a flat, open area until you are comfortable riding it.

## PRE-RIDE CHECKLIST

Ensure that your Stealth is in proper working order each time you ride. If a part of the Stealth does not function correctly, please contact our Customer Support Center.

- Ensure the battery is fully charged before riding your E-Scooter.
- Please wear all appropriate safety and protective gear before operating your E-Scooter.
- Make sure to wear comfortable clothes and flat, closed-toe shoes when operating your E-Scooter.

## RIDING YOUR STEALTH

**FAILURE TO FOLLOW ANY OF THE FOLLOWING SAFETY PRECAUTIONS MAY LEAD TO DAMAGE TO YOUR DEVICE, DAMAGE TO PROPERTY, VOID YOUR MANUFACTURER WARRANTY, AND MAY CAUSE SERIOUS BODILY INJURY OR DEATH.**

### OPERATING YOUR DEVICE

Make sure the device is fully charged before the first use. Before turning on your Stealth E-Scooter, ride it like a normal kick scooter to get comfortable with the device before using it with the motor.

When you are comfortable riding the E-Scooter, power it on. For the motor to activate, you must first push off the ground with your foot to get the E-Scooter moving, then press the throttle down with your thumb.

To slow down, disengage the throttle and squeeze the brake handle to engage the brake. The brake is pressure-sensitive, so a tighter squeeze will result in more stopping power. Do not attempt to stop suddenly, as this may lead to injury or damage to your brakes.

Use the handlebars to turn the Stealth in the desired direction.

The Stealth can be operated manually if you do not wish to use the motor.

At higher speeds, it is necessary to shift your weight when making turns to maintain your stability.

Prepare to brace yourself if you encounter bumps or uneven surfaces. If necessary, dismount your Stealth and carry it to a safe operating surface.



## **WARNING**

Do not turn sharply or at high speeds. Do not turn or ride quickly along slopes, as it may cause injury.

### **SPEED AND WEIGHT LIMITATIONS**

Speed and weight limits are set for your own safety. Please abide by the limits listed here in the manual.

- Maximum Speed: 20 mph
- Maximum Supported Weight: 220 lbs

## **WARNING**

Riding the Stealth while exceeding the weight limit may increase the possibility of injury or product damage.

### **OPERATING RANGE**

The Stealth can travel up to 30 miles on a fully charged battery under ideal riding conditions. The following are some of the major factors that will affect the operating range of your device:

- **Terrain:** Operating range is highest when riding on a smooth, flat surface. Riding uphill and/or on rough terrain will reduce the operating range significantly.
- **Weight:** A lighter user will have a higher operating range than a heavier user.
- **Ambient Temperature:** Please ride and store the E-Scooter in recommended temperatures. This will preserve the operating range, battery life, and overall performance of your device.
- **Speed and Riding Style:** Maintaining a moderate and consistent speed while riding produces maximum operating range. Traveling at high speeds for extended periods of time, frequent starts and stops, and idling will decrease operating range.

## **WARNING**

Proper use of your brake is vital to ensure safe, efficient stopping. To avoid misuse and potential injury, do not apply sudden or excessive force to your brake. Apply the brake gradually and give yourself enough room to come to a complete stop safely.

## **SAFETY ALERTS**

If a system error occurs or an improper operation is performed while riding your Stealth, the device will alert the user in a variety of ways.

The following are common occurrences that will produce safety alerts. These notices should not be ignored and appropriate action should be taken to correct any improper operation, failure, or errors.

- Prohibited riding surfaces (uneven, too steep, unsafe, etc.)
- Battery voltage is too low.
- The E-Scooter is still charging.
- The E-Scooter is overheating, or the motor temperature is too high.
- When the battery is about to run out of power, the battery icon will flash.
- If any tires are blocked, the device will stop after 10 seconds.
- When the battery level has depleted below protection mode, the motor will power off after 15 seconds.
- If a high discharge current is produced during use (such as riding up a steep slope for a long period of time), the motor will shut off after 15 seconds.

# WARRANTY

For warranty information, please visit us at [www.hover-1.com](http://www.hover-1.com)

Error codes	Error code EA - controller / instrument communication failure, the controller needs to be replaced
	Error code EB - accelerator failure, the accelerator needs to be replaced
	Error code EC - motor failure, check the wiring of the motor hall communication line. If the wiring is connected, the motor needs to be replaced
	Error code ED - motor blocking fault, release the accelerator
	Error code EE - battery over-voltage protection, the battery needs to be replaced
	Error code EF - mainboard MOS tube failure, the mainboard needs to be replaced

Manufacturer: DGL Group, Ltd.  
2045 Lincoln Highway, Edison, NJ 08817

Affix Serial Number Label Here:



@RideHover1



@RideHover1



@RideHover1



[www.Hover-1.com](http://www.Hover-1.com)