



User Manual

Evaporative Air Cooler

Before using your TOSOT Evaporative Air Cooler,
please read this user manual in its entirety.

MODEL NUMBER

KSWA-04S63Dg

TOSOT

Welcome to the TOSOT Direct Family!

We're extremely happy to welcome you as a new member of our family! Please read the tips below before using your product.

Tips

Keep the original packaging material including packing foam, carton and printed material until you decide to keep the unit. If you need to return the unit, having all of the original packaging material will make it much easier.

1. If you have not operated the humidification function within the last month, please clean the water tank before powering on.
2. Replace the water in the water tank every day to prevent the growth of bacteria.

Table of Contents

Important Safety Instructions	01
Installation and Setup	01
Electrical Safety Warning	02
Specifications	03
Parts List	04
Installation	05
Features	07
Using the Ice Pack	07
Using the Aromatherapy Box	08
Half-Light Display	08
Memory Function	08
Auto Standby	08
Operation	09
Adding Water	09
Control Panel	10
Remote Control	12
Maintenance	13
Troubleshooting	14
Warranty&Customer Support	15

Safety and Instructions

Your safety and the safety of others are very important to us. Please read the following safety precautions before use and installation. A digital version can be obtained from customer support.

Installation and Setup

- This appliance is not intended for use by persons (including children) with reduced physical, sensory, or mental capabilities or lack of experience and knowledge unless they have been given supervision or instruction concerning the use of the appliance by a person responsible for their safety. Children should be supervised to ensure they do not play with the appliance.
- Do not place the unit under high temperature or low temperature. In the summertime, the water may evaporate and cause odor, so please add fresh water regularly. In the wintertime when the indoor temperature is below 32°F, please add warm water into the water tank if you want to use it. After operation, use a towel to dry the water tank.
- Don't insert foreign objects into air inlet or air outlet.
- Do not let liquid get into the air cooler. Do not wash the product in water.
- The water level in the tank should not exceed the highest water level, and during humidification, the total water level in the tank should not drop below the lowest water level.
- After the water tank is filled with water, do not tilt the unit when placing or moving it. To move the unit, please move it slowly to prevent water overflow.
- To Reduce The Risk Of Fire, Electric Shock Or Injury To Persons, Do Not Use Replacement Parts That Have Not Been Recommended By The Manufacturer (e.g. Parts Made At Home Using A 3D Printer).

Electrical Safety Warning

- Always plug into a fixed 120V 60 Hz AC outlet.
- To prevent overload, do not use a multi-plug power strip. The capacity of the power socket should be the same as that of the plug of electric appliances. The plug must be inserted into the socket tightly.
- **WARNING:** To reduce the risk of fire or electric shock, do not use this air cooler with any solid-state speed control device.
- Do not use the air cooler if the cord or plug is damaged.
- Do not wind the appliance with the power cord; otherwise, the insulating coating of the power cord may be damaged.
- Do not cover the power cord with a rug or carpeting. Do not route the cord under furniture or appliances.
- Only for household use. Do not use the unit outdoors or for commercial use.
- When you do not use the product, please unplug the power plug. Please be careful when inserting or plugging the plug. Do not pull the power cord by hand.

When using the humidification function, do not operate it in an enclosed space for a long time to prevent high humidity.

- Do not bend the power cord or put heavy objects on the power cord. This product employs overload protection (fuse). A blown fuse indicates an overload or short-circuit situation. If the fuse blows, unplug the product from the outlet. Replace the fuse as per the user servicing instructions (follow product marking for proper fuse rating) and check the product. If the replacement fuse blows, a short-circuit may be present and the product should be discarded or returned to an authorized service facility for examination and/or repair.

- User Servicing Instructions
 - a) Grasp plug and remove it from the receptacle or other outlet device. Do not unplug by pulling on the cord.
 - b) Open the fuse cover. Slide open fuse access cover on top of attachment plug towards blades.
 - c) Remove the fuse carefully. Push the fuse from the other side to remove the fuse.
 - d) Risk of fire. Replace fuse only with 2.5 Amp, 125 Volt fuse.
 - e) Close fuse cover. Slide closed the fuse access cover on top of attachment plug.
- Risk of fire. Do not replace the attachment plug. Contains a safety device (fuse, AFCI, LCDI) that should not be removed. Discard the product if the attachment plug is damaged.

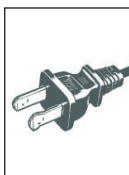
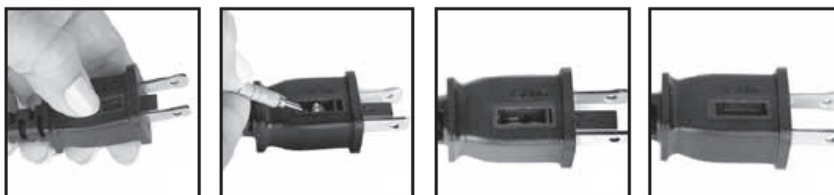

THIS APPLIANCE HAS A POLARIZED PLUG (one blade is wider than the other). To reduce the risk of electric shock, this plug is intended to fit in a polarized outlet only one way. If the plug does not fit fully in the outlet, reverse the plug. If it still does not fit, contact a qualified electrician to install the proper outlet. Always use AC 120V~,60Hz power supply.

DO NOT ATTEMPT TO MODIFY THIS PLUG OR DEFECT THIS SAFETY FEATURE IN ANY WAY.

Specifications

Power Supply	AC120V, 60Hz
Rated Power	50W
Tank Capacity	1.06Gal / 4L
Max Noise Level	63dB(A)

Parts List

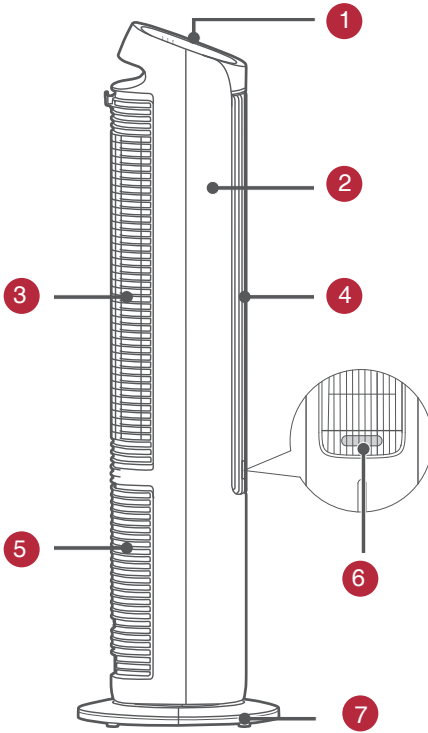

Remote Control

1 Control Panel

2 Front Case

3 Cooling Pad and Grill

4 Air Outlet

5 Water Tank

6 Aromatherapy Box

7 Base

Installation

Please assemble the base according to the following installation method. Do not use it if not assembled properly.

1. Take the two parts of the base and the unit body out of the box. Rotate the two part of the base along the semicircular positioning slot until they are at the same level as the bottom surface and the clasps at the two sides are locked.

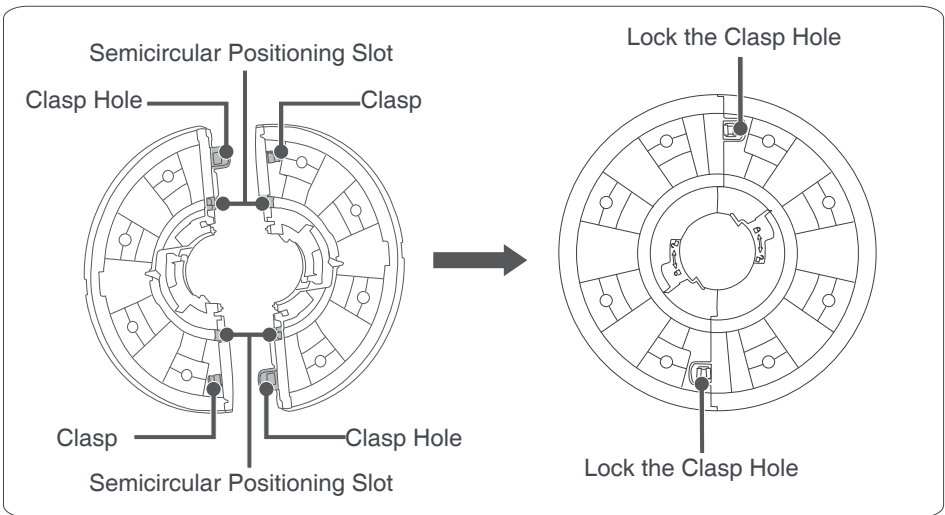

2. Let the power cord of the unit pass through the cable hole of the base.
3. After aligning the long base slot with the long clasp on the bottom of fan, rotate it counterclockwise and then install the power cord on the cable groove of the base. Pay attention to fixing the power cable in the cable clasp and straightening it.

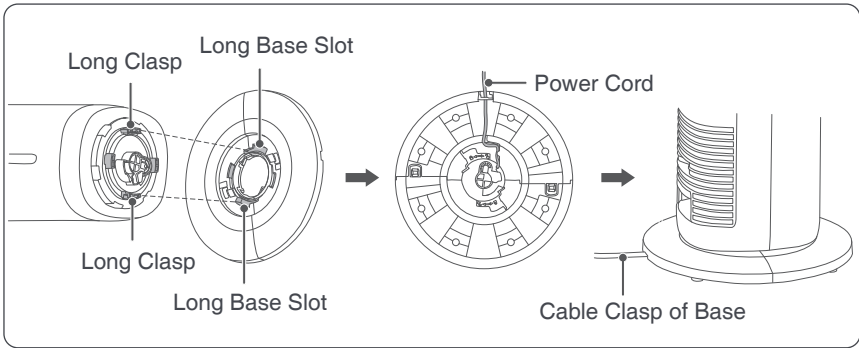

Note:

1. When you hear a “click” sound while rotating the base, it indicates that the base is assembled. Do not rotate it forcibly to avoid damaging the oscillation function.
2. When the unit is operating, do not turn the unit body or base forcibly.

Features

Using the Ice Pack

You can also choose to use it or not based on the temperature. The ice pack can be frozen repeatedly and reused.

Note:

1. Before placing or taking out the ice pack, make sure to turn off the unit and remove the power cord from the power outlet.
2. Do not open the cover of the ice pack or eat the ice crystal inside the ice pack.

- Before using, please place the ice pack in the freezer for about 4 hours, then place it in the water of the internal water tank. Make sure the water level does not exceed the highest water level mark after placing the ice pack inside.
- If you don't want to use the ice pack, pull out the water tank from the back side and then remove the ice pack.

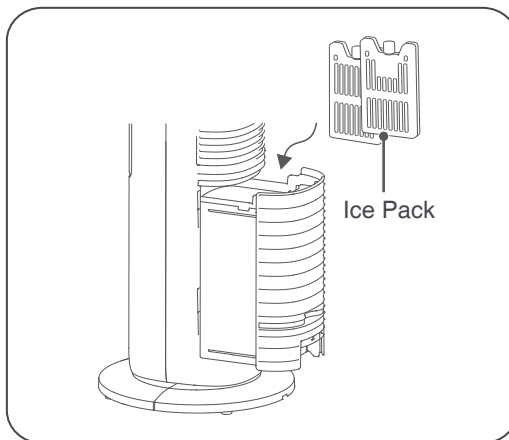

Using the Aromatherapy Box

- Pull out the aromatherapy box from the fan and take out one piece of the cotton inside.
- Drop 1-2 drops of essential oil onto the cotton and put the aromatherapy box back into the fan.

Note: Do not let the aromatherapy oil contact other parts except the aromatherapy box (such as the air louver, body, etc.) to prevent damage. If it has contacted other parts, please clean and wipe them with a dry cloth.

Half-Light Display

If there is no operation for 40 seconds, the light will reduce the brightness by 50%. Press any button to exit the half-on status.

Memory Function

Under standby status, the previous setting will be memorized and the unit will work according to the memorized setting when it is turned on again.

Auto standby

Under operating status, if there is no operation in 15 hours, the unit will automatically enter standby mode.

Operation

Adding water

- Before pulling out the water tank, please be sure to turn off the power.
- Add water but do not exceed the highest water level.
- Don't exert too much force when removing or inserting the water tank to avoid damaging the components. When removing, please make sure the residual water inside the honeycomb cooling pad has dripped back to the water tank to prevent it from spilling outside the unit.

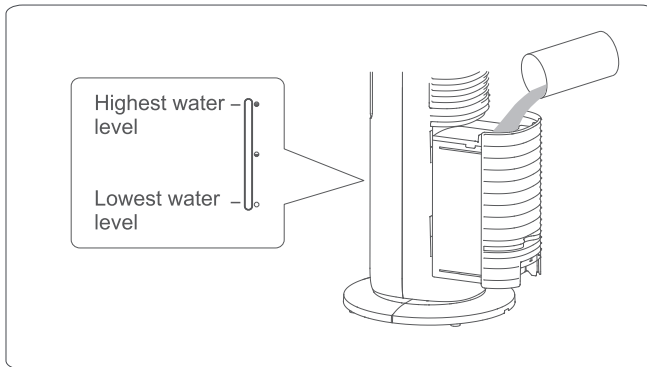

Control Panel

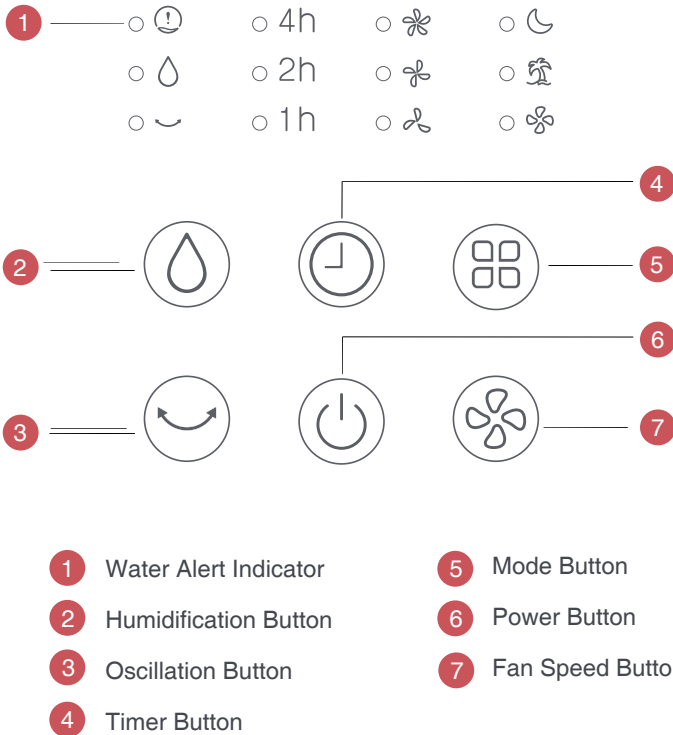

1 Water Alert Indicator

- Flashes to indicate there is not enough water in the water tank.
- Please add water according to the “Adding water” section and press the humidification button to restart the function.

2 Humidification Button

- Press this button to turn on/off the humidification function and the humidification indicator will be on.
- Before starting the humidification function, please check the water level inside the water tank. If the water level is close to or below the lowest water level mark, please add water.

3 Oscillation Button



- Press this button to turn on/off the oscillation function. When the oscillation function is set, the oscillation indicator will light up.
- Don't twist the fan forcibly to change the air supply direction which will damage the product.
- The oscillation range is 80°.

4 Timer Button

Press this button to activate the timer function. The time setting range is 1-7 hours. Holding the button for 2 seconds will cause the timer to change rapidly. The corresponding time indicator will be on. After reaching 7h, press the button again to cancel the timer function and the indicator will turn off.

5 Mode Button

Press this button to choose among 3 modes: general wind, natural wind, and sleeping wind.

	General wind	Blow wind on the set fan speed.
	Natural wind	The fan speed will change automatically.
	Sleeping wind	The fan speed will decrease automatically according to the preset program.

6 Power Button

Press this button to power on/off the fan.

7 Fan Speed Button

Press this button to cycle the fan speed between low, mid, and high.

Remote Control

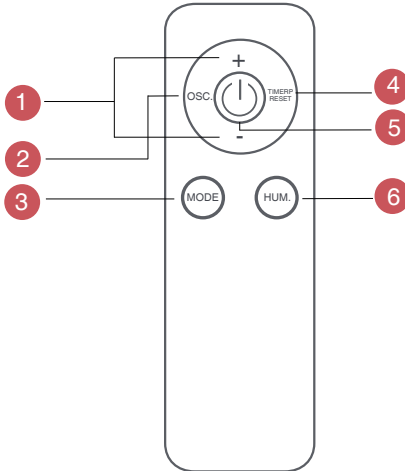

- 1 +/- Button
- 2 Oscillation Button
- 3 Mode Button
- 4 Timer Button
- 5 Power Button
- 6 Humidification Button

1 +/- Button

Press this button to increase/decrease the fan speed.

2 Oscillation Button

Press this button to turn on/off the oscillation function.

3 Mode Button

Press this button to choose among 3 modes: general wind, natural wind, and sleeping wind.

4 Timer Button

Press the button to set the timer from 1 to 7 hours. Holding the button for 2 seconds will cause the timer to change rapidly. After reaching 7h, press the button again to cancel the timer function and the indicator will be off.

5 Power Button

Press this button to power on/off the unit.

6 Humidification Button

Press this button to turn on/off the humidification function.

Maintenance

- Please be sure to cut off the power before maintenance.
- Use a wet cloth to wipe the surface of the unit. Do not wash the unit with water. Do not use a corrosive detergent to clean the unit.
- Place your thumb in the pressing groove of the water tank, and squeeze the clasp of the water tank upward with the remaining four fingers to pull out the water tank completely. Do not pull the water tank with excessive force.
- The water pump is fixed at the bottom of the water tank. When you reach into the water tank with one hand, gently pinch the pressing plates on both sides of the water pump to take out the water pump and pull out the filter of the water pump.
- Use a soft brush or soft cloth to clean the water tank and the filter of the water pump, and then clean them up with clear water.

Tips:

In order to keep the unit in the best condition and prolong the service life of the unit, please clean the water tank and the filter of the water pump once every two weeks. If the unit is used in a poor environment (such as too much dust or scale, or poor water quality), please increase the cleaning frequency appropriately.

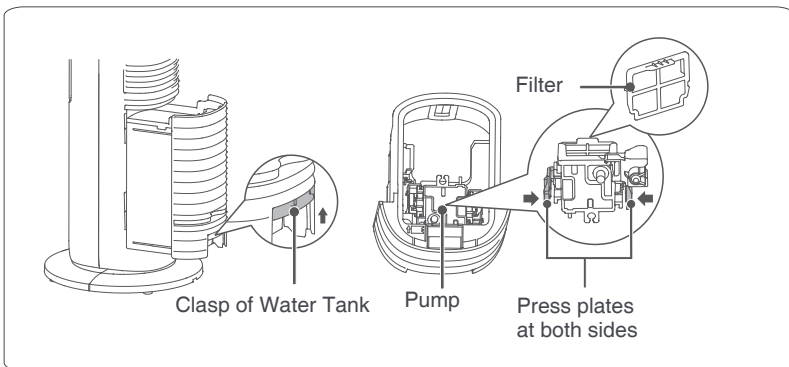

Troubleshooting

Issues	Self check	Possible solutions
The unit can't operate	Power cord is not connected or connected poorly	Make sure it is well connected
	Internal wiring is loose	Contact our support team
No humidification / pump has abnormal sound	No water in the water tank, or water quantity is below than the lowest water level of the water tank	Disconnect the power and add water, make sure the water level is between the highest and lowest water level
	The pump can't draw water	Press the Humidification button repeatedly until the pump can draw water normally
	The filter of the pump is blocked	Clean the filter of the pump according to "Maintenance"

Warranty & Customer Support

Warranty Information

1. 1-Year warranty:

TOSOT Evaporative Air Cooler comes with a 1-year warranty from the date of purchase.

This warranty covers manufacturing and material defects. Please visit <https://tosotdirect.com/warranty> for more details.

2. Additional 6-Month warranty extension:

You can get a 6-month warranty extension by registering your new product at www.tosotdirect.com/extend.

Customer Support

Questions? We are here to help

✉ support@tosotdirect.com

🌐 www.tosotdirect.com



Share your experience



@tosotdirect

VTST20230407