

X Lite Muffler - Installation Instructions

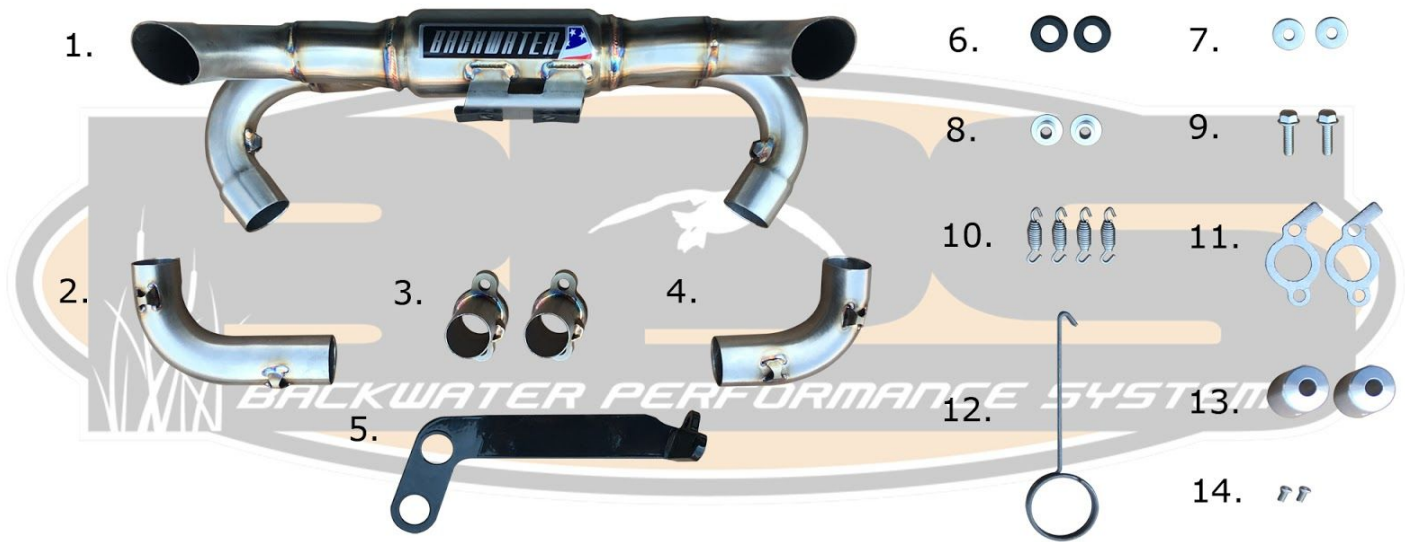

- 1. X Lite muffler
- 2. Muffler pipe #1
- 3. Exhaust header X 2
- 4. Muffler pipe #2
- 5. Muffler bracket

- 6. Bracket grommet X 2
- 7. Grommet washer X 2
- 8. Grommet spacer X 2
- 9. Bracket bolts X 2
- 10. Retainer spring X 4

- 11. Muffler gasket X 2
- 12. Spring tool
- 13. Silencer insert (optional)
- 14. Silencer screw (optional)

Remove your old muffler. First, locate the fasteners that hold your current muffler to the engine. If the muffler studs, nuts or bolts are rusted, spray them with penetrating fluid. Remove your old muffler by unscrewing the exhaust and bracket fasteners using a socket or wrench of the appropriate size. Then remove the old gaskets being careful not to let any debris enter the exhaust holes. You may have to clean the old gasket using a razor blade or scraper knife. Save the bolts.



Install the muffler gaskets and exhaust headers on the cylinder heads using the bolts you saved. Do not tighten the muffler fasteners all the way yet; you will do so at a later step.

Push the long end of the left and right muffler pipes firmly onto the exhaust headers with the spring brackets facing inwards. The illustration shows a view of the engine from the back. From this point of view, you will install muffler pipe #1 on the left side and muffler pipe #2 on the right side. Note that the short ends of the pipes are pointing up and the spring brackets are located on the inside.



Prepare the muffler bracket by laying the bracket flat (with the bent end sticking up) and pushing the rubber grommets into the large holes on the curved end of the muffler bracket. Push the spacers into the grommets. Place the bracket bolts inside the spacers. Pick up the bracket, place the washers on the extended ends of the bracket bolts, and attach the bracket to the clip-on nuts located on the bottom of the X Lite muffler. Do not tighten the bracket bolts all the way yet. The bracket washers should be between the muffler and the bracket. The bent end of the bracket should be pointed down and towards the engine.



Push the X Lite muffler firmly onto the muffler pipes previously installed, and attach the bent end of the bracket to the engine using the bolts you saved.



Tighten the exhaust headers and the muffler bracket bolts all the way, being careful not to over-tighten the bolts. Place any of the original bolts that you haven't used yet back into their original locations, and tighten them all the way.

Attach two of the retainer springs to the spring brackets on each of the exhaust headers. Use the spring tool to attach the free end of the retainer springs to the spring brackets located on the long end of each muffler pipe.



Attach the remaining two retainer springs to the spring brackets on the short end of each muffler pipe. Use the spring tool to attach the free end of the retainer springs to the spring brackets located on both ends of the muffler.

Installing the silencers is optional. Once installed, they are very difficult to remove. Install each silencer by lining up one of the holes in a silencer with the hole on the bottom end of the muffler. Press the silencer into the end of the muffler until the two holes are aligned. Secure the silencer to the muffler by inserting a silencer screw into the aligned holes and then tightening.

Make sure that all the bolts are tight and that the springs are in place. Once installed, the X Lite Muffler should look like this (the silencers are not installed on the muffler shown in this picture):

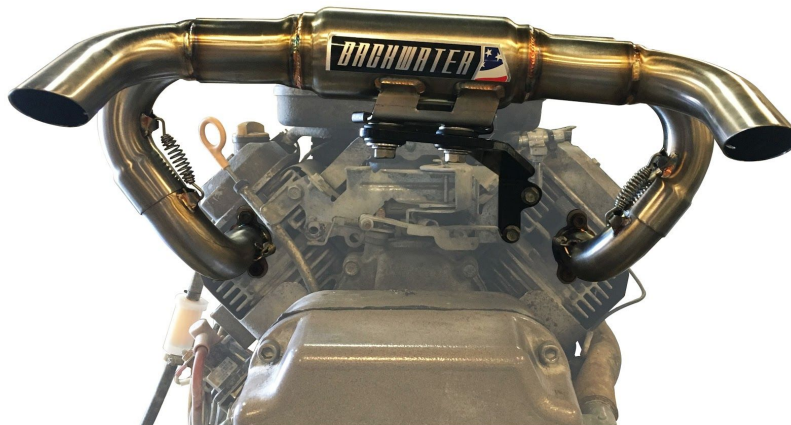

View more products and tech tips at backwaterperformance.com. Call [385-695-3807](tel:385-695-3807) if you require further assistance.