

Link-Able Light Series



Both sides Light

1. Introduction

2022 New NO RF Integrated LED Linear Lighting with 85+ CRI and up to 152lm/Watt efficiency. This light is dust proof and flame retardant.

2. Features

- A. Flame retardant PC cover and end cap, dust proof light.
- B. High 85+CRI and luminous flux, up to 80Ra and 152lm/Watt.
- C. Quick, simple installation
- D. High power factor
- E. 70% or more energy savings compared to conventional fluorescent tube systems.
- F. NO RF models feature an Internal RF Line Filter, eliminating radio distortion/interference, and garage door remote operation issues

3. Certificates

FCC VDE GS CE SAA RoHS CQC PSE LVD EMC

4. Application

Office lighting, Industrial/Commercial Shop, Factory, Parking Garage, Supermarkets, etc.

5. LED Durability Life Testing

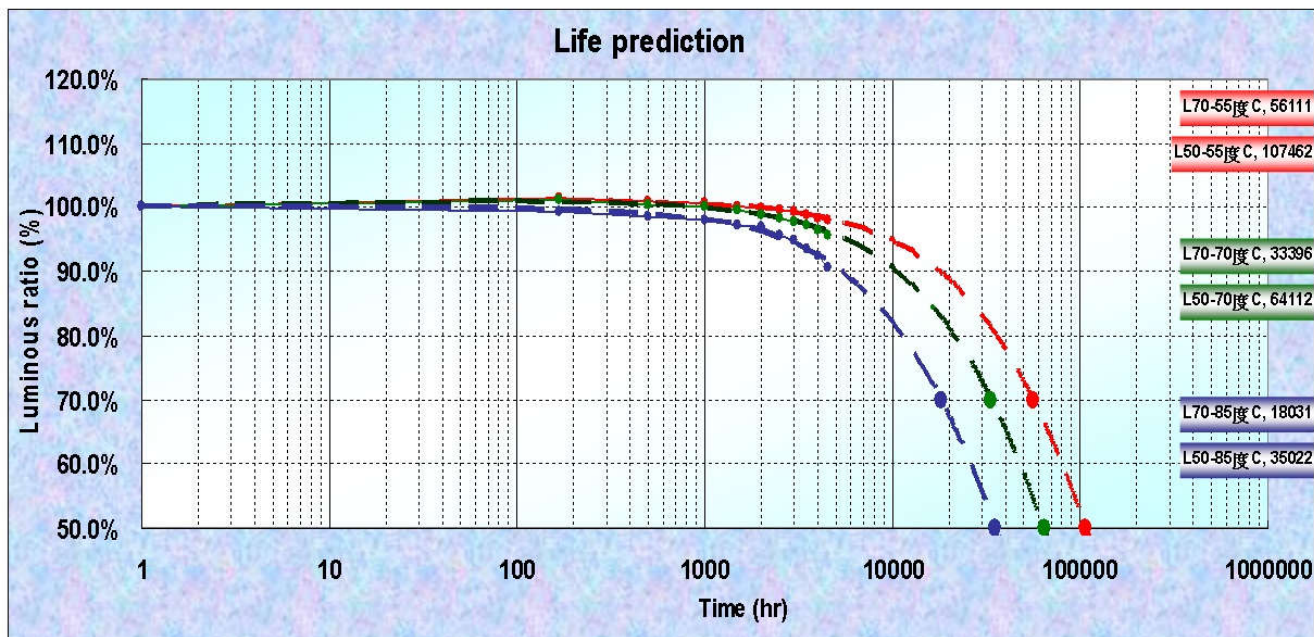

- Specifications: T8
- 1 Foot 10 Watt 1,520 Lumen
 - 2 Foot 18 Watt 2,736 Lumen
 - 3 Foot 25 Watt 3,800 Lumen
 - 4 Foot 36 Watt 5,472 Lumen "NO RF"
 - 4 Foot 72 Watt 10,944 Lumen "NO RF"
 - 5 Foot 48 Watt 7,296 Lumen
 - 6 Foot 56 Watt 8,512 Lumen
 - 8 Foot 72 Watt 10,944 Lumen "NO RF"
 - 8 Foot 144 Watt 21,888 Lumen "NO RF"

1. Cree 2835SMD LED's CLEAR COVER (152 lm/w)
*Frosted Cover 20% Less light output 170° projection
2. 85-277V NO RF Driver
3. 152.33+ Lumens Per Watt - High Efficacy System with Superior Driver Technology.
4. 5500-6500K 85+CRI(White) is standard, other Kelvin available by special order W/Stainless Steel Mounting Hardware
5. Direct Wire Cord (Whip)
6. Linking Plug for Daisy Chaining up to 300 Watt run.
7. Socket Cap
8. Industrial/Commercial Grade
9. Interlinking for continuous runs
10. HO Fluorescent Equivalent
11. 85+ CRI
12. Instant Start In Cold Conditions No Flicker or Hum
13. Aluminum/Polycarbonate Construction
14. 12 Year Simple Exchange Warranty based on LM79 Rated 80,000 Hours

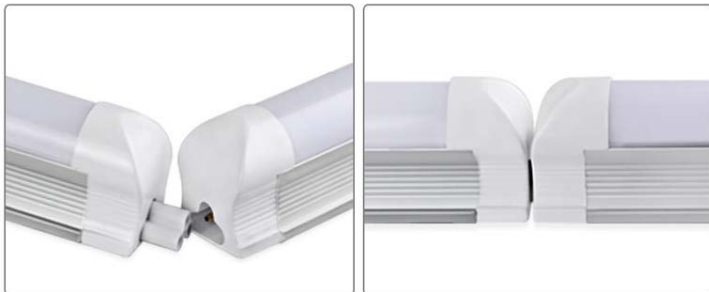

Included Accessories

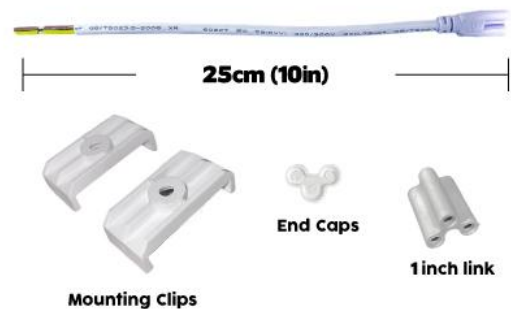

Installation method

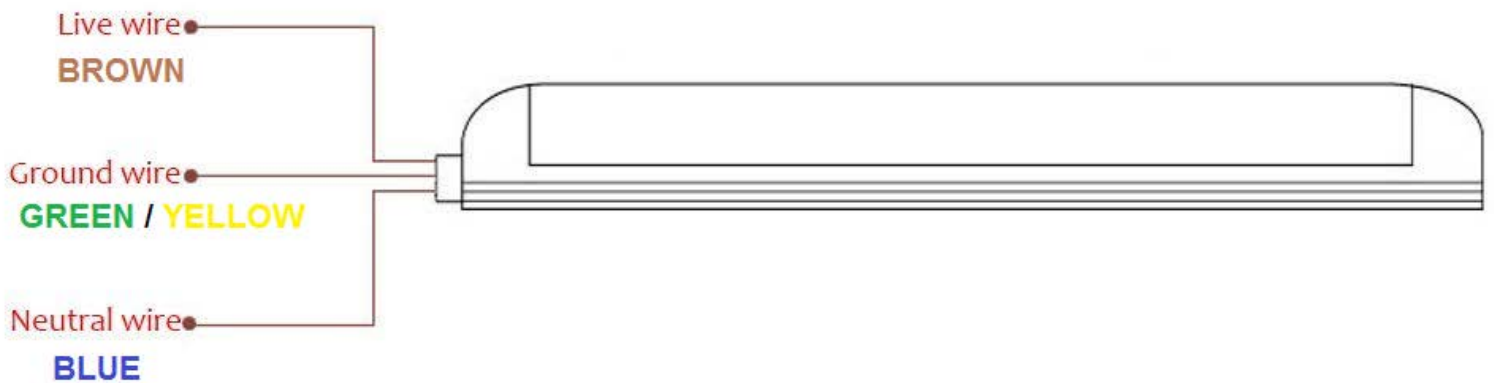
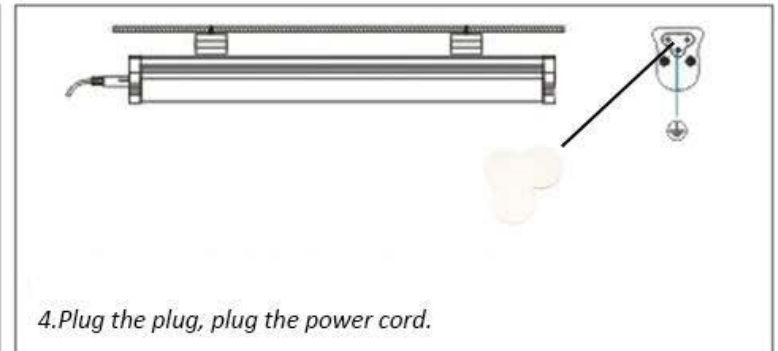
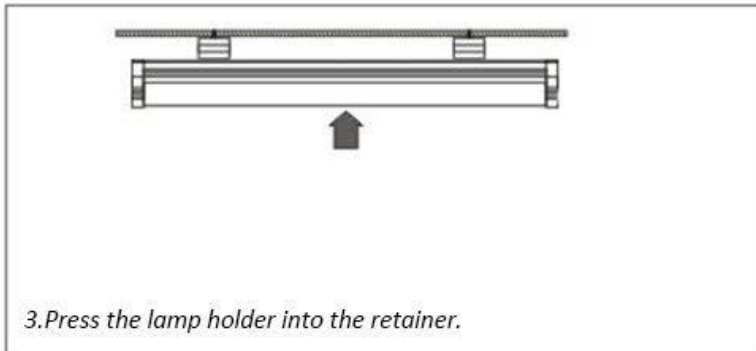
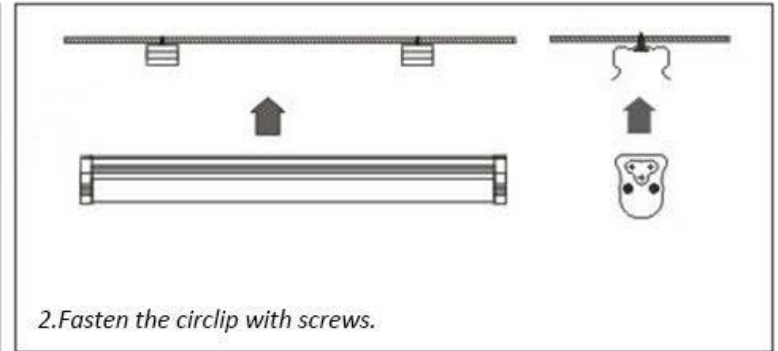
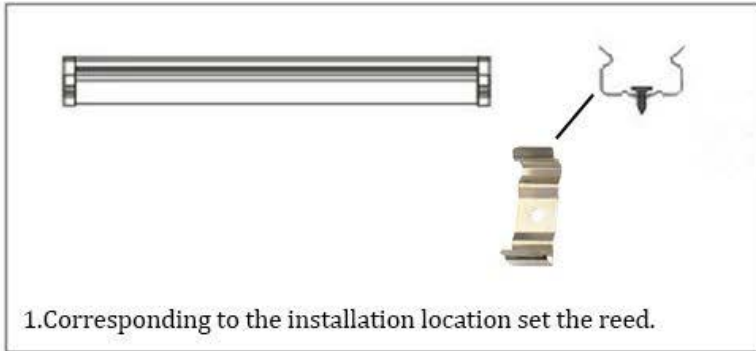

Tandem mounting method

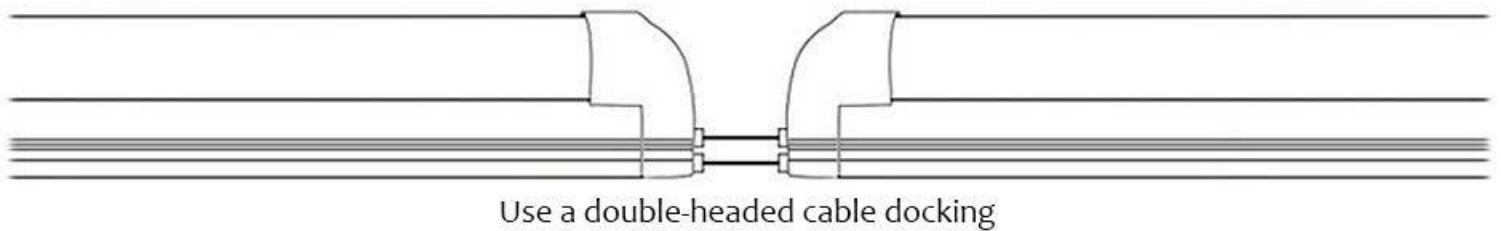
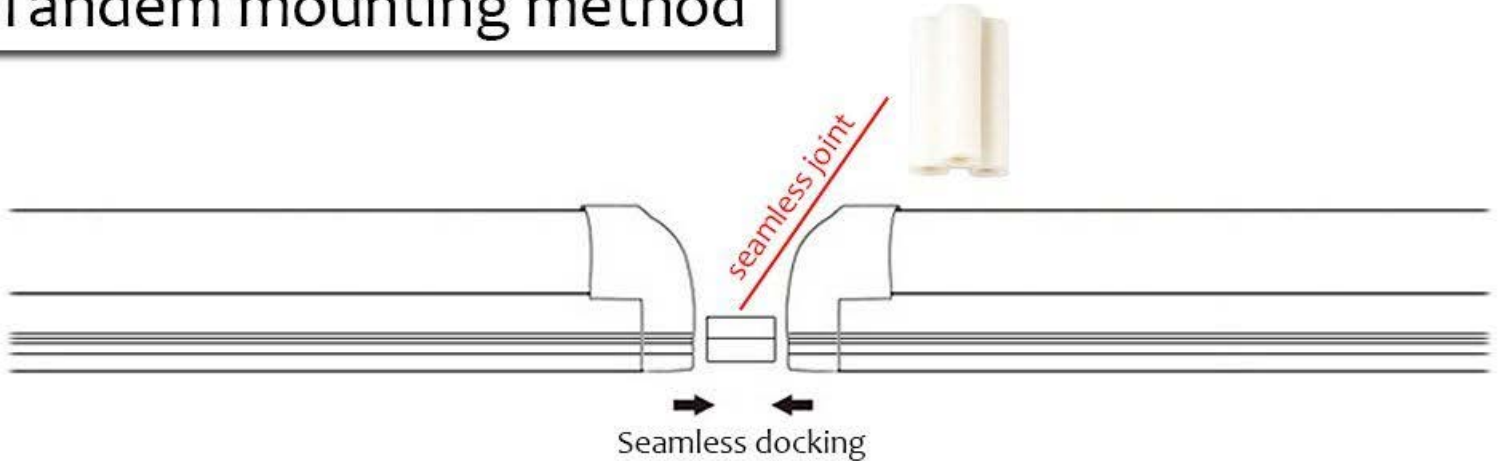

Note: The maximum length of the double-headed cable docking can not exceed 4 feet

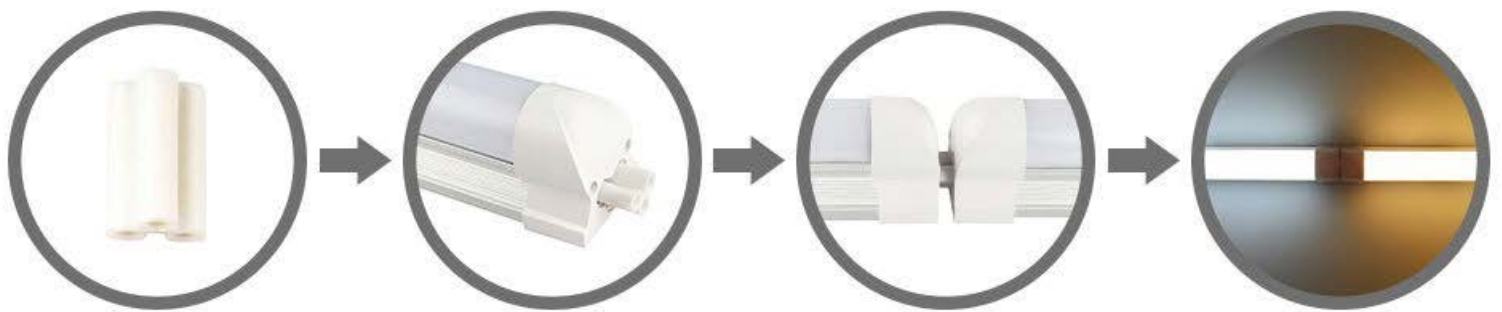

- ❶ Find the matching seamless interface. ❷ Seamless interface is inserted into the interface.
- ❸ Take another light tube alignment interface. ❹ press both ends to install.

Double-headed cable to force butt, installation is complete