

NEXEO | HDX™ Crew Communication Platform Quick Start Guide

THE NEXEO® BASE STATION AT A GLANCE



Each dot indicates a screen, blue is the one currently visible. Click on a dot or swipe/drag the screen to the left or right to view other screens.

INTRODUCTION

Congratulations on your investment! You are now equipped with the best wireless headset system available for your business needs. The interactive HOME screen provides you with a complete overview of your system at a glance. Innovative smart features enhance ease of use while color-coded indicators provide a quick visual status of a feature or component.



A green indicator means that the feature/component is online, active, and functional. In this example, the Speaker/Microphone is connected and functioning properly.



A red indicator means that the feature/component is offline, inactive, or requires attention. In this example, there are no headsets detected. Turn on a headset and pair one for this indicator to turn green.



A yellow indicator is a transitional state. In this example, the transceiver is scanning for available channels. Once an available channel is found, it turns green (this can take a few minutes).



A gray indicator means that no AC70 Smart Battery Charger is detected. Position the AC70 within 10 feet (3 m) of the base station for this indicator to turn green. Note: the AC70 can function independently (it does not require a base station connection to function).

HOME SCREEN OVERVIEW

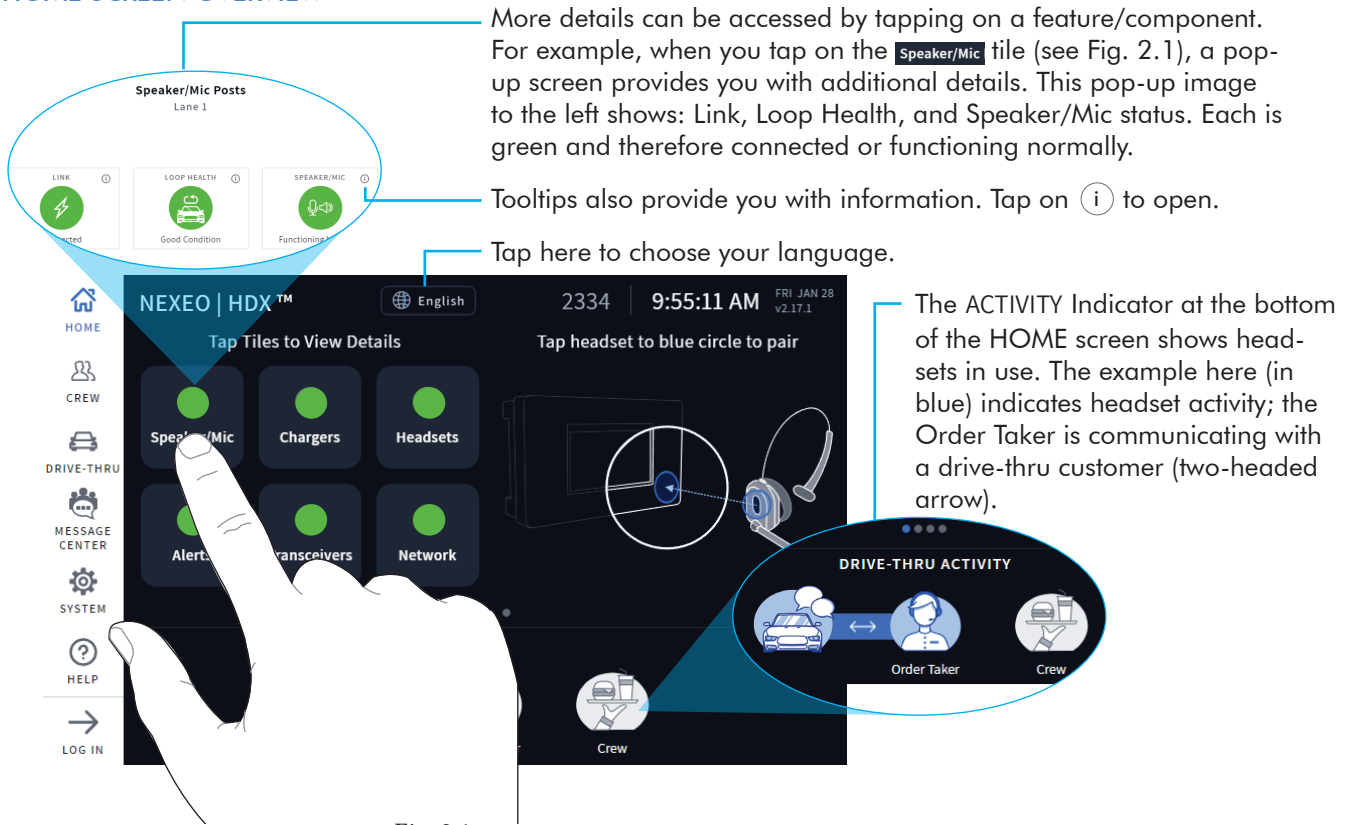

Fig. 2.1

MESSAGE CENTER OVERVIEW

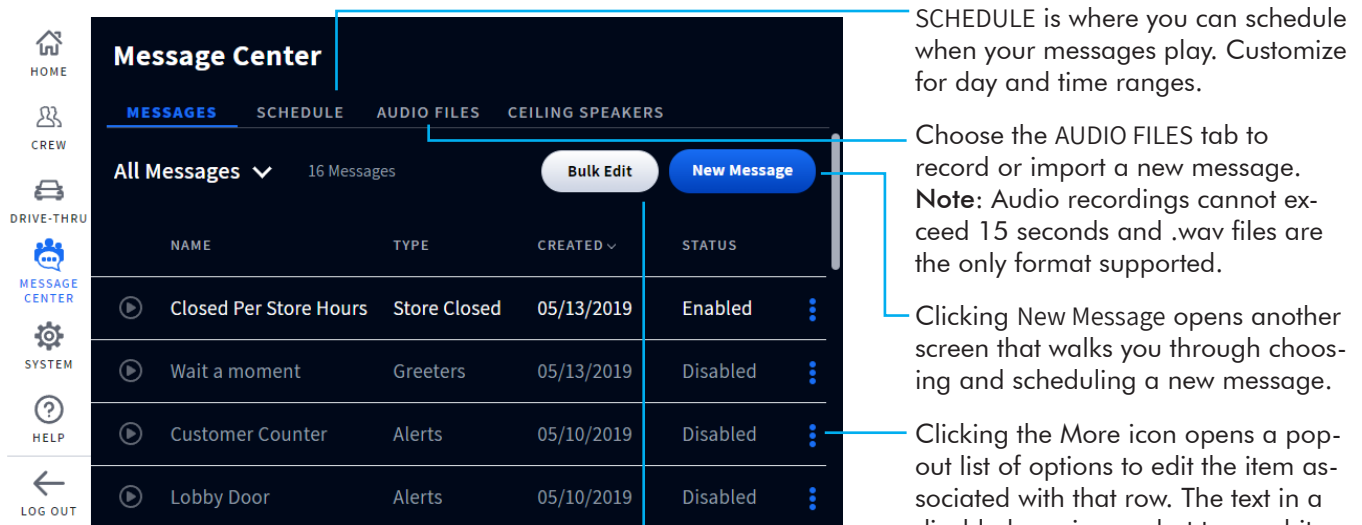

Fig. 2.2

The Message Center allows you to select a "Message Type" from a library of prerecorded messages and configure schedules for the message. You can also customize, record, or import your own audio files. Ceiling speaker volumes are also adjusted here.

Note: The Message Center requires a four-digit PIN to access. The Store Manager receives this after installation. Record here: _____

HEADSET OVERVIEW

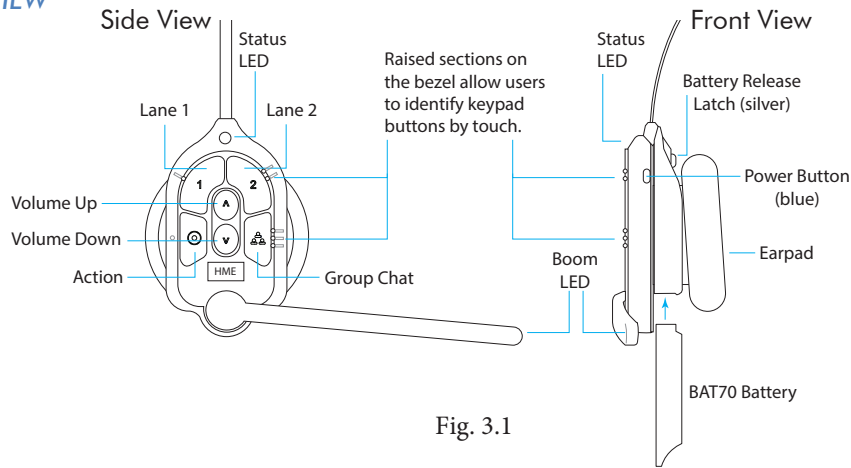

Fig. 3.1

Headset Keypad Reference Table				
Icon	Label	Status LED	Boom LED	Status/Description (voice commands are initiated by saying "Ok Nexeo" first)
1	Lane 1	Green	Green	Tap to talk to lane 1. The Status LED flashes green while the Boom LED turns on solid green. Tap again to stop. The Status LED turns solid; the Boom LED turns off. Voice Command: "lane 1" (to listen only) or "talk to lane 1," or "change lane" if in lane 2
2	Lane 2	Red	Red	Tap to talk to lane 2. The Status LED flashes red while the Boom LED turns on solid red. Tap again to stop. The Status LED turns solid; the Boom LED turns off. Voice Command: "lane 2" (to listen only) or "talk to lane 2," or "change lane" if in lane 1
	Volume Up			Tap to increase volume (the headset beeps become louder as confirmation). Press and hold to maximize volume to loudest. Voice Command: "volume up" or "volume #"
	Volume Down			Tap to decrease volume (the headset beeps become quieter as confirmation). Press and hold to minimize volume to quietest. Voice Command: "volume down" or "volume #"
	Group			Tap for group chat. Both Status and Boom LEDs flash quickly, alternating red & green. Tap again to stop. The Status LED changes to a solid yellow in listening only mode.
	Action			If the headset is set to answer phone calls. Tap once to answer, tap again to end call. Press the 1 or 2 key twice to put the phone call on hold and talk to a respective lane. Press 1 or 2 once followed by the Action key to return to call. Press again to end call.

Notes: Both the Status and Boom LEDs flash slowly with alternating colors when the headset needs to be paired. A yellow Status LED indicates a low battery. The low battery Status LED is also accompanied by audio prompts.

Voice commands can be used instead of tapping the keypad but must first be enabled on the Base Station. To use voice commands, begin by saying "Ok Nexeo," then, once the Boom LED turns on white continue with a voice command, see table above.

Push-to-Talk mode: Press and hold any audio button (L1, L2 or Group Chat) to use in this mode (there is an audible single-tone confirmation). Release to cease communication and exit this mode (there is an audible two-tone confirmation).

Pairing your Headset (AIO HS7000):

1. Verify the headset has a fully charged BAT70 battery installed (see Fig. 3.1).
2. Press the blue power button to turn on the headset (see Fig. 3.1). The headset LEDs turn on and flash slowly, alternating between green and red, indicating you now need to pair the headset.
3. Hold the keypad side of the headset against the blue headset pairing ring on the base station. Pairing begins automatically once the headset is sensed. The blue pairing ring turns a swirling green to indicate it is pairing (see Fig. 3.2).

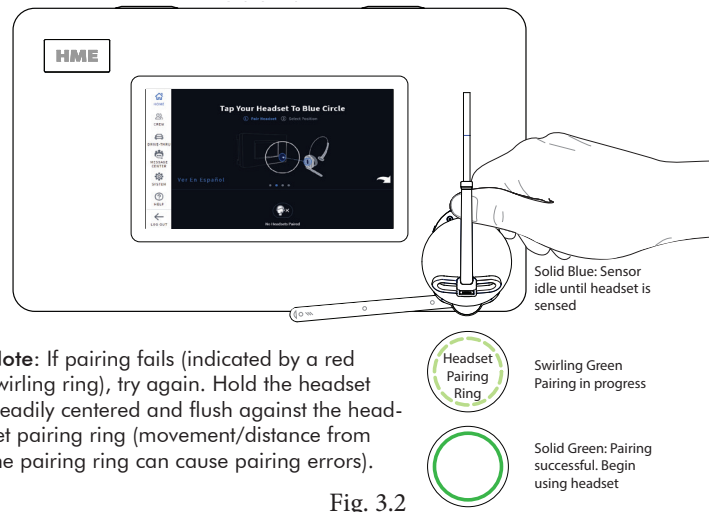

Fig. 3.2

- When the headset pairing ring turns solid green, pairing is successful. The headset status LED also turns solid green. Registration also happens automatically with the initial pairing. See Fig. 3.2 note if pairing fails.
- Select your name from the crew profile or skip and continue as a quest. When the **Select Your Position & Options** screen appears (see Fig. 4.1), tap on a tile to select your position. If you are selecting a DRIVE-THRU position, you also have the option of AUTO HANDS-FREE mode. This saves you from having to manually connect with a new customer using the headset keypad.

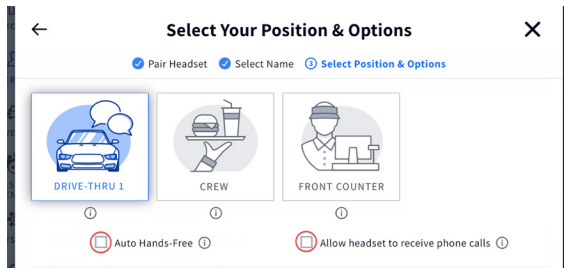

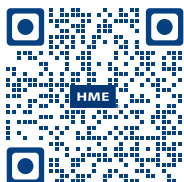

Fig. 4.1

When the AUTO HANDS-FREE box is checked, you are automatically connected with customers when they arrive at the order point and then automatically disconnected when they leave. This feature is only available for one headset per drive-thru lane. The headset remains in this mode until the headset is taken out of use or powered off.

When the ALLOW HEADSET TO RECEIVE PHONE CALLS box is checked, your headset can answer phone calls using the  (Action) key. Only one headset can be designated to receive phone calls and your system must have a TI7000 installed to use this feature.

- Select Next, and this Success prompt appears. Tap OK to begin using your headset.



Visit the **HME Training Portal** by scanning this QR Code to the left or going to: <https://www.hme.com/training>

This guide, regulatory and compliance information, and much more can also be found under NEXEO | HDX by scanning the QR code below or going to: <https://www.hme.com/qsr/drive-thru-user-manuals/>

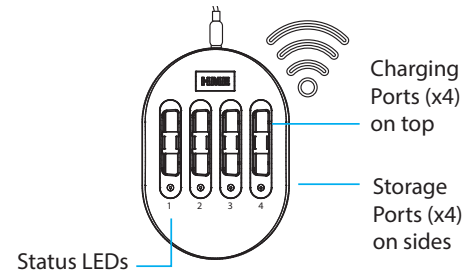

AC70 SMART BATTERY CHARGER OVERVIEW



Note: The storage ports do not charge batteries.

Using the AC70 Smart Battery Charger:

- Install the AC70 close to the base station (<10 ft (3 m)) and connect it to a power outlet.
Note: The AC70 will still charge batteries outside of this range but without base station feedback.
- Insert a BAT70 battery into the charging port to begin charging (new batteries must be charged). The Status LEDs on the AC70 indicate charge status (see AC70 LED Reference Table).
Note: When within range, battery status is also provided via the base station HOME screen. Tap **Chargers** on the HOME screen to view status.

AC70 LED Reference Table		
LED	Color	Status/Description
	Green	Flashing green = Charging Solid green = Fully charged
	Red	Flashing red = Incompatible battery
	Red/Yellow	Flashing red & yellow = Fault condition

HELP

Need more help? Tap HELP or use the QR code and URL links on this page. Product guides are found under Drive-Thru Headset Systems>NEXEO | HDX. Contact information is also found on the front page.

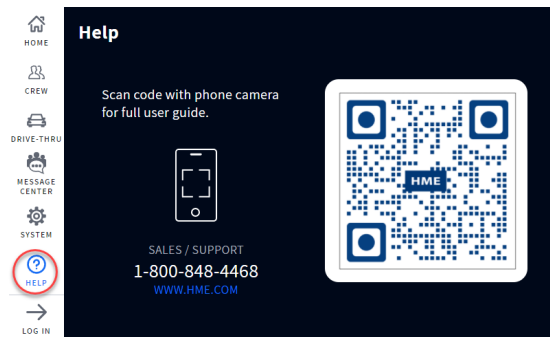

HME User Manuals and Documents
www.hme.com/manuals

© 2023 HM Electronics, Inc. All rights reserved.

The HME logo and product names are trademarks or registered trademarks of HM Electronics, Inc.