

- For non-user replaceable light sources:
"The light source contained in this
luminaire shall only be replaced by the
manufacturer or
his service agent or a similar qualified
person."

Giulio Recessed Wall flexible hose

Assembly Instructions

11840-13

220V-240V ~ 50Hz/60Hz

LED 1xMax.3W

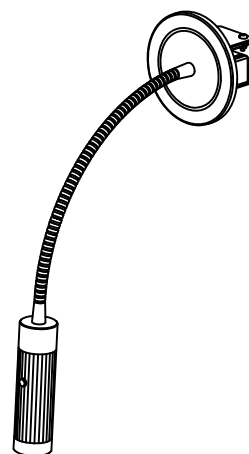

Lighting Solutions

CONTENTS

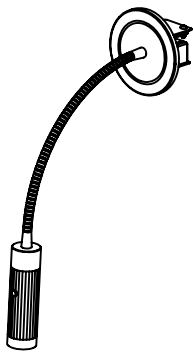

1 x main body



2 x Raw plugs



2 x Wall Screws

BEFORE YOU START

It is extremely important that these instructions are read carefully and any illustrations studied before commencing installation. Please retain these instructions for future reference.

WARNING!

- Electricity can be dangerous.
- Do not attempt to fit installation unless you are competent.
- If in any doubt consult a qualified electrician to complete electrical installation.
- Installation to comply with current IET wiring regulations
- The lighting is for use in a normal dry domestic indoor environment.
- If you find any damage to the electrical parts, please ask a qualified electrician to replace it.

Installation

- Take care when handling and installing to avoid damage to the product.
- Avoid mounting the fitting on a damp surface such as newly painted or plastered area as this may cause discoloration of the finish.

Tools

- Cross headed screwdriver.

Cleaning Instructions and Care

- Take extra care when cleaning and assembling.
- Do not use any chemical or abrasive agents to clean the shade.

General Assembly

1. Making sure that the power source is still accessible. Drill the surface to fit the section wall light using the metal bracket to locate the holes position.
2. Open the hole in the fixing board size: Ø5.5CM
4. Screw the metal bracket onto the wall. using the selftaping screws and raw plugs if necessary. put the deco cover in place.

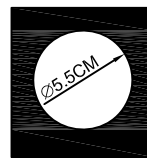

3. Using the connector block to connect to the mains power supply as shown below.

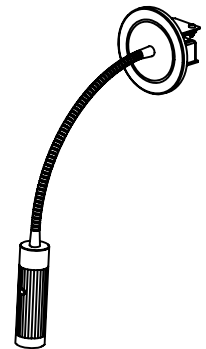
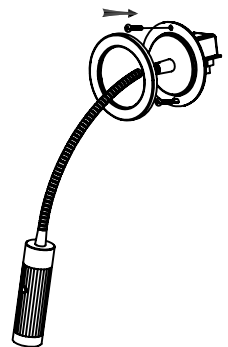
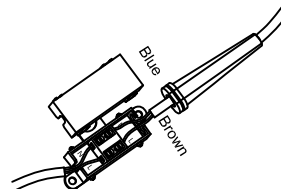

Your light is now ready for use