

## Implant-One Healing Caps (Tissue Formers)

100 Series



Standard Profile

IT140-05	IT240-05
IT140-10	IT240-10
IT140-20	IT240-20
IT140-30	IT240-30
IT140-40	IT240-40
IT140-50	IT240-50

200 Series



Wide Emergence Profile

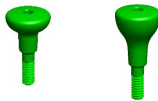

IT142-30	IT242-30
IT142-50	IT242-50

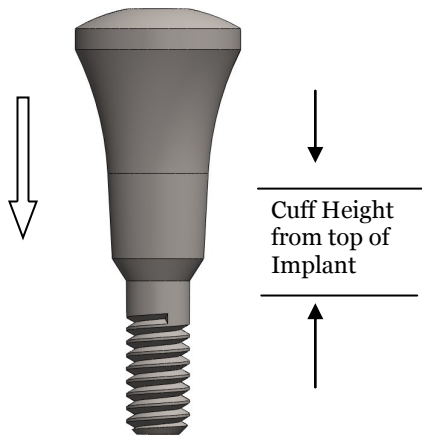

Standard .050 Hex



Wide Emergence Profile Cap

### Important note:

When installing Healing Cap, tighten it only finger tight, no more than 6 Ncm torque. It can be difficult to remove if over tightened.

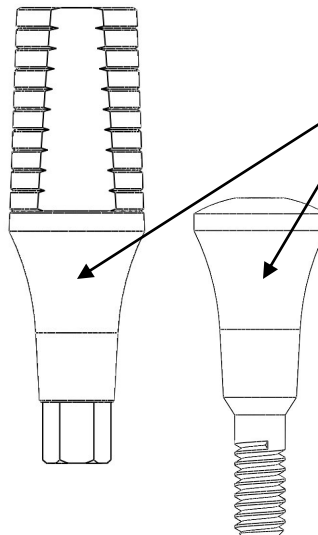
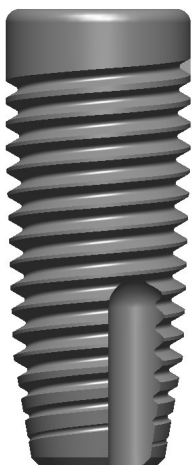

Emergence Profile of Standard Healing Caps exactly match that of the system Abutment components.

In cases where the standard abutment can be utilized, the Abutment will fit exactly in the socket formed by the corresponding Healing Cap.