

Implant-One Conical Abutment

Implant-One standard conical abutments are used to secure screw retained prosthesis

Made of Grade 5 Titanium.

The straight abutment will compensate for up to a 20 degree angled implant and is available in 1mm, 3mm, and 5mm cuff heights

Burn out sleeves for use in casting a bar with the mating conical shaped mating socket (supplied with abutment)

Titanium sleeve can be bonded into all zirconium, screw retained removable dentures. (optional part)

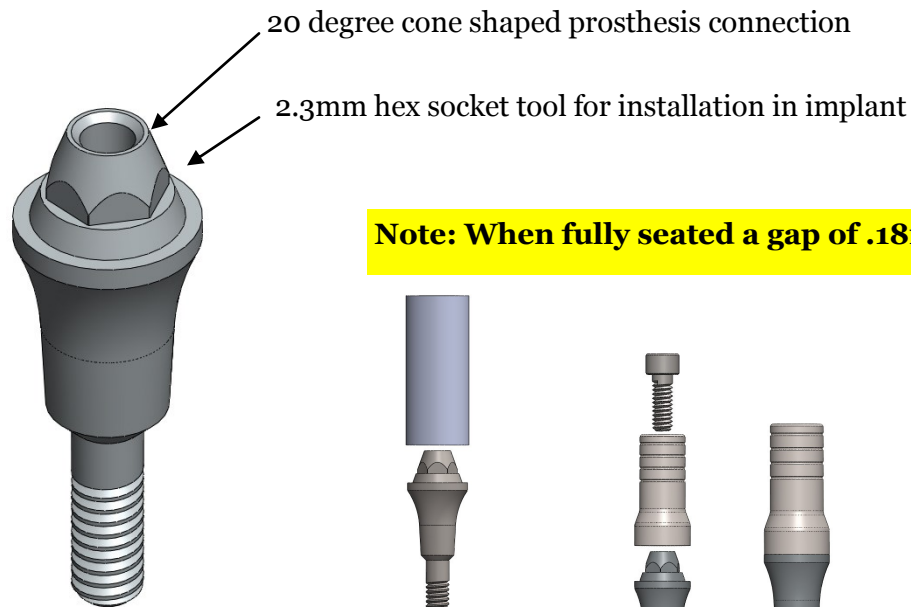

Note: When fully seated a gap of .18mm (.007") is visible

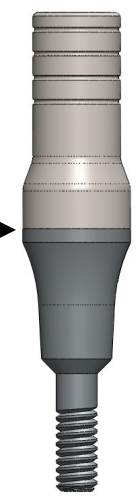

- | | |
|---|---|
| <p>200 Series
IT237-10
IT237-30
IT237-50</p> | <p>100 Series
IT137-10
IT137-30
IT137-50</p> |
|---|---|

Conical Abutment
With standard burn
out sleeve

Conical Abutment
with optional
Titanium Sleeve
Part no. IT331

Impression coping
Open tray style only
Part no. IT3500

Analog
Part no. IT390

Healing Cap
Part no. IT341

Socket Driver
Part no. ST510