

Appearance

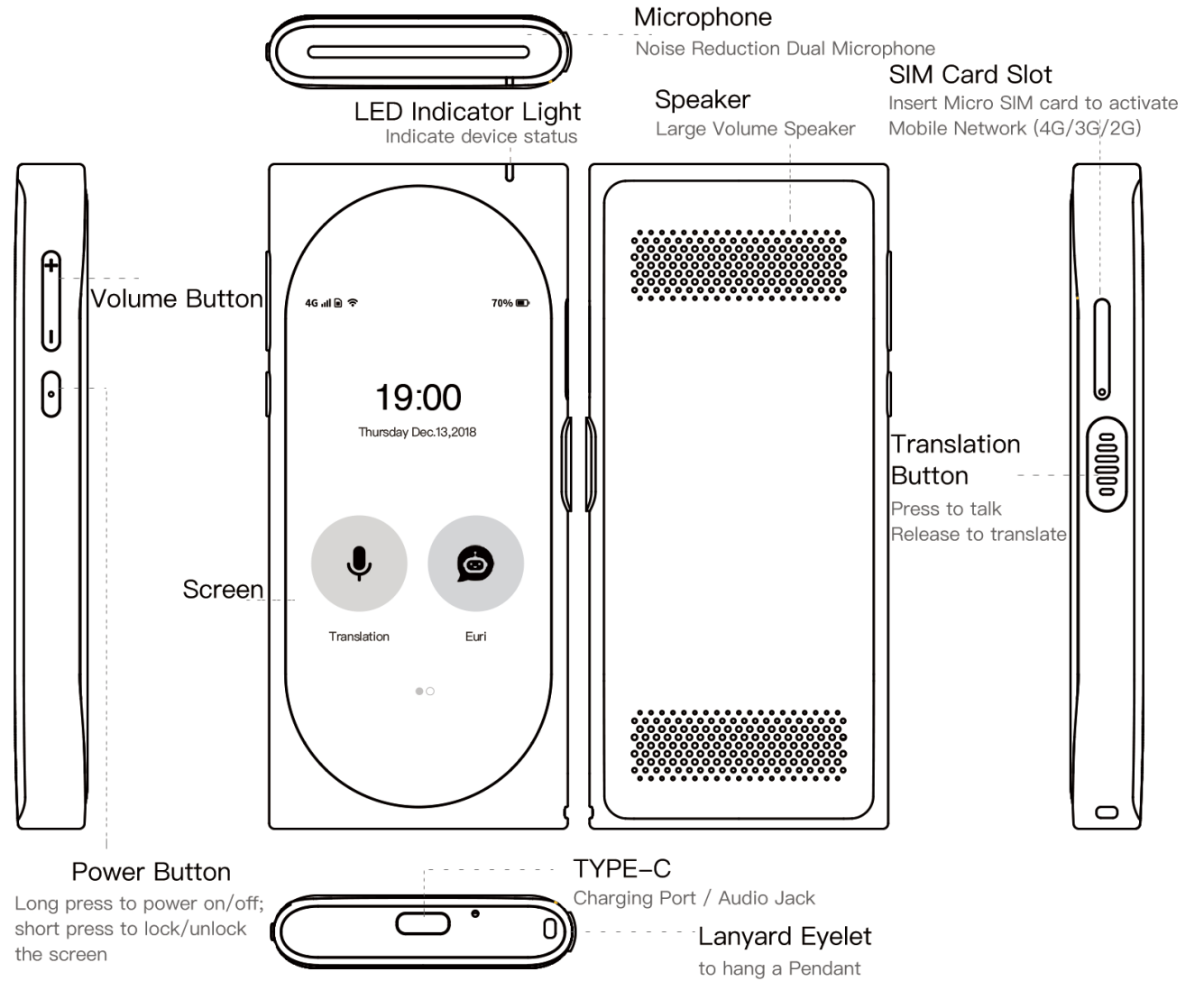

Specifications

Production: Langogo Genesis

Dimensions: 4.78*2.41*0.52in

Colors: Black / White

Weight: 0.25lb

Touch Screen: 3.1in capacitive screen;
800*480p

CPU: MTK6739 Quad-Core 1.5GHz

ROM: 8GB

Microphone: Active Noise Reduction Dual Microphone

Speaker: High-fidelity loudspeaker with
two-chamber high power amplifier

Support typeC audio output connector

Supported Frequency: 2G GSM(B2,B3,B5,B8)

3G TDSCDMA(B34,B39)

3G WCDMA(B1,B2,B5,B8)

4G TDD_LTE(B38,B39,B40,B41)

4G FDD_LTE(B1,B2,B3,B5,B7,B8,B17,B20)

Battery Capacity: 2200mAh

Working Temperature: 14°F-104°F

Working Humidity: <70%

Working voltage: 3.5V-4.2V

What's in the Box: Translator *1 Type-c Cable *1

Eject Pin *1 User Manual *1 Lanyard *1

Operation Guide

How to connect network?

1.Connect Wi-Fi

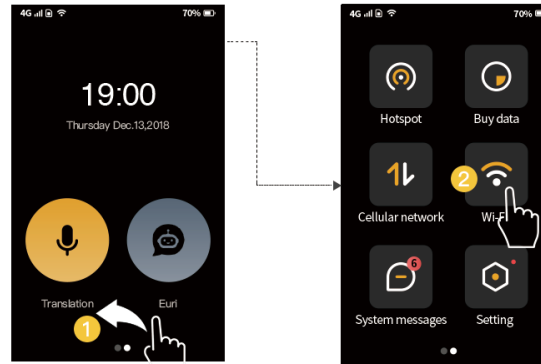

Slide left to the menu page > click "Wi-Fi" button > enable Wi-Fi connection > select the wireless network to be connected to > enter the correct password to connect

2.Insert SIM Card

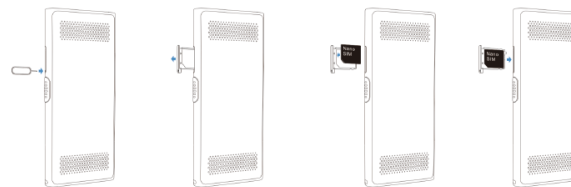

Note: Only Micro-SIM card is available for our Device. Any other non-standard card may cause the broken of SIM card slot or the device can't recognize the card. After inserting SIM card and restart the device, you can use SIM Card network service.

3.Use device self-contain eSIM Card

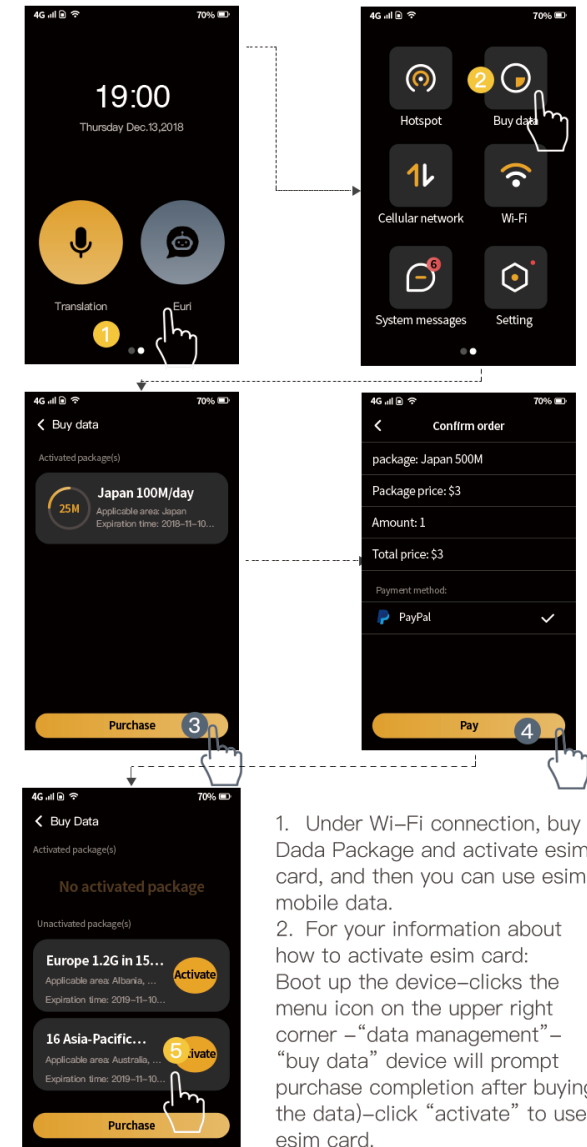

1. Under Wi-Fi connection, buy Dada Package and activate esim card, and then you can use esim mobile data.
2. For your information about how to activate esim card: Boot up the device-clicks the menu icon on the upper right corner -"data management"- "buy data" device will prompt purchase completion after buying the data)-click "activate" to use esim card.

How to Switch Between Languages?



Enter voice translation interface

Slide upward to show inter-translation languages

Click national flag to enter language list

Click to select language

Two-way translation:

It supports two-way translation between the selected two languages.

How to translate?



Press to speak

Release to translate

One Click translation:

Device can automatically judge the inter-translation language which means if you say one language, it will translate another language automatically.

How to Share Hotspot to Another Device?

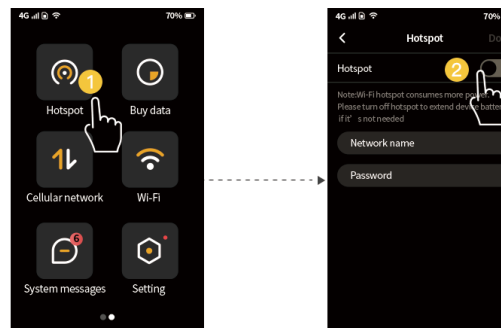

How to Use Voice Assistant Euri?

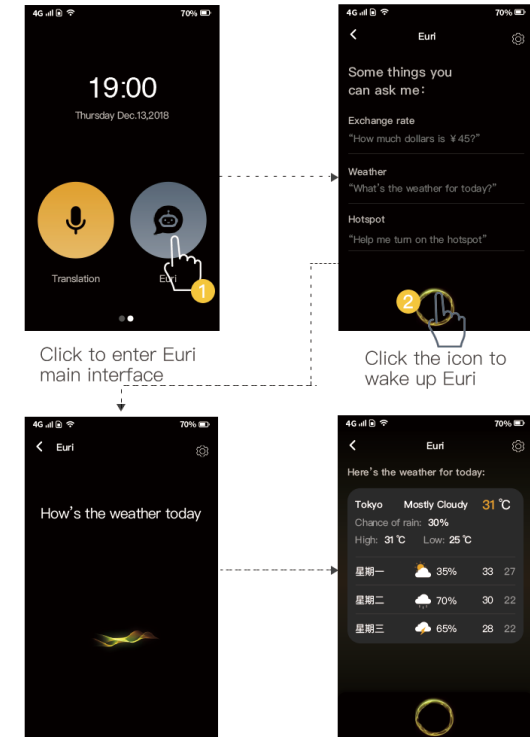

Click to enter Euri main interface

Click the icon to wake up Euri

Tell Euri your questions

The result shows

Languages:

Euri only supports 2 languages: Chinese / English now.

Euri's skills:

You can use Euri to inquire the weather, turn on hotspot, convert exchange rate etc. Searching for food and entertainments and using navigation etc. will be available gradually.

Usage Scenario

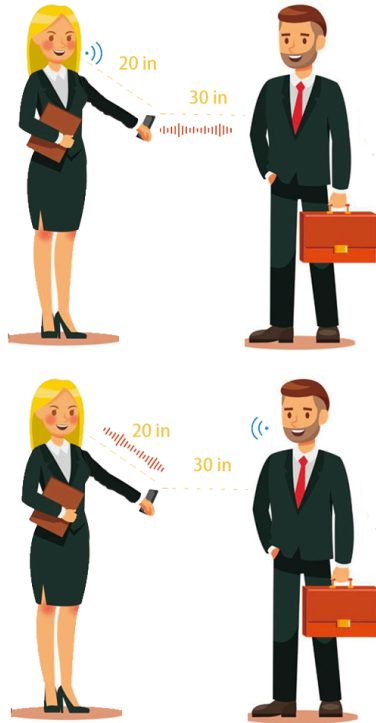

Far-field Recognition:

Our device support far-field recognition (0-40in recognition distance).

Ambient Noise Cancellation:

The translator can reduce the surrounding noise effectively under noisy environments.

Precautions

- 1- Please upgrade the firmware using the official methods if needed.
- 2- The signal may be weak or even no signal at airport, expressway, port, etc. Please restart the device to reconnect the network after leaving those places.
- 3- Please don't watch video online, download video, software or other high-traffic operations online when using hotspot overseas.
- 4- Do not use it outdoors in lightning storms.
- 5- Keep it out of reach of children.
- 6- Please use the battery, the charger and other accessories supplied by Langogo Genesis.
- 7- Do not make the device undergo the collision or damage.
- 8- The device is not waterproof, so please keep it away from any liquids.
- 9- Power off the device before boarding or near gas station.
- 10- Please charge the device in a well-ventilated environment and keep it away from flammable and explosive materials.

*Please use the device according to above instructions, otherwise we will not bear any responsibility, please acknowledge.

Declaration



FCC Declaration of Conformity

FCC ID: 2AQLY-T1

This device complies with part 15 of the FCC Rules. Operation is subject to the following two conditions:
(1) This device may not cause harmful interference, and (2) this device must accept any interference received, including interference that may cause undesired operation.



CE Declaration of Conformity

This product complies with the Council's RTTE Directive 99/5/EC. The CE mark is used to demonstrate compliance with this directive.