

Wall Hook

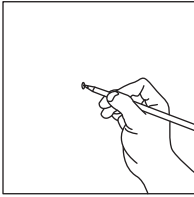

1. Mark.

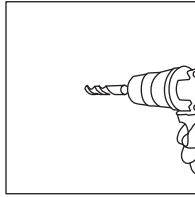
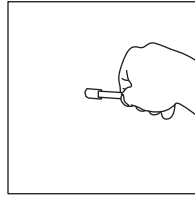

2. Drill.



3. Insert.

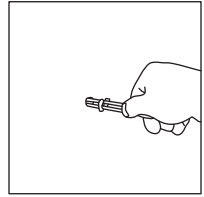

4. Slide.

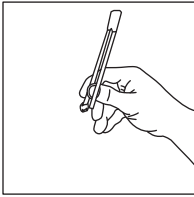

5. Snap.

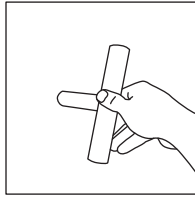

6. Twist.

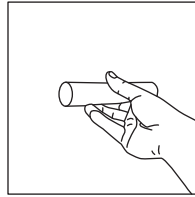

7. Stop.

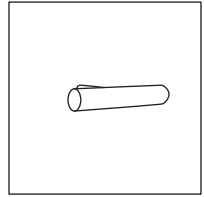

8. Enjoy.

Parts Needed

Wall hook, drywall anchor, pencil & drill.

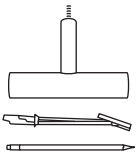

Instructions

1. Mark hole.
2. Drill a 1/2" hole.
3. Press metal channel against plastic shaft and insert into hole.
4. Hold ends of straps between thumb and forefinger and pull toward you until channel rests flush behind wall. Slide plastic cap down the shaft with other hand until flange of cap is tight and flush with wall.
5. Lift one side of the shaft up to snap off and do the same with the bottom side.
6. Place Wall Hook and tighten like a corkscrew until flush with wall.
7. When you get to your final turn, do not twist back or the hook will become loose.
8. Enjoy.